

DESIGNATION OF ZONING DIST.

IBD

HEAVY IND.

REFERENCE DRAWINGS:

CAD FILE: 139GP065000

REV	BY	DATE	DESCRIPTION
1	18759 DRW	6/06	UPDATED PROPERTY OWNERSHIP
0	19859 DRW	4/06	NEW DRAWING

COMPANY CONFIDENTIAL
 This drawing is the property of Sterling Chemicals and must be accounted for. Information herein is confidential and must not be reproduced, transmitted to unauthorized persons or used outside the company without proper authorization.

STERLING CHEMICALS
 TEXAS CITY, TEXAS
 ENGINEERING DEPT.
 PLOT NO. 18759
 TEXAS CITY GENERAL PLANT

PLOT PLAN
 ADJACENT PROPERTY

DATE	BY	DATE	BY
4/13/06			
SCALE	NONE	DATE	187

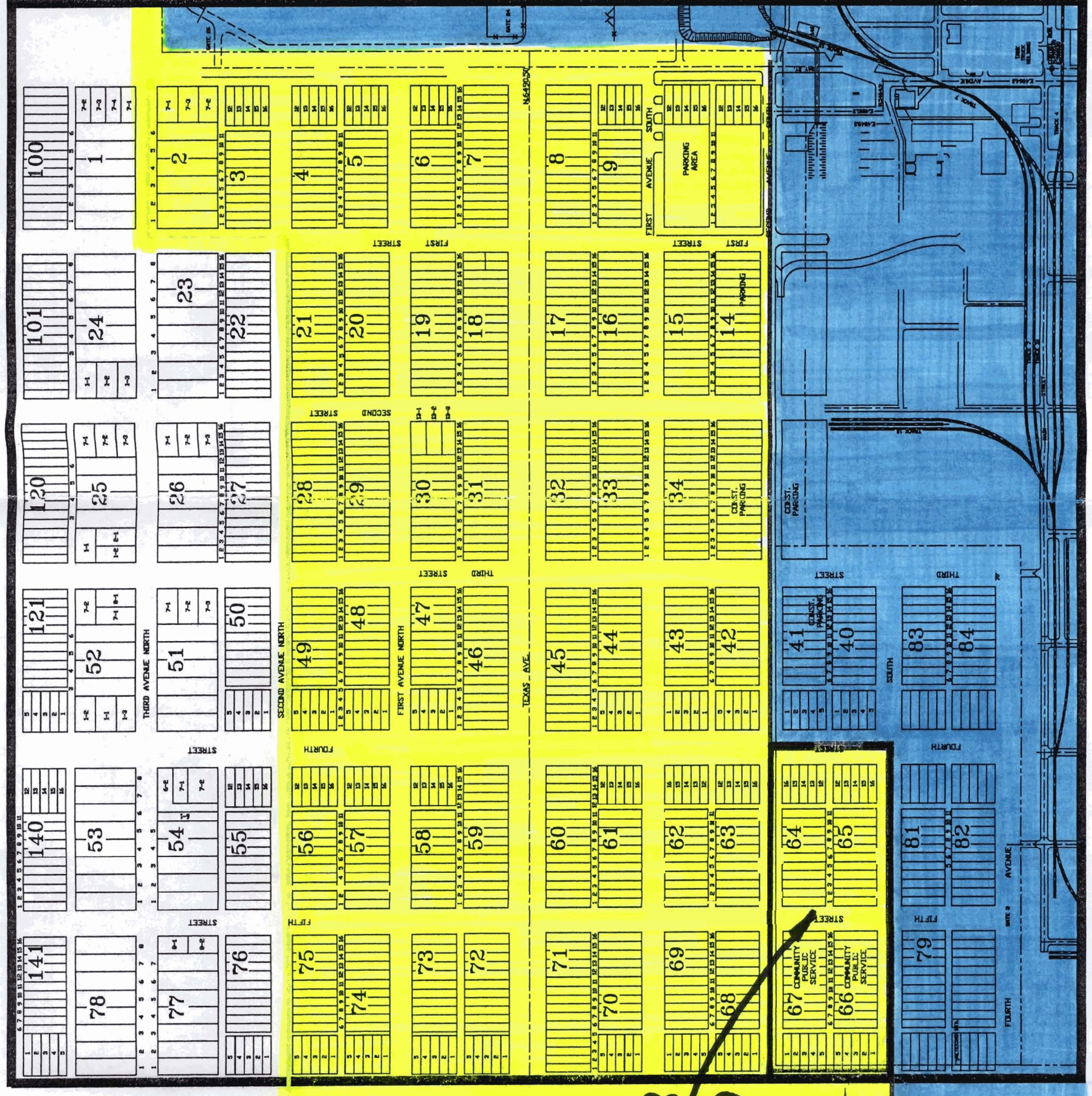

LIGHT INDUSTRY

PROPERTY TO BE REZONED

REZONE TO HEAVY INDUSTRY

HEAVY INDUSTRY