



Permit to Construct Access Driveway Facilities On Atascosa County Road Right of Way

Permit Number: <u>1024-317</u> ck# <u>21361</u>		
Applicant/Permitee	GPS*	Roadway
Name: Wesla Ranches, LLC	Latitude, Longitude N <u>28°59'53.81"</u> , W <u>98°46'02.65"</u>	Name: CR 311
Mailing Address: <u>150 Candelaria</u>		
City, State, Zip: <u>Helotes, TX 78023</u>	For County's Use	
Phone number: <u>210-223-6751</u>	Pct. No.: _____	
*Global positioning system coordinates intersection of driveway centerline with abutting roadway.		

Atascosa County, hereinafter called the County, hereby authorizes Wesla Ranches, LLC hereinafter called the Permittee, to _____ construct/ reconstruct a commercial (residential, commercial, farm, etc.) access driveway on the County Road right of way abutting County Road 311 in Atascosa County, located 1.13 miles south of SH 173 on a 234.84 ac tract (Property ID 224522) _____ (use additional sheet as needed).

Subject to Access Driveway Policy and the following:

1. The undersigned hereby agrees to comply with the terms and conditions set forth in this permit for construction and maintenance of an access driveway on the county road right of way.
2. Design of facilities shall be as follows and/or as shown on sketch on page 15 and is subject to conditions stated below:
30 ft wide all-weather paving driveway (12" compacted base), constructed per C3.0 (attached)

_____ All construction of materials shall be subject to inspection and approval by the County.

3. Maintenance of facilities constructed hereunder shall be the responsibility of the Permittee, and the County reserves the right to require any changes, maintenance or repairs as may be necessary to provide protection of life or property on or adjacent to the highway. Changes in design will be made only with the approval of the County.
4. The Permittee shall hold harmless the County and its duly appointed agents and employees against any action for personal injury or property damage sustained by reason of the exercise of this permit.
5. Except for regulatory and guide signs at county roads and city streets, the Permittee shall not erect

any sign on or extending over any portion of the highway right of way, and vehicle service fixtures such as fuel pumps, vendor stands, or tanks and shall be located at least 12 feet from the right of way line to ensure that any vehicle services from these fixtures will be off the county road right of way.

6. The County reserves the right to require a new access driveway permit in the event of a material change in land use or change in driveway traffic volume or vehicle types.

7. This permit will become null and void if the above-referenced driveway facilities are not constructed within six (6) months from the issuance date of this permit.

8. The Permittee will contact the County's representative Britni Van Curan telephone (830) 769-2748 at least twenty-four (24) hours prior to beginning the work authorized by this permit.

9. The requesting Permittee will be provided instructions on the appeal process if this permit request is denied by the County.

Date of Issuance County Authorized Representative

The undersigned hereby agrees to comply with the terms and conditions set forth in this permit for construction and

maintenance of an access driveway on the highway right of way.

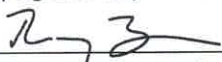
Date: 11/4/2024 Signed: 
(Property owner or owner's representative)
Engineer

WESLA RACHES, LLC

COUNTY ROAD 311
CHARLOTTE, TX

COMMERCIAL DRIVEWAY PERMIT CONSTRUCTION PLANS

SHEET INDEX

Description	Sheet No.
COVER SHEET	C0.0
GENERAL NOTES	C1.0
DRAINAGE PLAN	C2.0
DRIVEWAY PLAN	C3.0
TRAFFIC CONTROL PLAN	C4.0

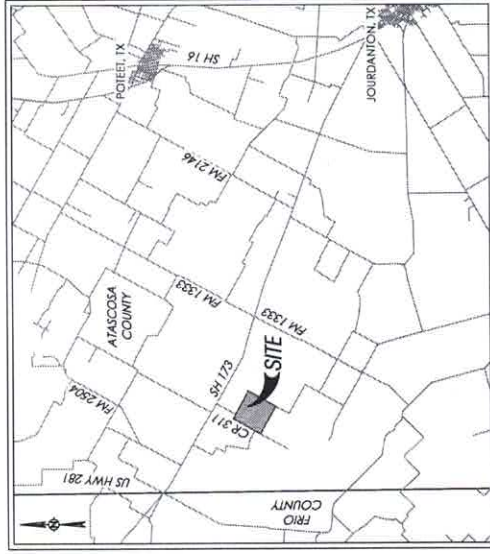

OWNER
WESLA RANCHES, LLC
150 CANDELARIA
HELOTES, TX 78023

NOVEMBER 2024

RL BACA
ENGINEERING
15055 W. LOOP SOUTH, SUITE 100
HELOTES, TEXAS 78023
PH: 281.295.1111 | WWW.RLBACA.COM

RL BACA PROJECT NO. 24-187
DRIVEWAY PERMIT PROJECT RECONSTRUCTION
PROPERTY OF: WESLA RANCHES, LLC
SCALE: AS SHOWN
DATE: 11/15/24
DRAWN BY: RL BACA
CHECKED BY: RL BACA
DATE: 11/15/24



DATE	DESCRIPTION

DATE	BY
CHECKED	DATE

C1.0

GENERAL NOTES

- ALL WORK SHALL BE PERFORMED IN ACCORDANCE WITH ATASCOSA COUNTY COMMERCIAL DRIVEWAY STANDARDS.
- CONSTRUCTION SHALL BE DEDICATED TO THE PUBLIC SHALL BE PERFORMED PER THE REQUIREMENTS OF THE STANDARDS.
- CONTRACTOR SHALL MAINTAIN A COPY OF ALL NECESSARY PERMITS ON THE JOBITE.
- MAJOR ACCESSORY CONTRACTOR SHALL PROVIDE FOR BARRICADES AND TRAFFIC CONTROL DEVICES AS PER THE TEXAS MANUAL ON UNIFORM TRAFFIC CONTROL DEVICES (TMUD).
- AS APPLICABLE, TREES ON SITE ARE TO REMAIN IN UNIMPAIRED CONDITION UNLESS REMOVAL OR TRIMMING IS IDENTIFIED ON THE PLAN OR OTHERWISE REQUIRED BY PERMITS. REMOVAL OR TRIMMING SHALL BE PERFORMED IN ACCORDANCE WITH THE TEXAS MANUAL ON UNIFORM TRAFFIC CONTROL DEVICES (TMUD). REMOVAL OR TRIMMING SHALL BE COMPLETED PRIOR TO THE START OF CONSTRUCTION. REPLACEMENT SHALL BE PROVIDED FOR ALL REMOVED TREES. REPLACEMENT SHALL BE PROVIDED FOR ALL REMOVED TREES. REPLACEMENT SHALL BE PROVIDED FOR ALL REMOVED TREES.
- UNLESS OTHERWISE SPECIFIED, THE FOLLOWING STATEMENT SHALL APPLY TO THE ENTIRE PROJECT: THE CONTRACTOR SHALL BE RESPONSIBLE FOR OBTAINING ALL NECESSARY PERMITS AND APPROVALS FROM ALL AFFECTED AGENCIES AND AGENCIES. THE CONTRACTOR SHALL BE RESPONSIBLE FOR OBTAINING ALL NECESSARY PERMITS AND APPROVALS FROM ALL AFFECTED AGENCIES AND AGENCIES. THE CONTRACTOR SHALL BE RESPONSIBLE FOR OBTAINING ALL NECESSARY PERMITS AND APPROVALS FROM ALL AFFECTED AGENCIES AND AGENCIES.
- ALL EXCAVATION TO BE UNCLASSED AND SHALL INCLUDE ROCK AND ALL OTHER MATERIALS ENCOUNTERED REGARDLESS OF THEIR DEPTH OR QUANTITY. ALL EXCAVATION SHALL BE PROTECTED FROM OVERHEAD POWER LINES AND OTHER HAZARDOUS CONDITIONS.
- CONTRACTOR SHALL PROVIDE DROPPED CURBS AS NECESSARY TO PREVENT DAMAGE TO ADJACENT PROPERTIES AND TO CONFORM WITH LOCAL JURISDICTIONAL AUTHORITY REQUIREMENTS.
- MAJOR TRAFFIC CONTROL DEVICES SHALL BE PROVIDED AT ALL MAJOR INTERSECTIONS AND AT ALL MAJOR TRAFFIC CONTROL DEVICES SHALL BE PROVIDED AT ALL MAJOR INTERSECTIONS AND AT ALL MAJOR TRAFFIC CONTROL DEVICES.
- CONTRACTOR AND/OR CONTRACTOR'S INDEPENDENTLY RETAINED ENGINEER OR STRUCTURAL ENGINEER SHALL REVIEW AND APPROVE ALL CONSTRUCTION DETAILS AND SHALL BE RESPONSIBLE FOR THE DESIGN OF ALL STRUCTURAL ELEMENTS. THE CONTRACTOR SHALL BE RESPONSIBLE FOR THE DESIGN OF ALL STRUCTURAL ELEMENTS. THE CONTRACTOR SHALL BE RESPONSIBLE FOR THE DESIGN OF ALL STRUCTURAL ELEMENTS.
- UNLESS OTHERWISE SPECIFIED, THE CONTRACTOR SHALL BE RESPONSIBLE FOR OBTAINING ALL NECESSARY PERMITS AND APPROVALS FROM ALL AFFECTED AGENCIES AND AGENCIES. THE CONTRACTOR SHALL BE RESPONSIBLE FOR OBTAINING ALL NECESSARY PERMITS AND APPROVALS FROM ALL AFFECTED AGENCIES AND AGENCIES. THE CONTRACTOR SHALL BE RESPONSIBLE FOR OBTAINING ALL NECESSARY PERMITS AND APPROVALS FROM ALL AFFECTED AGENCIES AND AGENCIES.
- CONTRACTOR IS RESPONSIBLE FOR REMOVAL OF ALL WASTE MATERIALS UPON COMPLETION.

PAVEMENT NOTES

- ALL WORK WITHIN STATE COUNTY AND/OR CITY RIGHT-OF-WAYS SHALL BE PERFORMED IN ACCORDANCE WITH EACH ENTITIES GOVERNING RULES AND STANDARDS. CONTRACTOR SHALL MAINTAIN A COPY OF ALL NECESSARY PERMITS ON THE JOBITE.
- ALL PAVEMENT MATERIALS SHALL BE TESTED AND APPROVED PRIOR TO BEING USED. ALL PAVEMENT MATERIALS SHALL BE TESTED AND APPROVED PRIOR TO BEING USED. ALL PAVEMENT MATERIALS SHALL BE TESTED AND APPROVED PRIOR TO BEING USED.
- PAVEMENT SURFACES SHALL BE STRIPPED OF VEGETATION, LOOSE TOPSOIL, AND PAVEMENT MATERIALS IN THE PROJECT AREA. ALL EXISTING PAVEMENT SHALL BE STRIPPED AND EXCAVATED TO THE UNDERLYING SUBGRADE. ALL EXISTING PAVEMENT SHALL BE STRIPPED AND EXCAVATED TO THE UNDERLYING SUBGRADE. ALL EXISTING PAVEMENT SHALL BE STRIPPED AND EXCAVATED TO THE UNDERLYING SUBGRADE.
- UNLESS OTHERWISE SPECIFIED, THE CONTRACTOR SHALL BE RESPONSIBLE FOR OBTAINING ALL NECESSARY PERMITS AND APPROVALS FROM ALL AFFECTED AGENCIES AND AGENCIES. THE CONTRACTOR SHALL BE RESPONSIBLE FOR OBTAINING ALL NECESSARY PERMITS AND APPROVALS FROM ALL AFFECTED AGENCIES AND AGENCIES. THE CONTRACTOR SHALL BE RESPONSIBLE FOR OBTAINING ALL NECESSARY PERMITS AND APPROVALS FROM ALL AFFECTED AGENCIES AND AGENCIES.
- PAVEMENT SURFACES SHALL BE STRIPPED OF VEGETATION, LOOSE TOPSOIL, AND PAVEMENT MATERIALS IN THE PROJECT AREA. ALL EXISTING PAVEMENT SHALL BE STRIPPED AND EXCAVATED TO THE UNDERLYING SUBGRADE. ALL EXISTING PAVEMENT SHALL BE STRIPPED AND EXCAVATED TO THE UNDERLYING SUBGRADE. ALL EXISTING PAVEMENT SHALL BE STRIPPED AND EXCAVATED TO THE UNDERLYING SUBGRADE.
- UNLESS OTHERWISE SPECIFIED, THE CONTRACTOR SHALL BE RESPONSIBLE FOR OBTAINING ALL NECESSARY PERMITS AND APPROVALS FROM ALL AFFECTED AGENCIES AND AGENCIES. THE CONTRACTOR SHALL BE RESPONSIBLE FOR OBTAINING ALL NECESSARY PERMITS AND APPROVALS FROM ALL AFFECTED AGENCIES AND AGENCIES. THE CONTRACTOR SHALL BE RESPONSIBLE FOR OBTAINING ALL NECESSARY PERMITS AND APPROVALS FROM ALL AFFECTED AGENCIES AND AGENCIES.
- CONTRACTOR SHALL PROVIDE DROPPED CURBS AS NECESSARY TO PREVENT DAMAGE TO ADJACENT PROPERTIES AND TO CONFORM WITH LOCAL JURISDICTIONAL AUTHORITY REQUIREMENTS.
- MAJOR TRAFFIC CONTROL DEVICES SHALL BE PROVIDED AT ALL MAJOR INTERSECTIONS AND AT ALL MAJOR TRAFFIC CONTROL DEVICES SHALL BE PROVIDED AT ALL MAJOR INTERSECTIONS AND AT ALL MAJOR TRAFFIC CONTROL DEVICES.
- CONTRACTOR AND/OR CONTRACTOR'S INDEPENDENTLY RETAINED ENGINEER OR STRUCTURAL ENGINEER SHALL REVIEW AND APPROVE ALL CONSTRUCTION DETAILS AND SHALL BE RESPONSIBLE FOR THE DESIGN OF ALL STRUCTURAL ELEMENTS. THE CONTRACTOR SHALL BE RESPONSIBLE FOR THE DESIGN OF ALL STRUCTURAL ELEMENTS. THE CONTRACTOR SHALL BE RESPONSIBLE FOR THE DESIGN OF ALL STRUCTURAL ELEMENTS.
- UNLESS OTHERWISE SPECIFIED, THE CONTRACTOR SHALL BE RESPONSIBLE FOR OBTAINING ALL NECESSARY PERMITS AND APPROVALS FROM ALL AFFECTED AGENCIES AND AGENCIES. THE CONTRACTOR SHALL BE RESPONSIBLE FOR OBTAINING ALL NECESSARY PERMITS AND APPROVALS FROM ALL AFFECTED AGENCIES AND AGENCIES. THE CONTRACTOR SHALL BE RESPONSIBLE FOR OBTAINING ALL NECESSARY PERMITS AND APPROVALS FROM ALL AFFECTED AGENCIES AND AGENCIES.
- CONTRACTOR IS RESPONSIBLE FOR REMOVAL OF ALL WASTE MATERIALS UPON COMPLETION.

- CONTRACTOR SHALL PROVIDE DROPPED CURBS AS NECESSARY TO PREVENT DAMAGE TO ADJACENT PROPERTIES AND TO CONFORM WITH LOCAL JURISDICTIONAL AUTHORITY REQUIREMENTS.
- MAJOR TRAFFIC CONTROL DEVICES SHALL BE PROVIDED AT ALL MAJOR INTERSECTIONS AND AT ALL MAJOR TRAFFIC CONTROL DEVICES SHALL BE PROVIDED AT ALL MAJOR INTERSECTIONS AND AT ALL MAJOR TRAFFIC CONTROL DEVICES.
- CONTRACTOR AND/OR CONTRACTOR'S INDEPENDENTLY RETAINED ENGINEER OR STRUCTURAL ENGINEER SHALL REVIEW AND APPROVE ALL CONSTRUCTION DETAILS AND SHALL BE RESPONSIBLE FOR THE DESIGN OF ALL STRUCTURAL ELEMENTS. THE CONTRACTOR SHALL BE RESPONSIBLE FOR THE DESIGN OF ALL STRUCTURAL ELEMENTS. THE CONTRACTOR SHALL BE RESPONSIBLE FOR THE DESIGN OF ALL STRUCTURAL ELEMENTS.
- UNLESS OTHERWISE SPECIFIED, THE CONTRACTOR SHALL BE RESPONSIBLE FOR OBTAINING ALL NECESSARY PERMITS AND APPROVALS FROM ALL AFFECTED AGENCIES AND AGENCIES. THE CONTRACTOR SHALL BE RESPONSIBLE FOR OBTAINING ALL NECESSARY PERMITS AND APPROVALS FROM ALL AFFECTED AGENCIES AND AGENCIES. THE CONTRACTOR SHALL BE RESPONSIBLE FOR OBTAINING ALL NECESSARY PERMITS AND APPROVALS FROM ALL AFFECTED AGENCIES AND AGENCIES.
- CONTRACTOR IS RESPONSIBLE FOR REMOVAL OF ALL WASTE MATERIALS UPON COMPLETION.

