

INSTRUCTIONS FOR APPLICATION FOR PIPELINE CROSSING PERMIT

BASIC INFORMATION: Find attached an application for pipeline permit to cross county roads in Atascosa County. Contact the county judge's office to determine in which commissioner precinct your crossing will be located.

Contact the County Commissioner so the proposed crossing can be discussed and to determine/confirm amount of crossing fee(s). After the commissioner has been contacted, the crossing surveyed and the fee amount confirmed, the application needs to be signed, in the presence of a notary, and then submitted to Atascosa County Commissioners Court for approval.

The fully executed application and check for fees must be received in the office of the County Judge BEFORE it will be placed on the agenda. The deadline for receipt of agenda items is NOON on the Thursday before Commissioner's Court Meeting. Contact this office for the next scheduled meeting and date of posting.

REPRESENTATION AT COMMISSIONERS COURT MEETING: A representative should accompany the application to the meeting in the event the court has questions unless previous arrangements have been made with the individual County Commissioner.

FEE: A fee is required for each crossing. Additional fees may be required. See application for further information on fees. Fees can be paid and application/permit will be filed with the Atascosa County Clerk. **MAKE CHECKS PAYABLE TO: ATASCOSA COUNTY.**

PLAT: The crossing location must be surveyed and a plat provided for each crossing. Provide the plat along with the fully executed application.

NOTE: BE ADVISED THERE IS A PENALTY FOR INSTALLING A PIPELINE ACROSS A COUNTY ROAD WITHOUT OBTAINING A PERMIT.

THERE IS ALSO A 90 DAY TERM OF CONTRACT ON THE APPLICATION WHICH INCLUDES REAPPLICATION AND REPAYMENT OF FEES IF THE APPLICATION EXPIRES BEFORE THE PIPELINE IS INSTALLED.

UPON COMMISSIONERS COURT APPROVAL THE COUNTY CLERK'S OFFICE WILL PROVIDE YOU WITH A FULLY EXECUTED COPY OF THE PERMIT AND RECEIPT FOR PAYMENT. PLEASE PROVIDE RETURN CONTACT INFORMATION ON PAGE 3 OF 3 OF THE PERMIT. THE INFORMATION YOU PROVIDE THERE WILL BE USED TO RETURN THE FULLY EXECUTED COPIES AND RECEIPT FOR YOUR RECORDS.

FEE SCHEDULE:

APPLICATION FEE: \$500.00

COST PER YARD OR ANY PART THEREOF OF A CROSSING EXCEEDING 50 FEET: \$32.00

AMENDMENT OF PERMIT: \$250.00

EACH 6 MONTH EXTENSION OF PERMIT: \$ 200.00

PENALTY FEE FOR INSTALLATION OF PIPELINE WITHOUT A PERMIT: \$5000.00

ATASCOSA COUNTY PIPELINE PERMIT

X ORIGINAL APPLICATION AMENDMENT 6 MONTH EXTENSION

ON THIS THE 17th day of March, 2025, A.D., the undersigned "Company", does hereby make application to use the hereinafter described lands belonging to Atascosa County, Texas, for the purposes of constructing, maintaining, operating or repairing mains or lines for the transportation of natural gas or other hydrocarbons across said lands as shown on plat attached hereto and made a part hereof.

In consideration of the \$500.00 application fee, plus a \$5,000 penalty fee if said pipeline has been installed prior to this application being presented to and approved by Atascosa County Commissioners Court and the further consideration of: (1) \$32.00 per yard or any part thereof for any part of a crossing exceeding fifty (50) feet; (2) \$250 for any amendment of this permit; and (3) \$200.00 for each 6 month extension of this permit to be paid by Company and the County's granting permission to make use of the lands above described for the purposes aforesaid, the undersigned Company agrees that such use shall be subject to the following terms, covenants and conditions, to-wit:

I.

No main or line shall ever be laid or maintained by the Applicant in such manner as to interfere with the construction, maintenance or repair of roads, (STATE or COUNTY) and in the event it shall develop that any main or line hereafter to be laid by the Applicant in any manner interferes with the construction, maintenance or repair of any existing road (STATE or COUNTY) because of the depth at which the same has been laid, or for any other reason, the Applicant, upon request of the Commissioners Court, shall promptly change or alter, at Applicant's sole expense, such main or line, in such manner that the same will no longer interfere with such construction, maintenance or repair.

II.

It is understood that no main or line shall ever be laid by Applicant in such a way or manner as to interfere with traffic, so as to interfere with any drainage now or hereafter to be affected on or along such road and that no main or line shall ever be laid or maintained by the Applicant in such a way as to constitute a danger or hazard or to become a nuisance of any kind to anyone using any road or living in the vicinity thereof.

It is understood that no main or line shall ever be laid by Applicant in such a way or manner to run parallel to the county road within the county right-of-way.

III.

The Applicant further agrees that it shall in no way enter upon any property hereby affected for the purpose of constructing, laying or repairing any main or line now existing or hereafter to exist unless it shall have first submitted to the Commissioners Court of Atascosa County, plans, sections and such description of construction, laying, maintenance or repair, as to fully describe the same.

IV.

It is further understood and agreed that all lines crossing any County Road shall be either jacked, bored or driven under surfaced portion of the roadway; and that the section of line placed through boring shall extend

the full width of the surfacing; and that all pipelines under such roads shall be placed through an iron or other approved casing of approximately two inches larger in diameter than the pipeline; or, as an alternative to casing, Applicant may install a heavier walled carrier pipe beneath the roadway; provided, however, that in either instance the installation shall meet all the requirements of the Department of Transportation as set forth in Title 49, Code of Federal Regulations, Part 192, and/or those same regulations as adopted by Texas Railroad Commission and any other regulations promulgated by the Texas Railroad Commission under the authority of V.T.C.S. Art. 6053-1; and provided further that the County Commissioner in whose precinct the crossing is being made, with the concurrence of the Commissioners Court, may require that the carrier pipe be cased beneath the roadway when in his opinion the best interests of Atascosa County would be served thereby. Said pipeline shall have at least forty-two (42) inches of cover unless special permission to the contrary is obtained from the Commissioners Court of Atascosa County. Said pipeline crossing shall be placed within 10 Degrees of Perpendicular (80° to 100°) to the roadway.

V.

The Applicant further agrees, in connection herewith, to save and hold harmless the said County against any and all liability that it may have or appear to have to any person whomsoever by reason of any act or thing that Applicant, its agents, servants, employees and contractors may do or cause to be done in the premises.

VI.

In consideration of the granting of the privilege hereby petitioned for, Applicant agrees that whenever it shall in any manner damage any County Road or other structure by reason of any operation hereunder, it will immediately, at its own expense, restore the same to the condition that the same was in before the damage took place. Applicant further especially agrees that whenever the County Commissioners Court shall notify it in writing that it, its agents, servants, employees and contractors have damaged any road, or other structure, Applicant will commence the restoration thereof, in accordance with the terms hereof, within forty-eight (48) hours after the receipt of such notice, and prosecute such restoration to completion, diligently and continuously, and that in the event of its failure in such event to begin such restoration or repair within the time aforesaid, or in the event of its failure to therefore prosecute the same to completion, diligently and continuously, the Commissioners Court or its representative of said County, may take over the making of such restoration or repair with County employees, or through a private contractor, and complete and effect such repair or restoration at the expense of the Applicant and that the action of the County Commissioners Court, or its representative, in making such restoration or repair shall be binding upon the Applicant, and such Commissioners Court estimate or statement of the cost and expense incurred in making such repair or restoration shall be final, conclusive and binding upon the Applicant.

VII.

It is further agreed that in the event Applicant enters upon any property hereby affected for the purpose of construction, laying or repairing any main or line of Applicant, now existing or hereafter to exist, in connection with any State road or highway, that Applicant shall comply with all conditions and requirements of the Texas State Highway Department or its authorized representative with reference to any matter pertaining to any such purposes.

VIII.

[REDACTED]

IX.

It is further agreed that the order of the Commissioners Court granting this application shall be and does constitute acceptance on the part of the County of the offer hereby made, and said order and this application shall constitute a contract between the parties hereto their heirs, assigns, representatives and successors according to the terms hereof.

X.

This application for pipeline permit shall expire 90 days after the same is approved by motion and order entered into Commissioners Court Records of Atascosa County, Texas. After expiration of the same, a new

application for pipeline permit and payment of fees shall be required from the applicant if the pipeline has not been installed prior to the expiration date of this permit.

IN WITNESS WHEREOF, the Applicant has caused this instrument to be executed on this the ____ day of _____, 20 ____ A.D.

After approval the fully executed permit should be returned to:

Phillip Gunn
1922 Dry Creek Way, Suite 116
San Antonio, TX 78259
pgunn@entrustsol.com

Submitted by Phillip Gunn of ENTRUST Solutions Group, 1922 Dry Creek Way, Ste 116, San Antonio, TX 78259 on behalf of Spectrum a Franchise Utility Company. Work will be performed by a Contractor along with Spectrum's Construction Coordinator
pgunn@entrustsol.com | 303-788-9168

ENTRUST Solutions Group

Company _____
By: Phillip Gunn for Spectrum _____

CORPORATE ACKNOWLEDGMENT

THE STATE OF TEXAS
COUNTY OF _____

BEFORE ME, the undersigned authority, in and for said County, Texas, on this day personally appeared _____ known to me to be the person and officer whose name is subscribed to the foregoing instrument and acknowledged to me that the same was the act of the said _____ a corporation, and that he executed the same as the act of such corporation for the purposes and consideration therein expressed, and in the capacity therein stated.

GIVEN UNDER MY HAND AND SEAL OF OFFICE, this the ____ day of _____, 20 ____ A.D.

Notary Public in and for _____
County, Texas
Commission expires: _____

*****FOR COUNTY USE ONLY*****
County Road: _____ Comm. Pct. No.: _____ Dia. Line _____

Examined and approved in open Commissioners Court on this the ____ day of _____; 20 ____

By: _____ Weldon P. Cude, Atascosa County Judge

This permit Expires on the ____ day of _____; 20 ____



**MEMORANDUM OF PAYMENT FOR DAMAGES TO
ATASCOSA COUNTY**

KNOW ALL MEN BY THESE PRESENTS:

Comes now Spectrum Gulf Coast, LLC, hereafter known as Payor and Atascosa County, Texas, hereafter known as Atascosa County.

Whereas Payor is extensively utilizing the roads of Atascosa County, Texas, for the economic benefit of Payor; and

Whereas Atascosa County is a political subdivision of the State of Texas which maintains certain roads within Atascosa County; and

Whereas Atascosa County has limited resources for the maintenance of such roads; and

Whereas Atascosa County is authorized to act and does act by and through the Commissioners Court of Atascosa County, pursuant to V.T.C.A. Local Government Code Section 81.032 and V.T.C.A., Transportation Code Section 252.214 to accept donations of property or funds.

THEREFORE:

Payor does hereby pay and transfer to Atascosa County the materials and/or funds described below:

It is the expectation of the Payor that the materials and/or funds donated to Atascosa County will be used for the repair, maintenance and upgrade of roads or facilities described below; however, Atascosa County makes no specific warranty for the use of the funds or materials paid:

Materials and/or funds paid are not subject to return to the Payor by Atascosa County.

For a payment to be accepted, such payment, subsequent to being offered, must be accepted and approved by the Commissioners Court of Atascosa County in an open session of the Commissioners Court of Atascosa County.

Said funds shall be paid to the County for disbursement pursuant to any conditions delineated or approved by the Commissioners Court.

Payor, by executing this Memorandum of Payment For Damages to Atascosa County agrees and understands that this document contains all terms of the donation and this is not a contract or a settlement.

Spectrum Gulf Coast, LLC
Printed Name of Payor (If Company or Business Entity)

Paul R. Arredondo III
Printed Name of Payor's Authorized Agent

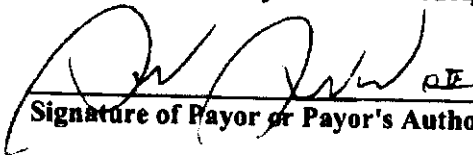
Signature of Payor or Payor's Authorized Agent

4/11/2025
Date

Approved and Accepted by:
Commissioners Court

Date

Weldon P. Cude, County Judge

Mark Gillespie, Commissioner Pct 1

Mark Bowen, Commissioner Pct 2

George Pawelek, Commissioner Pct 3

Kennard Riley, Commissioner Pct 4

ATTEST

Theresa Carrasco, County Clerk

**ROAD USE AGREEMENT BETWEEN
ATASCOSA COUNTY AND Spectrum Gulf Coast, LLC**

On this the ___ day of _____, _____, Atascosa County, herein known as "County" address #1 Courthouse Circle Drive, Jourdanton, Texas 78026 and Spectrum Gulf Coast, LLC

herein known as Spectrum Gulf Coast, LLC, address _____

for mutual consideration agrees as follows:

1. County roads have a weight limit of 58,420 pounds and repeated use of said roads exceeding the weight limit will damage said roads.
2. The State of Texas, through the Highway Commission, can issue overweight permits to allow overweight traffic on county roads.
3. Despite having an overweight permit, _____, acknowledges, pursuant to Transportation Code §251.160, that it has a responsibility to repair damage caused to county roads by overweight loads. Specifically, _____, agrees to repair damage to the following roads _____ in Commissioner Precinct No. _____.
4. The County and Spectrum Gulf Coast, LLC _____ agree to meet before such overweight traffic begins on county roads to document the condition of the county roads.
5. After _____ the _____ overweight _____ traffic _____ stops, _____, agrees to repair the county roads to the condition the roads were in before such overweight traffic began.
6. _____, further agrees to make the necessary arrangements for such repairs to county roads within 60 days from the drilling operations being completed.

Authorized Representative for:
Spectrum Gulf Coast, LLC
by Charter Communications, Inc

Paul R. Arredondo 4/1/2005
Signature Date

Paul R. Arredondo
Printed Name

Authorized Representative for Atascosa
County: Weldon P Cude, County Judge

Signature Date

Atascosa County Commissioner, Precinct No. _____

Signature of Commissioner Date

ATTEST:

Theresa Carrasco, County
By: _____ Deputy
Clerk

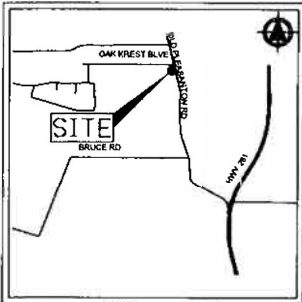

LOCATION MAP
NTS

NO FACILITIES OF OLD PLEASANTON ROAD WERE MARKED
IN FIELD. LOCATES WERE NOT MARKED.



NOTE:
THE INFORMATION AND GRAPHICS DEPICTED ON THIS SHEET HAVE BEEN PLOTTED FROM AVAILABLE RECORDS AND FIELD OBSERVATIONS BUT ARE NOT NECESSARILY EXACT. IT IS THE EXCAVATOR'S RESPONSIBILITY TO VERIFY AND FIELD LOCATE ALL UNDERGROUND OBSTRUCTIONS AND UTILITIES PRIOR TO EXCAVATION. COMPLETE REPAIR OF ANY AND ALL DAMAGES INCURRED SHALL BE AT THE EXPENSE OF THE EXCAVATOR.

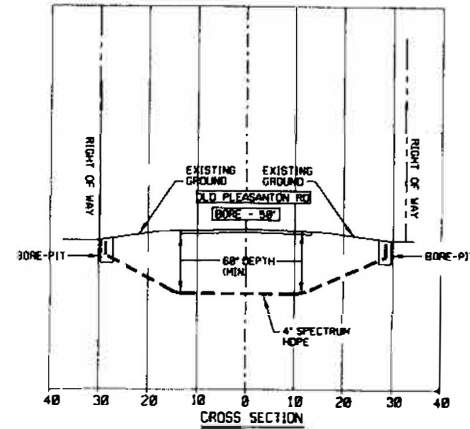
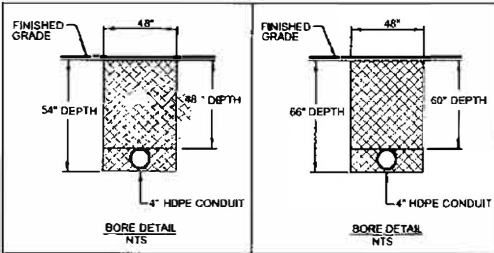

DIRECTIONAL BORE 180 LF & INSTALL:
(1) 4" HDPE CONDUIT-48" MIN DEPTH
(1) FIBER OPTIC CABLE

STAGING AREA
BORE PIT
LAT: 29.127525
LON: -98.495760

DIRECTIONAL BORE 50 LF & INSTALL:
(1) 4" HDPE CONDUIT-60" MIN DEPTH
(1) FIBER OPTIC CABLE

DIRECTIONAL BORE 392 LF & INSTALL:
(1) 4" HDPE CONDUIT-48" MIN DEPTH
(1) FIBER OPTIC CABLE

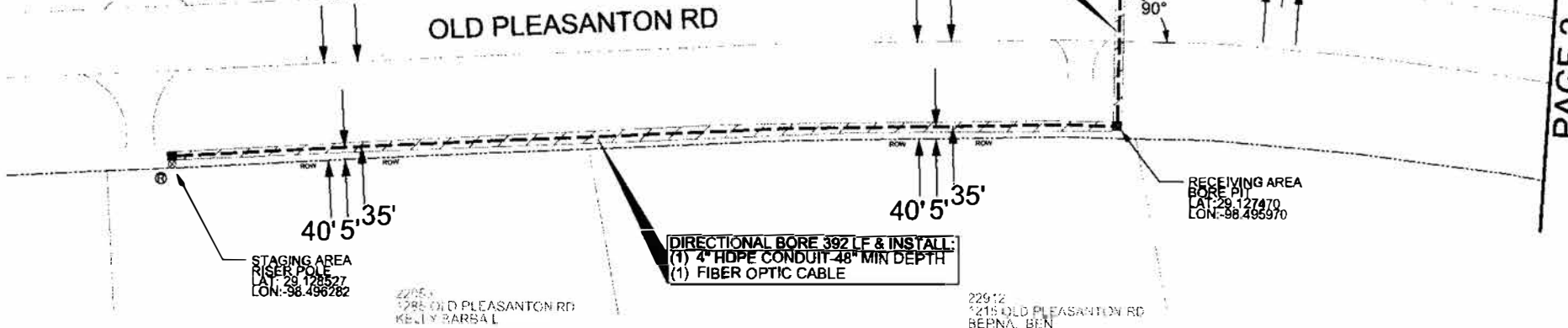

PAGE 2



PROJECT		GRANT BEX 1521.00 TX 6331E	
LOCATION		1101 MOGFORD RD	
DRAWN	DATE	SCALE	APPROVED BY
MD G	03-14-2025	NTS	JONATHAN SKINNER
PROJECT NO	CITY	PAGE	COUNTY
4902424	SAN ANTONIO	1	UG

● VERIZON	-W- WATER UTILITY	-SS- SANITARY SEWER UTIL.
○ PROPOSED CATV POLE	-G- NATURAL GAS UTILITY	-SC- EX. SPECTRUM CONDUIT
⊙ STEEL POLE	-GR- GRADE UTILITY	-UG- UNDERGROUND
⊞ TRANSFORMER POLE	-T- TELEPHONE UTILITY	-R.O.W- RIGHT OF WAY LINE
⊚ POWER POLE	-E- ELECTRIC UTILITY	-C.S.- EXISTING CURB
		-E.P.- EDGE OF PAVEMENT

▨ LIMITS OF CONSTRUCTIONS
⊕ RISER
— NEW BUILD
--- OVERLASH
--- NEW UG TRENCH
--- NEW UG BORE

REVISIONS	
DATE	COMMENTS

PREPARED BY:
ENTRUST SOLUTIONS GROUP

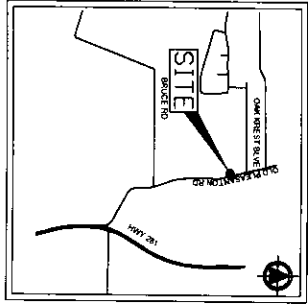

LOCATION MAP
NTS

NO FACILITIES OF OLD PLEASANTON ROAD WERE MARKED
IN FIELD, LOCATES WERE NOT MARKED.

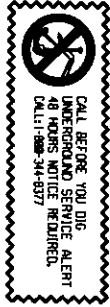

NOTE:

THE INFORMATION AND GRAPHICS DEPICTED ON THIS SHEET HAVE BEEN PLOTTED FROM AVAILABLE RECORDS AND FIELD OBSERVATIONS BUT ARE NOT NECESSARILY EXACT. IT IS THE EXCAVATOR'S RESPONSIBILITY TO VERIFY AND FIELD LOCATE ALL UNDERGROUND OBSTRUCTIONS AND UTILITIES PRIOR TO EXCAVATION. COMPLETE REPAIR OF ANY AND ALL DAMAGES INCURRED SHALL BE AT THE EXPENSE OF THE EXCAVATOR.

14415
1216 OLD PLEASANTON RD
ESPEY EDWIN

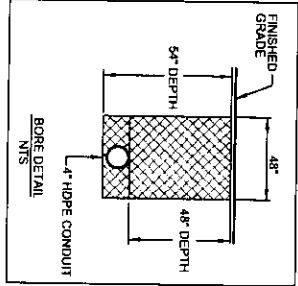

DIRECTIONAL BORE 20 LF & INSTALL
(1) 4" HDPE CONDUIT-48" MIN DEPTH
(1) FIBER OPTIC CABLE

RECEIVING AREA
BORE PIT
LAT: 38.155975
LON: -122.155975

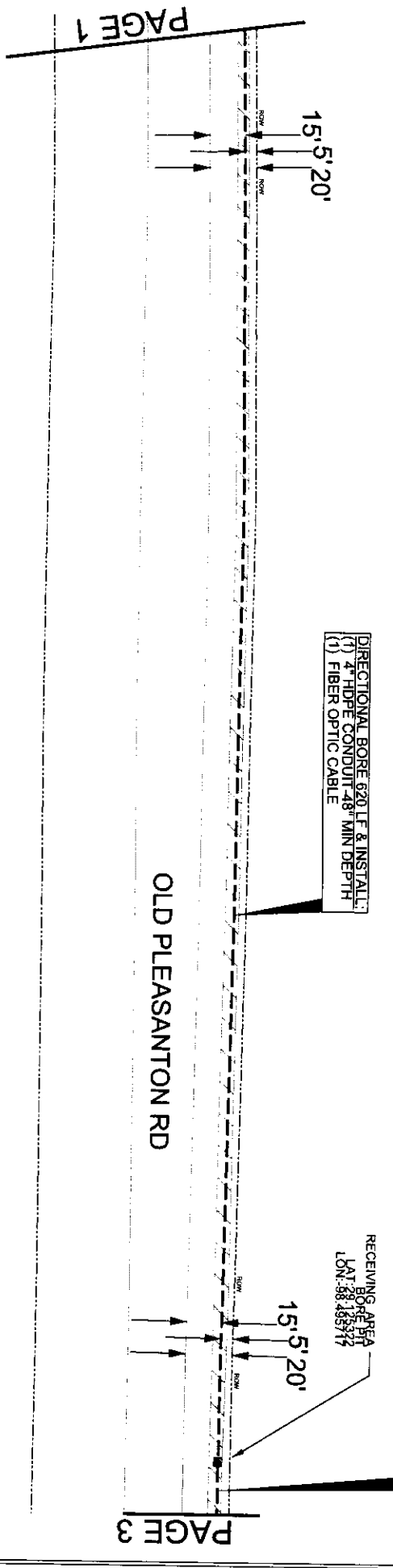

PAGE 1

PAGE 3

Spectrum

PROJECT		GRANT BEX 1521.00 TX 6331E	
LOCATION	1101 MCGFORD RD	SCALE	AS SHOWN
DATE	03-14-2025	NTS	
CITY	SAN ANTONIO	DESIGNED BY	CONTOUR UG
		DATE	2
		DESIGNED BY	JOHNTMAN SKINNER

- VERIZON
- PROPOSED CAVY POLE
- ⊗ STEEL POLE
- ⊗ TRANSFORMER POLE
- ⊗ POWER POLE

- W- WATER UTILITY
- G- GAS UTILITY
- GR- GROUND UTILITY
- T- TELEPHONE UTILITY
- E- ELECTRIC UTILITY

- S- SANITARY SEWER UTIL.
- SC- EX. SPECTRUM CONDUIT
- UC- UNDERGROUND
- R- RIGHT OF WAY LINE
- E- EXISTING CURB
- E.C.P. EDGE OF PAVEMENT

- ⊗ LIMITS OF CONSTRUCTION
- ⊗ NEW BUILD
- ⊗ OVERLASH
- ⊗ NEW UC BORE

DATE	REVISIONS

PREPARED BY:

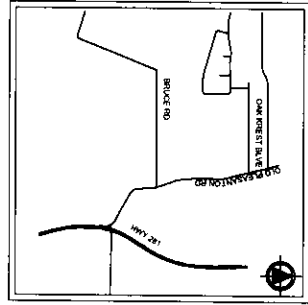

LOCATION MAP
NTS

NO FACILITIES OF OLD PLEASANTON ROAD WERE MARKED
IN FIELD, LOCATES WERE NOT MARKED.

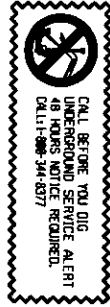

NOTE:
THE INFORMATION AND GRAPHICS DEPICTED ON THIS SHEET HAVE BEEN PLOTTED FROM AVAILABLE RECORDS AND FIELD OBSERVATIONS BUT ARE NOT NECESSARILY EXACT. IT IS THE EXCAVATOR'S RESPONSIBILITY TO VERIFY AND FIELD LOCATE ALL UNDERGROUND OBSTRUCTIONS AND UTILITIES PRIOR TO EXCAVATION. COMPLETE REPAIR OF ANY AND ALL DAMAGES INCURRED SHALL BE AT THE EXPENSE OF THE EXCAVATOR.

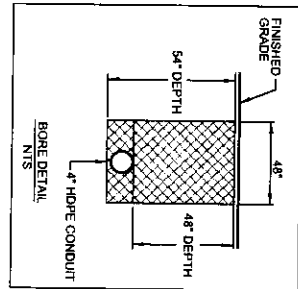

DIRECTIONAL BORE 620LF & INSTALL:
(1) 4" HDPE CONDUIT 48" MIN DEPTH
(1) FIBER OPTIC CABLE

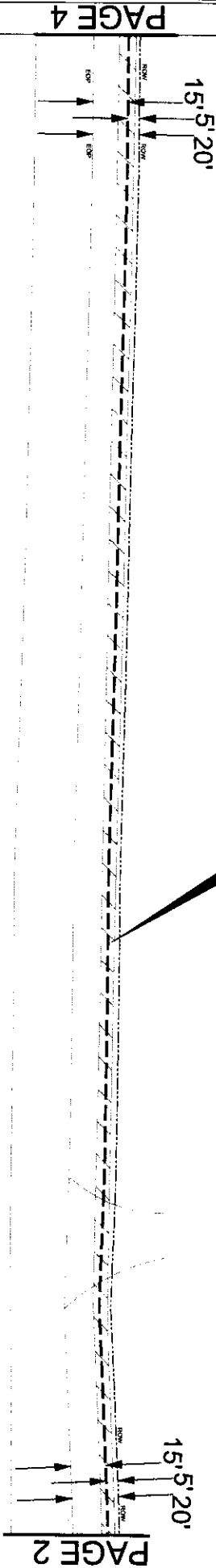

14875
1218 OLD PLEASANTON RD
ESPEY FOUN

Spectrum

PROJECT		GRANT BEX 152100 TX 6831E	
LOCATION	1101 MOGFORD RD	DATE	03-14-2025
DRAWN BY	NTS	CITY	SAN ANTONIO
SCALE	1"=50'	PARCEL	3
DESIGNED BY	JONATHAN SKINNER		

- VERIZON
- PROPOSED CARRY POLE
- ⊙ STEEL POLE
- ⊞ TRANSFORMER POLE
- ⊚ POWER POLE

- W- WATER UTILITY
- G- NATURAL GAS UTILITY
- CR- CABLE TELEVISION UTILITY
- T- TELEPHONE UTILITY
- E- ELECTRIC UTILITY

- SS- SANITARY SEWER UTIL.
- SC- EX. SPECTRUM CONDUIT
- UG- UNDERGROUND
- R/W- RIGHT OF WAY LINE
- E.O.D- EXISTING CURB
- E.O.P- EDGE OF PARKING

- ⊞ LIMITS OF CONSTRUCTION
- ⊞ NEW BUILD
- ⊞ OVERLASH
- ⊞ NEW US TRENCH
- ⊞ NEW US BORE

DATE	REVISIONS	COMMENTS



PREPARED BY:

Spectrum

PROJECT GRANT, BEX, 1521.00 TX, 6331E
 LOCATION 1101 MOGORD RD
 DATE 03-14-2025
 CITY SAN ANTONIO
 STATE TX
 COUNTY BEX
 COUNTY UG
 JONATHAN SKINNER

- PROPOSED DAILY POLE
- ⊙ STEEL POLE
- ⊕ TRAFFIC SIGN POLE
- ⊗ POWER POLE

- W- WATER UTILITY
- G- NATURAL GAS UTILITY
- GR- GROUND UTILITY
- T- TELEPHONE UTILITY
- E- ELECTRIC UTILITY

- SS- SANITARY SEWER UTIL.
- FC- EX. STRUCTURE CONDUIT
- UC- UNDERGROUND
- R.D.V- RIGHT OF WAY LINE
- EXIST- EXISTING CURB
- EDGE- EDGE OF PAVEMENT

- ⊕ LIMITS OF CONSTRUCTION
- ⊗ NEW BUILD
- ⊕ OVERLAP
- ⊗ NEW TO TRENCH
- ⊕ NEW TO BORE

DATE	REVISIONS	COMMENTS

PREPARED BY: **ENTRUST SOLUTIONS GROUP**

PAGE 6

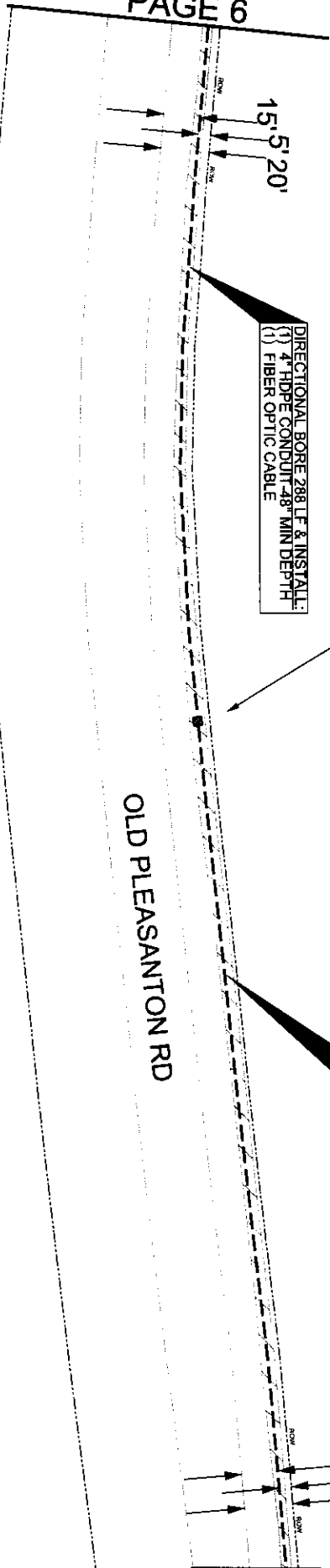

PAGE 4

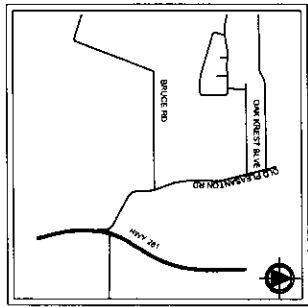

NO FACILITIES OF OLD PLEASANTON ROAD WERE MARKED IN FIELD. LOCATES WERE NOT MARKED.



NOTE:
 THE INFORMATION AND GRAPHICS DEPICTED ON THIS SHEET HAVE BEEN PLOTTED FROM AVAILABLE RECORDS AND FIELD OBSERVATIONS BUT ARE NOT NECESSARILY EXACT. IT IS THE EXCAVATOR'S RESPONSIBILITY TO VERIFY AND FIELD LOCATE ALL UNDERGROUND OBSTRUCTIONS AND UTILITIES PRIOR TO EXCAVATION. COMPLETE REPAIR OF ANY AND ALL DAMAGES INCURRED SHALL BE AT THE EXPENSE OF THE EXCAVATOR.

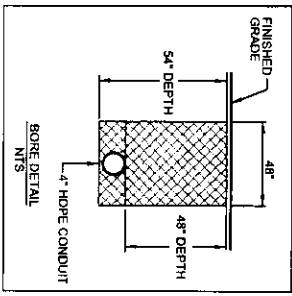

Spectrum

PROJECT
 GRANT BEX 152100 TX 6331E

LOCATION 1101 MOGFORD RD
DATE 03-14-2025
CITY SAN ANTONIO

SCALE NTS
APPRAISED BY JONOTHIAN SKINNER

NO. OF SHEETS 8
PAGE 8

- VERIZON
- PROPOSED CAVITY POLE
- ③ STEEL POLE
- ⊕ TRANSMISSION POLE
- ⊙ POWER POLE
- W- WATER UTILITY
- G- GAS UTILITY
- OR- ORANGE UTILITY
- T- TELEPHONE UTILITY
- E- ELECTRIC UTILITY
- SS- SANITARY SEWER UTIL.
- SC- EX. SPECTRUM CONDUIT
- UG- UNDERGROUND
- R.O.K. RIGHT OF WAY LINE
- E.O.D. EXISTING CURB
- E.O.P. EDGE OF PAVEMENT
- ⊕ LIMITS OF CONSTRUCTION
- ⊕ RISER
- ⊕ NEW BUILD OVERLAP
- ⊕ NEW UG TRENCH
- ⊕ NEW UG BORE

DATE	REVISIONS	PREPARED BY

ENRUST
 SOLUTION GROUP

PAGE 5

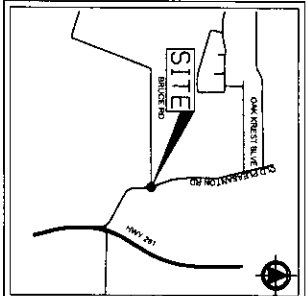

NO FACILITIES OF OLD PLEASANTON ROAD WERE MARKED IN FIELD. LOCATES WERE NOT MARKED.

CALL BEFORE YOU DIG
 UNDERGROUND SERVICE ALERT
 48 HOURS NOTICE REQUIRED.
 CALL 1-800-344-8377

NOTE:
 THE INFORMATION AND GRAPHICS DEPICTED ON THIS SHEET HAVE BEEN PLOTTED FROM AVAILABLE RECORDS AND FIELD OBSERVATIONS BUT ARE NOT NECESSARILY EXACT. IT IS THE EXCAVATOR'S RESPONSIBILITY TO VERIFY AND FIELD LOCATE ALL UNDERGROUND OBSTRUCTIONS AND UTILITIES PRIOR TO EXCAVATION. COMPLETE REPAIR OF ANY AND ALL DAMAGES INCURRED SHALL BE AT THE EXPENSE OF THE EXCAVATOR.

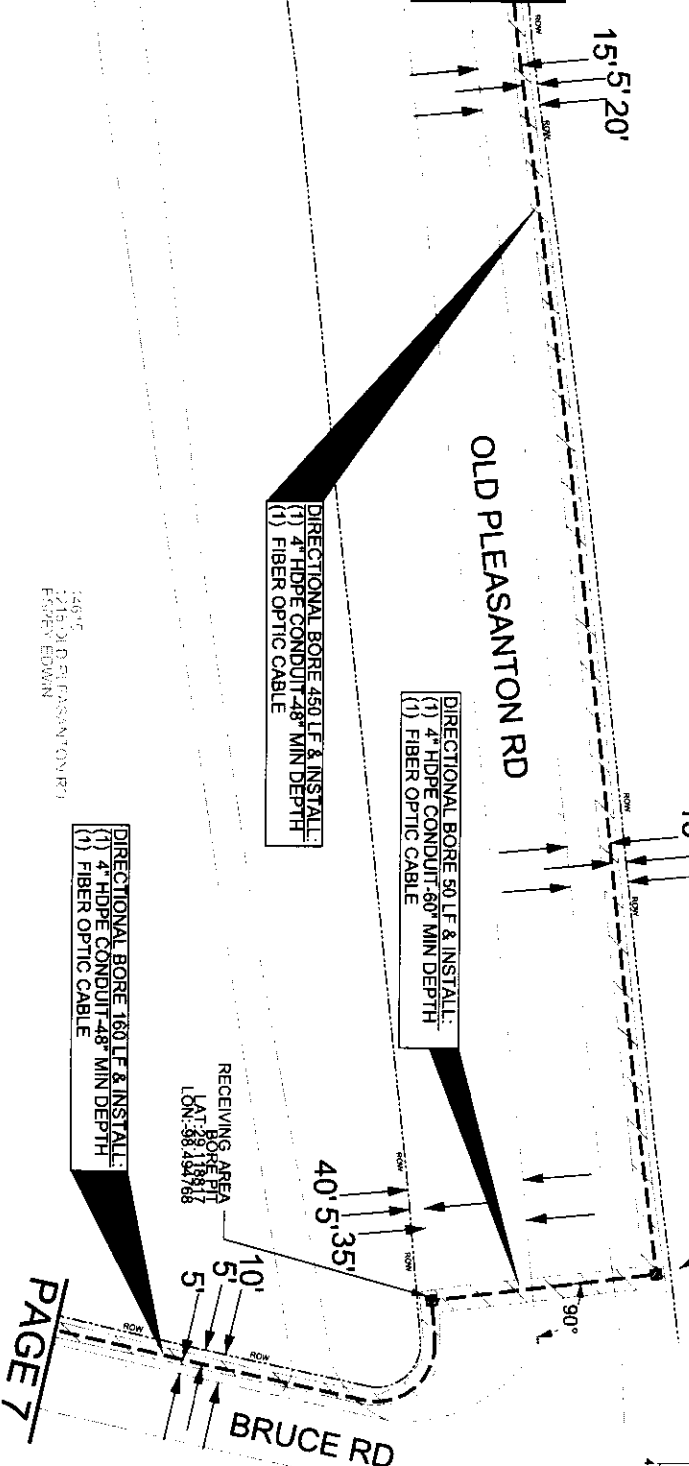

152100
 GRANT BEX 152100 TX 6331E
 JONOTHIAN SKINNER

STAGING AREA
 LAT: 29.189153
 LON: 98.494573

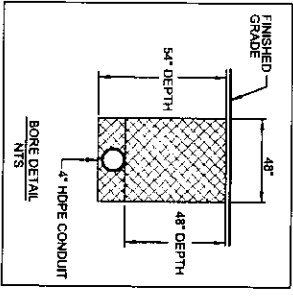
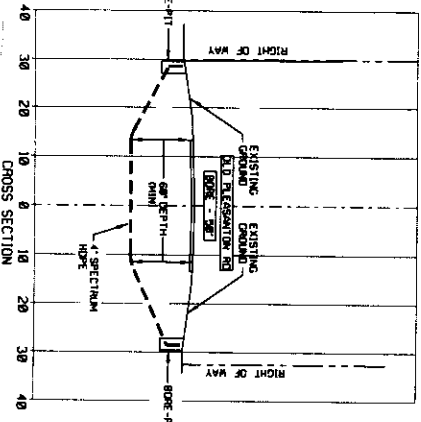

PAGE 7

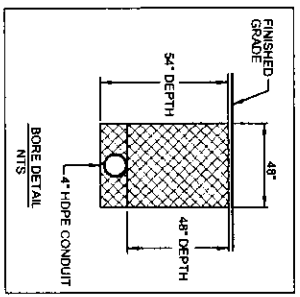
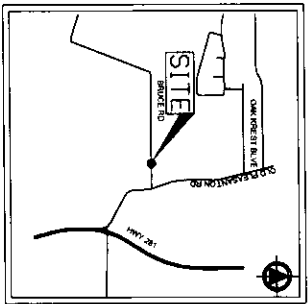

LOCATION MAP
NTS

DATE: 12/15/2023
BY: J. SWANSON

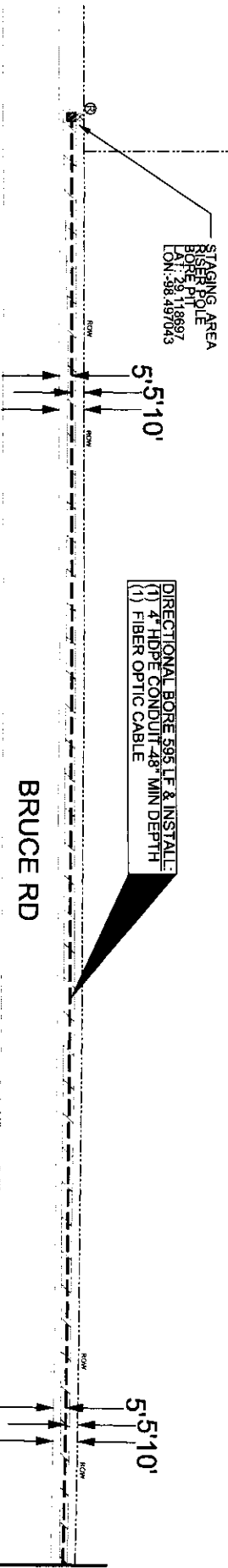

CALL BEFORE YOU DIG
UNDERGROUND SERVICE ALERT
48 HOURS NOTICE REQUIRED
CALL 1-888-344-6377

NO FACILITIES OF BRUCE ROAD WERE MARKED
IN FIELD, LOCATES WERE NOT MARKED.

NOTE:
THE INFORMATION AND GRAPHICS DEPICTED ON THIS SHEET HAVE BEEN PLOTTED FROM AVAILABLE RECORDS AND FIELD OBSERVATIONS BUT ARE NOT NECESSARILY EXACT. IT IS THE EXCAVATOR'S RESPONSIBILITY TO VERIFY AND FIELD LOCATE ALL UNDERGROUND OBSTRUCTIONS AND UTILITIES PRIOR TO EXCAVATION. COMPLETE REPAIR OF ANY AND ALL DAMAGES INCURRED SHALL BE AT THE EXPENSE OF THE EXCAVATOR.



PROJECT		GRANT BEX 152100 TX 6331E	
LOCATION	1101 MOGORD RD	SCALE	AS SHOWN
DRAWN BY	DATE 03-14-2025	COUNTY	UG
CITY	SAN ANTONIO	PROJECT NO.	7
PROJECT NO.	4902924	APPROVED BY	JOHNATHAN SKINNER

<ul style="list-style-type: none"> ● VERTICAN ○ PROPOSED DAILY POLE ③ STEEL POLE ⊕ TRANSFORMER POLE ⊕ POWER POLE 	<ul style="list-style-type: none"> -W- WATER UTILITY -G- NATURAL GAS UTILITY -CR- CABLE UTILITY -T- TELEPHONE UTILITY -E- ELECTRIC UTILITY 	<ul style="list-style-type: none"> -SS- SANITARY SEWER UTIL. -UC- UNDERGROUND CONDUIT -R.O.V- RIGHT OF WAY LINE -E.O.D- EXISTING DRIVE -E.O.P- EDGE OF PAVEMENT 	<ul style="list-style-type: none"> ① LIMIT OF CONSTRUCTION ② NEW ROAD ③ NEW UTILITY ④ NEW UTILITY
---	---	--	---

REVISIONS	DATE	COMMENTS	PREPARED BY

