



# AIA<sup>®</sup> Document G710<sup>™</sup> – 2017

## Architect's Supplemental Instructions

**PROJECT:** *(name and address)*  
Charlotte ISD Bond 2024

**CONTRACT INFORMATION:**  
Contract For: General Construction  
Date:

**ASI INFORMATION:**  
ASI Number: 001  
Date: July 1, 2025

**OWNER:** *(name and address)*  
Charlotte ISD  
102 E. Hindes Ave.  
Charlotte, Texas 78011

**ARCHITECT:** *(name and address)*  
Pfluger Architects  
200 E. Grayson, Ste. 115  
San Antonio, Texas 78215

**CONTRACTOR:** *(name and address)*  
Century Construction  
1617 W. Sixth Street, Ste. B  
Austin, Texas 78703

The Contractor shall carry out the Work in accordance with the following supplemental instructions without change in Contract Sum or Contract Time. Proceeding with the Work in accordance with these instructions indicates your acknowledgment that there will be no change in the Contract Sum or Contract Time.  
*(Insert a detailed description of the Architect's supplemental instructions and, if applicable, attach or reference specific exhibits.)*

Updates to the driveway, per Atascosa County requirements. Refer to attached Civil drawings for additional information.  
ASI # 1 (pages 1 thru 5), attached.

### ISSUED BY THE ARCHITECT:

Pfluger Architects  
\_\_\_\_\_  
**ARCHITECT** *(Firm name)*  
  
\_\_\_\_\_  
**SIGNATURE**  
Keith Fey, AIA  
\_\_\_\_\_  
**PRINTED NAME AND TITLE**  
07.01.25  
\_\_\_\_\_  
**DATE**



  
07/01/2025



ISO 9001:2015 CERTIFIED

ENGINEERS • PLANNERS • SCIENTISTS • CONSTRUCTION MANAGERS

7109 N. Bartlett, Suite 201 • Laredo, Texas 78041 • Phone (956) 729-7844

Jazheel Fuentes  
Pfluger Architects  
200 E Grayson Street, Suite 115  
San Antonio, Texas, 78215

**RE: ASI-1**  
Charlotte ISD Field House

Ms. Fuentes,

These revisions were completed to comply with the Commercial Access Driveway requirements in Atascosa County:

**C03.0B Jointing Plan – Field House** – Updated the jointing and notes meet the dimensional compliance with Atascosa County regulations.

**C04.0B Dimensional Plan – Field House** – Updated driveway to meet the dimensional compliance with Atascosa County regulations and updated the Traffic Control Plan.

**C05.0B Grading Plan - Field House** – Updated driveway elevations to match the given dimensional changes.

**C07.0B Typical Details - Field House** – No changes were made to this sheet. It is in reference to the pavement thickness, which is a requirement for the driveway permit.

Please contact us should you have any questions.

Sincerely,

Jeffrey G. Puig, P.E., R.P.L.S.  
Practice Leader

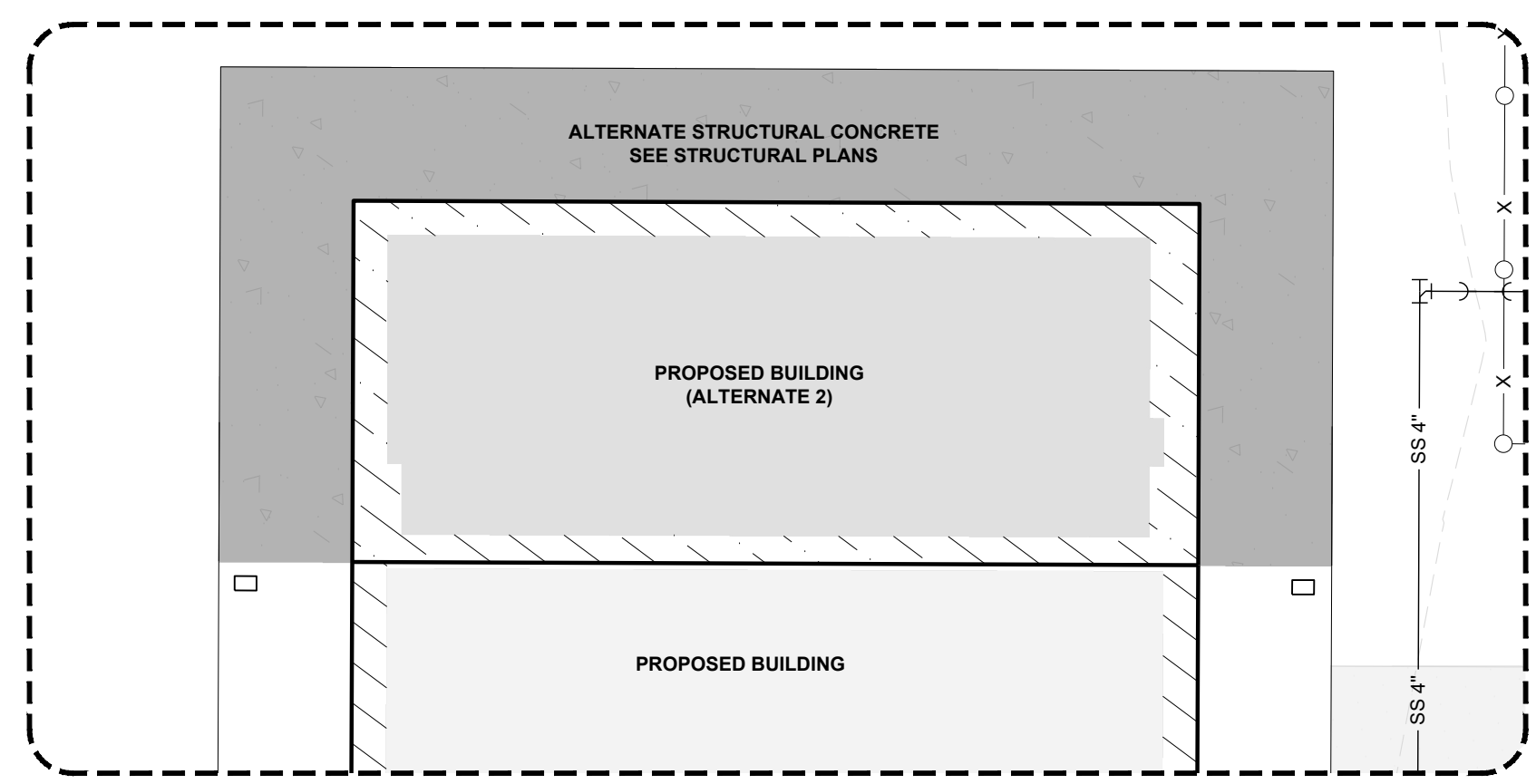
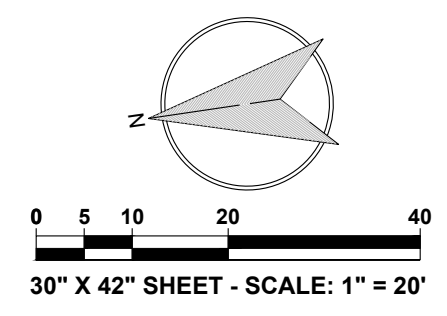

**INSET 'A' - ALTERNATE A**  
SCALE: 1"=10'

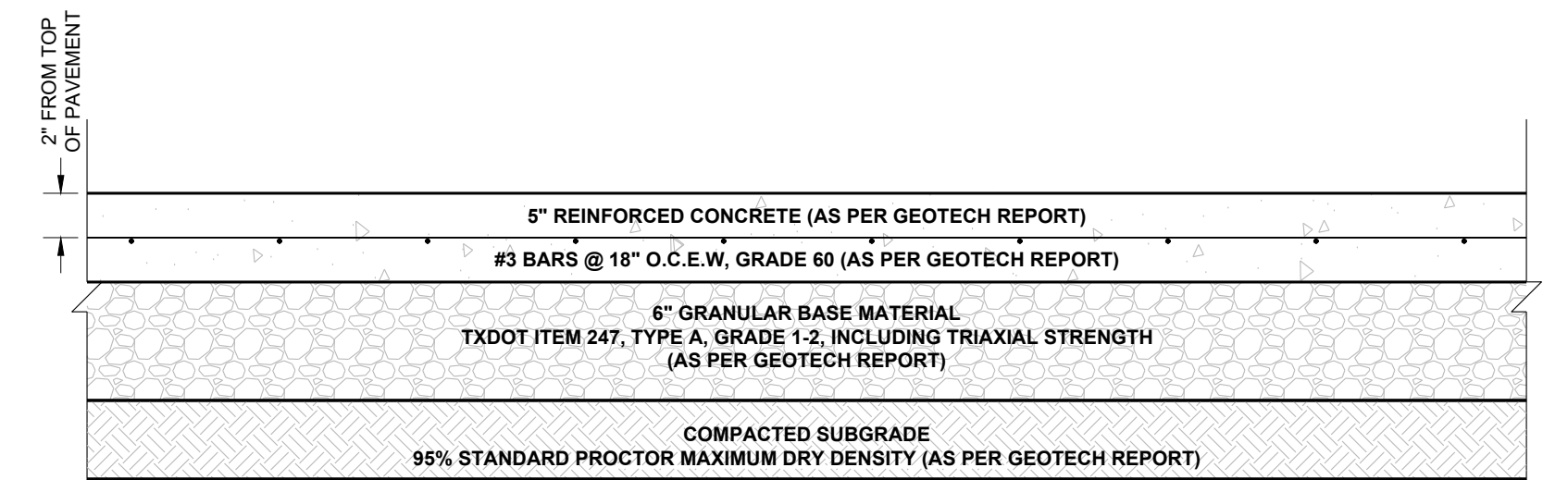

- PAVEMENT NOTES:**
1. CONTRACTOR SHALL COMPLY WITH ALL REQUIREMENTS SET BY THE REPORT TITLED "CHARLOTTE ISD BOND 2024 IMPROVEMENTS", PREPARED BY TERRACON, PROJECT NO. 90245292, ON DECEMBER 13, 2024.
  2. FOR ANY DISCREPANCIES BETWEEN THESE PLANS AND THE REPORT STATED ABOVE, THE STRICTEST REQUIREMENT SHALL GOVERN.

**LIGHT DUTY CONCRETE SECTION**  
SCALE: N.T.S.

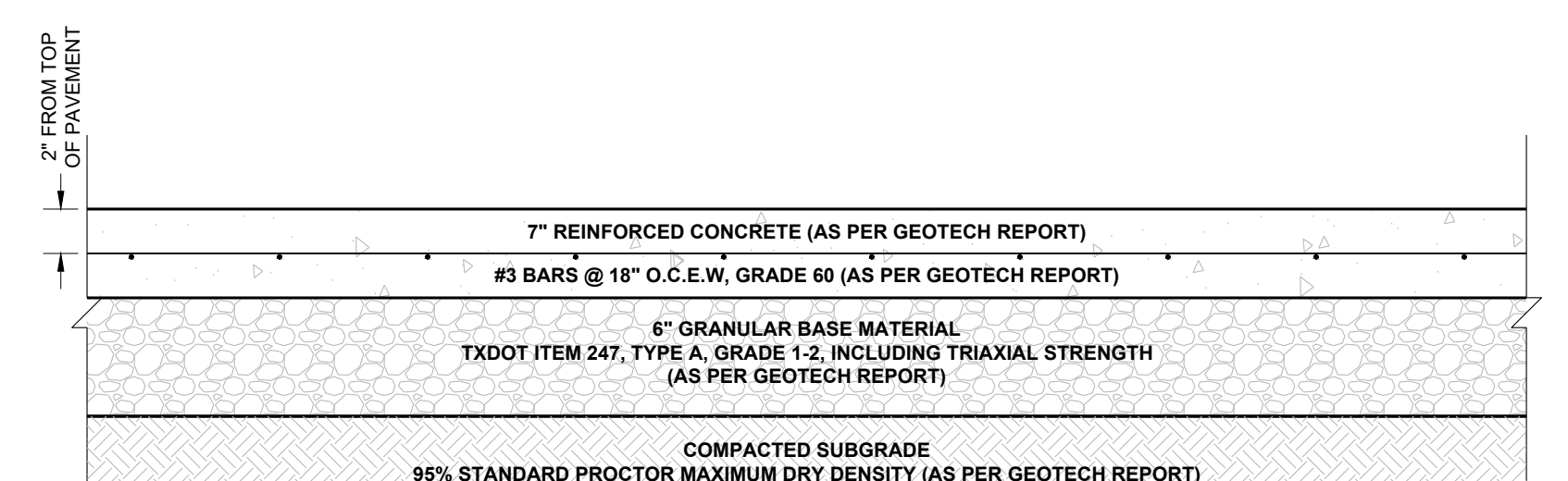

- PAVEMENT NOTES:**
1. CONTRACTOR SHALL COMPLY WITH ALL REQUIREMENTS SET BY THE REPORT TITLED "CHARLOTTE ISD BOND 2024 IMPROVEMENTS", PREPARED BY TERRACON, PROJECT NO. 90245292, ON DECEMBER 13, 2024.
  2. FOR ANY DISCREPANCIES BETWEEN THESE PLANS AND THE REPORT STATED ABOVE, THE STRICTEST REQUIREMENT SHALL GOVERN.

**HEAVY DUTY CONCRETE SECTION**  
SCALE: N.T.S.

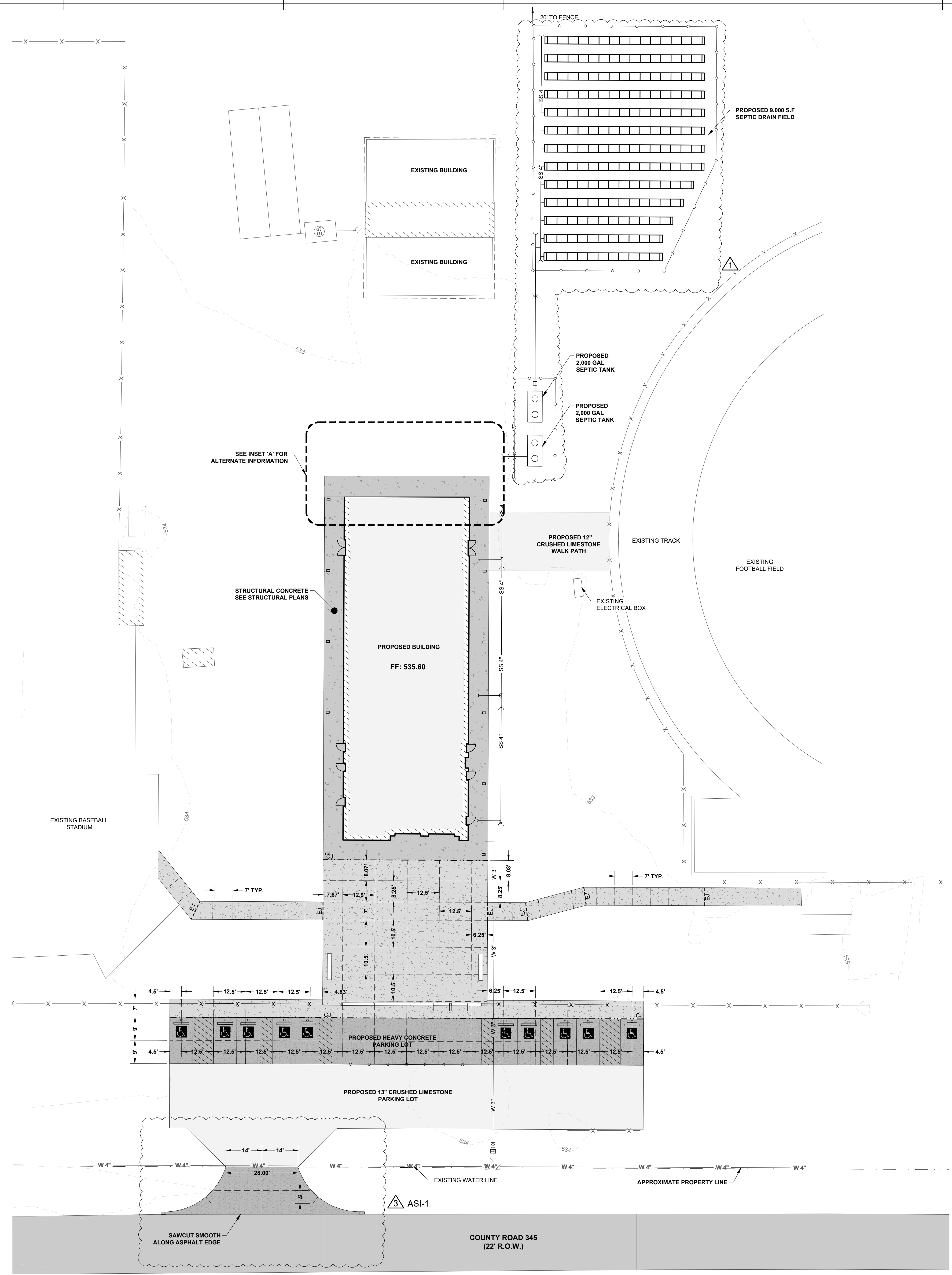

LEGEND	
PROPOSED BUILDING LINE	
HEAVY DUTY CONCRETE	
LIGHT DUTY CONCRETE	
EXISTING ASPHALT PAVEMENT	
CONTRACTION JOINT	
CONSTRUCTION JOINT	
EXPANSION JOINT	

**ABBREVIATIONS:**  
 OHE = OVERHEAD ELECTRIC EASEMENT  
 B.S. = BUILDING SETBACK  
 U.E. = UTILITY EASEMENT  
 OHE = OVERHEAD ELECTRIC

- NOTES**
- CONTRACTION/DUMMY JOINT SPACING PAVEMENT THICKNESS OF 5 TO 5.5 INCHES SHALL BE A MAXIMUM OF 12.5' EACH WAY.
  - CONTRACTION/DUMMY JOINT SPACING PAVEMENT THICKNESS OF 6 OR GREATER SHALL BE A MAXIMUM OF 15' EACH WAY.
  - SAW CUT CONTROL JOINTS SHOULD BE CUT WITHIN 6 TO 12 HOURS OF PAVEMENT THICKNESS.
  - CONTRACTION JOINT DEPTH SHALL BE AT LEAST ONE-FOURTH (1/4) OF PAVEMENT THICKNESS.
  - CONTRACTION JOINT WIDTH SHALL BE ONE-FOURTH (1/4) INCH OR AS REQUIRED BY JOINT SEALANT MANUFACTURE.
  - ALL JOINTS SHOULD BE SEALED. IF ALL JOINTS, INCLUDING SAWCUTS, ARE NOT SEALED THEN EXPANSION JOINTS SHOULD BE INSTALLED.
  - ALL JOINTS AS PER REPORT TITLED "CHARLOTTE ISD BOND 2024 IMPROVEMENTS" PROJECT NO. 90245292, PREPARED BY TERRACON, ON DECEMBER 13, 2024.

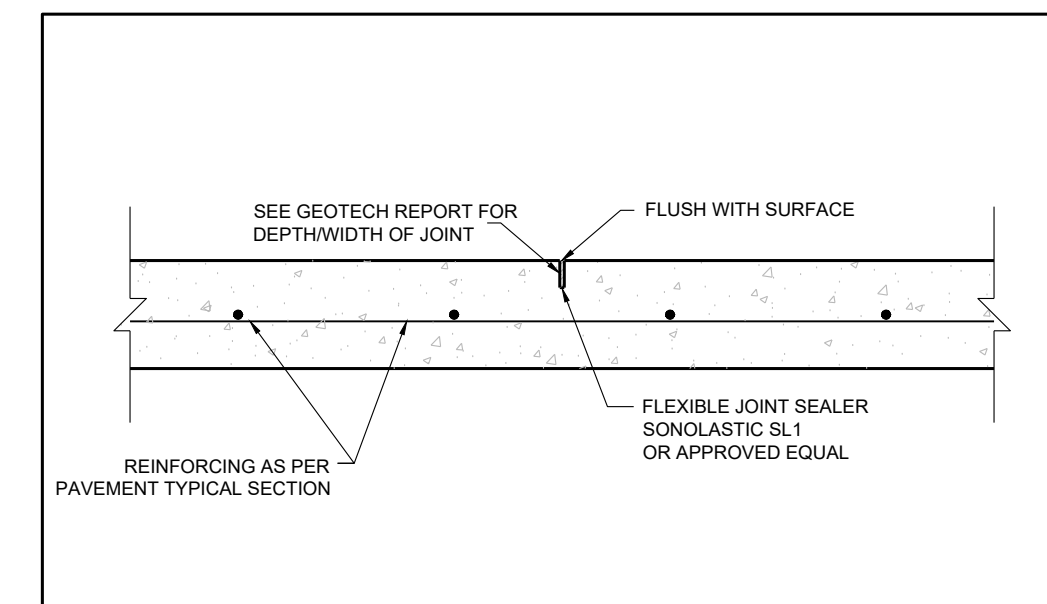

**CONTRACTION/DUMMY JOINT SECTION**  
SCALE: N.T.S.

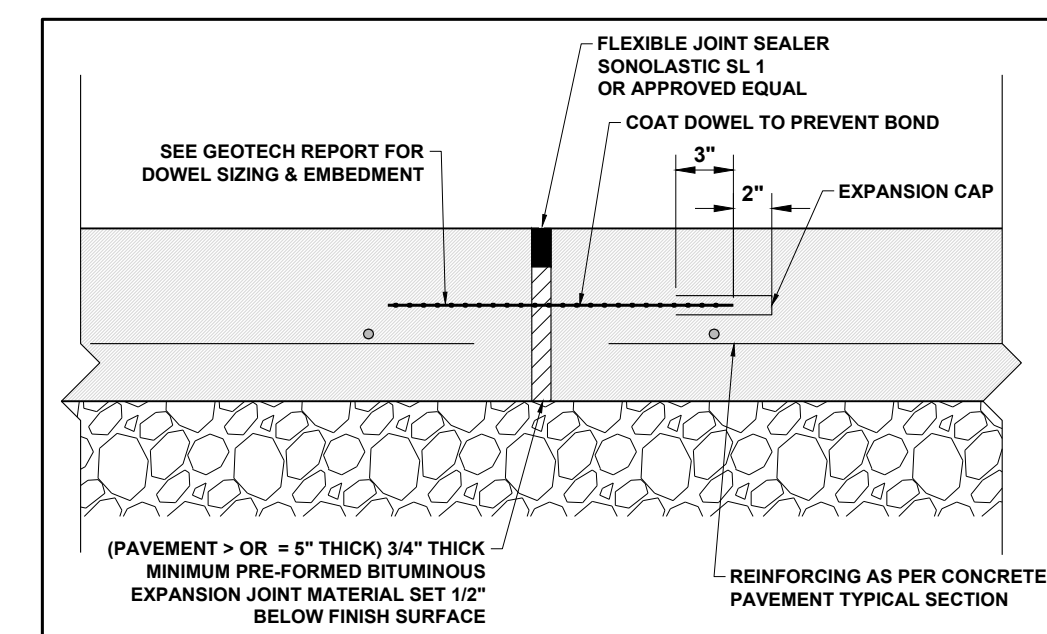

- NOTE:**
1. CONTRACTOR TO REFER TO GEOTECHNICAL REPORT FOR LOCATION OF EXPANSION JOINTS.

**EXPANSION JOINT**  
SCALE: N.T.S.

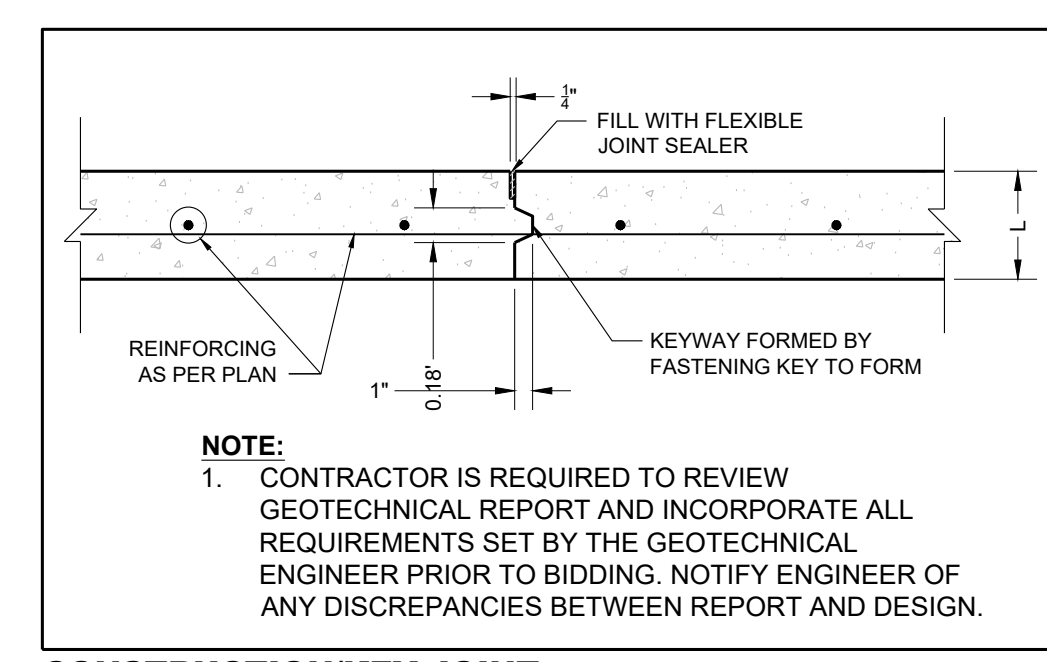

**CONSTRUCTION/KEY JOINT**  
SCALE: N.T.S.



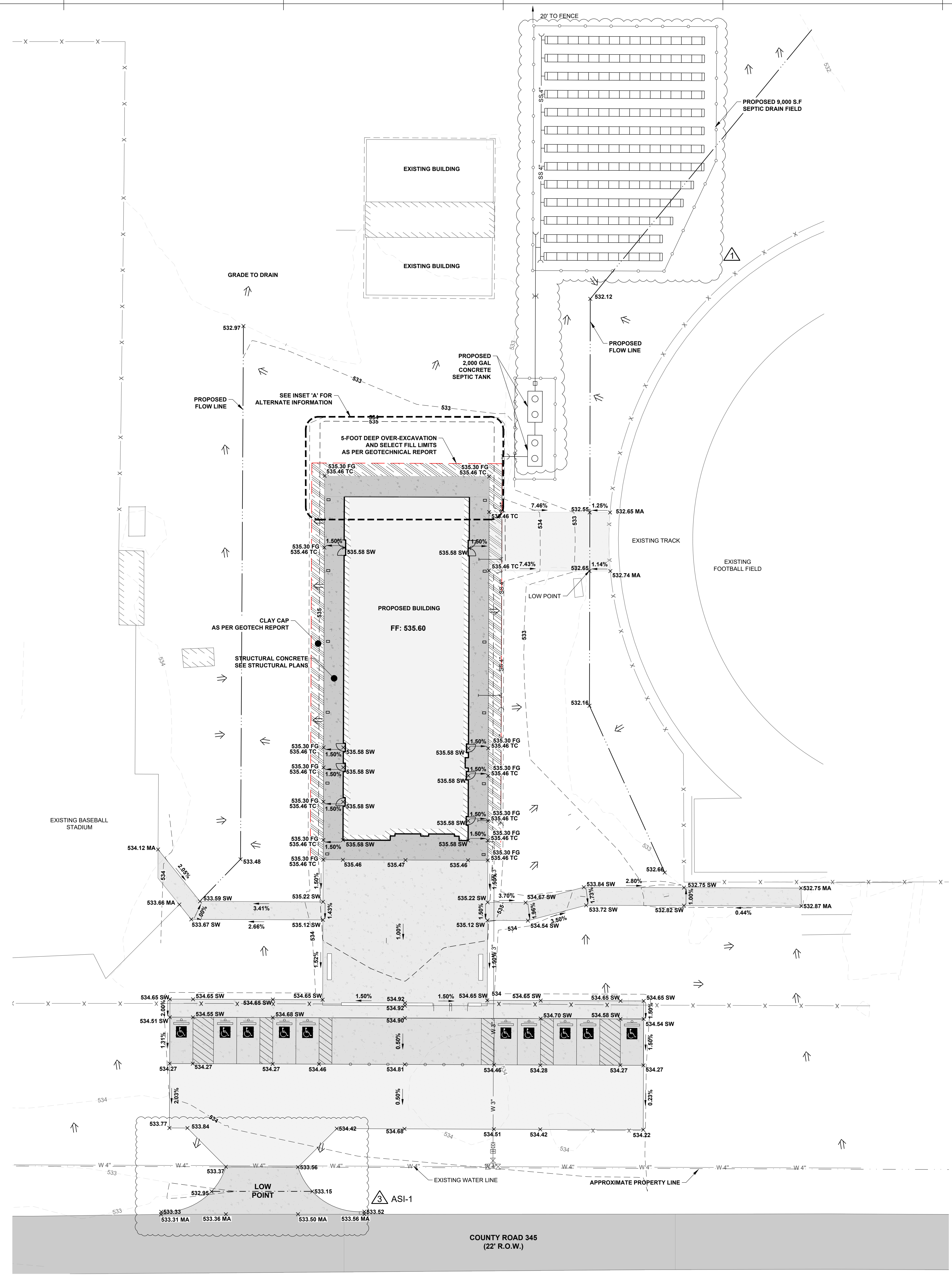
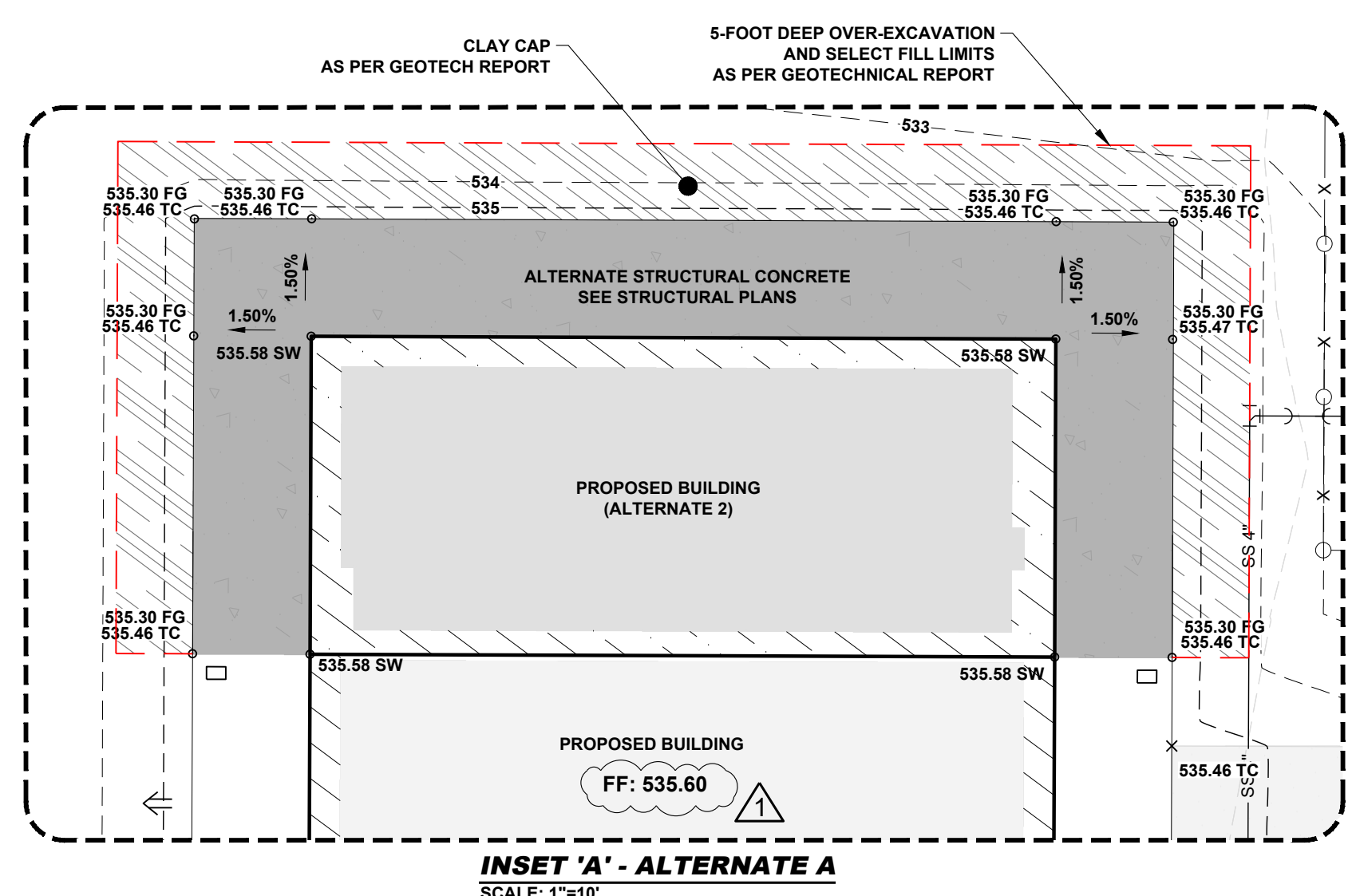
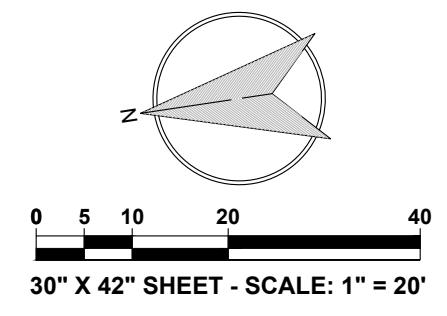

**LEGEND**

BUILDING LINE	
CONCRETE PAVEMENT	
CONCRETE FLATWORK (SIDEWALK/KRIPRAP)	
ASPHALT PAVEMENT	
CRUSHED LIMESTONE	
CONTOUR (MAJOR)	450
CONTOUR (MINOR)	448
EXISTING CONTOUR (MAJOR)	450
EXISTING CONTOUR (MINOR)	448
GRADE	2.0%
SPOT ELEVATION	X 450.00 TC
GRADE BREAK	
RIDGE LINE	
FLOWLINE	

**ABBREVIATIONS:**  
 FF = FINISH FLOOR  
 BC = BACK OF CURB  
 BLDG = BUILDING  
 FL = FLOWLINE  
 INV = INVERT  
 NG = NATURAL GROUND  
 RIM = RIM ELEVATION  
 SW = SIDEWALK  
 TC = TOP OF CONCRETE

E:\ddp\pjt\_2024\10020240510\_01\site\_civil\sheet\_P20\pfluger\CAD\Drawings\sheet\field\HouseGRADING\_Field House.dwg  
 06/21/2025

**pfluger**  
 PLANNERS  
 ARCHITECTS  
 ENGINEERS  
 CONSTRUCTORS  
 CONSULTANTS  
 200 E. Grayson St., Suite 115,  
 San Antonio, TX 78215  
 Office: 210.227.2724 | Fax: 210.227.2730  
 Phone: (857) 256-7944  
 TBE Registration No. F-1073  
 pflugerarchitects.com

**KCI**  
 TECHNOLOGIES  
 7109 N. Bartlett Avenue, Suite 200  
 San Antonio, TX 78217  
 Phone: (857) 256-7944  
 TBE Registration No. F-1073

**CHARLOTTE ISD 2024 BOND**  
**ATHLETICS FIELD HOUSE**  
 1247 Couser Blvd., Charlotte, TX 78011

CHARLOTTE ISD  
 102 E. Hines Ave.  
 P.O. Box 489  
 Charlotte, TX 78011

STATE OF TEXAS  
 JEFFREY G. PUG  
 86352  
 LICENSED PROFESSIONAL ENGINEER  
  
 06/21/2025

PROJECT NO.	24-02	
DATE	06/27/2025	
DRAWN BY:		
CHECKED BY:		
REVISIONS:		
No.	Date	Description
1	06/27/2025	4292621411
3	06/27/2025	AS1

**C05.0B**  
 GRADING PLAN  
 - FIELD HOUSE

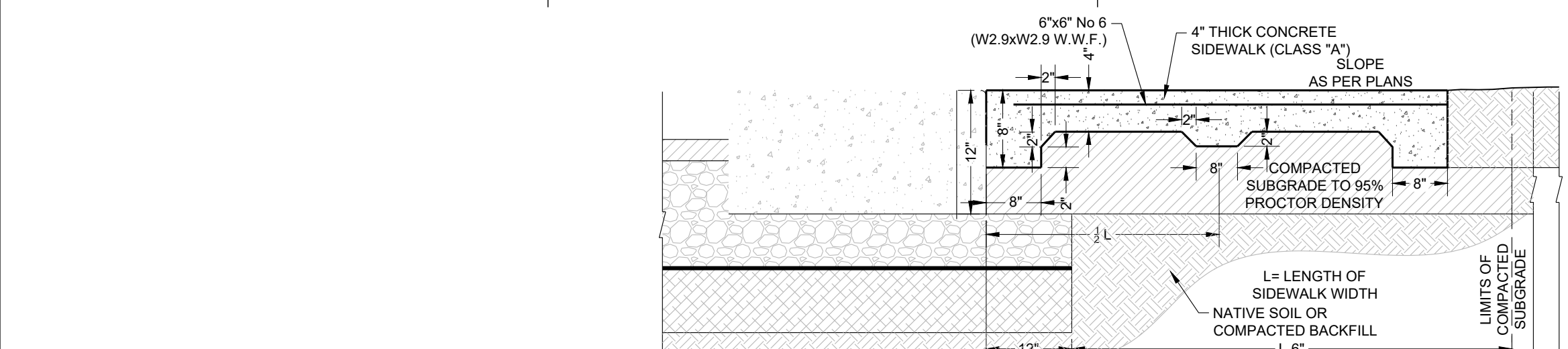

**1 > 6' to 12' SIDEWALK DETAIL**  
SCALE: N.T.S.

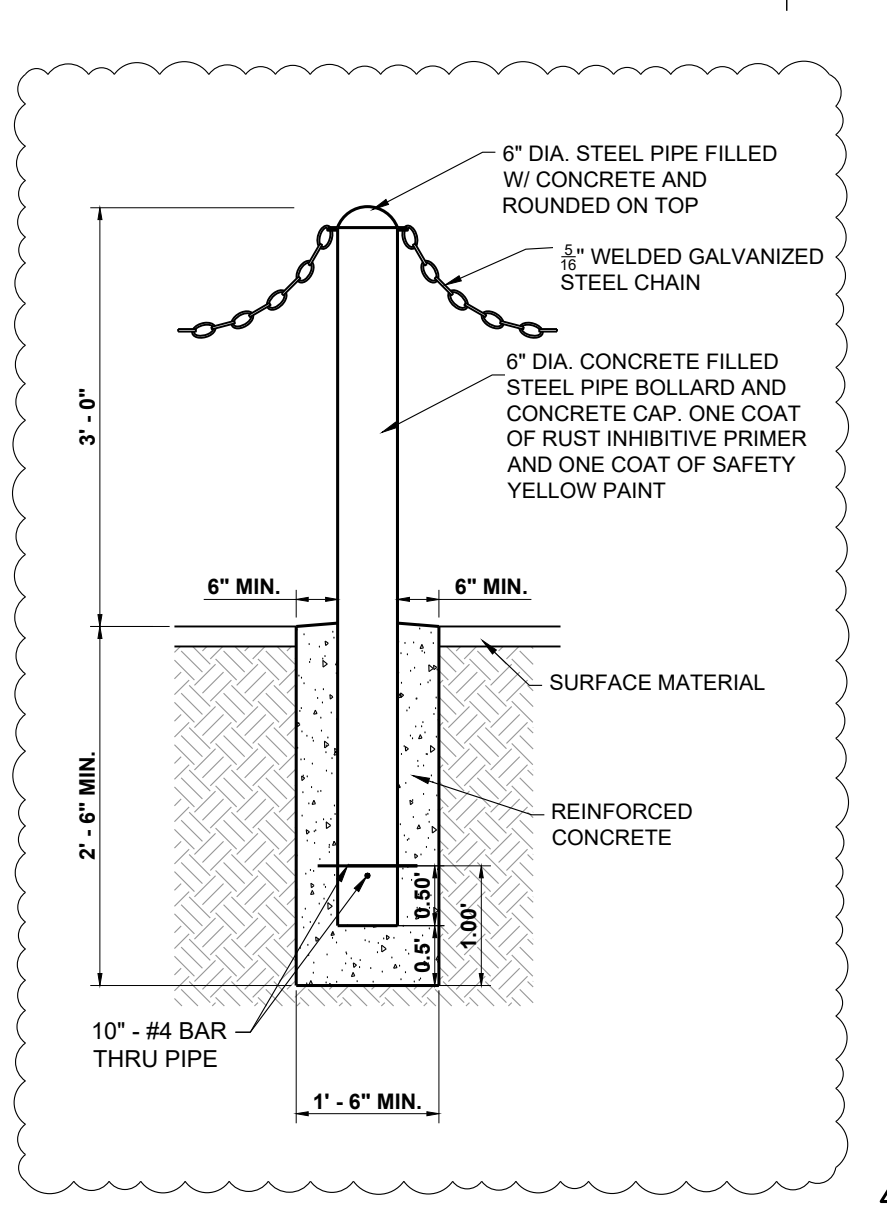

**5 BOLLARD AND CHAIN DETAIL**  
SCALE: N.T.S.

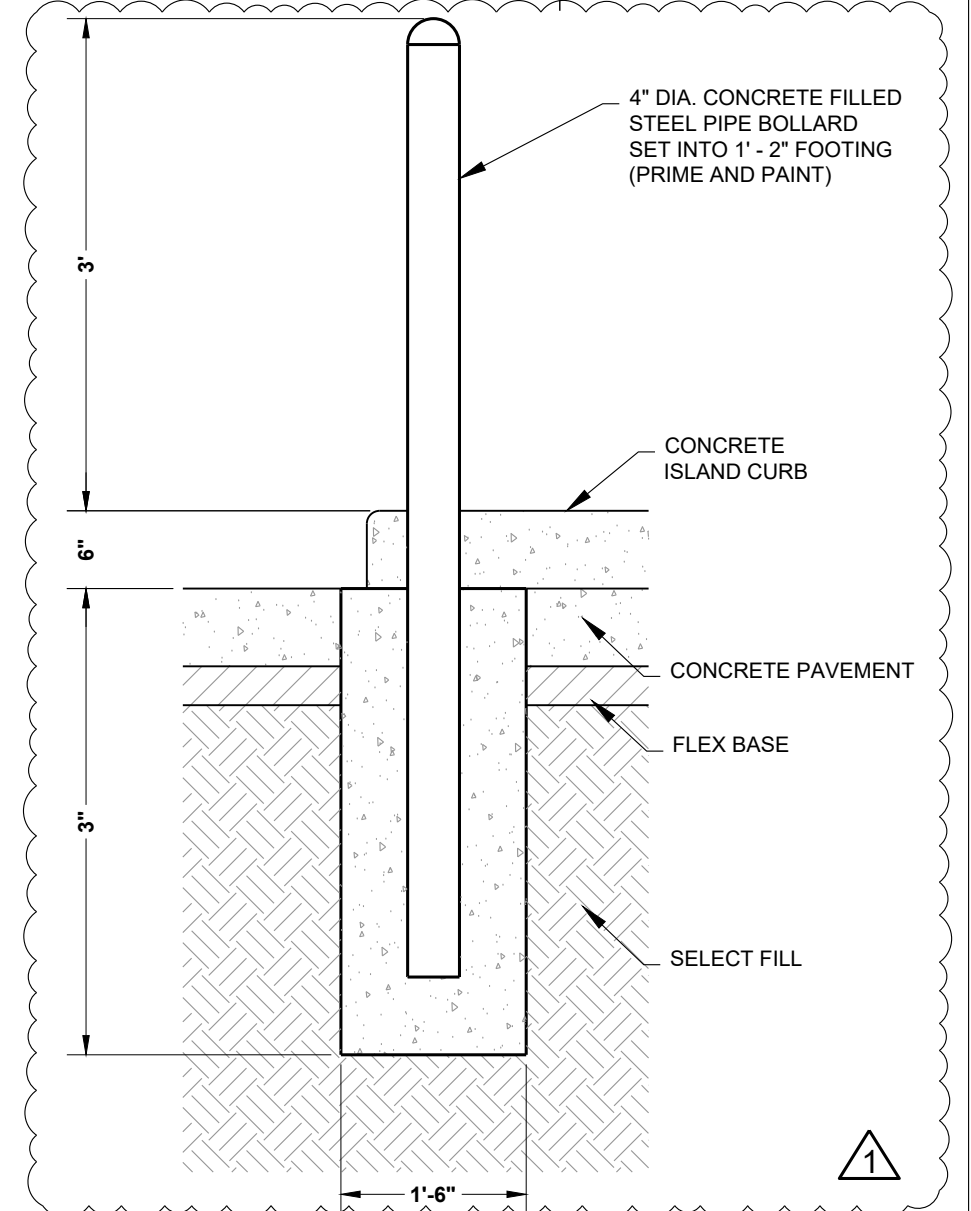

**6 STEEL PIPE BOLLARD DETAIL**  
SCALE: N.T.S.

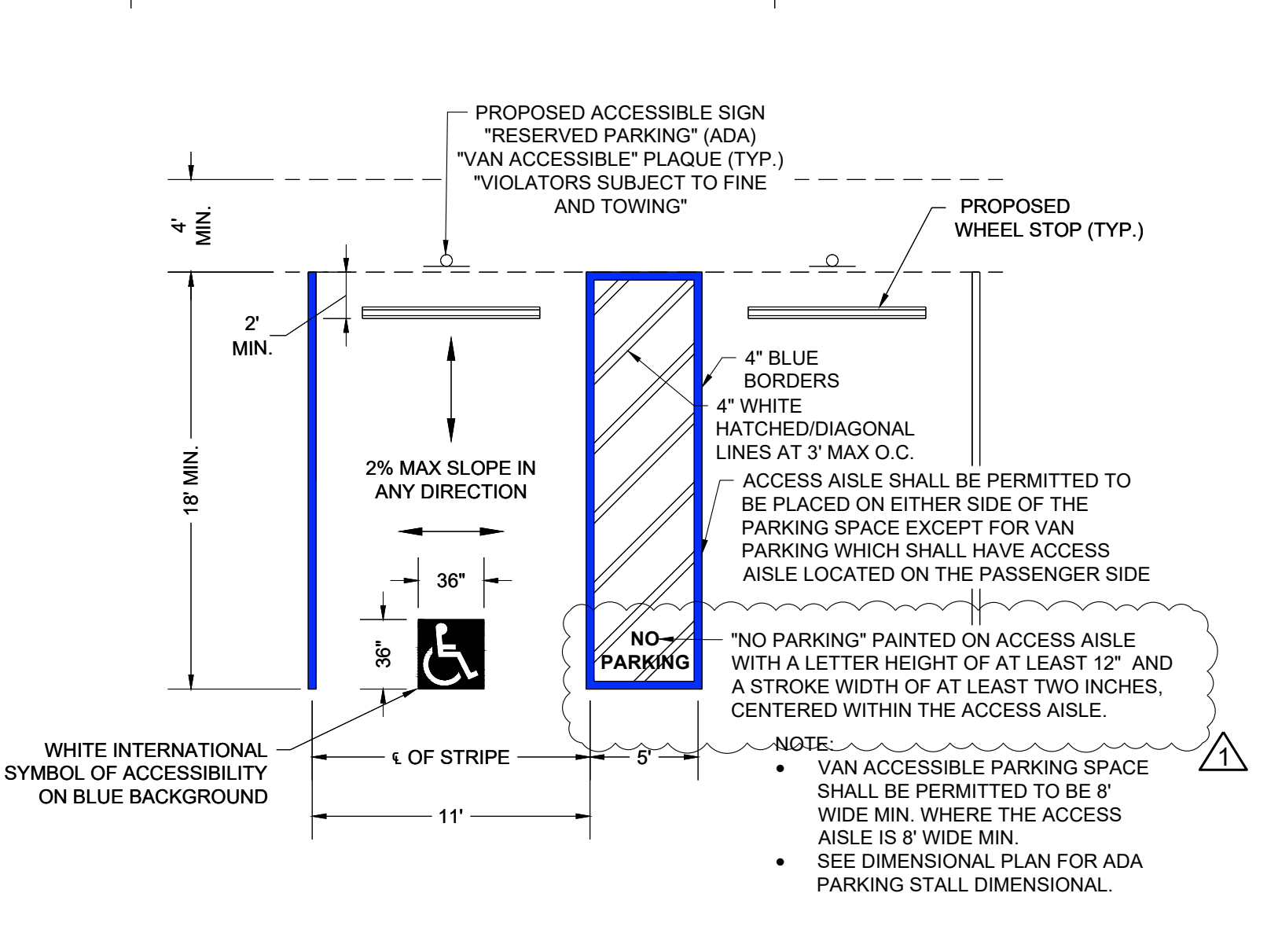

**7 ADA STRIPING DETAIL**  
SCALE: N.T.S.

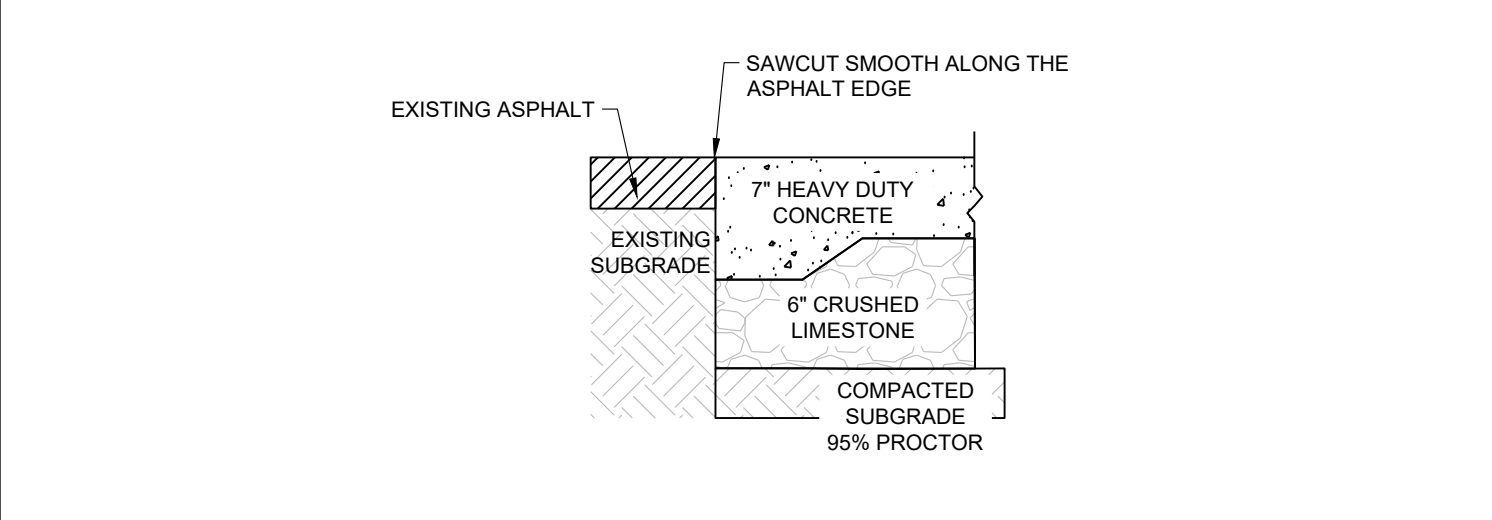

**2 ASPHALT PAVEMENT CONNECTION TO PROPOSED CONCRETE**  
SCALE: N.T.S.

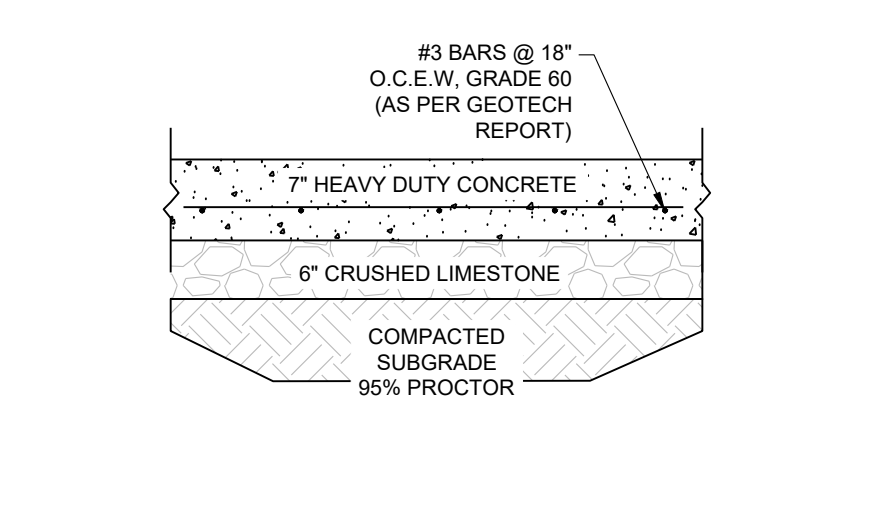

**3 7\"/>**

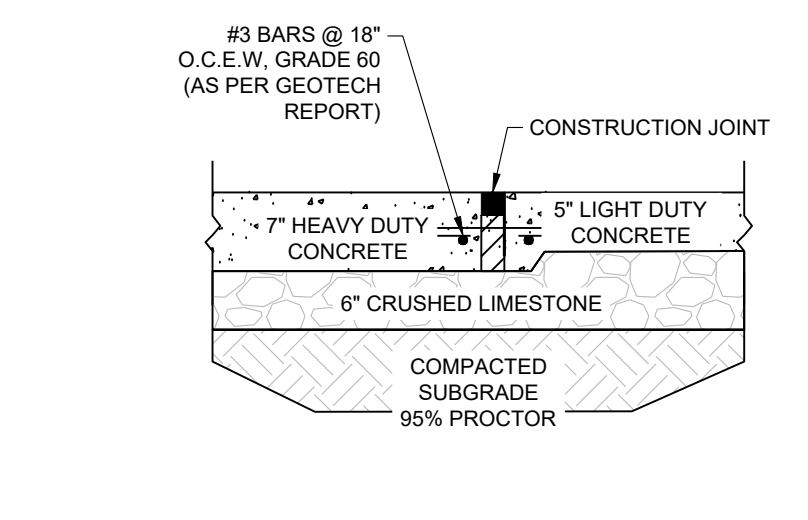

**4 7\"/>**

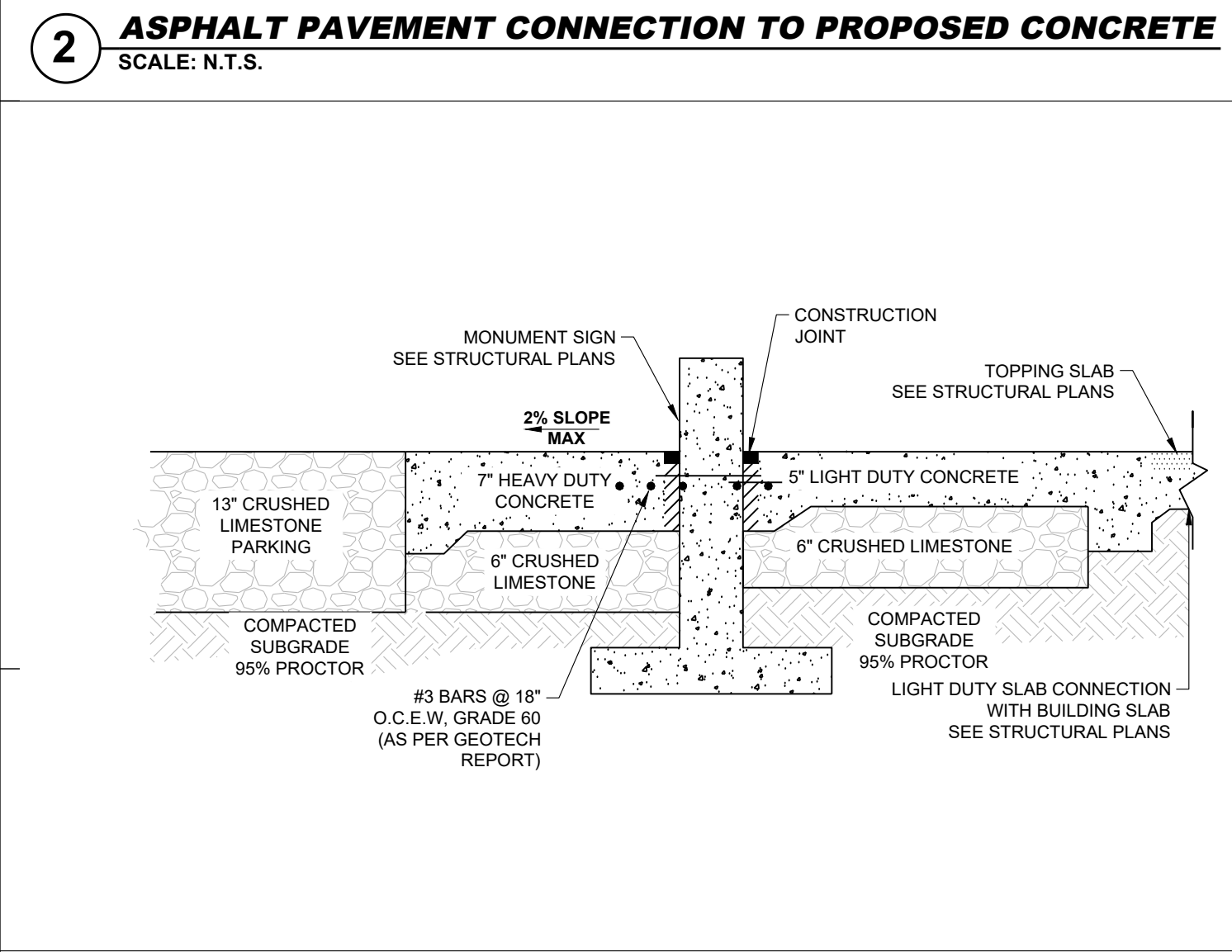

**8 PARKING SECTION & ENTRANCE SECTION DETAIL**  
SCALE: N.T.S.

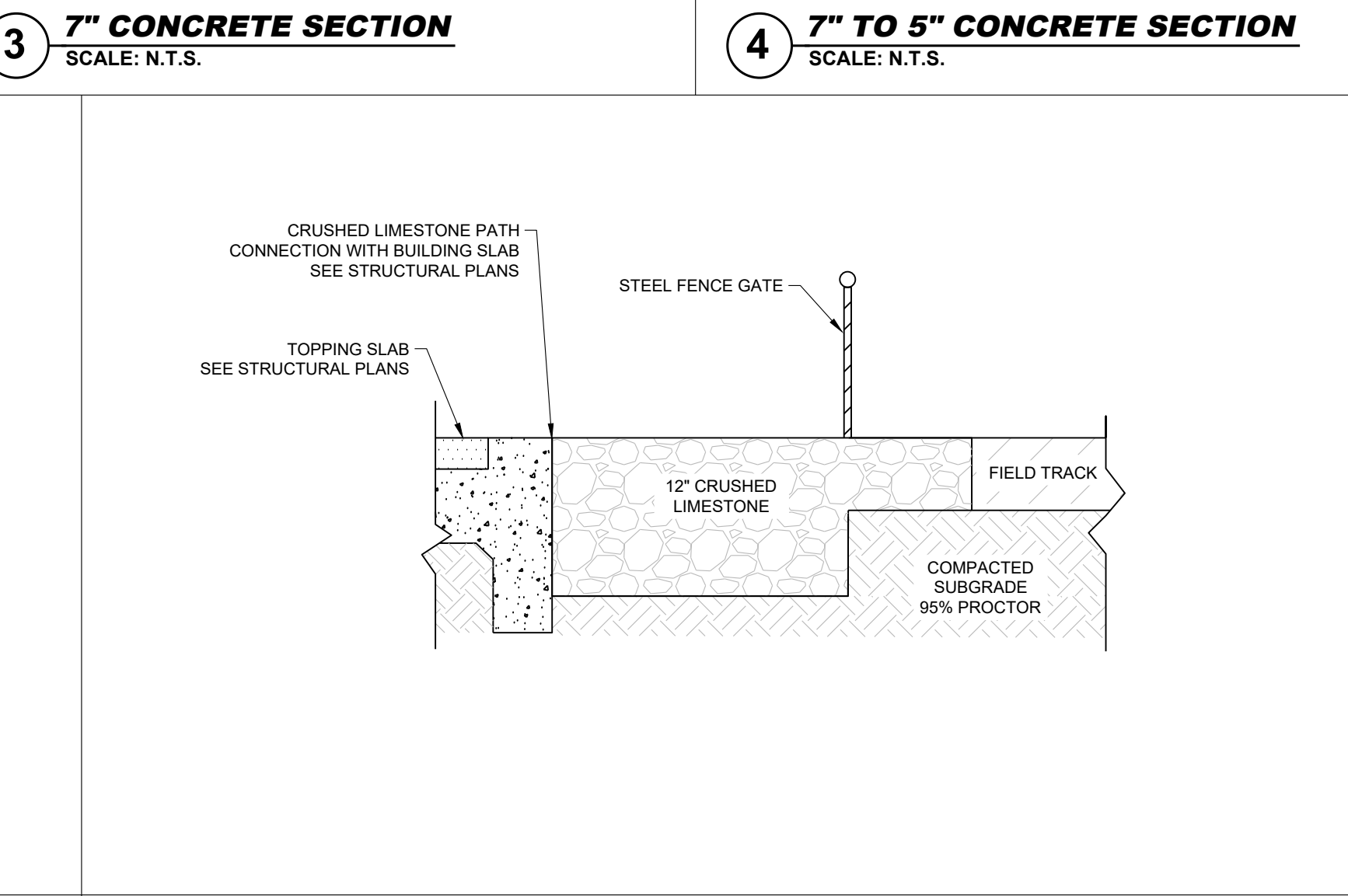

**9 CRUSHED LIMESTONE PATH SECTION DETAIL**  
SCALE: N.T.S.

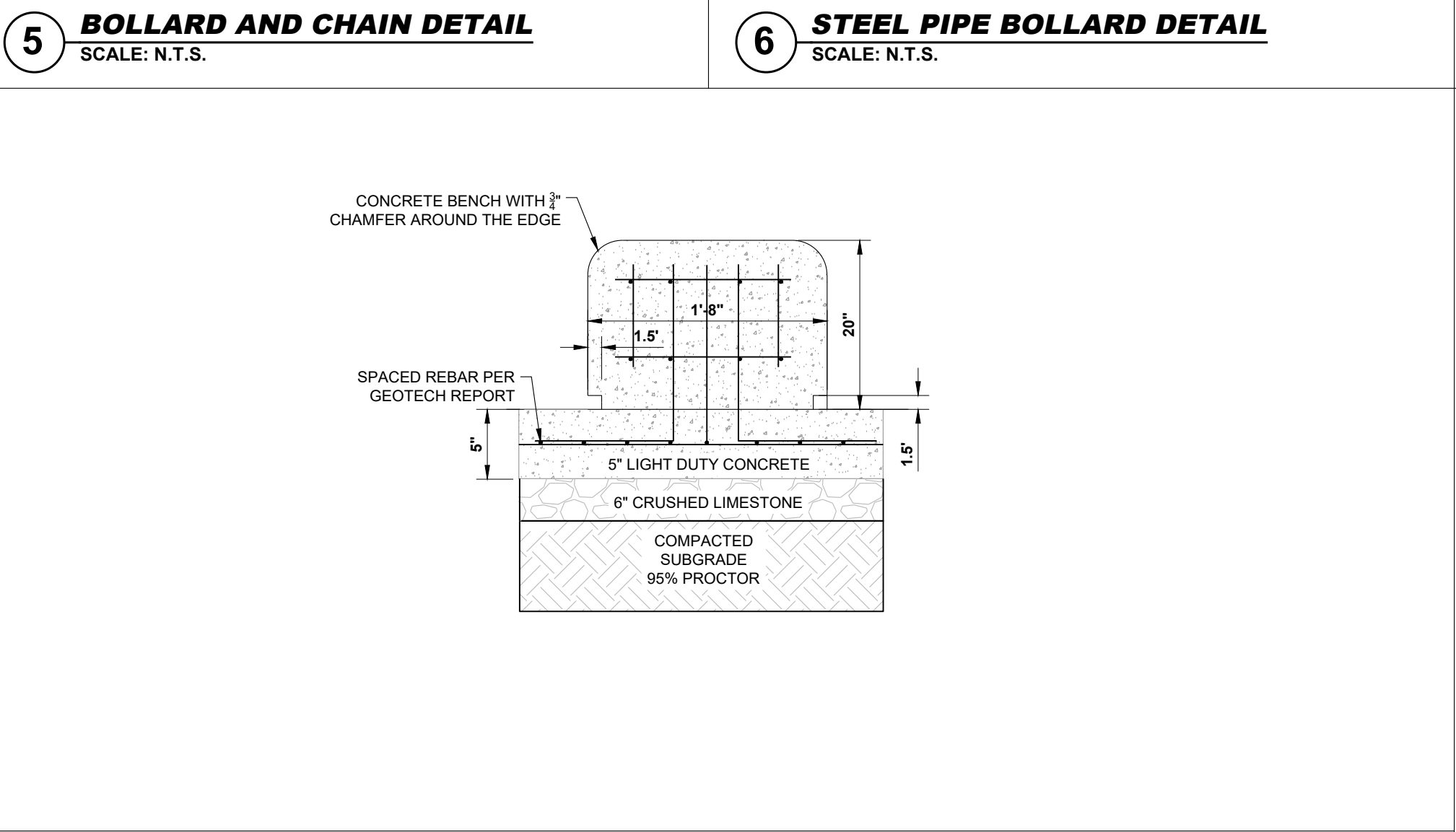

**10 CONCRETE BENCH SECTION DETAIL**  
SCALE: N.T.S.

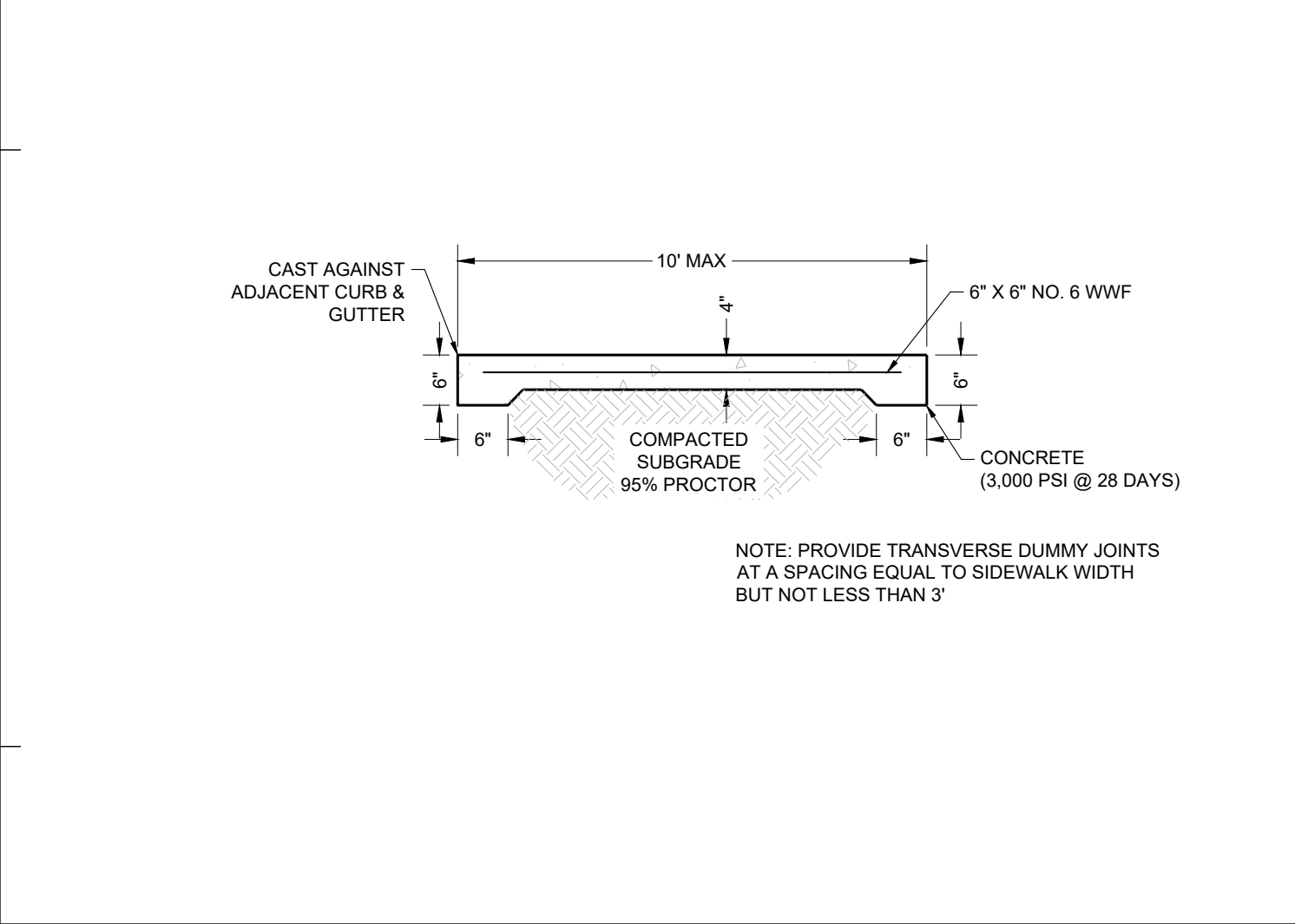

**11 CONCRETE SIDEWALK (UP TO 10')**  
SCALE: N.T.S.

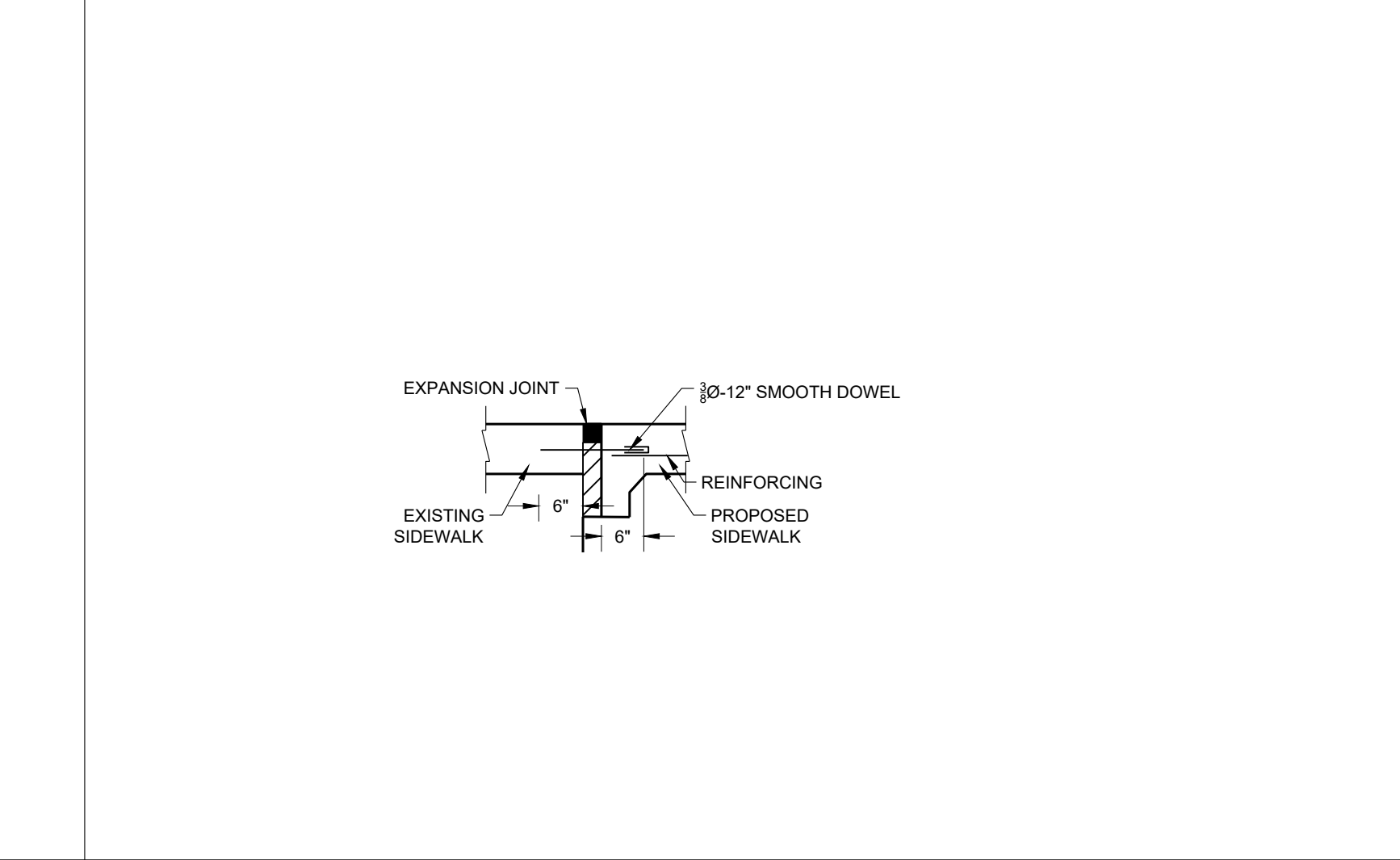

**12 EXISTING SIDEWALK TO PROPOSED SIDEWALK DETAIL**  
SCALE: N.T.S.

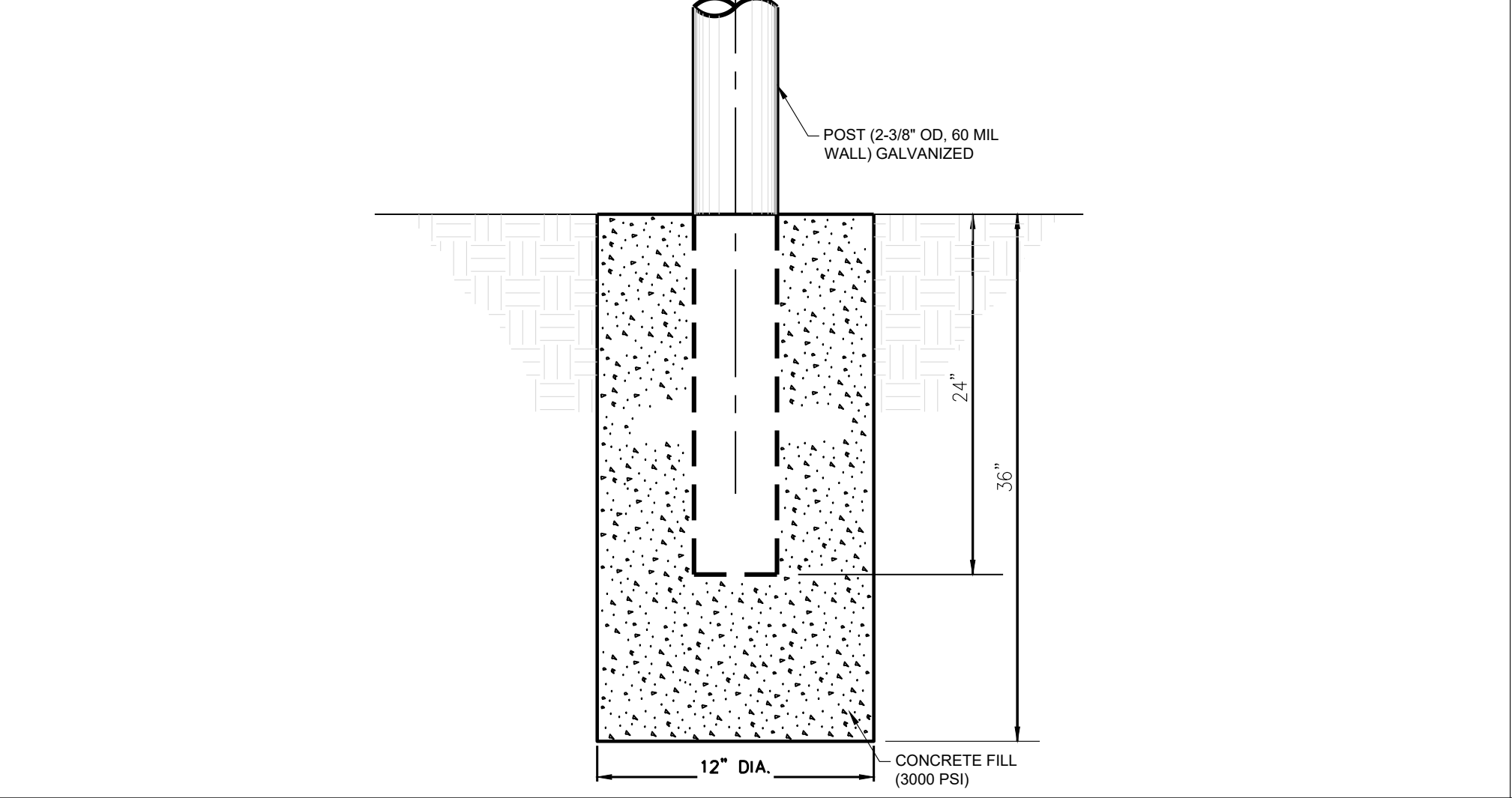

**13 STANDARD POST DETAIL**  
SCALE: N.T.S.

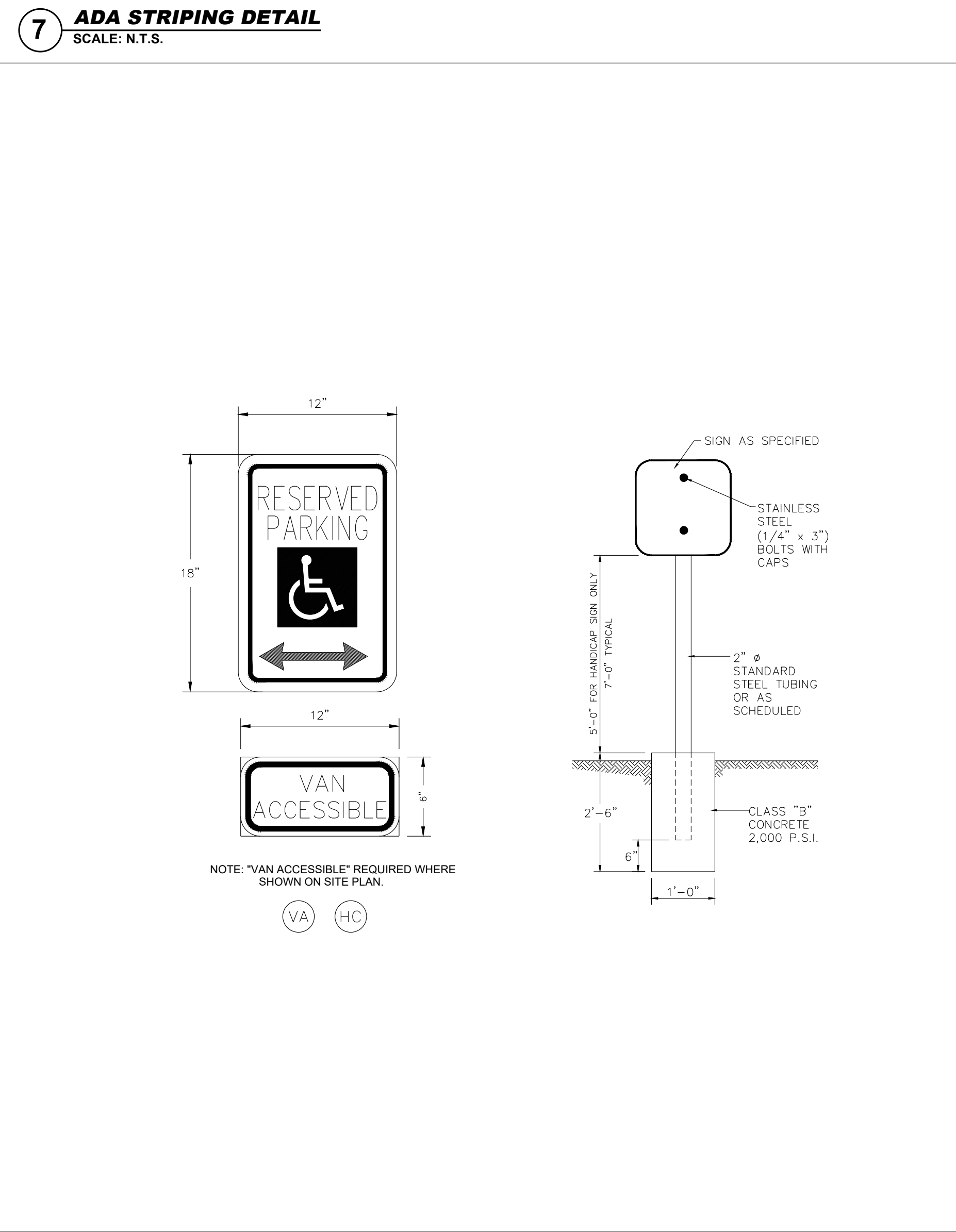

**14 ACCESSIBLE PARKING SIGN AND PIPE SUPPORT DETAIL**  
SCALE: N.T.S.

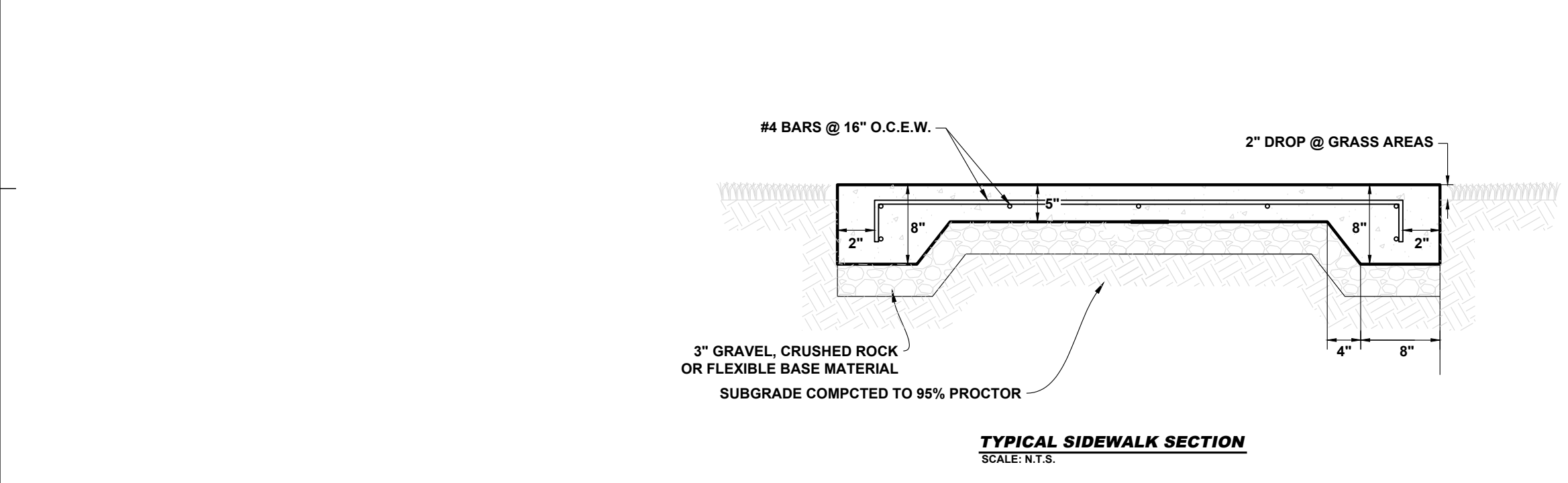

**15 CONCRETE SIDEWALK DETAIL**  
SCALE: N.T.S.

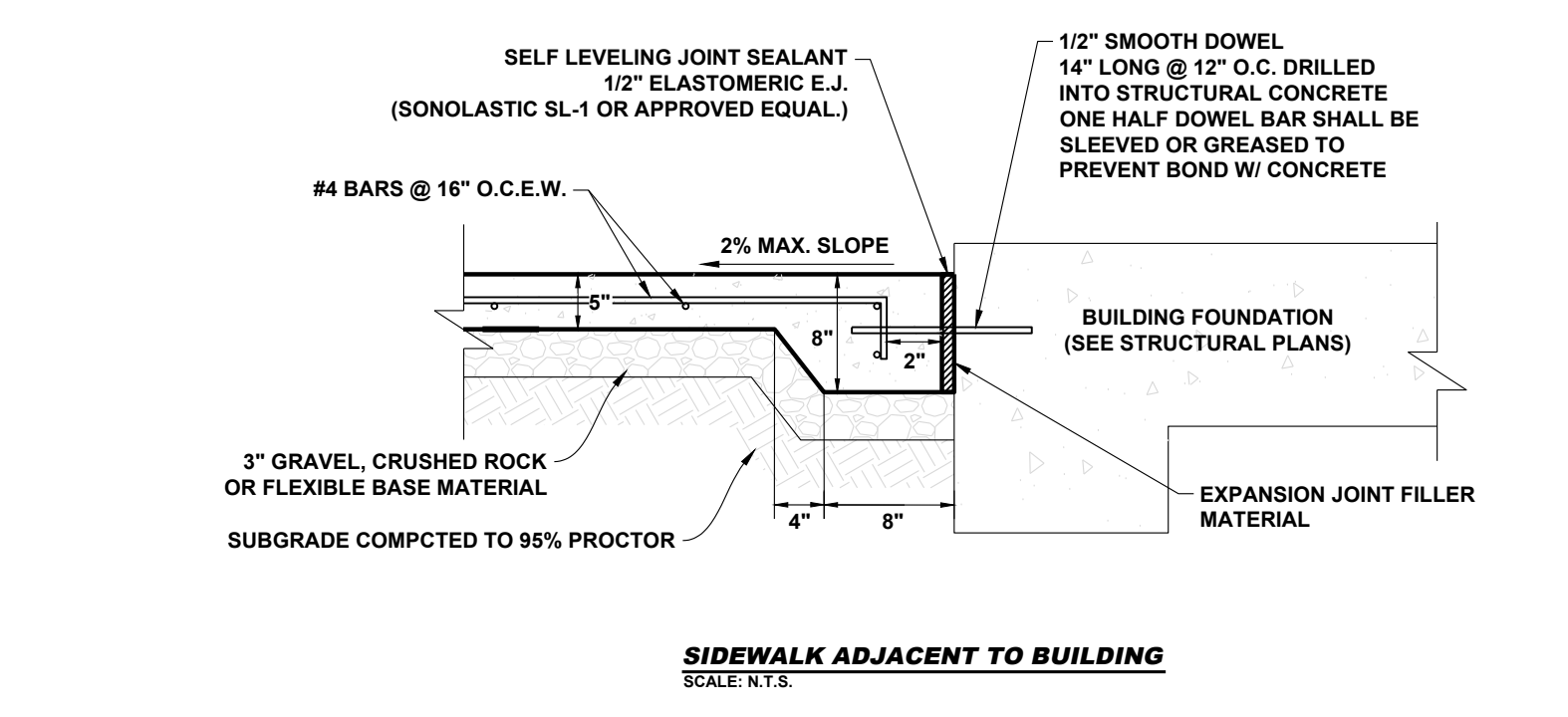

**15 CONCRETE SIDEWALK DETAIL**  
SCALE: N.T.S.



**15 CONCRETE SIDEWALK DETAIL**  
SCALE: N.T.S.

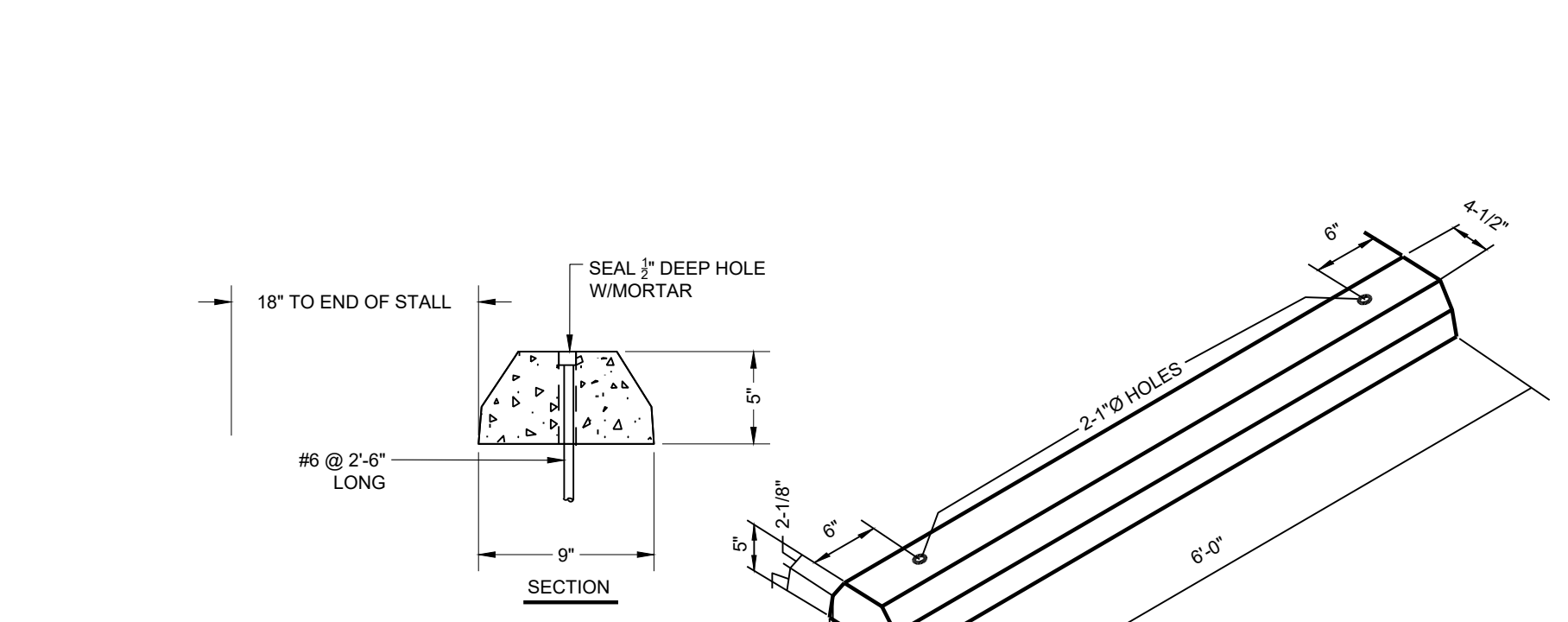

**15 CONCRETE SIDEWALK DETAIL**  
SCALE: N.T.S.

- NOTES:**
1. ALL SIDEWALKS SHALL BE A MINIMUM 3,300 PSI CONCRETE WITH NO. 4 BARS AT 16 INCHES ON CENTER.
  2. SLOPE SIDEWALKS AWAY FROM BUILDING AS INDICATED ON PLANS.
  3. ALL SIDEWALK SURFACE SHALL HAVE BRUSH FINISH.
  4. CONTRACTION JOINTS SHALL BE SPACED 8 FT. ON CENTER, WITH 1/2\"/>

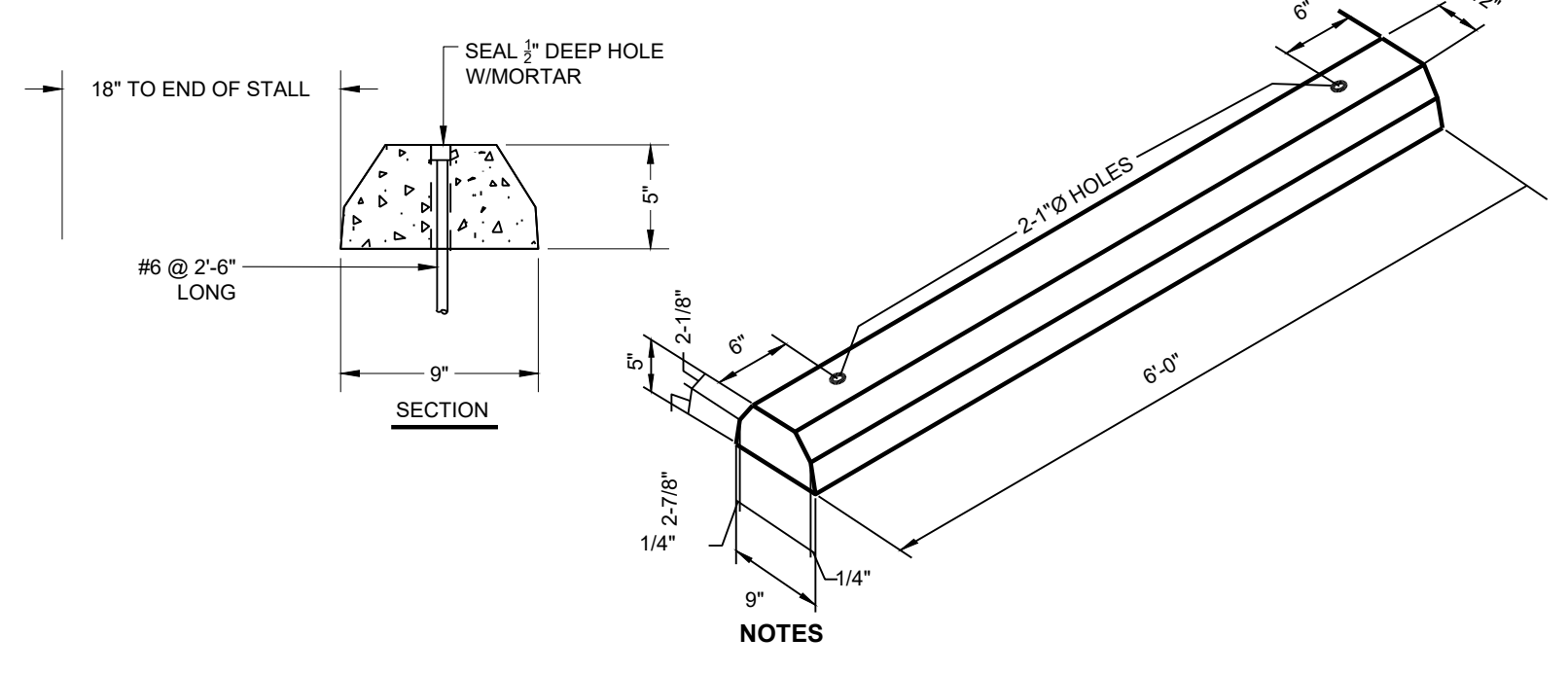

**16 PRECAST CONCRETE WHEEL STOP DETAIL**  
SCALE: N.T.S.

- NOTES:**
1. CONCRETE WHEEL STOPS TO BE PLACED WHERE NOTED ON THE PLANS.
  2. THE CONTRACTOR SHALL SECURE THE PRECAST CONCRETE WHEEL STOP TO THE PAVEMENT USING #6 REBARS, 30\"/>