

LEGEND

D.R. = DEED RECORDS OF ATASCOSA COUNTY, TEXAS
 ESMT = EASEMENT
 NTS = NOT TO SCALE
 OPR = OFFICIAL PUBLIC RECORDS OF REAL PROPERTY OF ATASCOSA COUNTY, TEXAS
 PGS. = PAGES
 R.O.W. = RIGHT-OF-WAY
 VOL. = VOLUME

1
4.56 AC

○ = FOUND STEEL ROD MONUMENT
 ▲ = FOUND TxDOT CONCRETE MONUMENT
 ■ = SET MAG-NAL WITH WASHER STAMPED "RAKOWITZ ENGINEERING & SURVEYING"
 ● = SET 5/8" STEEL ROD MONUMENT WITH CAP STAMPED "RAKOWITZ ENGINEERING & SURVEYING"

— = PROPERTY LINE
 — = LOT LINE
 — = ADJOINER
 -512 = EXISTING CONTOUR

◇ = SUPPLEMENTAL EASEMENT AND RIGHT OF WAY (INSTRUMENT NO. 210189 OPR)

ATASCOSA COUNTY SUBDIVISION REGULATION NOTES:

- THE SUBDIVISION IS IN THE CHARLOTTE ISD.
- CONVEYANCE OF LOTS SHALL NOT BE PERMITTED UNTIL THE FINAL PLAT HAS BEEN APPROVED BY THE ATASCOSA COUNTY COMMISSIONERS COURT, AND THE RECORDED PLAT FILED WITH THE COUNTY CLERK.
- IF A CULVERT IS INSTALLED, THE MINIMUM DRIVEWAY CULVERT SIZE FOR EACH LOT SHALL NOT BE LESS THAN 18 INCHES. IF A CULVERT IS NOT INSTALLED, THEN MAKE SURE DRIVEWAY IS CONSTRUCTED IN A MANNER TO NOT BLOCK UPGRADIENT WATER.
- NO STRUCTURE IN THIS SUBDIVISION SHALL BE OCCUPIED UNTIL CONNECTED TO A PUBLIC WATER SYSTEM OR AN INDIVIDUAL WATER SYSTEM. DUE TO DECLINING WATER SUPPLY, PROSPECTIVE PROPERTY OWNERS ARE CAUTIONED BY ATASCOSA COUNTY TO QUESTION THE SELLER CONCERNING GROUNDWATER AVAILABILITY. RAIN WATER COLLECTION IS ENCOURAGED AND IN SOME AREAS MAY OFFER THE BEST RENEWABLE WATER RESOURCE.
- NO STRUCTURE IN THIS SUBDIVISION SHALL BE OCCUPIED UNTIL CONNECTED TO A PUBLIC SEWER SYSTEM OR TO AN ON-SITE SEWAGE FACILITY THAT HAS BEEN APPROVED AND PERMITTED BY THE ATASCOSA COUNTY SANITATION OFFICER.
- ALL LOTS HAVE BEEN DESIGNED IN COMPLIANCE WITH THE RULES OF ATASCOSA COUNTY FOR ON-SITE SEWAGE FACILITIES.
- NO STRUCTURE OR DEVELOPMENT WITHIN THE SUBDIVISION MAY BEGIN UNTIL FINAL APPROVAL OF THE PLAT BY ATASCOSA COUNTY COMMISSIONERS COURT AND RECORDING OF THE APPROVED PLAT BY THE COUNTY CLERK.
- THE LOCATION AND DIMENSIONS OF STREETS AS SET FORTH AND LAID OUT ON THIS PLAT ARE IN ACCORDANCE WITH THE SUBDIVISION AND DEVELOPMENT REGULATIONS OF ATASCOSA COUNTY, TEXAS.
- NO HOMES ARE TO BE BUILT OR BROUGHT ON TO THE LOT(S) UNTIL FLOODPLAIN PERMITS HAVE BEEN OBTAINED AND AN APPLICATION FOR SEPTIC PERMIT HAS BEEN SUBMITTED.
- THIS SUBDIVISION WILL BE SERVED BY CITY OF CHARLOTTE WATER, P.O. BOX 216, CHARLOTTE, TX 78011. INFORMATION ON THE CITY OF CHARLOTTE WATER IS AVAILABLE TO PROSPECTIVE PURCHASERS OF LOTS IN THIS SUBDIVISION IN THE OFFICE OF THE COUNTY CLERK OF ATASCOSA COUNTY, TEXAS.
- WATER SERVICE PROVIDED TO MTW SERVICES LLC BY CITY OF CHARLOTTE WATER.
- ELECTRIC SERVICE PROVIDED TO MTW SERVICES LLC BY AEP TEXAS INC. OR KARNES ELECTRIC CO-OP INC.
- IN ORDER TO PROMOTE SAFE USE OF ROADWAYS AND PRESERVE THE CONDITIONS OF PUBLIC ROADWAYS, NO DRIVEWAY CONSTRUCTED ON ANY LOT WITHIN THIS SUBDIVISION SHALL BE PERMITTED ACCESS ONTO A PUBLICLY DEDICATED ROADWAY UNLESS A DRIVEWAY PERMIT HAS BEEN APPROVED BY THE PRECINCT COMMISSIONER OF ATASCOSA COUNTY OR HIS OR HER DESIGNATED REPRESENTATIVE, OR TEXAS DEPARTMENT OF TRANSPORTATION FOR DRIVEWAYS ENTERING ONTO STATE ROADS, AND THE DRIVEWAY SHALL BE DESIGNED AND CONSTRUCTED IN ACCORDANCE WITH THE ATASCOSA COUNTY ROAD STANDARDS OR TxDOT STANDARDS, AS APPLICABLE.
- ADDITIONAL RECORDED EASEMENTS AND RESERVATIONS FOR THE LOTS ESTABLISHED BY THIS SUBDIVISION PLAT ARE LISTED IN THE ATASCOSA COUNTY CLERK'S FILES NO. 233368.

LOT SUMMARY TABLE

LOT SIZE	NO. OF LOTS	WATER WELL	COLLECTIVE SEWER	OSSF
< 2.5 AC	2			2
2.5-10 AC				
> 10 AC				
TOTAL	2			2

PLAT INCLUDES 0 LF STREET

SURVEYOR NOTES:

- THE BASIS OF BEARING FOR THIS PLAT IS GRID NORTH, TEXAS STATE PLANE COORDINATE SYSTEM, NAD 83 (2011), SOUTH CENTRAL ZONE.
- 5/8" STEEL ROD MONUMENT WITH CAP STAMPED "RAKOWITZ ENGINEERING AND SURVEYING" SET AT ALL CORNERS UNLESS OTHERWISE NOTED.

SETBACK NOTES:

BUILDING SETBACKS TO BE AS FOLLOWS FOR ALL LOTS:
 20' FRONT (ROADWAY SIDE)
 20' BACK
 20' SIDE

FLOODPLAIN NOTE:

THIS PLAT IS NOT WITHIN FEMA FLOODPLAIN PER FEMA FIRM MAP NUMBER 48013C0450C EFFECTIVE NOVEMBER 4, 2010.

TxDOT NOTES:

- FOR COMMERCIAL DEVELOPMENT DIRECTLY ADJACENT TO STATE RIGHT-OF-WAY, THE DEVELOPER SHALL BE RESPONSIBLE FOR ADEQUATE SET-BACK AND/OR SOUND ABATEMENT MEASURES FOR FUTURE NOISE MITIGATION.
- IF SIDEWALKS ARE REQUIRED BY APPROPRIATE CITY ORDINANCE, A SIDEWALK PERMIT MUST BE APPROVED BY TxDOT PRIOR TO CONSTRUCTION WITHIN STATE RIGHT-OF-WAY. LOCATIONS OF SIDEWALKS WITHIN STATE RIGHT-OF-WAY SHALL BE DIRECTED BY TxDOT.
- TRACT #1 (LOT 1) HAS AN EXISTING COMMERCIAL DRIVEWAY WHICH WILL NOT BE RELOCATED OR ALTERED. TRACT #2 (LOT 2) WILL BE ALLOWED ONE (1) DRIVEWAY. DRIVEWAY LOCATION FOR TRACT #2 (LOT 2) TO BE DETERMINED BY TxDOT DURING THE PERMITTING PROCESS.
- DEVELOPER IS REQUIRED TO OBTAIN ALL MUNICIPAL APPROVALS REQUIRED BEFORE TxDOT PERMITTING WILL BE ISSUED.
- DEVELOPER IS RESPONSIBLE FOR ALL UTILITY LOCATES AND/OR ADJUSTMENTS.

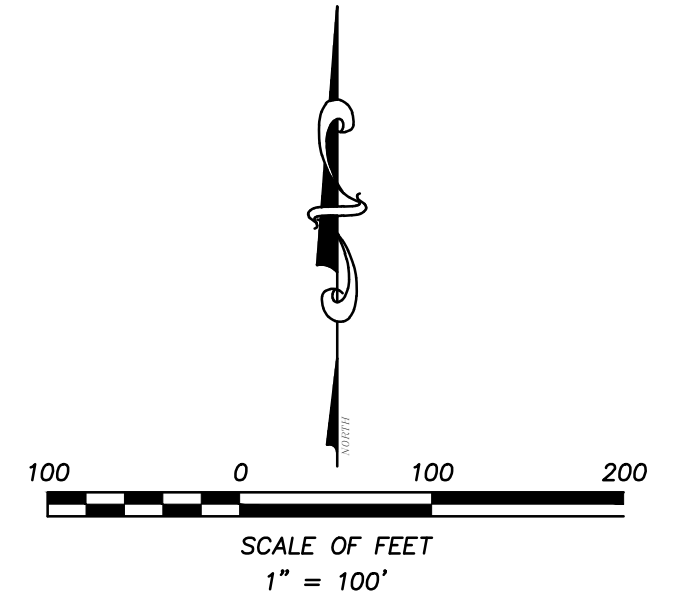

THE STATE OF TEXAS §
 COUNTY OF ATASCOSA §

THE OWNER OF THE LAND SHOWN ON THIS PLAT, IN PERSON OR THROUGH A DULY AUTHORIZED AGENT, DEDICATES THE USE OF THE PUBLIC, EXCEPT AREAS IDENTIFIED AS PRIVATE, FOREVER ALL STREETS, ALLEYS, PARKS, WATERCOURSES, DRAINS, EASEMENTS, AND PUBLIC PLACES THEREON SHOWN FOR THE PURPOSE AND CONSIDERATION THEREIN EXPRESSED. ADDITIONALLY, THE OWNERS AGREE TO EXTEND PUBLIC UTILITIES LISTED ON THIS PLAT ADJACENT TO EACH PLATTED LOT BEFORE SAID LOT IS SOLD.

OWNER: JOHN E HEILIGMAN
 P.O. BOX 117
 CHARLOTTE, TX 78011

STATE OF TEXAS §
 COUNTY OF ATASCOSA §

BEFORE ME, THE UNDERSIGNED AUTHORITY ON THIS DAY PERSONALLY APPEARED, KNOWN TO ME TO BE PERSON WHOSE NAME IS SUBSCRIBED TO THE FOREGOING INSTRUMENT AND ACKNOWLEDGED TO ME THAT HE EXECUTED THE SAME FOR THE PURPOSES AND CONSIDERATIONS GIVEN UNDER MY HAND AND SEAL OF OFFICE DATED THIS ____ DAY OF _____, 20__ A.D.

NOTARY PUBLIC

STATE OF TEXAS §
 COUNTY OF ATASCOSA §

THE OWNER OF THE LAND SHOWN ON THIS PLAT, IN PERSON OR THROUGH A DULY AUTHORIZED AGENT, DEDICATES THE USE OF THE PUBLIC, EXCEPT AREAS IDENTIFIED AS PRIVATE, FOREVER ALL STREETS, ALLEYS, PARKS, WATERCOURSES, DRAINS, EASEMENTS, AND PUBLIC PLACES THEREON SHOWN FOR THE PURPOSE AND CONSIDERATION THEREIN EXPRESSED. ADDITIONALLY, THE OWNERS AGREE TO EXTEND PUBLIC UTILITIES LISTED ON THIS PLAT ADJACENT TO EACH PLATTED LOT BEFORE SAID LOT IS SOLD.

OWNER: WANDA HEILIGMAN
 P.O. BOX 117
 CHARLOTTE, TX 78011

STATE OF TEXAS §
 COUNTY OF ATASCOSA §

BEFORE ME, THE UNDERSIGNED AUTHORITY ON THIS DAY PERSONALLY APPEARED, KNOWN TO ME TO BE PERSON WHOSE NAME IS SUBSCRIBED TO THE FOREGOING INSTRUMENT AND ACKNOWLEDGED TO ME THAT HE EXECUTED THE SAME FOR THE PURPOSES AND CONSIDERATIONS GIVEN UNDER MY HAND AND SEAL OF OFFICE DATED THIS ____ DAY OF _____, 20__ A.D.

NOTARY PUBLIC

CERTIFICATE OF THE PRECINCT COMMISSIONER

I, THE UNDERSIGNED COMMISSIONER IN THE PRECINCT IN WHICH THE LAND SUBDIVIDED ACCORDING TO THE PLAT TO WHICH THIS CERTIFICATE IS PRESENTED, HEREBY CERTIFY THAT I HAVE REVIEWED THE SAID PLAT AND THAT ALL REQUIREMENTS OF ATASCOSA COUNTY FOR THE PRESENTATION OF THE PLAT FOR FINAL APPROVAL HAVE BEEN FULLY MET TO THE BEST OF MY KNOWLEDGE AND BELIEF.

COMMISSIONER PRECINCT 3

CERTIFICATE OF FINAL APPROVAL

APPROVED BY THE COMMISSIONERS COURT OF ATASCOSA COUNTY, TEXAS, THIS ____ DAY OF _____, 20__ A.D.

ATASCOSA COUNTY JUDGE

COMMISSIONER PRECINCT 1

COMMISSIONER PRECINCT 2

COMMISSIONER PRECINCT 3

COMMISSIONER PRECINCT 4

CERTIFICATE OF COUNTY ATTORNEY

ALL REQUIREMENTS OF THE SUBDIVISION ORDER CURRENTLY IN EFFECT HAVE BEEN MET ACCORDING TO MY BEST KNOWLEDGE AND BELIEF, AND THIS PLAT IS APPROVED FOR FINAL SUBMISSION.

COUNTY ATTORNEY

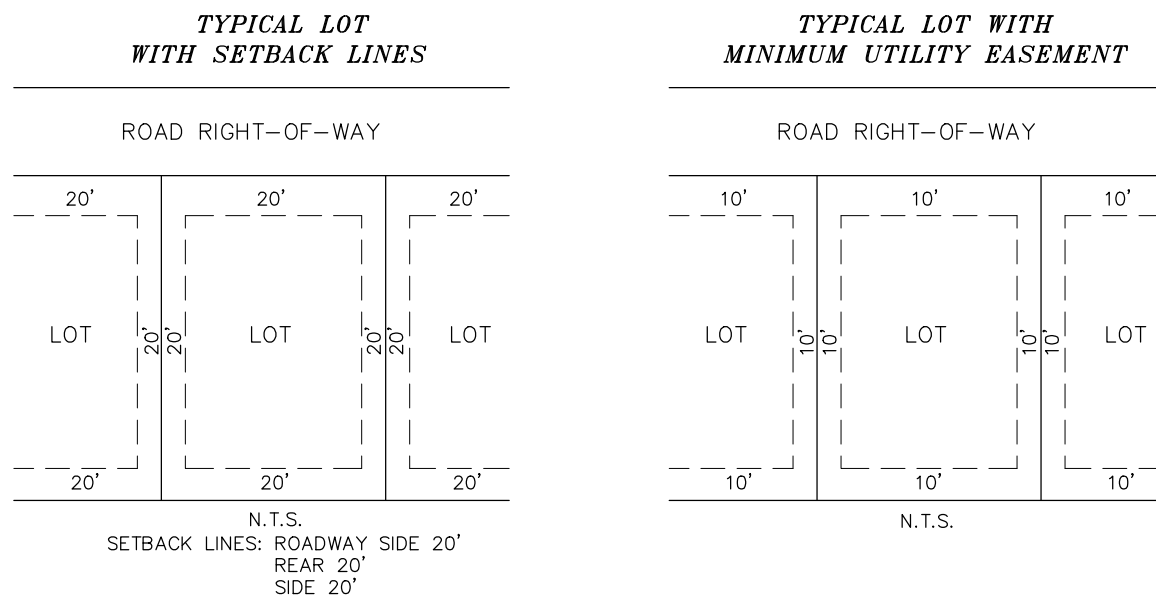

THE STATE OF TEXAS
 COUNTY OF ATASCOSA

KNOW ALL MEN BY THESE PRESENTS:

THAT I, WALT F. RAKOWITZ, BEING A REGISTERED PROFESSIONAL LAND SURVEYOR, REGISTERED IN THE STATE OF TEXAS, DO HEREBY CERTIFY THAT THIS PLAT WAS PREPARED FROM AN ACTUAL AND ACCURATE ON-GROUND SURVEY OF THE LAND SHOWN HEREON, AND THAT THE CORNER MONUMENTS SHOWN HEREON WERE PROPERLY PLACED UNDER MY PERSONAL SUPERVISION, IN ACCORDANCE WITH THE SUBDIVISION REGULATIONS OF ATASCOSA COUNTY, TEXAS.

PRELIMINARY

WALT F. RAKOWITZ
 REGISTERED PROFESSIONAL LAND SURVEYOR
 NO. 6435, STATE OF TEXAS
 515 W. OAKLAWN STE. A
 PLEASANTON, TEXAS 78064

THE STATE OF TEXAS
 COUNTY OF ATASCOSA

I, STEPHEN G. LASKOWSKI, DO HEREBY CERTIFY THAT THE INFORMATION CONTAINED ON THIS PLAT PREPARED BY ME, DOES TO THE BEST OF MY KNOWLEDGE ACCURATELY REFLECT THE GENERAL LOCATION (OR ABSENCE) OF ALL STREAMS, RIVERS, PONDS, LAKES, OTHER WATER FEATURES OR ANY SENSITIVE FEATURES AND COMPLIES WITH THE SUBDIVISION AND FLOODPLAIN MANAGEMENT ORDINANCES ADOPTED BY ATASCOSA COUNTY, TEXAS.

PRELIMINARY

STEPHEN G. LASKOWSKI
 LICENSED PROFESSIONAL ENGINEER
 NO. 133002, STATE OF TEXAS
 515 W. OAKLAWN STE. A
 PLEASANTON, TEXAS 78064



ENGINEER & SURVEYOR:
 RAKOWITZ ENGINEERING AND SURVEYING
 515 W OAKLAWN, SUITE A
 PLEASANTON, TX 78064
 (830) 281-4060

OWNER:
 JOHN E & WANDA HEILIGMAN
 P.O. BOX 396
 CHARLOTTE, TX 78011
 (830) 570-7103

PLAT OF MTW SERVICES SUBDIVISION
 ESTABLISHING LOTS 1 & 2, BEING A TOTAL OF 13.51 ACRES, BEING ALL OF A 13.51 ACRE TRACT OF LAND, DESCRIBED IN AN INSTRUMENT, RECORDED IN CLERK'S FILE NO. 233368, OFFICIAL PUBLIC RECORDS, ATASCOSA COUNTY, TEXAS, AND ALSO LYING IN THE VINCENT BLUNTZER SURVEY NO. 4, ABSTRACT NO. 1264, ATASCOSA COUNTY, TEXAS.

NO.	REVISION	DATE	BY
1	PLAT CREATED	06/25/25	SQL