



City of Billings
RIGHT-OF-WAY ACTIVITY
PERMIT

Please check the type of activity you are applying for:

Parade Run/Walk/Procession Street/Alley Closure Block Party

Submit this application with attachments to either the: Public Works office, 2224 Montana Ave., Billings, MT 59101 or Downtown Billings office, 2815 2nd Ave North, Billings, MT 59101. Application packet should be turned in at least 60 days prior to the date of the proposed event for approval.

PERSON MAKING APPLICATION Don Linder

ORGANIZATION MAKING APPLICATION Inland Truck Parts Co.

PHONE 406-248-7349

ADDRESS 115 Nth 16th Street Billings 59101

EMAIL ADDRESS donl@inlandtruck.com

APPROXIMATE TIME EVENT WILL:

Assemble 9:00 Am Start 11:00 am Disband 6:00 pm

DATE OF EVENT Sept. 16th

PURPOSE/DESCRIPTION OF EVENT: (Description and detail of the event.)

off Road Truck Show & BBQ

EVENT ROUTE DESIRED (IF APPLICABLE): (Please attach map.)

Close N. 16th Street between 1st Aven. and 2nd Ave N.

BLOCK PARTY STREET LOCATION (IF APPLICABLE):

N.A.

CLEAN UP IMPLEMENTATION: (Company contracted or services you will provide)

F.T.P.

CERTIFICATION OF INSURANCE WHICH MUST SHOW: (1) The limits of liability coverage for the period of this agreement as a minimum of \$750,000 per claim/ \$1.5 million per occurrence general liability, and (2) the City of Billings named on the Certificate of Insurance as the additional insured. (Refer to the sample insurance copy. Please note a certificate of insurance *is not required* for Block Parties)

NOTICE: ANY MARKINGS (NO PAINT ALLOWED) TO BE PLACED ON PUBLIC RIGHT-OF-WAY MUST BE APPROVED BY THE CITY TRAFFIC/ENGINEERING DEPARTMENT PRIOR TO PLACEMENT, BE ENVIRONMENTALLY SAFE, AND NOT CONFLICT WITH EXISTING MARKINGS.

FOR DOWNTOWN EVENTS: YOU OR THE ORGANIZATION YOU REPRESENT MUST "ASSIGN" THE FIRST TWO BLOCKS OF THE DOWNTOWN EVENT ROUTE FOR NO PARKING TWO HOURS PRIOR TO YOUR EVENT USING THE ROUTE SIGNS PROVIDED BY THE CITY. IT IS YOUR RESPONSIBILITY TO PROVIDE THE APPROPRIATE BARRICADES FOR THE STREET CLOSURE.

IF USING THE ESTABLISHED EVENT ROUTE, THE CITY WILL PROVIDE TWO POLICE OFFICERS WITH VEHICLES TO START THE EVENT, AND A STREET SWEEPER, IF NECESSARY, TO FOLLOW THE EVENT.

COORDINATOR OF EVENTS AT WHICH ALCOHOL WILL BE CONSUMED IN PUBLIC RIGHT-OF WAY ARE REQUIRED TO OBTAIN AN OPEN-CONTAINER PERMIT FROM THE POLICE DEPARTMENT

UPON SIGNING OF THIS APPLICATION, THE APPLICANT AGREES NOT TO VIOLATE ANY STATE OR CITY CODES IN THE PRESENTATION OF THE REQUESTED SPECIAL ACTIVITY.

In consideration for permission to conduct its activity as requested, applicant agrees to indemnify, defend and hold harmless the City of Billings, its officers, agents, employees and volunteers from damage to property and for injury to or death of any person and from all liability claims, actions or judgments which may arise from the activity.

Applicants also agree to obtain valid "save or hold harmless agreements" from all participants in its activity, protecting the City of Billings from all losses arising out of its activity, including damages of any kind or nature.

APPLICANT SIGNATURE  DATE 6-8-11
APPLICATION APPROVED _____ DATE _____
APPLICATION DENIED _____ DATE _____

ADDITIONAL RESTRICTIONS OR SPECIAL CONDITIONS: YES [] NO []
(IF YES, ATTACH COPY)

FOR CITY USE ONLY

FEE: \$100.00
PAID: _____
DATE: _____

- COPIES TO:**
CITY ADMINISTRATOR
DEPUTY CITY ADMINISTRATOR
POLICE CHIEF
FIRE CHIEF
FIRE MARSHALL
MET TRANSIT MANAGER
STREET/TRAFFIC SUPERINTENDANT
TRAFFIC ENGINEER
PRPL DIRECTOR
PARKING SUPERVISOR
CITY ATTORNEY

2nd Ave North

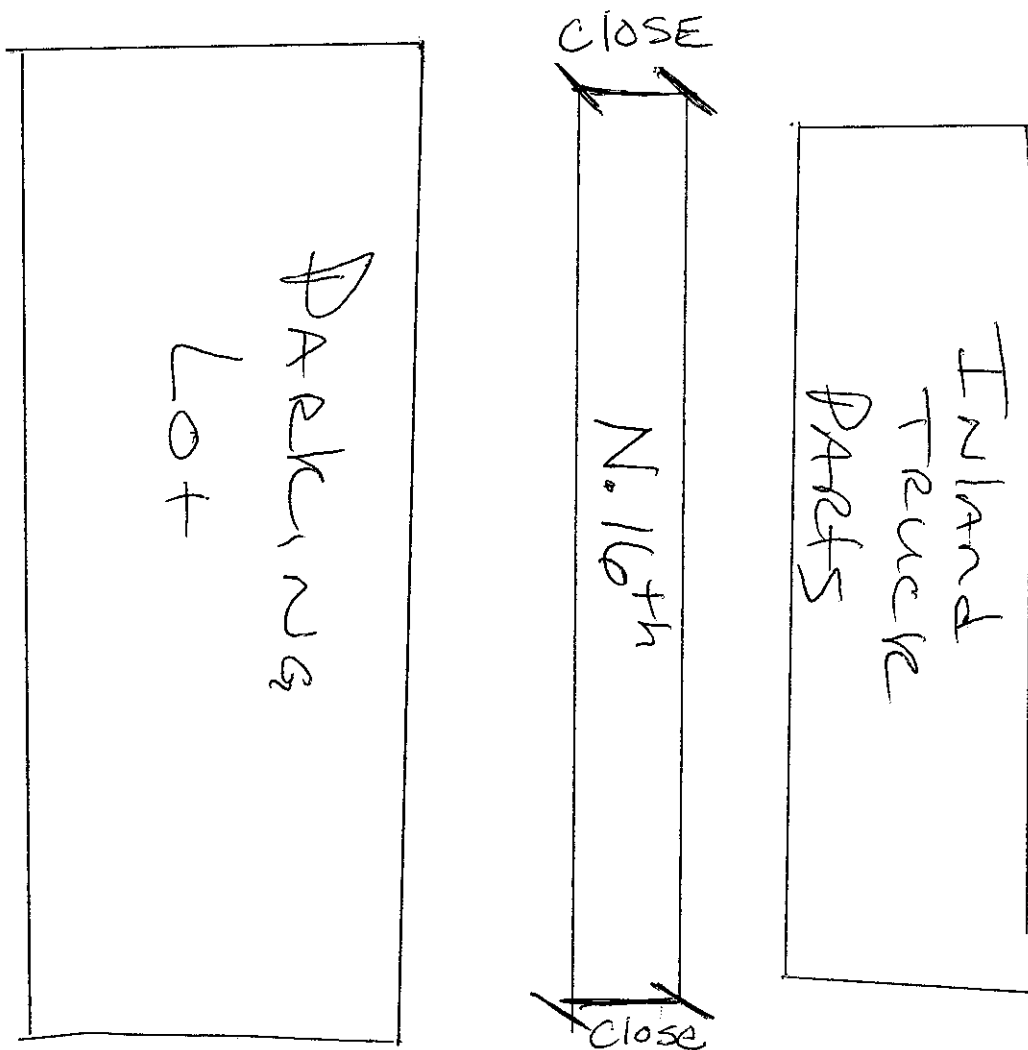

1st Ave North



CERTIFICATE OF LIABILITY INSURANCE

7/1/2012

DATE (MM/DD/YYYY)

8/9/2011

THIS CERTIFICATE IS ISSUED AS A MATTER OF INFORMATION ONLY AND CONFERS NO RIGHTS UPON THE CERTIFICATE HOLDER. THIS CERTIFICATE DOES NOT AFFIRMATIVELY OR NEGATIVELY AMEND, EXTEND OR ALTER THE COVERAGE AFFORDED BY THE POLICIES BELOW. THIS CERTIFICATE OF INSURANCE DOES NOT CONSTITUTE A CONTRACT BETWEEN THE ISSUING INSURER(S), AUTHORIZED REPRESENTATIVE OR PRODUCER, AND THE CERTIFICATE HOLDER.

IMPORTANT: If the certificate holder is an ADDITIONAL INSURED, the policy(ies) must be endorsed. If SUBROGATION IS WAIVED, subject to the terms and conditions of the policy, certain policies may require an endorsement. A statement on this certificate does not confer rights to the certificate holder in lieu of such endorsement(s).

PRODUCER Lockton Companies, LLC-1 Kansas City
444 W. 47th Street, Suite 900
Kansas City MO 64112-1906
(816) 960-9000

CONTACT NAME:		
PHONE (A/C, No, Ext):	FAX (A/C, No):	
E-MAIL ADDRESS:		
ADDRESS:		
INSURER(S) AFFORDING COVERAGE		NAIC #
INSURER A: St. Paul Travelers Companies		24767
INSURER B:		
INSURER C:		
INSURER D:		
INSURER E:		
INSURER F:		

INSURED 1007798 INLAND TRUCK PARTS COMPANY
ATTN: CHERYL FLOYD
4400 COLLEGE BLVD., SUITE 145
OVERLAND PARK KS 66211-2326

COVERAGES INLT01 IC CERTIFICATE NUMBER: 11377531 REVISION NUMBER: XXXXXXXX

THIS IS TO CERTIFY THAT THE POLICIES OF INSURANCE LISTED BELOW HAVE BEEN ISSUED TO THE INSURED NAMED ABOVE FOR THE POLICY PERIOD INDICATED. NOTWITHSTANDING ANY REQUIREMENT, TERM OR CONDITION OF ANY CONTRACT OR OTHER DOCUMENT WITH RESPECT TO WHICH THIS CERTIFICATE MAY BE ISSUED OR MAY PERTAIN, THE INSURANCE AFFORDED BY THE POLICIES DESCRIBED HEREIN IS SUBJECT TO ALL THE TERMS, EXCLUSIONS AND CONDITIONS OF SUCH POLICIES. LIMITS SHOWN MAY HAVE BEEN REDUCED BY PAID CLAIMS.

INSR LTR	TYPE OF INSURANCE	ADDL INSR	SUBR WVD	POLICY NUMBER	POLICY EFF (MM/DD/YYYY)	POLICY EXP (MM/DD/YYYY)	LIMITS
A	GENERAL LIABILITY <input checked="" type="checkbox"/> COMMERCIAL GENERAL LIABILITY <input type="checkbox"/> CLAIMS-MADE <input checked="" type="checkbox"/> OCCUR GENL AGGREGATE LIMIT APPLIES PER: <input type="checkbox"/> POLICY <input type="checkbox"/> PRO-JECT <input type="checkbox"/> LOC	Y	N	Y-630-283D0673	7/1/2011	7/1/2012	EACH OCCURRENCE \$ 1,000,000 DAMAGE TO RENTED PREMISES (Ea occurrence) \$ 100,000 MED EXP (Any one person) \$ 5,000 PERSONAL & ADV INJURY \$ 1,000,000 GENERAL AGGREGATE \$ 10,000,000 PRODUCTS - COMP/OP AGG \$ 2,000,000
A	AUTOMOBILE LIABILITY <input checked="" type="checkbox"/> ANY AUTO ALL OWNED AUTOS <input checked="" type="checkbox"/> HIRED AUTOS <input checked="" type="checkbox"/> GKLL-\$1,000,000 <input type="checkbox"/> SCHEDULED AUTOS NON-OWNED AUTOS	N	N	Y-810-283D0673	7/1/2011	7/1/2012	COMBINED SINGLE LIMIT (Ea accident) \$ 1,000,000 BODILY INJURY (Per person) \$ XXXXXXXX BODILY INJURY (Per accident) \$ XXXXXXXX PROPERTY DAMAGE (Per accident) \$ XXXXXXXX
A	<input checked="" type="checkbox"/> UMBRELLA LIAB <input checked="" type="checkbox"/> OCCUR <input type="checkbox"/> EXCESS LIAB <input type="checkbox"/> CLAIMS-MADE DED RETENTION \$	Y	N	YSM-CUP-283D0673	7/1/2011	7/1/2012	EACH OCCURRENCE \$ 5,000,000 AGGREGATE \$ 5,000,000 \$ XXXXXXXX
A	WORKERS COMPENSATION AND EMPLOYERS' LIABILITY ANY PROPRIETOR/PARTNER/EXECUTIVE OFFICER/MEMBER EXCLUDED? (Mandatory in NH) If yes, describe under DESCRIPTION OF OPERATIONS below	Y/N	N/A	YN-UB-283D0673	7/1/2011	7/1/2012	<input checked="" type="checkbox"/> WC STATUTORY LIMITS <input type="checkbox"/> OTHER E.L. EACH ACCIDENT \$ 500,000 E.L. DISEASE - EA EMPLOYEE \$ 500,000 E.L. DISEASE - POLICY LIMIT \$ 500,000
A	PROPERTY	N	N	Y-630-283D0673	7/1/2011	7/1/2012	BUILDING \$56,810,665; BPP-\$32,092,953 DED \$25K RENTED EQUIPMENT INCLUDED

DESCRIPTION OF OPERATIONS / LOCATIONS / VEHICLES (Attach ACORD 101, Additional Remarks Schedule, if more space is required)
THE CITY OF BILLINGS, MONTANA IS ADDITIONAL INSURED AS REQUIRED BY CONTRACT SUBJECT TO POLICY TERMS AND CONDITIONS.

CERTIFICATE HOLDER

CANCELLATION

11377531
CITY OF BILLINGS, MONTANA

SHOULD ANY OF THE ABOVE DESCRIBED POLICIES BE CANCELLED BEFORE THE EXPIRATION DATE THEREOF, NOTICE WILL BE DELIVERED IN ACCORDANCE WITH THE POLICY PROVISIONS.

AUTHORIZED REPRESENTATIVE