

November 11, 2011

Magic City Blues (MCB) is a three-day annual music festival planned for the second weekend in August each year. The event takes place in the Billings, Montana "Historic District" and in South Park. This year, 2012, will be the eleventh annual.

It will be a combination of local, national and international musical acts appearing on two outdoor stages downtown and one stage in South Park.

To accommodate the outdoor stages and provide a safe gathering place for the people attending MCB, Montana Avenue will need to be closed to all vehicle traffic. Affected blocks will be 2500-2300 block of Montana Avenue. Closures will be from 9am Friday, August 10 to 12 noon Sunday, August 12, 2012. These are the same festival closure times approved by council for the past eight years.

Billings Construction Supply will handle traffic closure and diversion.

Our marketing and advertising is very strong and will make people aware of the event on Montana Ave., the dates, and the resulting street closure. In addition to our marketing campaign, major media outlets in Billings will cover the festival as a story to further the awareness. It is the intention of the organizers to make the 2012 festival as smooth and complaint free as years past to ensure continued city support for future festivals.

Traffic diversion on Montana Avenue will begin at N 29<sup>th</sup> with two signs, one in the north and one in the south lane – MONTANA AVE CLOSED AT N 25<sup>th</sup> ST. This will be repeated at N 28<sup>th</sup> and N 27<sup>th</sup>. Through traffic can divert to either 2<sup>nd</sup> Ave N or 1<sup>st</sup> Ave. S at each intersection up to 25<sup>th</sup>, where the barricade will divert remaining cars to 2<sup>nd</sup> Ave. North. Signs will include electronic arrows, cones and road closed ahead signs.

The main outdoor stage will be erected on Montana Avenue, just like last year. Having the stage in this spot provides excellent views and acoustics for the audience, which will be gathering in front of the stage and in the parking lot between the Rex and Venture Theater. This space can comfortably and safely hold the 3500 – 5000 people we expect each night.

Billings Police Association and Starplex Crowd Management Services will again act as the primary agents providing security.

Event liability insurance will be acquired at the required levels. (see sample attached from last year) As it has on all previous festivals, the special event policy cannot be issued until 30 days prior to festival. A certificate listing the City of Billings as an additional insured will be issued and mailed to the city once the insurance is bound.

The night shows will remain adult-oriented with no one under 18 allowed into the site after 4pm each day. The Rex and Carlin will provide staff and license for alcohol service within the perimeter. A chain link fence perimeter will be erected with gate entries at 25<sup>th</sup>, 23<sup>rd</sup> and the north end of the Rex parking lot on 24<sup>th</sup>.

Our intention, in addition to presenting more Live Music, is to draw people downtown and develop a broad festival atmosphere over the weekend. Magic City Blues at South Park was a big success last year and we intend to do it again this year. It is our goal to make Magic City Blues a national destination event and attract thousands of music fans from out of town each year. The resulting commerce provides a big boost to city hotels, restaurants and merchants and further builds the live music culture in Billings.

We are very proud of our involvement in providing community entertainment and donating \$40,000 to Public School music programs over the years, both through the festival and also through Perfect Pitch, a 501(c)3 non-profit. This relationship with the public schools is a foundation of our business practices and we will continue to work to increase opportunities and funding for the students.

The Magic City Blues festival has become a signature event for the City of Billings and fans come from all over the city, state and country to enjoy the hospitality and great music. We have worked hard to build the festival in a responsible manner and have gone to great lengths to develop a very good reputation with both the people who attend and the businesses we impact.

The objective of this proposal is to obtain an event permit and permission to close Montana Avenue for the festival. Once this is accomplished, the festival organizers can proceed with obtaining sponsorships, booking talent and all other logistical challenges associated with the event.

All other issues needing resolution will be addressed as is deemed necessary by governing authorities.

Respectfully submitted by:

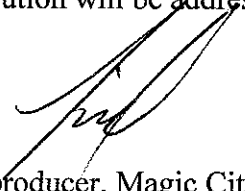
  
Tim Goodridge – Executive producer, Magic City Blues  
Mike Schaer – partner, Magic City Blues  
Gene Burgad – partner, Magic City Blues

[tgoodridge3@bresnan.net](mailto:tgoodridge3@bresnan.net)

670-2329

2990 Lohof Dr. Billings, MT 59102



City of Billings  
RIGHT - OF - WAY ACTIVITY  
PERMIT

Please check the type of activity you are applying for:

Parade  Run/Walk/Procession  Street/Alley Closure  Block Party

Submit this application with attachments to either: The Public Works office - 2224 Montana Ave. or Downtown Billings office - 2815 2<sup>nd</sup> Ave. N. (both - Billings, MT 59101) Application packet should be turned in at least 60 days prior to the date of the proposed event for approval.

PERSON MAKING APPLICATION Tim Goodridge  
ORGANIZATION MAKING APPLICATION City Blue Productions LLP  
ADDRESS 2990 Lokot Dr. City Billings State MT Zip 59102  
EMAIL ADDRESS tgoodridge3@brcsnan.net

APPROXIMATE TIME EVENT WILL:

Assemble \_\_\_\_\_ Start 6pm Disband 1am

DATE OF EVENT 8/10, 11, 12

PURPOSE OF EVENT: (Description and detail of plans)

Music Festival - 11th Annual blues festival  
2 nights of music on Montana Ave with 2 stages  
and 12 bands.

EVENT ROUTE DESIRED (IF APPLICABLE) - Please attach map

2300-2500 block of Montana Ave.

BLOCK PARTY STREET LOCATION (IF APPLICABLE)

CLEAN UP IMPLEMENTATION: (Company contracted or services you will provide)





# CERTIFICATE OF LIABILITY INSURANCE

DATE (MM/DD/YYYY)  
08/08/2011

THIS CERTIFICATE IS ISSUED AS A MATTER OF INFORMATION ONLY AND CONFERS NO RIGHTS UPON THE CERTIFICATE HOLDER. THIS CERTIFICATE DOES NOT AFFIRMATIVELY OR NEGATIVELY AMEND, EXTEND OR ALTER THE COVERAGE AFFORDED BY THE POLICIES BELOW. THIS CERTIFICATE OF INSURANCE DOES NOT CONSTITUTE A CONTRACT BETWEEN THE ISSUING INSURER(S), AUTHORIZED REPRESENTATIVE OR PRODUCER, AND THE CERTIFICATE HOLDER.

**IMPORTANT:** If the certificate holder is an ADDITIONAL INSURED, the policy(ies) must be endorsed. If SUBROGATION IS WAIVED, subject to the terms and conditions of the policy, certain policies may require an endorsement. A statement on this certificate does not confer rights to the certificate holder in lieu of such endorsement(s).

<b>PRODUCER</b> L.A. Xcess Insurance Brokers, Inc. 10474 Santa Monica Blvd #306 Los Angeles, CA 90025  Phone No. (310) 405-0001      Fax No. (310) 405-0002		<b>CONTACT NAME:</b> Aaron Ma <b>PHONE (A/C, No, Ext):</b> (818) 623-5415 <b>FAX (A/C, No):</b> (818) 623-5515 <b>E-MAIL ADDRESS:</b> ama@laxcess.com <b>PRODUCER CUSTOMER ID #:</b>	
<b>INSURED</b> City Blue Productions, LLP 2990 Lohof Drive Billings, MT 59102  Phone No. (406) 670-2329      Fax No. (406) 252-5279		<b>INSURER(S) AFFORDING COVERAGE</b> <b>NAIC #</b> <b>INSURER A:</b> STP - St. Paul Fire and Marine Ins. Co.      24767 <b>INSURER B:</b> <b>INSURER C:</b> <b>INSURER D:</b> <b>INSURER E:</b> <b>INSURER F:</b>	

**COVERAGES**      **CERTIFICATE NUMBER:**      **REVISION NUMBER:**

THIS IS TO CERTIFY THAT THE POLICIES OF INSURANCE LISTED BELOW HAVE BEEN ISSUED TO THE INSURED NAMED ABOVE FOR THE POLICY PERIOD INDICATED. NOTWITHSTANDING ANY REQUIREMENT, TERM OR CONDITION OF ANY CONTRACT OR OTHER DOCUMENT WITH RESPECT TO WHICH THIS CERTIFICATE MAY BE ISSUED OR MAY PERTAIN, THE INSURANCE AFFORDED BY THE POLICIES DESCRIBED HEREIN IS SUBJECT TO ALL THE TERMS, EXCLUSIONS AND CONDITIONS OF SUCH POLICIES. LIMITS SHOWN MAY HAVE BEEN REDUCED BY PAID CLAIMS.

INSR LTR	TYPE OF INSURANCE	ADDL SUBR INSR / W/D	POLICY NUMBER	POLICY EFF (MM/DD/YYYY)	POLICY EXP (MM/DD/YYYY)	LIMITS
STP	GENERAL LIABILITY		EW06121398	08/12/2011	08/14/2011	EACH OCCURRENCE \$ 1,000,000 DAMAGE TO RENTED PREMISES (Ea occurrence) \$ 50,000 MED EXP (Any one person) \$ Excluded PERSONAL & ADV INJURY \$ 1,000,000 GENERAL AGGREGATE \$ 2,000,000 PRODUCTS - COMP/OP AGG \$ 1,000,000
	<input checked="" type="checkbox"/> COMMERCIAL GENERAL LIABILITY					
	<input type="checkbox"/> CLAIMS-MADE <input checked="" type="checkbox"/> OCCUR					
	<input type="checkbox"/> LIQUOR LIABILITY EXCLUDED					
	GEN'L AGGREGATE LIMIT APPLIES PER:					
	<input type="checkbox"/> POLICY <input type="checkbox"/> PRO-JECT <input type="checkbox"/> LOC					
	<b>AUTOMOBILE LIABILITY</b>					COMBINED SINGLE LIMIT (Ea accident) \$ BODILY INJURY (Per person) \$ BODILY INJURY (Per accident) \$ PROPERTY DAMAGE (Per accident) \$
	<input type="checkbox"/> ANY AUTO					
	<input type="checkbox"/> ALL OWNED AUTOS					
	<input type="checkbox"/> SCHEDULED AUTOS					
	<input type="checkbox"/> HIRED AUTOS					
	<input type="checkbox"/> NON-OWNED AUTOS					
STP	UMBRELLA LIAB	<input checked="" type="checkbox"/> OCCUR	EX06103650	08/12/2011	08/14/2011	EACH OCCURRENCE \$ 1,000,000 AGGREGATE \$ 1,000,000
	<input checked="" type="checkbox"/> EXCESS LIAB	<input type="checkbox"/> CLAIMS-MADE				
	<input type="checkbox"/> DEDUCTIBLE					
	RETENTION \$					
	WORKERS COMPENSATION AND EMPLOYERS' LIABILITY	<input type="checkbox"/> Y/N				WC STATU-TORY LIMITS      OTH-ER
	ANY PROPRIETOR/PARTNER/EXECUTIVE OFFICER/MEMBER EXCLUDED? (Mandatory in NH)	<input type="checkbox"/> N/A				E.L. EACH ACCIDENT \$ E.L. DISEASE - EA EMPLOYEE \$ E.L. DISEASE - POLICY LIMIT \$
	If yes, describe under DESCRIPTION OF OPERATIONS below					

*Sample*  
*2011 Insurance*  
*2012 will be the same*

DESCRIPTION OF OPERATIONS / LOCATIONS / VEHICLES (Attach ACORD 101, Additional Remarks Schedule, if more space is required) Coverage Location: United States & Canada  
Event:

The Certificate holder is included as Additional Insured, but only as respects to claims arising out of the negligence of the Named Insured. All coverages expire at 12:01 a.m. Standard Time.

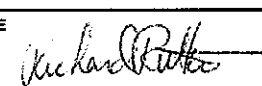
<b>CERTIFICATE HOLDER</b> City of Billings ATTN: Engineering Dept. 2224 Montana Avenue Billings, MT 59101 United States Of America  Phone No.      Fax No. (406) 237-6291	<b>CANCELLATION</b> SHOULD ANY OF THE ABOVE DESCRIBED POLICIES BE CANCELLED BEFORE THE EXPIRATION DATE THEREOF, NOTICE WILL BE DELIVERED IN ACCORDANCE WITH THE POLICY PROVISIONS.  AUTHORIZED REPRESENTATIVE 
--	---

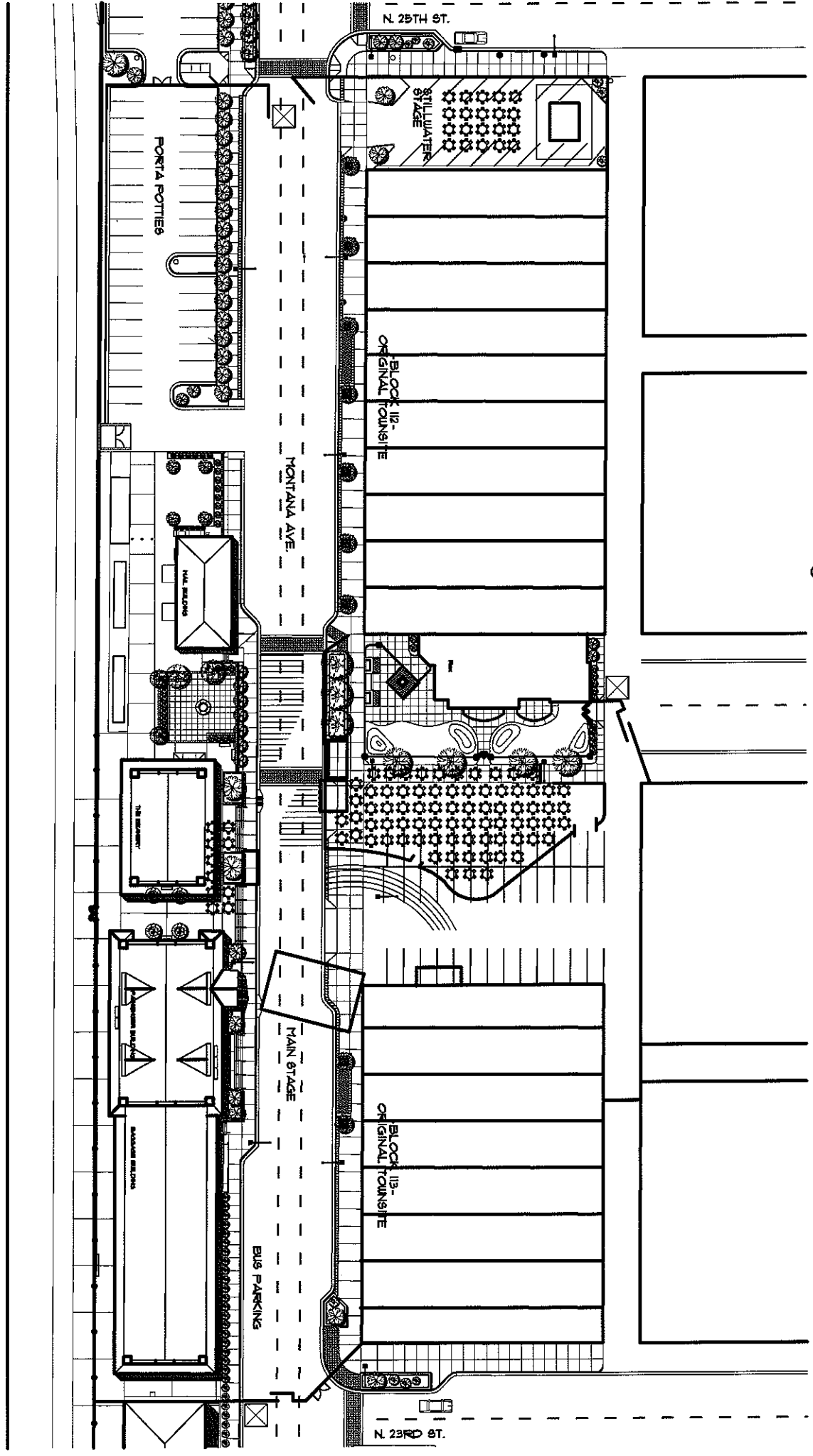

*Magic City Blues 2012.  
August 10, 11, 12.*

The eleventh annual Magic City Blues festival will be held in the 2500-2300 block of Montana Ave. on Friday and Saturday August 10 & 11, 2012. The street will be closed to vehicle traffic during those two days and part of Sunday to allow site set up and clean up. Pedestrian access to the two blocks will only be affected from 3 pm to 1 am on Friday and Saturday. At those times access will be restricted to ticket holders with admission only through the gates. During the rest of the day, people on foot can come and go as they please with no restrictions.

The festival will control all vendor activity in the street and on the sidewalk during the closure. Vendors will be required to abide by festival rules. Private businesses are encouraged to remain open during evening hours to take advantage of the concert crowds.

**I support the closure of Montana Avenue for Magic City Blues.**

Address	Property Owner	Business Name	Signature
2317 Montana Ave.	ROBERT WOOD	VENTURE THEATRE	Robert Wood
2310 } 2314 } 2404 } Montana Ave.	Computers Unlimited	Billings Depot	James Brown
2407 Montana Ave.	"	Computers Unlimited	Melba Scher
2417 Montana Ave.	"	Copstake	Melba Scher
2419 Montana Ave.	"	McCormick Cafe	Melba Scher
2501 Montana Ave.	"	Carlisle	Melba Scher
2503 Montana Ave.	"	Q Cuisine	Melba Scher
2511-2519	"	Ray Carlisle Building	Melba Scher

The eleventh annual Magic City Blues festival will be held in the 2500-2300 block of Montana Ave. on Friday and Saturday August 10 & 11, 2012. The street will be closed to vehicle traffic during those two days and part of Sunday to allow site set up and clean up. Pedestrian access to the two blocks will only be affected from 3 pm to 1am on Friday and Saturday. At those times access will be restricted to ticket holders with admission only through the gates. During the rest of the day, people on foot can come and go as they please with no restrictions.

The festival will control all vendor activity in the street and on the sidewalk during the closure. Vendors will be required to abide by festival rules. Private businesses are encouraged to remain open during evening hours to take advantage of the concert crowds.

**I support the closure of Montana Avenue for Magic City Blues.**

Address	Property Owner	Business Name	Signature
2600 Montana Ave.	CV	Carters	Mulo Selva
2600 Montana Ave.	CV	Railyard	Mulo Selva
2401 Montana Ave.	The Rex	The Rex	Gene Burgoyne
2411 Montana Ave.	OXFORD	ARTICLES	Michael Henry
2403 Montana Ave.	Rainbow Bar	Rainbow Bar	Frank Jackson
2413 Montana Ave.	Yellowstone Aster	Amy Nelson	Michelle
2301-2303 Montana Ave.	DB Squared LLC	Van Mando	Michelle