

## Attachment C Site Plan – The Vig Alehouse and Casino

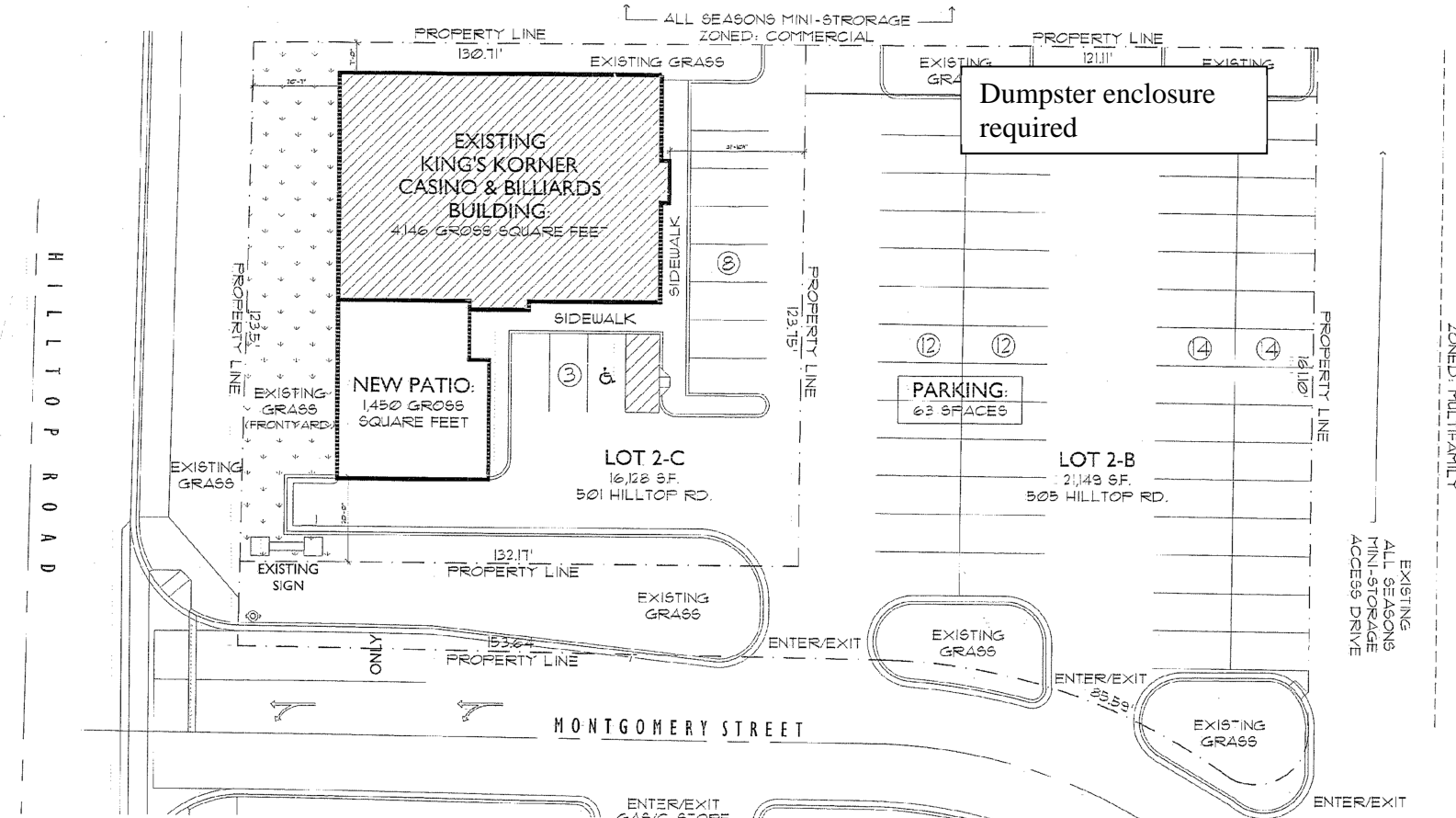

**PARKING CALCULATION:**  
 EXISTING BUILDING SQUARE FOOTAGE: 4146 @ 1 SPACE/100 SQFT. = 42 SPACES  
 PROPOSED PATIO SQUARE FOOTAGE: 1450 @ 1 SPACE/100 SQFT. = 15 SPACES  
 TOTAL PARKING SPACES REQUIRED: 57  
 PARKING SPACES PROVIDED: 63

**ZONED: HIGHWAY / COMMERCIAL**

**LANDSCAPING CRITERIA:**  
 TOTAL LOT AREA: 31,277 SQUARE FEET  
 PROPOSED BUILDING / LOT COVERAGE: 5,596 SQUARE FEET  
 REQ'D LANDSCAPE AREA: 31,277 - 5,596 = 25,681 X 1 = 25,681 SQ. FT.  
 FRONTYARD (HILLTOP RD.) 50% TOTAL LANDSCAPE REQ'D  
 FRONT YARD TOTAL: 12,840 SQUARE FEET

1-811 PROPOSED SITE PLAN WITH PATIO  
1"=10'-0"