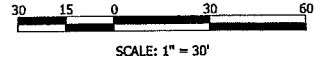

Exhibit 1A



SCALE  
 PLAN : 1" = 30'  
 PROFILE  
 HORIZ. : 1" = 30'  
 VERT. : 1" = 5'



CONTRACTOR TO POTHOLE VERIFY EX. UTILITY CROSSING DEPTHS PRIOR TO CONSTRUCTION OR A MIN. OF 100 FT PRIOR TO CROSSING THE UTILITY WITH THE NEW WATER MAIN OR SEWER MAIN AND NOTIFY THE ENGINEER OF ANY GRADE CONFLICTS.

NOTE:  
 -EXISTING UNDERGROUND INSTALLATIONS & PRIVATE UTILITIES SHOWN ARE INDICATED ACCORDING TO THE BEST INFORMATION AVAILABLE TO THE ENGINEER. THE ENGINEER DOES NOT GUARANTEE THE ACCURACY OF SUCH INFORMATION. SERVICE LINES (WATER, POWER, GAS, STORM, SEWER, TELEPHONE & TELEVISION) MAY NOT BE STRAIGHT LINES OR AS INDICATED ON THE PLANS. STATE LAW REQUIRES CONTRACTOR TO CALL ALL UTILITY COMPANIES BEFORE EXCAVATION FOR EXACT LOCATIONS.  
 -ALL IMPROVEMENTS SHALL BE PERFORMED IN ACCORDANCE WITH MONTANA PUBLIC WORKS STANDARD SPECIFICATIONS 6TH EDITION, APRIL, 2010, AND THE CITY OF BILLINGS STANDARD MODIFICATIONS, DATED FEBRUARY, 2015.  
 -UNLESS OTHERWISE SPECIFIED, ALL CONSTRUCTION LAYOUT AND STAKING SHALL BE PERFORMED UNDER THE RESPONSIBLE CHARGE OF A LAND SURVEYOR LICENSED IN THE STATE OF MONTANA AND BY A PARTY CHIEF OR ENGINEERING TECHNICIAN EXPERIENCED IN CONSTRUCTION LAYOUT AND STAKING TECHNIQUES AS ARE REQUIRED BY THE SPECIFIC TYPE OF WORK BEING PERFORMED.

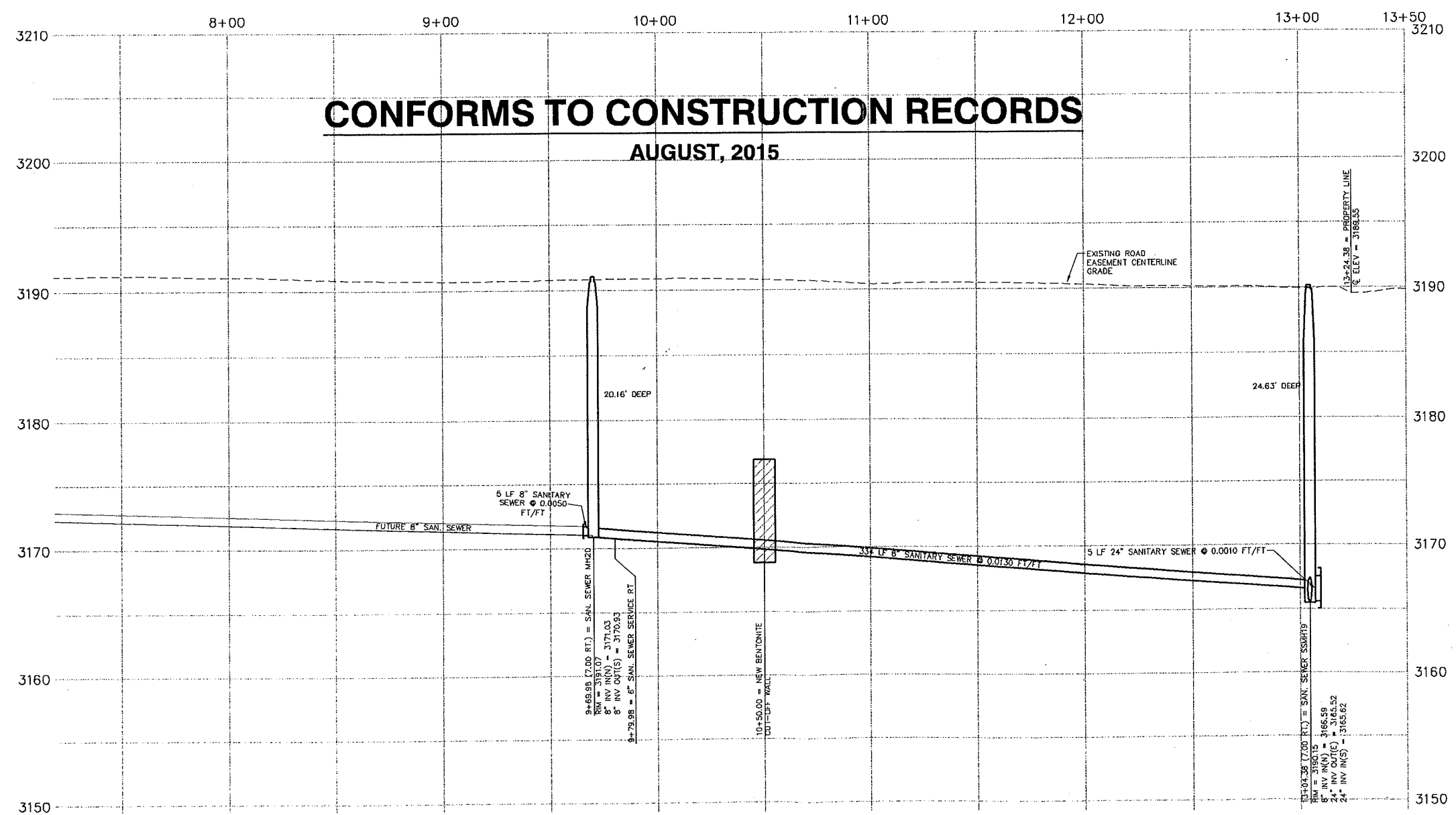

**CONFORMS TO CONSTRUCTION RECORDS**  
 AUGUST, 2015

**SANDERSON STEWART**  
 www.sandersonstewart.com

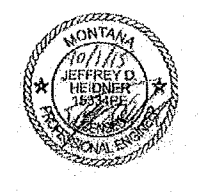

DATE:	10/01/2015
FILE:	14045_EAST_LANE_PNP.DWG
PROJECT NO:	14045
CAD:	BMB/CMK
QUALITY ASSURANCE:	DR 03/02/2015
REVISIONS	
DATE	DESCRIPTION
12/05/14	70% WATER DESIGN
02/19/15	90% UTILITY DESIGN
03/05/15	FOR BIDDING
04/01/15	ISSUED
04/22/15	CHANGE ORDER NO. 1
05/06/15	ISSUED FOR CONST

**CITY OF BILLINGS W.O. 14-13**  
 ELYSIAN AREA WATER AND SANITARY SEWER  
 EXTENSION PROJECT  
 BILLINGS, MONTANA  
 PLAN AND PROFILE EAST LANE STA. 8+00 TO 13+50