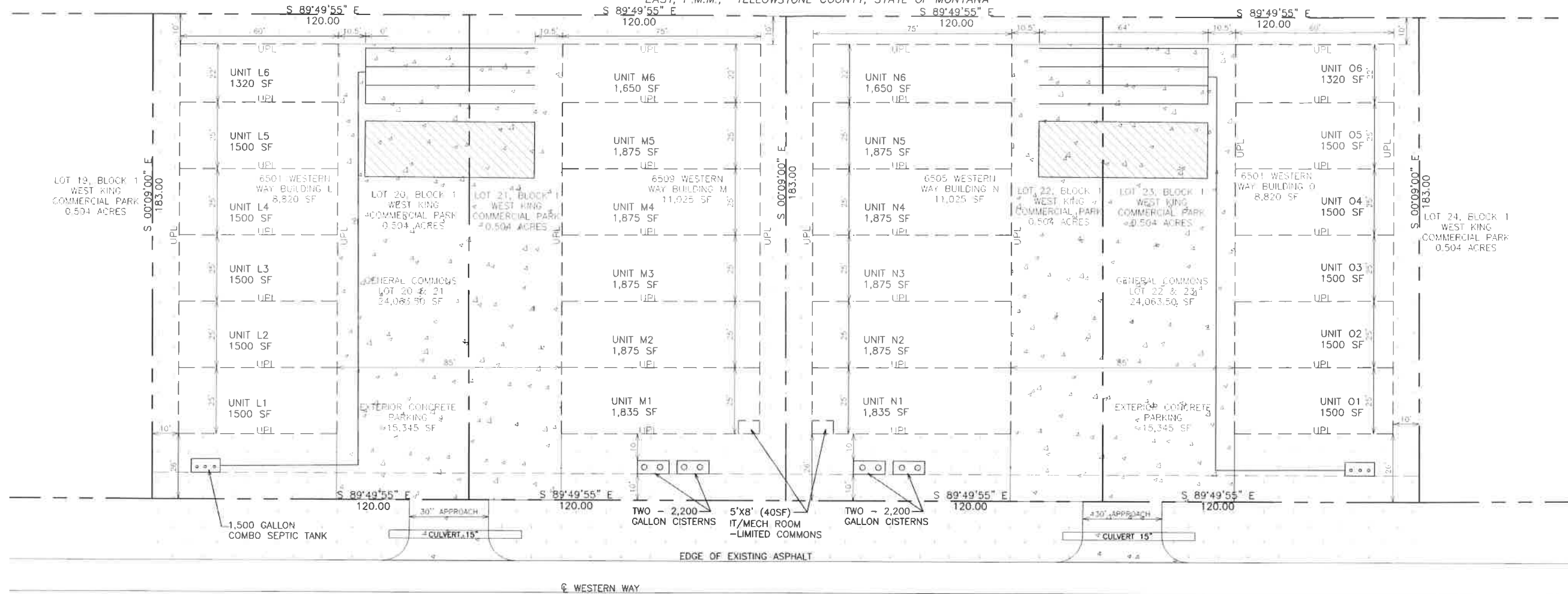

EXHIBIT "B"
PRELIMINARY SITE PLAN
NORTHFIELD WAREHOUSES

BEING LOTS 20, 21, 22 & 23, BLOCK 1 WEST KING COMMERCIAL PARK
 SUBDIVISION
 LOCATED IN THE SE 1/4 OF SECTION 7, TOWNSHIP 1 SOUTH, RANGE 25
 EAST, P.M.M., YELLOWSTONE COUNTY, STATE OF MONTANA



AREA CALCULATIONS FOR NORTHFIELD WAREHOUSES

6513 WESTERN WAY		
UNIT L1	1,500	SQ. FT.
UNIT L2	1,500	SQ. FT.
UNIT L3	1,500	SQ. FT.
UNIT L4	1,500	SQ. FT.
UNIT L5	1,500	SQ. FT.
UNIT L6	1,320	SQ. FT.
6509 WESTERN WAY		
UNIT M1	1,835	SQ. FT.
UNIT M2	1,875	SQ. FT.
UNIT M3	1,875	SQ. FT.
UNIT M4	1,875	SQ. FT.
UNIT M5	1,875	SQ. FT.
UNIT M6	1,650	SQ. FT.
6505 WESTERN WAY		
UNIT N1	1,835	SQ. FT.
UNIT N2	1,875	SQ. FT.
UNIT N3	1,875	SQ. FT.
UNIT N4	1,875	SQ. FT.
UNIT N5	1,875	SQ. FT.
UNIT N6	1,650	SQ. FT.
6501 WESTERN WAY		
UNIT O1	1,500	SQ. FT.
UNIT O2	1,500	SQ. FT.
UNIT O3	1,500	SQ. FT.
UNIT O4	1,500	SQ. FT.
UNIT O5	1,500	SQ. FT.
UNIT O6	1,320	SQ. FT.
LIMITED BUILDING COMMONS		
BUILDING L&M IT/MECH ROOM	40	SQ. FT.
BUILDING N&O IT/MECH ROOM	40	SQ. FT.
TOTAL BUILDING AREA	39,690	SQ. FT.
GENERAL COMMON AREA	48,127	SQ. FT.
TOTAL:	87,817	SQ. FT.

PZ-17-00128

CLERK AND RECORDER FILING INFORMATION

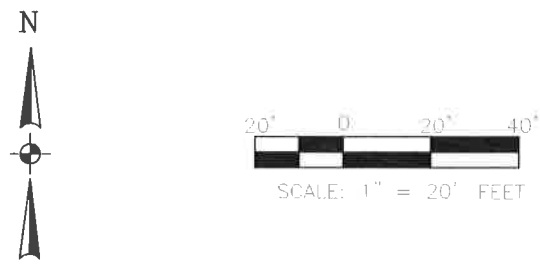

SUBDIVISION DETAILS:

- GROSS AREA: 2.016 ACRES
 - NET AREA: 2.016 ACRES
 - ROAD AREA: 0 ACRES (PRIVATE ACCESS)
 - NUMBER OF LOTS: 24
 - MAXIMUM LOT SIZE: 1,875 SQUARE FEET
 - MINIMUM LOT SIZE: 1,320 SQUARE FEET
 - PARK DEDICATION: 0 ACRES
 - EXISTING LAND USE: COMMERCIAL UNDEVELOPED
 - PROPOSED LAND USE: COMMERCIAL CONDO'S
- AREA IS NOT ZONED

LEGEND:

- PROPOSED CONCRETE
- PROPOSED 1-1/2" LANDSCAPE ROCK
- NOTE: LANDSCAPE ROCK ALONG ROAD TO BE PLACED SO TOP OF ROCK IS BELOW ROADWAY ELEV.
- LIMITED COMMON, GENERAL COMMON & UNIT PROPERTY LINES

VICINITY MAP

