

APPLICATION FORM

CITY SPECIAL REVIEW

Billings Special Review# _____ - Project # _____

The undersigned as owner(s) of the following described property hereby request a Special Review as outlined in the City of Billings Zoning Regulations.

Present Zoning: CONTROLLED INDUSTRIAL

Special Review Requested: CASINO / GAMING ESTABLISHMENT LOCATED WITHIN CONTROLLED INDUSTRIAL

TAX ID# 47-3161185 CITY ELECTION WARD # 5

Legal Description of Property: MIDLAND SUBDIVISION 4th FILING, S13, T01S, R25E, Block 2, Lot 1J

Address or General Location (If unknown, contact City Engineering): 869 S. 29th St. W

Size of Parcel (Area & Dimensions): 1.91 ACRES

Present Land-Use: RETAIL, MIXED USE

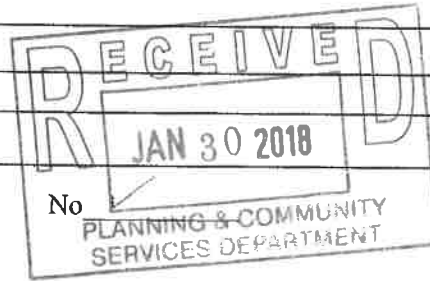

Covenants or Deed Restrictions on Property: Yes _____
If yes, please attach to application

*** Additional information may be required as determined by the Zoning Coordinator in order to fully evaluate the application.

Owner(s): 29th West Retail Partners LLC - Coramix Companies
(Recorded Owner)
2260 QUANT ROAD, Ste A, BILLINGS, MT 59102
(Address)
406-651-4300 SCORMPL@CORAMIXCOMPANIES.COM
(Phone Number) (email)

Agent(s): ROGER SINGH
(Name)
503 24th Street West Billings MT59102
(Address)
406-850-2691 rogerperhar@gmail.com
(Phone Number) (Email)

I understand that the filing fee accompanying this application is not refundable, that it pays for the cost of processing, and that the fee does not constitute a payment for a Special Review. Also, I attest that all the information presented herein is factual and correct.

Signature: [Signature] Date: 1/30/18
(Recorded Owner)

2000 GREAT ROAD, STE. C
 P.O. BOX 10477
 BILLYEAR, MA 01920
 OFFICE: 978.683.2343
 FAX: 978.683.2786
 www.designcollab.com

**COLLABORATIVE
 DESIGN
 ARCHITECTS
 INC.**



PROJECT: DOLLAR TREE
LOCATION: 806 S 29th ST WEST
BILLYEAR, MA
PREPARED FOR: CORNING CO.

DATE	REVISION
2/27/04	SCHEMATIC DEVELOPMENT
3/10/04	REVISED SITE
3/25/04	REVISED
4/15/04	REVISED
5/10/04	REVISED
6/10/04	REVISED
7/10/04	REVISED
8/10/04	REVISED
9/10/04	REVISED
10/10/04	REVISED
11/10/04	REVISED
12/10/04	REVISED
1/10/05	REVISED
2/10/05	REVISED
3/10/05	REVISED
4/10/05	REVISED
5/10/05	REVISED
6/10/05	REVISED
7/10/05	REVISED
8/10/05	REVISED
9/10/05	REVISED
10/10/05	REVISED
11/10/05	REVISED
12/10/05	REVISED
1/10/06	REVISED
2/10/06	REVISED
3/10/06	REVISED
4/10/06	REVISED
5/10/06	REVISED
6/10/06	REVISED
7/10/06	REVISED
8/10/06	REVISED
9/10/06	REVISED
10/10/06	REVISED
11/10/06	REVISED
12/10/06	REVISED
1/10/07	REVISED
2/10/07	REVISED
3/10/07	REVISED
4/10/07	REVISED
5/10/07	REVISED
6/10/07	REVISED
7/10/07	REVISED
8/10/07	REVISED
9/10/07	REVISED
10/10/07	REVISED
11/10/07	REVISED
12/10/07	REVISED
1/10/08	REVISED
2/10/08	REVISED
3/10/08	REVISED
4/10/08	REVISED
5/10/08	REVISED
6/10/08	REVISED
7/10/08	REVISED
8/10/08	REVISED
9/10/08	REVISED
10/10/08	REVISED
11/10/08	REVISED
12/10/08	REVISED
1/10/09	REVISED
2/10/09	REVISED
3/10/09	REVISED
4/10/09	REVISED
5/10/09	REVISED
6/10/09	REVISED
7/10/09	REVISED
8/10/09	REVISED
9/10/09	REVISED
10/10/09	REVISED
11/10/09	REVISED
12/10/09	REVISED
1/10/10	REVISED
2/10/10	REVISED
3/10/10	REVISED
4/10/10	REVISED
5/10/10	REVISED
6/10/10	REVISED
7/10/10	REVISED
8/10/10	REVISED
9/10/10	REVISED
10/10/10	REVISED
11/10/10	REVISED
12/10/10	REVISED
1/10/11	REVISED
2/10/11	REVISED
3/10/11	REVISED
4/10/11	REVISED
5/10/11	REVISED
6/10/11	REVISED
7/10/11	REVISED
8/10/11	REVISED
9/10/11	REVISED
10/10/11	REVISED
11/10/11	REVISED
12/10/11	REVISED
1/10/12	REVISED
2/10/12	REVISED
3/10/12	REVISED
4/10/12	REVISED
5/10/12	REVISED
6/10/12	REVISED
7/10/12	REVISED
8/10/12	REVISED
9/10/12	REVISED
10/10/12	REVISED
11/10/12	REVISED
12/10/12	REVISED
1/10/13	REVISED
2/10/13	REVISED
3/10/13	REVISED
4/10/13	REVISED
5/10/13	REVISED
6/10/13	REVISED
7/10/13	REVISED
8/10/13	REVISED
9/10/13	REVISED
10/10/13	REVISED
11/10/13	REVISED
12/10/13	REVISED
1/10/14	REVISED
2/10/14	REVISED
3/10/14	REVISED
4/10/14	REVISED
5/10/14	REVISED
6/10/14	REVISED
7/10/14	REVISED
8/10/14	REVISED
9/10/14	REVISED
10/10/14	REVISED
11/10/14	REVISED
12/10/14	REVISED
1/10/15	REVISED
2/10/15	REVISED
3/10/15	REVISED
4/10/15	REVISED
5/10/15	REVISED
6/10/15	REVISED
7/10/15	REVISED
8/10/15	REVISED
9/10/15	REVISED
10/10/15	REVISED
11/10/15	REVISED
12/10/15	REVISED
1/10/16	REVISED
2/10/16	REVISED
3/10/16	REVISED
4/10/16	REVISED
5/10/16	REVISED
6/10/16	REVISED
7/10/16	REVISED
8/10/16	REVISED
9/10/16	REVISED
10/10/16	REVISED
11/10/16	REVISED
12/10/16	REVISED
1/10/17	REVISED
2/10/17	REVISED
3/10/17	REVISED
4/10/17	REVISED
5/10/17	REVISED
6/10/17	REVISED
7/10/17	REVISED
8/10/17	REVISED
9/10/17	REVISED
10/10/17	REVISED
11/10/17	REVISED
12/10/17	REVISED
1/10/18	REVISED
2/10/18	REVISED
3/10/18	REVISED
4/10/18	REVISED
5/10/18	REVISED
6/10/18	REVISED
7/10/18	REVISED
8/10/18	REVISED
9/10/18	REVISED
10/10/18	REVISED
11/10/18	REVISED
12/10/18	REVISED
1/10/19	REVISED
2/10/19	REVISED
3/10/19	REVISED
4/10/19	REVISED
5/10/19	REVISED
6/10/19	REVISED
7/10/19	REVISED
8/10/19	REVISED
9/10/19	REVISED
10/10/19	REVISED
11/10/19	REVISED
12/10/19	REVISED
1/10/20	REVISED
2/10/20	REVISED
3/10/20	REVISED
4/10/20	REVISED
5/10/20	REVISED
6/10/20	REVISED
7/10/20	REVISED
8/10/20	REVISED
9/10/20	REVISED
10/10/20	REVISED
11/10/20	REVISED
12/10/20	REVISED
1/10/21	REVISED
2/10/21	REVISED
3/10/21	REVISED
4/10/21	REVISED
5/10/21	REVISED
6/10/21	REVISED
7/10/21	REVISED
8/10/21	REVISED
9/10/21	REVISED
10/10/21	REVISED
11/10/21	REVISED
12/10/21	REVISED
1/10/22	REVISED
2/10/22	REVISED
3/10/22	REVISED
4/10/22	REVISED
5/10/22	REVISED
6/10/22	REVISED
7/10/22	REVISED
8/10/22	REVISED
9/10/22	REVISED
10/10/22	REVISED
11/10/22	REVISED
12/10/22	REVISED
1/10/23	REVISED
2/10/23	REVISED
3/10/23	REVISED
4/10/23	REVISED
5/10/23	REVISED
6/10/23	REVISED
7/10/23	REVISED
8/10/23	REVISED
9/10/23	REVISED
10/10/23	REVISED
11/10/23	REVISED
12/10/23	REVISED
1/10/24	REVISED
2/10/24	REVISED
3/10/24	REVISED
4/10/24	REVISED
5/10/24	REVISED
6/10/24	REVISED
7/10/24	REVISED
8/10/24	REVISED
9/10/24	REVISED
10/10/24	REVISED
11/10/24	REVISED
12/10/24	REVISED
1/10/25	REVISED
2/10/25	REVISED
3/10/25	REVISED
4/10/25	REVISED
5/10/25	REVISED
6/10/25	REVISED
7/10/25	REVISED
8/10/25	REVISED
9/10/25	REVISED
10/10/25	REVISED
11/10/25	REVISED
12/10/25	REVISED
1/10/26	REVISED
2/10/26	REVISED
3/10/26	REVISED
4/10/26	REVISED
5/10/26	REVISED
6/10/26	REVISED
7/10/26	REVISED
8/10/26	REVISED
9/10/26	REVISED
10/10/26	REVISED
11/10/26	REVISED
12/10/26	REVISED
1/10/27	REVISED
2/10/27	REVISED
3/10/27	REVISED
4/10/27	REVISED
5/10/27	REVISED
6/10/27	REVISED
7/10/27	REVISED
8/10/27	REVISED
9/10/27	REVISED
10/10/27	REVISED
11/10/27	REVISED
12/10/27	REVISED
1/10/28	REVISED
2/10/28	REVISED
3/10/28	REVISED
4/10/28	REVISED
5/10/28	REVISED
6/10/28	REVISED
7/10/28	REVISED
8/10/28	REVISED
9/10/28	REVISED
10/10/28	REVISED
11/10/28	REVISED
12/10/28	REVISED
1/10/29	REVISED
2/10/29	REVISED
3/10/29	REVISED
4/10/29	REVISED
5/10/29	REVISED
6/10/29	REVISED
7/10/29	REVISED
8/10/29	REVISED
9/10/29	REVISED
10/10/29	REVISED
11/10/29	REVISED
12/10/29	REVISED
1/10/30	REVISED
2/10/30	REVISED
3/10/30	REVISED
4/10/30	REVISED
5/10/30	REVISED
6/10/30	REVISED
7/10/30	REVISED
8/10/30	REVISED
9/10/30	REVISED
10/10/30	REVISED
11/10/30	REVISED
12/10/30	REVISED
1/10/31	REVISED
2/10/31	REVISED
3/10/31	REVISED
4/10/31	REVISED
5/10/31	REVISED
6/10/31	REVISED
7/10/31	REVISED
8/10/31	REVISED
9/10/31	REVISED
10/10/31	REVISED
11/10/31	REVISED
12/10/31	REVISED

LEGEND

- 14 - BUILT UP ROOF
- 15 - 8" CONCRETE
- 16 - 4" G.I. LATH
- 17 - 1" POLYSTYRENE
- 18 - 1" POLYSTYRENE
- 19 - 1" POLYSTYRENE
- 20 - 1" POLYSTYRENE
- 21 - 1" POLYSTYRENE
- 22 - 1" POLYSTYRENE
- 23 - 1" POLYSTYRENE
- 24 - 1" POLYSTYRENE
- 25 - 1" POLYSTYRENE
- 26 - 1" POLYSTYRENE
- 27 - 1" POLYSTYRENE
- 28 - 1" POLYSTYRENE
- 29 - 1" POLYSTYRENE
- 30 - 1" POLYSTYRENE
- 31 - 1" POLYSTYRENE
- 32 - 1" POLYSTYRENE
- 33 - 1" POLYSTYRENE
- 34 - 1" POLYSTYRENE
- 35 - 1" POLYSTYRENE
- 36 - 1" POLYSTYRENE
- 37 - 1" POLYSTYRENE
- 38 - 1" POLYSTYRENE
- 39 - 1" POLYSTYRENE
- 40 - 1" POLYSTYRENE
- 41 - 1" POLYSTYRENE
- 42 - 1" POLYSTYRENE
- 43 - 1" POLYSTYRENE
- 44 - 1" POLYSTYRENE
- 45 - 1" POLYSTYRENE
- 46 - 1" POLYSTYRENE
- 47 - 1" POLYSTYRENE
- 48 - 1" POLYSTYRENE
- 49 - 1" POLYSTYRENE
- 50 - 1" POLYSTYRENE
- 51 - 1" POLYSTYRENE
- 52 - 1" POLYSTYRENE
- 53 - 1" POLYSTYRENE
- 54 - 1" POLYSTYRENE
- 55 - 1" POLYSTYRENE
- 56 - 1" POLYSTYRENE
- 57 - 1" POLYSTYRENE
- 58 - 1" POLYSTYRENE
- 59 - 1" POLYSTYRENE
- 60 - 1" POLYSTYRENE
- 61 - 1" POLYSTYRENE
- 62 - 1" POLYSTYRENE
- 63 - 1" POLYSTYRENE
- 64 - 1" POLYSTYRENE
- 65 - 1" POLYSTYRENE
- 66 - 1" POLYSTYRENE
- 67 - 1" POLYSTYRENE
- 68 - 1" POLYSTYRENE
- 69 - 1" POLYSTYRENE
- 70 - 1" POLYSTYRENE
- 71 - 1" POLYSTYRENE
- 72 - 1" POLYSTYRENE
- 73 - 1" POLYSTYRENE
- 74 - 1" POLYSTYRENE
- 75 - 1" POLYSTYRENE
- 76 - 1" POLYSTYRENE
- 77 - 1" POLYSTYRENE
- 78 - 1" POLYSTYRENE
- 79 - 1" POLYSTYRENE
- 80 - 1" POLYSTYRENE
- 81 - 1" POLYSTYRENE
- 82 - 1" POLYSTYRENE
- 83 - 1" POLYSTYRENE
- 84 - 1" POLYSTYRENE
- 85 - 1" POLYSTYRENE
- 86 - 1" POLYSTYRENE
- 87 - 1" POLYSTYRENE
- 88 - 1" POLYSTYRENE
- 89 - 1" POLYSTYRENE
- 90 - 1" POLYSTYRENE
- 91 - 1" POLYSTYRENE
- 92 - 1" POLYSTYRENE
- 93 - 1" POLYSTYRENE
- 94 - 1" POLYSTYRENE
- 95 - 1" POLYSTYRENE
- 96 - 1" POLYSTYRENE
- 97 - 1" POLYSTYRENE
- 98 - 1" POLYSTYRENE
- 99 - 1" POLYSTYRENE
- 100 - 1" POLYSTYRENE

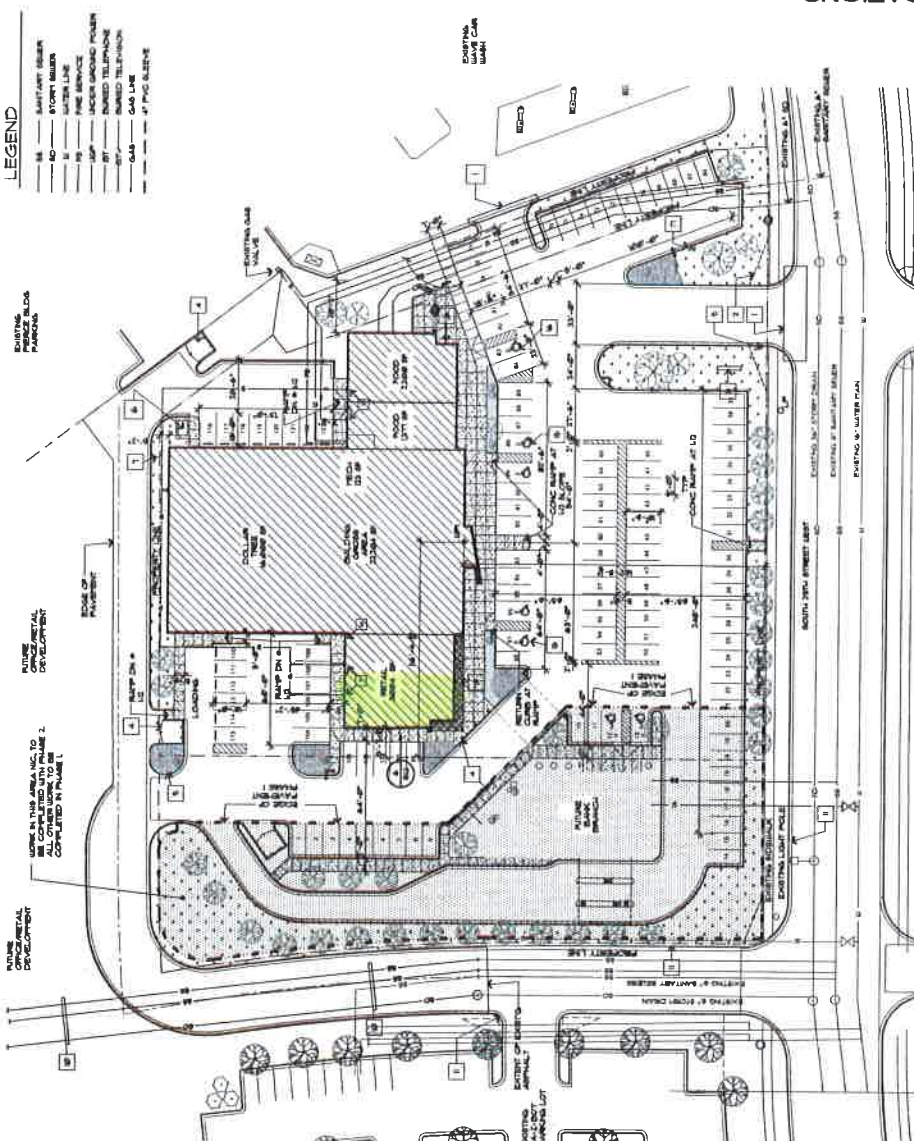

REVISIONS AND CLARIFICATIONS

NO. 1	DATE	DESCRIPTION
1	1/10/04	ISSUED FOR PERMIT
2	2/10/04	REVISED
3	3/10/04	REVISED
4	4/10/04	REVISED
5	5/10/04	REVISED
6	6/10/04	REVISED
7	7/10/04	REVISED
8	8/10/04	REVISED
9	9/10/04	REVISED
10	10/10/04	REVISED
11	11/10/04	REVISED
12	12/10/04	REVISED
13	1/10/05	REVISED
14	2/10/05	REVISED
15	3/10/05</	

896 S 29th St West
Suite D

N
1/4"=1'

Equipment
3 Tap Keg Cooler
2 Door Merchandiser
3 Compartment sink
Pop Sink
Syrup racks
Ice Maker

Storage area-
Mop sink
Hand sink
Electrical/Plumbing

New ADA Mens
Sink/Vanity/Mirror
Urinal
Commode
Handrails
Stall seperator
Electrical/Plumbing

Bar
Bar wall/Electrical/
Plumbing/Drains
Pendant lighting
Back bar lighting
Back bar storage/
display
Off sale cabinets

Carpet/Tile
Trim-Base/Crown/
Chair rail
Lighting
Shades/Blinds
Office counter/shelves

Security/Surveillance/Mag Locks
Sound

Exterior Signage

