



Summary Cost Estimate

Option 1

5 Year

Police Evidence Building Expansion
Billings, MT - Project # 1701
August 24, 2018

EXISTING BUILDING

Minor work, walls, doors, etc.

\$ 80,000.00

NEW ADDITION

Office, Storage & Vehicle Processing 9,555 SF x \$163.50:

\$ 1,562,242.50

\$ 1,642,242.50

SITE WORK

New Entrance Configuration, Public Parking, Impound Lot Increase:

266,316.00

Site Lighting:

89,710.00

Fencing: 8" high Trex with top wire.

160,000.00

\$ 516,026.00

SUBTOTAL: \$ 2,158,268.50

Construction Contingency (15%): \$ 323,740.28

A/E Compensation: \$ 250,000.00

TOTAL CONSTRUCTION: \$ 2,732,008.78

PRELIMINARY

Date MONTH ##, 2013
Issue
Drawn by Sml

REVISIONS	NUMBER	REVISION DESCRIPTION	DATE

BILLINGS EVIDENCE STORAGE



SCHUTZ FOSS
ARCHITECTS, P.C.
ARCHITECTURE INTERIORS PLANNING
BILLINGS, MONT. WWW.SCHUTZFOSS.COM

OPTION 2

Project No. 1701
3.0

02/24/2013 10:16:54 AM

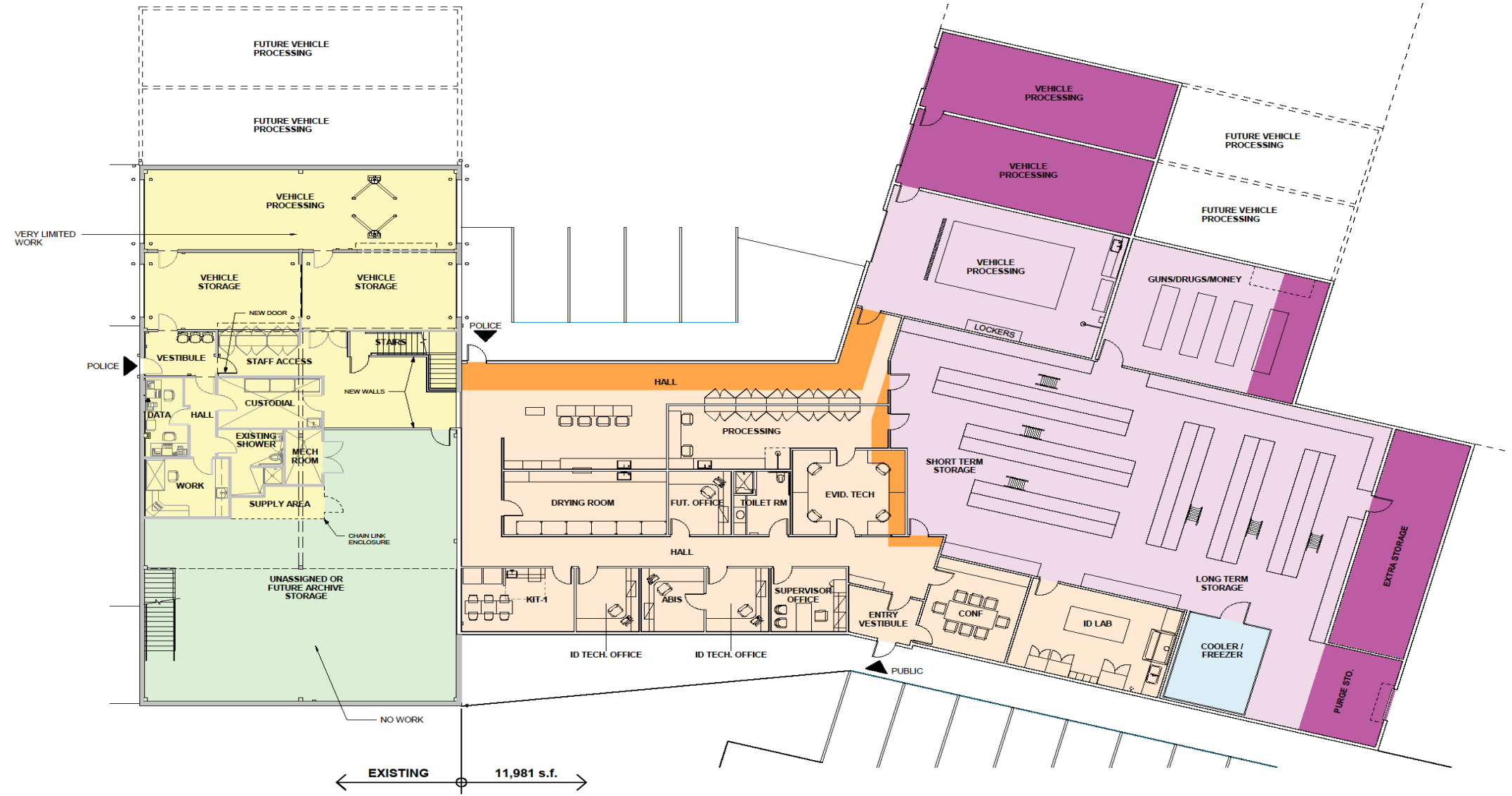

FLOOR PLAN
1/8" = 1'-0"

OPTION 2 - 10 YEARS RECOMMENDED



Summary Cost Estimate **Option 2**

10 Year

Police Evidence Building Expansion
Billings, MT - Project # 1701
August 24, 2018

EXISTING BUILDING

Minor work, walls, doors, etc. \$ 80,000.00

NEW ADDITION

Office, Storage & Vehicle Processing 11,981 SF x \$163.50: \$ 1,958,893.00 **\$ 2,038,893.00**

SITE WORK

New Entrance Configuration, Public Parking, Impound Lot Increase: 266,316.00
Site Lighting: 89,710.00
Fencing: 8" high Trex with top wire. 160,000.00

\$ 516,026.00

SUBTOTAL: \$ 2,554,919.00

Construction Contingency (15%): \$ 375,678.00

A/E Compensation: \$ 288,020.00

TOTAL CONSTRUCTION: \$ 3,218,617.00



SCHUTZ FOSS
ARCHITECTS, P.C.
ARCHITECTS • ENGINEERS • PLANNERS

Summary Cost Estimate

Option 3

20 Year

Police Evidence Building Expansion
Billings, MT - Project # 1701
August 24, 2018

EXISTING BUILDING

Minor work, walls, doors, etc.

\$ 80,000.00

NEW ADDITION

Office, Storage & Vehicle Processing 16,523 SF x \$163.50:

\$ 2,701,511.00

\$ 2,781,511.00

SITE WORK

New Entrance Configuration, Public Parking, Impound Lot Increase:

266,316.00

Site Lighting:

89,710.00

Fencing: 8" high Trex with top wire.

160,000.00

\$ 516,026.00

SUBTOTAL:

\$ 3,297,537.00

Construction Contingency (15%):

\$ 494,631.00

A/E Compensation:

\$ 379,217.00

TOTAL CONSTRUCTION:

\$ 4,171,385.00

Alternate Additional Work

On-site canopy for Police building

4,650 sf x \$55.00:

\$ 255,750.00

Recommendations

- **City Council approve Evidence Facility 10-Year Plan (Option 2) or add parts of 20-Year Plan**
- Move forward immediately with Phase II Design Contract with Schutz Foss/Roth Sheppard Architects
 - Place Evidence Expansion back into CIP
- Add design fees to FY19 Budget (Amend) and Construction in FY20 Budget