

# PRELIMINARY PLAT OF MACKENZIE MEADOWS SUBDIVISION, 2ND FILING

BEING LOT 5, BLOCK 1, MACKENZIE MEADOWS SUBDIVISION, 1ST FILING  
AND THE S 1/2, NW OF SECTION 28, T. 1 N., R. 25 E., P.M.M.  
YELLOWSTONE COUNTY, MONTANA

PREPARED FOR: SAMM, LLC  
SURVEYOR: NORTH STAR LAND SERVICES, P.C.  
ENGINEER: BLUELINE ENGINEERING LLC  
MARCH, 2018  
BILLINGS, MONTANA

## SUBDIVISION DETAILS:

GROSS AREA	=	167.891 ACRES
NET AREA	=	127.092 ACRES
ROAD AREA	=	29.299 ACRES
PARK AREA	=	11,500 ACRES
NUMBER OF LOTS	=	183
MINIMUM LOT SIZE	=	0.459 ACRES
MAXIMUM LOT SIZE	=	7.023 ACRES
ROAD LENGTH	=	16,404.00 LF
EXISTING ZONING	=	NONE/AG
SURROUNDING ZONING	=	
NORTH	=	AG/AS
SOUTH	=	AG
EAST	=	AG
WEST	=	NONE
EXISTING LAND USE	=	AG
PROPOSED LAND USE	=	RESIDENTIAL

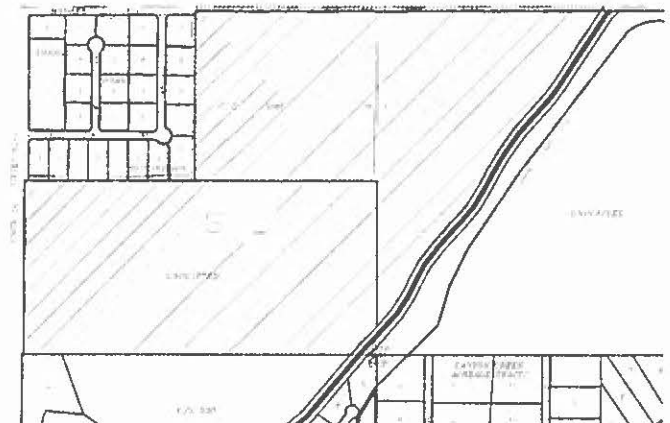
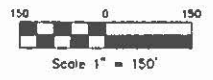

VICINITY MAP  
NOT TO SCALE