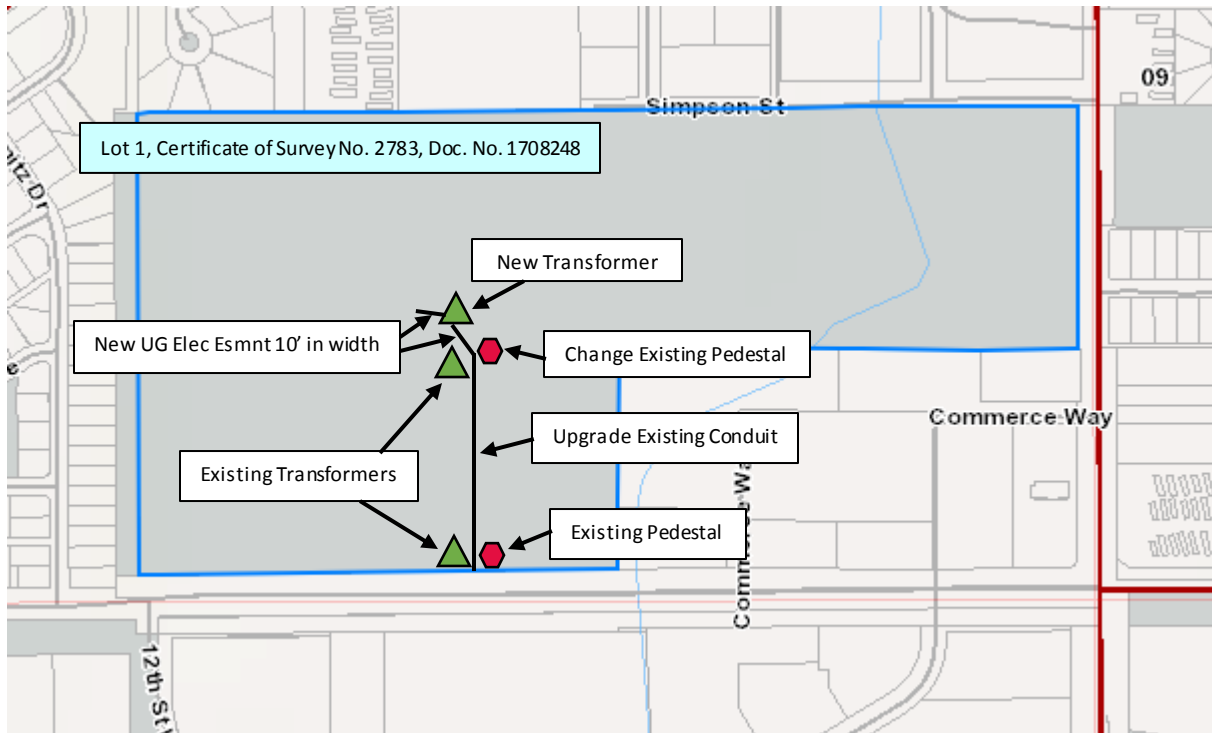

Exhibit "A"

The following is made a part of that certain Underground Electrical Easement dated _____ by and between THE CITY OF BILLINGS, of PO Box 1178, Billings, MT 59103-1178, as "Grantor" and Northwestern Corporation D/B/A NorthWestern Energy, as "Grantee".

All distances, areas and measurements shown below are approximate and not to scale.



Township 1 South, Range 26 East, M.P.M., Yellowstone County, MT
Section 8: A tract of land in the SW4 and SE4 of said Section, known as Tract 1 of Certificate of Survey 2783, in the City of Billings, Yellowstone County, Montana, as depicted in the official records of the Clerk and Recorder of Yellowstone County, MT under Document No. 1708248