



PROPRIETED, LLC
1053 LINCOLN LANE
BILLINGS, MT

| | | |
|---------|-------------|-------------------|
| DSGN BY | DESIGNED BY | QUALITY ASSURANCE |
| DRWL BY | DRAWN BY | CHK BY |
| DATE | DATE | DATE |
| REV BY | DATE | CHKD BY |
| | | |
| | | |

SHEET TITLE
1053 LINCOLN LANE
ANNEXATION MAP

PROJECT NUMBER
2020-046
SHEET NUMBER
1 OF 2
DRAWING NUMBER
EX 1
COPYRIGHT 2020 ©

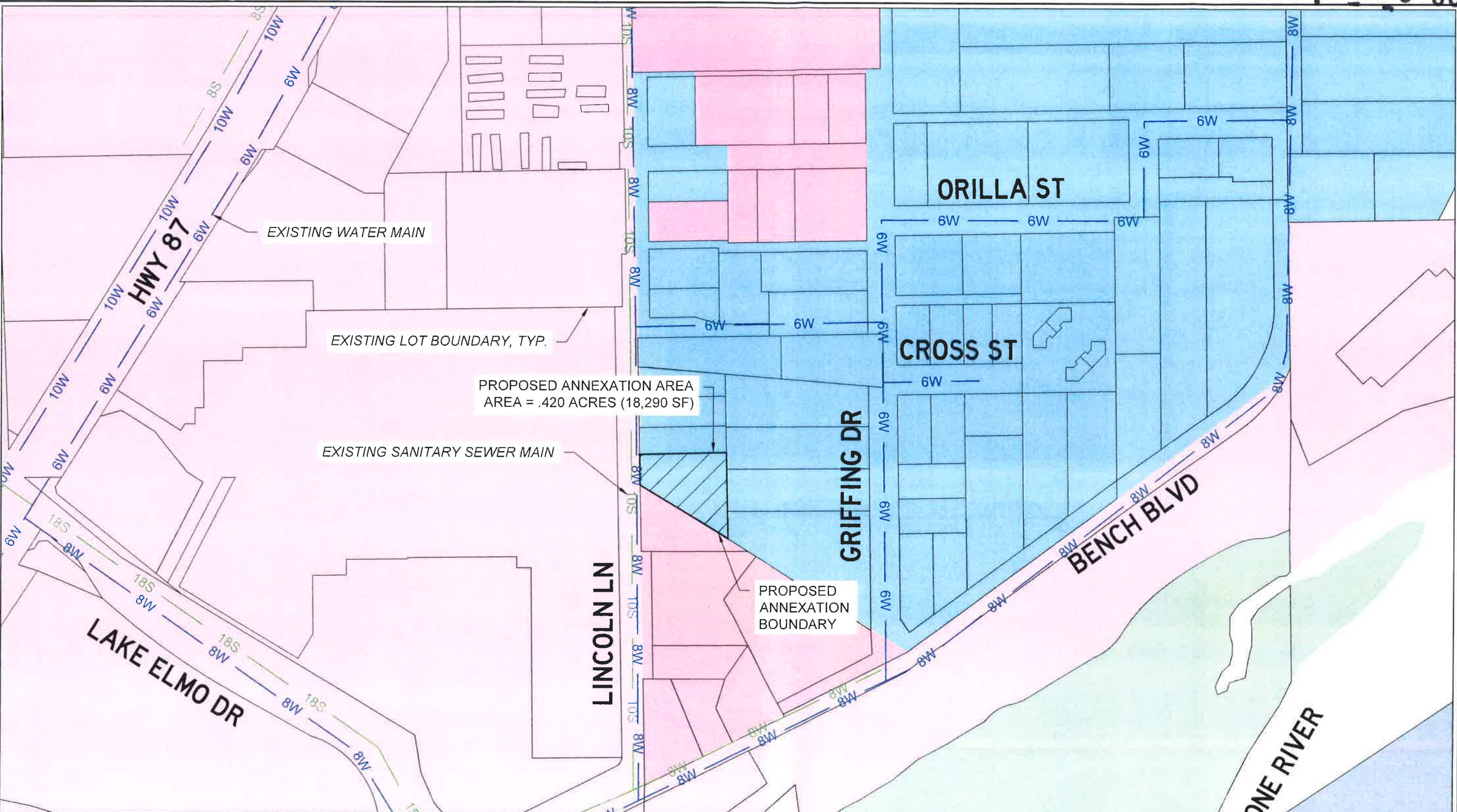

PROPOSED ANNEXATION AREA
AREA = .420 ACRES (18,290 SF)

PROPOSED ANNEXATION
BOUNDARY

LEGEND

- COMMUNITY COMMERCIAL
- PUBLIC
- PROPOSED ANNEXATION BOUNDARY
- HIGHWAY COMMERCIAL
- INDUSTRIAL CONTROLLED
- EXISTING SANITARY SEWER MAIN, VARYING SIZE
- EXISTING HEIGHTS WATER MAIN, VARYING SIZE
- RESIDENTIAL 7,000
- EXISTING LOT LINE BOUNDARY

LEGAL DESCRIPTION

INCLUDES PARCEL F OF C.O.S. 537, SECTION 27,
TOWNSHIP 01 NORTH, RANGE 26 EAST, P.M.M.,
BILLINGS, MONTANA

