



PROPRIETED, LLC

BILLINGS, MT

1053 LINCOLN LANE

DSGN BY	DESIGNED BY	QUALITY ASSURANCE
DRWN BY	DRAWN BY	CHK BY
DATE	DATE	DATE
REV BY	DATE	CHKD BY

SHEET TITLE
1053 LINCOLN LANE
ANNEXATION MAP

PROJECT NUMBER
2020-046

SHEET NUMBER
1 OF 2

DRAWING NUMBER
EX 1

COPYRIGHT 2020 ©

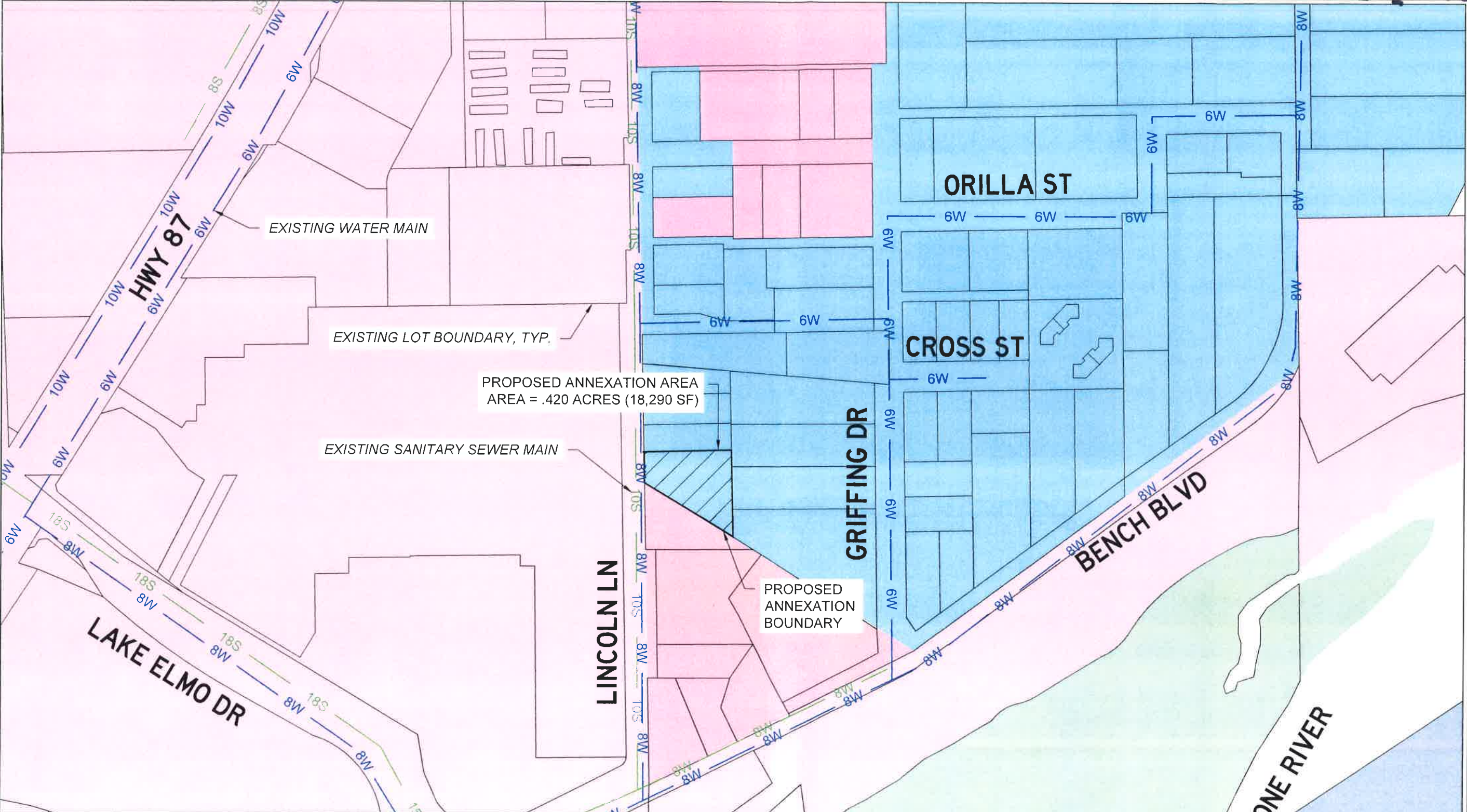

LEGEND

- | | | | | | |
|--|----------------------|--|----------------------------|--|--|
| | COMMUNITY COMMERCIAL | | PUBLIC | | PROPOSED ANNEXATION BOUNDARY |
| | HIGHWAY COMMERCIAL | | INDUSTRIAL CONTROLLED | | EXISTING SANITARY SEWER MAIN, VARYING SIZE |
| | RESIDENTIAL 7,000 | | EXISTING LOT LINE BOUNDARY | | EXISTING HEIGHTS WATER MAIN, VARYING SIZE |

LEGAL DESCRIPTION

INCLUDES PARCEL F OF C.O.S. 537, SECTION 27,
TOWNSHIP 01 NORTH, RANGE 26 EAST, P.M.M.,
BILLINGS, MONTANA

