

SAHARA PARK IMPROVEMENTS

A plan to benefit community,
neighborhood and Oasis



LOCATION

Corner of Aronson Ave. and Caravan Ave.

Adjacent to bike and walking path connecting to Swords Park

Nearest picnic shelter several miles away

Nearest open space about one mile away

Beautiful view of Alkali Creek

Next to Oasis parking lot

TIMELINE

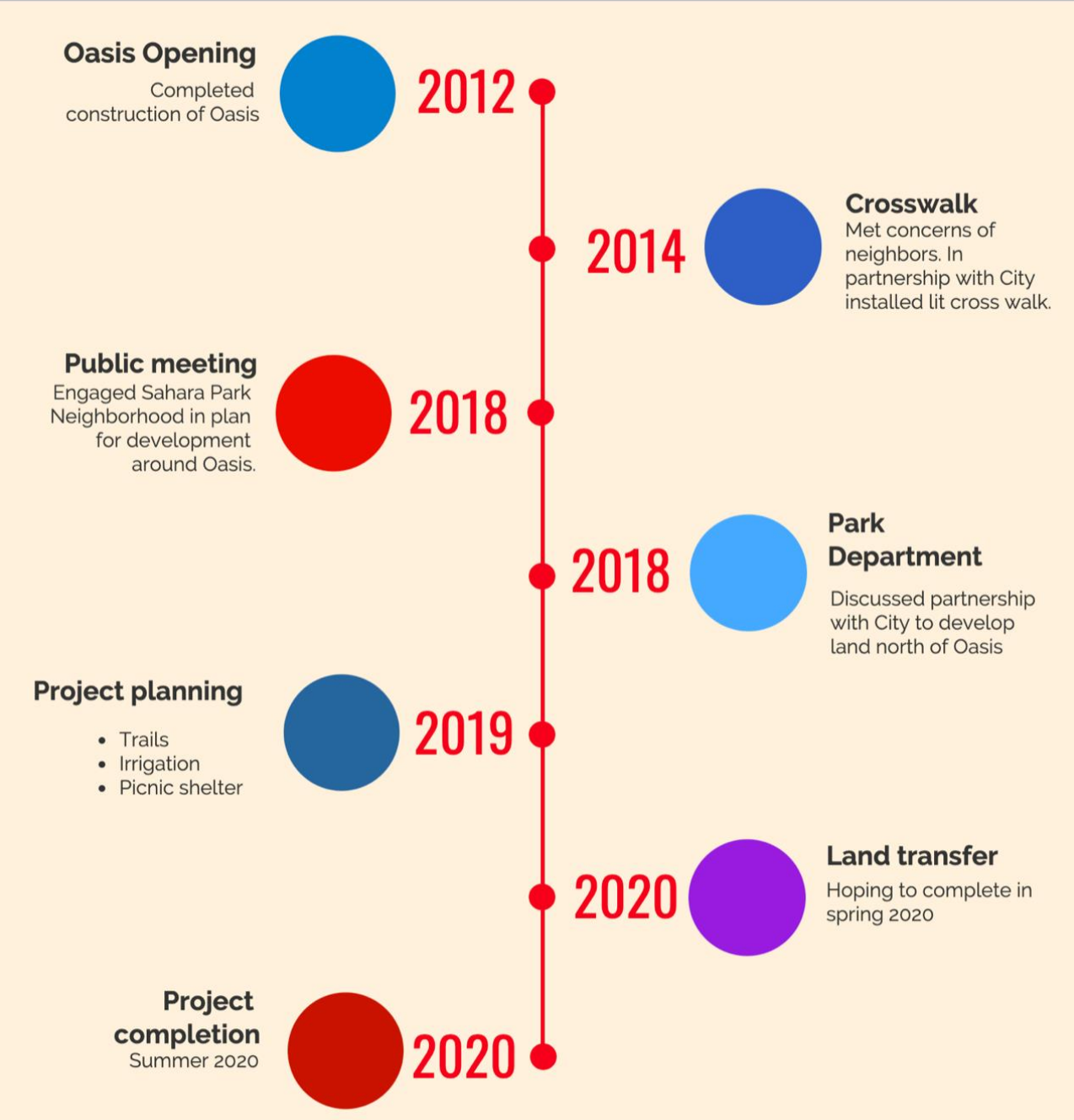



Results of Preliminary survey by Chuck & Larry

1. Existing perimeter sidewalk. Part of perimeter trail.
2. Existing sidewalk next to Oasis fence. Connection between trail and parking lot.
3. Perimeter trail to be designed, located and constructed.
4. Grove of Russian Olive Trees that need to be thinned to provide an attractive trail.
5. Connecting trail from Perimeter trail to the scenic rocks to East of Oasis. Needs coordination with City.
6. Potential BMX courses. Will need help in creating a good design. Needs coordination with City.
7. Potential Kiddi Plaground and Picnic Area. Also an area for a possible Picnic Shelter. Needs coordination with City.
8. Picnic Shelter with shade trees.
9. Grassy irrigated areas.
10. Potential volleyball, basketball and/or Pickleball courts.

OVERVIEW

1. Existing Sidewalk

City Park

9. Grassy irrigated area

8. Picnic Area with shade tree

Here

9. Grassy irrigated area

7 Potential Kiddi Playground, Picnic Area w/shade trees

City Park

Control Point

City Park

6. Potential BMX course

Control Point

5. Trail to Rocks

Rocks

Control Point

2. Existing Sidewalk

10. Volleyball? Pickleball? Basketball/

6. Potential BMX course

4. Need thinning of Russian Olive Trees

3. Perimeter Trail

Control Point

Aronson Ave

Aronson Ave

Aronson Ave

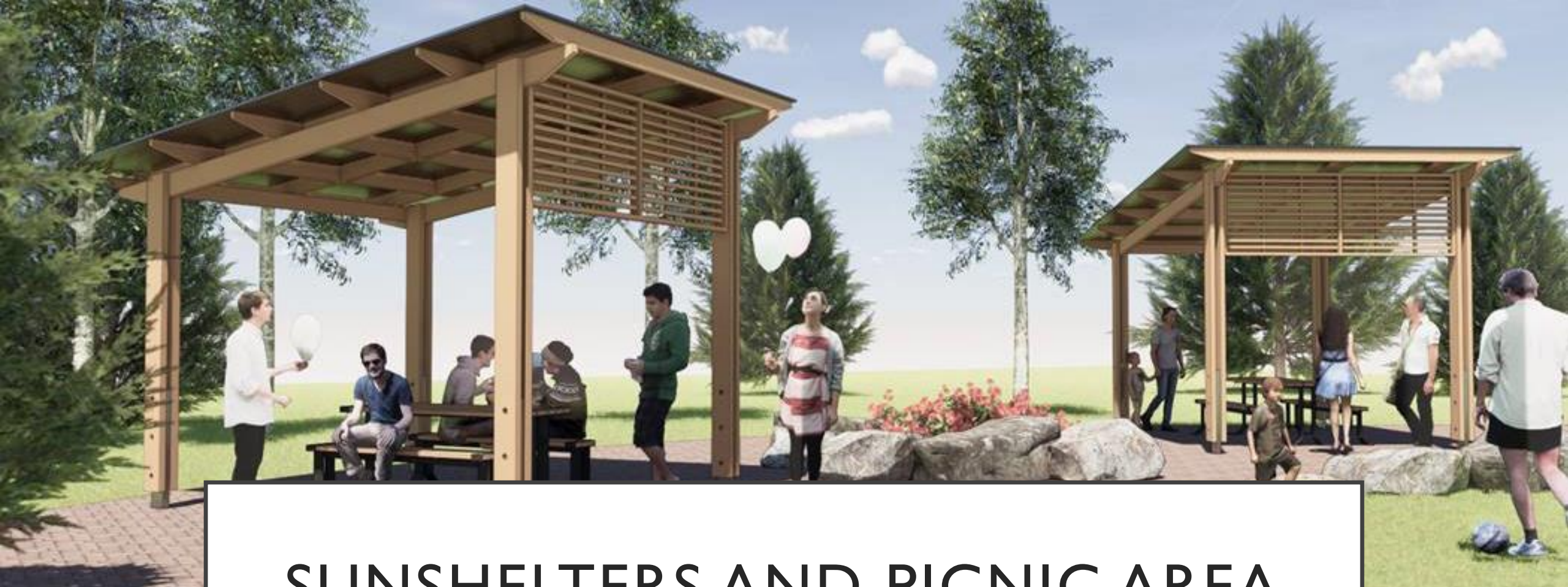

SUNSHELTERS AND PICNIC AREA

QUESTIONS OR COMMENTS

