

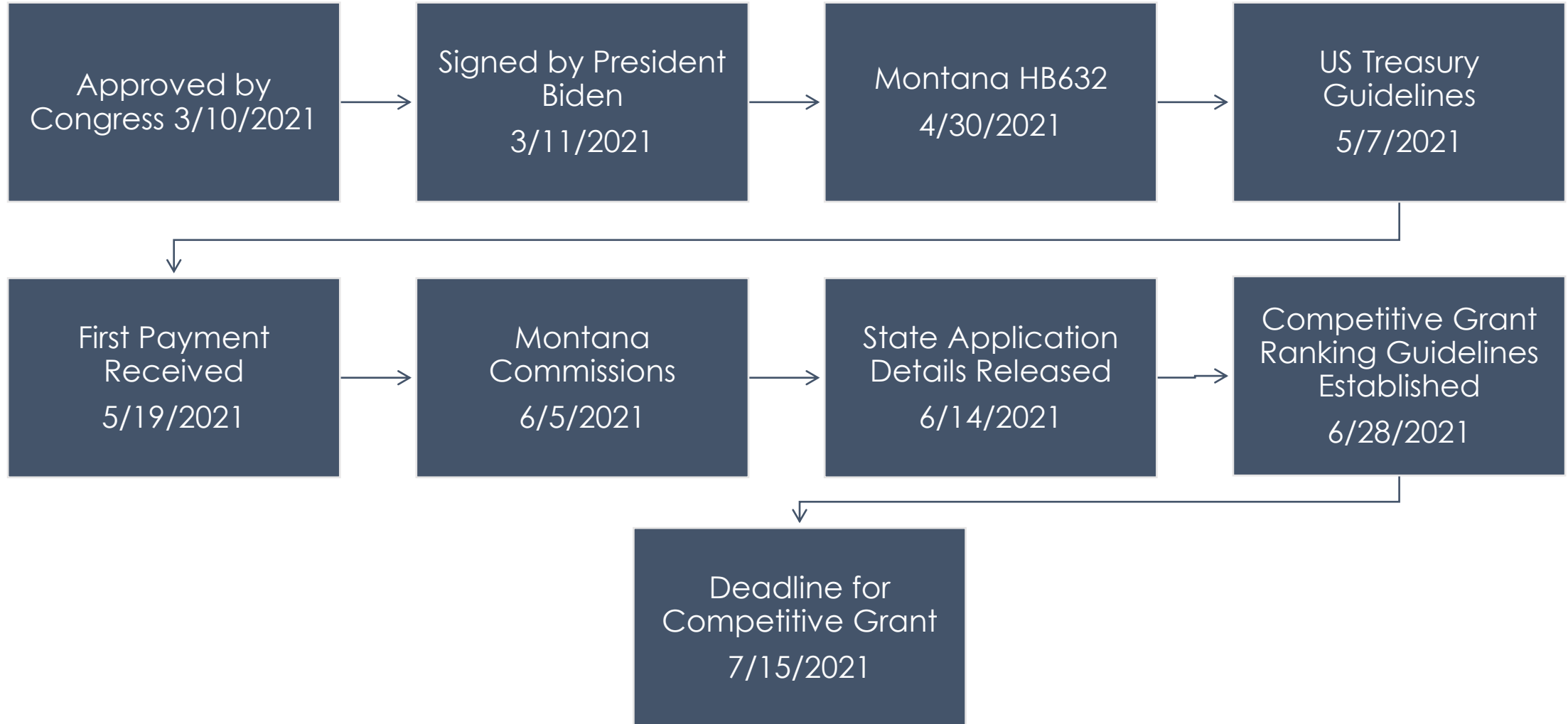

American Rescue Plan Act

# ARPA Timeline



# Funding Sources



## Federal Allocation

Local Fiscal Recovery Funds

\$15,940,314

## State Grants

Minimum Allocation Grant

\$15,607,145

Competitive Grant

Up to \$25M per project

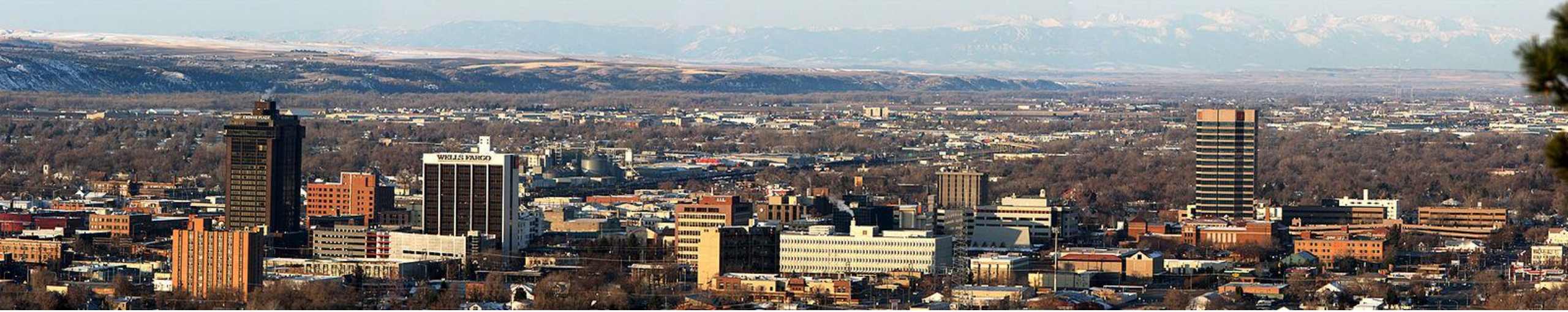

# American Rescue Plan Act

\$15,940,314

Revenue Loss  
Replacement

Infrastructure

Public Health  
Expenditures

Economic  
Impact  
Programs

Premium Pay  
for Essential  
Workers

# Revenue Loss Calculation

\$7,394,678

- ✓ Calendar Year 2020 Amount
- ✓ Growth Rate per calculation: 4.1%
- ✓ Revenue Loss due to COVID19: 3.6%
- ✓ No Federal Grants, Bonds, Utilities



# Eligible Uses for Revenue Loss Funds



# Funding Sources



Federal Allocation	State Grants	
Local Fiscal Recovery Funds	Minimum Allocation Grant	Competitive Grant
\$15,940,314	\$15,607,145	Up to \$25M per project

# Minimum Allocation Grant



\$15,607,145



Fund match requirement

- Lesser of \$3.9M or a one-to-one match per application



Application opens July 15th



Final Deadline January 1, 2023

# Funding Sources

## Competitive State Grant



### Federal Allocation

Local Fiscal Recovery  
Funds

\$15,940,314

### State Grants

Minimum Allocation Grant

\$15,607,145

Competitive Grant

Up to \$25M per project

# Eligible Water & Sewer Infrastructure Projects



## Drinking Water State Revolving Fund (DWSRF)

**Building/upgrading facilities**

**Transmission & distribution system**

**Storage systems**

**Replacement of lead service lines**

## Clean Water State Revolving Fund (CWSRF)

**Wastewater treatment**

**Wastewater collection system**

**Water conservation**

**Managing & Treating stormwater**

# Competitive State Grant



Applications due by 7/15/21 for first round



Covered Period 3/3/21 – 12/31/26



Obligated by 12/31/24



Ranking Categories	Points Available
DWSRF or CWSRF	420
Readiness	80
Affordability	50
Match	50
<b>Total</b>	<b>600</b>



# Competitive State Grant Water Project Rankings



<b>Water Project Ranking</b>	<b>Points</b>
<b>Documented health risks</b>	<b>180</b>
Acute health risks	120
Non-acute health risks	60
<b>Potential health risks</b>	<b>80</b>
Microbiological & nitrate health risks	50
Chemical contaminant health risks	30
<b>Compliance</b>	<b>50</b>
Proactive Compliance Measures	50
Project addresses a formal enforcement action	25
<b>Consolidation or creation of a new system</b>	<b>30</b>
<b>Conservation</b>	<b>80</b>
Water use efficiency	30
Water meters	20
Energy efficiency	30
<b>Total Points in DWSRF</b>	<b>420</b>

# Competitive State Grant Sewer Project Rankings



Sewer Project Ranking	Points
<b>Public health and water quality</b>	<b>250</b>
Project protects public health	75
Project reduces toxic effects	25
Project reduces sediment	25
Project reduces nutrients	25
Project complies with secondary standards	25
Project helps meet a TMDL	50
Project addresses formal enforcement action	25
<b>Effectiveness in improving water quality or public health</b>	<b>100</b>
Eliminate health hazards or restore beneficial uses	100
Improve but not fully restore	50
May or may not improve water quality	25
<b>Point source projects OR</b>	<b>70</b>
Capacity	10
Reliability or obsolescence	20
Beneficial use	20
Water conservation	10
Energy Conservation	10
<b>Total Points in CWSRF</b>	<b>420</b>

# Competitive Grants Other Ranking Criteria

City Match	Points
1:1 Match of % of the ARPA Local Recovery Funds	50
25% = \$7,886,865	
50% = \$15,773,730	
<b>Max Points</b>	<b>50</b>

Readiness to Proceed	Points
Engineer has been formally hired for planning and design	10
In planning document	10
All other project funding in place	10
Final plan and specs have been approved	20
Construction will begin within next 24 months	30
<b>Max Points</b>	<b>80</b>



Affordability: Expected average household combined water & sewer rates, including debt retirement and O&M are:	Points
> 3.5% of MHI	50
2.6% and 3.5% of MHI	25
1.1% and 2.5% of MHI	15
< 1.1% of MHI	10
<b>Max Points</b>	<b>50</b>

# Competitive Grant Projects - \$42.3M

Expense Types	West End Plant	2021 Water Rehab	2022 Water Rehab	West End Distribution	Staples Reservoir	Water Storage Improvements Zone 1	Zone 6 Reservoir and Redundant Line	Influent Lift Station
Project Costs	\$72,000,000	\$ 4,000,000	\$ 3,600,000	\$ 5,000,000	\$ 4,000,000	\$ 3,600,000	\$ 9,000,000	\$ 5,400,000
Application Amount	\$25,000,000	\$ 2,000,000	\$ 1,800,000	\$ 2,500,000	\$ 2,000,000	\$ 1,800,000	\$ 4,500,000	\$ 2,700,000
City Match	\$47,000,000	\$ 2,000,000	\$ 1,800,000	\$ 2,500,000	\$ 2,000,000	\$ 1,800,000	\$ 4,000,000	\$ 2,700,000
Points	170	240	210	160	180	210	210	365

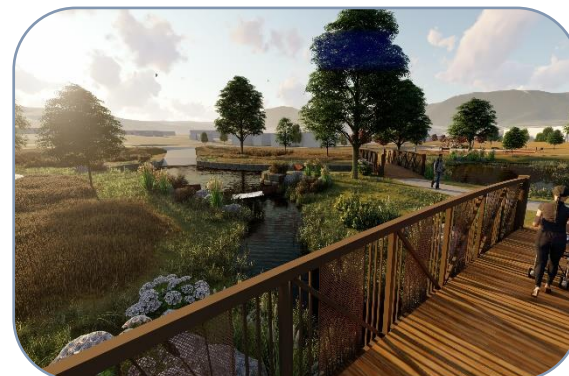

# Next Steps



7/12/21 - Authorize City to apply for State Competitive Grants



7/15/21 - Competitive Grant Applications due



8/15/21 - DNRC rankings to Commission



1/31/23 - Minimum Allocation Grant applications



Council prioritization of U.S. Treasury Local Fiscal Recovery Funds



Questions?