

# ANNUAL GRAVEL STREET PROGRAM

## SID 1427

---

### HANCOCK DRIVE IMPROVEMENTS



# PROJECT LOCATION

HANCOCK DRIVE

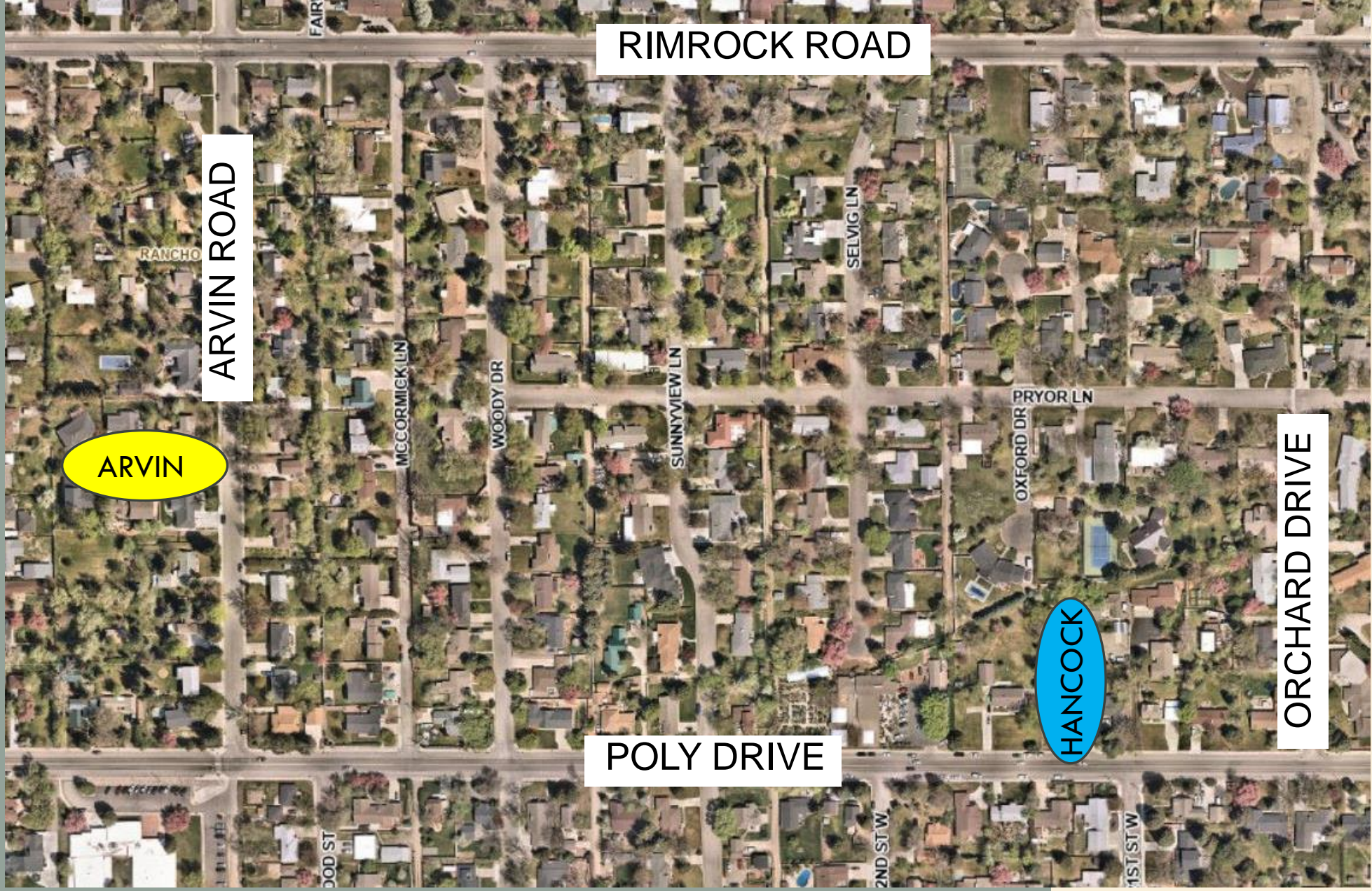

ARVIN

ARVIN ROAD

POLY DRIVE

RIMROCK ROAD

HANCOCK

ORCHARD DRIVE

# DESIGN COMPONENTS

## HANCOCK DRIVE



### GRAVEL STREET

PROPERTY OWNER  
REQUESTED SID

GRAVEL SURFACE  
MAINTENANCE

### ASPHALT STREET

30-FOOT RIGHT OF  
WAY

CONCRETE CURB

CONCRETE  
APPROACHES

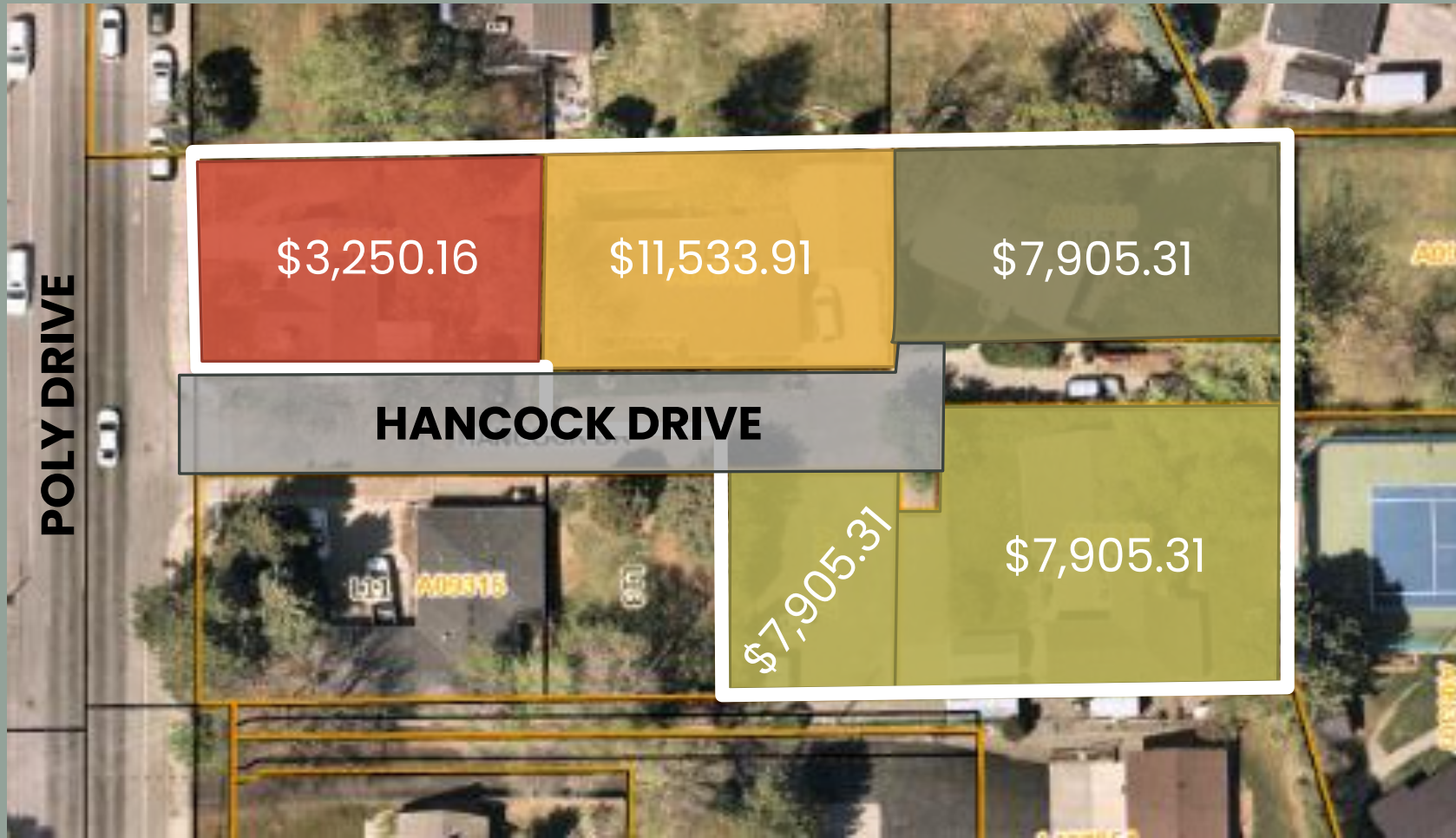

- HAMMOND  
REQUESTED  
IMPROVEMENTS
- KLARICH  
IN SUPPORT
- URLACHER  
NOT SUPPORTING
- LAMBRECHT  
TWO PROPERTIES  
IN SUPPORT

# DISTRICT BOUNDARY & ASSESSMENTS

HANCOCK DRIVE

# FINANCIAL INFORMATION

HANCOCK DRIVE

**TOTAL PROJECT COST**

**\$129,878.00**

**ASSESSMENT TOTAL**

**\$38,500.00**

**EQUAL AMOUNT METHOD**

**ASSESSABLE AREA METHOD**

**CITY CONTRIBUTION**

**\$91,378.00**

**SMD 2 FUNDS**

**CITY IN-HOUSE DESIGN**



- ▶ BIDS RECEIVED 12/19/2023
- ▶ RESOLUTION OF INTENT 1/22/2024
- ▶ RESOLUTION TO CREATE 2/12/2024
  
- ▶ CONSTRUCTION COMPLETE  
FALL OF 2024
  
- ▶ ASSESSMENTS ON TAXES 2025

PROJECT SCHEDULE

HANCOCK DRIVE



QUESTIONS?