

**PIONEER PARK TENNIS COURTS REPLACEMENT**  
**ADDENDUM #2**  
March 11, 2024

**CLARIFICATIONS:** none

**CHANGES TO PRIOR ADDENDA:** none

**BIDDING REQUIREMENTS:** none

**CONDITIONS OF THE CONTRACT:** none

**SPECIFICATIONS:**

1. SP-36
  - a. Add the following sentence
    01. Contractor shall provide safety/security fencing to prevent access to the site by the public. If sidewalks are to be closed, necessary approval and permits shall be obtained from the City of Billings.
2. SECTION 033800
  - a. Add the following under 3.2 Paragraph H
    01. Curing requirements can be discussed with the successful contractor following the project award. However, at this point, there is no change anticipated.
3. SECTION 321823
  - a. Add the following under 2.1, Paragraph E
    01. Structural fill specifications fall within the MPWSS specifications for 3" minus sub base course (02234 2.4 A)
4. SECTION 321823
  - a. Add the following under 2.1, Paragraph E
    01. Material being excavated and stockpiled for use in the project can be piled in the parking lane adjacent to the park along 3<sup>rd</sup> street temporarily. Individual stockpiles can remain on the street for no more than 3 days before it is removed. Prior to stockpiling any material on the street, the Owner is to be notified so that they can let the necessary City department know that work will be taking place in the street right-of-way. Ensure that proper SWPPP

PIONEER PARK TENNIS  
COURTS REPLACEMENT

Addendum #2

3/11/24

procedures are in place. Contact the City street departments for additional information.

**DRAWINGS:**

1. Detail 6/L1.4: The following fittings are approved for use on fencing.
  - a. Pressed steel loop cap is approved for use at top of line posts. Not to be used at corners and gate posts.
  - b. Pressed steel line clamp is approved for use at fence brace rails on line posts.

Attachments: Planholders List

Pre-Bid Meeting Sign-In

Pioneer Park Irrigation As-Built

THIS ADDENDUM IS HEREBY ATTACHED TO AND MADE A PART OF THE CONTRACT DOCUMENTS, AND EACH BIDDER SHALL ACKNOWLEDGE RECEIPT OF THIS ADDENDUM IN WRITING ON HIS BID.

**END ADDENDUM #2**





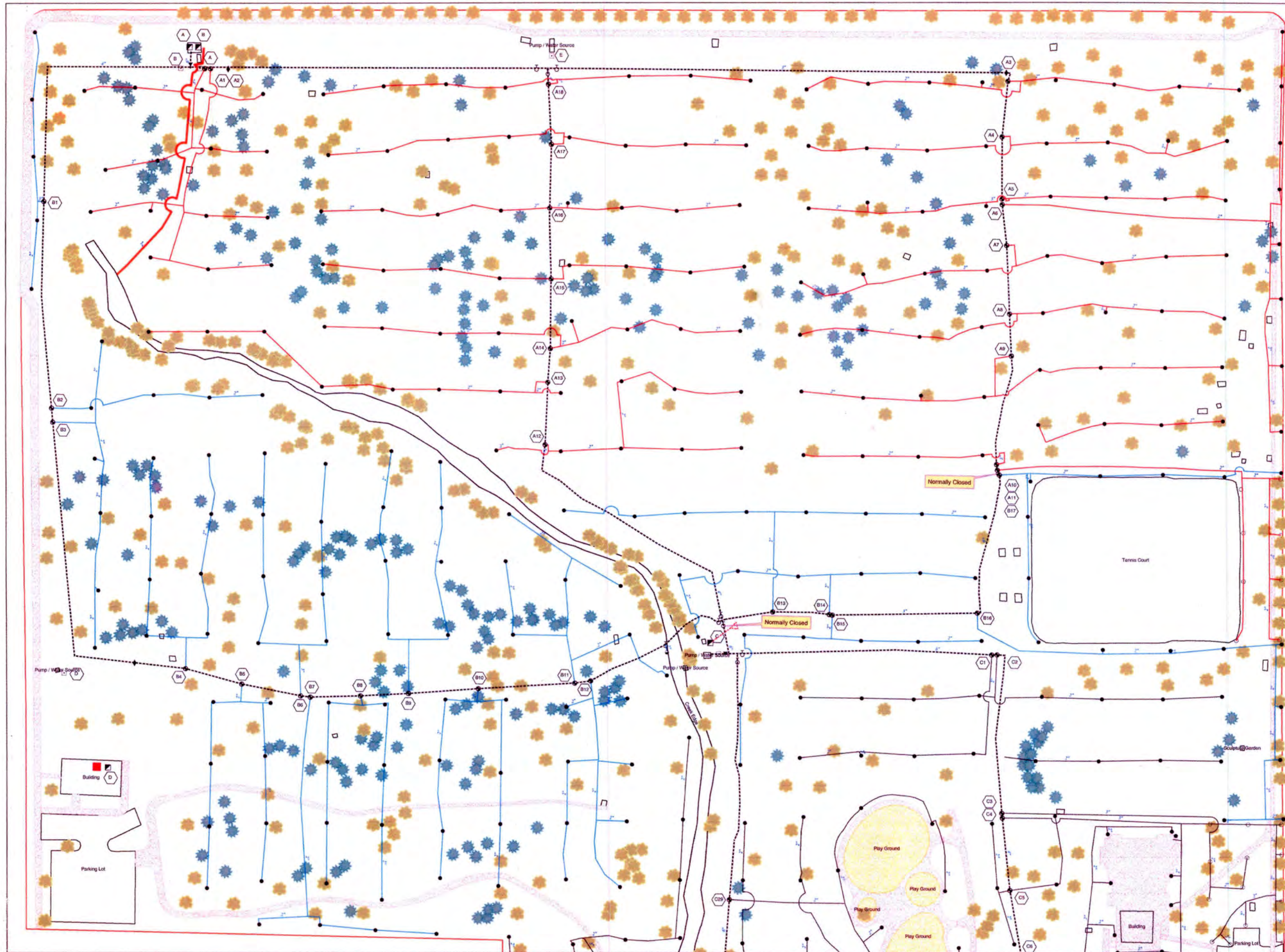



### Legend

**Equipment**

- ▲ Aerial
- Well
- Control
- Electric Valve
- Four Way Water Valve (45°/90°/45°)
- ↓ Ground Valve
- Lateral Valve
- Main Valve
- Water Meter
- Gate Valve
- Spherulite AFR 1/2"
- Spherulite AFR 1"
- Spherulite AFR 1.5"
- Spherulite AFR 2"
- Spherulite AFR 3"

**Type, Pipe, Zone**

- Four Inch Line
- Lateral A
- Lateral B
- Lateral C
- Lateral D
- Mainline
- Control Line
- Base Map Line Feature

**Description**

- Tree/Deciduous
- Tree/Evergreen
- Base Map Huge Tree
- Other

**Description**

- Playground
- Sidewalk
- Base Map Park Perimeter (Estimated)

Copyright 2004  
Hysam Enterprises

GPS Data Collected and  
Map Created by

**Hysam Enterprises**  
 1925 Grand Ave., Suite 103  
 Billings, MT 59102  
 (406) 860-6196

In Association With

**CARL THUESEN**  
 A P L A  
 GOLD COURSE ARCHITECTURE  
 LANDSCAPE ARCHITECTURE  
 100 GRAND AVENUE, SUITE 100  
 BILLINGS, MT 59101  
 (406) 251-2000

0 20 40 80 Feet

Page 1 of 2

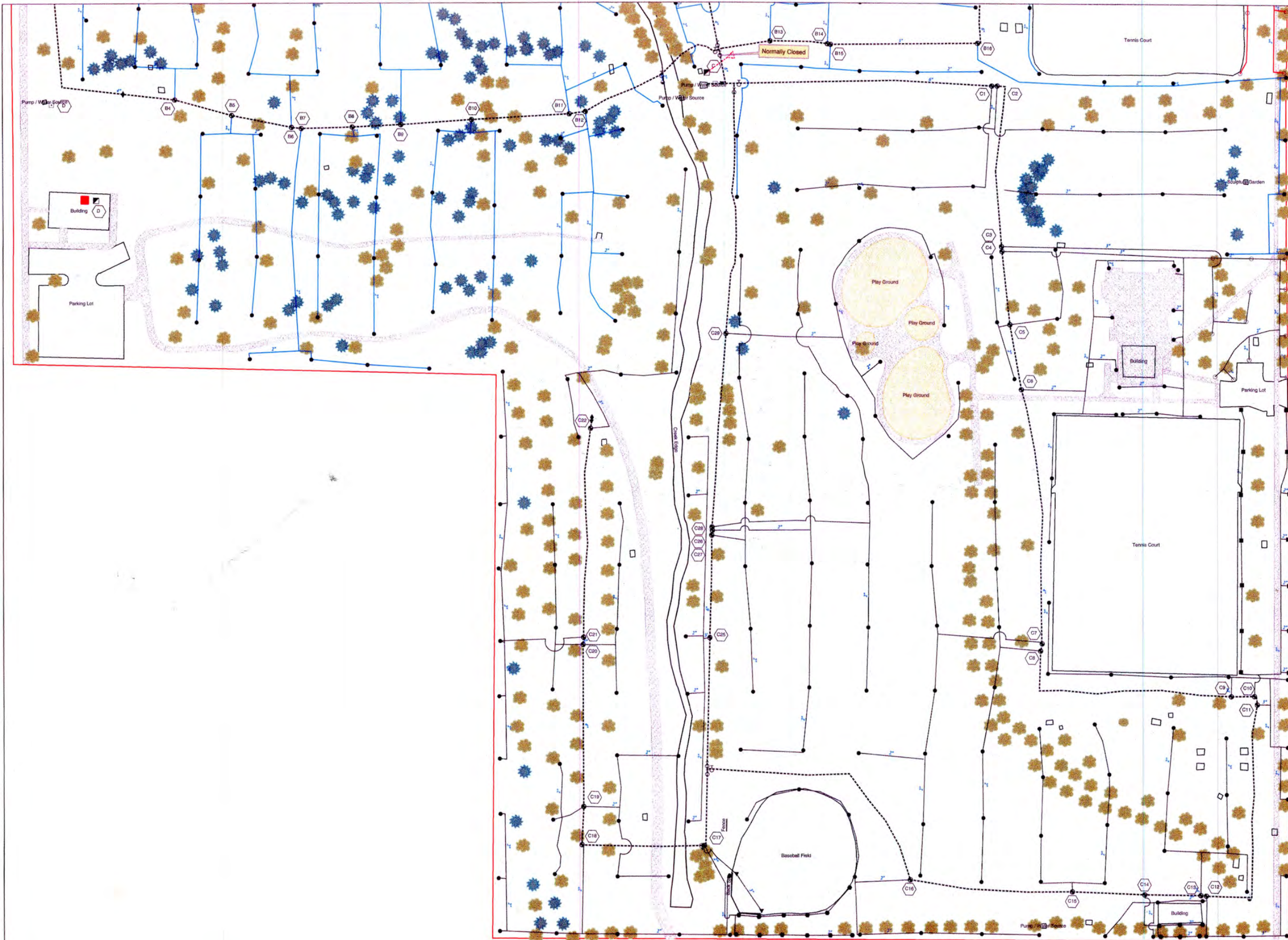



### Legend

**Equipment**

Type: Nozzle

- Air Valve
- Backflow Preventer
- Check Valve
- Flow Meter, Meter Valve, Retention Valve Only
- Ground Fault Circuit Interrupter
- Lateral Valve
- Mainline Valve
- Shut-off Valve
- Disk Check Valve
- Sprinkler/Headed 100' W.I.
- Sprinkler/Headed 200' W.I.
- Sprinkler/10' T. Box

Type: Pipe/Zone

- Fire Return Line
- Line A
- Line B
- Line C
- Line D
- Mainline
- Control Line

**Base Map Line Feature**

- Base Map Line Feature

**Description**

- Tree/Deciduous
- Tree/Evergreen
- Base Map Huge Tree
- Other

**Description**

- Play Ground
- Sidewalk
- Base Map Park Perimeter (Estimated)

Copyright 2004  
Hysham Enterprises

GPS Data Collected and  
Map Created By



1925 Grand Ave, Suite 103  
Billings, MT 59102  
(406) 860-6196

In Association With



160 GRAND AVE, SUITE 100  
P.O. BOX 2040  
BILLINGS, MT 59102  
(406) 251-7444 FAX 251-4853

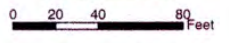

Page 2 of 2