



# COTTONWOOD PARK

MASTER PLAN **2024**



# COTTONWOOD PARK

# COMMUNITY CONTEXT



# COTTONWOOD PARK

# SITE CONTEXT



# COTTONWOOD PARK

# SITE CONTEXT

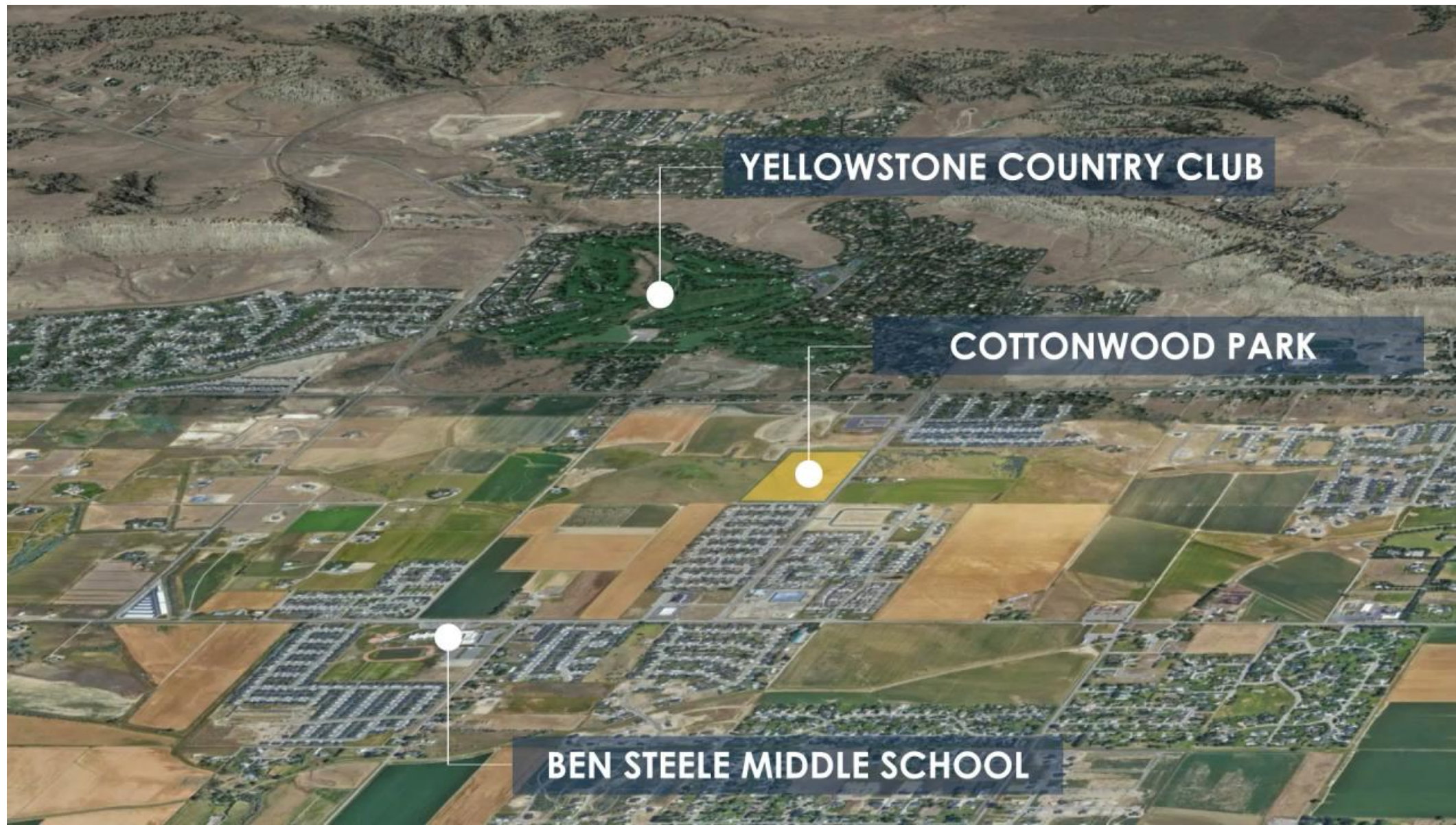

YELLOWSTONE COUNTRY CLUB

COTTONWOOD PARK

BEN STEELE MIDDLE SCHOOL

# COTTONWOOD PARK

# SITE CONTEXT



# HISTORY

- PROPERTY DONATED BY FORBES FAMILY
- PROPERTY BECAME CITY PARK IN 2002
- 38 ACRE PARCEL

## PARK VISION:

“A MULTI-FUNCTIONAL COMMUNITY PARK SUITABLE FOR CASUAL PLAY, PICNICKING, CONCERTS, STROLLING, COMMUNITY EVENTS AND THE LIKE.”

# PROPERTY DONATION

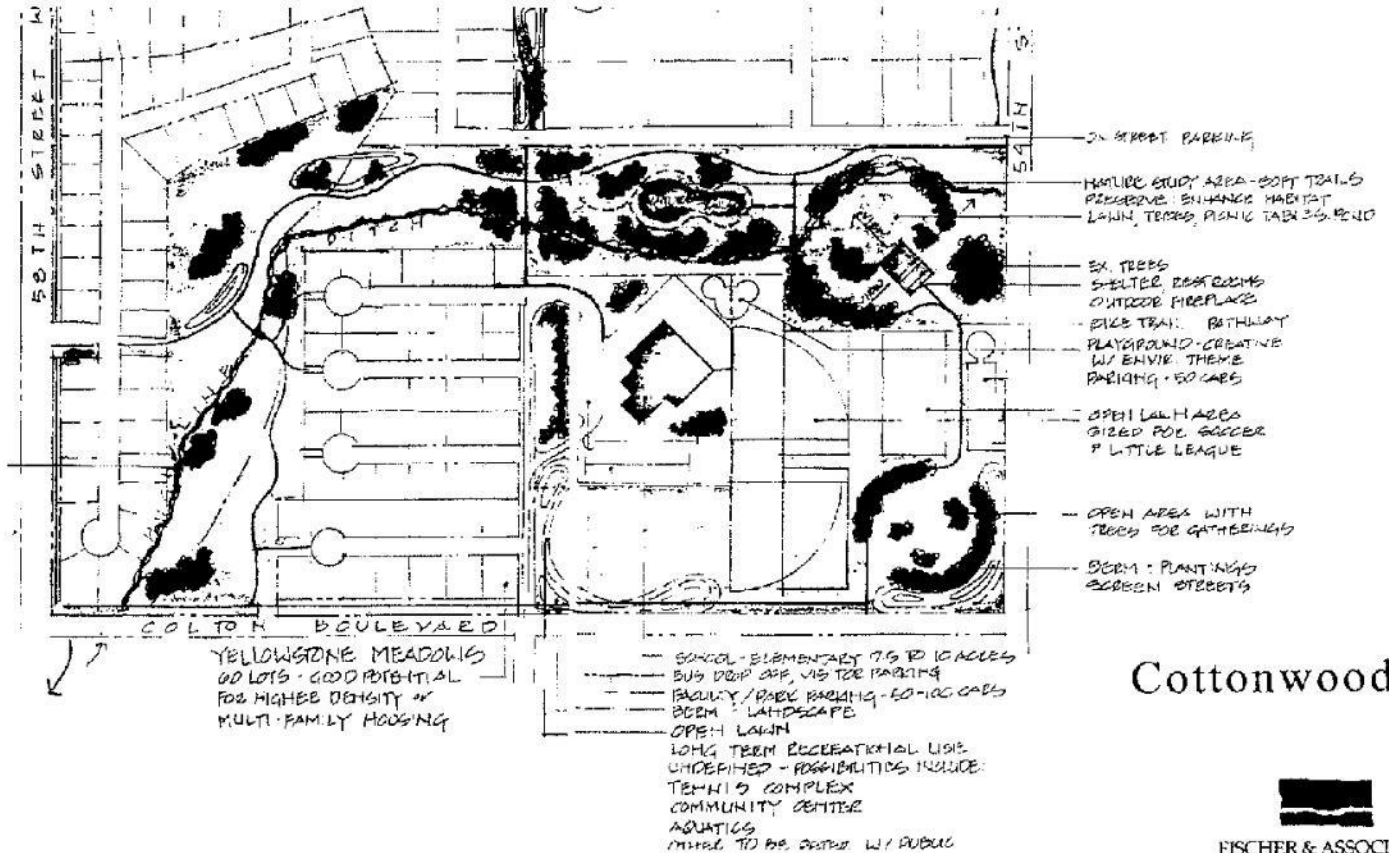

Cottonwood Park

# PROPERTY DEDICATION

# PROGRAM REQUIREMENTS & DESIRED IMPROVEMENTS

## REQUIREMENTS

- TURF GRASS
- ABUNDANCE OF TREES
- CHILDREN'S PLAYGROUND EQUIPMENT
- RESTROOM FACILITIES
- PICNIC TABLES
- OPEN SPACE FOR DIVERSE ACTIVITIES
- ONE LARGE PICNIC SHELTER

## RESTRICTIONS

- SPORTS COMPLEX
- POLICE STATION
- FIRE STATION
- MAINTENANCE (EXCEPT FOR PARK OPERATION)

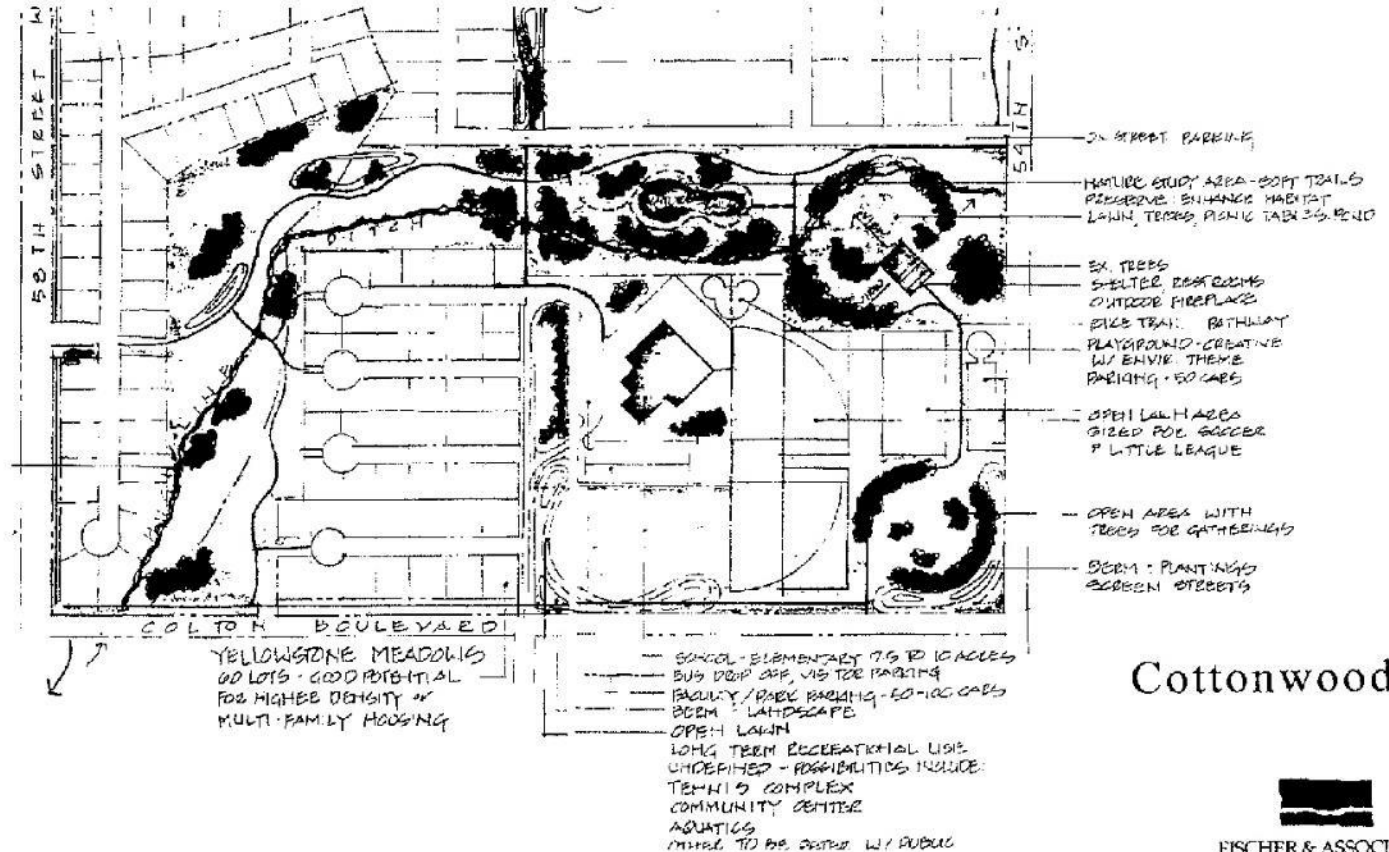

Cottonwood Park

# COTTONWOOD PARK

# PUBLIC PROCESS TIMELINE

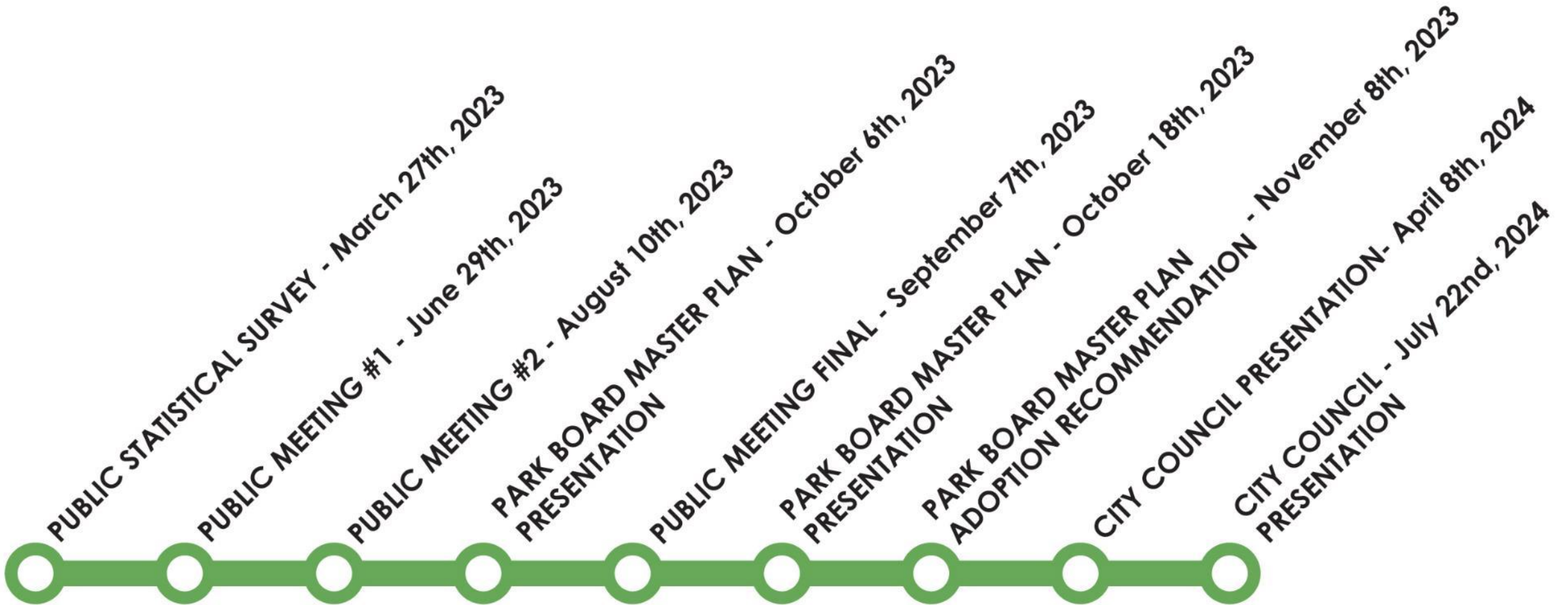

# COTTONWOOD PARK

# FINAL MASTER PLAN

## PLAN FEATURES

TURF AREA:	20 ACRES
MEMORIAL POND:	0.75 ACRES
PARKING LOT:	227 SPACES
SMALL SHELTERS:	11
PAVED TRAILS:	13,900 LINEAR FEET
GRAVEL TRAILS:	900 LINEAR FEET
COMMUNITY CENTER:	24,000 SF
PICKLEBALL COURTS:	8
BASKETBALL COURTS:	2
TENNIS COURTS:	5
LARGE PLAYGROUND:	30,000 S.F.
DOG PARK:	3.3 ACRES

**ESTIMATED COST RANGE:**  
**\$25,000,000 - \$30,000,000**



# COTTONWOOD PARK

# COST ESTIMATE

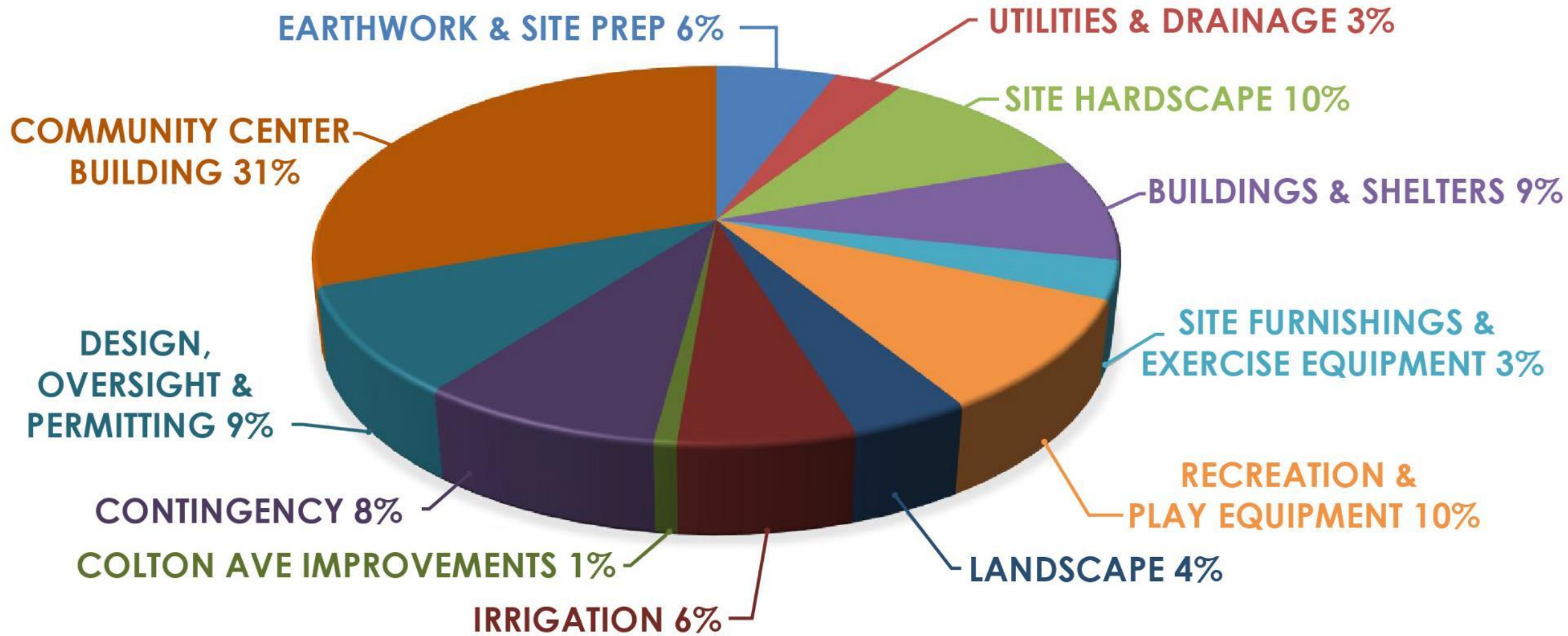

**TOTAL ESTIMATED COST \$25,000,000 - \$30,000,000**

**COTTONWOOD PARK**

**3D RENDERING**

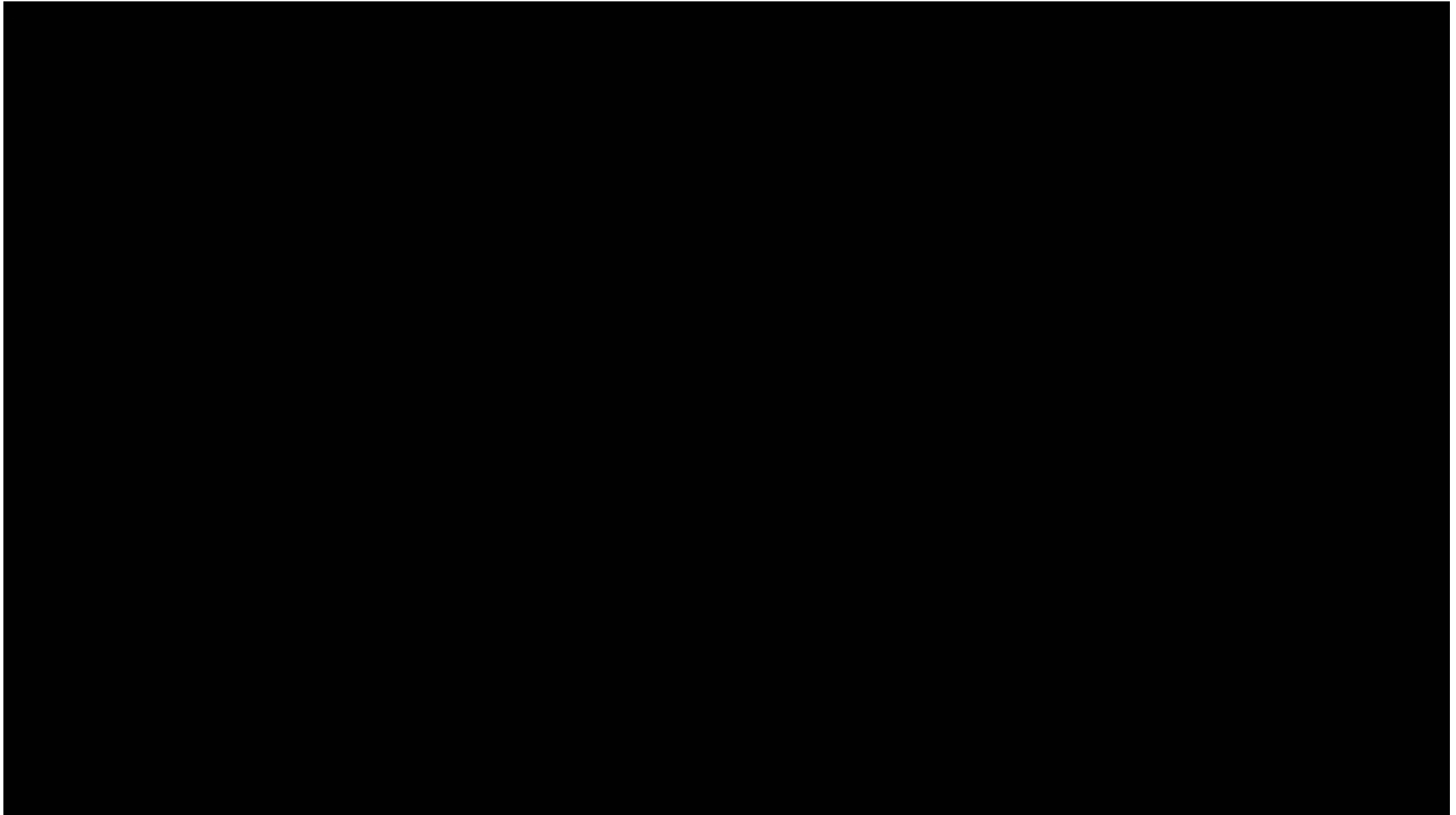



# COTTONWOOD PARK

MASTER PLAN **2024**

