

August 20, 2024

City of Billings Subdivision Regulations Update 2024 - Lighting

Dear Mac Fogelsong,

NorthWestern Energy (NWE) has put together a lighting example of what lighting in a subdivision would cost to install with having NWE installing everything.

Assumptions:

- 75 FT lot fronts
- Typical 50-60 FT road right-of-way
- 6 lights – Shoebox 125W LED
- 25 FT pole- 20 FT light mounting height
- 500 FT trench
- Pull boxes on each light
- New construction (during roadway subdivision construction)

Attached in Exhibit A is a rough sketch of what a subdivision lighting layout could look like and what the rough cost breakdown would be. These lights would illuminate both side of the roadway. NorthWestern Energy would supply all the labor and materials associated with installing these lights.

All of these assumptions and examples above are subject to change based on what the actual project scope is within the City of Billings. NorthWestern Energy does NOT do any lighting study to make sure the ANSI/IES RP-8 requirements and regulations are met. That study would have to be performed by the customer or a third party vendor. NWE would work with said customer/vendor on what lights NWE has to offer and what would work best for the subdivision.

Sincerely,

Cody Lux, PE

Cody Lux, PE

Billings Construction Superintendent

cody.lux@northwestern.com

C 406-570-8768

Billings New Construction 1-833-672-8453

24-Hour Service 888-467-2669

1944 Monad Rd | Billings, MT 59102

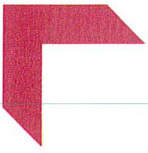
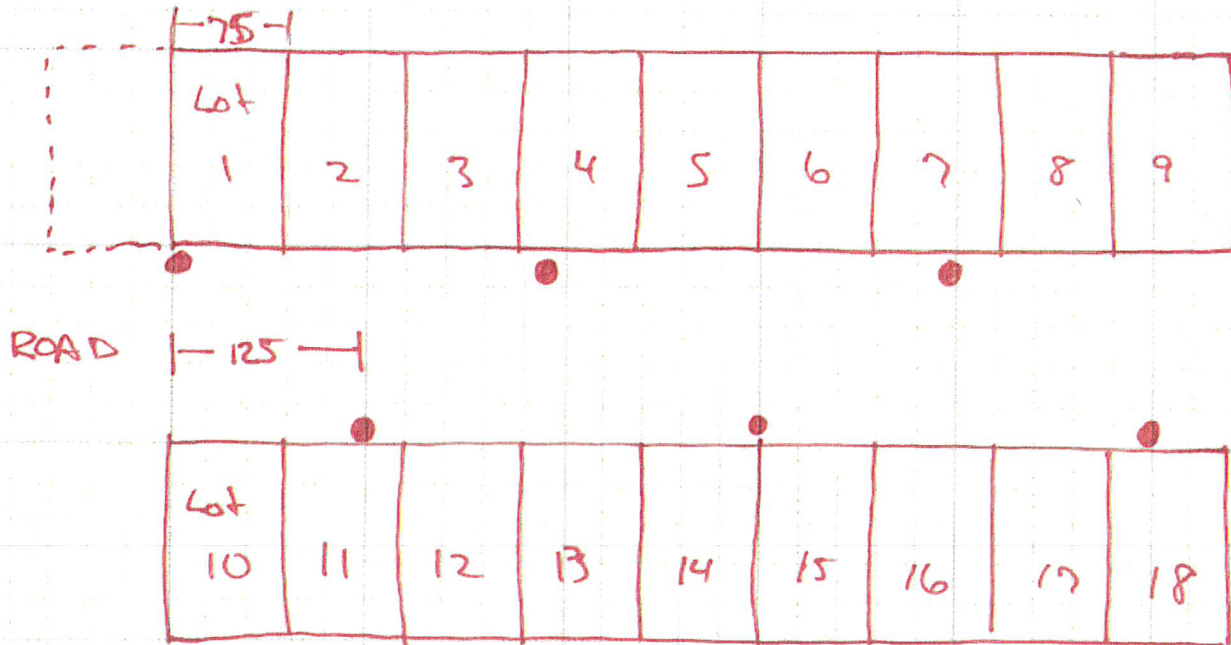

Exhibit A



\$ 432.52 / mo - 6 Lights

\$ 72.09 / mo / Light

\$ 5,190.24 / yr - 6 Lights

÷ 18 homes - \$ 288.35 / home / year

÷ 12 months - \$ 24.03 / home / mo

\$ 24.03 / home / month

Cody Lux, PE

Billings Construction Superintendent

cody.lux@northwestern.com

C 406-570-8768

Billings New Construction 1-833-672-8453

24-Hour Service 888-467-2669

1944 Monad Rd | Billings, MT 59102