

THIS DRAWING IS THE PROPERTY OF THE LANDSCAPE ARCHITECT. IT HAS BEEN PREPARED SPECIFICALLY FOR THIS SITE AND IS NOT TO BE USED FOR ANY OTHER PURPOSE, LOCATION, OR OWNER WITHOUT WRITTEN CONSENT OF THE LANDSCAPE ARCHITECT.

COULSON PARK SOUTH IMPROVEMENTS LAYOUT & MATERIALS PLAN

COPYRIGHT 2024
STEINER THUESEN PLLC

STEINER THUESEN PLLC

GOLF COURSE ARCHITECTURE
IRRIGATION DESIGN
LANDSCAPE ARCHITECTURE
1925 GRAND AVE. SUITE 105
P.O. BOX 22943
BILLINGS, MT 59104
406/252-5545 FAX 245-9855

DRAWN BY: JAV, GSG
DATE: 9/6/24
CHECKED BY: NGS
DATE: 9/6/24
REV: -
REV: -
FILE: L1 LAYOUT & MATERIALS PLAN.DGN

SHEET
L1



LEGEND:

- CONSTRUCTION LIMITS
- G - EXISTING GAS LINE, REFER TO PLAN FOR BURY DEPTH
- OHP - EXISTING OVERHEAD ELECTRICAL
- 315±.0 - EXISTING CONTOUR (1' INTERVAL)
- EXISTING POST AND RAIL FENCE
- 6' WIDE GRAVEL TRAIL, SEE 2/L3
- CONCRETE PARKING AREA: 6" OF CONCRETE OVER 6" OF 1-1/2" MINUS COMPACTED AGGREGATE AS SPECIFIED, SEE 1/L3.
- CONCRETE WALKWAY: 4" OF CONCRETE OVER 4" OF 1-1/2" MINUS COMPACTED AGGREGATE AS SPECIFIED, SEE 1&3/L3.

NOTES:

1. CONTRACTOR TO VERIFY EXISTING CONDITIONS AND LOCATION OF ALL UTILITIES PRIOR TO CONSTRUCTION.
2. ANY DAMAGE TO EXISTING UTILITIES ON-SITE OR ADJACENT PROPERTY SHALL BE CONTRACTOR'S RESPONSIBILITY.
3. PROVIDE SUBMITTALS FOR PARKING LOT STRIPING, ADA SIGNAGE, PARKING BLOCKS ETC.
4. LAYOUT OF GRAVEL TRAIL IN WOODED AREA IS CONCEPTUAL. CONTRACTOR TO STAKE TRAIL. SITE CLEARING TO BE PROVIDED BY CONTRACTOR TO ACCOMMODATE TRAIL CONSTRUCTION. CLEARING TO BE MINIMIZED TO RETAIN NATURAL CHARACTER OF SITE. COORDINATE W/ LANDSCAPE ARCHITECT TO FIELD ADJUST AS REQUIRED TO FIT TO SITE.
5. ALL CONCRETE SHALL BE 4000 PSI MIN.
6. REFER TO DETAILS AND SPECIFICATIONS FOR ADDITIONAL INFORMATION.

KEY NOTES:

- 1 EXISTING GRAVEL PARKING AREA.
- 2 ROCK BENCHES (22" X 48"), SEE 4/L3.
- 3 GRAVEL GATHERING AREA AT POINT. ENTIRE AREA TO BE GRADED SMOOTH WITHIN SOLID RED LINE AT COMPLETION OF PROJECT.
- 4 40' X 60' SHELTER PURCHASED BY OWNER, INSTALLED BY CONTRACTOR, SEE L4 & L5.
- 5 FUTURE RESTROOM LOCATION.
- 6 ROCK BENCHES (22" X 48"), SEE 4/L3. PROVIDE 12"-18" W X 4" DEEP SECTION OF CRUSHER FINES AROUND BASE AT LOCATIONS ALONG TRAIL.
- 7 4'-5" BERM SEE GRADING PLAN.
- 8 IMPROVEMENTS TO BE 10' MIN. OFF BANK. FIELD VERIFY WITH LANDSCAPE ARCHITECT PRIOR TO BEGINNING CONSTRUCTION.
- 9 ACCESSIBLE VAN PARKING SIGN ON 2" SQ GALVANIZED POST, SEE 5/L3. COORDINATE W/ PHILLIPS 66 PRIOR TO EXCAVATIONS AT SIGNS ADJACENT TO UTILITY. EXCAVATION SHALL BE NON-MECHANICAL.
- 10 ACCESSIBLE PARKING SIGN ON 2" SQ GALVANIZED POST, SEE 5/L3. COORDINATE W/ PHILLIPS 66 PRIOR TO EXCAVATIONS AT SIGNS ADJACENT TO UTILITY. EXCAVATION SHALL BE NON-MECHANICAL.
- 11 6" CONCRETE PARKING BUMPER WITH REINFORCING, PIN TO SURFACE, TYP.
- 12 48" PAINTED ADA PARKING EMBLEM, VERIFY CITY REQUIREMENTS, TYP.
- 13 4" WIDE PARKING LOT STRIPING, TYPICAL (YELLOW).
- 14 4" WIDE STRIPING AT 45° ANGLE, 24" O.C. (YELLOW).
- 15 PROJECT SIGN, SEE DETAIL 8/L3.
- 16 (6) EXISTING BOULDERS TO BE RELOCATED, SEE KEY NOTE #17. COORDINATE WITH LANDSCAPE ARCHITECT.
- 17 RELOCATED BOULDER - 4' BETWEEN - FIELD LOCATE WITH LANDSCAPE ARCHITECT. FILL LOW SPOTS UNDER BOULDERS WITH MATERIAL FROM ON-SITE EXCAVATION.
- 18 TRENCH DRAIN, SEE 7/L3. FIELD FIT TO EXISTING GRADES.
- 19 12" CMP CULVERT W/ FLARED END SECTIONS. FIELD FIT TO EXISTING GRADES.
- 20 CREATE 6'-6" WIDE OPENING AT EXISTING FENCE. INSTALL NEW POSTS AND ADJUST RAILS TO FIT.
- 21 EXISTING CONCRETE TRAIL.
- 22 BIKE RACKS, SEE 6/L3.

WARNING: High Pressure Pipeline(s).
No Excavation or Construction in this area without ONE-CALL and without contacting Phillips 66 PipeLine LLC (P66PL) at [phone number]

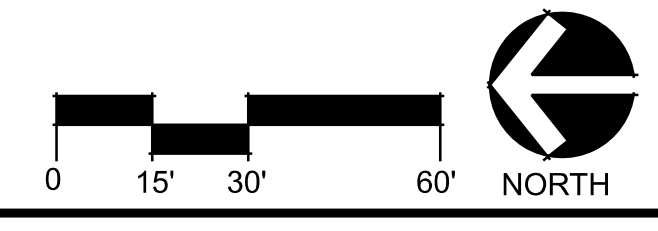

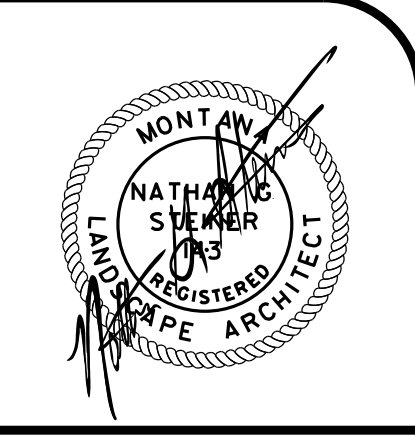

THIS DRAWING IS THE PROPERTY OF THE LANDSCAPE ARCHITECT. IT HAS BEEN PREPARED SPECIFICALLY FOR THIS SITE AND IS NOT TO BE USED FOR ANY OTHER PURPOSE, LOCATION, OR OWNER WITHOUT WRITTEN CONSENT OF THE LANDSCAPE ARCHITECT.

COULSON PARK SOUTH IMPROVEMENTS SITE GRADING PLAN

COPYRIGHT 2024
STEINER THUESEN PLLC

STEINER THUESEN PLLC

GOLF COURSE ARCHITECTURE
IRRIGATION DESIGN
LANDSCAPE ARCHITECTURE
1925 GRAND AVE. SUITE 105
BILLINGS, MT 59104
406/252-5545 FAX 245-9855

DRAWN BY: JAV, GSG
DATE: 9/6/24
CHECKED BY: NGS
DATE: 9/6/24
REV: -
REV: -
FILE: L2 SITE GRADING PLAN.DGN

SHEET
L2



LEGEND:

	CONSTRUCTION LIMITS
	EXISTING GAS LINE, REFER TO PLAN FOR BURY DEPTH
	EXISTING OVERHEAD ELECTRICAL
	EXISTING CONTOUR (1' INTERVAL)
	EXISTING POST AND RAIL FENCE
	6' WIDE GRAVEL TRAIL, SEE 2/L1.3
	PROPOSED CONTOUR (1' INTERVAL)
	FINISH SPOT GRADE
	MATCH EXISTING GRADE
	HIGH POINT
	LOW POINT

- NOTES:**
- CONTRACTOR TO VERIFY EXISTING CONDITIONS AND LOCATION OF ALL UTILITIES PRIOR TO CONSTRUCTION. ANY DAMAGE TO EXISTING UTILITIES ON-SITE OR ADJACENT PROPERTY SHALL BE CONTRACTOR'S RESPONSIBILITY.
 - STRIP VEGETATION AND TOPSOIL AS REQUIRED TO ACCOMMODATE CONSTRUCTION.
 - CONCRETE WALKWAY SLOPES SHALL MEET THE FOLLOWING ADA REQUIREMENTS:
 - LONGITUDINAL SLOPE: 1:20 MAX. (5%)
 - CROSS SLOPE: 1:48 MAX. (2%)
 - PARKING SLOPE NOT STEEPER THAN 1:48 (2%)
 - PROVIDE 1.5% CROSS SLOPE ON WALKWAYS.
 - ALL DISTURBED AREA SHALL BE RESTORED WITH LIKE MATERIALS. (CRUSHED AGGREGATE, SEED ETC.)
 - ALL DISTURBED AREAS SHALL BE RESTORED WITH SEED. PLACE 4" MIN. OF ON-SITE TOPSOIL PRIOR TO SEEDING.
 - FINISH GRADE ALONG CONCRETE TO BE 1" BELOW TOP OF CONCRETE PRIOR TO SEEDING.
 - GRAVEL TRAILS TO BE FIT TO EXISTING SITE GRADES AS MUCH AS POSSIBLE.
 - REFER TO DETAILS AND SPECIFICATIONS FOR ADDITIONAL INFORMATION.

- KEY NOTES:**
- TIE BACK TO EXISTING GRADES AT 15:1 SLOPE MAX UNLESS NOTED OTHERWISE.
 - TIE BACK INTO EXISTING GRADES WITH 1" MINUS CRUSHED AGGREGATE AT 15:1 SLOPE MAX. COMPACT TO 95%.
 - FIT TRENCH DRAIN TO EXISTING GRADES.
 - MAINTAIN EXISTING SWALE.
 - EXISTING TREES TO REMAIN. GRADE AROUND BASE AS NECESSARY TO PROTECT ROOTS.

WARNING: High Pressure Pipeline(s)
No Excavation or Construction in this area without ONE-CALL and without contacting Phillips 66 PipeLine LLC (P66PL) at [phone number]

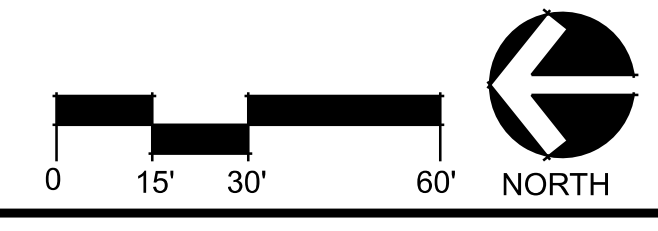

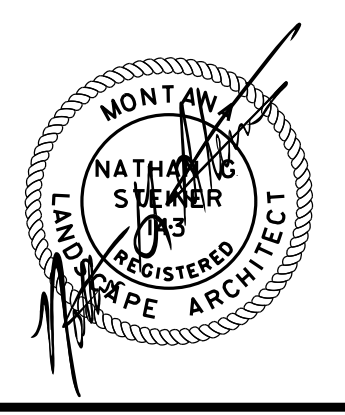

THIS DRAWING IS THE PROPERTY OF THE LANDSCAPE ARCHITECT. IT HAS BEEN PREPARED SPECIFICALLY FOR THIS SITE AND IS NOT TO BE USED FOR ANY OTHER PURPOSE. LOCATION, OR OWNER WITHOUT WRITTEN CONSENT OF THE LANDSCAPE ARCHITECT.

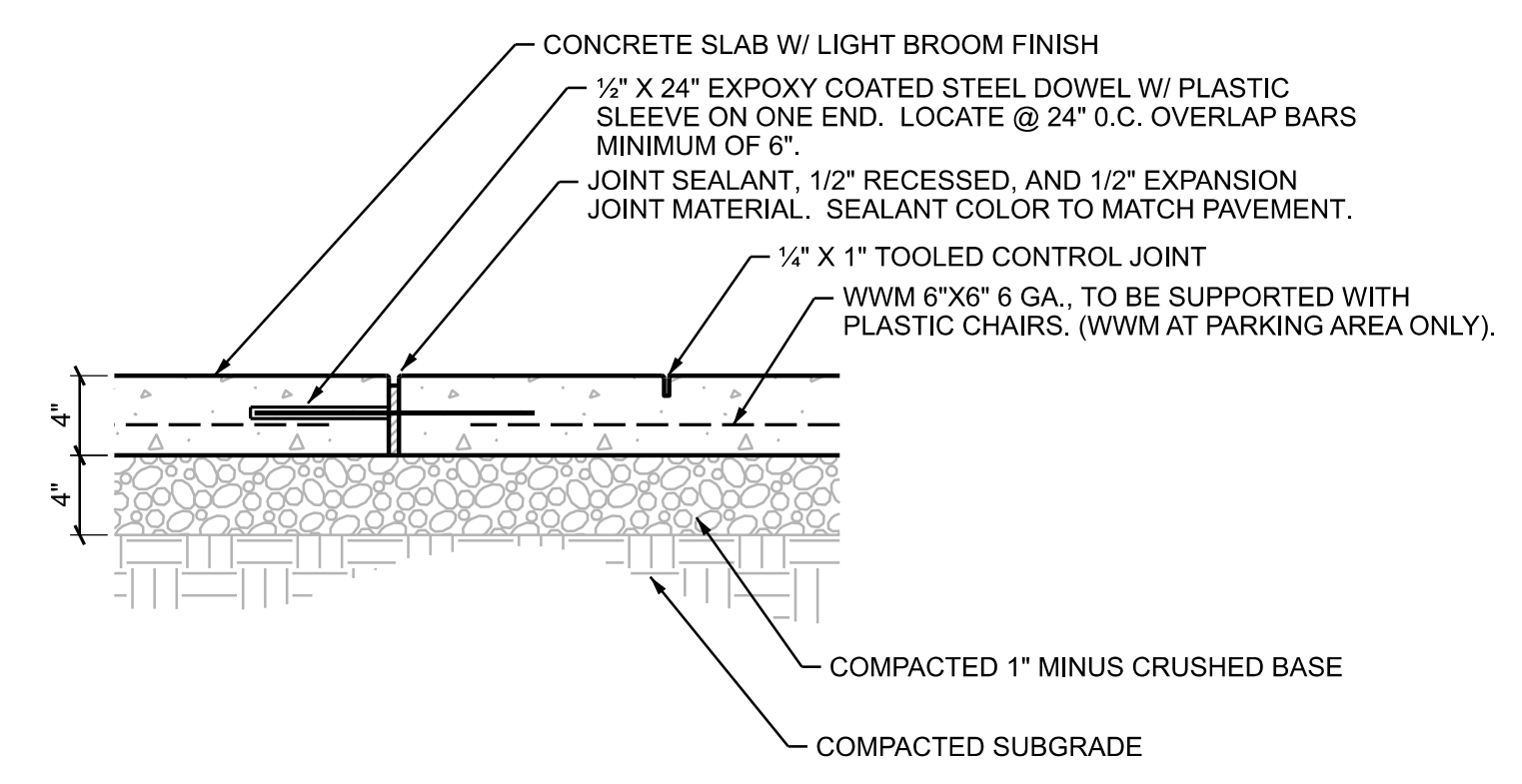

NOTES:
 1. 6" CONCRETE OVER 6" OF AGGREGATE AT PARKING.
 2. SAWCUT JOINTS ARE NOT ALLOWED.
 3. DOWELS REQUIRED AT CONNECTION TO EXISTING WALKWAY.

1 CONCRETE FLATWORK NOT TO SCALE

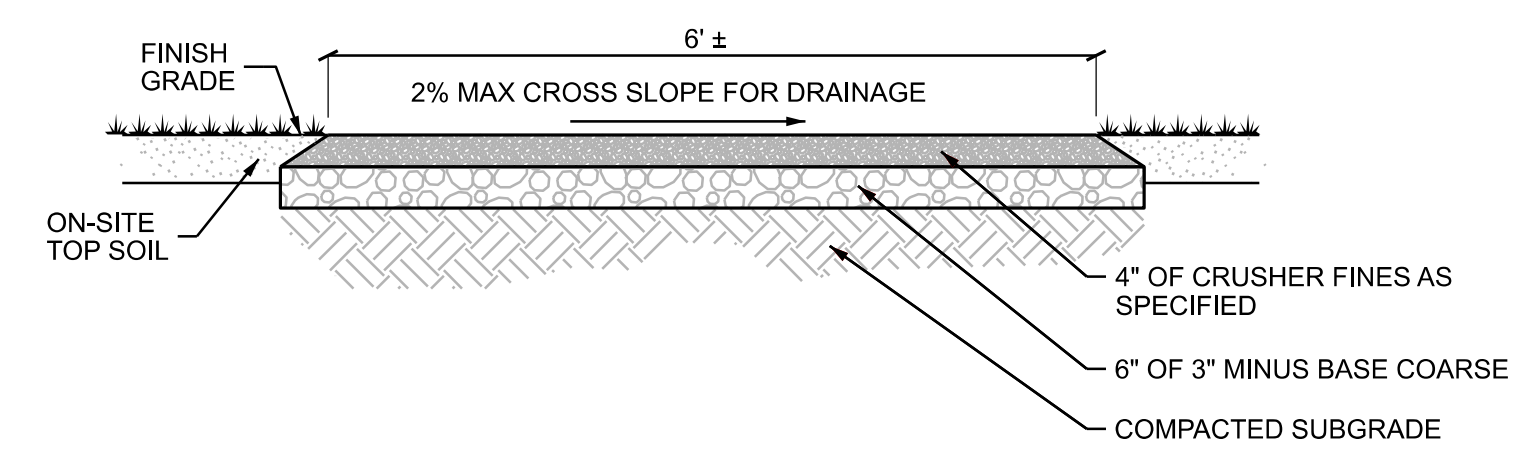

NOTES:
 1. DISTURBED AREAS ALONG PATHWAY TO BE SEEDED AS SPECIFIED.
 2. COMPACT SUBGRADES AND AGGREGATES TO 95% PROCTOR.

2 TYPICAL GRAVEL TRAIL SECTION NOT TO SCALE

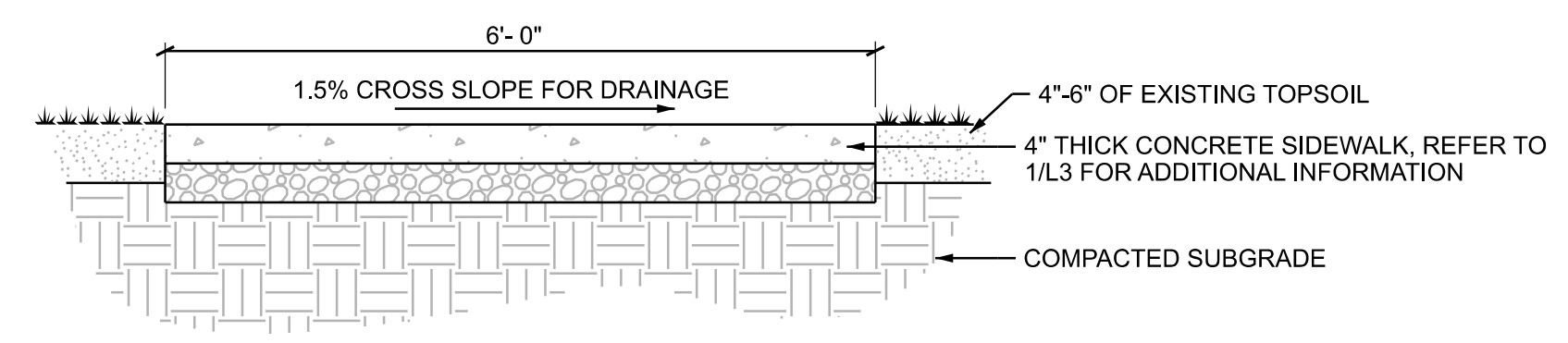

3 TYPICAL SIDEWALK SECTION NOT TO SCALE

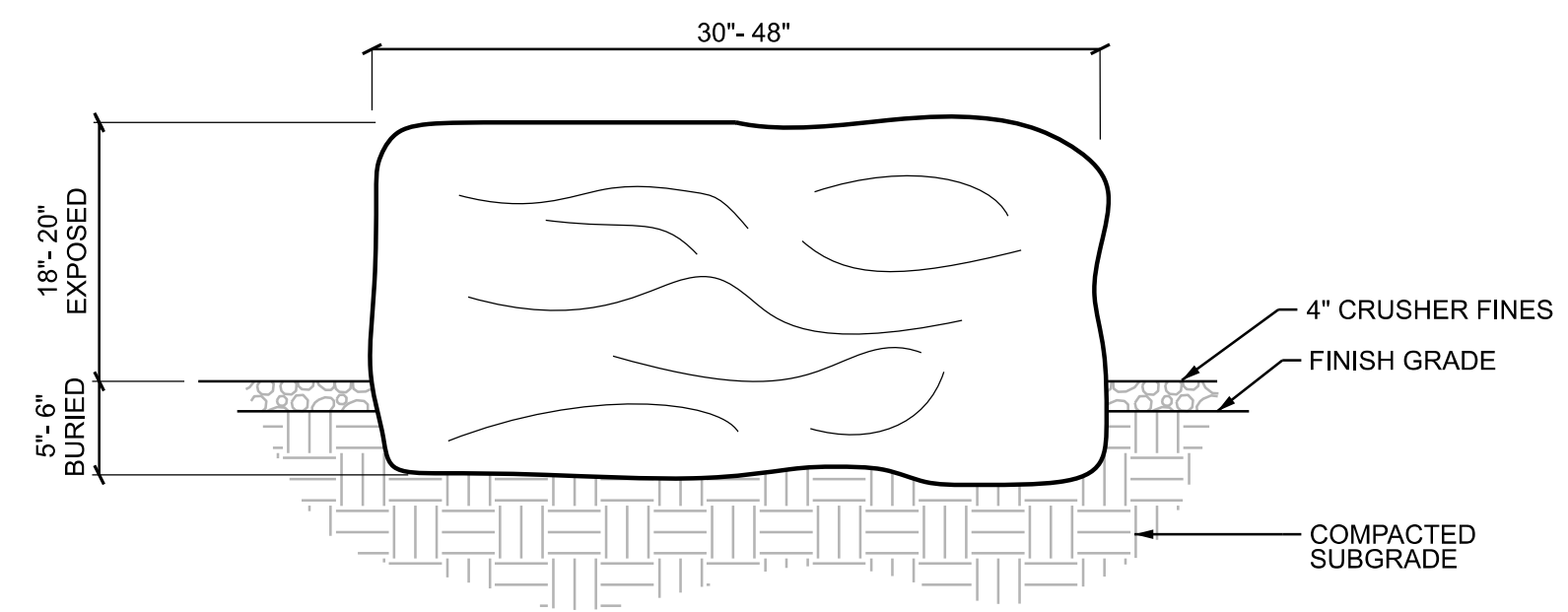

NOTES:
 1. 22" BLOCK ROCK AS SUPPLIED BY YVRS 406-670-9114 OR EQUAL APPROVED IN ADVANCE.

4 ROCK BENCH INSTALLATION NOT TO SCALE

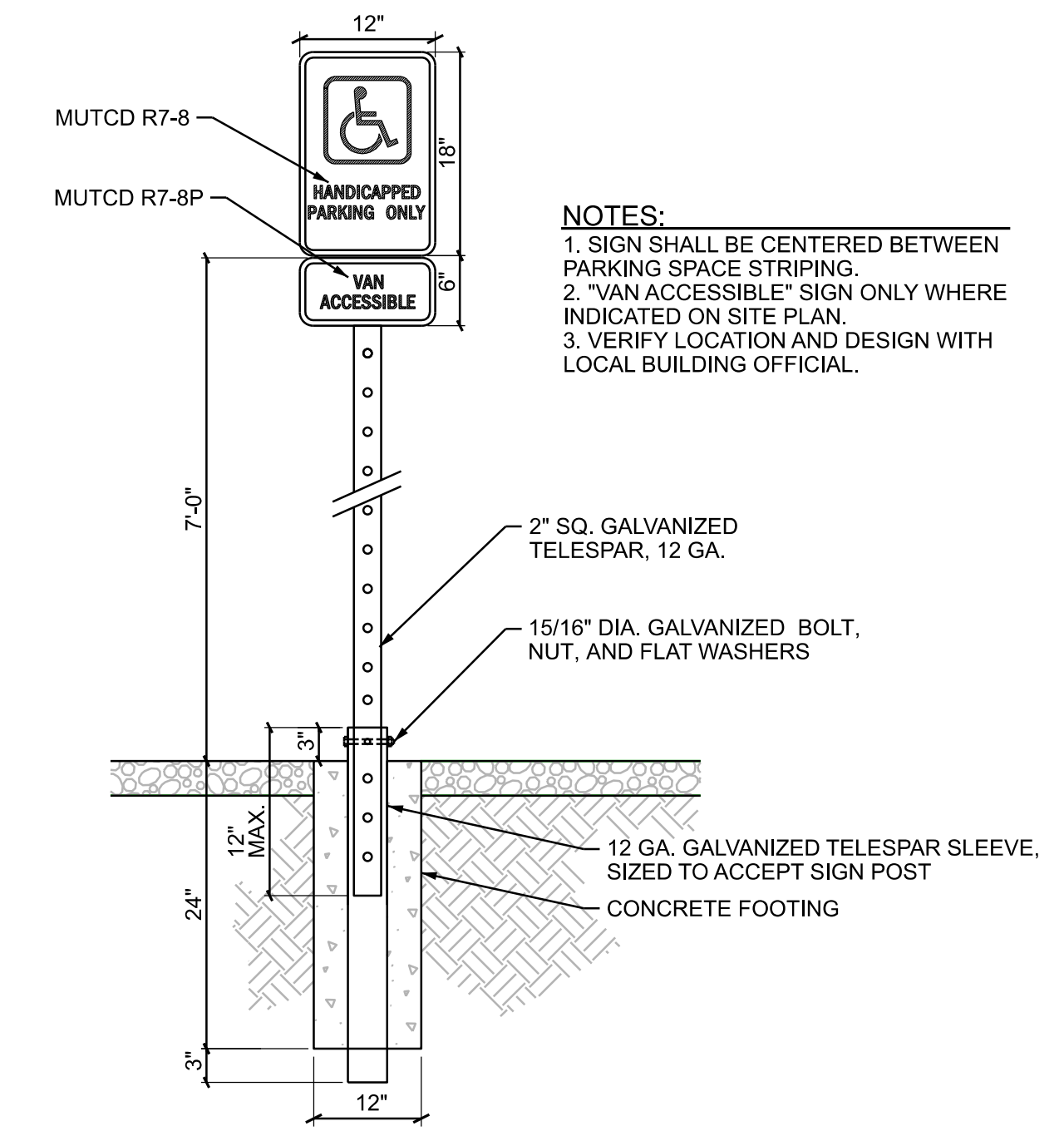

NOTES:
 1. SIGN SHALL BE CENTERED BETWEEN PARKING SPACE STRIPING.
 2. "VAN ACCESSIBLE" SIGN ONLY WHERE INDICATED ON SITE PLAN.
 3. VERIFY LOCATION AND DESIGN WITH LOCAL BUILDING OFFICIAL.

5 HANDICAP ACCESSIBLE PARKING SIGN NOT TO SCALE

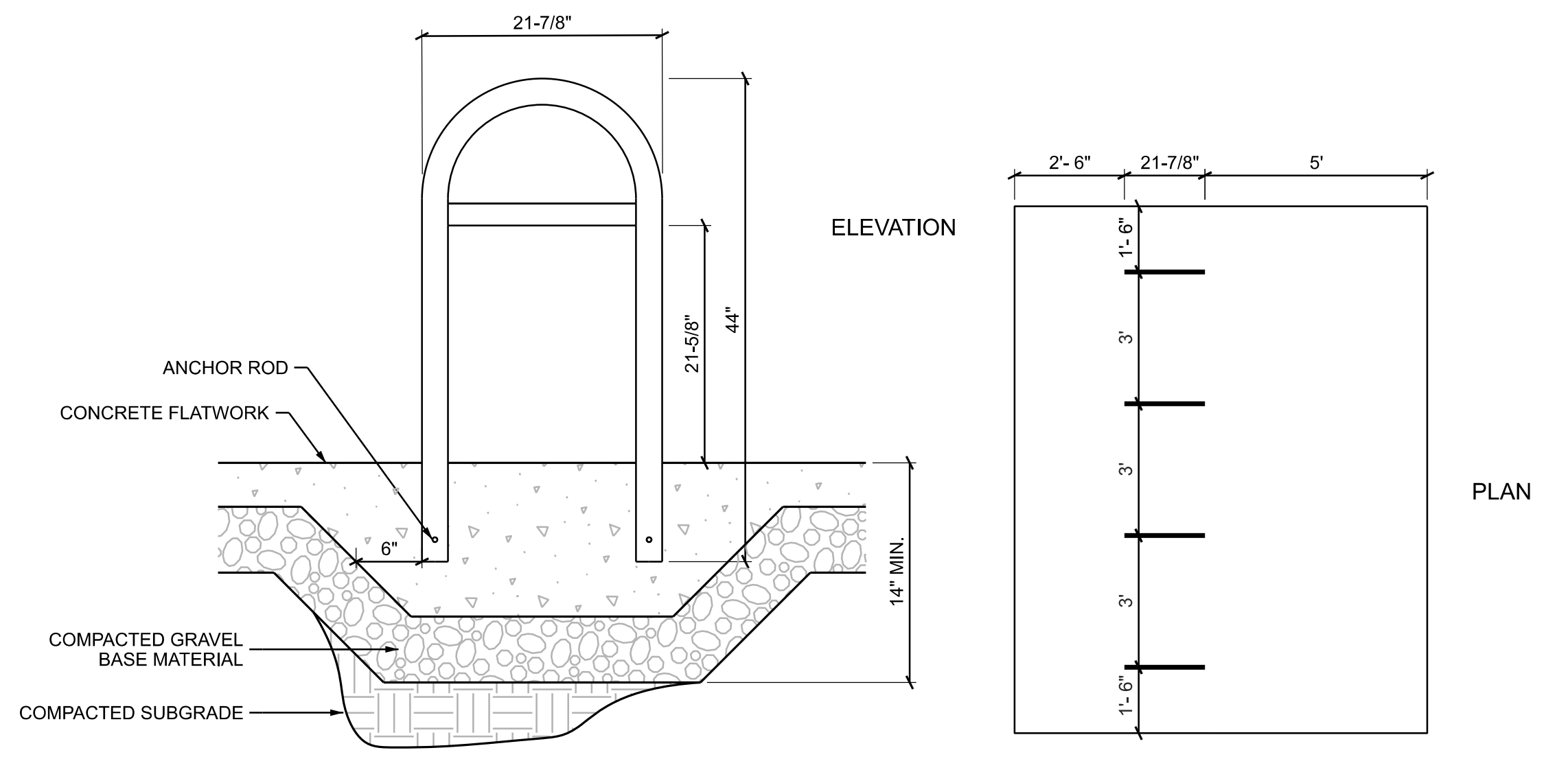

NOTES:
 1. BIKE RACK SHALL BE U238-LB-IG-P (BLACK POWDER COAT FINISH) MANUFACTURED BY MADRAX.
 2. INSTALL ACCORDING TO MANUFACTURER'S RECOMMENDATIONS.
 3. SEE L1 FOR LOCATIONS.

6 BIKE RACK NOT TO SCALE

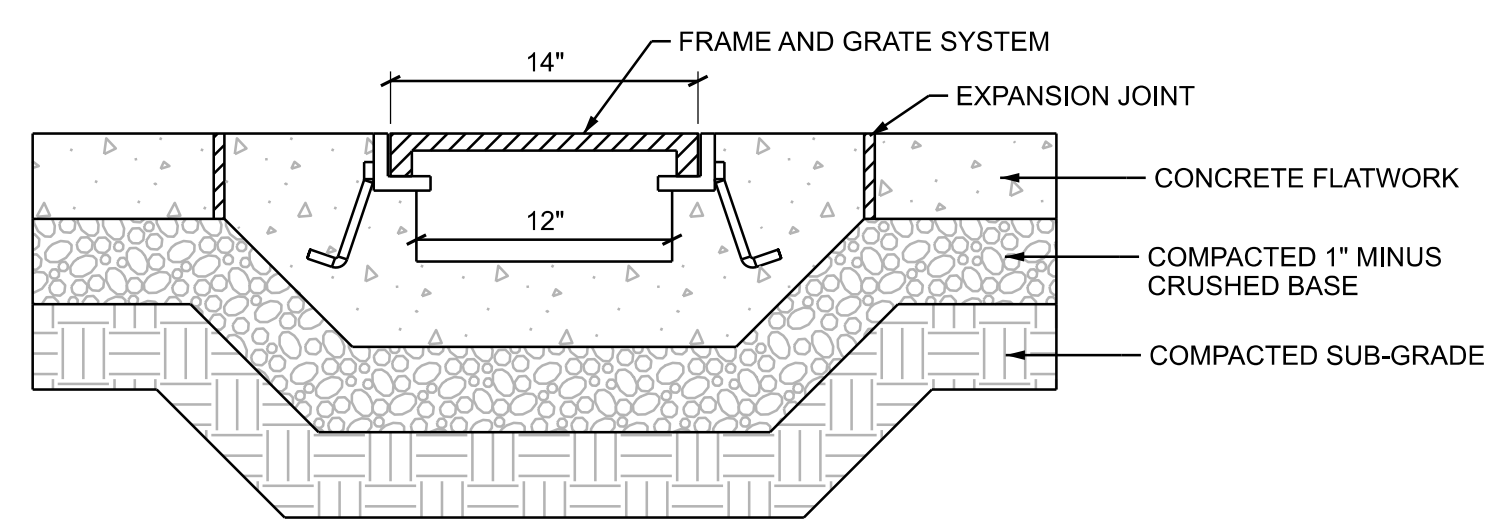

NOTES:
 1. FRAME AND GRATE SYSTEM TO BE NEENAH R-4999-DX W/ TYPE D SOLID LID. PROVIDE SUBMITTALS.
 2. TRENCH DRAIN TO BE APPROXIMATELY 6" DEEP. BOTTOM TO MATCH EXISTING SWALE DEPTH AND SLOPE. ADJUST AS REQUIRED.
 3. REFER TO CONCRETE FLATWORK DETAIL FOR ADDITIONAL INFORMATION.

7 TRENCH DRAIN NOT TO SCALE

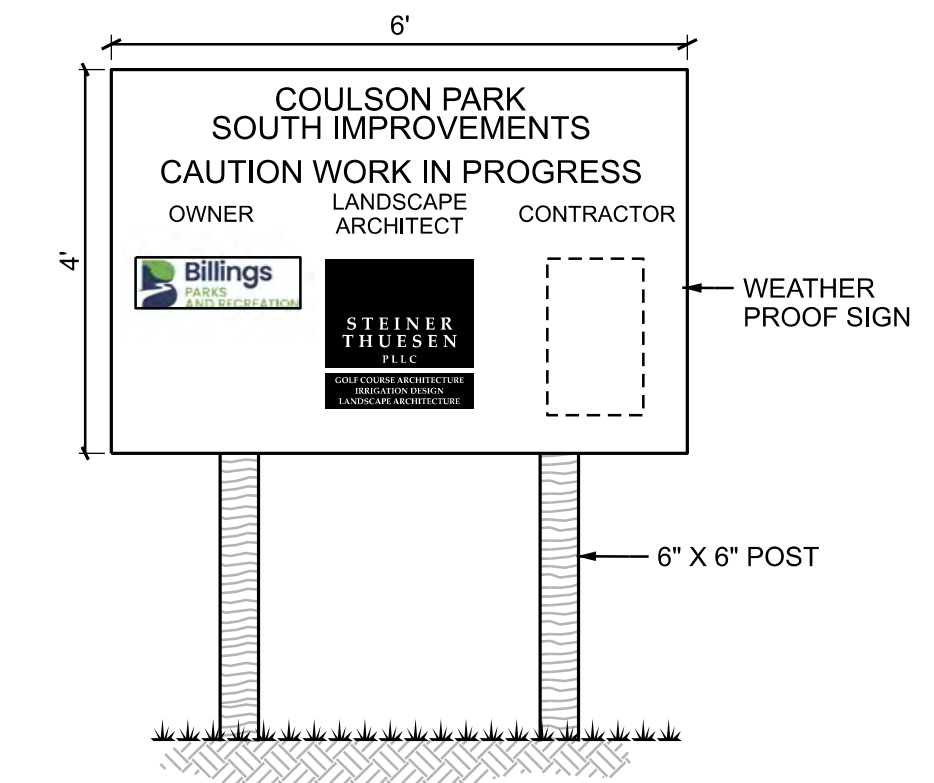

NOTES:
 1. PROVIDE COLOR SHOP DRAWING FOR APPROVAL.
 2. BACKGROUND TO BE WHITE.
 3. PROJECT TITLE TO BE GREEN.
 4. "OWNER", "LANDSCAPE ARCHITECT", AND "CONTRACTOR" TO BE BLACK.
 5. LOGOS TO BE FULL COLOR.
 6. LOCATION TO BE DETERMINED.
 7. REMOVE AT END OF PROJECT.

8 PROJECT SIGN NOT TO SCALE

COULSON PARK SOUTH IMPROVEMENTS
 SITE DETAILS

COPYRIGHT 2024
 STEINER THUESEN PLLC

STEINER THUESEN PLLC
 GOLF COURSE ARCHITECTURE
 IRRIGATION DESIGN
 LANDSCAPE ARCHITECTURE
 1925 GRAND AVE. SUITE 105
 P.O. BOX 22943
 BILLINGS, MT 59104
 406/252-5545 FAX 245-9855

DRAWN BY: JAV_GSG
 DATE: 9/6/24
 CHECKED BY: NGS
 DATE: 9/6/24
 REV: -
 REV: -
 FILE: L3 SITE DETAILS.DGN

SHEET
 L3

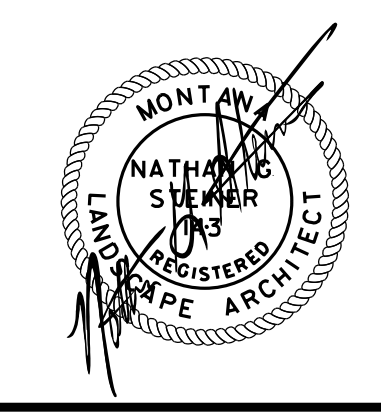

THIS DRAWING IS THE PROPERTY OF THE LANDSCAPE ARCHITECT. IT HAS BEEN PREPARED SPECIFICALLY FOR THIS SITE AND IS NOT TO BE USED FOR ANY OTHER PURPOSE, LOCATION, OR OWNER WITHOUT WRITTEN CONSENT OF THE LANDSCAPE ARCHITECT.

COULSON PARK SOUTH IMPROVEMENTS
SHELTER DETAILS

COPYRIGHT 2024
STEINER THUESEN PLLC

STEINER THUESEN
PLLC

GOLF COURSE ARCHITECTURE
IRRIGATION DESIGN
LANDSCAPE ARCHITECTURE

1925 GRAND AVE. SUITE 105
P.O. BOX 22943
BILLINGS, MT 59104
406/252-5545 FAX 245-9855

DRAWN BY: JAV_GSG
DATE: 9/6/24
CHECKED BY: NGS
DATE: 9/6/24
REV: -
REV: -
FILE: L4-SHELTER DETAILS.DGN

SHEET
L4

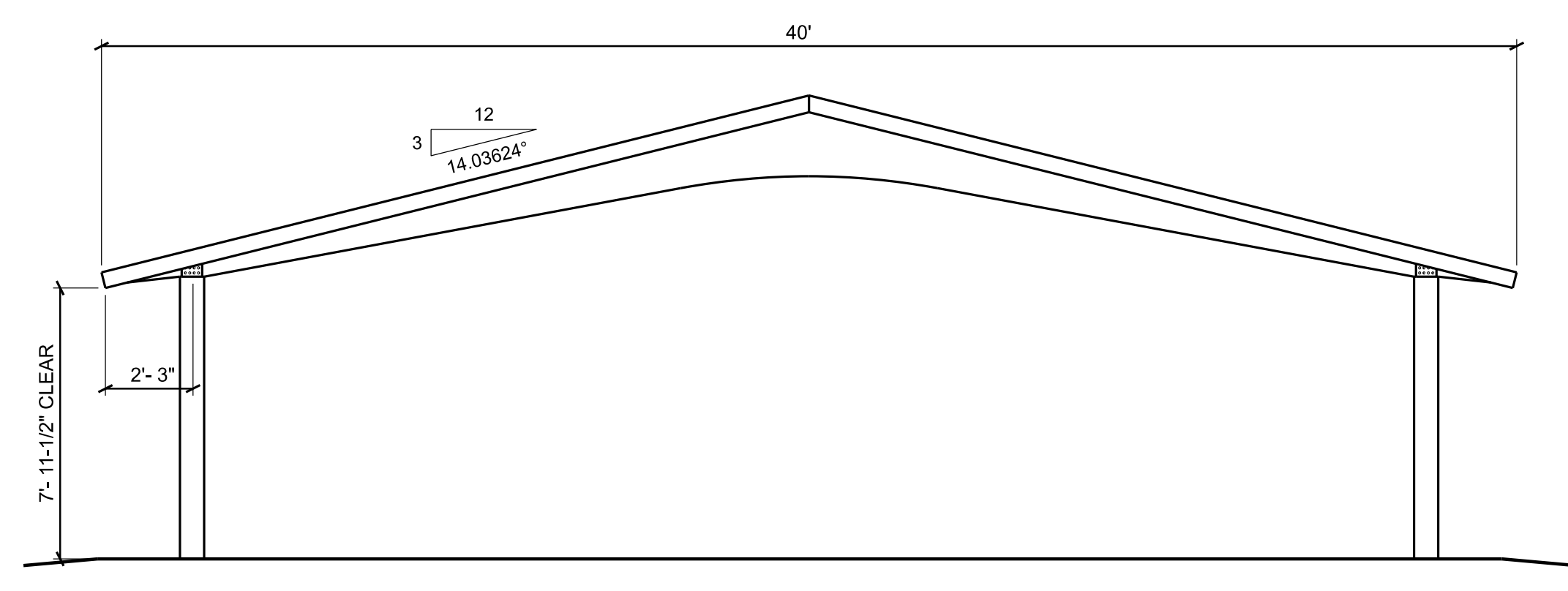

1 END ELEVATION

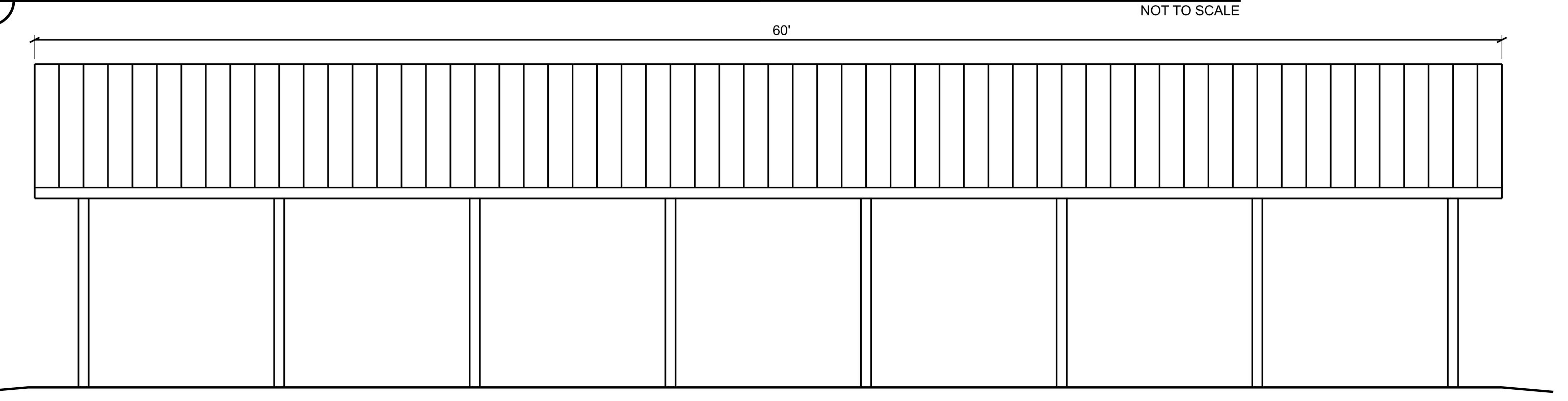

2 SIDE ELEVATION

NOTES:
1. DRAWINGS & DETAILS ARE REPRESENTATIVE OF SHELTER. FINAL DESIGN IS SHELTER MANUFACTURER'S RESPONSIBILITY. MANUFACTURER SHALL PROVIDE A FULL SET OF SHOP DRAWINGS, INCLUDING FOUNDATION DESIGN STAMPED BY A PROFESSIONAL ENGINEER BASED ON SPECIFIC SITE LOCATION. SHELTER MANUFACTURER SHALL APPLY FOR AND PROVIDE BUILDING PERMIT.
2. INSTALLATION TO BE ACCORDING TO MANUFACTURERS RECOMMENDATIONS.
3. CONTRACTOR TO SUBMIT JOINTING PLAN FOR SLAB AT SHELTER.
4. REFER TO GEOTECHNICAL REPORT FOR ADDITIONAL INFORMATION REGARDING EXISTING CONDITIONS AND FOR FOUNDATION REQUIREMENTS.

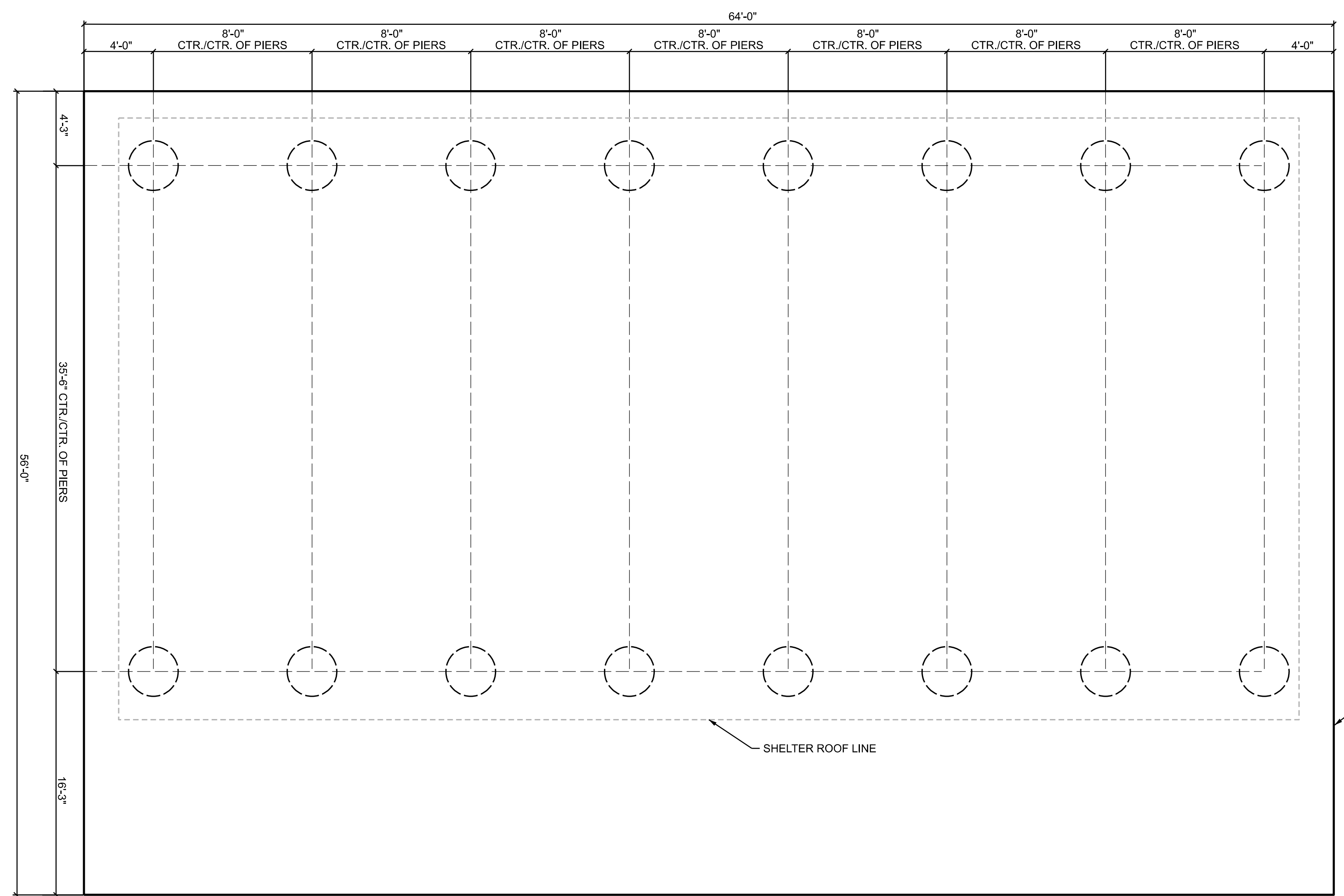

3 FOUNDATION PLAN

NOT TO SCALE



THIS DRAWING IS THE PROPERTY OF THE LANDSCAPE ARCHITECT. IT HAS BEEN PREPARED SPECIFICALLY FOR THIS SITE AND IS NOT TO BE USED FOR ANY OTHER PURPOSE, LOCATION, OR OWNER WITHOUT WRITTEN CONSENT OF THE LANDSCAPE ARCHITECT.

COULSON PARK SOUTH IMPROVEMENTS
SHELTER DETAILS

COPYRIGHT 2024
STEINER THUESEN PLLC

STEINER THUESEN PLLC

GOLF COURSE ARCHITECTURE
IRRIGATION DESIGN
LANDSCAPE ARCHITECTURE

1925 GRAND AVE. SUITE 105
P.O. BOX 22943
BILLINGS, MT 59104
406/252-5545 FAX 245-9855

DRAWN BY: JAV. GSG
DATE: 9/6/24
CHECKED BY: NGS
DATE: 9/6/24
REV: -
REV: -
FILE: L5-SHELTER DETAILS.DGN

SHEET
L5

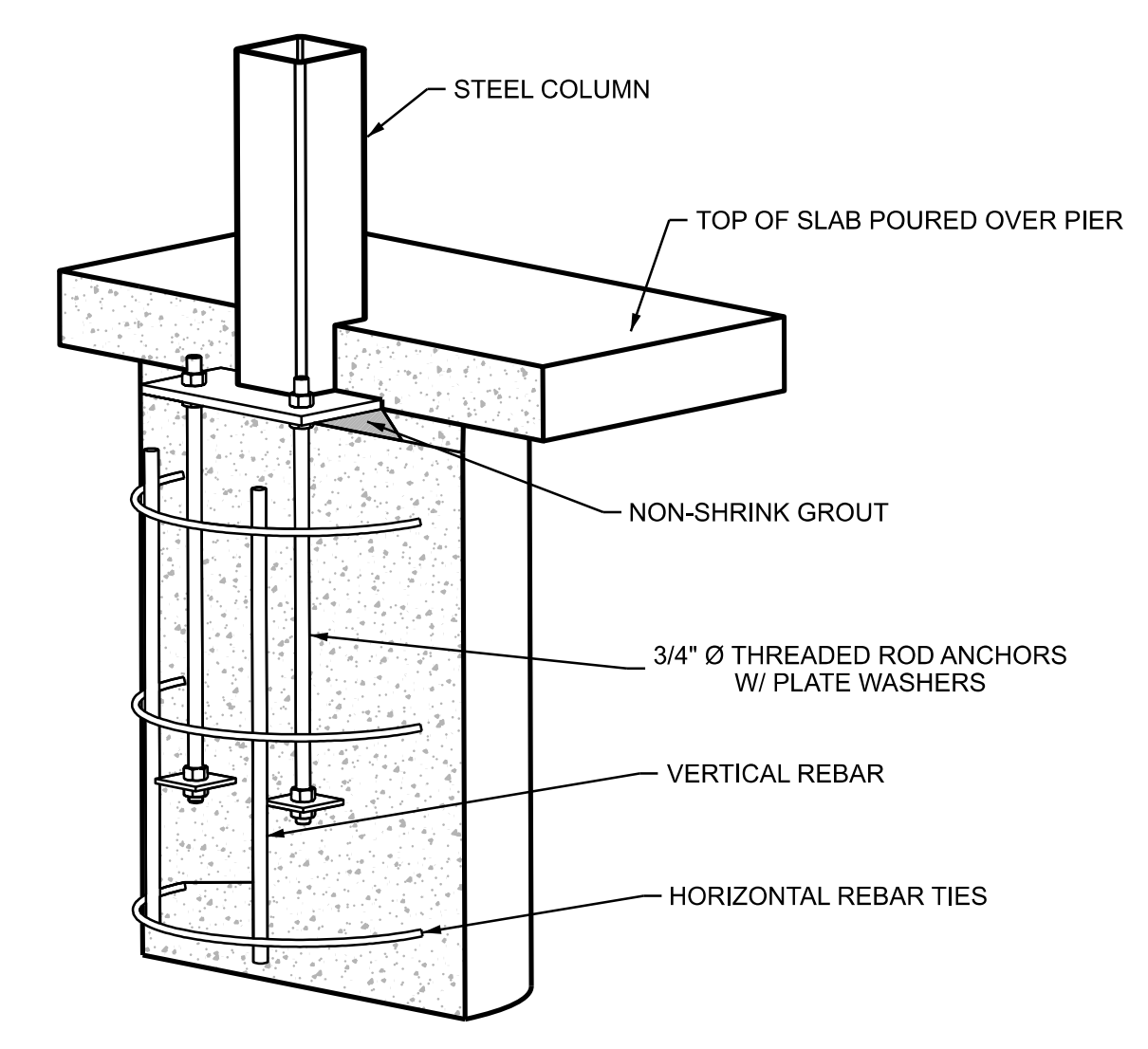

NOTES:
1. TYPICAL PIER DIAMETER IS BETWEEN 2'-0" AND 3'-0"±
2. TYPICAL PIER DEPTH IS BETWEEN 4'-0" AND 5'-6"±.
3. ACTUAL DESIGN WILL VARY DUE TO BUILDING CODE REQUIREMENTS AND MAY BE LARGER.
4. REFER TO GEOTECHNICAL REPORT FOR ADDITIONAL REQUIREMENTS.

2 STEEL COLUMN PIER DETAIL NOT TO SCALE

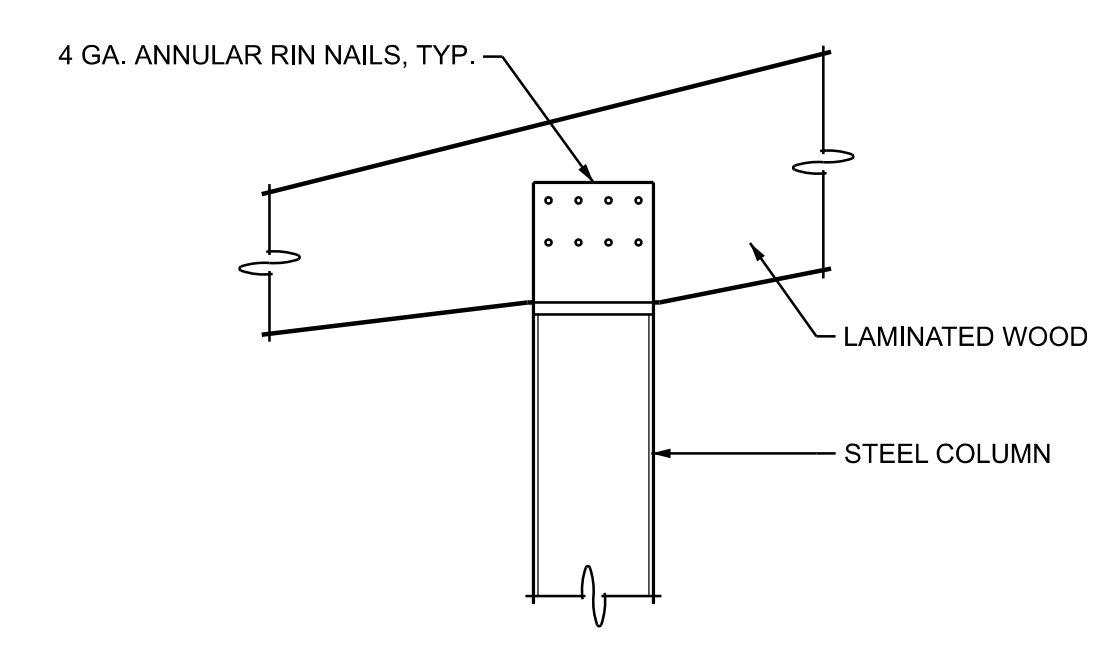

3 COLUMN TO BEAM CONNECTION NOT TO SCALE

NOTES:
1. DRAWINGS & DETAILS ARE REPRESENTATIVE OF SHELTER. FINAL DESIGN IS SHELTER MANUFACTURER'S RESPONSIBILITY. MANUFACTURER SHALL PROVIDE A FULL SET OF SHOP DRAWINGS, INCLUDING FOUNDATION DESIGN STAMPED BY A PROFESSIONAL ENGINEER BASED ON SPECIFIC SITE LOCATION. SHELTER MANUFACTURER SHALL APPLY FOR AND PROVIDE BUILDING PERMIT.
2. INSTALLATION TO BE ACCORDING TO MANUFACTURER'S RECOMMENDATIONS.
3. CONTRACTOR TO SUBMIT JOINTING PLAN FOR SLAB AT SHELTER.
4. REFER TO GEOTECHNICAL REPORT FOR ADDITIONAL INFORMATION REGARDING EXISTING CONDITIONS AND FOR FOUNDATION REQUIREMENTS.

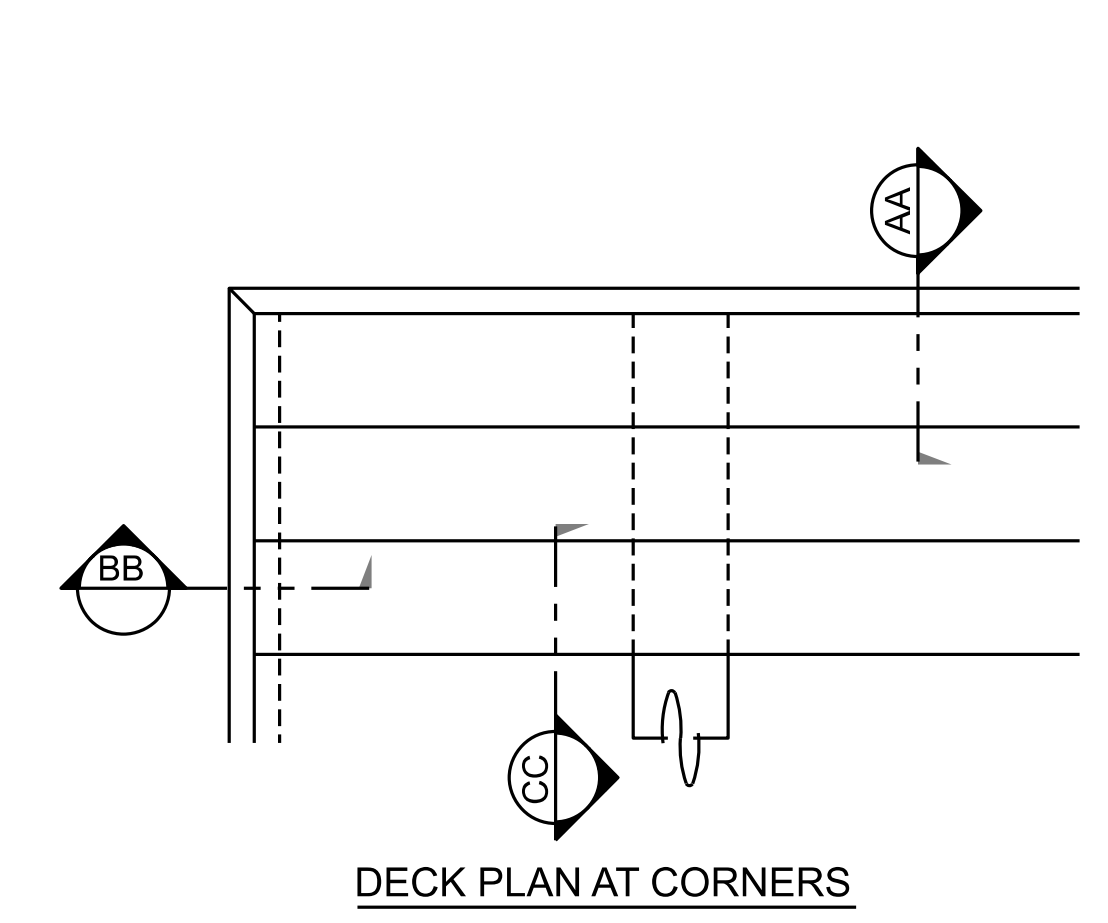

DECK PLAN AT CORNERS

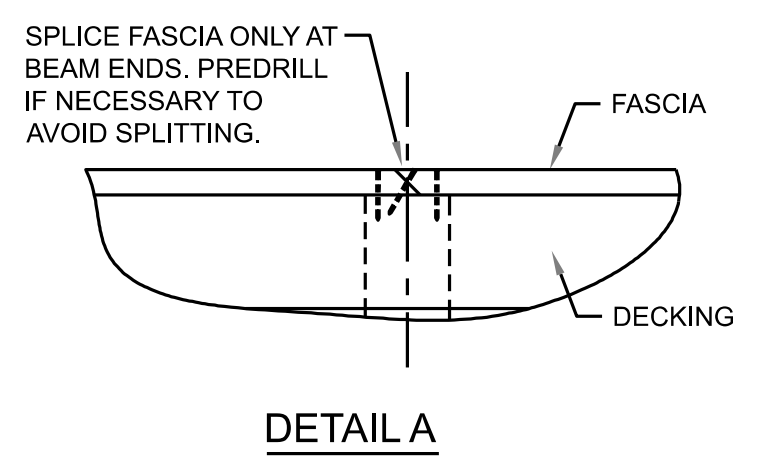

DETAIL A

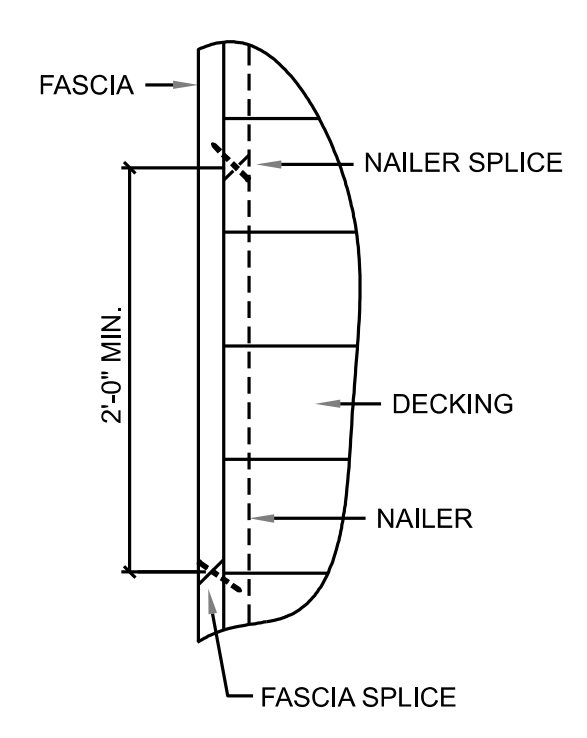

DETAIL B

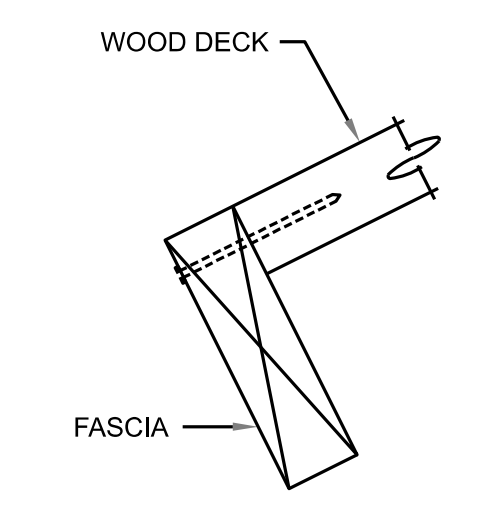

SECTION AA

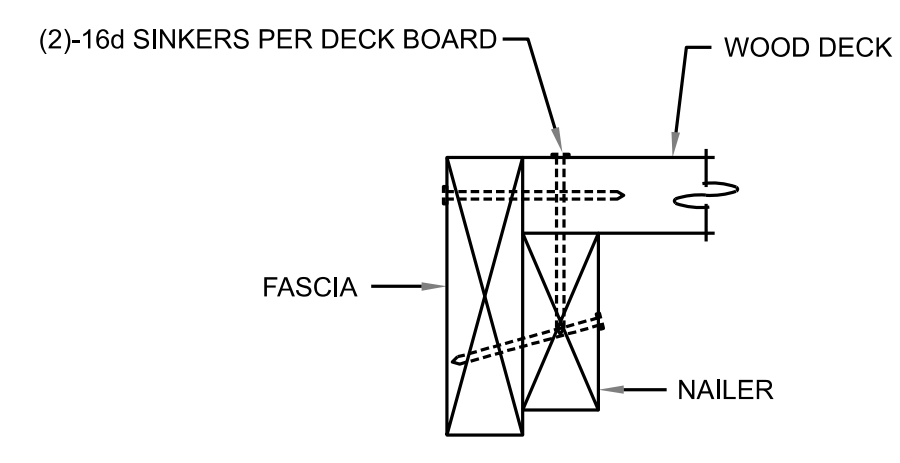

SECTION BB

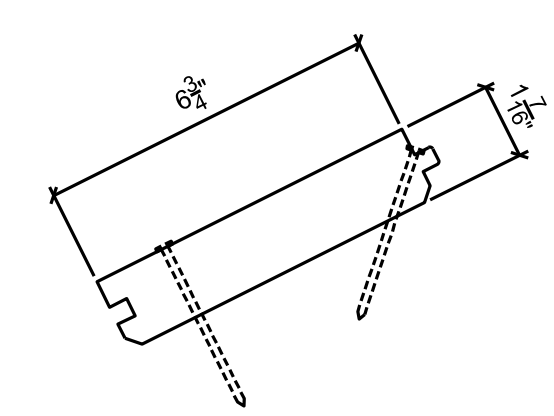

SECTION CC

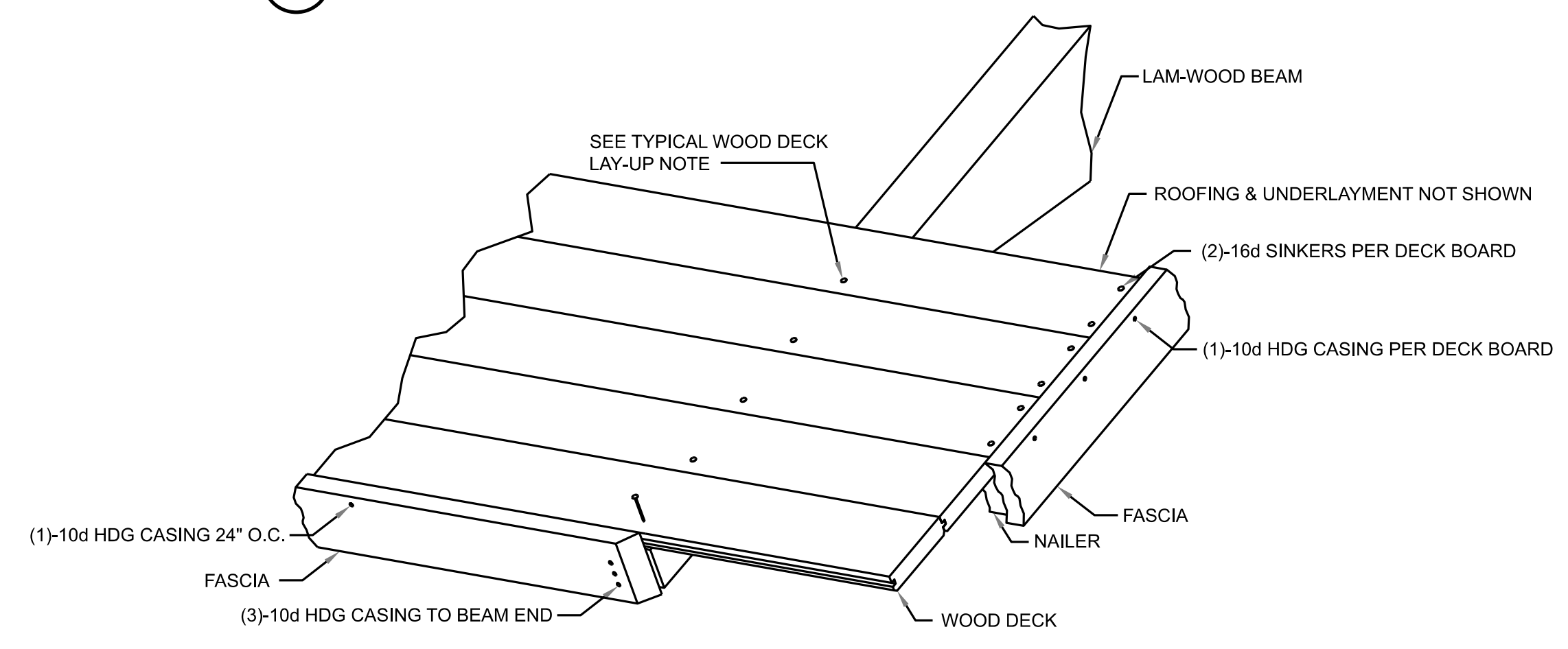

TYPICAL DECK LAY-UP

1. START LAYING DECK AT EAVE W/ TONGUES UP.
2. DRIVE COURSES TIGHT W/ BLOCKING.
3. TOE NAIL & FACE NAIL AT EACH SUPPORT (BEAMS) USING 16d COMMON NAILS.
4. SNAP CHALK LINE AT BUILDING RAKE & CUT DECKING STRAIGHT AND SQUARE.
5. DECKING IS FURNISHED IN SPECIFIED LENGTHS, ALTERNATE COURSES.

FASCIA NOTES:

1. ALL FASCIA CORNERS AND SPLICES ARE TO BE MITERED.
2. SEE DETAILS A & B FOR SPLICE DETAILS.
3. ATTACH FASCIA WITH 10d HDG CASING NAILS:
 - a. TO 2x4 NAILER - 24" O.C.
 - b. TO BEAM ENDS - 3 NAILS PER FASCIA
 - c. TO ENDS OF ROOF DECKING - 1 NAIL PER DECK BOARD
 - d. AT CORNERS - 2 NAILS EACH DIRECTION
 - e. OTHER LOCATIONS - 24" O.C. TO ROOF DECKING

2 x 4 NAILER

1. MITER ALL SPLICES
2. NAIL SPLICES TOGETHER WITH (2) 10d HDG CASING NAILS. DRIVE NAILS AT AN ANGLE TO AVOID PUNCHING THRU FASCIA.

1 DECKING DETAILS NOT TO SCALE

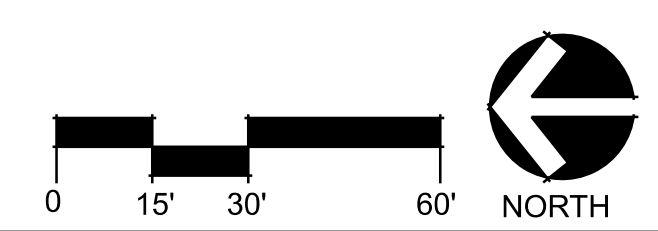

REUSE OF DOCUMENT

This document is the property of DHM Design Corp. The ideas and design incorporated on this document is an instrument of professional service and shall not be used for any other project without written authorization of DHM Design Corp.

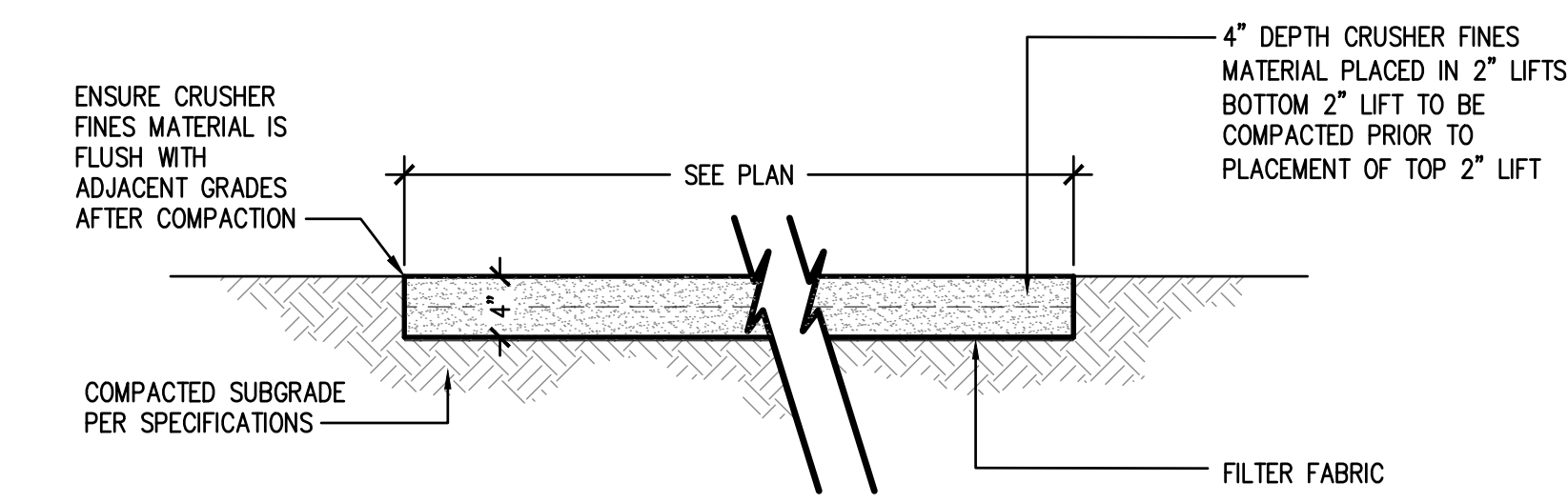

- CRUSHER FINES:**
- CRUSHER FINES MATERIAL SHALL MEET THE FOLLOWING SPECIFICATIONS: CLEAN, HARD, DURABLE PARTICLES OR FRAGMENTS OF 3/8" MINUS SELECT GREY CRUSHED GRANITE, RIVER ROCK OR BASALT. FINES SHALL BE ANGULAR AND MINIMUM OF 90% SHALL HAVE AT LEAST ONE FRACTURED FACE. COLOR TO BE APPROVED BY LANDSCAPE ARCHITECT, SAMPLES OF FINES WILL BE SUBMITTED FOR APPROVAL PRIOR TO APPLICATION.
 - TRAIL SUB-BASE SHALL BE ROLLED AND COMPACTED WITH NO LESS THAN 10 PASSES OF THE ROLLER. BOTH 2" LIFTS OF CRUSHER FINE APPLICATION SHALL BE WATERED, ROLLED AND COMPACTED WITH NO LESS THAN 5 PASSES EACH OF THE ROLLER. NO TRAIL COMPACTION TESTING WILL BE REQUIRED.
 - CONTRACTOR TO PROVIDE A FABRIC UNDER THE ENTIRE LENGTH AND WIDTH OF THE CRUSHER FINES TRAIL. TYPE #3401 THERMALLY SPUN POLYPROPYLENE, NON-WOVEN, THIN WEED CONTROL FABRIC 4.0 OZ./LINEAL YARD WEIGHT OR APPROVED EQUAL. CONTRACTOR TO PROVIDE A 12"x12" SAMPLE FOR APPROVAL PRIOR TO APPLICATION.

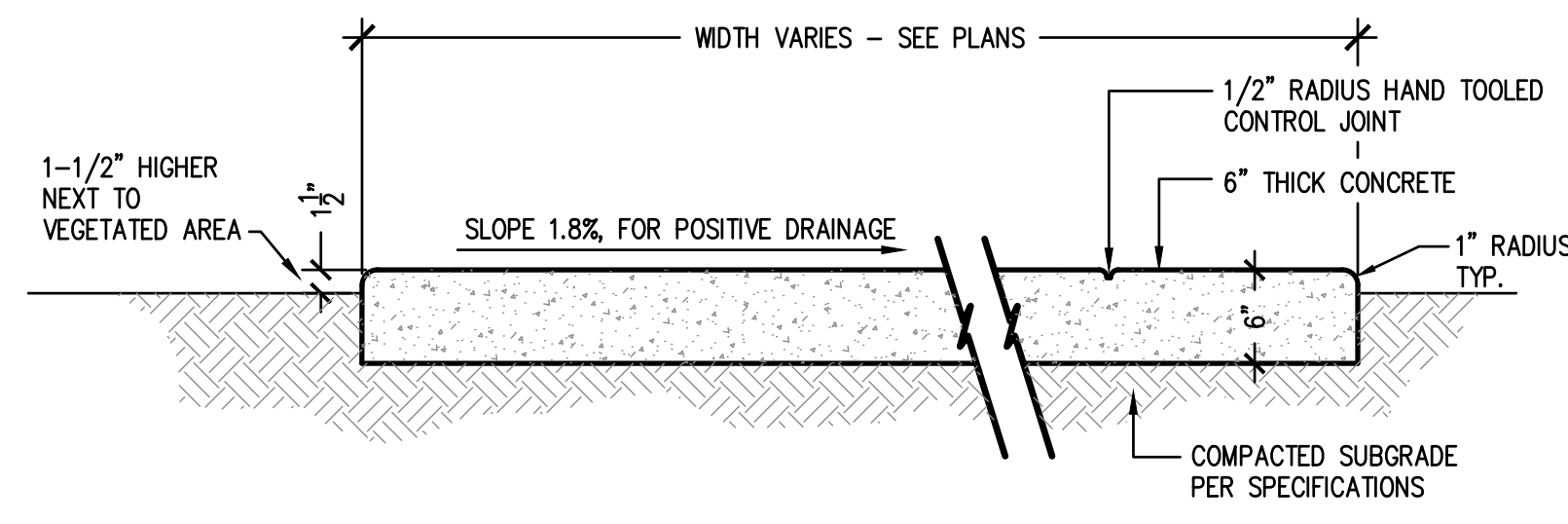

- CONCRETE PAVEMENT:**
- 4000 PSI CONCRETE PAVING W/MEDIUM BROOM FINISH PERPENDICULAR TO TRAFFIC FLOW. RE: SPEC FOR MIX DESIGN.
 - ALL FINISH SURFACES TO DRAIN AT 1.8% MAXIMUM CROSS SLOPE, UNLESS OTHERWISE NOTED.
 - ALL CONTROL JOINTS IN PLAZA AREAS TO BE HAND TOOLED TO 1/3 DEPTH OF CONCRETE, REFER TO PLANS FOR EXACT LOCATIONS
 - CONTROL JOINTS AT WALKWAYS SHALL BE AT 10' MAX, SCORE JOINTS SHALL BE AT 5' MAX.

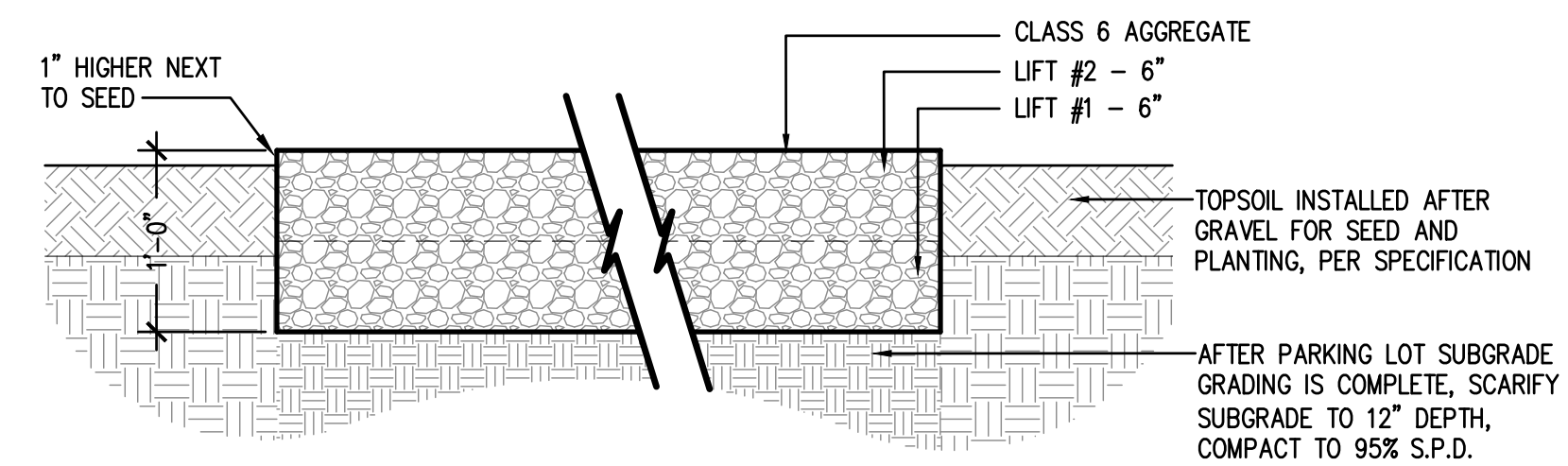

- GRAVEL PAVING:**
- REFER TO RECOMMENDATIONS FROM GEOTECHNICAL ENGINEER FOR PARKING LOT SURFACE. GEOTECH RECOMMENDATIONS TAKE PRECEDENCE OVER DETAIL.
 - CONTRACTOR TO PROOF-ROLL SUBGRADE, AND REMOVE SECTIONS THAT SHOW EXCESSIVE HEAVING OR DEFORMATION, REPLACE WITH SUITABLE FILL AND RE-COMPACT.

1 CRUSHER FINES NOT TO SCALE

2 CONCRETE PAVING NOT TO SCALE

3 GRAVEL SURFACING NOT TO SCALE

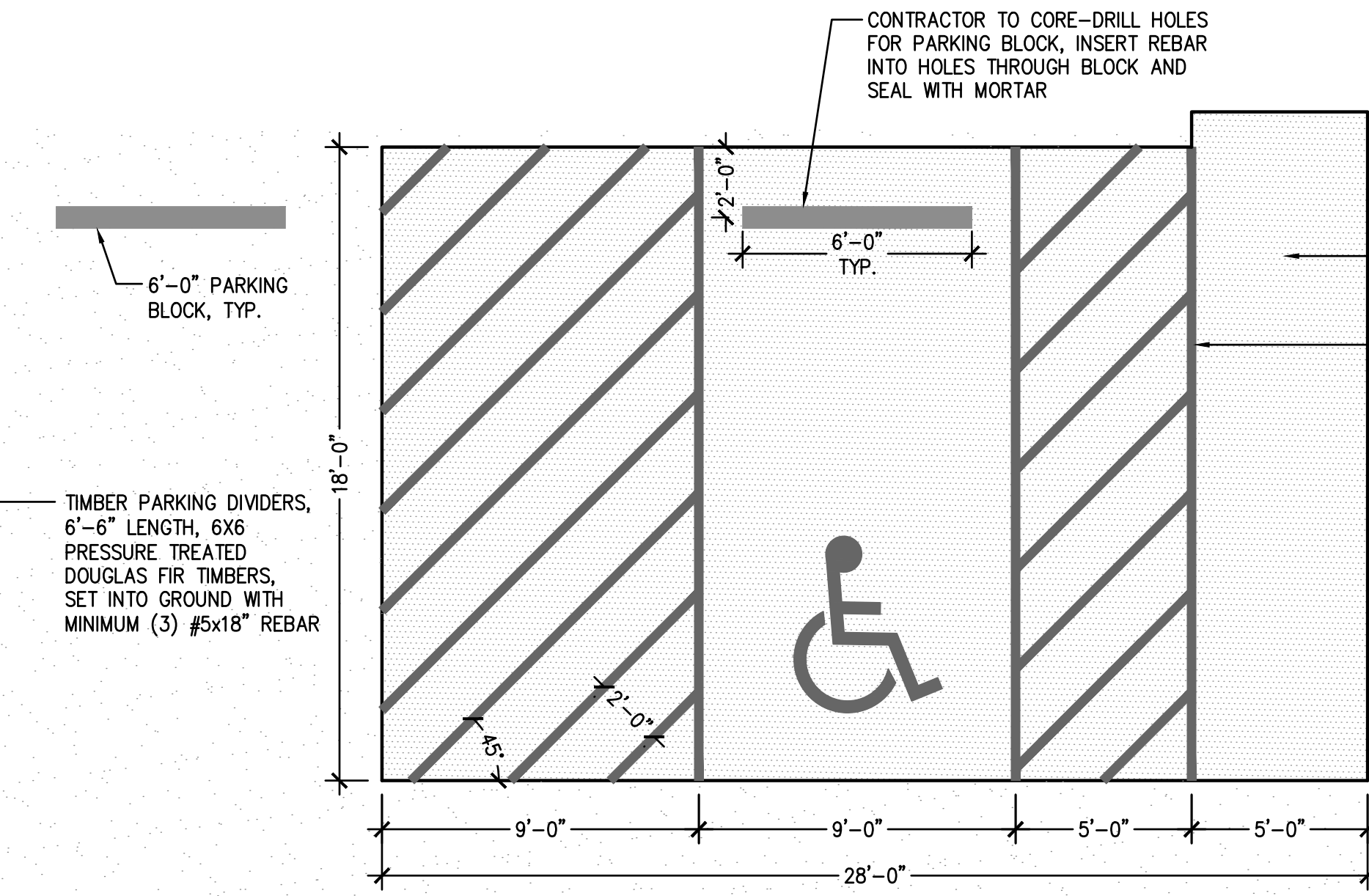
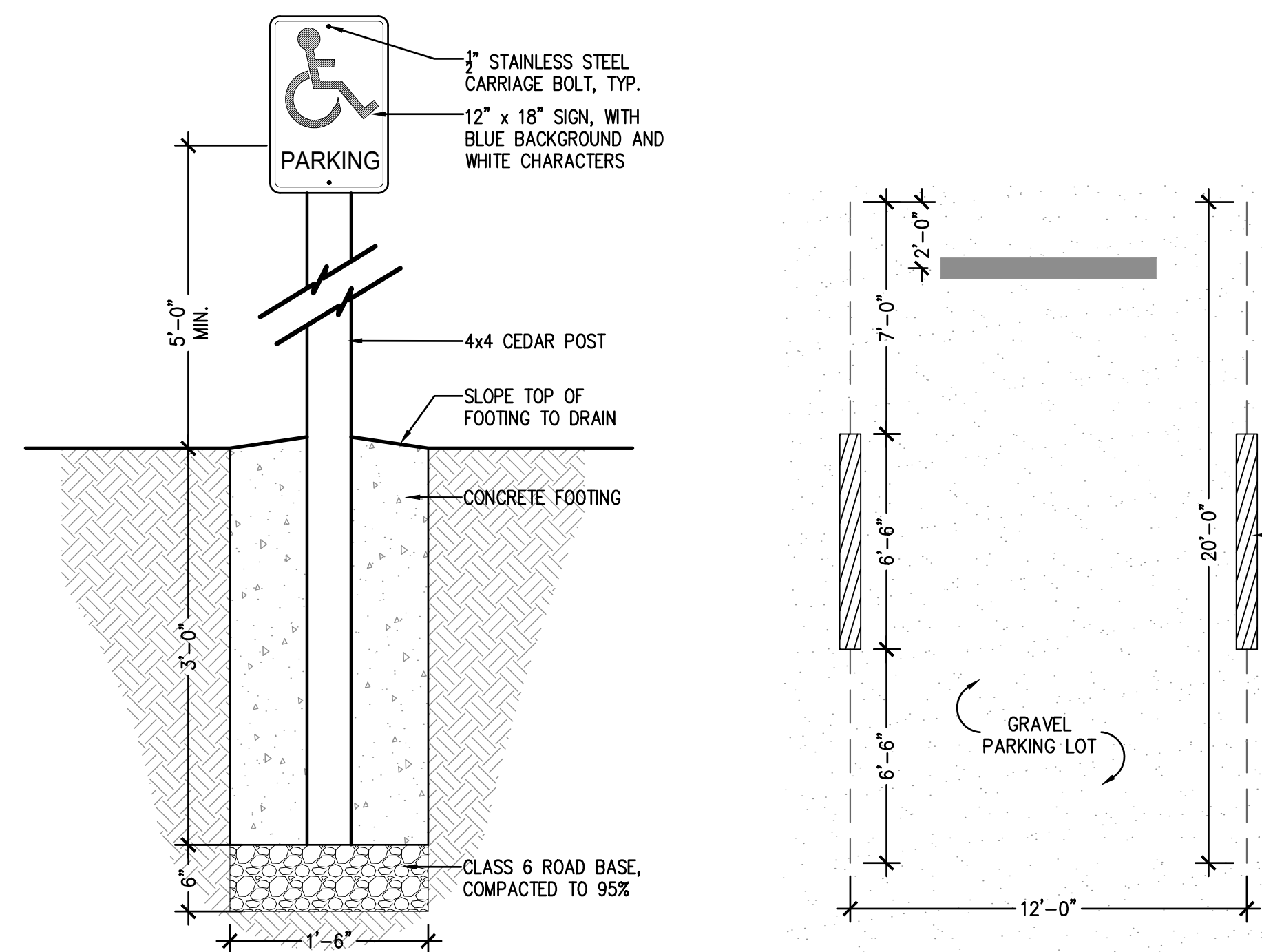

4 ACCESSIBLE SIGN NOT TO SCALE

5 ADA PARKING STALL NOT TO SCALE

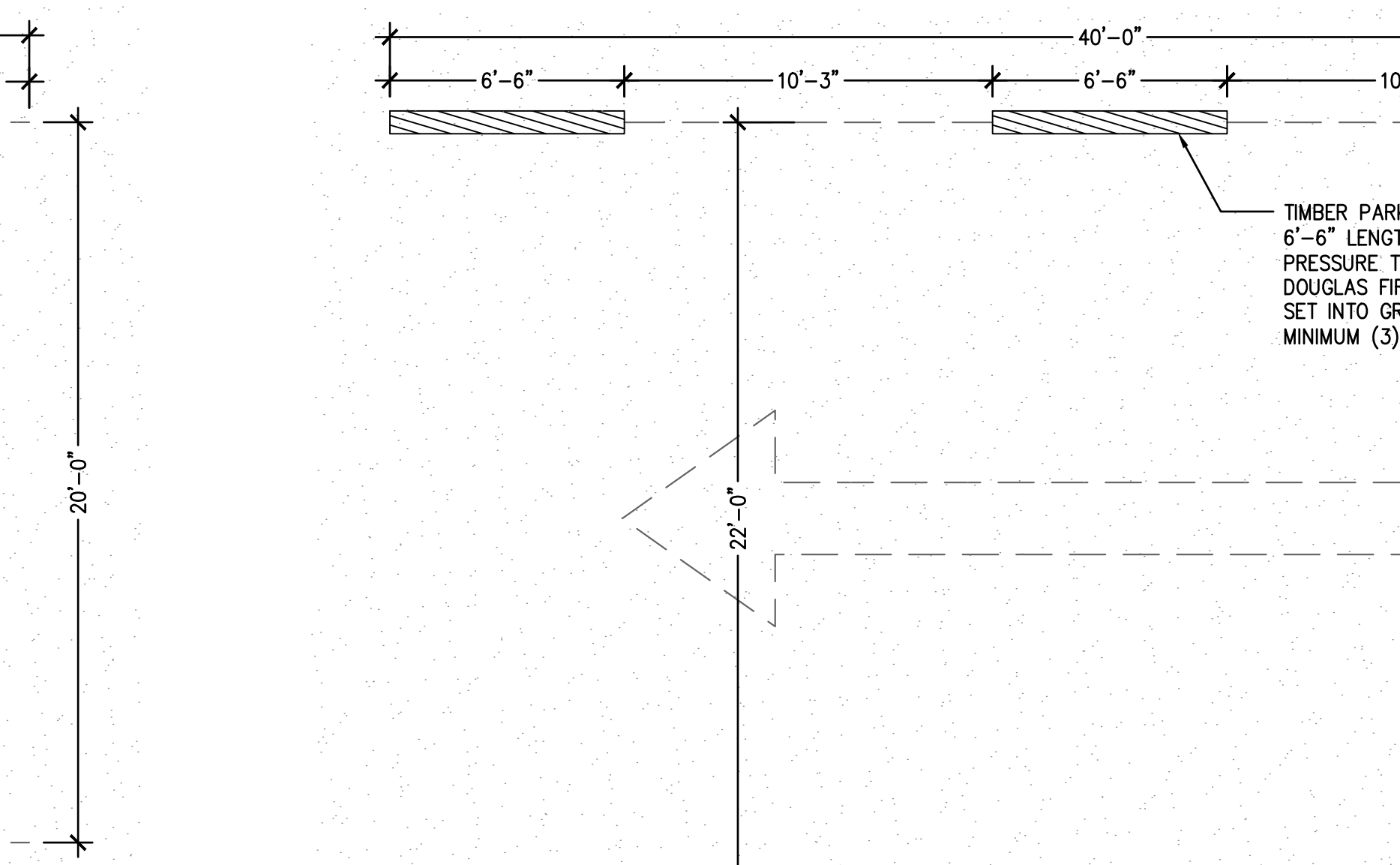
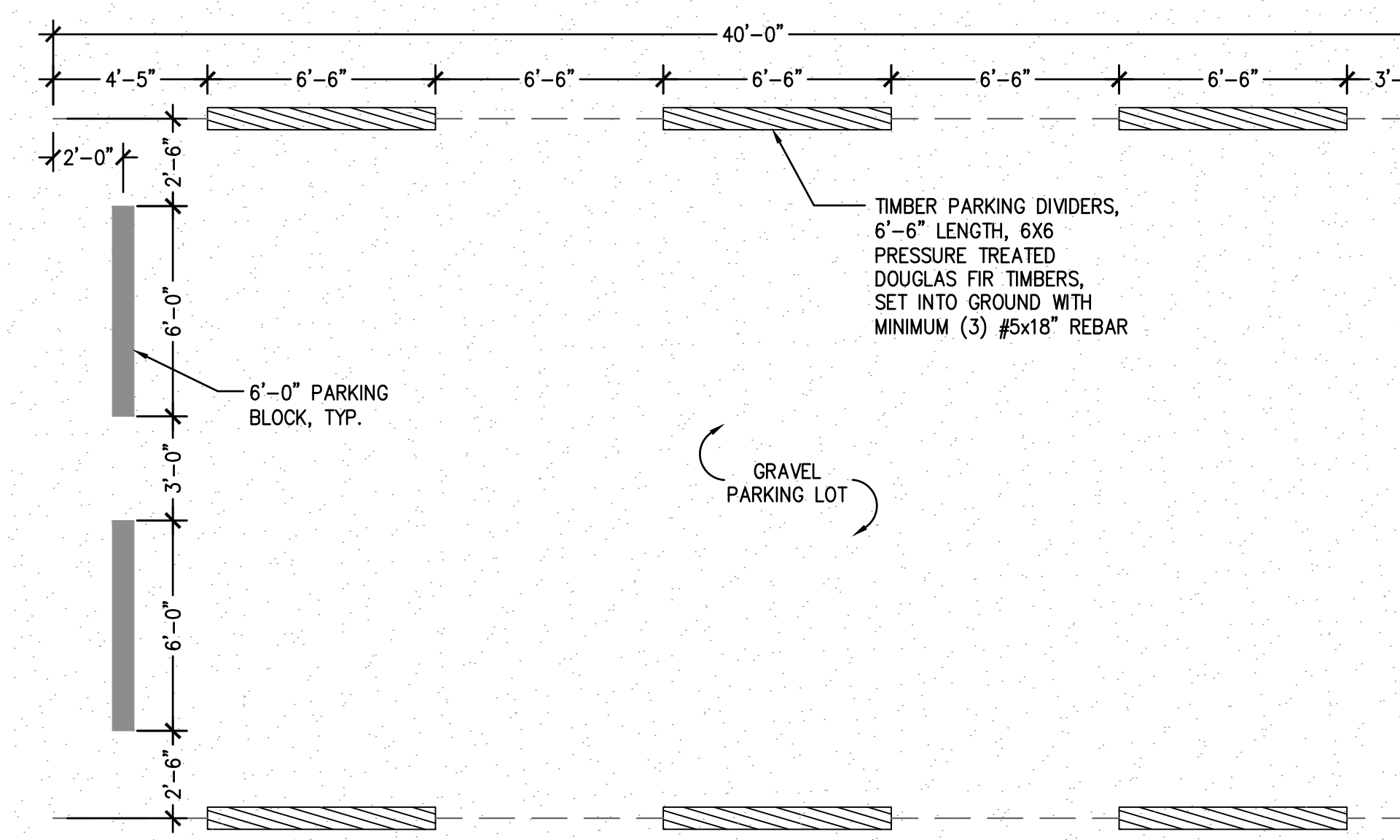

6 STANDARD TRUCK/TRAILER PARKING STALL NOT TO SCALE

7 PULL-THROUGH RV PARKING STALL NOT TO SCALE

COULSON PARK PHASE 1
Boat Ramp & Restroom Improvements
City of Billings, Montana

PROJECT NUMBER: 18322.00	DATE: 12.22.2020
DESIGNED:	
DRAWN:	
CHECKED:	
REVISIONS:	
02.16.2021	
JOB DESCRIPTION: 95% CONSTRUCTION DOCUMENTS	
SHEET TITLE: SITE DETAILS	
SCALE: AS SHOWN	
SHEET NUMBER:	

COULSON PARK NORTH IMPROVEMENTS
9/6/24

L3.0

FILE NAME: C:\Users\jwheeler\OneDrive\Documents\Projects\COULSON PARK PHASE 1\Drawings\18322-113-01-01.dwg
 PLOT DATE: 09/06/2024 10:48:00 AM
 PLOT BY: jwheeler

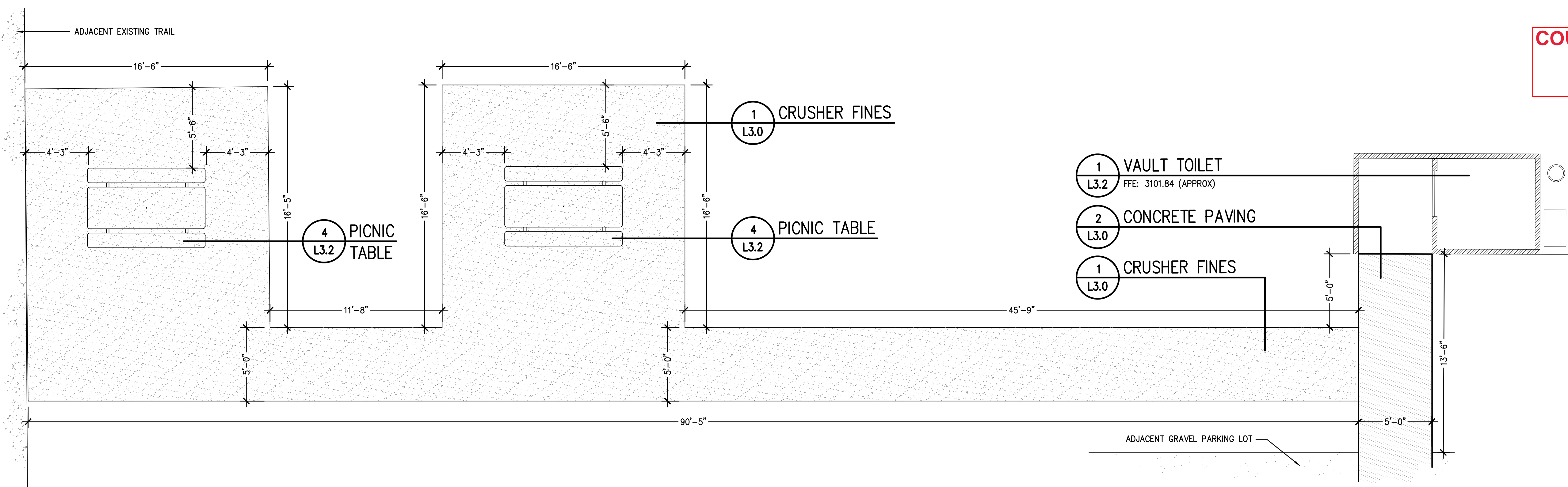

1 PICNIC AREA

NOT TO SCALE

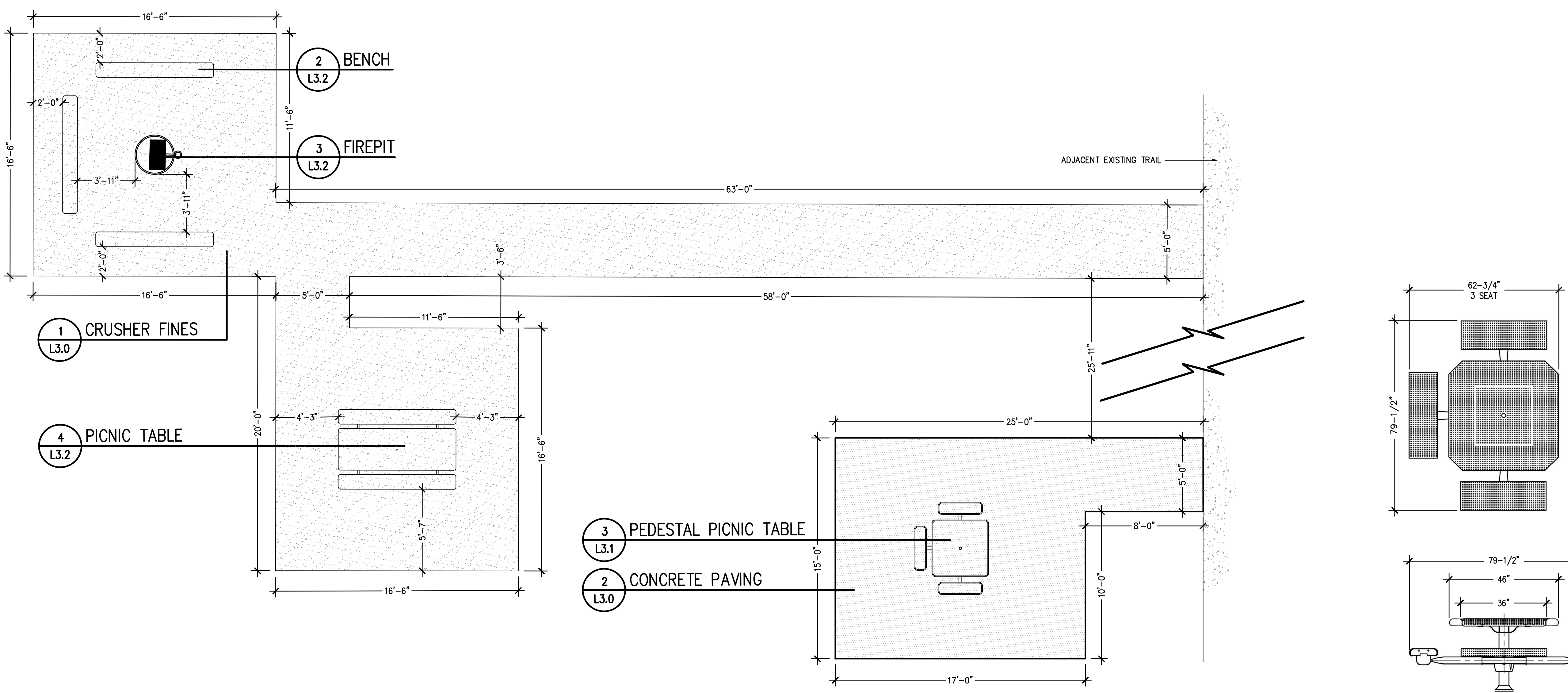

2 ADA PICNIC AREA & FIRE PIT AREA

NOT TO SCALE

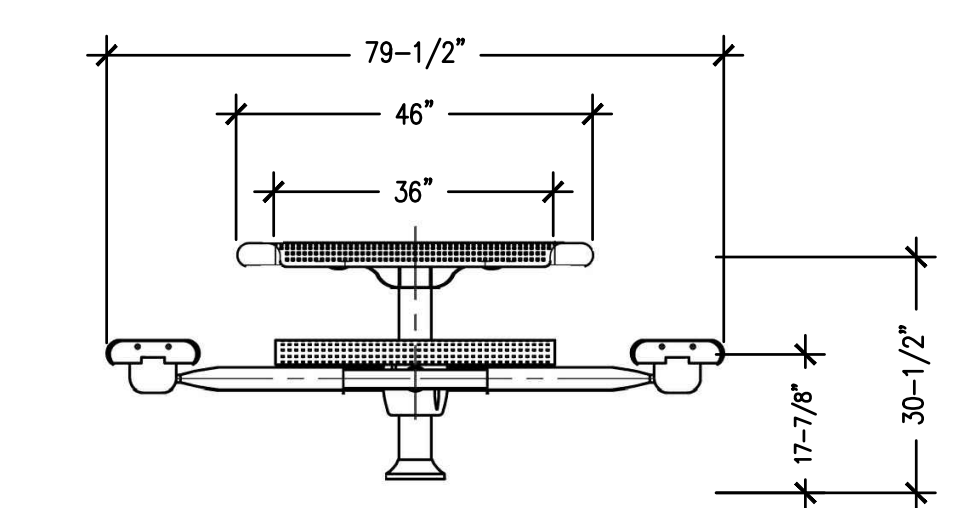
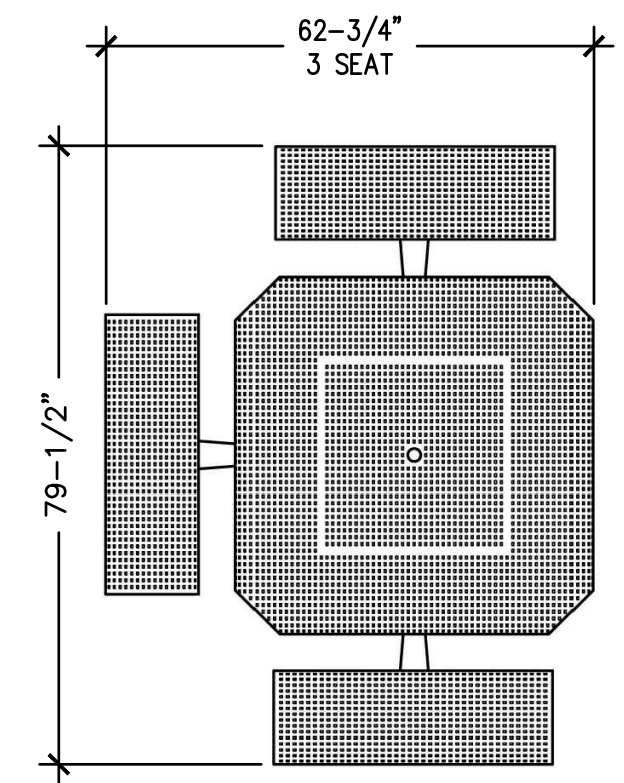

3 PEDESTAL PICNIC TABLE

NOT TO SCALE

MANUFACTURER: URBANSCAPE (OR APPROVED SUBSTITUTE)
MODEL: PODP51C, 46" SQUARE TABLE
SEATS: 3 (ADA MODEL)
COLORS: SEAT/TABLETOP - PEWTER VEIN
FRAME - TEXTURED BLACK
MOUNTING: SURFACE MOUNT ON 6" THICK CONCRETE PAD
PERFORMANCE: SQUARE

COULSON PARK PHASE 1
Boat Ramp & Restroom Improvements
City of Billings, Montana

PROJECT NUMBER: 18322.00 DATE: 12.22.2020

DESIGNED:
DRAWN:
CHECKED:

REVISIONS:

02.16.2021
JOB DESCRIPTION:
95% CONSTRUCTION DOCUMENTS

SHEET TITLE:
SITE DETAILS

SCALE: AS SHOWN
SHEET NUMBER:

L3.1

FILE NAME: C:\Users\jordan\OneDrive\Documents\Projects\COULSON PARK PHASE 1\Drawings\18322-113 - 01.dwg
DATE: 09/06/24
PLOT DATE: 09/06/24

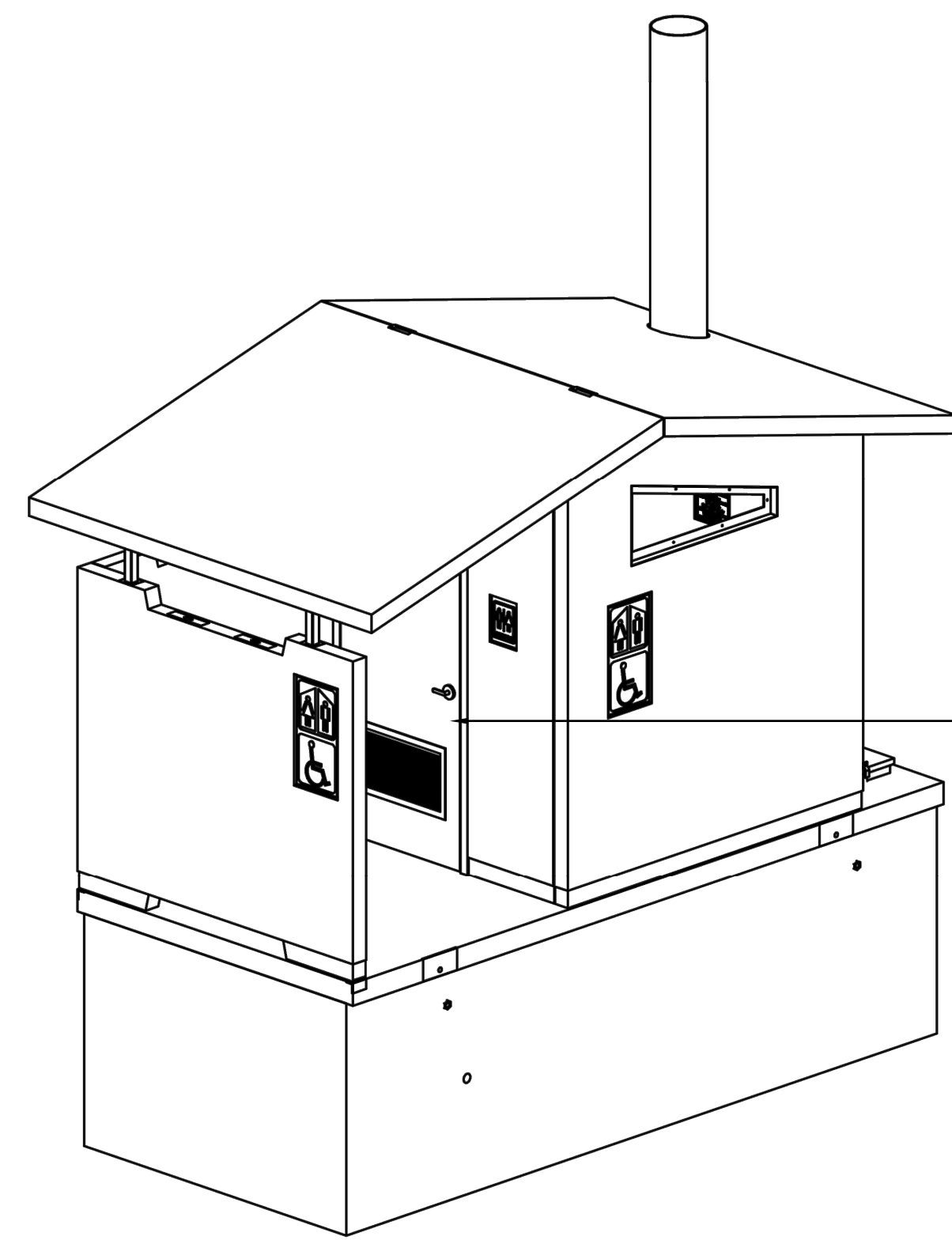

FASTLOG FLOOD PROTECTION TO BE INSTALLED BY CONTRACTOR

RAISED CLEANOUT TO BE 4'-6" ABOVE FFE

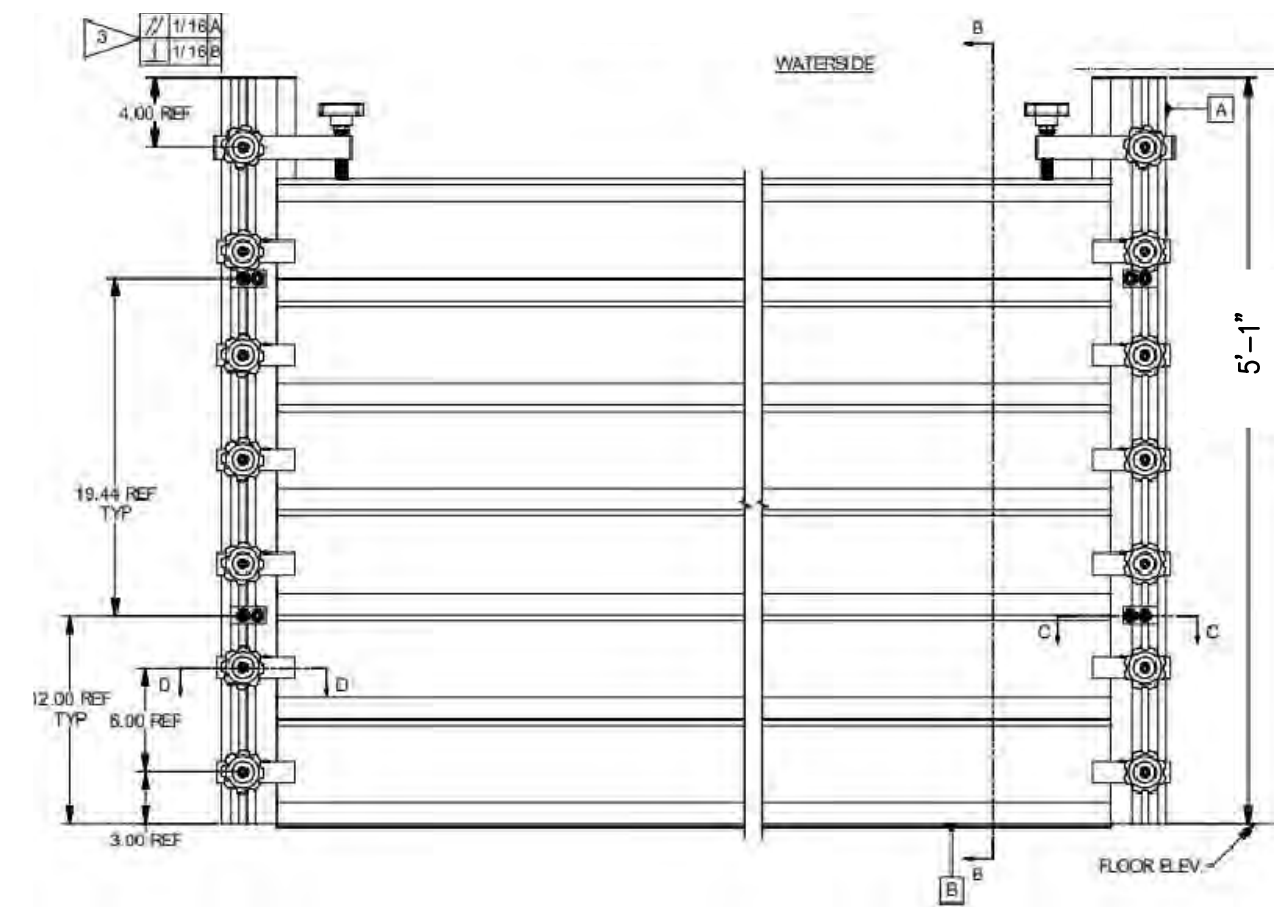
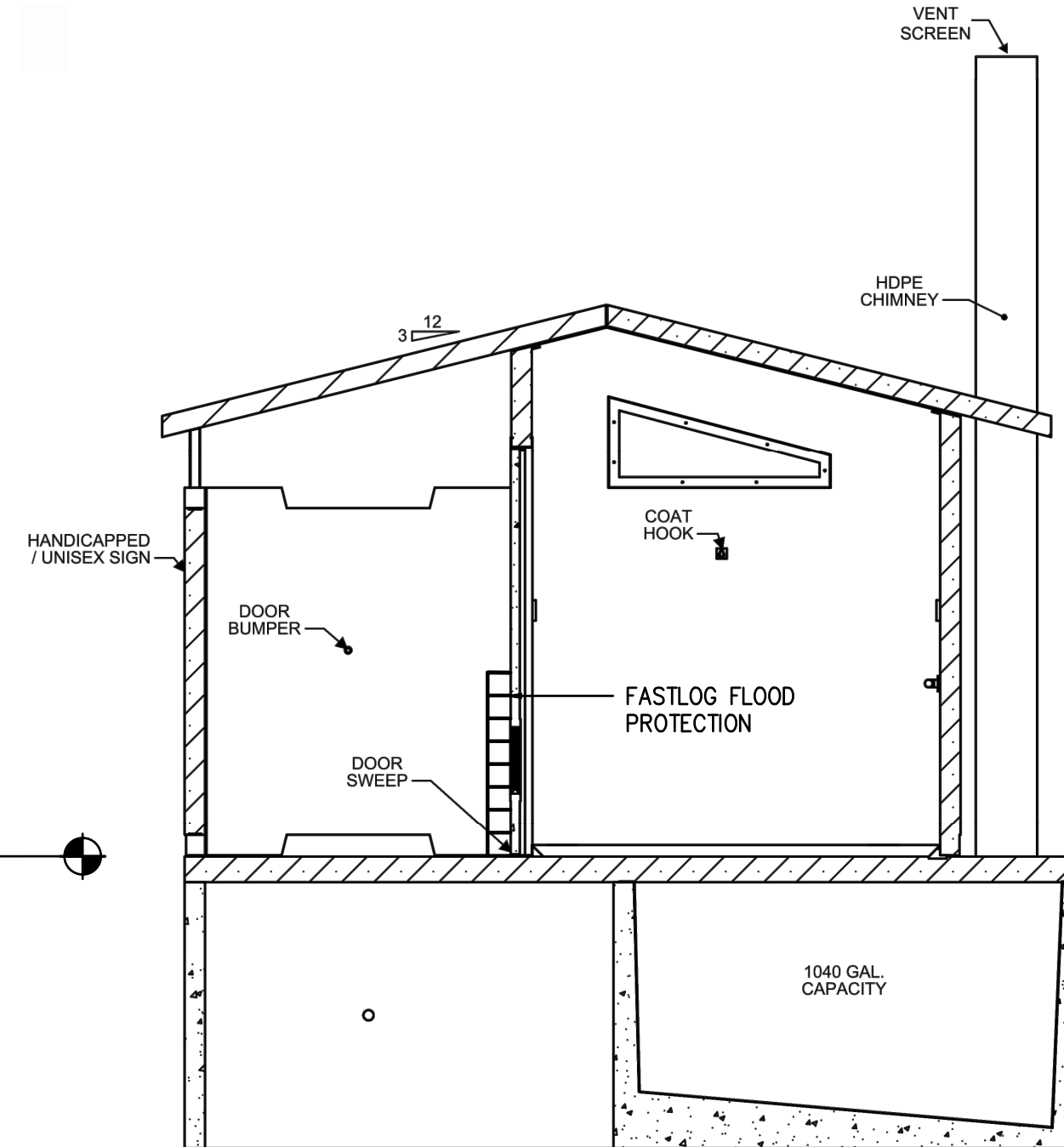
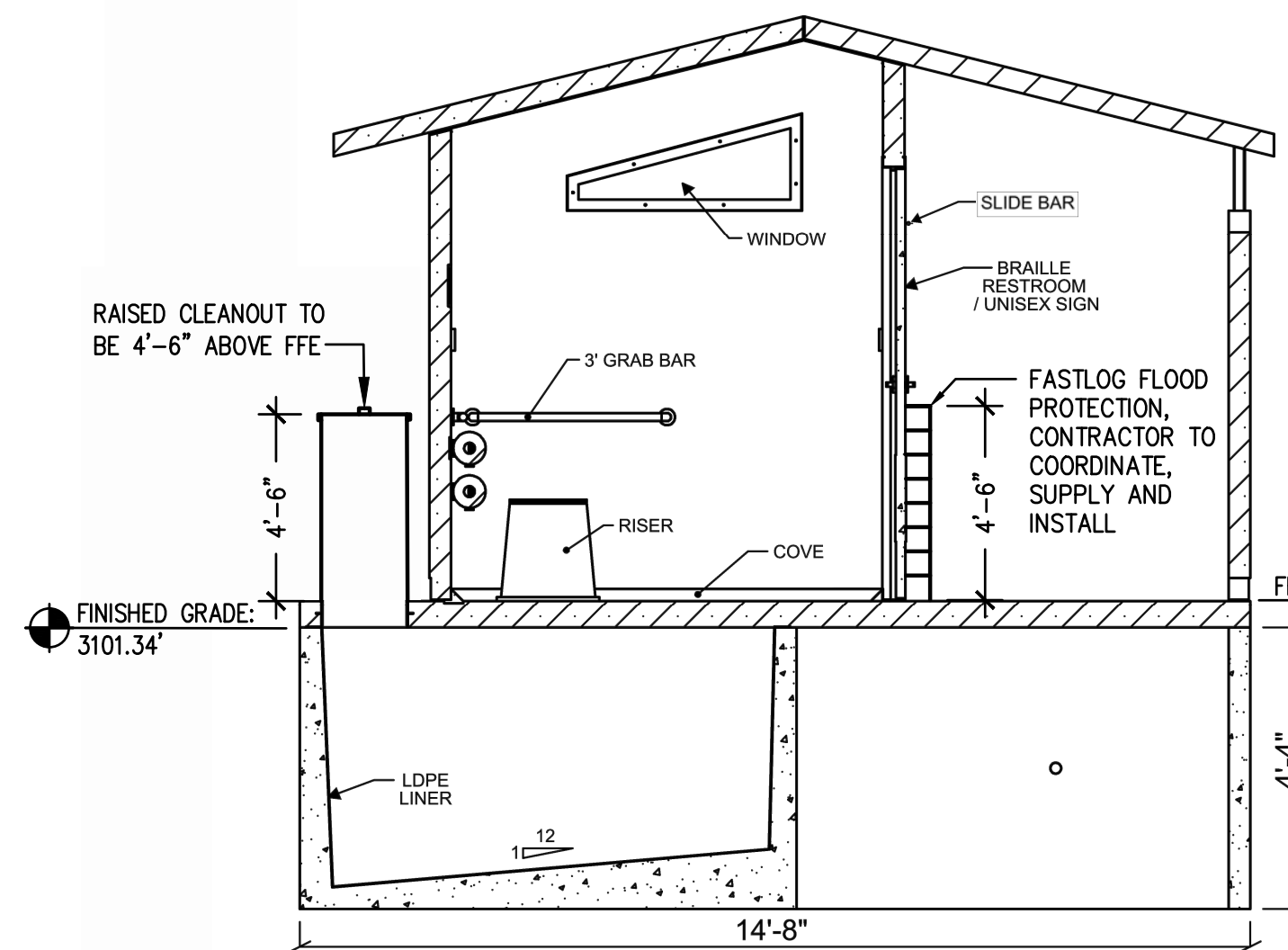
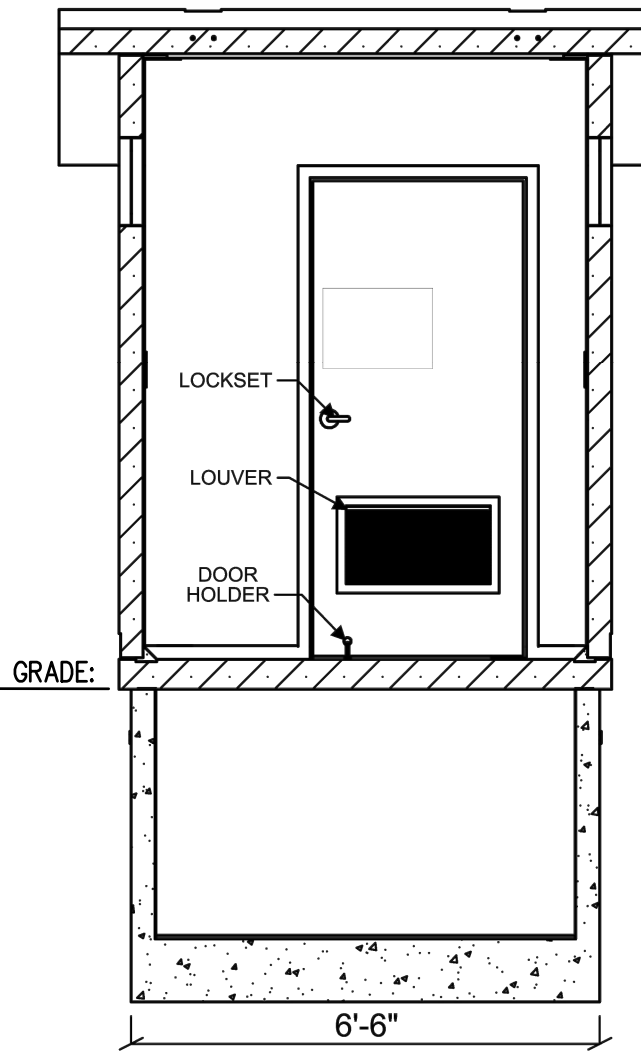
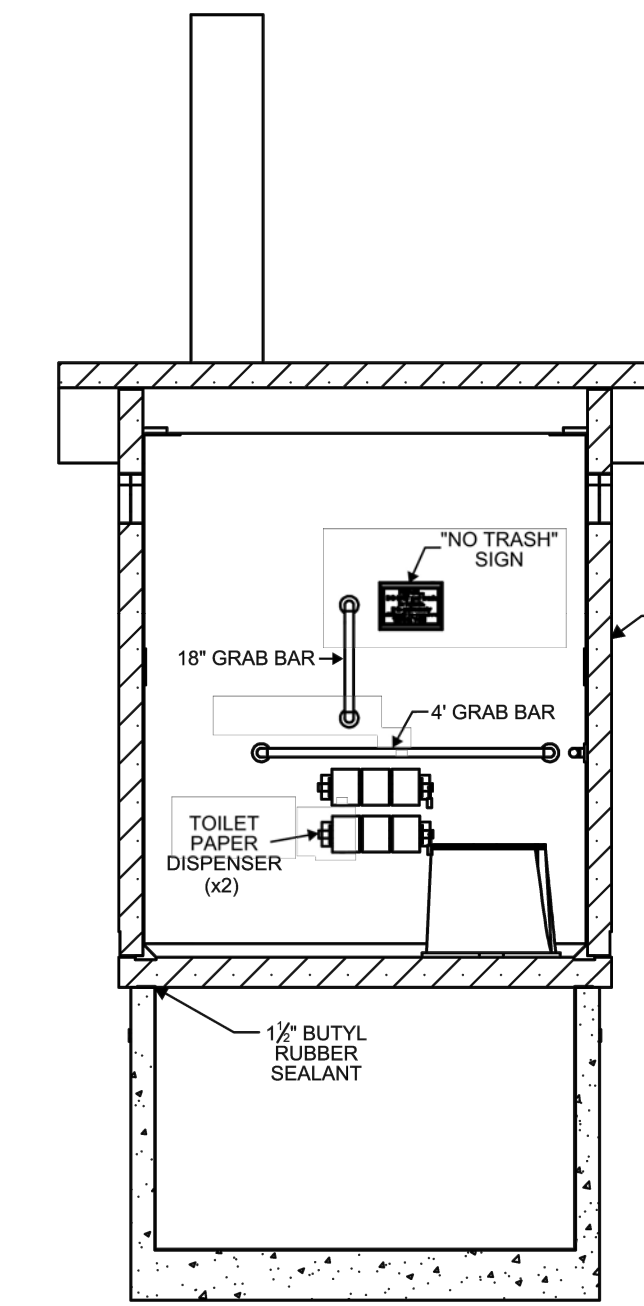
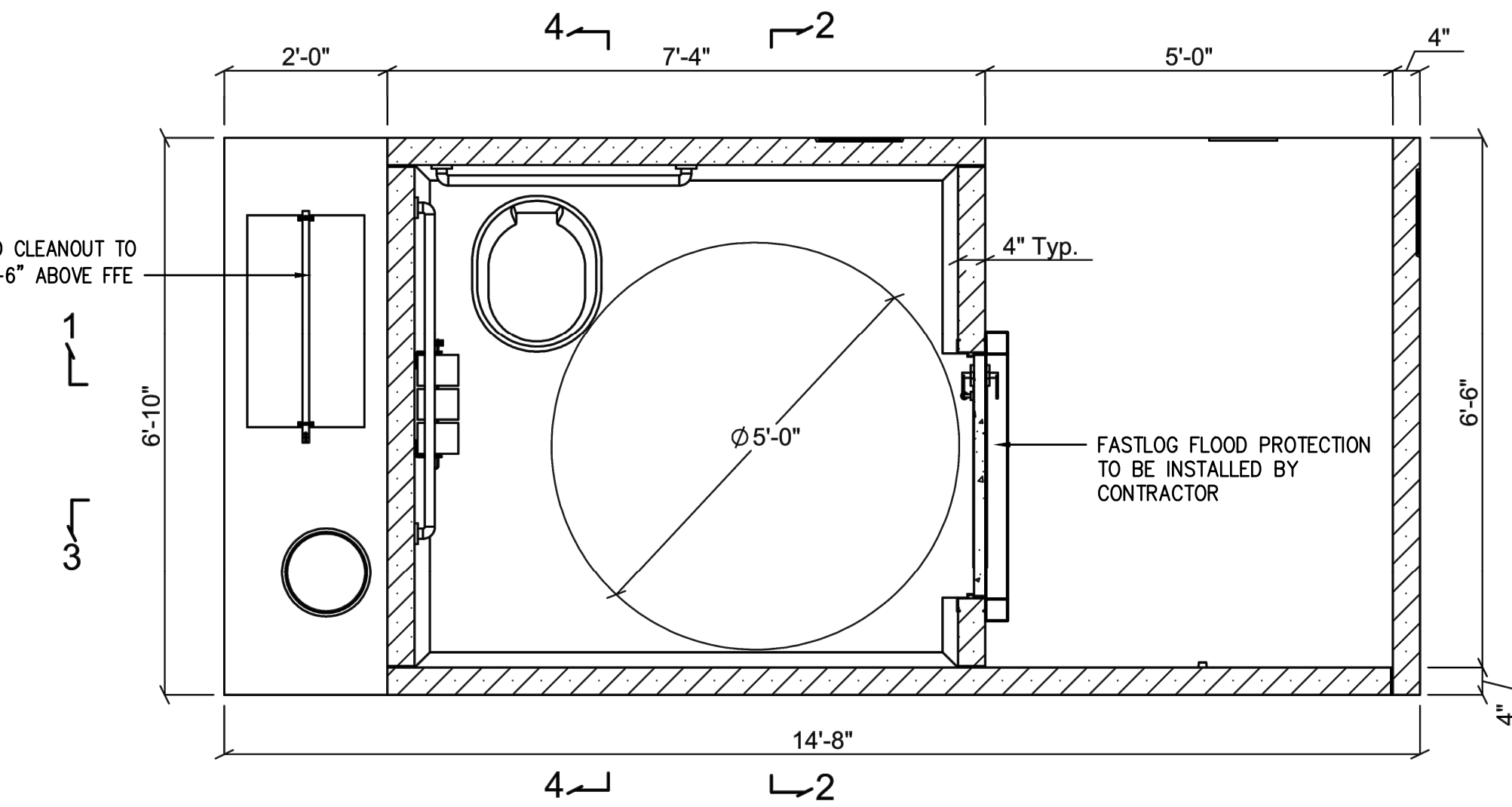

FASTLOG FLOOD PROTECTION

PRESRAY FASTLOG MODEL #AL6061-T6,
SUPPLIED BY PRESRAY, OR APPROVED SUBSTITUTE
PHONE: 845-373-6700

VAULT RESTROOM NOTES:

1. VAULT RESTROOM STRUCTURE PROVIDED BY (NO APPROVED SUBSTITUTE): MISSOULA CONCRETE, INC. PO BOX 16086 MISSOULA, MONTANA 59808
2. CONTRACTOR IS RESPONSIBLE FOR PREPARING ALL SUBGRADE IMPROVEMENTS PRIOR TO RESTROOM DELIVERY.
3. ALL DRAWINGS ON THIS SHEET PROVIDED BY MISSOULA CONCRETE, INC.
4. IT IS THE CONTRACTORS RESPONSIBILITY TO MAKE THEMSELVES AWARE OF NECESSARY REQUIREMENTS BY THE RESTROOM MANUFACTURER PRIOR TO BIDDING AS ALL IMPROVEMENTS NECESSARY TO INSTALL RESTROOM STRUCTURE SHALL BE INCLUDED WITHIN THE BID AND AT NO ADDITIONAL COST TO THE OWNER.
5. CONTRACTOR TO PROVIDE AND INSTALL FASTLOG FLOOD PROTECTION GATES @ DOOR TO A HEIGHT OF: 4'-6", COORDINATE W/ MANUFACTURER OF RESTROOM AND FLOOD GATES.
6. VAULT VENT/ COVER TO BE RAISED/ EXTENDED BY 4'-6" TO ELEVATE IT ABOVE THE 3104.25' FLOODPLAIN ELEVATION, BY RESTROOM MANUFACTURER.

1 VAULT TOILET

NOT TO SCALE



2 BENCH

ULTRAPLAY BENCH MODEL #WB1915823, FRAME TO BE COLOR BLACK, SEAT TO BE COLOR GREEN, AS SUPPLIED BY GLOBAL INDUSTRIAL, OR APPROVED SUBSTITUTE

NOT TO SCALE



3 FIREPIT

NATIONAL OUTDOOR FURNITURE MODEL #JTA 11301. AS SUPPLIED BY NATIONAL OUTDOOR FURNITURE, OR APPROVED SUBSTITUTE

NOT TO SCALE

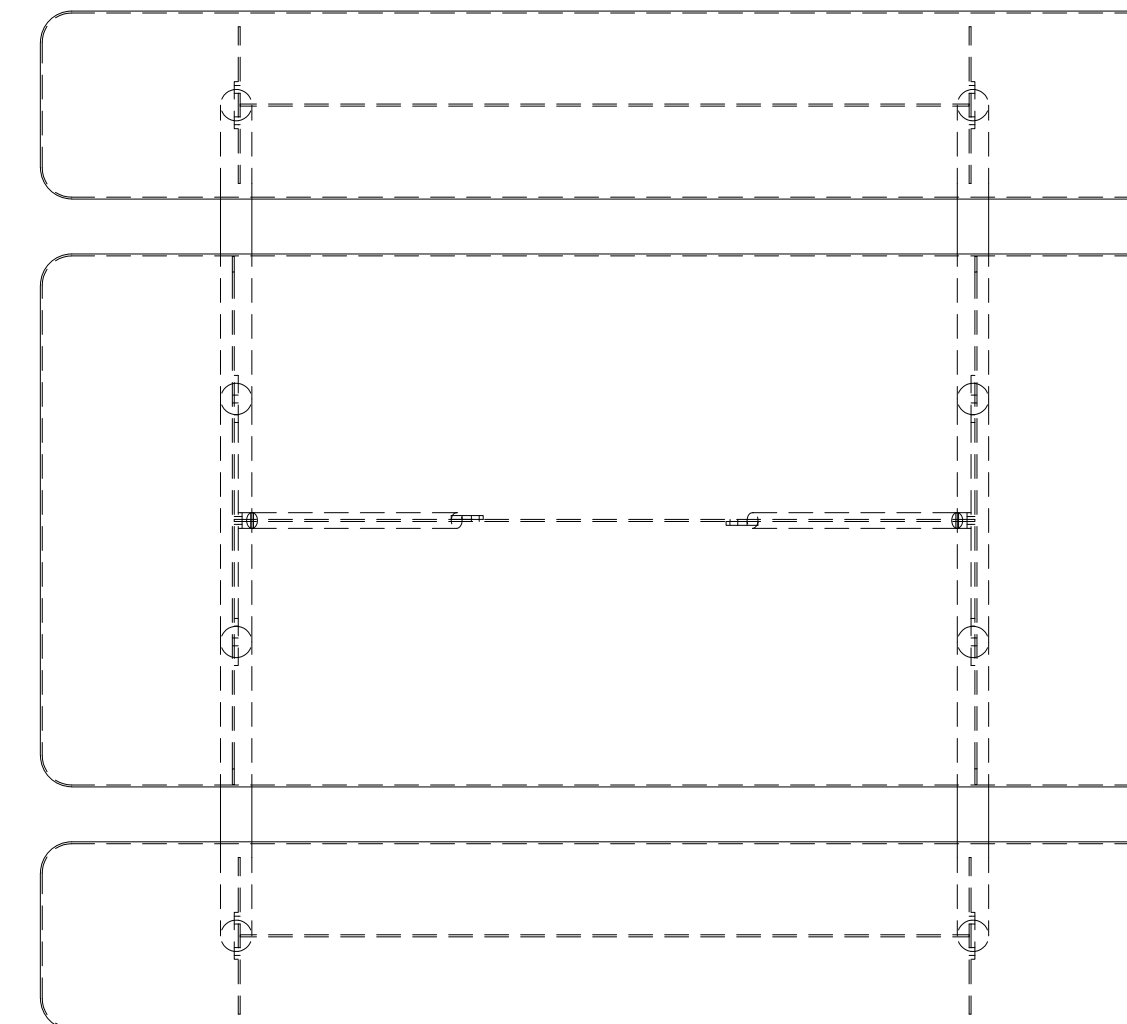

4 PICNIC TABLE

WAUSAU TILE PICNIC TABLE MODEL #MF1055, FRAME TO BE COLOR MF BLACK-8, TABLE TOP AND SEATS TO BE COLOR MF BROWN-4. AS SUPPLIED BY WABASH VALLEY, OR APPROVED SUBSTITUTE

NOT TO SCALE

PROJECT NUMBER: 18322.00 DATE: 12.22.2020

DESIGNED:
DRAWN:
CHECKED:

REVISIONS:

02.16.2021
JOB DESCRIPTION:
95% CONSTRUCTION DOCUMENTS

SHEET TITLE:
SITE DETAILS

SCALE: AS SHOWN
SHEET NUMBER: