

KEY PLAN

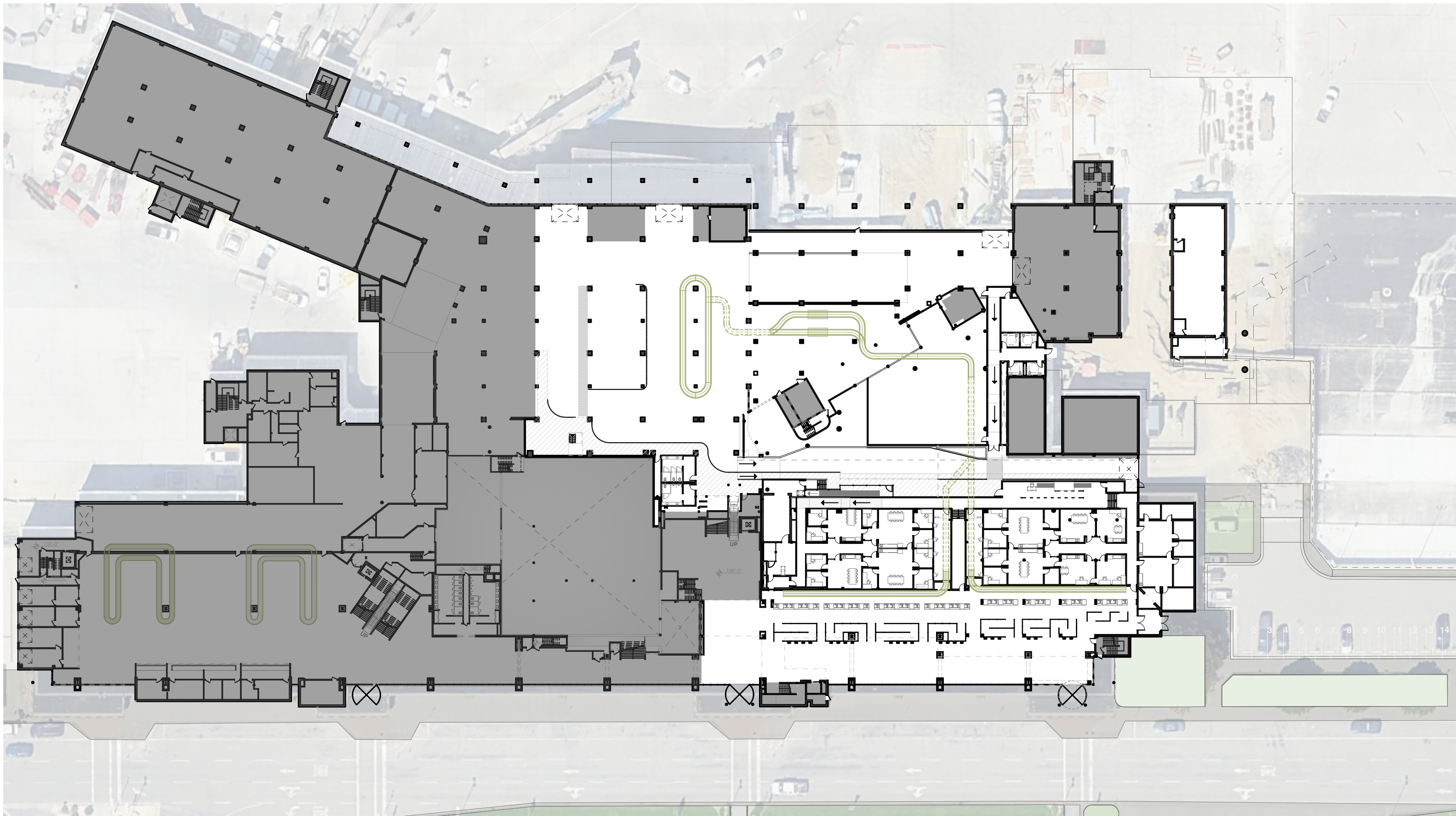



1 OVERALL FIRST FLOOR PLAN - SITE
1" = 50'



BILLINGS LOGAN INTERNATIONAL AIRPORT
TICKETING & BAGGAGE REMODEL | SCHEMATIC DESIGN



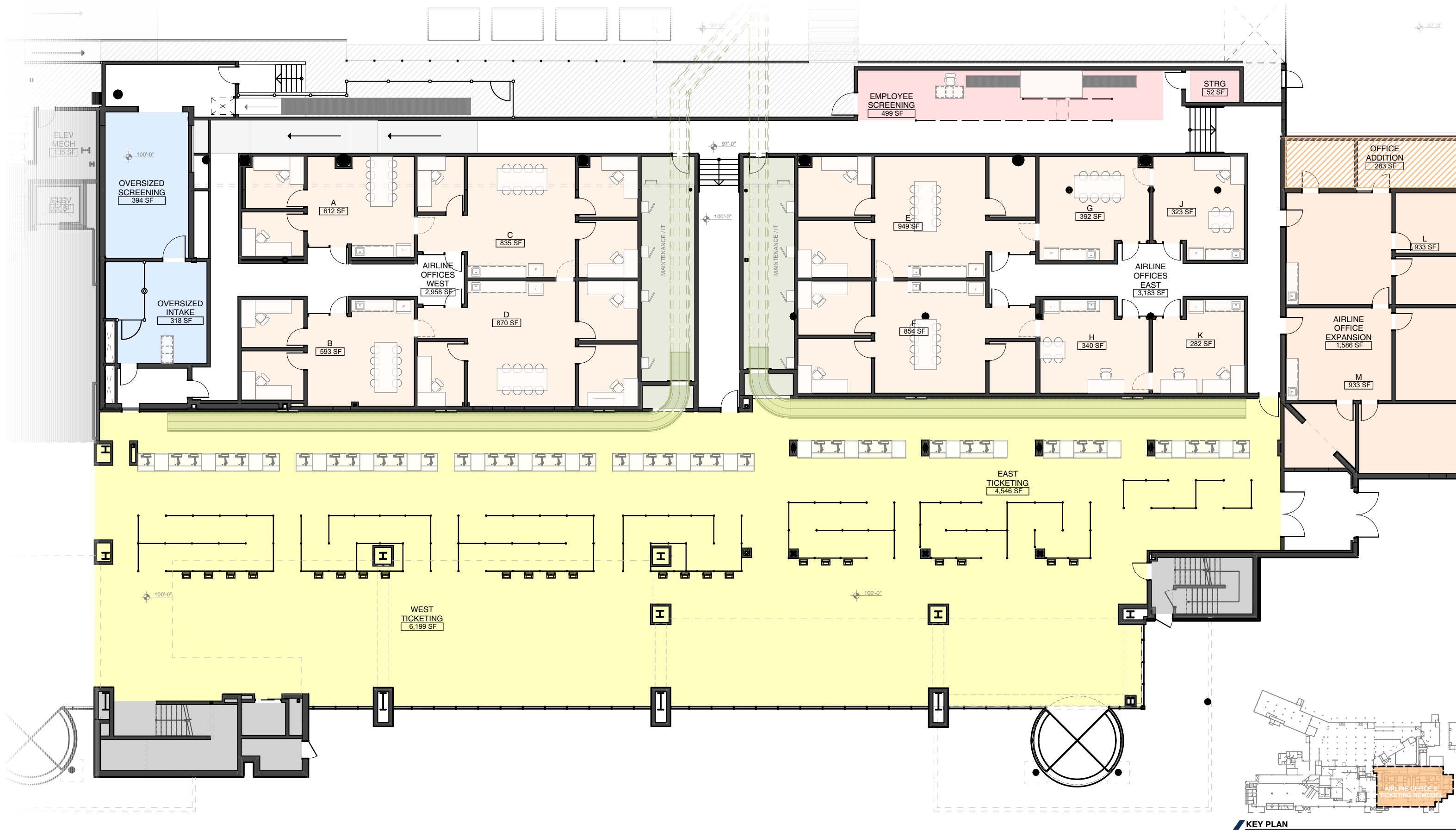

1 FIRST FLOOR PLAN
1/16" = 1'-0"

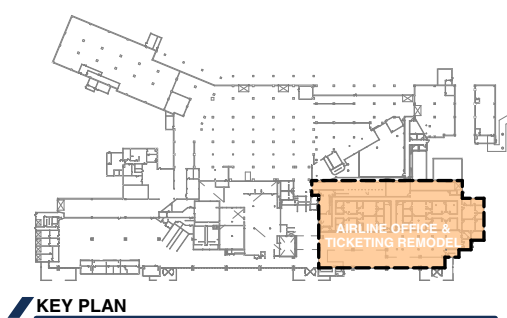

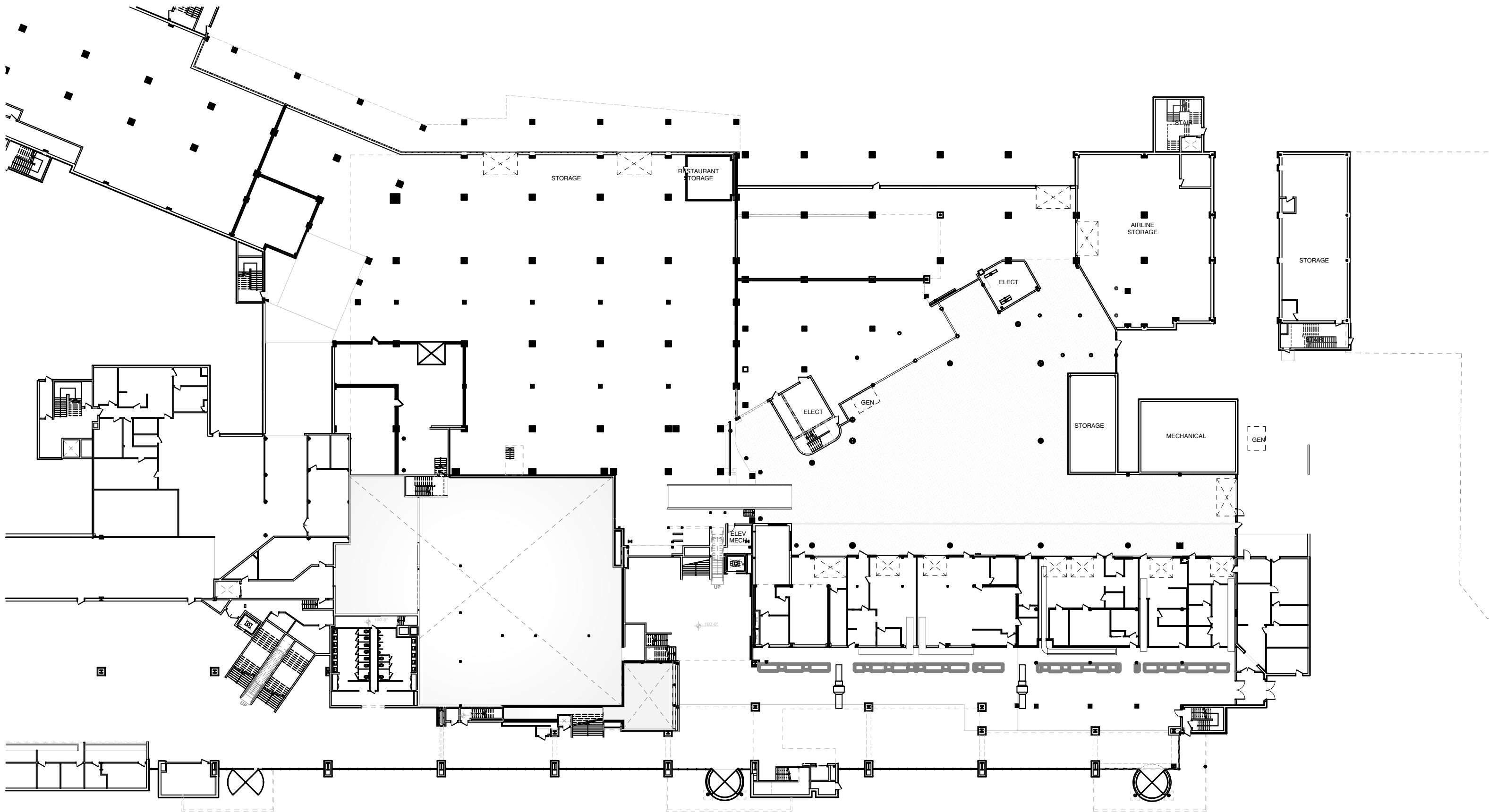

1 (E) OVERALL FIRST FLOOR PLAN
 1" = 40'