

LANDSCAPE LEGEND:

ALL TREES TO MEET OR EXCEED A.N.A. SPECIFICATIONS (U.O.N. - UNLESS OTHERWISE NOTED)

| TREES | SIZE | QTY |
|--|-------------------------|-----|
| Acacia salicina Willow Acacia Must be 12" Tall at time of planting | 36" Box Standard | 31 |
| Acacia aneura Mulga Tree | 24" Box Standard | 06 |
| Chilopsis linearis 'Bubba' Seedless Desert Willow -Bubba var. | 24" Box Multi-Trunk | 03 |
| Cercidium florida Blue Palo Verde | 24" Box High Breaker | 03 |
| Prosopis velutina 'Hybrid Cooperi' Cooper's Thornless Mesquite | 24" Box Multi-Trunk | 05 |
| Cercidium Hybrid Desert Museum | 24" Box Standard | 11 |
| Ulmus parviflora Evergreen Elm | 24" Box Standard | 10 |
| Existing Tree to remain and be protected | 48" Box or Larger | |

SHRUBS / ACCENTS

| | SIZE | QTY |
|---|----------------------------|-----|
| Eremophila hydrophana Blue Bells | 5 Gallon | 36 |
| Hesperaloe parviflora 'Yellow' Yellow Hesperaloe Yucca | 5 Gallon | 96 |
| Acacia SP Emu Cousin Itt | 5 Gallon | 44 |
| Senna wislizenii Shrubby Senna | 5 Gallon | 31 |
| Tecoma stans Yellow Bells / Orange Jubilee | 5 Gallon (Even Mixture) | 65 |

GROUNDCOVERS

| | SIZE | QTY |
|--|----------|-----|
| Lantana X Dallas Red Lantana | 1 Gallon | 19 |
| Lantana montevidensis Trailing Lantana Purple | 1 Gallon | 46 |
| Decomposed Granite-1/2" Match Existing 2" min thickness in all NEW landscape areas Top Dress parking island in large central parking lot. | | |

CITY OF CHANDLER LANDSCAPE PLAN NOTES

- ALL SITE IMPROVEMENTS, INCLUDING LANDSCAPE AND SITE CLEANUP, MUST BE COMPLETED PRIOR TO CERTIFICATE OF OCCUPANCY FOR ANY BUILDING WITHIN A PHASE.
- NO OBSTRUCTIONS TO VIEW SHALL BE ERECTED, CONSTRUCTED OR PARKED WITHIN THE SIGHT VISIBILITY AREA, ALL TREES WITHIN THE LINE OF SIGHT WILL MAINTAIN A CANOPY HEIGHT ABOVE 6' CURB ELEVATION, ALL SHRUBS IN THIS AREA MAY NOT REACH A MATURE HEIGHT OVER 24"
- ALL PLANT MATERIALS ARE GUARANTEED FOR A MINIMUM PERIOD OF SIXTY (60) DAYS FROM THE DATE OF FINAL APPROVAL BY THE CITY. ANY PLANT MATERIALS, WHICH ARE NOT APPROVED BY THE CITY PRIOR TO OCTOBER 1 OF THE CALENDAR YEAR IN WHICH THEY ARE INSTALLED, SHALL BE FURTHER GUARANTEED UNTIL MAY 20 OF THE FOLLOWING CALENDAR YEAR.
- TREES, SHRUBS, VINES, GROUND COVER AND TURF THAT HAVE TO BE REPLACED UNDER TERMS OF THE GUARANTEE, SHALL BE GUARANTEED FOR AN ADDITIONAL SIXTY (60) DAYS FROM THE DATE OF REPLACEMENT.
- ALL PLANT MATERIALS MUST BE MAINTAINED IN HEALTH AND VIGOR AND BE ALLOWED TO ATTAIN NATURAL SIZE AND SHAPE IN ACCORDANCE WITH THE ORIGINALLY APPROVED LANDSCAPE PLAN. SEE SECTION 1902 (6)(H).
- PARKING LOT TREES MUST HAVE A MINIMUM CLEAR CANOPY DISTANCE OF 5'. SEE SECTION 1903(C)(4).
- FINISH GRADE OF LANDSCAPE AREAS (TOP OF TURF OR D.G.) MUST BE GRADED 1-1/2" BELOW CONCRETE OR OTHER PAVED SURFACES. SEE SECTION 1903(6)(C)(11) ZONING CODE.
- TREES MUST BE PLACED A MINIMUM OF 5' FROM SIDEWALKS, PUBLIC ACCESS-WAYS. SHRUBS MUST BE, AT MATURITY, 3' FROM ALL SIDES OF A FIRE HYDRANT, PIV OR FDC. SEE SECTION 1903(6)(J)(1), ZONING CODE. (INDICATE HYDRANT, PIV AND FDC LOCATIONS ON THE LANDSCAPE PLAN)
- ALL LANDSCAPING SHALL BE MAINTAINED BY THE LANDOWNER OR THE LESSOR. SEE SECTION 1903(6)(G), ZONING CODE.
- THERE SHALL BE NO OBSTRUCTIONS OF SITE SIGNAGE BY LANDSCAPE PLANT MATERIAL, AND THAT SUCH MUST BE RELOCATED AND/OR CORRECTED BEFORE THE FIELD INSPECTION WILL ACCEPT/PASS THE SIGN IN THE FIELD OR ISSUE A CERTIFICATE OF OCCUPANCY FOR A PROJECT.
- ALL TRANSFORMER BOXES, METER PANELS AND ELECTRIC EQUIPMENT, BACKFLOW DEVICES OR ANY OTHER UTILITY EQUIPMENT NOT ABLE OR REQUIRED TO BE SCREENED BY THE LANDSCAPING OR WALLS SHALL BE PAINTED TO MATCH THE BUILDING COLOR.
- ALL WALLS OVER 7' IN HEIGHT, SITE LIGHTING, SIGNAGE, RAMADAS AND SHADE STRUCTURES REQUIRE SEPARATE SUBMITTAL AND PERMITS.
- ALL TREES SHALL COMPLY WITH THE LATEST AMENDED EDITION OF THE "ARIZONA NURSERY ASSOCIATION - RECOMMENDED TREE SPECIFICATIONS." SEE SECTION 1903(6)(A) ZONING CODE; (THIS IS TO BE NOTED IN THE PLANT LEGENDS ON EACH SHEET)

EXISTING LANDSCAPE AND IRRIGATION NOTES

- SITE VERIFY ALL EXISTING CONDITIONS PRIOR TO BIDDING. ANY DISCREPANCIES ARE TO BE BROUGHT TO THE LANDSCAPE ARCHITECT IMMEDIATELY.
- ALL PLANT MATERIAL DESIGNATED AS "EXISTING TO REMAIN" SHALL BE PROTECTED DURING ALL PHASES OF CONSTRUCTION. ANY TREE THAT DIES DUE TO LACK OF WATER, MAINTENANCE/CARE, NEGLIGENCE OR VANDALISM SHALL BE REPLACED BY A LIKE TYPE TREE 48" BOX MINIMUM. ALL SHRUBS AND GROUNDCOVER SHALL BE REPLACED WITH 5 GALLON PLANTS, AT NO ADDITIONAL COST TO THE OWNER. LANDSCAPE AREAS DISTURBED BY NEW CONSTRUCTION SHALL BE REPAIRED WITH NEW DECOMPOSED GRANITE MATCHING EXISTING. BLEND ALL DISTURBED AREAS WITH UNDISTURBED SO THERE IS A SMOOTH TRANSITION BETWEEN ALL EDGES. REPLACE ALL DISTURBED, BROKEN OR DAMAGED HEADERS WITH MATCHING TYPE.
- ALL EXISTING PLANT MATERIAL AND ADJACENT PLANT MATERIAL SHALL HAVE UNINTERRUPTED WATERING DURING ALL PHASES OF CONSTRUCTION. THIS SHALL INCLUDE BUT NOT BE LIMITED TO: HAND WATERING, TEMPORARY ABOVE GROUND IRRIGATION, EXISTING SYSTEM ETC....
- EXISTING IRRIGATION SYSTEM SHALL BE PROTECTED, MAINTAINED AND REPAIRED DURING ALL PHASES OF CONSTRUCTION. IF THE EXISTING SYSTEM IS TIED INTO ADJACENT PROPERTIES. ALL EQUIPMENT SUCH AS MAINLINE, WIRES, LATERALS, HEADS, VALVES ETC... SHALL BE REPAIRED AND REPLACED TO MAINTAIN CONTINUOUS WATERING.
- PROVIDE NEW SCHEDULE 40 SLEEVES AT ALL NEW DRIVES (SEE SLEEVE SCHEDULE)
- ALL EXISTING TO REMAIN TREES AND SHRUBS, SHALL BE SELECTIVELY PRUNED PER LANDSCAPE ARCHITECTS DIRECTIONS, AND GUARANTEED 100% IRRIGATION COVERAGE DURING ALL CONSTRUCTION PHASES.
- ALL EXISTING SHRUBS WITHIN THE SIGHT DISTANCE LINES AND VISIBILITY TRIANGLES SHALL BE SELECTIVELY PRUNED TO A MAXIMUM HEIGHT OF 30".
- ALL EXISTING TREES WITHIN THE SIGHT DISTANCE LINES AND VISIBILITY TRIANGLES SHALL HAVE ITS CANOPY BE LIFTED TO A CLEAR HEIGHT OF 7'.
- LANDSCAPE CONTRACTOR SHALL BORE UNDER EXISTING SIDEWALK RATHER THAN SAW CUT TO PLACE NEW SLEEVES.
- L.C. AND G.C. ARE RESPONSIBLE FOR LOCATING ALL EXISTING IRRIGATION SLEEVES PRIOR TO SETTING ANY PAVERS AND/OR CONCRETE.

**N IOWA STREET
10 TREES TOTAL
Street Tree Requirements:
25% - 48" Box / 25% - 36" Box / 50% - 24" Box
5 Existing - 48" Box or Larger
5 New - 24" Box**

GENERAL BUILDING FOUNDATION LANDSCAPE / IRRIGATION NOTES:

POSITIVE DRAINAGE NEEDS TO BE MAINTAINED FROM THE BUILDINGS EXTERIOR WALLS FOR A MINIMUM OF 10'. NO IRRIGATED LANDSCAPE MATERIALS WITHIN THE FIRST 3' NEXT TO THE BUILDING FOUNDATION. WITHIN 3'-5' OF THE BUILDING FOUNDATION ONLY LANDSCAPE MATERIALS THAT CAN BE IRRIGATED WITH A 1 GPH EMITTER ARE ALLOWED. ANY LANDSCAPE MATERIALS REQUIRING AN EMITTER GREATER THAN 1GPH, INCLUDING TURF SHALL BE A MINIMUM OF 5' FROM THE OUTSIDE FACE OF THE BUILDING FOUNDATION. ALL IRRIGATION LINES, OTHER THAN THOSE SUPPLYING INDIVIDUAL EMITTERS SHALL NOT BE PLACED WITHIN 5' OF THE BUILDING FOUNDATION.

| | |
|---------------------------------------|-------------------------|
| New Total Site Area: | 81,082 S.F. |
| Exist Area Upgraded: | 41,497 S.F. |
| Total Building Area: | 20,689 S.F. |
| NEW Landscape Area: | 29,595 S.F. |
| NEW Parking Area: | 9,307 S.F. |
| NEW Landscape in Parking Area: | 1,876 S.F. = 20% |
| NEW Live Coverage: | 30,754 S.F. |
| NEW Inert Coverage: | 32,825 S.F. |

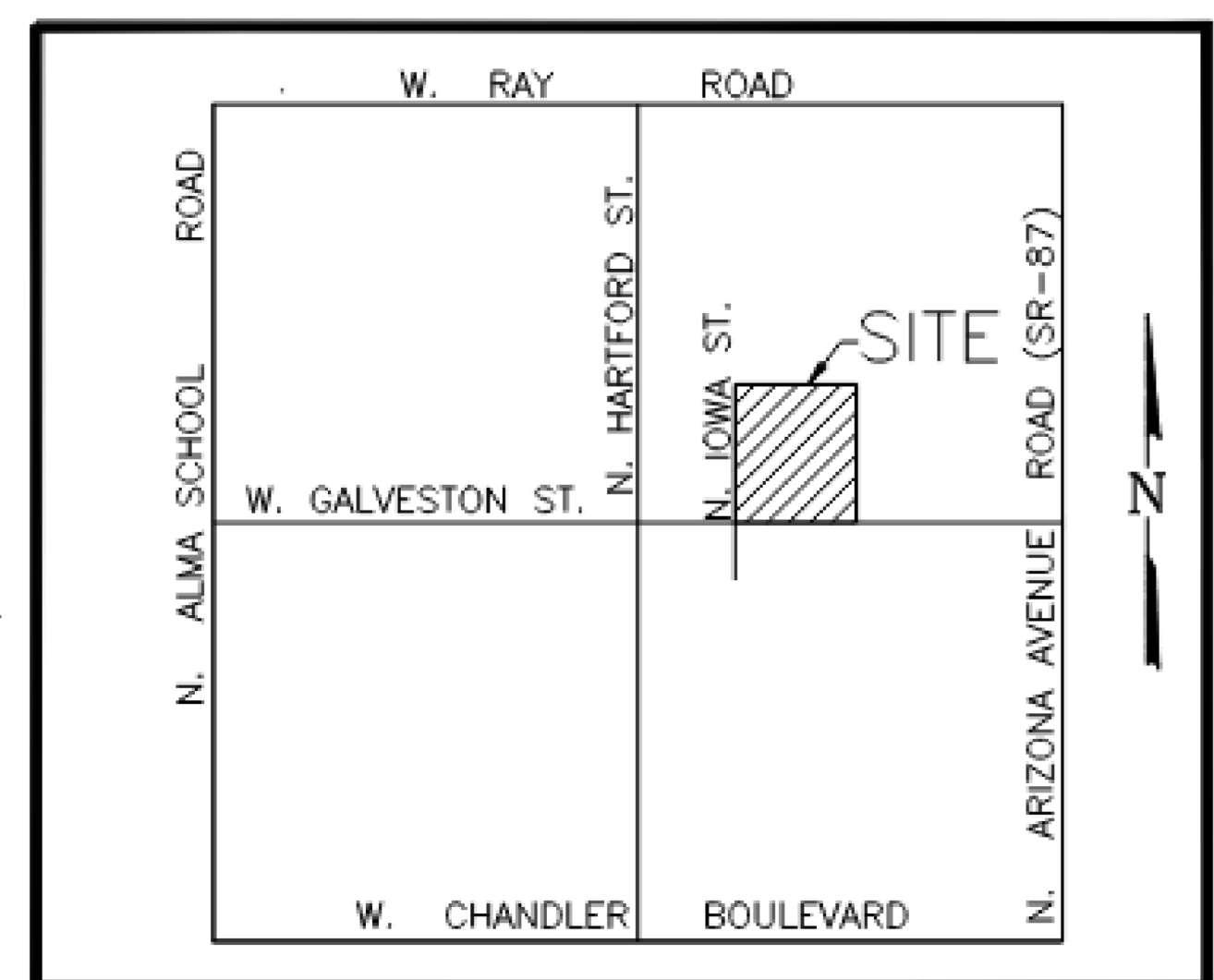

VICINITY MAP
N.T.S.

OWNER:

ST. MARY ROMAN CATHOLIC PARISH
400 E. MONROE STREET
PHOENIX, ARIZONA 85004
CONTACT: ZACH KILGAS
(602) 354-2162
ZKILGAS@DPHX.ORG

ARCHITECT:

ADAPTIVE ARCHITECTS, INC.
160 E. UNIVERSITY DRIVE, SUITE #2
MESA, ARIZONA 85201
CONTACT: VINCE DI BELLA, AIA
(480) 655-0633
VINCE@ADAPTIVEARCHITECTSINC.COM

CIVIL ENGINEER:

HENDERSON ENGINEERING GROUP, LLC
1533 S. PARKCREST CIRCLE
MESA, ARIZONA 85206
CONTACT: BRENT L. HENDERSON P.E.
(480) 334-7507
BRENT@HEG-LLC.COM

LAND SURVEYOR

CONSULTANT REGISTERED SURVEYING, INC.
8732 E. PICCADILLY ROAD
SCOTTSDALE, ARIZONA 85251
CONTACT: CARL SITTERLEY, R.L.S.
(480) 620-1382
CSITTERLEY-CRS@COX.NET

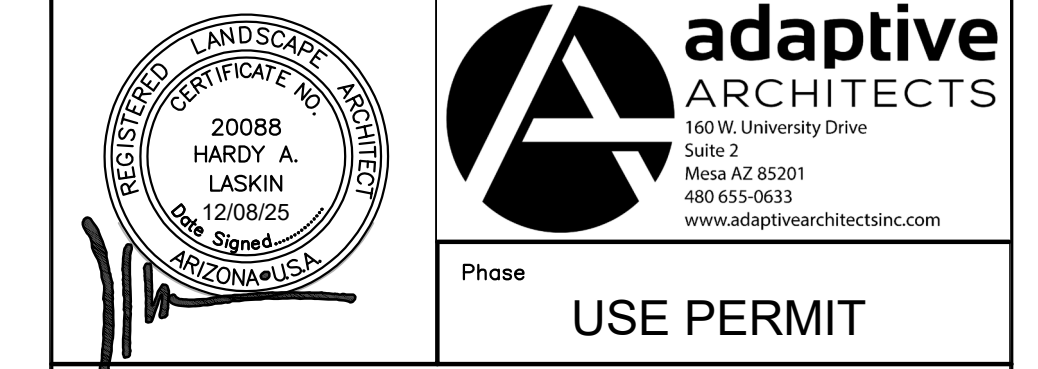
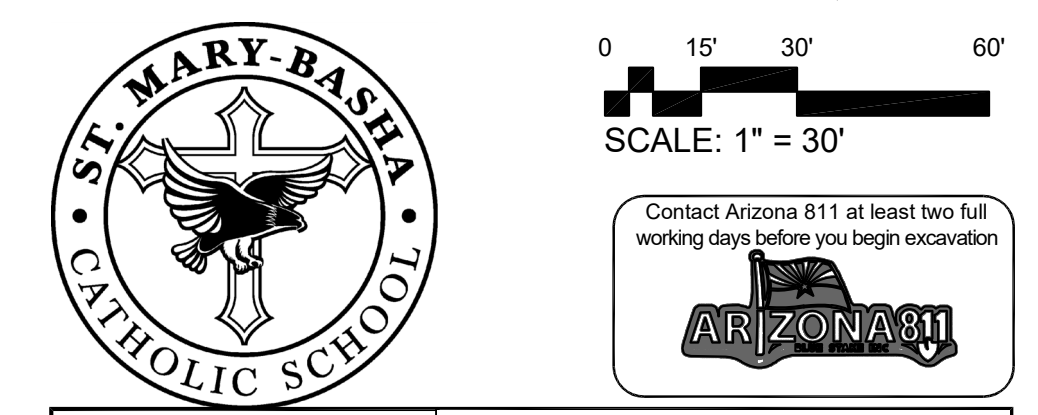

USE PERMIT

ST. MARY-BASHA CATHOLIC SCHOOL
200 W GALVESTON ST.
CHANDLER, AZ 85225

CONCEPT LANDSCAPE PLAN

| | | |
|--------------------------------|----------------|--|
| Project Number: 2411 | Revision Date: | Sheet Number: CLP 1 OF 1 |
| Date: 12/08/2025 | | |