



Annexation Map

Ordinance No. 5151

-  Proposed Annexation
East of the Northeast Corner of Willis Road and McQueen Road
-  Incorporated Area
-  Unincorporated Area

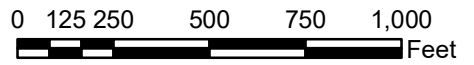
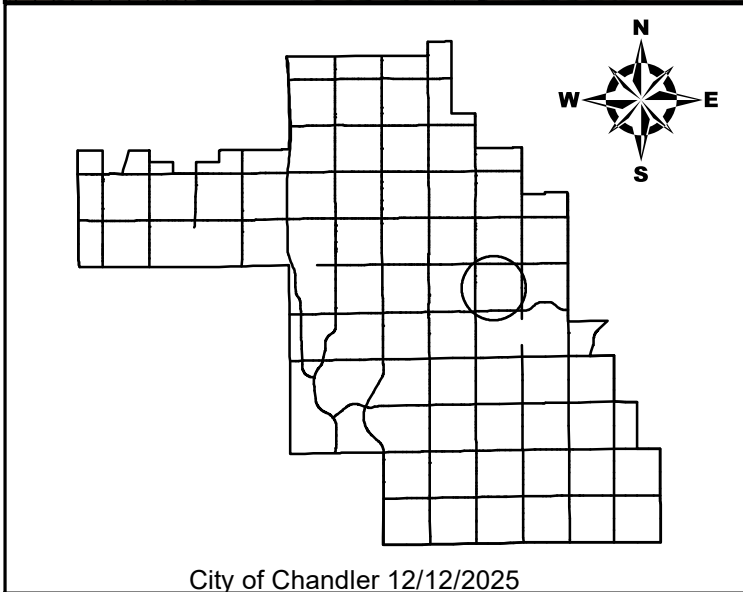





Exhibit A



Annexation Map

Ordinance No. 5151

-  Proposed Annexation
East of the Northeast Corner of Willis Road and McQueen Road
-  Incorporated Area
-  Unincorporated Area

0 125 250 500 750 1,000 Feet

Exhibit A