

Minor work relocate wall

Add Food prep sink

- independent indirect waste to existing floor sink. Trap required
- Extend existing HW/KW from adjacent sinks
- Add electrical outlets in sandwich prep area.

PROPOSED

BLD19-2309

TRANSPORTATION & DEVELOPMENT DEPARTMENT
City of Chandler

REVIEWED FOR COMPLIANCE WITH BUILDING CODES MAINTAIN ON JOB SITE

Review of plans and specifications shall not be construed as a permit for or an approval of any violation of the provisions of the Building Inspection Division.

AS IS

NOTE CHANGES

DATE: 7-24-19 BY: [Signature]

ARCHIVE

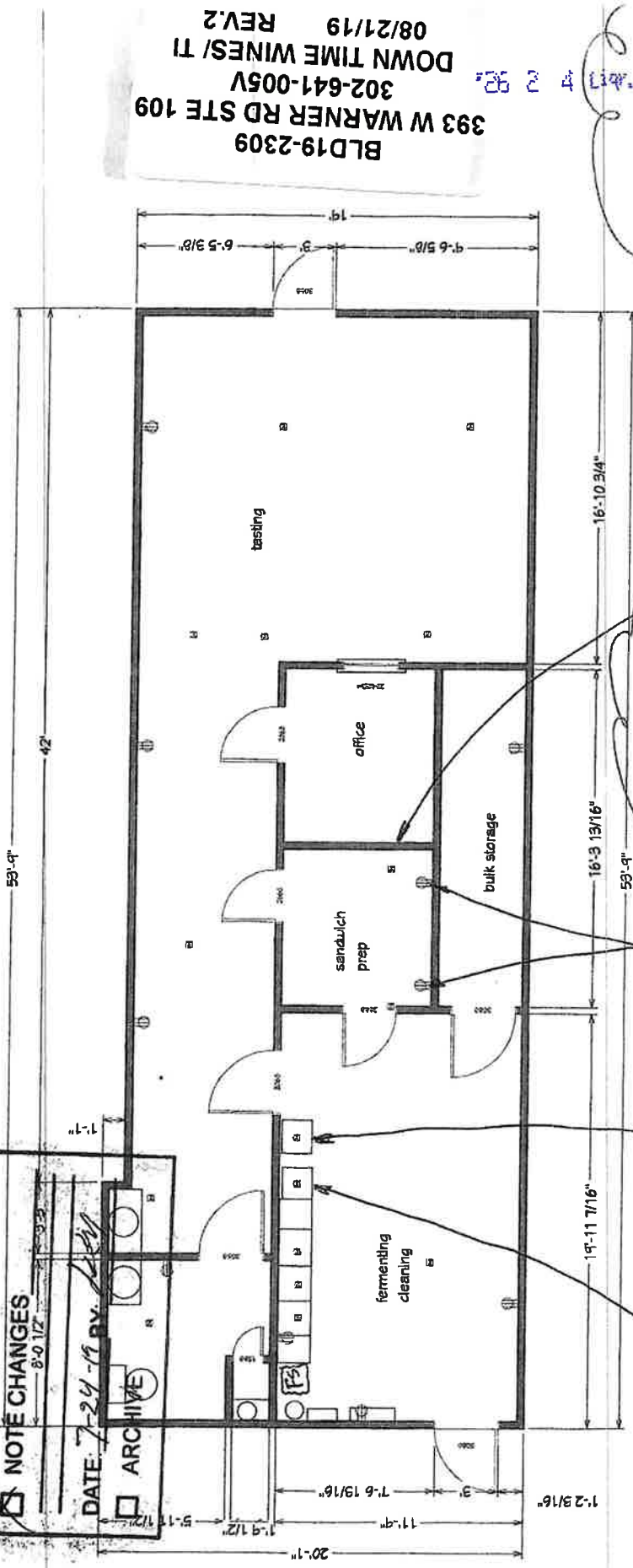

- INSTALL HANDWASH SINK OVER APP. 7" FERMENTING CLEANING
- RELOCATE WALL 32" (FROM EXISTING) TOWARD BACK
- ADD TWO OUTLETS
- ONE DEDICATED FOR MICROWAVE
- Provide pipe water in subfloor
- ALL WALLS EXCEPT BATHROOM ARE NON-STRUCTURAL & 8' HEIGHT.
- SHOW AMPS
- CONN. TO SLEB