

ADOT Disposal D-SE-001 EXHIBIT "A"

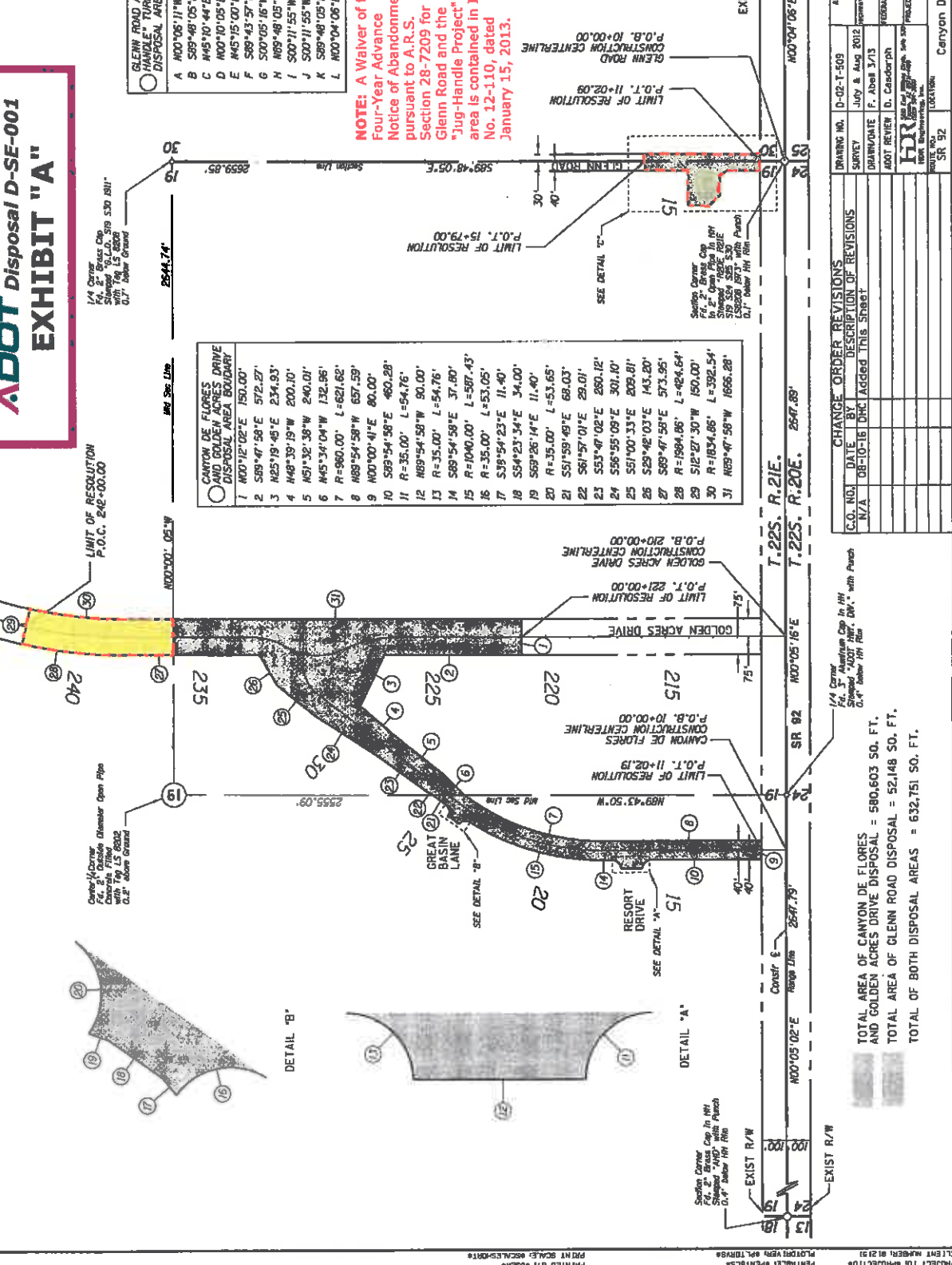
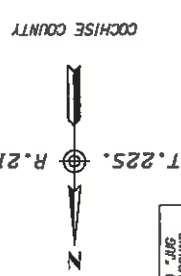

GLENN ROAD AND "JUG HANDLE" TURN-AROUND DISPOSAL AREA BOUNDARY

A	N00°06'11"W	40.00'
B	S89°48'05"E	138.14'
C	N45°10'44"E	38.49'
D	N00°10'05"E	75.00'
E	N45°15'00"E	59.91'
F	S89°43'57"E	89.86'
G	S00°05'16"W	144.88'
H	N69°48'05"W	181.22'
I	S00°11'55"W	40.00'
J	S00°11'55"W	30.00'
K	S89°48'05"E	479.00'
L	N00°04'05"E	30.00'

NOTE: A Waiver of the Four-Year Advance Notice of Abandonment, pursuant to A.R.S. Section 28-7209 for Glenn Road and the "Jug-Handle Project" area is contained in IGA No. 12-110, dated January 15, 2013.

CANYON DE FLORES AND GOLDEN ACRES DRIVE DISPOSAL AREA BOUNDARY

1	N00°12'02"E	150.00'
2	S89°47'58"E	572.27'
3	N25°19'45"E	234.93'
4	N48°39'19"W	200.10'
5	N51°32'38"W	240.01'
6	N45°34'04"W	132.96'
7	R=980.00'	L=621.62'
8	N69°54'58"W	657.59'
9	N00°00'41"E	80.00'
10	S89°54'58"E	460.28'
11	R=35.00'	L=54.76'
12	N69°54'58"W	90.00'
13	R=35.00'	L=54.76'
14	S89°54'58"E	37.80'
15	R=1040.00'	L=507.43'
16	R=35.00'	L=53.05'
17	S39°54'23"E	11.40'
18	S54°23'34"E	34.00'
19	S89°26'14"E	11.40'
20	R=35.00'	L=53.65'
21	S51°59'49"E	68.03'
22	S61°57'01"E	20.01'
23	S53°47'02"E	260.12'
24	S56°55'09"E	301.10'
25	S51°00'33"E	209.81'
26	S29°48'03"E	143.20'
27	S89°47'58"E	573.96'
28	R=1894.86'	L=424.64'
29	S12°27'30"W	150.00'
30	R=1834.86'	L=392.54'
31	N69°47'58"W	1666.28'

DRIVING NO.	D-02-T-509	ARIZONA DEPARTMENT OF TRANSPORTATION
SURVEY	July & Aug 2012	INTERNAL TRANSPORTATION DIVISION
DRAWN/DATE	F. Abel 3/13	SIERRA VISTA-BISBEE
ADOT REVIEW	D. Casadorph	GENERAL AB. M.L.
PROJECT NO.	092-AIG000A	
PROJECT NAME	Canyon De Flores-Glenn Road	
DATE	08/17/16	
SCALE	AS SHOWN	
PROJECT NO.	092 CH 324 HT167	
PROJECT NAME	Canyon De Flores-Glenn Road	
PROJECT NO.	11119-23 AM	
PROJECT NAME	11119-23 AM	

C.O. NO.	DATE	BY	DESCRIPTION OF REVISIONS
N/A	08-10-16	DKK	Added This Sheet

CHANGE ORDER REVISIONS

TOTAL AREA OF CANYON DE FLORES AND GOLDEN ACRES DRIVE DISPOSAL = 580,603 SQ. FT.
TOTAL AREA OF GLENN ROAD DISPOSAL = 52,148 SQ. FT.
TOTAL OF BOTH DISPOSAL AREAS = 632,751 SQ. FT.