



16 NOV 14 11:47 AM 251

Arizona Department of Liquor Licenses and Control
800 W Washington 5th Floor
Phoenix, AZ 85007-2934
www.azliquor.gov
(602) 542-5141

Parcel # 402-83-0104

Application for Liquor License
Type or Print with Black Ink

APPLICATION FEE AND INTERIM PERMIT FEES (IF APPLICABLE) ARE NOT REFUNDABLE
A service fee of \$25 will be charged for all dishonored checks (A.R.S. § 44-6852)

RECEIVED
COCHISE COUNTY
BOARD OF SUPERVISORS
2016 NOV 21 A 7:40

SECTION 1 This application is for a:

- Interim Permit (Complete Section 5)
New License (Complete Sections 2, 3, 4, 13, 14, 15, 16)
Person Transfer (Complete Section 2, 3, 4, 12, 13, 14, 16)
Location Transfer (Bars and Liquor Stores Only)
Probate/ Will Assignment/ Divorce Decree
Government (Complete Sections 2, 3, 4, 10, 13, 16)
Seasonal

SECTION 2 Type of Ownership:

- J.T.W.R.O.S. (Complete Section 6)
Individual (Complete Section 6)
Partnership (Complete Section 6)
Corporation (Complete Section 7)
Limited Liability Co (Complete Section 7)
Club (Complete Section 8)
Government (Complete Section 10)
Trust (Complete Section 6)
Tribe (Complete Section 6)
Other (Explain)

SECTION 3 Type of license

1. Type of license: Farm Winery (Series 13) LICENSE # 13023048

SECTION 4 Applicants

- 1. Individual Owner/Agent's Name: DESFACHELLES ERIC T.
2. Owner Name: Copper Horse Vineyard LLC
3. Business Name: Copper Horse Vineyard
4. Business Location Address: 3450 S. Copper Horse Dr.
5. Mailing Address: 3450 S. Copper Horse Dr.
6. Business Phone: (206) 707-2959
7. Email Address: edesfac@gmail.com
8. Is the Business located within the incorporated limits of the above city or town?
9. Does the Business location address have a street address for a City or Town but is actually in the boundaries of another City, Town or Tribal Reservation?
10. Total Price paid for Series 6 Bar, Series 7 Beer & Wine Bar or Series 9 Liquor Store ( license only) \$ 0

Department Use Only

Fees: Application 100, Interim Permit, Site Inspection, Finger Prints 22, Total of All Fees \$ 122-
Is Arizona Statement of Citizenship & Alien Status for State Benefits complete? Yes
Accepted by: MS Date: 11/15/2016 License # 13023048

**SECTION 5 Interim Permit**

- If you intend to operate business when your application is pending you will need an interim permit pursuant to ARS § 4-203.01
- There **MUST** be a valid license of the same type you are applying for currently issued to the location or for the replacement of a Hotel/Motel license with a Restaurant license pursuant to A.R.S. § 4-203.01.

1. Enter license number currently at the location: \_\_\_\_\_

2. Is the license currently in use?  Yes  No If no, how long has it been out of use? \_\_\_\_\_

**Attach a copy of the license currently issued at this location to this application.**

I, _____ (Print Full Name)	declare that I am the CURRENT OWNER, AGENT, OR CONTROLLING PERSON on the stated license and location.
X _____ (Signature of CURRENT Individual Owner/Agent)	State of _____ County of _____ The foregoing instrument was acknowledged before me this _____
My commission expires on: _____ Date	_____ of _____ / _____ Day Month Year
_____ Signature of NOTARY PUBLIC	

**SECTION 6 Individual, Partnership, J.T.W.R.O.S, Trust, Tribe Ownerships**

EACH PERSON LISTED MUST SUBMIT A COMPLETED QUESTIONNAIRE, AN "APPLICANT" TYPE FINGERPRINT CARD AND \$22 PROCESSING FEE FOR EACH CARD.

Individual

Last	First	Middle	%Owned	Mailing Address	City	State	Zip Code

Is any person other than above, going to share in profit/losses of the business?  Yes  No

If Yes, give name, current address, and telephone number of person(s). Use additional sheets if necessary.

Last	First	Middle	Mailing Address	City	State	Zip Code	Phone #

Partnership

Name of Partnership: \_\_\_\_\_

General-Limited	Last	First	Middle	%Owned	Mailing Address	City	State	Zip Code
<input type="checkbox"/>	<input type="checkbox"/>							
<input type="checkbox"/>	<input type="checkbox"/>							
<input type="checkbox"/>	<input type="checkbox"/>							
<input type="checkbox"/>	<input type="checkbox"/>							

J.T.W.R.O.S (Joint Tenant with Rights of Survivorship)

Name of J.T.W.R.O.S: \_\_\_\_\_

Last	First	Middle	Mailing Address	City	State	Zip Code

**SECTION 6 - continued**

**TRUST**

Name of Trust: \_\_\_\_\_

Last	First	Middle	Mailing Address	City	State	Zip Code

**TRIBE**

Name of Tribal Ownership: \_\_\_\_\_

Last	First	Middle	Mailing Address	City	State	Zip Code

**SECTION 7 Corporations/ Limited Liability Co**

EACH PERSON LISTED MUST SUBMIT A COMPLETED QUESTIONNAIRE, AN "APPLICANT" TYPE FINGERPRINT CARD AND \$22 PROCESSING FEE FOR EACH CARD.

- Corporation Complete Questions 1, 2, 3, 4, 5, 6, and 7  
 L.L.C. Complete Questions 1, 2, 3, 4, 5, 6, and 7

1. Name of Corporation/ L.L.C.: Copper Horse Vineyard LLC

2. Date Incorporated/Organized: 10/20/2011 State where Incorporated/Organized: AZ

3. AZ Corporation or AZ L.L.C File No: L17150915 Date authorized to do Business in AZ: 11/03/2011

4. Is Corp/LLC. Non Profit?  Yes  No

5. List Directors, Officers, Members in Corporation/LLC:

Last	First	Middle	Title	Mailing Address	City	State	Zip Code
DESFACHELLES	Eric	T.	Member	3450 S Copper Horse Dr, Portal, AZ			85632

(Attach additional sheet if necessary)

6. List all Stockholders / percentage owners who own 10% or more:

Last	First	Middle	%Owned	Mailing Address	City	State	Zip Code
DESFACHELLES	Eric	T.	100%	3450 S Copper Horse Dr, Portal, AZ			85632

(Attach additional sheet if necessary)

7. If the corporation/ LLC are owned by another entity, attach an Organizational **FLOWCHART** showing the structure of the ownership. Attach additional sheets as needed in order to disclose the Officers, Directors, Members, Managers, Partners, Stockholders and percentage owners of those entities.



**SECTION 12 Person to Person Transfer**

**Questions to be completed by Current Licensee (Bar and Liquor Stores Only- Series, 06, 07, and 09)**

1. Individual Owner / Agent Name: \_\_\_\_\_ Entity: \_\_\_\_\_  
Last First Middle (Individual, Agent, Etc.)

2. Ownership Name: \_\_\_\_\_  
(Exactly as it appears on license)

3. Business Name: \_\_\_\_\_  
(Exactly as it appears on license)

4. Business Location Address: \_\_\_\_\_  
Street City State Zip

5. License Type: \_\_\_\_\_ License Number: \_\_\_\_\_

6. Current Mailing Address: \_\_\_\_\_  
Street City State Zip

7. Have all creditors, lien holders, interest holders, etc. been notified?  Yes  No

8. Does the applicant intend to operate the business while this application is pending?  Yes  No

If yes, complete Section 5 (**Interim Permit**) of this application; attach fee, and current license to this application.

9. I, (Print Full Name) \_\_\_\_\_ hereby authorize the department to process this Application to transfer the privilege of the license to the applicant provided that all terms and conditions of sale are met. Based on the fulfillment of these conditions, I certify that the applicant now owns or will own the property rights of the license by the date of issue.

I, (Print Full Name) \_\_\_\_\_, declare that I am the **CURRENT OWNER, MEMBER, PARTNER STOCKHOLDER or LICENSEE** of the stated license. I have read the above Section 12 and confirm that all statements are true, correct, and complete.

**NOTARY**

X \_\_\_\_\_  
(Signature of CURRENT Individual Owner/Agent)

State of \_\_\_\_\_ County of \_\_\_\_\_  
The foregoing instrument was acknowledged before me this

My commission expires on: \_\_\_\_\_  
Date

\_\_\_\_\_ of \_\_\_\_\_  
Day Month Year

\_\_\_\_\_  
Signature of NOTARY PUBLIC

**SECTION 13 Proximity to Church or School**

Questions to be completed by all in-state applicants.

**A.R.S. § 4-207.** (A) and (B) state that no retailer's license shall be issued for any premises which are at the time the license application is received by the director, within three hundred (300) horizontal feet of a church, within three hundred (300) horizontal feet of a public or private school building with kindergarten programs or grades one (1) through (12) or within three hundred (300) horizontal feet of a fenced recreational area adjacent to such school building.

The above paragraph DOES NOT apply to:

- a) Restaurant license (§ 4-205.02) Series 12
- b) Hotel/motel license (§ 4-205.01) Series 11
- c) Microbrewery Series 3
- d) Craft Distillery Series 18
- e) Government license (§ 4-205.03) Series 5
- f) Fenced playing area of a golf course (§ 4-207 (B)(5))
- g) Wholesaler Series 4
- h) Farm Winery Series 13

1. Distance to nearest School: \_\_\_\_\_ Name of School: \_\_\_\_\_  
 (If less than one (1) mile note footage) Address: \_\_\_\_\_

2. Distance to nearest Church: \_\_\_\_\_ Name of Church: \_\_\_\_\_  
 (If less than one (1) mile note footage) Address: \_\_\_\_\_

**SECTION 14 Business Financials**

1. I am the:  Lessee  Sub-lessee  Owner  Purchaser  Management Company

2. If the premise is leased give lessors: Name: \_\_\_\_\_  
 Address: \_\_\_\_\_  
Street City State Zip

3. Monthly Rent/ Lease Rate: \$ 0

4. What is the remaining length of the lease? Yrs. \_\_\_\_\_ Months \_\_\_\_\_

5. What is the penalty if the lease is not fulfilled? \$ \_\_\_\_\_ or Other: \_\_\_\_\_  
(Give details-attach additional sheet if necessary)

6. Total money borrowed for the Business not including lease? \$ 0  
 Please List Lenders/People you owe money to for business.

Last	First	Middle	Amount Owed	Mailing Address	City	State	Zip

(Attach additional sheet if necessary)

7. What type of business will this license be used for (be specific)?  
Grow grapes, make wine at a off-premise custom crush location, and store Tax-Paid Wine on-premise.  
Sell and ship wine to Arizona-licensed wholesalers, Arizona licensed retailers, and on-line Direct To Customer.

8. Has a license or a transfer license for the premises on this application been denied by the state with in the past (1) year?  Yes  No If yes, attach explanation.

9. Does any spirituous liquor manufacture, wholesaler, or employee have an interest in your business?  Yes  No

10. Is the premises currently license with a liquor license?  Yes  No

If yes, give license number and licensee's name:

License #: \_\_\_\_\_ Individual Owner /Agent Name: \_\_\_\_\_  
(Exactly as it appears on license)

**SECTION 15 Restaurant or hotel/motel license applicants**

- 1. Is there an existing Restaurant or Hotel/Motel Liquor License at the proposed location?  Yes  No
- 2. If the answer to Question 1 is YES, you may qualify for an Interim Permit to operate while your application is pending; consult A.R.S. § 4-203.01; and complete SECTION 5 of this application.
- 3. All Restaurant and Hotel/Motel applicants must complete a Restaurant Operation Plan form provided by the Department of Liquor Licenses and Control.
- 4. As stated in A.R.S. § 4-205.02. (H) (2), a Restaurant is an establishment which derives at least forty (40) percent of its gross revenue from the sale of food. Gross revenue is the revenue derived from sales of food and spirituous liquor on the licensed premises. By applying for this  Restaurant  Hotel/Motel, I certify that I understand that I must maintain a minimum of forty (40) percent food sales based on these definitions and have included the Restaurant Hotel/Motel Records Required for Audit form with this application.

\_\_\_\_\_  
(Applicant's Signature)

5. I understand it is my responsibility to contact the Department of Liquor Licenses and Control to schedule an inspection when all tables and chairs are on site, kitchen equipment, and, if applicable, patio barriers are in place on the licensed premises. With the exception of the patio barriers, these items are not required to be properly installed for this inspection. Failure to schedule an inspection will delay issuance of the license. If you are not ready for your inspection 90 days after filing your application, please request an extension in writing; specify why the extension is necessary; and the new inspection date you are requesting.

\_\_\_\_\_  
(Applicant's Initials)

**SECTION 16 Diagram of Premises**

Check ALL boxes that apply to your business:

- Entrances/Exits       Liquor storage areas      **Patio:**       Contiguous
- Walk-up windows       Drive-through windows       Non Contiguous

1. Is your licensed premises currently closed due to construction, renovation or redesign?  Yes  No  
If yes, what is your estimated completion date? \_\_\_\_\_

Month/Day/Year

- 2. **Restaurants and Hotel/Motel** applicants are required to draw a detailed floor plan of the kitchen and dining areas including the locations of all kitchen equipment and dining furniture. Place for diagram is on section 16 number 6.
- 3. The diagram (a detailed floor plan) you provide is required to disclose only the area(s) where spirituous liquor is to be sold, served, consumed, dispensed, possessed or stored on the premises unless it is a restaurant (see # 3 above).
- 4. Provide the square footage or outside dimensions of the licensed premises. Please do not include non-licensed premises such as parking lots, living quarters, etc.
- 5. **As stated in A.R.S. § 4-207.01 (B), I understand it is my responsibility to notify the Department of Liquor Licenses and Control when there are changes to the boundaries, entrances, exits, added or deleted doors, windows, service windows or increase or decrease to the square footage after submitting this initial diagram.**

ED.  
(Applicant's Initials)

**SECTION 16 Diagram of Premises – continued**

6. On the diagram please show only the areas where spirituous liquor is to be sold, served, consumed, dispensed, possessed or stored. It must show all entrances, exits, interior walls, bars, hi-top tables, dining tables, dining chairs, dance floor, stage, game room, and the kitchen. DO NOT include parking lots, living quarters, etc. When completing diagram, North is up ↑.

If a legible copy of a rendering or drawing of your diagram of the premises is attached to this application, please write the words "DIAGRAM ATTACHED" in the box provided for the diagram on the application.

**DIAGRAM OF PREMISES**

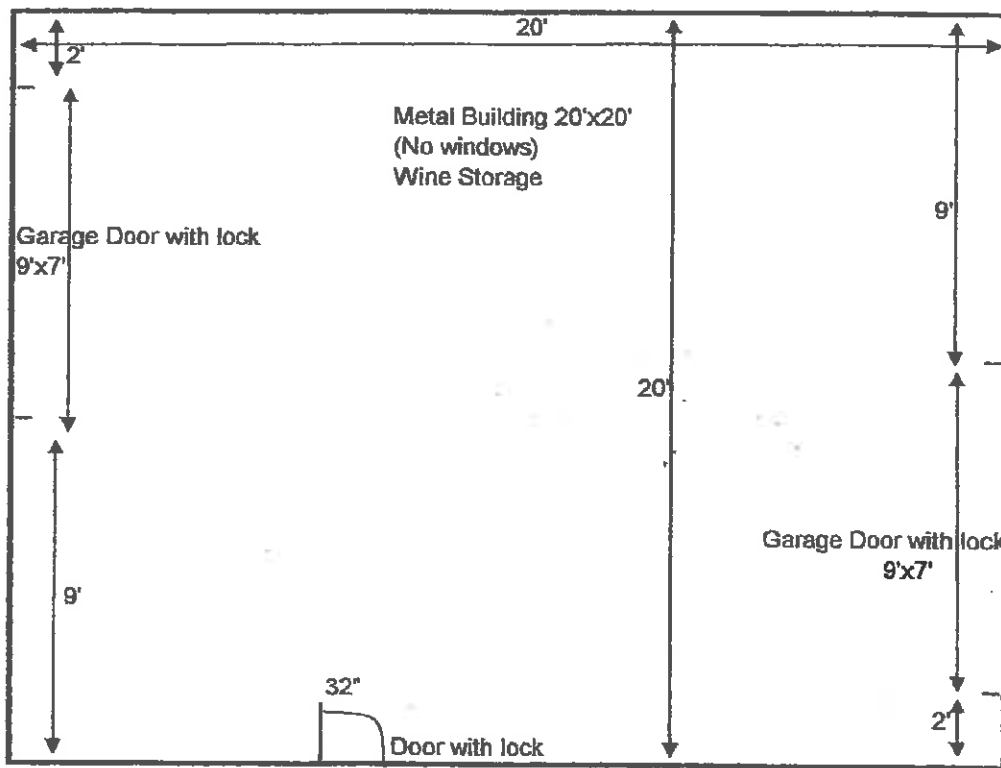

**SECTION 17 SIGNATURE BLOCK**

**NOTARY**

I, (Print Full Name) Eric T. Desfachelles, hereby declare that I am the Owner/Agent filing this application as stated in Section 4 # 1. I have read this application and verify all statements to be true, correct and complete.

x   
(Signature of CURRENT Individual Owner/Agent)

State of ARIZONA County of GRAHAM  
The foregoing instrument was acknowledged before me this

My commission expires on: FEB 10, 2019  
Date

20<sup>th</sup> of Oct., 2016  
Day Month Year

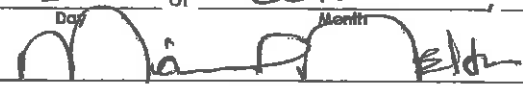
  
Signature of NOTARY PUBLIC

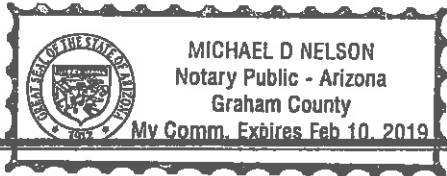

**A.R.S. § 41-1030. Invalidity of rules not made according to this chapter, prohibited agency action; prohibited acts by state employees; enforcement; notice**

B. An agency shall not base a licensing decision in whole or in part on a licensing requirement or condition that is not specifically authorized by statute, rule or state tribal gaming compact. A general grant of authority in statute does not constitute a basis for imposing a licensing requirement or condition unless a rule is made pursuant to that general grant of authority that specifically authorizes the requirement or condition.

D. THIS SECTION MAY BE ENFORCED IN A PRIVATE CIVIL ACTION AND RELIEF MAY BE AWARDED AGAINST THE STATE. THE COURT MAY AWARD REASONABLE ATTORNEY FEES, DAMAGES AND ALL FEES ASSOCIATED WITH THE LICENSE APPLICATION TO A PARTY THAT PREVAILS IN AN ACTION AGAINST THE STATE FOR A VIOLATION OF THIS SECTION.

E. A STATE EMPLOYEE MAY NOT INTENTIONALLY OR KNOWINGLY VIOLATE THIS SECTION. A VIOLATION OF THIS SECTION IS CAUSE FOR DISCIPLINARY ACTION OR DISMISSAL PURSUANT TO THE AGENCY'S ADOPTED PERSONNEL POLICY.

F. THIS SECTION DOES NOT ABROGATE THE IMMUNITY PROVIDED BY SECTION 12-820.01 OR 12-820.02.