

COCHISE COUNTY

Docket RZ21-17 (Limestone)

Request for a Rezoning From R-36 to RU-4

Board of Supervisors

February 8, 2021



Public Programs...Personal Service

COCHISE COUNTY

Docket RZ21-17 (Limestone)

Applicant: Mr. Samuel Julovich
Location: Limestone Rd, approximately 420 feet west of Easy Street,
near Bisbee
APN: 101-36-012A
Parcel Size: 6.2 Acres
Current Zoning: R-36 (Residential, one dwelling per 36,000 square feet)
Proposed Zoning: RU-4 (Rural; one dwelling per 4 acres)
Growth Area: D – Rural Areas
Plan Designation: Rural
Area Plan: None
Existing Uses: Unpermitted Single Family Home
Proposed Uses: Permitted Single Family Home

The Planning and Zoning Commission recommended approval to the Board of Supervisors at their meeting of January 12, 2022.



Public Programs...Personal Service

COCHISE COUNTY

Docket RZ21-17 (Limestone)

Location



Site Plan

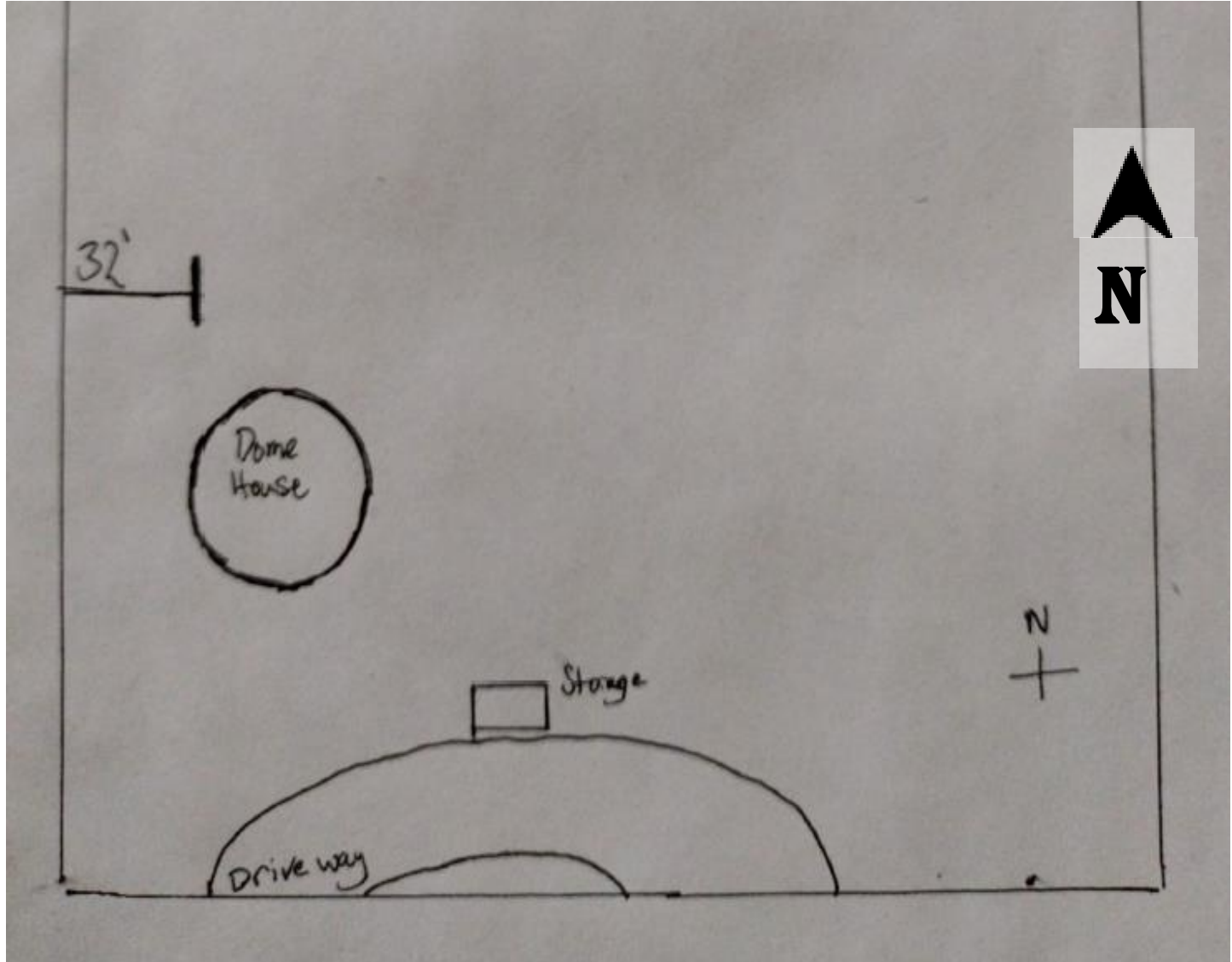

Factors in Favor and Against Approving the Rezoning:

Factors in Favor of Approval

1. The request complies with eleven of the applicable rezoning factors used by Staff to analyze this request;
2. The request would be in keeping with the character of the existing development in the area.

Factors Against Approval

1. None identified.



**Recommendation:
Conditional Approval**

1. The applicant shall provide the County with a signed Acceptance of Conditions and a Waiver of Claims form arising from ARS Section 12-1134 signed by the property owner of the subject property within thirty (30) days of Board of Supervisors approval of the rezoning; and
2. The applicant's responsibility is to obtain any additional permits or meet any additional conditions that may apply to the proposed use pursuant to other federal, state, or local laws or regulations.

