



MEMORANDUM

TO: Cochise County Planning and Zoning Commission
FROM: Christine McLachlan, AICP, Planner II
FOR: Daniel Coxworth AICP, Development Services Director
SUBJECT: SU 23-01 (Omphalos Wine Tasting), Application for a Special Use Authorization
DATE: January 31, 2023, for the February 8, 2023, Meeting

DRT AND AGENCY COMMENTS DOCKET SU 23-01

On January 6, 2023, the Development Review Team for the County and relevant external agencies was transmitted case information for their review. Reviewers were given until January 25, 2023 to respond. At that time, they were notified that a failure to respond by that date would result in an automatic approval by their agency/Department. The following is a summation of all the comments that were received by that date.

Cochise County, Floodplain:

- Not Passed: 1. A complete Site Plan was not included with the submittal for the entire twenty acres. Please provide.
- Comment: 2. The application states that there are 5 acres being proposed to be cleared with this submittal. Therefore, prior to construction start-up and since disturbed construction area is more than one (1) acre:
- Condition: A. A Stormwater Pollution Prevention Plan (SWPPP) may be required from the Arizona Department of Environmental Quality (ADEQ). This will also include a Notice of Intent (NOI) to clear land. A copy of the NOI must be submitted to Cochise County. For more information, please contact: <https://azdeq.gov/AZPDES/CGP>
- Condition: B. A Clearing Permit must be obtained from Cochise County. Please contact: <https://www.cochise.az.gov/development-services/home>
- Condition: C. A Notice to Clear Native Plants may be obtained from the Arizona Department of Agriculture and a copy submitted to Cochise County. For more information, please contact: <https://agriculture.az.gov/plantsproduce/native-plants>
- Not Passed: D. A Drainage Analysis will be required. This includes, but not limited to, Grading Plans, Site Plans, and Drainage Reports prepared by an Arizona Registered Civil Engineer. Please contact the Cochise County Engineering and Natural Resources Department for a copy of the Floodplain Regulations for Cochise County (December 2015). https://www.cochise.az.gov/sites/default/files/highway_and_floodplain/FLOOD_REGGS_2015.pdf
- Not Passed: a). As a part of the Drainage Analysis, the engineer needs to show that no adverse impacts to the property, property boundaries, adjacent properties, or roadways will occur as a result of this proposed development. Refer to Section 5.1.D of the Floodplain Requirements.
- Comment: b). Note that a Master Plan for the entire build-out of the property is recommended with the

drainage analysis, but not required.

- Comment: 3. When these items are submitted, then the review process will continue. The applicant is aware that additional comments may be forthcoming.

Cochise County ROW:

ROW permit from 2018 is on file for a 24' wide dirt driveway. No changes proposed for this venture, no further comment.

Cochise County Building: No comments received.

Cochise County Attorney's Office: No comments received.

Cochise County Environmental Health: Plans submitted to EH 8/2022 Reference PRF22-000035

Cochise County Sheriff's Office: No comments received.

Sulfur Springs Valley Electric Cooperative: SSVEC has no special conditions to submit regarding this special use permit request. If the property owner/applicant requires an upgrade in service or a new line extension, please have them refer to the Sulphur Springs Valley Electric Cooperative website at www.ssvec.org then the "Services" tab for information about Service Conditions, Service Entrance Requirements, how to establish a new service, and for Line Extension/New Service Applications. They can also contact our Willcox Engineering Services Representatives for assistance at 520-384-5469.

El Paso Gas: No comments received

Arizona Game and Fish: Attached

National Resources Defense Council: No comments received.

Arizona Department of Environmental Quality: No comments received.

State Lands Department: No comments received.

Arizona Department of Water Resources: No comments received.



January 23, 2023

Christine McLachlan, AICP
Planner II
Cochise County, Development Services
1415 Melody Lane, Building F
Bisbee, AZ 85603

Electronically submitted to cmclachlan@cochise.az.gov

Re: Review of the Cochise County Application SU-23-01 (Omphalos Wine Tasting)

Dear Ms. McLachlan:

The Arizona Game and Fish Department (Department) reviewed your Project Evaluation Request dated January 6, 2023, Special Use Authorization to operate an off-site wine tasting room and small agricultural processing facility on a 20-acre parcel in unincorporated Willcox, Arizona. The proposal includes an off-site winery tasting room and agricultural processing with less than a 300-foot minimum setback. Currently the subject parcel has a 480 SF building, which is proposed to be converted into space for wine making (agricultural production) and an off-site wine tasting room. The applicant intends to plant grapevines on the property. In the near-term, the applicant intends on purchasing locally grown grapes for wine production until the vines are established. The current land cover within the parcel is primarily undisturbed native vegetation, including Apacherian-Chihuahuan semi-desert grassland and Apacherian-Chihuahuan Mesquite Upland Scrub vegetation.

Based on the information provided, the Department offers the following general recommendations:

- Please minimize impacts to vegetation during project construction. Staging areas should be located in previously disturbed sites and kept as small as possible. Implement erosion and drainage control measures during the project to prevent the introduction of sediment-laden runoff into adjacent washes or surface waters and to prevent impacts to surface water quality. Stabilize exposed soils, particularly on slopes, with native vegetation as soon as possible to prevent excess erosion.
- If proposed ground disturbance (both temporary and permanent) will meet or exceed 0.25 acre in areas with native vegetation, please ensure the project complies with [Arizona Native Plant Law](#) regulations¹. A Native Plant Inventory may need to be conducted to identify, record, and coordinate plant salvage efforts for species that are Protected under

¹ <https://agriculture.az.gov/plantsproduce/native-plants>

azgfd.gov | 602.942.3000

5000 W. CAREFREE HIGHWAY, PHOENIX AZ 85086

GOVERNOR: KATIE HOBBS **COMMISSIONERS:** CHAIRMAN JAMES E. GOUGHNOUR, PAYSON | TODD G. GEILER, PRESCOTT | CLAY HERNANDEZ, TUCSON
MARSHA PETRIE SUE, SCOTTSDALE | LELAND S. "BILL" BRAKE, ELGIN **DIRECTOR:** TY E. GRAY **DEPUTY DIRECTOR:** TOM P. FINLEY

the Arizona Native Plant Law. In addition, the applicable land management agencies should be consulted regarding guidelines for revegetation efforts.

- Please minimize the potential introduction or spread of exotic invasive species, including aquatic and terrestrial plants, animals, insects and pathogens. Precautions should be taken to wash and/or decontaminate all equipment utilized in the project activities before entering and leaving the site.
- If trenching will occur, trenching and backfilling crews should be close together to minimize the amount of open trenches at any given time. Avoid leaving trenches open overnight. Where trenches cannot be back-filled immediately, escape ramps should be constructed at least every 90 meters. Escape ramps can be short lateral trenches or wooden planks sloping to the surface. The slope should be less than 45 degrees (1:1). Trenches that have been left open overnight should be inspected and animals removed prior to backfilling.
- Artificial lighting could impair the ability of nocturnal animals to navigate (e.g., owls, migratory birds, bats, and other nocturnal mammals) and may affect wildlife behavior and populations. The Department recommends using only the minimum amount of light needed for safety, especially in areas immediately adjacent to open space or undeveloped lands. The Department encourages the use of motion sensing lighting and narrow spectrum lighting wherever possible to lower the range of species affected by lighting. Also, please consider shielding, canting, or cutting all lighting, where possible, to ensure that light reaches only areas needing illumination and to minimize impacts to nocturnal wildlife.

The Department appreciates the opportunity to provide an evaluation of impacts to wildlife or wildlife habitats associated with the Cochise County Application SU-23-01 (Omphalos Wine Tasting). If you have any questions regarding this letter, please contact me at (623) 236-7615 and visit our [website](#)² for additional guidelines.

Sincerely,

Cheri Bouchér

Cheri Bouchér
Project Evaluation Program Specialist, Habitat Branch
Arizona Game and Fish Department

AZGFD #M23-01064159

² <https://www.azgfd.com/wildlife/planning/wildlifeguidelines/>

Arizona Environmental Online Review Tool Report



Arizona Game and Fish Department Mission

To conserve Arizona's diverse wildlife resources and manage for safe, compatible outdoor recreation opportunities for current and future generations.

Project Name:

SU-23-01 (Omphalos Wine Tasting)

Project Description:

The applicant, Thomas Messier, requests Special Use Authorization to operate an off-site wine tasting room and small agricultural processing facility on a 20-acre parcel in unincorporated Willcox, Arizona. The establishment of an off-site winery tasting room (607.13) and agricultural processing with less than a 300-foot minimum setback (607.38) is subject to Special Use Authorization from the Planning and Zoning Commission in a rural zoning district. The proposed business, located on parcel 305-55-024B/6107 East Cattle Drive Willcox, AZ, where indicated on the location map. Currently the subject parcel has a 480 SF building, which is proposed to be converted into space for wine making (agricultural production) and an off-site wine tasting room. The applicant intends to plant grapevines on the property. In the near-term, the applicant intends on purchasing locally grown grapes for wine production until the vines are established. Wine processing will occur on this site as well as a separate facility that is not a part of this application.

Project Type:

Development Outside Municipalities (Rural Development), Commercial/industrial (mall) and associated infrastructure, New construction

Contact Person:

Cheri Boucher

Organization:

Arizona Game and Fish Department

On Behalf Of:

COCHISE

Project ID:

HGIS-18220

Please review the entire report for project type and/or species recommendations for the location information entered. Please retain a copy for future reference.

Disclaimer:

1. This Environmental Review is based on the project study area that was entered. The report must be updated if the project study area, location, or the type of project changes.
2. This is a preliminary environmental screening tool. It is not a substitute for the potential knowledge gained by having a biologist conduct a field survey of the project area. This review is also not intended to replace environmental consultation (including federal consultation under the Endangered Species Act), land use permitting, or the Departments review of site-specific projects.
3. The Departments Heritage Data Management System (HDMS) data is not intended to include potential distribution of special status species. Arizona is large and diverse with plants, animals, and environmental conditions that are ever changing. Consequently, many areas may contain species that biologists do not know about or species previously noted in a particular area may no longer occur there. HDMS data contains information about species occurrences that have actually been reported to the Department. Not all of Arizona has been surveyed for special status species, and surveys that have been conducted have varied greatly in scope and intensity. Such surveys may reveal previously undocumented population of species of special concern.
4. Arizona Wildlife Conservation Strategy (AWCS), specifically Species of Greatest Conservation Need (SGCN), represent potential species distribution models for the State of Arizona which are subject to ongoing change, modification and refinement. The status of a wildlife resource can change quickly, and the availability of new data will necessitate a refined assessment.

Locations Accuracy Disclaimer:

Project locations are assumed to be both precise and accurate for the purposes of environmental review. The creator/owner of the Project Review Report is solely responsible for the project location and thus the correctness of the Project Review Report content.

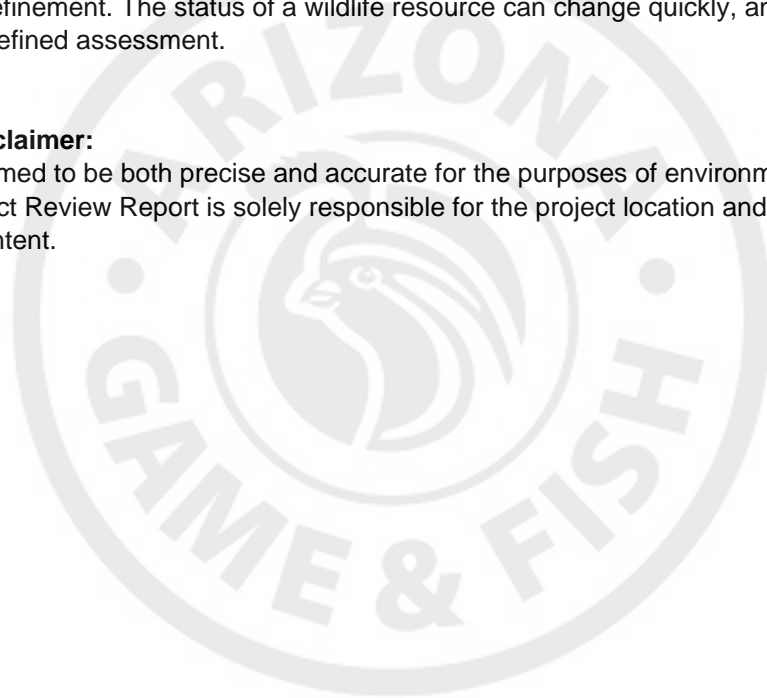

Recommendations Disclaimer:

1. The Department is interested in the conservation of all fish and wildlife resources, including those species listed in this report and those that may have not been documented within the project vicinity as well as other game and nongame wildlife.
2. Recommendations have been made by the Department, under authority of Arizona Revised Statutes Title 5 (Amusements and Sports), 17 (Game and Fish), and 28 (Transportation).
3. Potential impacts to fish and wildlife resources may be minimized or avoided by the recommendations generated from information submitted for your proposed project. These recommendations are preliminary in scope, designed to provide early considerations on all species of wildlife.
4. Making this information directly available does not substitute for the Department's review of project proposals, and should not decrease our opportunity to review and evaluate additional project information and/or new project proposals.
5. Further coordination with the Department requires the submittal of this Environmental Review Report with a cover letter and project plans or documentation that includes project narrative, acreage to be impacted, how construction or project activity(s) are to be accomplished, and project locality information (including site map). Once AGFD had received the information, please allow 30 days for completion of project reviews. Send requests to:
Project Evaluation Program, Habitat Branch
Arizona Game and Fish Department
5000 West Carefree Highway
Phoenix, Arizona 85086-5000
Phone Number: (623) 236-7600
Fax Number: (623) 236-7366
Or
PEP@azgfd.gov
6. Coordination may also be necessary under the National Environmental Policy Act (NEPA) and/or Endangered Species Act (ESA). Site specific recommendations may be proposed during further NEPA/ESA analysis or through coordination with affected agencies

SU-23-01 (Omphalos Wine Tasting) USA Topo Basemap With Locator Map

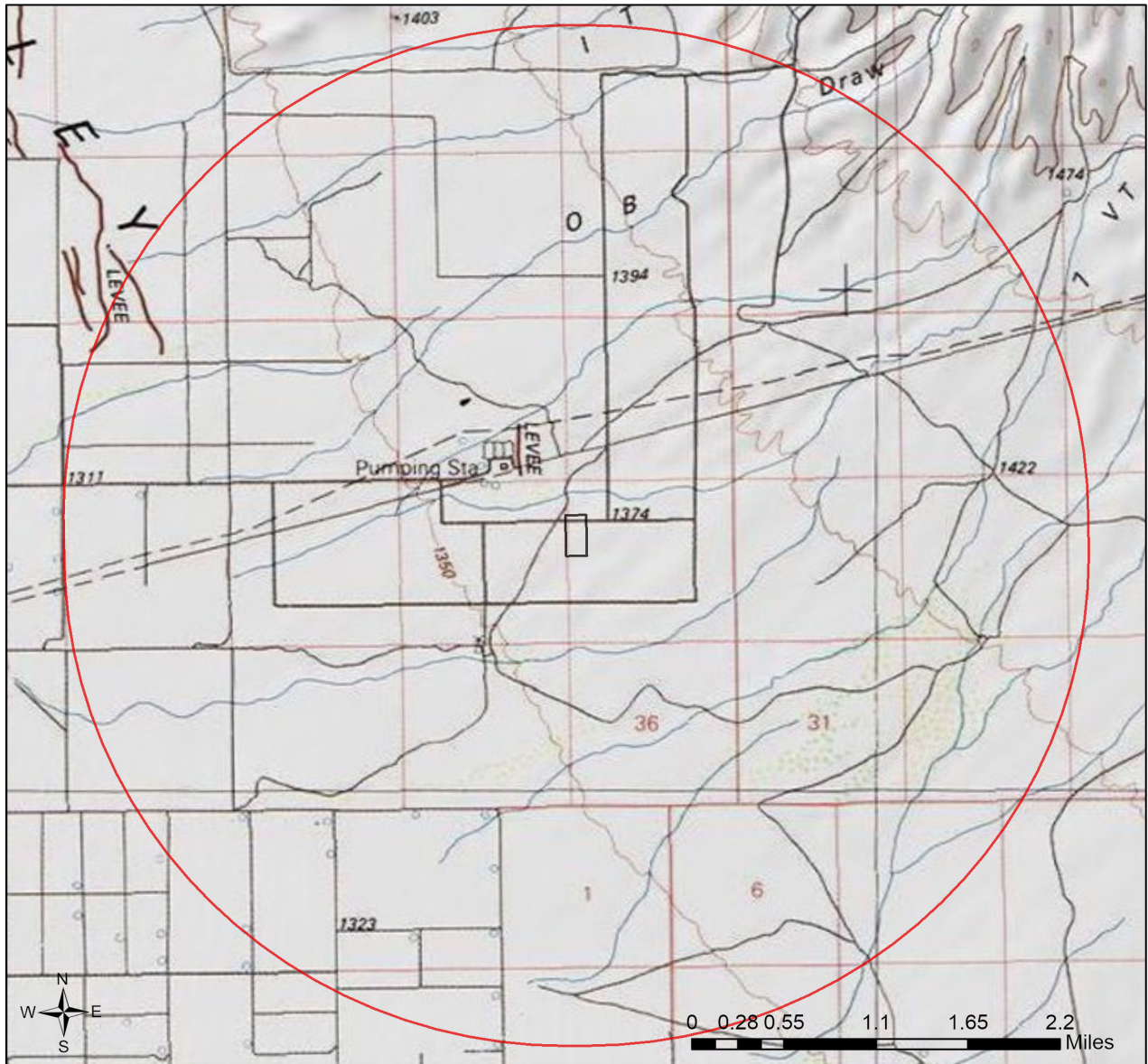

- Buffered Project Boundary
- Project Boundary

Project Size (acres): 19.96

Lat/Long (DD): 32.1031 / -109.6532

County(s): Cochise

AGFD Region(s): Tucson

Township/Range(s): T15S, R26E

USGS Quad(s): DOS CABEZAS SW





Sources: Esri, Airbus DS, USGS, NGA, NASA, CGIAR, N Robinson, NCEAS, NLS, OS, NMA, Geodatastyrelsen, Rijkswaterstaat, GSA, Geoland, FEMA, Intermap and the GIS user community

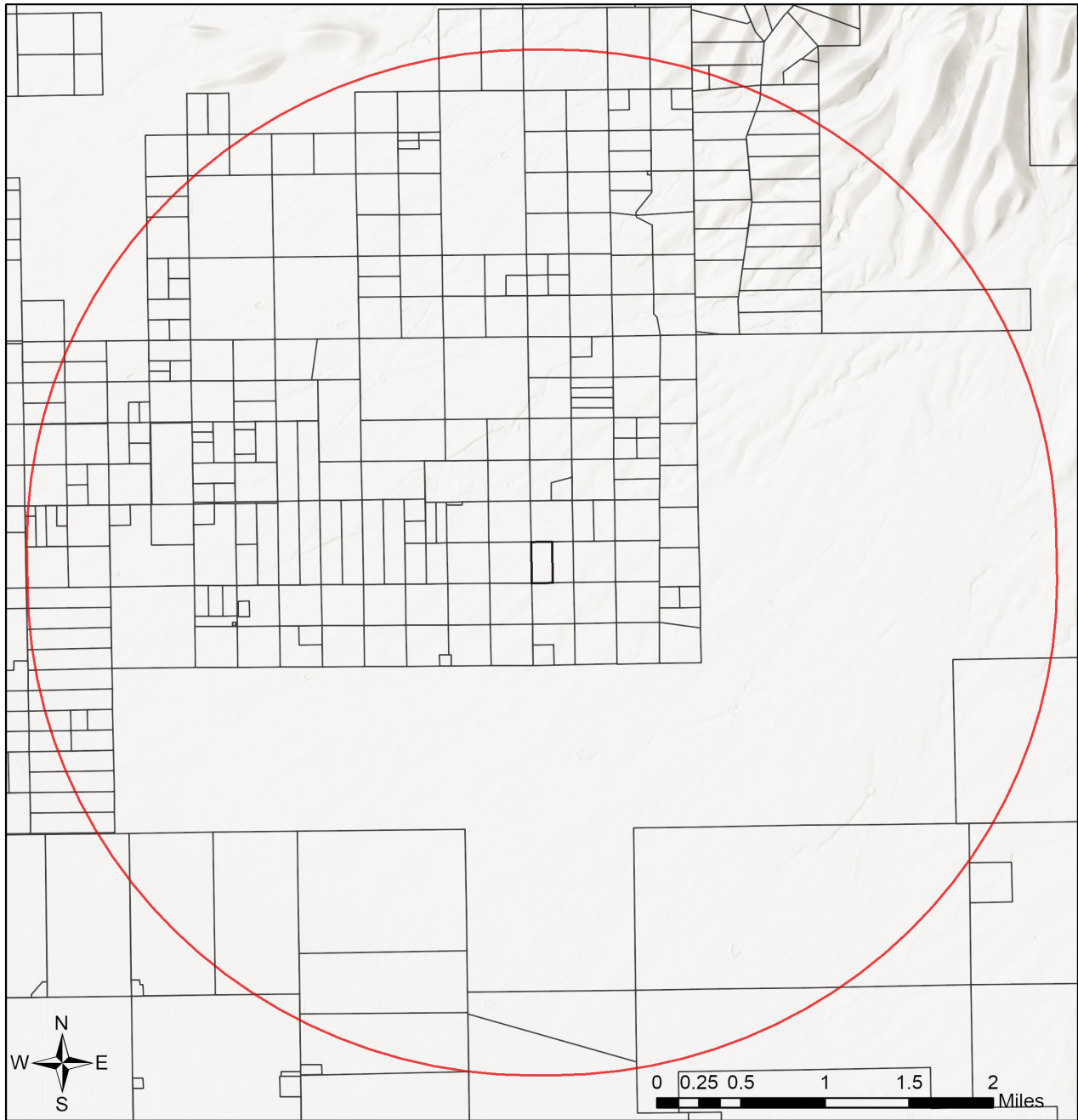

SU-23-01 (Omphalos Wine Tasting)

Web Map As Submitted By User



-  id_cochise
-  Counties
-  Buffered Project Boundary
-  Project Boundary

Project Size (acres): 19.96
Lat/Long (DD): 32.1031 / -109.6532
County(s): Cochise
AGFD Region(s): Tucson
Township/Range(s): T15S, R26E
USGS Quad(s): DOS CABEZAS SW

Sources: Esri, Airbus DS, USGS, NGA, NASA, CGIAR, N Robinson, NCEAS, NLS, OS, NMA, Geodatastyrelsen, Rijkswaterstaat, GSA, Geoland, FEMA, Intermap and the GIS user community

SU-23-01 (Omphalos Wine Tasting) Important Areas



- Buffered Project Boundary
- Project Boundary
- Important Bird Areas
- Critical Habitat
- Pinal County Riparian
- Important Connectivity Zones
- Wildlife Connectivity

Project Size (acres): 19.96
 Lat/Long (DD): 32.1031 / -109.6532
 County(s): Cochise
 AGFD Region(s): Tucson
 Township/Range(s): T15S, R26E
 USGS Quad(s): DOS CABEZAS SW

Sources: Esri, Airbus DS, USGS, NGA, NASA, CGIAR, N Robinson, NCEAS, NLS, OS, NMA, Geodatastyrelsen, Rijkswaterstaat, GSA, Geoland, FEMA, Intermap and the GIS user community
 Sources: Esri, HERE, Garmin, FAO, NOAA, USGS, © OpenStreetMap contributors, and the GIS User Community

SU-23-01 (Omphalos Wine Tasting) Township/Ranges and Land Ownership

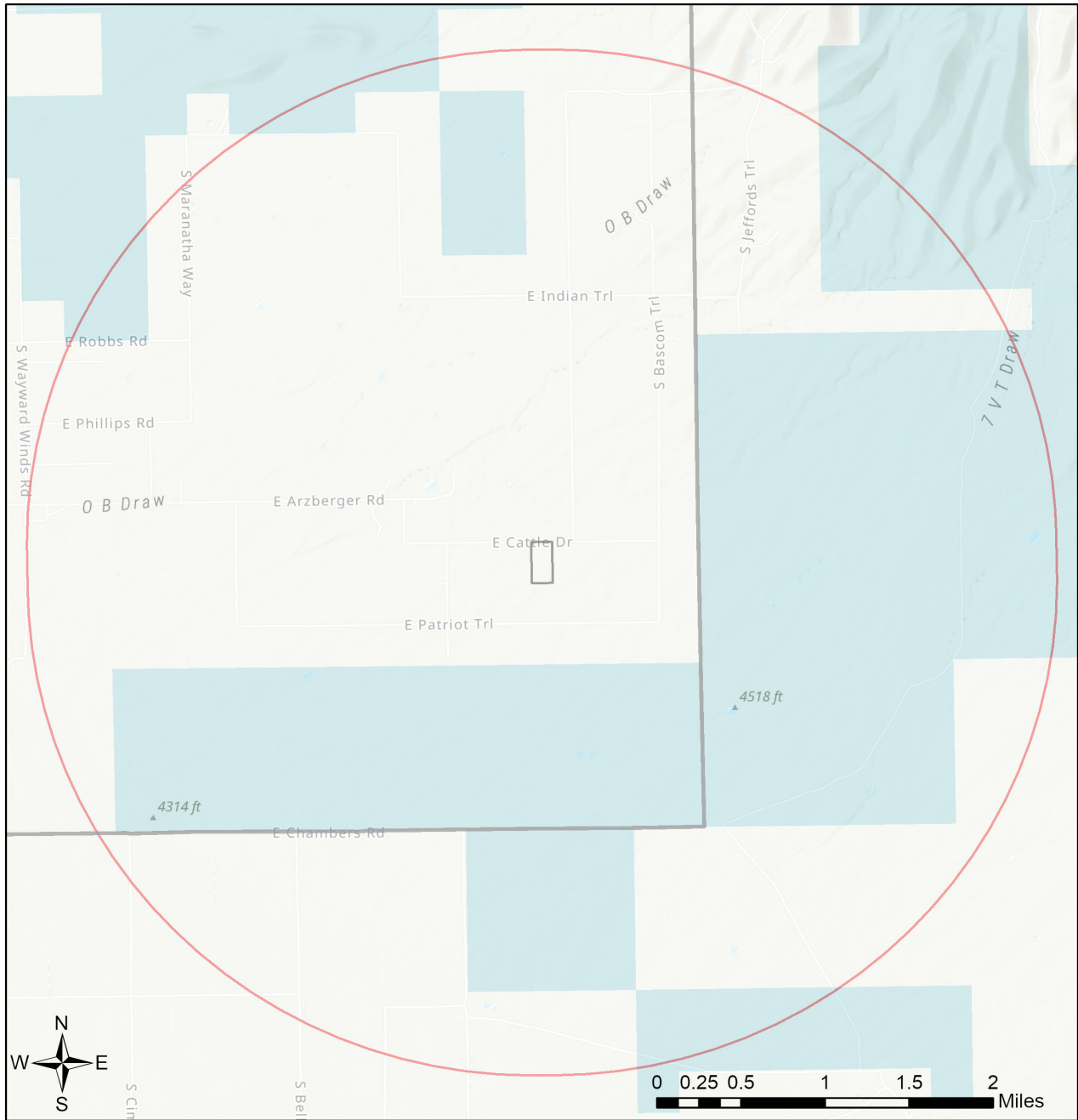

- | | |
|---|--|
| Buffered Project Boundary | National Park/Mon. |
| Project Boundary | Private |
| AZ Game & Fish Dept. | State & Regional Parks |
| BLM | State Trust |
| BOR | US Forest Service |
| Indian Res. | Wildlife Area/Refuge |
| Military | Township/Ranges |
| Mixed/Other | |

Project Size (acres): 19.96
 Lat/Long (DD): 32.1031 / -109.6532
 County(s): Cochise
 AGFD Region(s): Tucson
 Township/Range(s): T15S, R26E
 USGS Quad(s): DOS CABEZAS SW

Sources: Esri, Airbus DS, USGS, NGA, NASA, CGIAR, N Robinson, NCEAS, NLS, OS, NMA, Geodatastyrelsen, Rijkswaterstaat, GSA, Geoland, FEMA, Intermap and the GIS user community
 Sources: Esri, HERE, Garmin, FAO, NOAA, USGS, © OpenStreetMap contributors, and the GIS User Community

Special Status Species Documented within 3 Miles of Project Vicinity

Scientific Name	Common Name	FWS	USFS	BLM	NPL	SGCN
Choeronycteris mexicana	Mexican Long-tongued Bat	SC	S	S		2
Leptonycteris yerbabuenae	Lesser Long-nosed Bat	SC				1
Opuntia martiniana	Seashore Cactus				SR	
Terrapene ornata luteola	Desert Box Turtle			S		

Note: Status code definitions can be found at <https://www.azgfd.com/wildlife/planning/wildlifeguidelines/statusdefinitions/>

No Special Areas Detected

No special areas were detected within the project vicinity.

Species of Greatest Conservation Need Predicted that Intersect with Project Footprint as Drawn, based on Predicted Range Models

Scientific Name	Common Name	FWS	USFS	BLM	NPL	SGCN
Anthus spragueii	Sprague's Pipit	SC				2
Aquila chrysaetos	Golden Eagle			S		2
Artemisiospiza nevadensis	Sagebrush Sparrow					
Aspidoscelis sonorae	Sonoran Spotted Whiptail					2
Athene cucularia hypugaea	Western Burrowing Owl	SC	S	S		2
Buteo regalis	Ferruginous Hawk	SC		S		2
Buteo swainsoni	Swainson's Hawk					2
Calcarius ornatus	Chestnut-collared Longspur					2
Callipepla squamata	Scaled Quail					2
Campylorhynchus brunneicapillus	Cactus Wren					2
Chaetodipus baileyi	Bailey's Pocket Mouse					2
Charadrius montanus	Mountain Plover	SC				2
Choeronycteris mexicana	Mexican Long-tongued Bat	SC	S	S		2
Chordeiles minor	Common Nighthawk					2
Coccyzus americanus	Yellow-billed Cuckoo (Western DPS)					
Corvus cryptoleucus	Chihuahuan Raven					2
Corynorhinus townsendii pallescens	Pale Townsend's Big-eared Bat	SC	S	S		1
Cynomys ludovicianus	Black-tailed Prairie Dog	CCA		S		1
Elgaria kingii	Madrean Alligator Lizard					2
Empidonax wrightii	Gray Flycatcher					2
Eumops perotis californicus	Greater Western Bonneted Bat					
Falco mexicanus	Prairie Falcon					2
Falco sparverius	American Kestrel					2
Hypsiglena sp. nov.	Hooded Nightsnake					2
Icterus bullockii	Bullock's Oriole					2
Idionycteris phyllotis	Allen's Lappet-browed Bat	SC	S	S		2
Incilius alvarius	Sonoran Desert Toad					2

Species of Greatest Conservation Need Predicted that Intersect with Project Footprint as Drawn, based on Predicted Range Models

Scientific Name	Common Name	FWS	USFS	BLM	NPL	SGCN
Lanius ludovicianus	Loggerhead Shrike	SC				2
Lasiurus blossevillii	Western Red Bat		S			2
Lasiurus cinereus	Hoary Bat					2
Lasiurus xanthinus	Western Yellow Bat		S			2
Leptonycteris yerbabuenae	Lesser Long-nosed Bat	SC				1
Megascops kennicottii	Western Screech-owl					
Melanerpes uropygialis	Gila Woodpecker					2
Melospiza lincolni	Lincoln's Sparrow					2
Micruroides euryxanthus	Sonoran Coralsnake					2
Myotis auriculus	Southwestern Myotis					2
Myotis thysanodes	Fringed Myotis	SC				2
Myotis velifer	Cave Myotis	SC		S		2
Myotis yumanensis	Yuma Myotis	SC				2
Nyctinomops femorosaccus	Pocketed Free-tailed Bat					2
Nyctinomops macrotis	Big Free-tailed Bat	SC				2
Parabuteo unicinctus	Harris's Hawk					2
Passerculus sandwichensis	Savannah Sparrow					2
Peucaea botterii arizonae	Arizona Botteri's Sparrow			S		2
Poocetes gramineus	Vesper Sparrow					2
Spizella breweri	Brewer's Sparrow					2
Tadarida brasiliensis	Brazilian Free-tailed Bat					
Terrapene ornata	Ornate Box Turtle			S		1
Toxostoma bendirei	Bendire's Thrasher					2

Species of Economic and Recreation Importance Predicted that Intersect with Project Footprint as Drawn

Scientific Name	Common Name	FWS	USFS	BLM	NPL	SGCN
Callipepla gambelii	Gambel's Quail					
Callipepla squamata	Scaled Quail					
Odocoileus hemionus	Mule Deer					
Patagioenas fasciata	Band-tailed Pigeon					
Pecari tajacu	Javelina					
Puma concolor	Mountain Lion					
Zenaida asiatica	White-winged Dove					
Zenaida macroura	Mourning Dove					

Project Type: Development Outside Municipalities (Rural Development), Commercial/industrial (mall) and associated infrastructure, New construction

Project Type Recommendations:

During the planning stages of your project, please consider the local or regional needs of wildlife in regards to movement, connectivity, and access to habitat needs. Loss of this permeability prevents wildlife from accessing resources, finding mates, reduces gene flow, prevents wildlife from re-colonizing areas where local extirpations may have occurred, and ultimately prevents wildlife from contributing to ecosystem functions, such as pollination, seed dispersal, control of prey numbers, and resistance to invasive species. In many cases, streams and washes provide natural movement corridors for wildlife and should be maintained in their natural state. Uplands also support a large diversity of species, and should be contained within important wildlife movement corridors. In addition, maintaining biodiversity and ecosystem functions can be facilitated through improving designs of structures, fences, roadways, and culverts to promote passage for a variety of wildlife. Guidelines for many of these can be found at: <https://www.azgfd.com/wildlife/planning/wildlifeguidelines/>.

Consider impacts of outdoor lighting on wildlife and develop measures or alternatives that can be taken to increase human safety while minimizing potential impacts to wildlife. Conduct wildlife surveys to determine species within project area, and evaluate proposed activities based on species biology and natural history to determine if artificial lighting may disrupt behavior patterns or habitat use. Use only the minimum amount of light needed for safety. Narrow spectrum bulbs should be used as often as possible to lower the range of species affected by lighting. All lighting should be shielded, canted, or cut to ensure that light reaches only areas needing illumination.

Minimize the potential introduction or spread of exotic invasive species, including aquatic and terrestrial plants, animals, insects and pathogens. Precautions should be taken to wash and/or decontaminate all equipment utilized in the project activities before entering and leaving the site. See the Arizona Department of Agriculture website for a list of prohibited and restricted noxious weeds at <https://www.invasivespeciesinfo.gov/unitedstates/az.shtml> and the Arizona Native Plant Society <https://aznps.com/invas> for recommendations on how to control. To view a list of documented invasive species or to report invasive species in or near your project area visit iMapInvasives - a national cloud-based application for tracking and managing invasive species at <https://imap.natureserve.org/imap/services/page/map.html>.

- To build a list: zoom to your area of interest, use the identify/measure tool to draw a polygon around your area of interest, and select "See What's Here" for a list of reported species. To export the list, you must have an account and be logged in. You can then use the export tool to draw a boundary and export the records in a csv file.

Minimization and mitigation of impacts to wildlife and fish species due to changes in water quality, quantity, chemistry, temperature, and alteration to flow regimes (timing, magnitude, duration, and frequency of floods) should be evaluated. Minimize impacts to springs, in-stream flow, and consider irrigation improvements to decrease water use. If dredging is a project component, consider timing of the project in order to minimize impacts to spawning fish and other aquatic species (include spawning seasons), and to reduce spread of exotic invasive species. We recommend early direct coordination with Project Evaluation Program for projects that could impact water resources, wetlands, streams, springs, and/or riparian habitats.

The Department recommends that wildlife surveys are conducted to determine if noise-sensitive species occur within the project area. Avoidance or minimization measures could include conducting project activities outside of breeding seasons.

Based on the project type entered, coordination with State Historic Preservation Office may be required (<https://azstateparks.com/>).

Trenches should be covered or back-filled as soon as possible. Incorporate escape ramps in ditches or fencing along the perimeter to deter small mammals and herpetofauna (snakes, lizards, tortoise) from entering ditches.

Communities can actively support the sustainability and mobility of wildlife by incorporating wildlife planning into their regional/comprehensive plans, their regional transportation plans, and their open space/conservation land system programs. An effective approach to wildlife planning begins with the identification of the wildlife resources in need of protection, an assessment of important habitat blocks and connective corridors, and the incorporation of these critical wildlife components into the community plans and programs. Community planners should identify open spaces and habitat blocks that can be maintained in their area, and the necessary connections between those blocks to be preserved or protected. Community planners should also work with State and local transportation planning entities, and planners from other communities, to foster coordination and cooperation in developing compatible development plans to ensure wildlife habitat connectivity. The Department's guidelines for incorporating wildlife considerations into community planning and developments can be found on the Wildlife Friendly Guidelines portion of the Wildlife Planning page at <https://www.azgfd.com/wildlife/planning/wildlifeguidelines/>.

Based on the project type entered, coordination with Arizona Department of Environmental Quality may be required (<http://www.azdeq.gov/>).

Based on the project type entered, coordination with Arizona Department of Water Resources may be required (<https://new.azwater.gov/>).

Based on the project type entered, coordination with U.S. Army Corps of Engineers may be required (<http://www.usace.army.mil/>)

Based on the project type entered, coordination with County Flood Control district(s) may be required.

Development plans should provide for open natural space for wildlife movement, while also minimizing the potential for wildlife-human interactions through design features. Please contact Project Evaluation Program for more information on living with urban wildlife at PEP@azgfd.gov or at <https://www.azgfd.com/wildlife/planning/wildlifeguidelines/> and <https://www.azgfd.com/Wildlife/LivingWith>.

The Department requests further coordination to provide project/species specific recommendations, please contact Project Evaluation Program directly at PEP@azgfd.gov.

Project Location and/or Species Recommendations:

HDMS records indicate that one or more native plants listed on the **Arizona Native Plant Law and Antiquities Act** have been documented within the vicinity of your project area. Please contact:

Arizona Department of Agriculture
1688 W Adams St.
Phoenix, AZ 85007
Phone: 602.542.4373

<https://agriculture.az.gov/sites/default/files/Native%20Plant%20Rules%20-%20AZ%20Dept%20of%20Ag.pdf> starts on page 44

HDMS records indicate that **Lesser Long-nosed Bats** have been documented within the vicinity of your project area. Please review the Lesser Long-nosed Bat Management Guidelines

at: <https://s3.amazonaws.com/azgfd-portal-wordpress/PortallImages/files/wildlife/planningFor/wildlifeFriendlyGuidelines/FINALIecuyeHabitatGdIn.pdf>