

BLM Brass Cap
NW Cor. 7-21-8

Exhibit "A-1"

A portion of that parcel recorded in Docket 817, Page 444, records of Coconino county, situated in the West half of Section 7, Township 21 North, Range 8 East, Gila and Salt River Meridian, City of Flagstaff, Coconino county, Arizona.

Basis of Bearings: N 00°36'23" W 2,655.18'
N 00°36'23" W 171.64'

S 89°43'56" E 535.04'

T.P.O.B.

S 89°46'20" E 149.92'

16.00'

16.00'

Subject Parcel
APN 113-23-004J
Por. of Dkt. 817, Pg. 444
24,709 Sq. Ft.

Easement Area 5,087 Sq. Ft.
S 45°09'19" E 183.06'

N 45°03'25" W 284.90'

North Kaspar Drive
S 47°28'53" W 105.90'

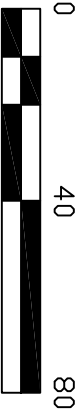
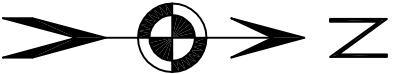

LEGEND:

- ◆ Found Sectional Corner as noted.
- ⊙ - Computed Point, nothing found or set.

COF Alum. Cap
W 1/4 Cor. 7-21-8

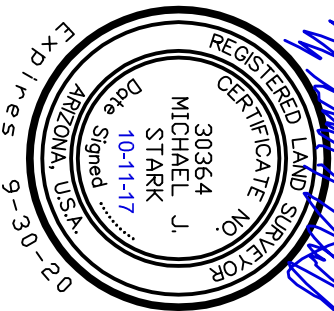

Descriptive Title: _____

City File No. _____

528 W. Aspen Avenue, Flagstaff, Arizona 86001 (928) 774-5058

NORTHLAND EXPLORATION SURVEYS, INC.

JOB No.	DRWN.	DATE	SCALE
17-087	M.J.S.	10-11-17	1"=40.0'