



Northern Arizona Healthcare **Regional Plan Amendment**

Flagstaff City Council

Dec. 6, 2022



HEALTH AND WELLNESS VILLAGE

About us

Nonprofit health care system governed by a volunteer board of directors who balance financial decisions with respect for community concerns and needs

3,000+ employees serve a community of more than a million people

All revenue is reinvested to improve facilities, equipment and patient care

ERs open to all, regardless of ability to pay

Only Level 1 Trauma facility north of Phoenix



HEALTH AND WELLNESS VILLAGE

How we serve the community

25% of patients are considered **financially disadvantaged**

Serving a region of **more than 50,000 square miles** in northern Arizona

Sole community provider health system in northern Arizona

1/3 of our patients at Flagstaff Medical Center are **enrolled members of Native American tribes**

NAH provided **more than \$125 million*** in care for patients who would not have been able to afford those services otherwise in FY2021



HEALTH AND WELLNESS VILLAGE

We've outgrown our home at FMC

Current facility more than 25% smaller than modern benchmarks

Inpatient beds span 5 different buildings, which complicates wayfinding for patients and families

Existing campus is divided by city streets and has elevation changes that prohibit integration of all services

Not enough parking to meet demand of outpatient services

In the past year, we have had 5,600 deferrals due to unit capacity with 55% of those being from facilities on tribal lands



Flagstaff Medical Center – Google Earth View 2022



HEALTH AND WELLNESS VILLAGE



Example of a current FMC ICU Room

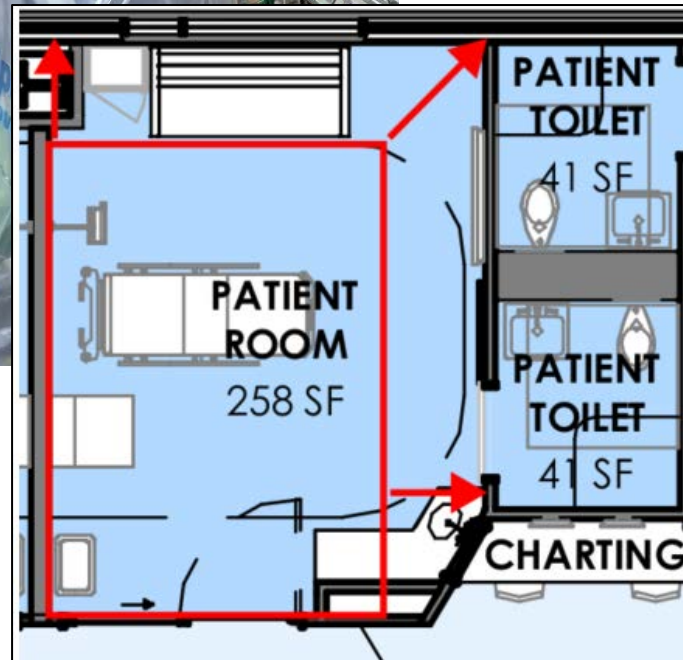

Red outline represents current FMC ICU room set within the future ICU floorplan

What we're facing today

FMC's current ICU rooms do not meet modern standards of care

Insufficient square footage for clinicians and equipment needed to provide best-in-class patient care

Clinicians may not have clear line of sight to patient rooms from charting stations

Family is not able to stay in the room with patients to provide support

Not all rooms have windows and sunlight



HEALTH AND WELLNESS VILLAGE

So we're making our largest ever investment





HEALTH AND WELLNESS VILLAGE

Social Determinants of Health

Lifestyle and behavior along with economic determinants, environmental determinants, and social gradient form the Social Determinants of Health.

Social Determinants of Health account for 80% of health outcomes, medical factors only determine 10%.





HEALTH AND WELLNESS VILLAGE

Addressing SDOH Factors

Social and Community Context

Economic Stability

Neighborhood and Built Environment

Health Care and Quality

Education Access and Quality

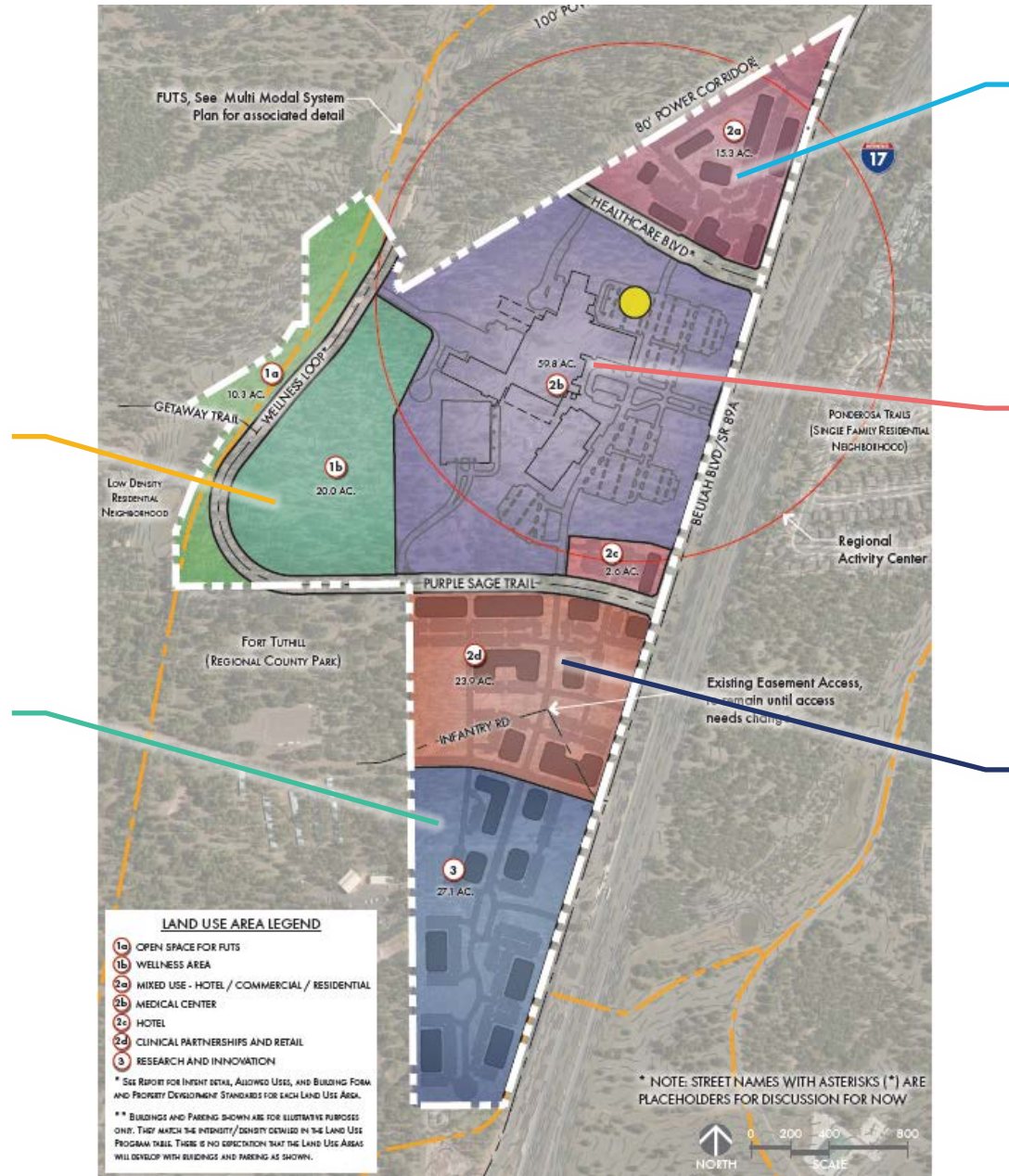



HEALTH AND WELLNESS VILLAGE

Supporting Flagstaff's Regional Plan

GROWTH AREAS & LAND USE

Continue to enhance the region's unique sense of place within the urban, suburban, and rural context

Balance housing and employment land uses with the preservation and protection of our unique natural and cultural setting

Encourage compact development principles to achieve efficiencies and open space preservation

Increase the variety of housing options and expand opportunities for employment and neighborhood shopping within all suburban neighborhoods

Plan for and encourage employee-intensive uses throughout the area as activity centers, corridors, research and development offices, business parks, and light industrial areas to encourage efficient infrastructure and multimodal commuting

Develop well designed activity centers and corridors with a variety of employment, business, shopping, civic engagement, cultural opportunities, and residential choices



HEALTH AND WELLNESS VILLAGE

Supporting Flagstaff's Regional Plan

TRANSPORTATION

Improve mobility and access throughout the region

Improve transportation safety and efficiency for all modes

Promote transportation infrastructure and services that enhance the quality of life of the communities within the region

Establish a functional, safe, and aesthetic hierarchy of roads and streets



HEALTH AND WELLNESS VILLAGE

Supporting Flagstaff's Regional Plan

NEIGHBORHOODS, HOUSING & URBAN CONSERVATION

Foster and maintain healthy and diverse urban, suburban, and rural neighborhoods in the Flagstaff region

Make available a variety of housing types at different price points, to provide housing opportunity for all economic sectors



HEALTH AND WELLNESS VILLAGE

Supporting Flagstaff's Regional Plan

ECONOMIC DEVELOPMENT

Support and encourage an excellent educational system that promotes critical thinking and job training programs at all levels

Regional economic development partners support the start-up, retention, and expansion of existing business enterprises

Continue to promote and enhance Flagstaff's unique sense of place as an economic development driver

Promote redevelopment and infill as a well-established means to accomplish a variety of community economic, planning, and environmental goals

Promote the continued physical and economic viability of the region's commercial districts by focusing investment on existing and new activity centers



HEALTH AND WELLNESS VILLAGE

Estimated economic benefits for City of Flagstaff

**\$387
MILLION**

Annual economic benefit generated by full buildout in 2045 to the community

**10,000+
JOBS**

Generated by the construction and operation of the village

**\$6.7
MILLION**

Construction-related sales taxes paid directly to the City of Flagstaff

**\$1.5
MILLION**

Annual taxes paid directly to the City of Flagstaff over the lifetime of the project and in perpetuity



HEALTH AND WELLNESS VILLAGE

Continued Community Engagement

ADOT & City Traffic	Sen. Mark Kelly	Verde Valley Mayors, Managers, Supervisors, Tribe and Nation Bi-Weekly Meeting
Coconino County Representatives	Sen. Kyrsten Sinema	
Flagstaff City Manager	Rep. Tom O'Halleran	City of Cottonwood
ECONA	Forest Highlands HOA	Coconino Community College
Flagstaff Chamber of Commerce	Vision Communities	Northern Arizona Leadership Alliance
Airport Commission	University Heights	City of Flagstaff Sustainability Planning
Mountain Line/NAIPTA	Northern Arizona Association of Realtors	Northern Arizona Building Association
Navajo Nation	Downtown Business Alliance	City of Flagstaff Development
Northern Arizona University	Sterling Real Estate	Arizona Department of Health Services
Townsite Homes	Assistance League of Flagstaff	Public Meetings per City Guidelines on 01/04, 01/18, 10/10
Flagstaff City Support Divisions	Friends of Flagstaff	
Sustainability Commission	Mountain Dell Ridge HOA	
Neighboring Landowners	Continuum of Care Flagstaff	

Recent meetings include:

- Coconino County Leadership (10/19)
- Metro Plan (11/16)
- ADOT (11/22)
- Mountain Line (11/28)
- Sean Ryan – Mt. Dell (11/30)

Development support from:

- Arizona Health Care Cost Containment System
- Arizona Medical Association
- Arizona Nurses Association
- Arizona Osteopathic Medical Association
- Arizona Public Health Association
- Dr. Richard Carmona, former U.S. Surgeon General



HEALTH AND WELLNESS VILLAGE

Mission

Improving health, healing people.

Vision

Always better care.

Every person, every time...**together.**

Values

