

**PLANT SCHEDULE (ON SITE)**

SYMBOL	BOTANICAL/COMMON NAME	SIZE	QTY.	MAT. SIZE	REMARKS
<b>TREES</b>					
○	ACER GINNALA 'FLAME' AMUR MAPLE	2" CAL.	11	15x12	LOW-BREAKING
○	CRATAEGUS LAEVIGATA 'CRIMSON CLOUD' CRIMSON CLOUD HAWTHORN	2" CAL.	11	20x15	STANDARD
○	PICEA PUNGENS 'BABY BLUEEYES' BABY BLUEEYES SPRUCE	6' TALL	9	20x10	STANDARD
○	POPULUS TREMULOIDES QUAKING ASPEN	15-GAL.	6	50x15	STANDARD
○	PYRUS CALLERYANA 'CHANTICLEER' CHANTICLEER PEAR	2" CAL.	13	30x15	STANDARD

SYMBOL	BOTANICAL/COMMON NAME	SIZE	QTY.	MAT. SIZE	REMARKS
<b>SHRUBS / GRASSES</b>					
⊗	ARONIA MELANOCARPA 'IROQUOIS BEAUTY' IROQUOIS BEAUTY CHOKEBERRY	5 GAL.	6	3x4	2 GPH EMITTER
⊗	CALAMAGROSTIS x ACUTIFLORA 'K.F.' FOERSTER'S FEATHER REED GRASS	5 GAL.	54	4x2.5	2 GPH EMITTER
⊕	CORNUS SERICEA 'ARCTIC FIRE' ARCTIC FIRE DOGWOOD	5 GAL.	14	4x4	2 GPH EMITTER
⊕	MAHONIA AQUIFOLIUM OREGON GRAPE	5 GAL.	54	4x4	2 GPH EMITTER
⊗	PEROVSKIA ATRIPLICIFOLIA RUSSIAN SAGE	5 GAL.	42	4x4	2 GPH EMITTER
⊕	POTENTILLA FRUTICOSA 'GOLDFINGER' GOLDFINGER POTENTILLA	5 GAL.	44	3x3	2 GPH EMITTER

SYMBOL	BOTANICAL/COMMON NAME	SIZE	QTY.	MAT. SIZE	REMARKS
<b>GROUND COVER</b>					
⊗	JUNIPERUS HORIZONTALIS 'WILTONI' BLUE RUG JUNIPER	5 GAL.	25	.75x6	2 GPH EMITTER
⊗	JUNIPERUS COMMUNIS 'MONDAP' ALPINE CARPET JUNIPER	5 GAL.	43	1x4	2 GPH EMITTER
⊕	MAHONIA REPENS 'DARKSTAR' CREEPING OREGON GRAPE	1 GAL.	21	1.5x4	2 GPH EMITTER

MATERIALS	REMARKS
MAHOGANY (ROCK PROS) DECOMPOSED GRANITE	1/2" SCREENED 2" DEPTH IN LANDSCAPE AREAS EXCEPT HYDROSEED

**PLANT SCHEDULE (PARKWAY - OFF SITE)**

SYMBOL	BOTANICAL/COMMON NAME	SIZE	QTY.	MAT. SIZE	REMARKS
○	ACER GINNALA 'FLAME' AMUR MAPLE	2" CAL.	4	15x12	LOW-BREAKING
	MAHOGANY (ROCK PROS) DECOMPOSED GRANITE	1/2" SCREENED	1,312 S.F.	2"	DEPTH IN PARKWAY

**CITY OF FLAGSTAFF LANDSCAPE NOTES**

- ADJACENT SITE IMPROVEMENTS, PAVEMENT CONSTRUCTION, IRRIGATION INSTALLATION AND FINISH GRADING SHALL BE COMPLETED PRIOR TO INSTALLATION OF PLANT MATERIAL. DO NOT PLANT WHEN CONDITIONS ARE NOT SUITABLE FOR DIGGING, MIXING, RAKING AND/OR GRADING. PLANTING SHALL OCCUR DURING THE MONTHS THAT IRRIGATION SYSTEMS ARE IN OPERATION. THEREFORE, PLANTING MAY OCCUR BETWEEN APRIL 1st AND SEPTEMBER 30th.
- SOIL EXCAVATED FROM THE PLANTING PIT SHALL BE TYPICALLY CONSIDERED ACCEPTABLE AS BACKFILL MATERIAL FOR PLANTING.
- ALL CONTAINERS SHALL BE REMOVED PRIOR TO PLANT INSTALLATION IN A MANNER THAT DOES NOT DISTURB THE POTTED SOIL OR ROOT BALL.
- SET THE ROOT BALL ON SIX-INCHES OF FIRM PLANTING SOIL, PLUMB AND IN THE CENTER OF THE PIT WITH THE ROOT BALL CROWN SLIGHTLY ABOVE THE SAME ELEVATION AS ADJACENT FINISHED LANDSCAPE GRADES. REMOVE ANY WIRE, TWINE, BURLAP, OR OTHER MATERIAL FROM THE UPPER ONE-THIRD OF THE ROOT BALL OF BALLED AND BURLAPPED STOCK. WIRE BASKETS AND SYNTHETIC BURLAP SHALL BE COMPLETELY REMOVED AFTER THE ROOT BALL HAS BEEN PLACED IN ITS FINAL LOCATION.
- ONCE PLANT IS SET, PLACE BACKFILL MATERIAL AROUND BASE AND SIDES OF ROOT BALL AND WORK EACH LAYER TO SETTLE BACKFILL AND ELIMINATE VOIDS. WHEN BACKFILLING IS TWO-THIRDS COMPLETE, WATER THOROUGHLY. PLACE THE REMAINDER OF THE BACKFILL AND REPEAT WATERING UNTIL NO MORE IS ABSORBED. PLACE THE FINAL LAYER OF BACKFILL AND WATER.
- ALL DECIDUOUS TREES SHALL BE WRAPPED FROM THE GROUND LINE UP TO AND INCLUDING THE FIRST PRIMARY CROTCH FORMED BY THE FIRST MAJOR BRANCH. WRAPPING SHALL BE DONE AFTER THE PLANT HAS BEEN INSTALLED.
- TWO TO THREE INCHES OF SPECIFIED MULCH SHALL BE PLACED IN THE AREA DISTURBED BY EXCAVATION OF THE PLANTING WELL.
- PRIOR TO PLANTING ACTIVITIES, COMPLETELY REMOVE EXISTING WEEDS, INCLUDING ROOTS. IMMEDIATELY PRIOR TO INSTALLATION, CULTIVATE GROUND COVER AREAS TO A DEPTH OF SIX-INCHES AND GRADE SMOOTHLY AND UNIFORMLY. PLANT GROUND COVER SO THE ROOT CROWN IS AT OR SLIGHTLY ABOVE THE BED'S FINISH GRADE. AFTER PLANTING OF GROUND COVER AND PRIOR TO MULCHING, APPLY PRE-EMERGENT WEED CONTROL OVER PLANTING BED SOIL SURFACE IN ACCORDANCE WITH MANUFACTURER'S WRITTEN DIRECTIONS. INSTALL THE SPECIFIED MULCH TO A DEPTH OF TWO-INCHES OVER THE ENTIRE GROUND COVER BED.
- PRUNE DEAD OR DAMAGED BRANCHES, MAKING ALL CUTS AT BRANCH COLLAR. MAINTAIN THE NATURAL HABIT, SHAPE AND SPECIFIED SIZE. REMOVE ALL TAGS, LABELS, AND OTHER MATERIAL.

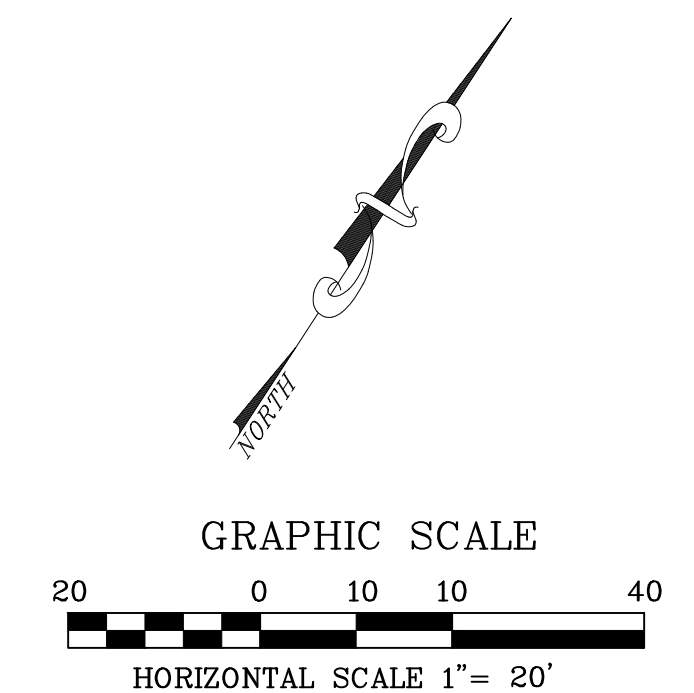

NO.	DATE	REVISIONS

The **WLB** Group, Inc.  
 WLB Group, Inc.  
 Surveying • Planning • Urban Design  
 Landscape Architecture • Civil Engineering  
 Office Locations:  
 Flagstaff, and Las Vegas, NV,  
 500 N. Beaver Street,  
 Flagstaff, AZ 86001  
 Ph: (928) 779-1500

**SHAMROCK FOOD SERVICE  
WAREHOUSE #551**  
 LANDSCAPE  
 SITE PLAN

DESIGNED BY: WLB  
 DRAWN BY: WLB  
 CHECK BY: BL  
 DATE: DECEMBER 2021

PROJECT NO.  
 32006A003  
 SHEET  
**L1**

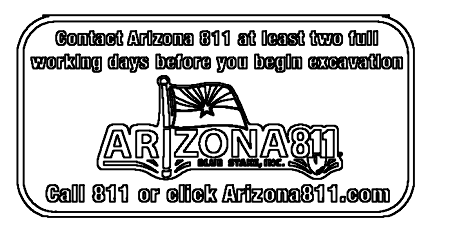

N:\32006A003\_Shamrock FSW Flagstaff North\dwg\Cut-Site\Improvement\Landscape\LS.dwg, 12/20/2021, 4:07:30 PM

**IRRIGATION LEGEND:**

SYMBOL	DESCRIPTION	MANUFACTURER/MODEL	COMMENTS
	WATER METER	N/A	WATER METER TO BE INSTALLED PER CIVIL PLANS
	BACKFLOW PREVENTER	FEBCO 825YA	3/4" BFP TO BE INSTALLED PER CIVIL PLANS. INSTALL IN A SECURABLE BACKFLOW PREVENTER CAGE.
	FLOW SENSOR	IRRITROL FS-400	INSTALL AFTER MASTER VALVE AT P.O.C.
	CONTROLLER	IRRITROL TC-18EXM-R 18-STATION WALL MOUNTED CONTROLLER IN METAL CABINET	INSTALL PER MANUFACTURER'S SPECIFICATIONS PROVIDE KEYS AND OPERATING INSTRUCTIONS TO OWNER
	GATE VALVE	WATTS WGV THD BRASS GATE VALVE	INSTALL IN 10" ROUND VALVE BOX.
	1" QUICK COUPLER	TORO 100-SLSC W/ 100-SLK KEY	INSTALL IN 10" ROUND VALVE BOX. PROVIDE 3 KEYS
	REMOTE CONTROL DRIP VALVE ASSEMBLY	TORO DZK-700, 1" DRIP VALVE ASSEMBLY INCLUDES Y-FILTER AND PRESSURE REGULATOR	INSTALL IN VALVE BOX
	MAIN LINE	SCH 40 PVC, SCH 80 FITTINGS	SIZE PER PIPE SCHEDULE (1" MIN.); SOLVENT WELD.
	SHRUB/G.C. LATERAL	CLASS 200 PVC	3/4" UNLESS OTHERWISE NOTED.
	TREE LATERAL	CLASS 200 PVC	3/4" UNLESS OTHERWISE NOTED.
	MULTI-OUTLET DRIP EMITTER	TORO T-PR25-9 PRESSURE REGULATING MANIFOLD OR APPROVED EQUAL	NOT SHOWN ON PLAN. SEE EMITTER DETAILS..
	SINGLE-OUTLET DRIP EMITTER	TORO T-DPJ08-A, 2-CPH EMITTER OR APPROVED EQUAL	NOT SHOWN ON PLAN. SEE EMITTER DETAILS.
	DISTRIBUTION TUBE	1/4" POLYETHYLENE	MAXIMUM LENGTH 6-FEET. SEE EMITTER DETAILS.
	END FLUSH CAP	TORO T-FCH-H-FIPT, OR APPROVED EQUAL	LOCATE IN 10" ROUND VALVE BOX
	SLEEVE	SCH. 40 PVC PIPE	SIZE TO BE 2X DIAMETER OF PIPE BEING SLEEVED
	ELECTRICAL SLEEVE	SCH. 40 PVC PIPE (1.5" MINIMUM)	SLEEVE UNDER ALL PAVING TYP.

PIPE SIZING SCHEDULE		SLEEVE SIZING SCHEDULE (MIN.)				EMITTER NOTES	
SIZE	GPM	SIZE	GPM	PIPE	SLEEVE	PIPE	SLEEVE
3/4"	6-10	1 1/2"	26-35	3/4"	1 1/2"	1 1/2"	3"
1"	11-15	2"	36-55	1"	2"	2"	4"
1 1/4"	16-25	2 1/2"	56-80	1 1/4"	2.5"	2 1/2"	5"

	STATION NUMBER
	VALVE SIZE/ZONE TYPE

**IRRIGATION NOTES:**

- ALL EXACT QUANTITIES OF EQUIPMENT REMAIN THE RESPONSIBILITY OF THE IRRIGATION CONTRACTOR AND NO ADDITIONAL COSTS TO OWNER WILL BE ACCEPTED AFTER BIDDING THIS PROJECT EXCEPT FOR CHANGE ORDERS APPROVED BY THE OWNER.
- PLANS ARE DIAGRAMMATIC AND APPROXIMATE. ALL IRRIGATION EQUIPMENT SHALL BE LOCATED IN LANDSCAPE AREAS; ALL SLEEVES SHALL BE INSTALLED PRIOR TO PAVING WORK. NO TEES, ELLS OR OTHER TURNS IN PIPING SHALL BE LOCATED UNDER PAVING EXCEPT WHERE SHOWN ON THE PLANS.
- THE IRRIGATION SYSTEM IS DESIGNED FOR 90 STATIC PSL. CONTRACTOR SHALL VERIFY WATER PRESSURE IN THE FIELD PRIOR TO CONSTRUCTION. CONTRACTOR IS RESPONSIBLE FOR ALERTING THE LANDSCAPE ARCHITECT AND OWNER OF ANY DISCREPANCIES BETWEEN DESIGN PRESSURE AND FIELD PRESSURE.
- CONTRACTOR SHALL CONFORM TO ALL STATE AND LOCAL CODES AND IS RESPONSIBLE FOR OBTAINING PERMITS FROM LOCAL AGENCIES AND UTILITY COMPANIES HAVING JURISDICTION OVER THE PROJECT SITE.
- CONTRACTOR SHALL VERIFY LOCATIONS OF ALL UNDERGROUND UTILITIES PRIOR TO ANY INSTALLATION. CONTACT BLUE STAKES CENTER (263-1100) FORTY-EIGHT (48) HOURS PRIOR TO CONSTRUCTION.
- CONTRACTOR SHALL PROVIDE ALL LABOR, MATERIALS, AND EQUIPMENT NECESSARY TO INSTALL THE IMPROVEMENTS INDICATED ON THE IRRIGATION PLANS. CONTRACTOR IS RESPONSIBLE FOR CAREFUL SITE INSPECTION, REVIEW OF ALL LANDSCAPE DOCUMENTS, AND COORDINATION WITH OTHER CONTRACTORS ON-SITE PRIOR TO ANY INSTALLATION. ANY DISCREPANCIES SHALL BE IMMEDIATELY BROUGHT TO THE ATTENTION OF THE SITE SUPERINTENDENT AND THE OWNER.
- CONTRACTOR IS RESPONSIBLE FOR THE COORDINATING THE INSTALLATION OF SLEEVES UNDER PAVED SURFACES WITH THE GENERAL CONTRACTOR.
- PROVIDE PVC VALVE BOXES FOR ALL UNDERGROUND VALVES, PRESET PRESSURE REGULATORS AND FLUSH PLUGS.
- USE ONLY #14 DIRECT BURIAL COPPER WIRE FOR ALL UNDERGROUND WIRING. ALL WIRE RUNS TO BE CONTINUOUS FROM CONTROLLER TO CONTROL VALVE. USE ONLY EPOXY FILLED WATERPROOF WIRE ASSEMBLIES BY SPEARS (OR EQUAL) FOR ALL WIRE SPLICES.
- OBTAIN APPROVAL FROM THE OWNER'S AGENT OF STAKED LOCATIONS FOR ALL VALVES, MAINLINE, AND THE AUTOMATIC CONTROLLER PRIOR TO INSTALLATION.
- TEST MAINLINE UNDER PRESSURE FROM THE WATER SOURCE (POINT OF CONNECTION) TO CONTROL VALVES AND QUICK COUPLERS FOR A MINIMUM OF 12-HOURS. OBTAIN APPROVAL FROM OWNER'S AGENT PRIOR TO BACKFILLING.
- ALL PVC SLEEVEING PASSING UNDER PAVED SURFACES AND THROUGH FOOTINGS SHALL BE SCHEDULE-40 PVC PIPE TWICE THE SIZE OF THE PIPE PASSING THROUGH. PROVIDE A SEPARATE SLEEVE FOR ELECTRICAL WIRING (1.5" MINIMUM).
- EXACT PIPE SIZING AND FOOTAGE ARE THE RESPONSIBILITY OF THE IRRIGATION CONTRACTOR.
- USE TEFLON TAPE OR PIPE JOINT COMPOUND ON ALL THREADED JOINTS.
- ALL DRIP SYSTEM LATERAL PIPING SHALL BE 3/4-INCH CLASS 200 PVC. ALL FITTINGS SHALL BE SCHEDULE 40 PVC.
- CONTRACTOR IS RESPONSIBLE FOR COORDINATING THE IRRIGATION WORK WITH THE LANDSCAPE PLANS TO AVOID CONFLICT BETWEEN IRRIGATION EQUIPMENT AND PLANTING PITS.
- WHERE TREES, LIGHT STANDARDS, ETC. ARE AN OBSTRUCTION OF SPRAYS, PIPING AND SPRINKLER HEADS SHALL BE ADJUSTED AND/OR RELOCATED AS REQUIRED TO ACHIEVE FULL HEAD TO HEAD COVERAGE.
- PROVIDE A TYPED WATERING SCHEDULE ENCASED IN PLASTIC AND ATTACHED TO THE INSIDE OF THE CONTROLLER ENCLOSURE.
- PRIOR TO INITIATING THE 90-DAY MAINTENANCE PERIOD, TEST THE SYSTEM WITH THE OWNER'S AGENT TO VERIFY THAT THE SYSTEM IS FULLY OPERATIONAL. PROVIDE WRITTEN RECOMMENDATIONS OF SUGGESTED SEASONAL WATERING SCHEDULES.
- PROVIDE A WRITTEN 18-MONTH GUARANTEE FOR ALL IRRIGATION EQUIPMENT DATED FROM THE START OF THE 90-DAY MAINTENANCE PERIOD. CONTRACTOR SHALL PROVIDE LABOR, MATERIALS AND EQUIPMENT AS NECESSARY TO RESTORE THE FULL OPERATION OF THE SYSTEM AND REPLACE ANY PLANT MATERIAL THAT DIED AS A DIRECT RESULT OF THE FAILURE.

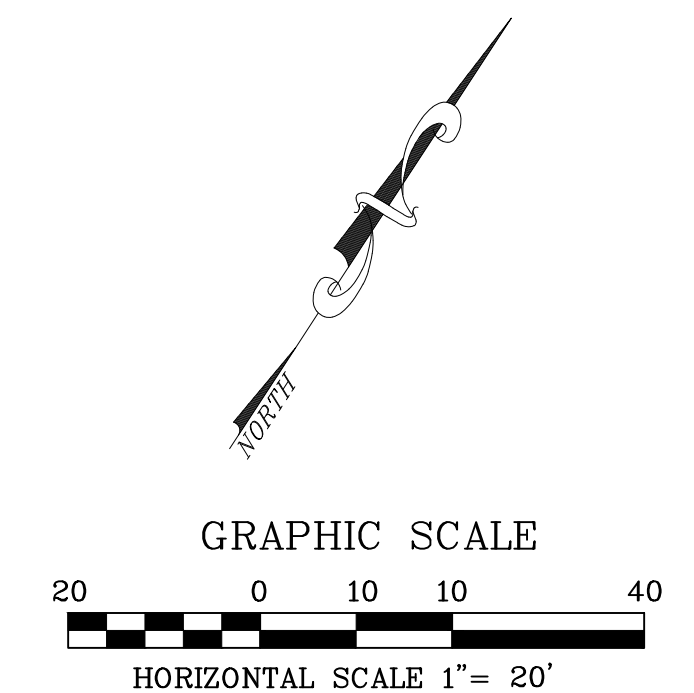
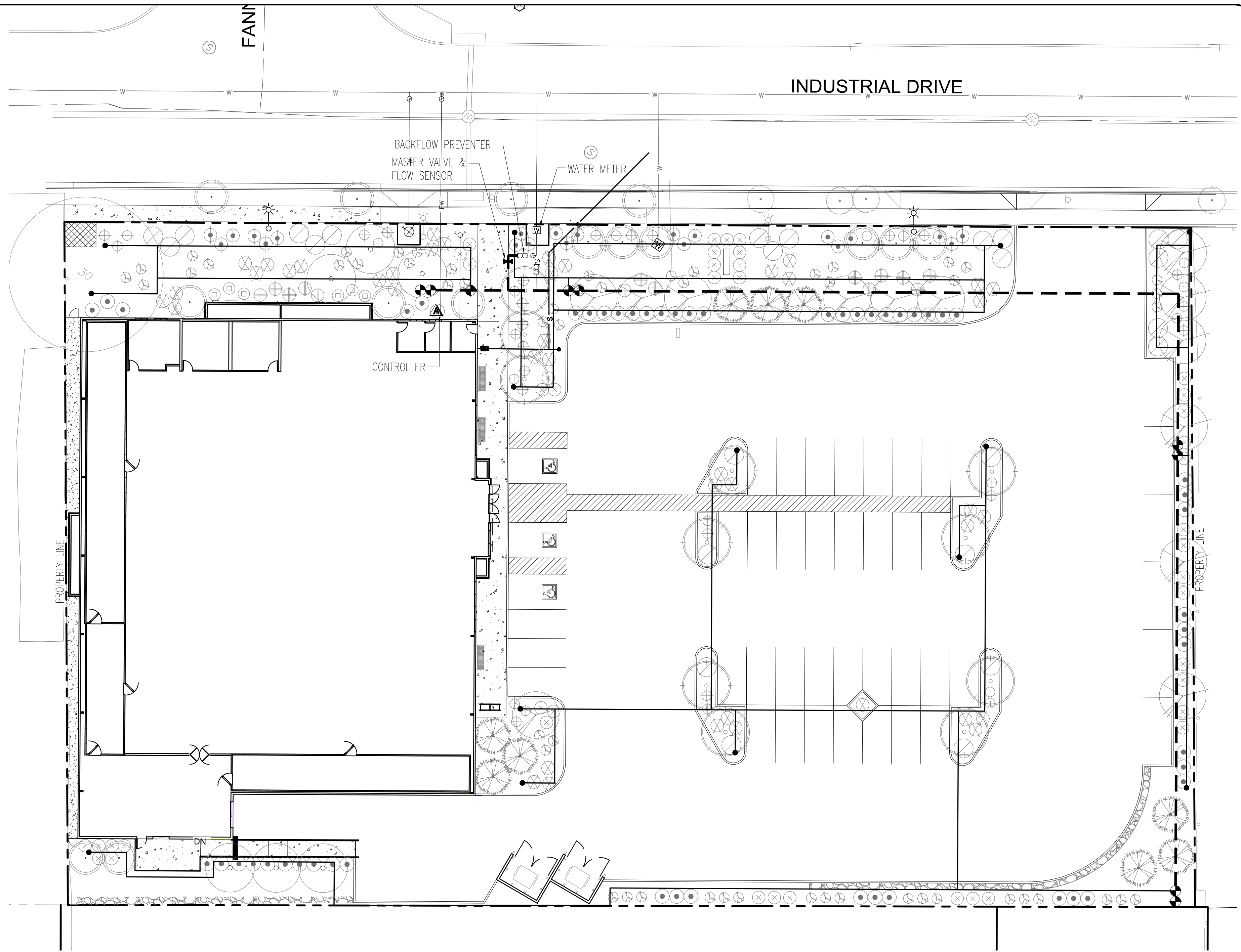

NO:	DATE:	ITEM:

Engineering • Planning • Surveying  
**The WLB Group, Inc.**  
 Offices located in: Tucson, Phoenix, Flagstaff, and Las Vegas, NV.  
 500 N. Beaver Street, Flagstaff, AZ, 86001  
 PH: (928) 779-1500

**SHAMROCK FOOD SERVICE WAREHOUSE #551**  
 IRRIGATION SITE PLAN



DESIGNED BY: WLB  
 DRAWN BY: WLB  
 CHECK BY: BL  
 DATE: DECEMBER 2021

PROJECT NO. 320006A003  
 SHEET  
**L2**

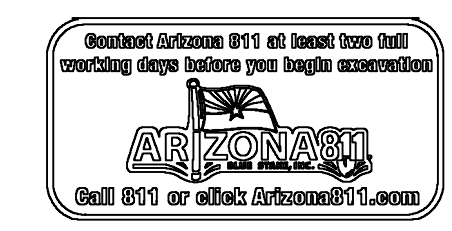

N:\320006A003\_Shamrock FSW Flagsstaff North\dwg\Cut-Site\Improvement\Landscape\IR.dwg, 12/20/2021, 4:07:48 PM