

Quotation



Russ Bassett Corporation
 8189 Byron Road Whittier, CA 90606
 Tel: 800.350.2445 Fax: 562.698.8972
 www.russbassett.com

PROJECT #: PN-10060-01 **Option: 1**
REVISION: B
PROJECT NAME: Flagstaff Console Modernization

QUOTE DATE: 10/16/2023	SALES EXECUTIVE: Peter Fink
EXPIRATION DATE: 11/18/2023	ADDRESS: 8189 Byron Rd Whittier, CA 90606
CUSTOMER: Flagstaff Police Department	PHONE: (562) 945-2445 xt 3354
CONTACT: Katie Brandis	EMAIL: pfink@russbassett.com
ADDRESS: 911 E. Sawmill Road Flagstaff, AZ 86001	
PHONE: (928) 774-1414	
EMAIL: kbrandis@coconino.az.gov	

10425

QTY	PART NUMBER	DESCRIPTION	HGACBuy PRICE	EXTENDED
AREA: 1		Dispatch Room Consoles	AREA 1 TOTAL: \$	229,153.87
12	FSA-CS-72-R56	Flex Sit-Stand, R56, 90° Corner, 72W, Adjustable Array	\$ 6,249.10	\$ 74,989.20
4	FSW-07-1842-SWN-SWN	Flex Wall, 07D, 18L x 42H, Slatwall Side A, Slatwall Side B	\$ 597.43	\$ 2,389.72
11	FSW-07-3042-EMT-EMT	Flex Wall, 07D, 30L x 42H, Empty Side A, Empty Side B	\$ 280.03	\$ 3,080.33
2	FSW-07-4242-SSF-EMT	Flex Wall, 07D, 42L x 42H, Sit-Stand Fabric Side A, Empty Side B	\$ 500.83	\$ 1,001.66
4	FSW-07-4242-SSF-EMT	Flex Wall, 07D, 42L x 42H, Sit-Stand Fabric Side A, Empty Side B	\$ 500.83	\$ 2,003.32
9	FSW-07-4242-SSF-SSF	Flex Wall, 07D, 42L x 42H, Sit-Stand Fabric Side A, Sit-Stand Fabric Side B	\$ 694.03	\$ 6,246.27
2	FSW-07-4842-SWN-EMT	Flex Wall, 07D, 48L x 42H, Slatwall Side A, Empty Side B	\$ 493.93	\$ 987.86
1	FSW-07-CC42-SSF-EMT	Flex Wall, 07D, 42.3L x 42H, Sit-Stand Fabric Side A, Empty Side B	\$ 500.83	\$ 500.83
1	FSW-07-CC42-SSF-EMT	Flex Wall, 07D, 42.3L x 42H, Sit-Stand Fabric Side A, Empty Side B	\$ 500.83	\$ 500.83
2	FBP-3042-SPS	Flex Back Panel, 30W x 42H, Solid, Powder, Square	\$ 231.15	\$ 462.30
6	FBP-4242-SPS	Flex Back Panel, 42W x 42H, Solid, Powder, Square	\$ 244.95	\$ 1,469.70
2	FBP-4842-SPS	Flex Back Panel, 48W x 42H, Solid, Powder, Square	\$ 251.85	\$ 503.70
2	FBP-CC42-SPS	Flex Back Panel, 42.3W x 42H, Solid, Powder, Square	\$ 244.95	\$ 489.90
12	FTC-0706-SL-S	Flex Top Cap, 7D x 6W, Status Indicator Light Pole Receiver, Square	\$ 207.58	\$ 2,490.96
4	FTC-0718-S-S	Flex Top Cap, 7D x 18W, Solid, Square	\$ 131.68	\$ 526.72
2	FTC-0736-S-S	Flex Top Cap, 7D x 36W, Solid, Square	\$ 152.38	\$ 304.76
2	FTC-0766-GL-BL-S	Flex Top Cap, 7D x 66W, Blue Lit Glass W/ Logo, Square	\$ 1,741.10	\$ 3,482.20
7	FTC-0766-S-S	Flex Top Cap, 7D x 66W, Solid, Square	\$ 187.45	\$ 1,312.15
2	FTC-0772-S-S	Flex Top Cap, 7D x 72W, Solid, Square	\$ 194.35	\$ 388.70
2	FTC-0790-GL-BL-S	Flex Top Cap, 7D x 90W, Blue Lit Glass W/ Logo, Square	\$ 1,998.70	\$ 3,997.40
2	FTC-07CC-S-S	Flex Top Cap, 7D x 42.3W, Solid, Square	\$ 159.85	\$ 319.70
10	FCF-42-T-SSF-R56	Flex Sit-Stand Corner Filler, 42H, Tech Storage, Fabric, R56	\$ 888.95	\$ 8,889.50
8	FWS-FRE-3618-W	Work Surface, Rectangle, 36D x 18L	\$ 453.68	\$ 3,629.44
2	FWS-FRE-3648-W	Work Surface, Rectangle, 36D x 48L	\$ 701.50	\$ 1,403.00
12	FWS-SCA-3672-N-W	Work Surface, 90° Corner Sit-Stand, Single Lift Array, 36D x 72L	\$ 1,088.48	\$ 13,061.76
4	FCC-07L-4542-EPS	Flex Corner Connector, 7D, 45° L-Type, 42H, Exterior, Powder, Square	\$ 283.48	\$ 1,133.92
1	FCC-07T-9042-EPS	Flex Corner Connector, 7D, 90° T-Type, 42H, Exterior, Powder, Square	\$ 317.40	\$ 317.40
2	FCC-07X-9042-MTS	Flex Corner Connector, 7D, 90° X-Type, 42H, Empty, Square	\$ 207.58	\$ 415.16
4	FPP-3618-BCL-L-N	Flex Drawer Pedestal, 36D x 18W, Box/Closed, Left Swing, Lam Faces, No Lk	\$ 438.73	\$ 1,754.92
4	FPP-3618-BCR-L-N	Flex Drawer Pedestal, 36D x 18W, Box/Closed, Right Swing, Lam Faces, No Lk	\$ 438.73	\$ 1,754.92
2	FPP-3624-BCL-L-N	Flex Drawer Pedestal, 36D x 24W, Box/Closed, Left Swing, Lam Faces, No Lk	\$ 461.15	\$ 922.30

Quotation

PROJECT #:	PN-10060-01	Option: 1
REVISION:	B	
PROJECT NAME:	Flagstaff Console Modernization	



Russ Bassett Corporation
 8189 Byron Road Whittier, CA 90606
 Tel: 800.350.2445 Fax: 562.698.8972
 www.russbassett.com

QTY	PART NUMBER	DESCRIPTION	HGACBuy PRICE	EXTENDED
2	FPP-3624-BCR-L-N	Flex Drawer Pedestal, 36D x 24W, Box/Closed, Right Swing, Lam Faces, No Lk	\$ 461.15	\$ 922.30
5	FEC-AAN-0742-B-L	Flex Back-to-Back End Cap, Array Sit-Stand, 7" Wall, 42"H, Lam	\$ 483.00	\$ 2,415.00
1	FEC-AAN-0742-L-L	Flex Left End Cap, Array Sit-Stand, 7" Wall, 42"H, Lam	\$ 431.83	\$ 431.83
1	FEC-AAN-0742-R-L	Flex Right End Cap, Array Sit-Stand, 7" Wall, 42"H, Lam	\$ 431.83	\$ 431.83
4	FEC-FH-0742-L	Flex End Cap, Fixed Height, 7" Wall, 42"H, Lam	\$ 276.00	\$ 1,104.00
24	FTP-12-N-R56	Under Surface Tech Pod, 12"W, R56	\$ 472.65	\$ 11,343.60
12	DAC-CUPHLDR-US-R	Cup Holder, Under Surface, Rotating	\$ 114.43	\$ 1,373.16
24	DAC-DASH-BLANK	Dash Plate, Blank	\$ 31.63	\$ 759.12
12	DAC-DASH-CHRG-AC	Dash Plate, Device Charging, USB A-C	\$ 163.88	\$ 1,966.56
12	DAC-DASH-DIMMER	Dash Plate, Ambient Dimmer	\$ 94.88	\$ 1,138.56
12	DAC-DASH-LIGHT	Dash Plate, Gooseneck Light	\$ 204.70	\$ 2,456.40
12	DAC-DASH-SWITCH-R	Dash Plate, Switch, Status Indicator Light, Red	\$ 104.08	\$ 1,248.96
12	DAC-DASH-USB-X2	Dash Plate, 2 USB Keystones W/ Cables	\$ 116.73	\$ 1,400.76
12	DAC-DTC-ADA	Desktop Controller, ADA	\$ 62.68	\$ 752.16
12	DAC-LED-DA-SW	Dimmable LED Task Light - Double Arm, Slatwall Mount	\$ 317.40	\$ 3,808.80
12	DAC-MM-01-SW-PM	Monitor Mount, Slatwall, Pole Mount	\$ 362.25	\$ 4,347.00
12	DAC-MM-11-SW-PM	Monitor Mount, 1-Over-1, Slatwall, Pole Mount	\$ 586.50	\$ 7,038.00
12	DAC-MM-LG-200	Monitor Mount, Large Screen, 200MM VESA	\$ 345.58	\$ 4,146.96
12	DAC-PCS-FLX-A	Flex Personal Comfort System, Heat & Air, Array Console	\$ 1,500.18	\$ 18,002.16
12	DAC-SL-CIS	Status Indicator Light - Custom Interchangeable Sign	\$ 121.33	\$ 1,455.96
12	DAC-SW-SANSTN	Slatwall Sanitation Station	\$ 200.68	\$ 2,408.16
12	DAC-SW-WIPES-425	Slatwall Disinfecting Wipes Holder, 4.25" Diameter	\$ 135.13	\$ 1,621.56
12	DAC-VESA-4X4	VESA Adapter Plate, 400mm x 400mm	\$ 101.20	\$ 1,214.40
1	WAC-ARTWORK	Logo Artwork Prep - Per Logo Design	\$ 687.70	\$ 687.70
12	WAC-DTB-14	14 Port Data Termination Bracket, Universal	\$ 83.38	\$ 1,000.56
4	WAC-ETCH-LOGO	Glass Etching, Logo - Per Logo Instance	\$ 722.20	\$ 2,888.80
4	WAC-ETCH-TEXT	Glass Etching, Text - Per Text Line	\$ 996.48	\$ 3,985.92
12	WAC-SLT-5-36	Pole Mount Situation Awareness Light, 5-Lens, 36"H Pole	\$ 585.93	\$ 7,031.16
12	WAC-UEM-12	Universal Equipment Mount Kit, 12"	\$ 86.83	\$ 1,041.96
AREA: 2 Dispatch Room Optional Accessories			AREA 2 TOTAL:	\$ 5,230.32
12	DAC-AMB-SW-12	Ambient Light, Slatwall, 12", Blue	\$ 104.08	\$ 1,248.96
12	DAC-AMB-SW-72	Ambient Light, Slatwall, 72", Blue	\$ 276.00	\$ 3,312.00
12	DAC-AMB-PWR	Ambient Light Power Supply W/ Splitter	\$ 55.78	\$ 669.36
AREA: 3 Training Room Consoles			AREA 3 TOTAL:	\$ 19,492.07
1	FSA-CS-72-R56	Flex Sit-Stand, R56, 90° Corner, 72W, Adjustable Array	\$ 6,249.10	\$ 6,249.10
1	FSW-07-1842-SWN-EMT	Flex Wall, 07D, 18L x 42H, Slatwall Side A, Empty Side B	\$ 424.93	\$ 424.93
2	FSW-07-4242-SSF-EMT	Flex Wall, 07D, 42L x 42H, Sit-Stand Fabric Side A, Empty Side B	\$ 500.83	\$ 1,001.66
1	FSW-07-CC42-SSF-EMT	Flex Wall, 07D, 42.3L x 42H, Sit-Stand Fabric Side A, Empty Side B	\$ 500.83	\$ 500.83

Quotation

PROJECT #:	PN-10060-01	Option: 1
REVISION:	B	
PROJECT NAME:	Flagstaff Console Modernization	



Russ Bassett Corporation
 8189 Byron Road Whittier, CA 90606
 Tel: 800.350.2445 Fax: 562.698.8972
 www.russbassett.com

QTY	PART NUMBER	DESCRIPTION	HGACBuy PRICE	EXTENDED
1	FBP-1842-SPS	Flex Back Panel, 18W x 42H, Solid, Powder, Square	\$ 217.35	\$ 217.35
2	FBP-4242-SPS	Flex Back Panel, 42W x 42H, Solid, Powder, Square	\$ 244.95	\$ 489.90
1	FBP-CC42-SPS	Flex Back Panel, 42.3W x 42H, Solid, Powder, Square	\$ 244.95	\$ 244.95
1	FTC-0706-SL-S	Flex Top Cap, 7D x 6W, Status Indicator Light Pole Receiver, Square	\$ 207.58	\$ 207.58
1	FTC-0718-S-S	Flex Top Cap, 7D x 18W, Solid, Square	\$ 131.68	\$ 131.68
1	FTC-0736-S-S	Flex Top Cap, 7D x 36W, Solid, Square	\$ 152.38	\$ 152.38
1	FTC-0742-S-S	Flex Top Cap, 7D x 42W, Solid, Square	\$ 159.85	\$ 159.85
1	FTC-07CC-S-S	Flex Top Cap, 7D x 42.3W, Solid, Square	\$ 159.85	\$ 159.85
2	FTP-12-N-R56	Under Surface Tech Pod, 12"W, R56	\$ 472.65	\$ 945.30
1	FWS-FRE-3618-W	Work Surface, Rectangle, 36D x 18L	\$ 453.68	\$ 453.68
1	FWS-SCA-3672-N-W	Work Surface, 90° Corner Sit-Stand, Single Lift Array, 36D x 72L	\$ 1,088.48	\$ 1,088.48
1	FPP-3618-BCL-L-N	Flex Drawer Pedestal, 36D x 18W, Box/Closed, Left Swing, Lam Faces, No Lk	\$ 438.73	\$ 438.73
2	FCC-07L-4542-EPS	Flex Corner Connector, 7D, 45° L-Type, 42H, Exterior, Powder, Square	\$ 283.48	\$ 566.96
1	FEC-AAN-0742-R-L	Flex Right End Cap, Array Sit-Stand, 7" Wall, 42"H, Lam	\$ 431.83	\$ 431.83
1	FEC-FH-0742-L	Flex End Cap, Fixed Height, 7" Wall, 42"H, Lam	\$ 276.00	\$ 276.00
1	WAC-DTB-14	14 Port Data Termination Bracket, Universal	\$ 83.38	\$ 83.38
1	WAC-SLT-5-36	Pole Mount Situation Awareness Light, 5-Lens, 36"H Pole	\$ 585.93	\$ 585.93
1	WAC-UEM-12	Universal Equipment Mount Kit, 12"	\$ 86.83	\$ 86.83
1	DAC-CUPHLDR-US-R	Cup Holder, Under Surface, Rotating	\$ 114.43	\$ 114.43
2	DAC-DASH-BLANK	Dash Plate, Blank	\$ 31.63	\$ 63.26
1	DAC-DASH-CHRG-AC	Dash Plate, Device Charging, USB A-C	\$ 163.88	\$ 163.88
1	DAC-DASH-DIMMER	Dash Plate, Ambient Dimmer	\$ 94.88	\$ 94.88
1	DAC-DASH-LIGHT	Dash Plate, Gooseneck Light	\$ 204.70	\$ 204.70
1	DAC-DASH-SWITCH-R	Dash Plate, Switch, Status Indicator Light, Red	\$ 104.08	\$ 104.08
1	DAC-DASH-USB-X2	Dash Plate, 2 USB Keystones W/ Cables	\$ 116.73	\$ 116.73
1	DAC-DTC-ADA	Desktop Controller, ADA	\$ 62.68	\$ 62.68
1	DAC-LED-DA-SW	Dimmable LED Task Light - Double Arm, Slatwall Mount	\$ 317.40	\$ 317.40
1	DAC-MM-01-SW-PM	Monitor Mount, Slatwall, Pole Mount	\$ 362.25	\$ 362.25
1	DAC-MM-11-SW-PM	Monitor Mount, 1-Over-1, Slatwall, Pole Mount	\$ 586.50	\$ 586.50
1	DAC-MM-LG-200	Monitor Mount, Large Screen, 200MM VESA	\$ 345.58	\$ 345.58
1	DAC-PCS-FLX-A	Flex Personal Comfort System, Heat & Air, Array Console	\$ 1,500.18	\$ 1,500.18
1	DAC-SL-CIS	Status Indicator Light - Custom Interchangeable Sign	\$ 121.33	\$ 121.33
1	DAC-SW-SANSTN	Slatwall Sanitation Station	\$ 200.68	\$ 200.68
1	DAC-SW-WIPES-425	Slatwall Disinfecting Wipes Holder, 4.25" Diameter	\$ 135.13	\$ 135.13
1	DAC-VESA-4X4	VESA Adapter Plate, 400mm x 400mm	\$ 101.20	\$ 101.20
AREA: 4	Training Room Optional Accessories		AREA 4 TOTAL:	\$ 435.86
1	DAC-AMB-SW-12	Ambient Light, Slatwall, 12", Blue	\$ 104.08	\$ 104.08
1	DAC-AMB-SW-72	Ambient Light, Slatwall, 72", Blue	\$ 276.00	\$ 276.00
1	DAC-AMB-PWR	Ambient Light Power Supply W/ Splitter	\$ 55.78	\$ 55.78

Quotation



Russ Bassett Corporation
 8189 Byron Road Whittier, CA 90606
 Tel: 800.350.2445 Fax: 562.698.8972
 www.russbassett.com

PROJECT #: PN-10060-01	Option: 1
REVISION: B	
PROJECT NAME: Flagstaff Console Modernization	

QTY	PART NUMBER	DESCRIPTION	HGACBuy PRICE	EXTENDED
AREA: 5		Lockers	AREA 5 TOTAL: \$	8,834.36
10	DEF-LKR-1572-3H-SD	Personal Storage Locker, 19"D x 15"W x 72"H, 3 High Unit, Solid Door, Locking	\$ 700.93	\$ 7,009.30
2	DEF-LKR-BSE-0230	Locker Base, 2 Wide, 19"D x 30"W x 2"H	\$ 150.65	\$ 301.30
2	DEF-LKR-BSE-0245	Locker Base, 3 Wide, 19"D x 45"W x 2"H	\$ 184.00	\$ 368.00
2	DEF-LKR-TOP-30	Locker Top, 2 Wide, 19"D x 30"W	\$ 243.80	\$ 487.60
2	DEF-LKR-TOP-45	Locker Top, 3 Wide, 19"D x 45"W	\$ 334.08	\$ 668.16

MILESTONE

PROGRESS PAYMENT INVOICED

- | | |
|------------------------------------------|-----------------------|
| 1. SUBMITTAL OF ORDER TO RBC | 25% Due: Net 30 Days |
| 2. ORDER SHIPMENT | 50% Due: Net 30 Days |
| 3. SUBSTANTIAL COMPLETION OF THE PROJECT | 25% Due: Net 30 Days* |
- *10% retainage can be held back if there are minor punch list items delaying final completion.*

HGACBuy Contract #: EC07-23 (911 Equipment & Emergency Notification Software and Services).
 Prices shown herein are Net (discount applied) unless otherwise noted. Effective Dates 7/1/2020 - 6/30/25.

Product Total:	\$	263,146.48
Sales/Use Tax (9.18%):	\$	24,156.85
3-Phase Delivery Services:	\$	20,250.00
3-Phase Russ Bassett Installation Services:	\$	75,500.00
Total Due	\$	383,053.33

CUSTOMER

CUSTOMER:
FLAGSTAFF POLICE DEPARTMENT
 PROJECT ADDRESS:
 911 E. SAWMILL RD
 FLAGSTAFF AZ 86001

PROJECT

PROJECT NAME:
FLAGSTAFF PD CONSOLE MODERNIZATION
 PROJECT INITIATION DATE:
 11/23/2022
 CONSOLE TYPE: FLEX NUMBER OF POSITIONS: 13
 SCALE:
 NTS

SALES EXECUTIVE
 PETER FINK
 DESIGNER
 JESSE GREEN

SHEET INDEX

NO.	
1	3D VIEW 1
2	3D VIEW 2
3	PLAN VIEW
4	RENDERING VEIW 1
5	RENDERING VIEW 2
6	
7	
8	
9	
10	
11	
12	
13	
14	
15	

REVISIONS

REV	DATE	DESCRIPTION	BY
B	05/30/23	MONITOR & ACCESSORY VFCN	JN

SHEET DESCRIPTION
3D VIEW 1

DRAWING #	OPT.	REV.	SHEET
PN-10060-01	1	B	1 / 5

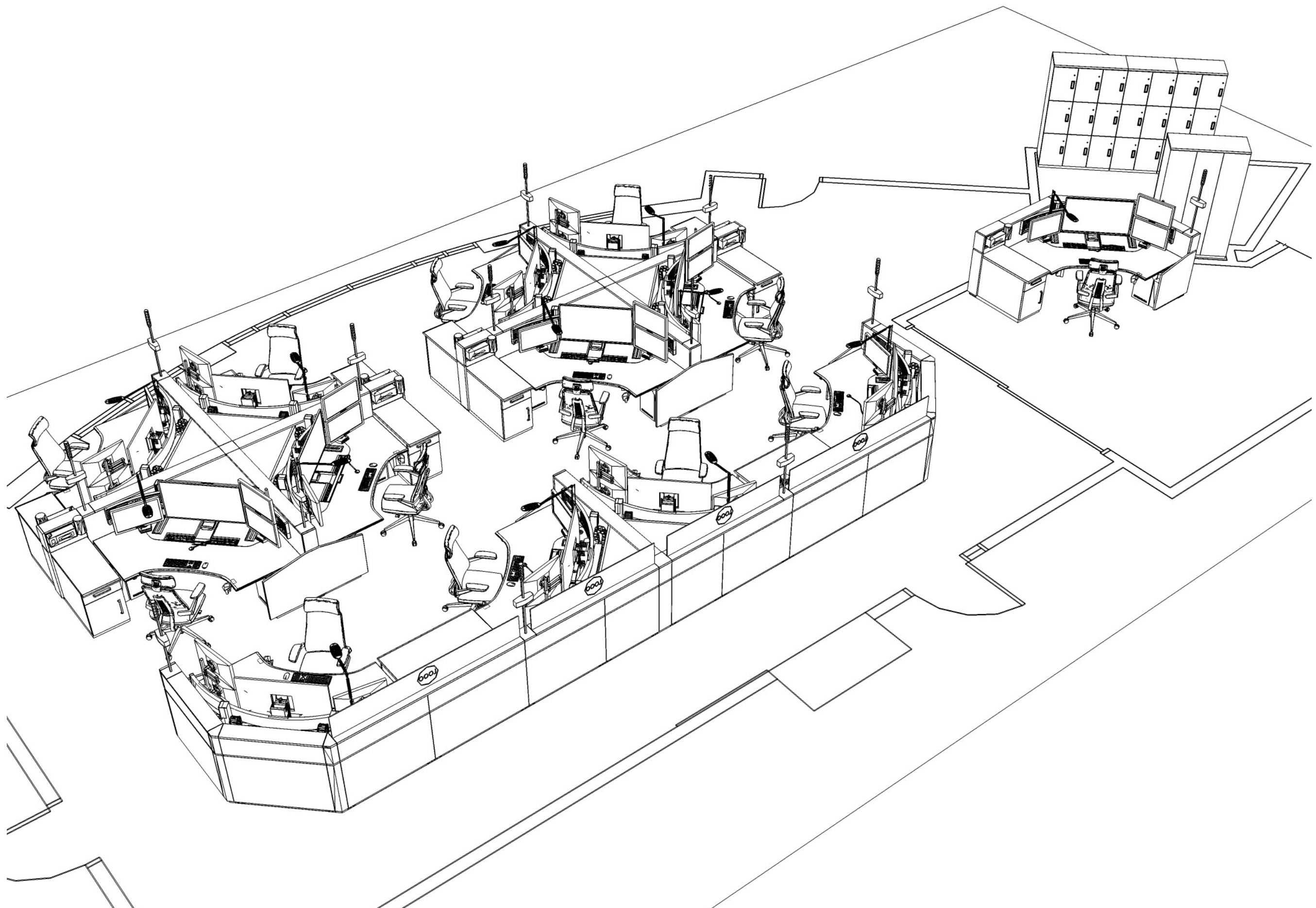

RUSS BASSETT CORPORATION HEREBY EXPRESSLY RESERVES ITS COMMON LAW COPYRIGHT AND OTHER PROPERTY RIGHTS IN THESE PLANS. THESE PLANS ARE NOT TO BE COPIED, REPRODUCED OR CHANGED IN ANY FORM OR MANNER WHATSOEVER, NOR ARE THEY TO BE ASSIGNED TO ANY THIRD PARTY WITHOUT FIRST OBTAINING THE EXPRESS WRITTEN PERMISSION AND CONSENT OF RUSS BASSETT CORPORATION.

CUSTOMER

CUSTOMER:
FLAGSTAFF POLICE DEPARTMENT
 PROJECT ADDRESS:
 911 E. SAWMILL RD
 FLAGSTAFF AZ 86001

PROJECT

PROJECT NAME:
FLAGSTAFF PD CONSOLE MODERNIZATION
 PROJECT INITIATION DATE:
 11/23/2022
 CONSOLE TYPE: FLEX NUMBER OF POSITIONS: 13
 SCALE:
 NTS

SALES EXECUTIVE

PETER FINK

DESIGNER

JESSE GREEN

SHEET INDEX

NO.	
1	3D VIEW 1
2	3D VIEW 2
3	PLAN VIEW
4	RENDERING VEIW 1
5	RENDERING VIEW 2
6	
7	
8	
9	
10	
11	
12	
13	
14	
15	

REVISIONS

REV	DATE	DESCRIPTION	BY
B	05/30/23	MONITOR & ACCESSORY VFCN	JN

SHEET DESCRIPTION
3D VIEW 2

DRAWING #	OPT.	REV.	SHEET
PN-10060-01	1	B	2 / 5

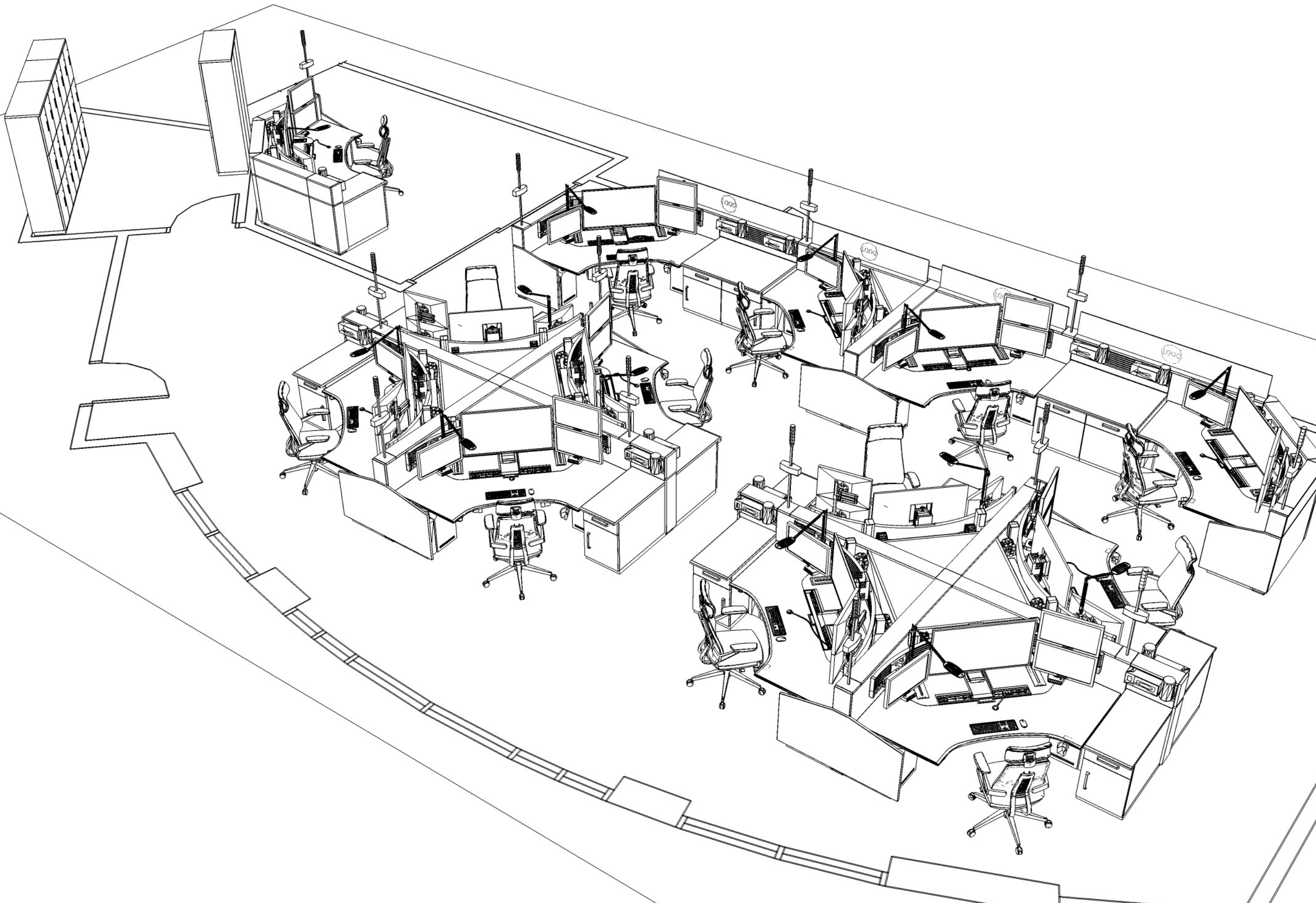

RUSS BASSETT CORPORATION HEREBY EXPRESSLY RESERVES ITS COMMON LAW COPYRIGHT AND OTHER PROPERTY RIGHTS IN THESE PLANS. THESE PLANS ARE NOT TO BE COPIED, REPRODUCED OR CHANGED IN ANY FORM OR MANNER WHATSOEVER, NOR ARE THEY TO BE ASSIGNED TO ANY THIRD PARTY WITHOUT FIRST OBTAINING THE EXPRESS WRITTEN PERMISSION AND CONSENT OF RUSS BASSETT CORPORATION.

CUSTOMER

CUSTOMER:
FLAGSTAFF POLICE DEPARTMENT
 PROJECT ADDRESS:
 911 E. SAWMILL RD
 FLAGSTAFF AZ 86001

PROJECT

PROJECT NAME:
FLAGSTAFF PD CONSOLE MODERNIZATION
 PROJECT INITIATION DATE:
 11/23/2022
 CONSOLE TYPE: FLEX NUMBER OF POSITIONS: 13
 SCALE:
 3/16" = 1'-0"

SALES EXECUTIVE
 PETER FINK
 DESIGNER
 JESSE GREEN

SHEET INDEX

NO.	DESCRIPTION
1	3D VIEW 1
2	3D VIEW 2
3	PLAN VIEW
4	RENDERING VIEW 1
5	RENDERING VIEW 2
6	
7	
8	
9	
10	
11	
12	
13	
14	
15	

REVISIONS

REV	DATE	DESCRIPTION	BY
B	05/30/23	MONITOR & ACCESSORY VFCN	JN

SHEET DESCRIPTION
PLAN VIEW

DRAWING #	OPT.	REV.	SHEET
PN-10060-01	1	B	3 / 5

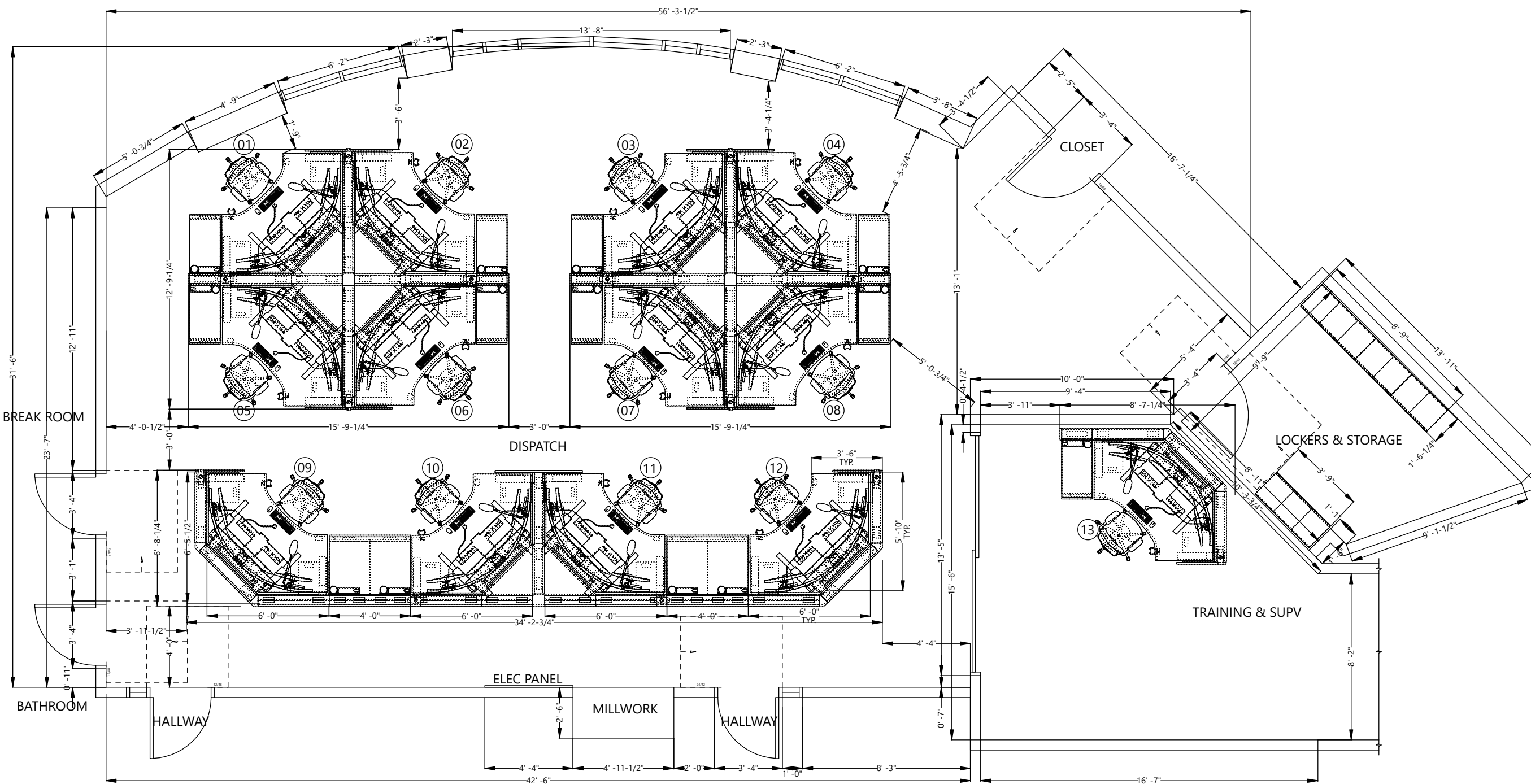

RUSS BASSETT CORPORATION HEREBY EXPRESSLY RESERVES ITS COMMON LAW COPYRIGHT AND OTHER PROPERTY RIGHTS IN THESE PLANS. THESE PLANS ARE NOT TO BE COPIED, REPRODUCED OR CHANGED IN ANY FORM OR MANNER WHATSOEVER, NOR ARE THEY TO BE ASSIGNED TO ANY THIRD PARTY WITHOUT FIRST OBTAINING THE EXPRESS WRITTEN PERMISSION AND CONSENT OF RUSS BASSETT CORPORATION.

CUSTOMER

CUSTOMER:
FLAGSTAFF POLICE DEPARTMENT
PROJECT ADDRESS:
911 E. SAWMILL RD
FLAGSTAFF AZ 86001

PROJECT

PROJECT NAME:
FLAGSTAFF PD CONSOLE MODERNIZATION
PROJECT INITIATION DATE:
11/23/2022
CONSOLE TYPE: NUMBER OF POSITIONS:
FLEX 13

SCALE:
NTS
SALES EXECUTIVE
PETER FINK
DESIGNER
JESSE GREEN

SHEET INDEX

NO.	
1	3D VIEW 1
2	3D VIEW 2
3	PLAN VIEW
4	RENDERING VEIW 1
5	RENDERING VIEW 2
6	
7	
8	
9	
10	
11	
12	
13	
14	
15	

REVISIONS

REV	DATE	DESCRIPTION	BY
B	05/30/23	MONITOR & ACCESSORY VFCN	JN

**SHEET DESCRIPTION
RENDERING 1**

DRAWING #	OPT.	REV.	SHEET
PN-10060-01	1	B	4 / 5

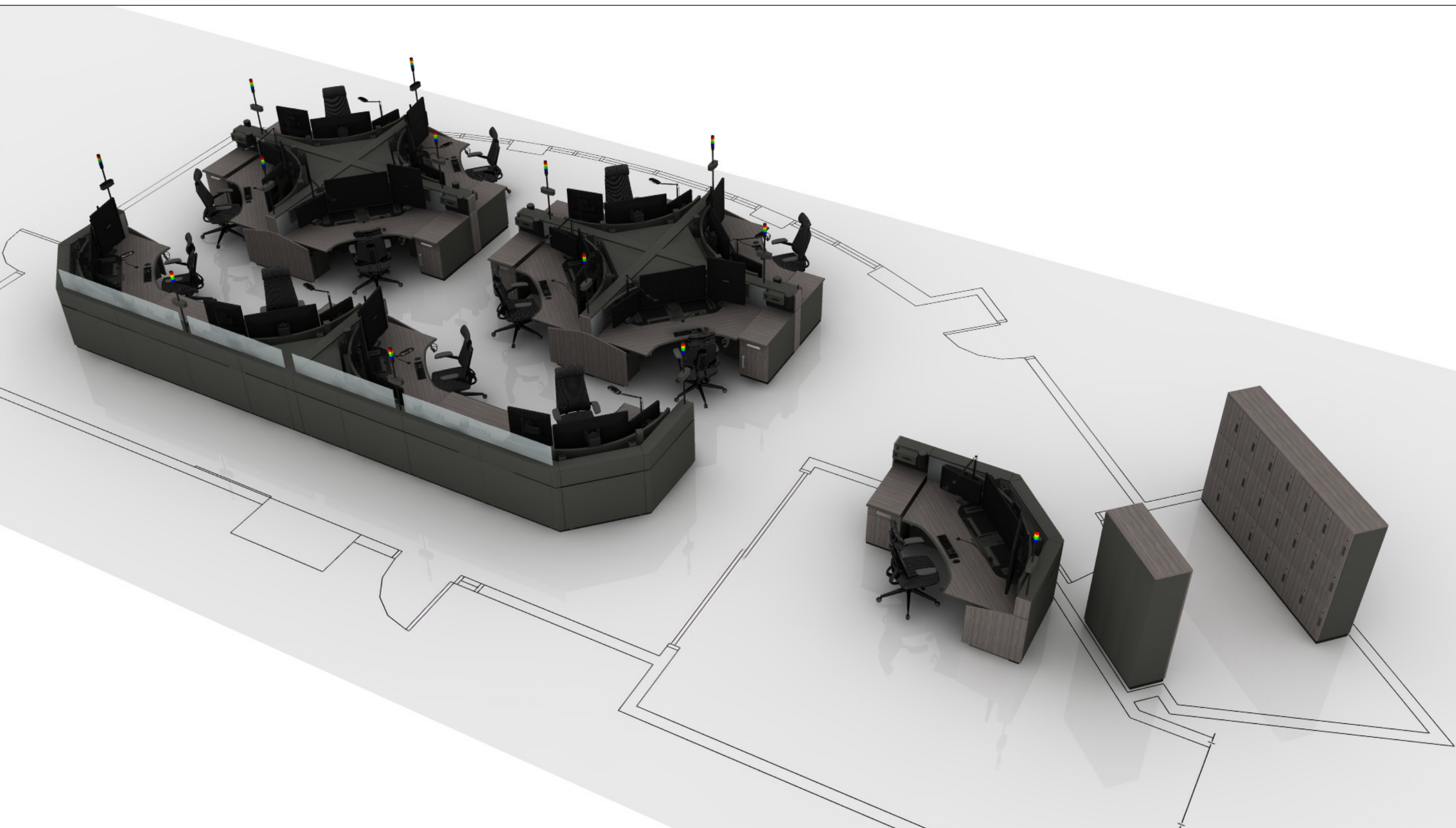

COLOR SCHEME:		
FABRIC:	WATERFALL	
LAMINATE:	PORTICO TEAK	
POWDER COAT:	CHARCOAL	

RUSS BASSETT CORPORATION HEREBY EXPRESSLY RESERVES ITS COMMON LAW COPYRIGHT AND OTHER PROPERTY RIGHTS IN THESE PLANS. THESE PLANS ARE NOT TO BE COPIED, REPRODUCED OR CHANGED IN ANY FORM OR MANNER WHATSOEVER, NOR ARE THEY TO BE ASSIGNED TO ANY THIRD PARTY WITHOUT FIRST OBTAINING THE EXPRESS WRITTEN PERMISSION AND CONSENT OF RUSS BASSETT CORPORATION.

CUSTOMER

CUSTOMER:
FLAGSTAFF POLICE DEPARTMENT
PROJECT ADDRESS:
911 E. SAWMILL RD
FLAGSTAFF AZ 86001

PROJECT

PROJECT NAME:
FLAGSTAFF PD CONSOLE MODERNIZATION
PROJECT INITIATION DATE:
11/23/2022
CONSOLE TYPE: FLEX NUMBER OF POSITIONS: 13
SCALE:
NTS

SALES EXECUTIVE
PETER FINK
DESIGNER
JESSE GREEN

SHEET INDEX

NO.	
1	3D VIEW 1
2	3D VIEW 2
3	PLAN VIEW
4	RENDERING VEIW 1
5	RENDERING VIEW 2
6	
7	
8	
9	
10	
11	
12	
13	
14	
15	

REVISIONS



REV	DATE	DESCRIPTION	BY
B	05/30/23	MONITOR & ACCESSORY VFCN	JN

**SHEET DESCRIPTION
RENDERING 2**

DRAWING #	OPT.	REV.	SHEET
PN-10060-01	1	B	5 / 5



COLOR SCHEME:

FABRIC:	WATERFALL	
LAMINATE:	PORTICO TEAK	
POWDER COAT:	CHARCOAL	

RUSS BASSETT CORPORATION HEREBY EXPRESSLY RESERVES ITS COMMON LAW COPYRIGHT AND OTHER PROPERTY RIGHTS IN THESE PLANS. THESE PLANS ARE NOT TO BE COPIED, REPRODUCED OR CHANGED IN ANY FORM OR MANNER WHATSOEVER, NOR ARE THEY TO BE ASSIGNED TO ANY THIRD PARTY WITHOUT FIRST OBTAINING THE EXPRESS WRITTEN PERMISSION AND CONSENT OF RUSS BASSETT CORPORATION.