



Design of Pickleball Courts at Bushmaster Park

History and Council Direction

May 16th approval with the following direction for staff

Ensure the new courts (pods) are as far north as possible creating the largest distance from property line of southern properties

Remove as few trees as possible

Return to Council with City Code changes on hours of play especially into the evening, all days of the week and lighting

Courts were laid out as far north as possible given the existing amenities at the park

Tree counts along with a 1 for 1 replacement decision

Action completed on November 7, 2023, taking effect on December 7, 2023, on City Code. Updated signage in parks to follow

An outdoor basketball court with green and red surfaces, surrounded by a chain-link fence and trees. The court is empty, and the background shows a line of tall pine trees under a clear blue sky. A metal pole is visible on the left side of the frame.

Changes to the original Contract:

No longer a design-build contract with one partner

An on-call landscape architecture firm contracted for the design



Previous Contract:

8 courts (2 Pods) with lights
\$500,000

Overlay on existing courts \$420,643

Total not to exceed \$920,643



LOGAN SIMPSON



New contract with Logan Simpson Design, Inc. as the lead design firm, General Acrylics, Inc. as the constructing contractor

Scope:

8 pickleball courts with lights

Overlay on existing courts

\$58,465 expended on design services

Chartering of team – beginnings
of project management

Onsite visit with design services

Communication of direction

Bi-weekly meetings

Survey of existing conditions,
impervious surface
considerations, electrical/lighting,
do not repeat issues mentality

Due Diligence
on Design

Concept Design

Place 6 pickleball courts where existing tennis courts and create 2 new pickleball courts – locating to the north as far as possible

Create 2 new tennis courts plus make correct size

Push the basketball courts to the north plus eliminate cracking cause

1:1 on tree replacement plus **provide variety of species that does not exist today**

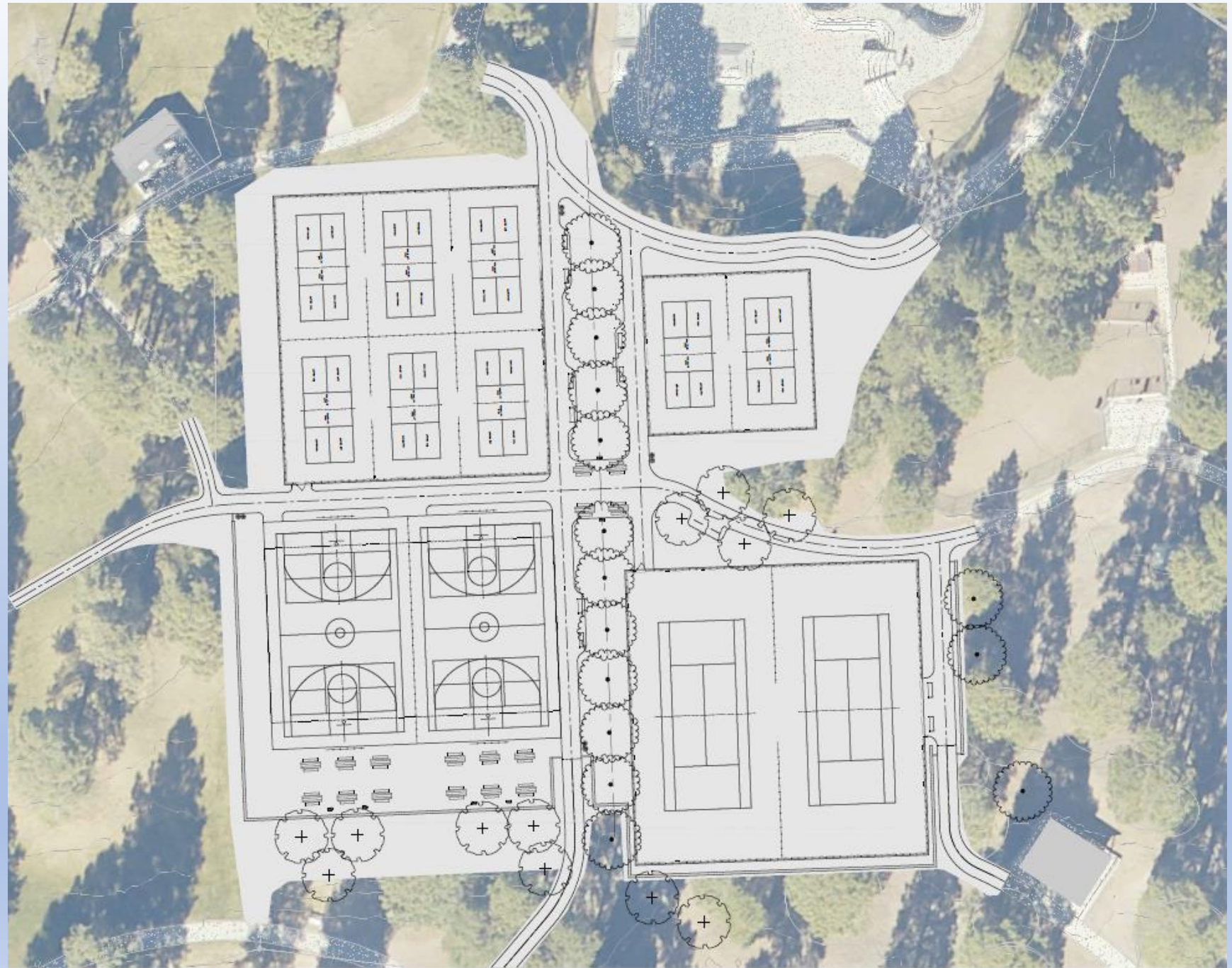

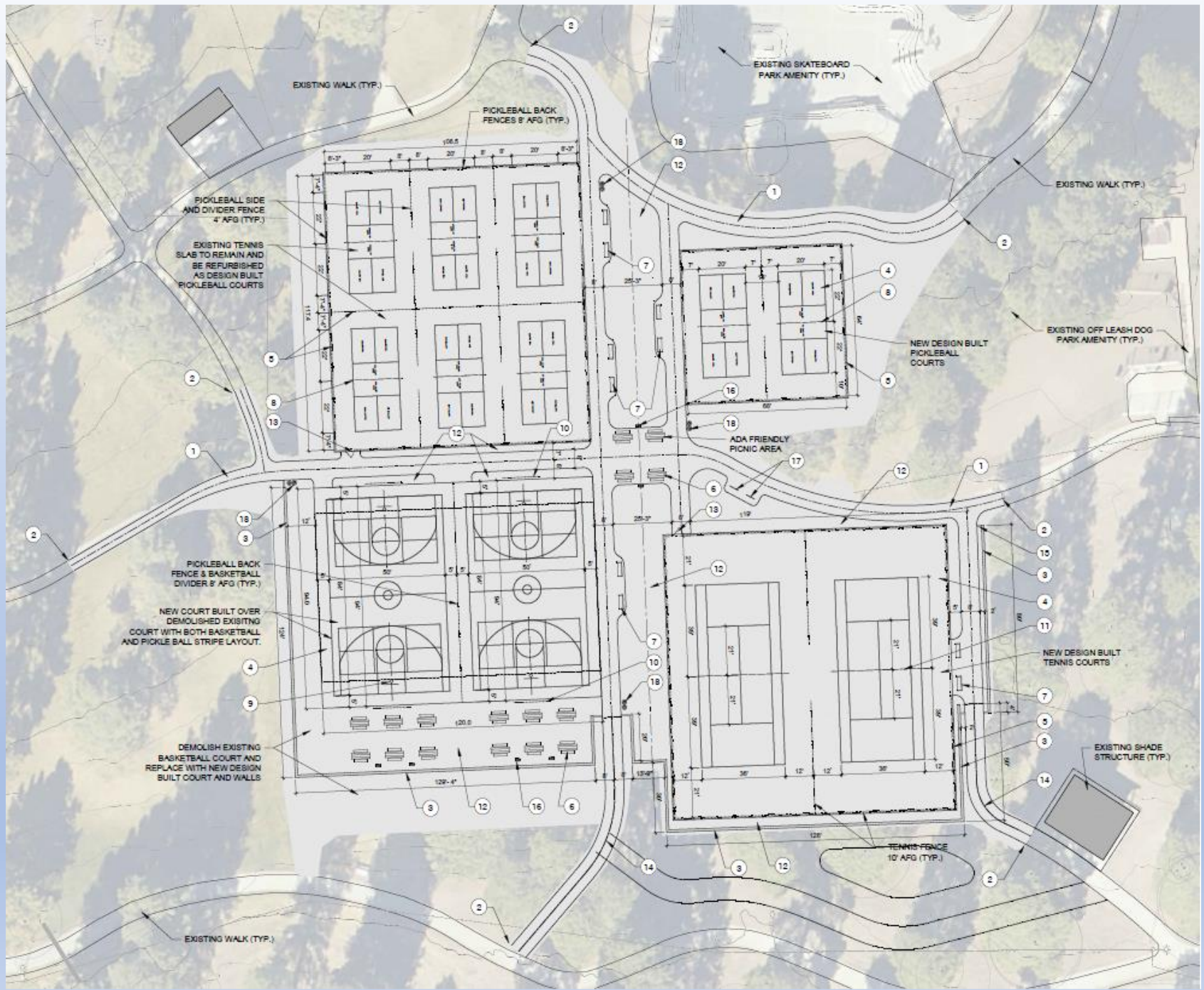



Center spine/walkway
 Central concourse

Seating opportunity
 Tree health opportunity

Center spine/walkway
Central concourse

Seating opportunity
Tree health opportunity



Correct sizing, maintenance longevity and placement, color scheme opportunities

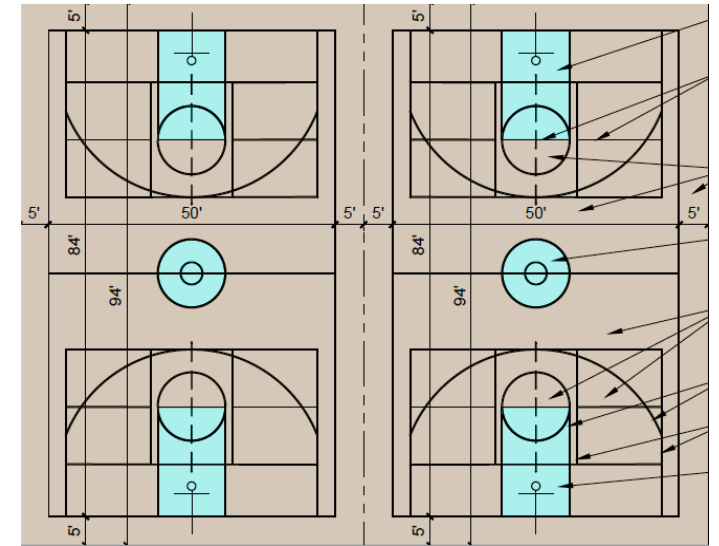
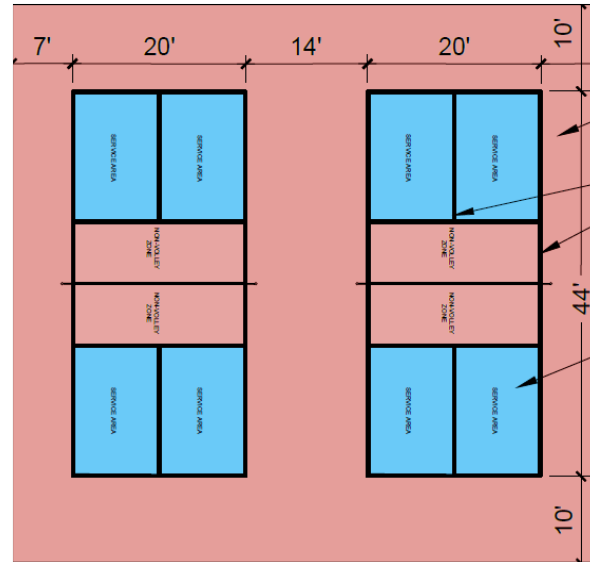
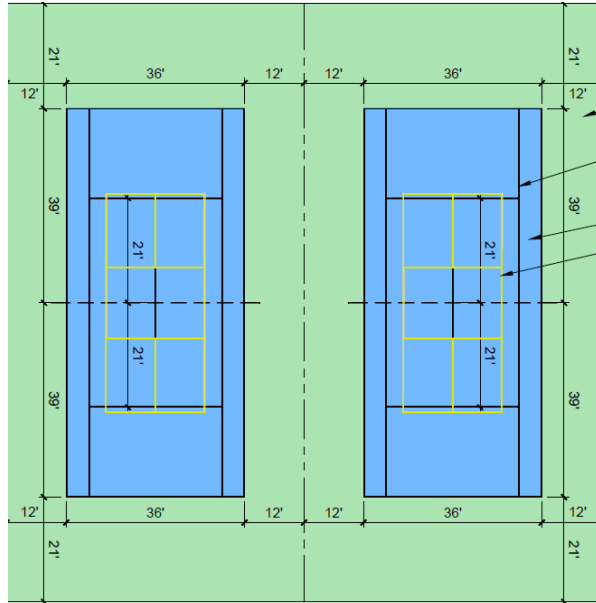



1 for 1 Tree Replacement

For the court layout 26 ponderosa pines are felled

Many are dual-trunks but counted per trunk

90% are less than 12-inch caliper

Staff determined a 1:1 replacement

Drought tolerant garner importance

Species variety holds value

Correct spacing

*Plus added shrubs and groundcover





Next Steps:

Design Review
(IDS)

Estimation of
construction
costs

Site Plan to
Construction
Documents



Current versus Post-Construction Management by PROSE

The current 8 pickleball courts (on tennis and basketball courts) have dedicated hours each day of the week of 8 AM to 12 PM

The 2 tennis courts and 2 basketball courts have dedicated hours each day of the week of 12 PM to close

There are portable nets onsite for usage for pickleball

The 8 new pickleball courts will be dedicated pickleball play

The 2 new tennis and 2 new basketball courts will be dedicated tennis/basketball play with dual striping for pickleball available for pickleball play via permit only

The portable nets will be available only via permit and during those times of the approved permit

Thank you

