

# **PUBLIC ART WALLS (PAWS)**

# WHAT ARE PUBLIC ART WALLS (PAWS)?

PAWS are newly built or existing infrastructure that is utilized as a public free use art space.

They are places where artists and the public are allowed to create in and are rooted in free thought and practice.

They are designated and protected by the City and/or State they reside in as legal spaces to create at.

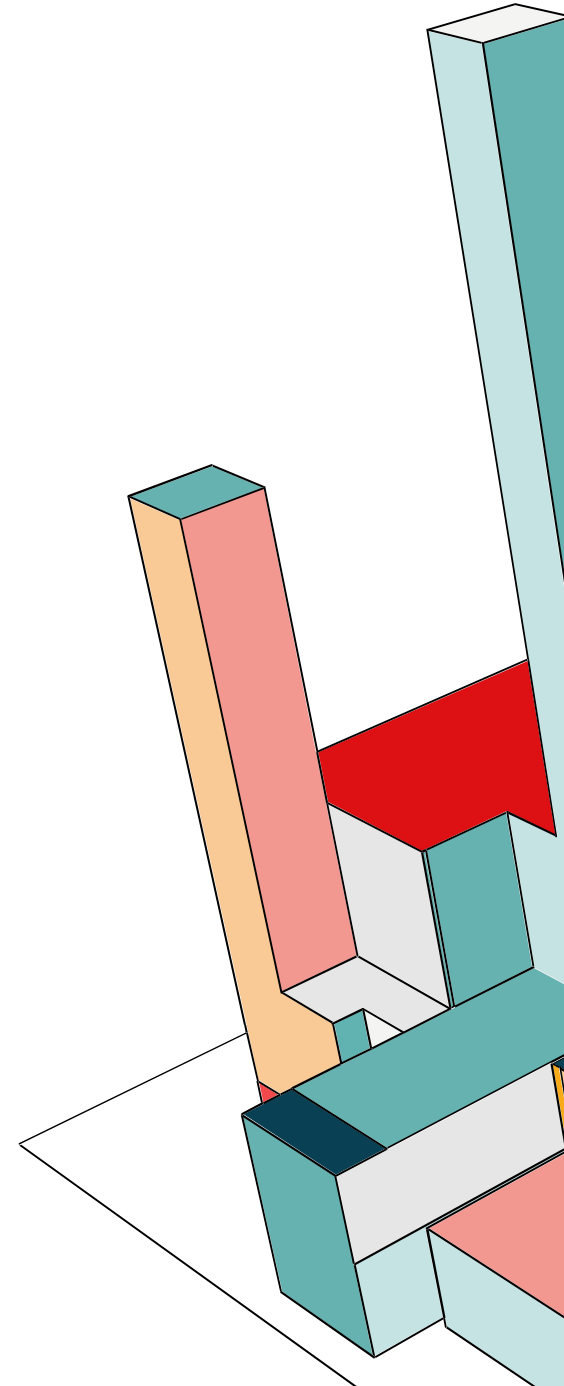

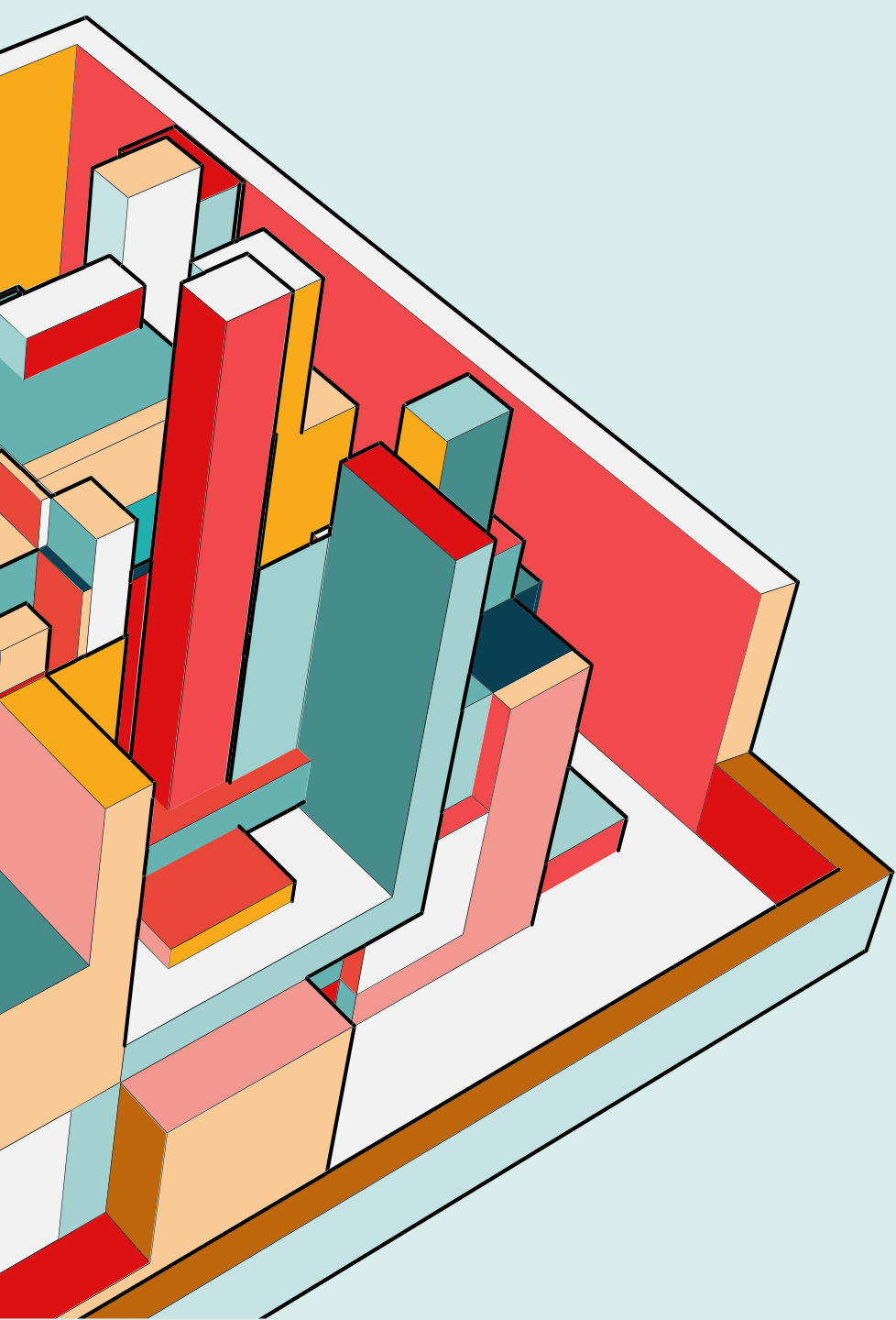

# **SANTEE PUBLIC GALLERY**

...so much more than a case study











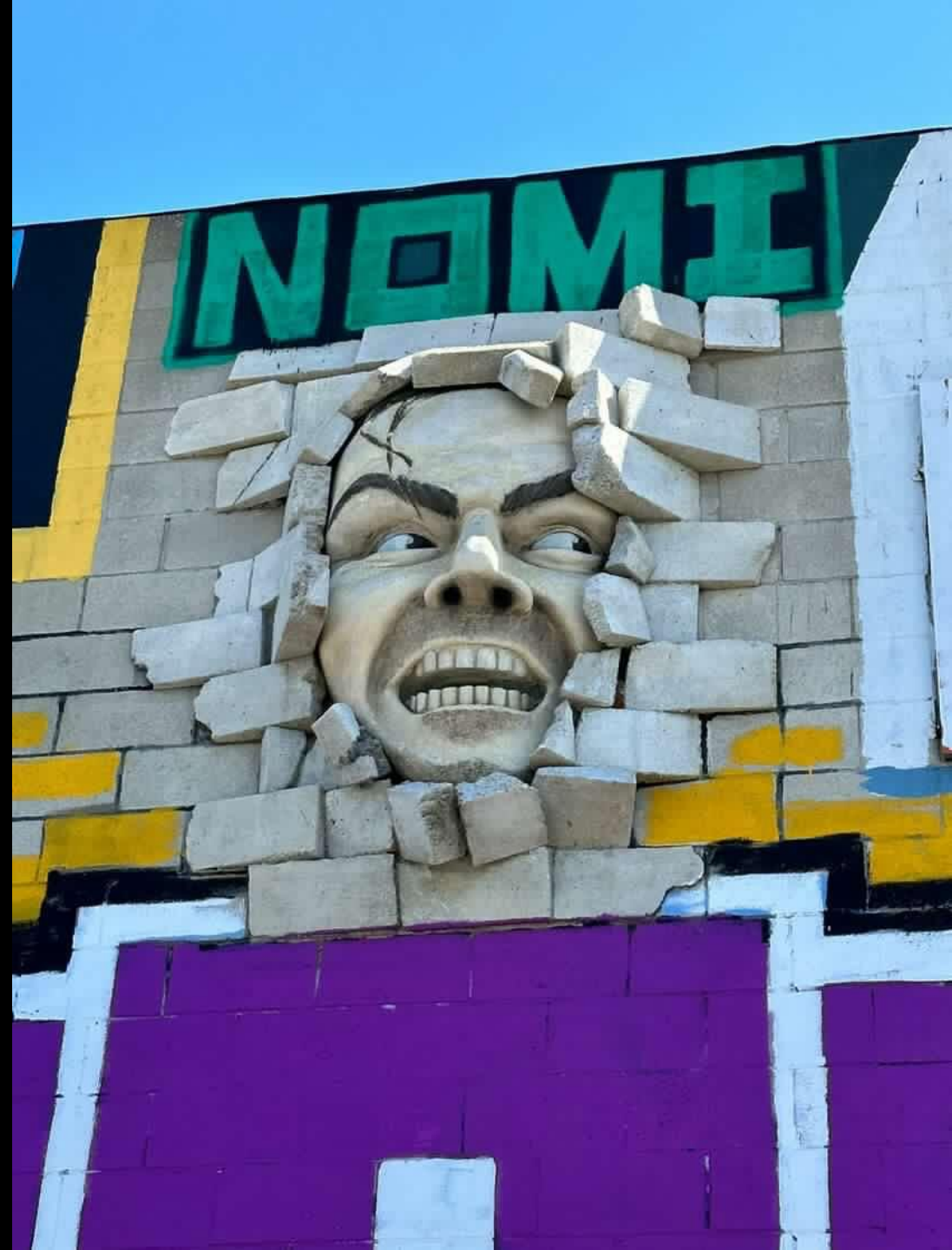

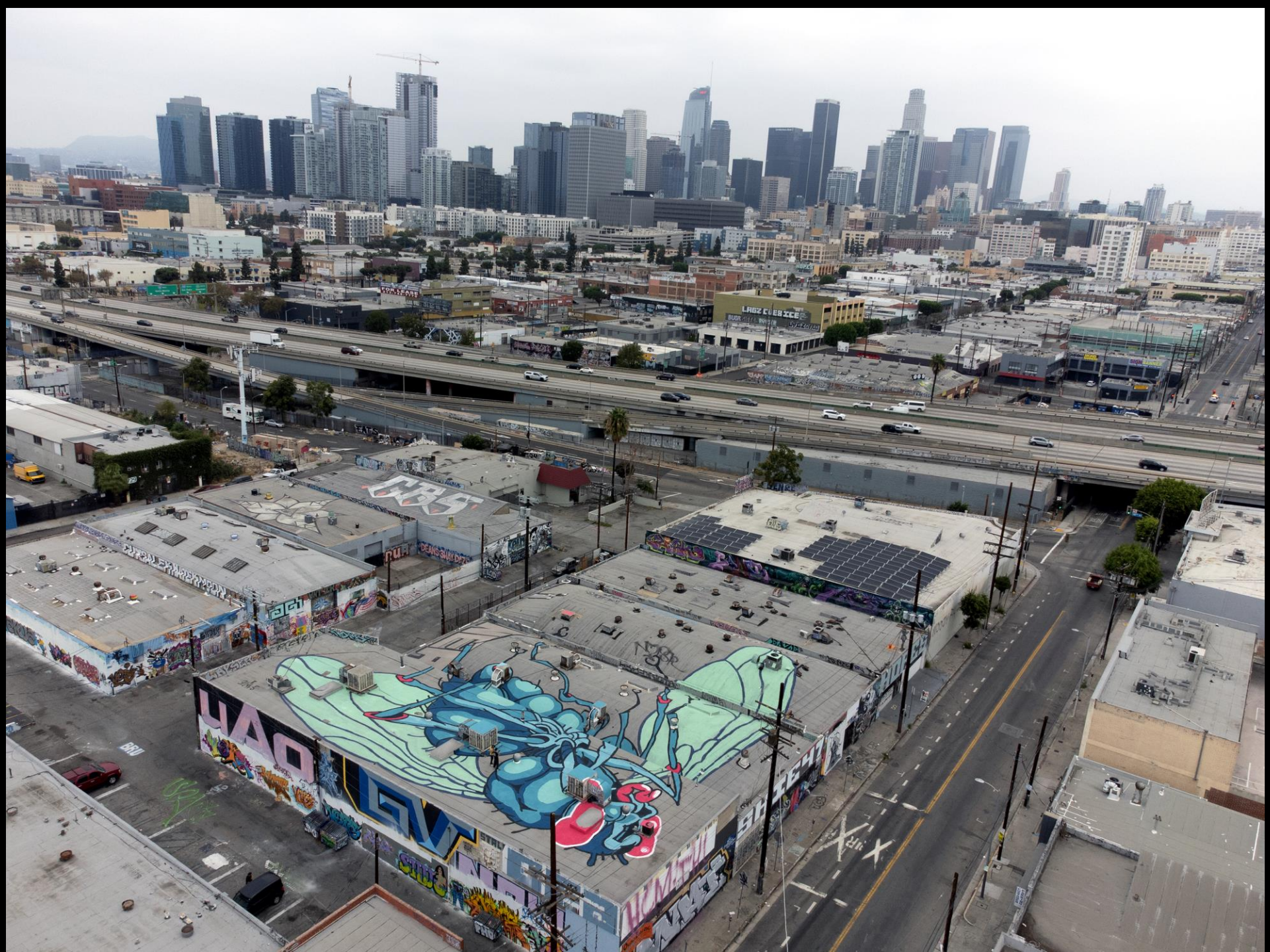

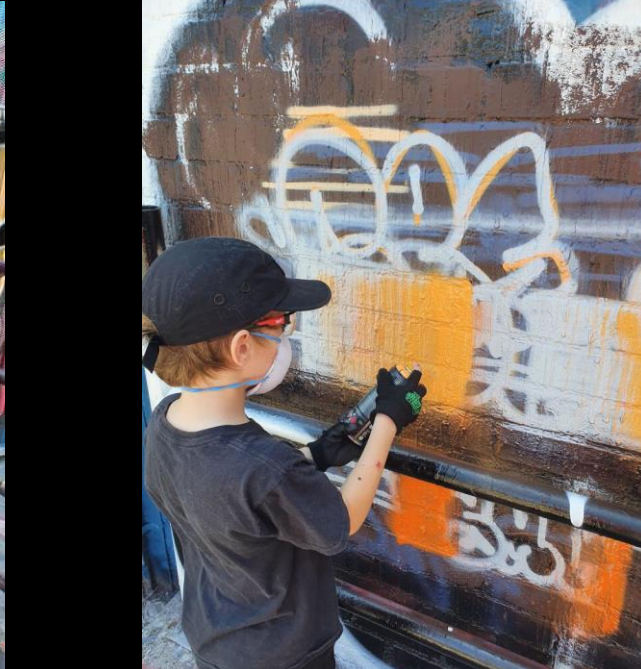
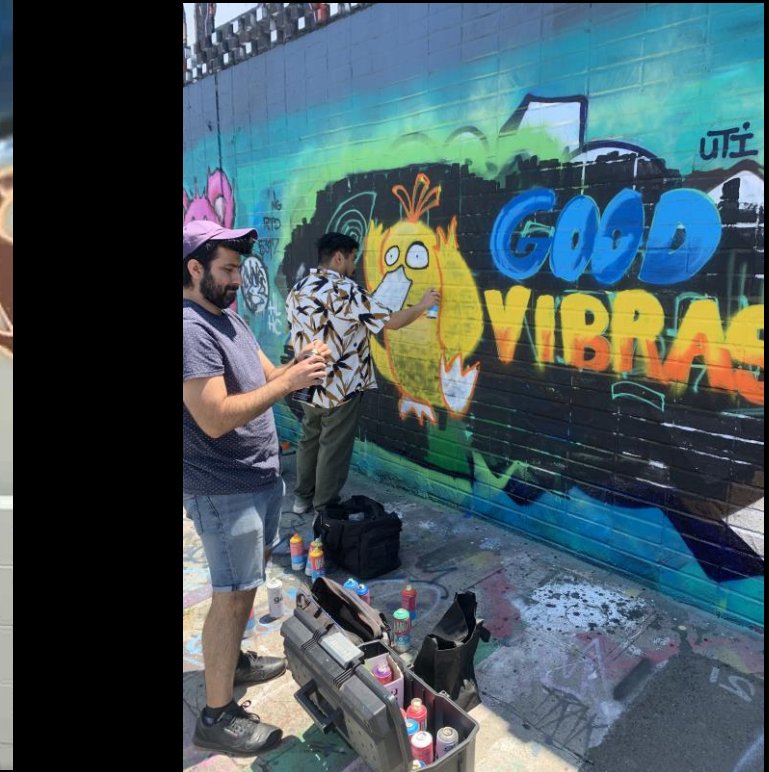
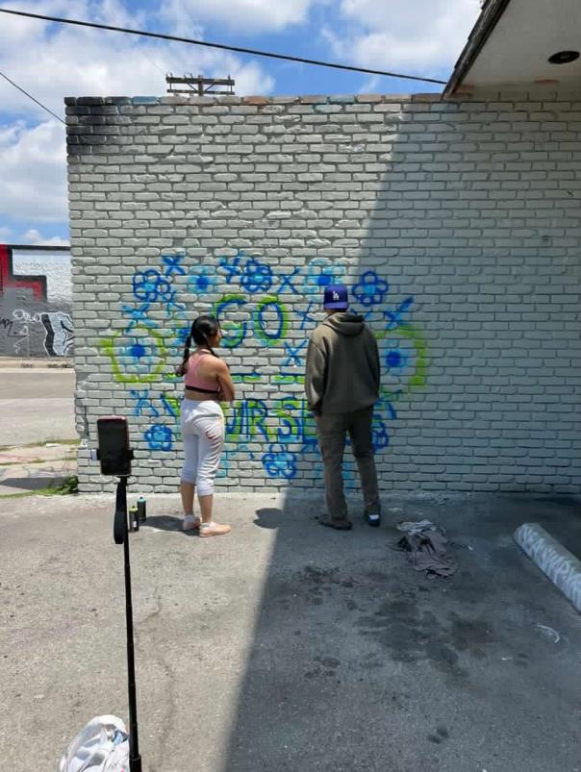

# PROPOSED SPACE IN THORPE PARK



## Thorpe Park Handball Courts

- Large wall space allows for a variety of work to be painted.
- Not many people play, so the infrastructure isn't being utilized for it's intended purpose.
- If people do use the courts, there is still space for artists to paint on the wings (shown in the next slides).

# WHAT WILL THE SPACE DO?

Allow for a free space for public art of ALL forms to exist legally.

Create a new space for art education outside of the classrooms. Programs built for children, teens and anyone willing to learn.

It will inspire a new community to form that will forge strong relationships involving artists, photographers, musicians, writers and members of the community.



# HOW WILL THIS POSITIVELY IMPACT THE COMMUNITY?

Allow artists a place to fight their addictions and manage better mental health with painting.

Give artists a legal and free opportunity to build their portfolios, thus gaining employment and greatly improving their skills.

Give artists a place to connect and network with other creatives like them.



# THANK YOU

Jason Saboury

818-876-2907

Jason.Saboury@nau.edu

@santee.public.gallery on IG

