





300 FT Buffer for 5015 E Lake Country Rd

Area of Interest (AOI) Information

Area : 658,803.12 ft²

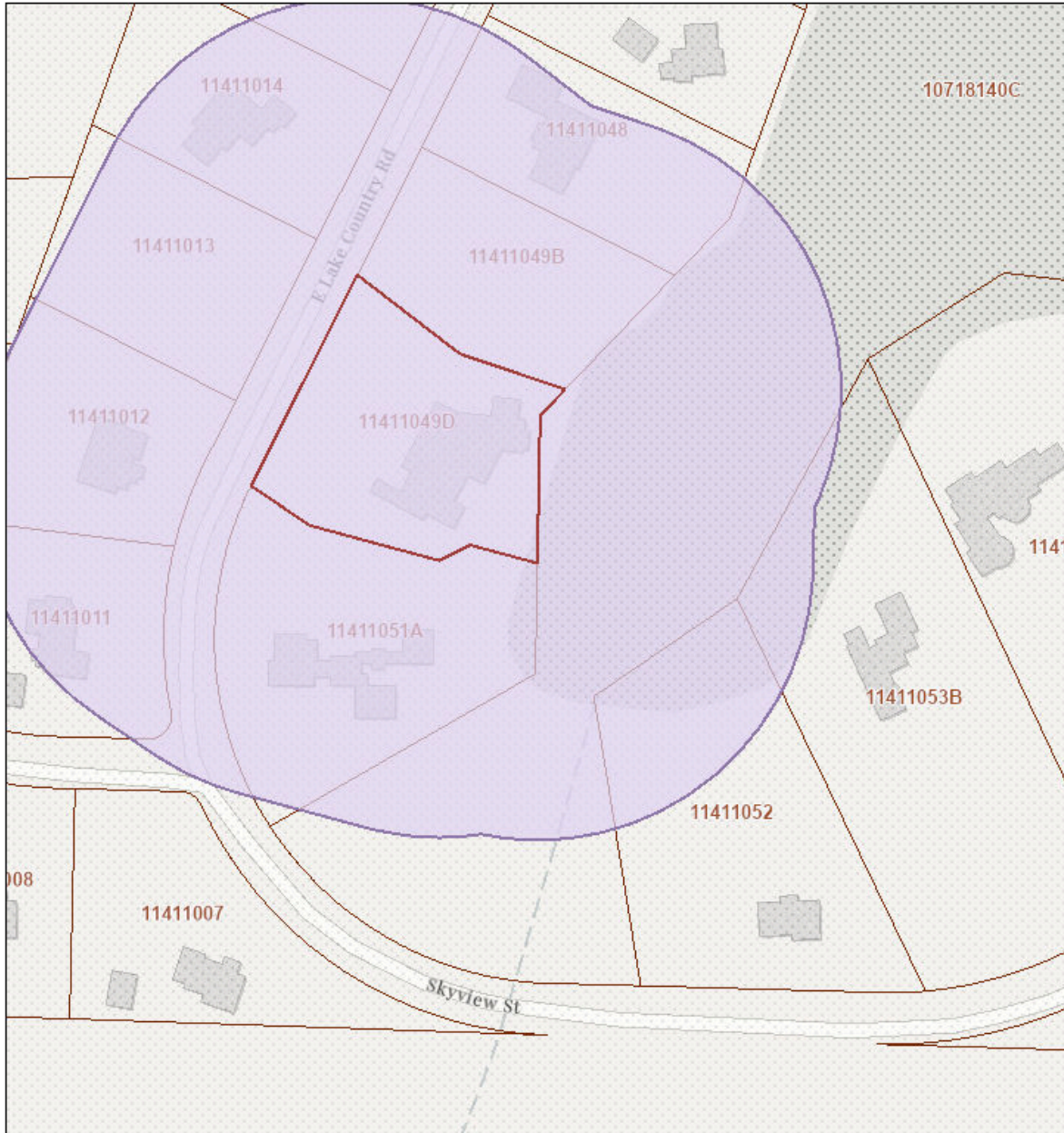
Sep 24 2024 8:36:24 GMT-07:00



 Coconino County Parcels



Tax Parcel

#	APN	Account #	Address	Owner Name	Owner Address
1	11411025	R0062540	4819 E MOUNT PLEASANT DR	CARLETON RICHARD V & KATHERINE L	4819 E MOUNT PLEASANT DR FLAGSTAFF, AZ 86004
2	11411027	R0062542	4805 E MOUNT PLEASANT DR	TRUJILLO LIVING TRUST DTD 05-14-04	4805 E MT PLEASANT DR FLAGSTAFF, AZ 86004
3	11411026	R0062541	4815 E MOUNT PLEASANT DR	DAMORE BEVERLY B & DAVID	4815 E MOUNT PLEASANT DR FLAGSTAFF, AZ 86004
4	11411015	R0047924	5040 E LAKE COUNTRY RD	GOODMAN WILLIAM & CAROLINE LIVING TRUST DTD 10-15-20	2058 E MYRNA LN TEMPE, AZ 85284
5	11411053B	R0038208	351 N SKY VIEW ST	SID HOLDINGS LLC	2532 N 4TH ST NO 278 FLAGSTAFF, AZ 86004
6	11411052	R0038207	301 N SKY VIEW ST	DRIES AMY & MICHAEL B	301 N SKY VIEW ST FLAGSTAFF, AZ 86004
7	11411011	R0059739	5000 E LAKE COUNTRY RD	SPROUTING LLC	111 E DUNLAP AVE NO 1-293 PHOENIX, AZ 85020
8	11411014	R0047923	5030 E LAKE COUNTRY RD	GUSSIO FAMILY REVOCABLE TRUST DTD 02-06-20	5030 E LAKE COUNTRY RD FLAGSTAFF, AZ 86004
9	11411048	R0038203	5035 E LAKE COUNTRY RD	NELSON CHRISTINE M FAMILY TRUST 01-21-16	PO BOX 1522 CAVE CREEK, AZ 85327
10	11411012	R0059740	5010 E LAKE COUNTRY RD	SADVARY THOMAS J & MARY C FAMILY TRUST DTD 06-08-01	7621 E WINDROSE DR SCOTTSDALE, AZ 85260
11	11411013	R0059741	5020 E LAKE COUNTRY RD	TVD FAMILY TRUST DTD 01-27-21	5020 E LAKE COUNTRY RD FLAGSTAFF, AZ 86004
12	11411049B	R0038204	5025 E LAKE COUNTRY RD	SHERWOOD SAM B & VICKI S REVOCABLE LIVING TRUST AGREEMENT DTD 06-20-95	3257 E HARMONY AVE MESA, AZ 85204
13	11411049D	R1377111	5015 E LAKE COUNTRY RD	HEBETS REVOCABLE TRUST DTD 03-28-95	2575 E CAMELBACK RD NO 700 PHOENIX, AZ 85016
14	11411051A	R1377126	5005 E LAKE COUNTRY RD	PONDEROSA PALISADE TRUST DTD 11-22-23	5005 E LAKE COUNTRY RD FLAGSTAFF, AZ 86004
15	10718140C	R1023126	2380 N OAKMONT DR	CONTINENTAL COUNTRY CLUB INC	2380 N OAKMONT DR FLAGSTAFF, AZ 86004

#	Subdivision	Parcel Area	Area Units	Sale Date	Sale Price	Area(ft ²)
1	CONTINENTAL LAKESIDE ACRES	1.610000	A	6/30/2009, 5:00 PM	680000.000000	0.17
2	CONTINENTAL LAKESIDE ACRES	1.060000	A	6/30/1996, 5:00 PM	113000.000000	372.83
3	CONTINENTAL LAKESIDE ACRES	1.050000	A	6/30/2014, 5:00 PM	625000.000000	2,602.39
4	CONTINENTAL LAKESIDE ACRES	1.290000	A	8/31/2020, 5:00 PM	720000.000000	10,745.62
5	CONTINENTAL LAKESIDE ACRES	3.140000	A	11/30/2015, 5:00 PM	1295000.000000	11,785.18
6	CONTINENTAL LAKESIDE ACRES	2.170000	A	6/30/2017, 5:00 PM	615000.000000	28,808.72
7	CONTINENTAL LAKESIDE ACRES	1.000000	A	9/30/2018, 5:00 PM	740000.000000	32,383.77
8	CONTINENTAL LAKESIDE ACRES	1.190000	A	2/28/2018, 5:00 PM	680000.000000	39,350.92
9	CONTINENTAL LAKESIDE ACRES	1.160000	A	8/31/2018, 5:00 PM	760000.000000	43,334.83
10	CONTINENTAL LAKESIDE ACRES	1.220000	A	9/30/2013, 5:00 PM	595000.000000	47,663.86
11	CONTINENTAL LAKESIDE ACRES	1.180000	A	7/31/2019, 5:00 PM	225000.000000	47,690.18
12	CONTINENTAL LAKESIDE ACRES	1.100000	A	12/31/2018, 5:00 PM	199000.000000	48,055.48
13	CONTINENTAL LAKESIDE ACRES	1.460000	A	N/A	N/A	63,565.47
14	CONTINENTAL LAKESIDE ACRES	1.840000	A	1/31/2022, 5:00 PM	1900000.000000	80,390.81
15	CONTINENTAL CC EST UNIT 01	89.260000	A	N/A	N/A	150,224.25

Permits

#	Permit Number	Area(ft ²)
1	EQ-20-0856	10,745.62
2	BD-23-0091	32,383.77
3	EQ-22-1127	32,383.77
4	EQ-19-0726	47,690.18
5	EQ-23-0765	47,690.18
6	EQ-23-0820	47,690.18
7	EQ-23-1183	47,690.18
8	EQ-23-0790	47,690.18
9	EQ-19-0949	47,690.18
10	EQ-19-0080	48,055.48
11	EQ-18-0202	48,055.48
12	EQ-21-0766	63,565.47
13	CD-21-067	63,565.47
14	EQ-22-0214	63,565.47
15	EQ-22-0036	80,390.81
16	EQ-22-0207	80,390.81
17	EQ-22-0107	80,390.81

County Supervisor

#	Supervisor District	Area(ft ²)
1	District 2	122.36
2	District 4	658,680.76

Subdivision

#	Subdivision	Area(ft ²)
1	CONTINENTAL LAKESIDE ACRES	606,974.51

These data are for general planning purposes only. No warranty of

accuracy is given or implied.