

**CULTURAL RESOURCES SURVEY OF 0.5 ACRES OF PRIVATE PROPERTY IN
FLAGSTAFF, COCONINO COUNTY, ARIZONA**

Prepared for
City of Flagstaff

Prepared by
Samuel Hemsley, M.A., RPA

Cornerstone Environmental Consulting, LLC
320 North Leroux Street, Suite A
Flagstaff, Arizona 86001

January, 2025



1. REPORT TITLE

1a. Report Title: Cultural Resources Survey of 0.5 Acres of Private Property in Flagstaff, Coconino County, Arizona

1b. Report Author(s): Samuel Hemsley, M.A., RPA

1c. Date: January 2, 2025

1d. Report Number: CEC 24-179

2. PROJECT REGISTRATION/PERMITS

2a. ASM Accession Number: NA

2b. AAA Permit Number: NA

2c. ASLD Lease Application Number(s): NA

2d. Other Permit Number(s): NA

3. ORGANIZATION/CONSULTING FIRM

3a. Name: Cornerstone Environmental Consulting, LLC (Cornerstone; CEC)

3b. Internal Project Number: CEC 24-179

3c. Internal Project Name: COF Rain Valley

3d. Contact Name: Michael Pitts

3e. Contact Address: 320 N. Leroux Street, Suite A, Flagstaff, Arizona 86001

3f. Contact Phone: (928) 522-4148

3g. Contact Email: MPitts@cornerstone-environmental.com

4. SPONSOR/LEAD AGENCY

4a. Sponsor: Private

4b. Lead Agency: City of Flagstaff

4c. Agency Project Number(s): NA

4d. Agency Project Name: NA

4e. Funding Source(s): Private

4f. Other Involved Agencies: NA

4g. Applicable Regulations: Per the City of Flagstaff Zoning Code Section 10-30.30 cultural resource studies are required for all public and private developments involving the development of undeveloped land.

5. DESCRIPTION OF PROJECT OR UNDERTAKING:

Cornerstone was contracted by Steven Terry (Client) to conduct a Class II pedestrian archaeological survey of approximately 0.5 acres of undeveloped, private land near Flagstaff in Coconino County, Arizona (Figure 1; Photograph 1; Photograph 2). The survey area consists of two small noncontiguous parcels in the vicinity of N.

Rain Valley Road. The survey was performed to comply with City of Flagstaff zoning and heritage management codes which indicate that the development of undeveloped land requires a cultural resource survey and was conducted prior to the construction of a private residence and garage. The entire survey was located on private land and only the proposed construction location was surveyed.

6. PROJECT AREA/AREA OF POTENTIAL EFFECTS:

The survey area consists of approximately 0.5 acres of private land in Flagstaff in Coconino County, Arizona located in Township 21N, Range 8E, Section 3. The project consists of two parcels in the vicinity of N. Rain Valley Road, ranging from 0.33 acres to 0.23 acres. Both parcels are entirely on private land.

7. PROJECT LOCATION

- 7a. **Address:** 6930 N. Rain Valley Rd
- 7b. **Route:** NA
- 7c. **Mileposts Limits:** NA
- 7d. **Nearest City/Town:** Flagstaff, Arizona
- 7e. **County:** Coconino
- 7f. **Project Locator UTM:** 0450636 m E / 3899611 m N
- 7g. **NAD 83**
- 7h. **Zone:** 12
- 7i. **Baseline & Meridian:** Gila & Salt River Baseline and Meridian
- 7j. **USGS Quadrangle(s):** Flagstaff East
- 7k. **Legal Description(s):** Township 21N, Range 8E, Section 3

8. SURVEY AREA

- 8a. **Total Acres:** 0.5
- 8b. **Survey Area**

1. Land Jurisdiction	2. Total Acres Surveyed	3. Total Acres Not Surveyed	4. Justification for Areas Not Surveyed
Private	0.5	NA	NA

9. ENVIRONMENTAL CONTEXTS

- 9a. **Landform:** River terrace immediately north of Rio de Flag.
- 9b. **Elevation:** 2,021 meters (6,633 feet) above sea level
- 9c. **Surrounding Topographic Features:** Rio de Flag is immediately south. The parcels are 1.2 miles east of Sheep Hill, Wildcat Hill is 1.1 miles to the southwest, and 1.81 miles northwest of Turkey Hills. The summit of Elden Mountain is 3.2 miles to the west.
- 9d. **Nearest Drainage:** The survey area is 180 feet north of Rio de Flag.

9e. Local Geology: The local geology consists of Holocene to middle Pliocene basaltic rocks (0–4 million years ago). These are volcanic igneous deposits consisting of basalt, andesite, dacite, and rhyolite. (Richard et al. 2000).

9f. Vegetation: Biotically, the area is classified as Petran Montane Conifer Forest transitioning to Plains and Great Basin Grassland (Brown 1994). Vegetation includes scattered ponderosa pine (*Pinus ponderosa*) and various grasses, forbs, and shrubs, with seasonally abundant wildflowers.

9g. Soils/Deposition: The survey area consists of Jacques clay loam soils, which are well drained and not considered suitable for prime farmland. (USDA NRCS 2008). Deposition is alluvial and is estimated to be at least 30 centimeters based off drainage depths.

9h. Buried Deposits: Buried cultural deposits are possible within the survey area.

9i. Justification: The survey area is within the floodplain of Rio de Flag, which has caused increased sediment deposition. There are numerous known cultural sites in the vicinity, and the heavy deposition could be obscuring additional cultural materials. Sites within one mile of the project area include habitation sites which have a high potential for buried cultural deposits.

10. BUILT ENVIRONMENT

The survey area is within a dispersed residential area and the surroundings include private residences, lawns, landscaping features, gardens, fencing, livestock corrals, meadows, drainages, roads, utility lines, and driveways. No houses or structures are present within the project area.

11. INVENTORY CLASS COMPLETED

11a. Class I Inventory:

11b. Researcher(s): Samuel Hemsley

11c. Class II Survey:

11d. Sampling Strategy: 100%

11e. Class III Inventory:

12. BACKGROUND RESEARCH SOURCES

12a. AZSITE:

12b. ASM Archaeological Records Office:

12c. SHPO Inventories and/or SHPO Library:

12d. NRHP Database:

12e. ADOT Portal:

12f. GLO Maps: Plat # 187957 (1879), Plat # 187961 (1904), Plat # 187963 (1915), Plat #187969 (1921),

12g. Land-Managing Agency Files: NA

12h. Tribal Cultural Resources Files: NA

12i. Local Government Websites: NA

12j. Other: USGS Topographic maps: 1886, 1891, 1894, 1899 San Francisco Mtns, AZ (1:250,000); 1908, 1912, 1947, 1954, 1958, 1960, 1962 Flagstaff, AZ (1:250,000); 1962 Flagstaff, AZ (1:24,000)

13. BACKGROUND RESEARCH RESULTS

Cornerstone personnel conducted a site file search on AZSITE to identify previous projects and sites which intersect the survey area. AZSITE records indicate no previous projects intersecting with the survey area and 13 previous projects within one mile of the survey area (Figure 2). AZSITE records identified 74 previously recorded archaeological sites within one mile, with no sites intersecting with the survey area (Figure 3). Site types within one mile of the survey area include artifact scatters, field houses, log cabins, pithouses, pueblos, masonry structures, multicomponent sites, railroads, rock art, and historic roads. At least three sites have undergone surface collection by ASM. Picture Canyon Archaeological Site (AZ I:14:346[ASM]) is listed on the NRHP (reference #07001349). A review of the Bureau of Land Management’s GLO land survey plats did not identify any features within the survey area.

13a. Previous Projects Within the Survey Area.

1. Project Reference Number	2. Project Name	3. Author(s)	4. Year
NA			

13b. Previously Recorded Cultural Resources Within the Survey Area.

1. Site Number/Name	2. Affiliation	3. Site Type	4. Eligibility Status	5. Associated Reference(s)
NA				

13c. Historic Buildings/Districts/Neighborhoods:

1. Property Name or Address	2. Year	3. Eligibility Status
NA		

14. CULTURAL CONTEXTS

14a. Prehistoric Culture: Archaic, Sinagua, Kayenta Ancestral Pueblo, Cohonina.

14b. Protohistoric Culture: Diné (Navajo), Havasupai, Hopi, Hualapai, Western Apache, Zuni.

14c. Indigenous Historic Culture: Fort Mojave Indian Tribe, Fort McDowell Yavapai Nation, Havasupai Tribe, Hualapai Tribe, Hopi Tribe, Navajo Nation, Pueblo of Zuni, San Carlos Apache Tribe, Tonto Apache Tribe, White Mountain Apache Tribe, Yavapai Apache Nation, Yavapai Prescott Indian Tribe (AZSHPO and SRP-MIC 2024).

14d. Euro-American Culture: 1542 CE to present.

15. FIELD SURVEY PERSONNEL

15a. Principal Investigator: Joshua Edwards

15b. Field Supervisor: Samuel Hemsley
 15c. Crew: NA
 15d. Fieldwork Date(s): December 23, 2024

16. SURVEY METHODS

16a. Transect Intervals: 20 m
 16b. Coverage (%): 100
 16c. Site Recording Criteria: NA, no sites recorded
 16d. Ground Surface Visibility: Visibility is good, averaging 50 percent open, with the remaining ground surface obscured by heavy vegetation and some duff.
 16e. Observed Disturbances: The survey area is within an undeveloped private lot. There is a cinder road driveway leading up to the survey area, but the survey area itself appears to be undisturbed.

17. FIELD SURVEY RESULTS

17a. No Cultural Resources Identified:
 17b. Historical In-Use Structures Identified: ; Form(s) Attached:
 17c. Number of IOs Recorded: 0
 17d. Table of IOs:

1. IO Number	2. Description	3. Date Range	4. UTM's	
			Easting	Northing
	NA			

18. COMMENTS

Cornerstone archaeologist Samuel Hemsley surveyed the 0.5-acre proposed construction location, in compliance with the requested Class II (sample) survey. Cornerstone encountered no IOs and no archaeological sites or other cultural material within the survey area.

19. ATTACHMENTS

19a. Project Location Map:
 19b. Land Jurisdiction Map:
 19c. Background Research Map(s):
 19d. GLO Map(s):
 19e. References:

20. CONSULTANT CERTIFICATION

I certify the information provided herein has been reviewed for content and accuracy and all work meets applicable agency standards.



Signature

Principal Investigator

Title

21. DISCOVERY CLAUSE

In the event that previously unreported cultural resources are encountered during ground disturbing activities, all work must immediately cease within 30 meters (100 feet) until a qualified archaeologist has documented the discovery and evaluated its eligibility for the Arizona or National Register of Historic Places in consultation with the lead agency, the SHPO, and Tribes, as appropriate. Work must not resume in this area without approval of the lead agency.

If human remains are encountered during ground-disturbing activities, all work must immediately cease within 30 meters (100 feet) of the discovery and the area must be secured. The Arizona State Museum, lead agency, SHPO, and appropriate Tribes must be notified of the discovery. All discoveries will be treated in accordance with NAGPRA (Public Law 101-601; 25 U.S.C. 3001-3013) or Arizona Revised Statutes (A.R.S. § 41-844 and A.R.S. § 41-865), as appropriate, and work must not resume in this area without authorization from ASM and the lead agency.

REFERENCES

Arizona State Museum (ASM)

1993 *Archaeological Site Recording Manual*. Arizona State Museum, University of Arizona, Tucson.

1995 *Revised Site Definition Policy*. Arizona State Museum, University of Arizona, Tucson.

Arizona State Historic Preservation Office (AZSHPO) and Salt River Pima-Maricopa Indian Community (SRP-MIC)

2024 *Government to Government Consultation Toolkit*. <https://sites.google.com/view/az-consultation-toolkit/home>. Accessed 2024.

Brown, David E. (editor)

1994 *Biotic Communities: Southwestern United States and Northwestern Mexico*. University of Utah Press, Salt Lake City.

Richard, S.M., Reynolds, S.J., Spencer, J.E., and Pearthree, P.A.

2000 Geologic Map of Arizona: Arizona Geological Survey Map 35, 1 sheet, scale 1:1,000,000.

USDA Natural Resource Conservation Service (NRCS)

2008 *SoilWeb*. Copyright Ca Soil Resource Lab,
http://casoilresource.lawr.ucdavis.edu/soil_web/kml/mapunits.kml

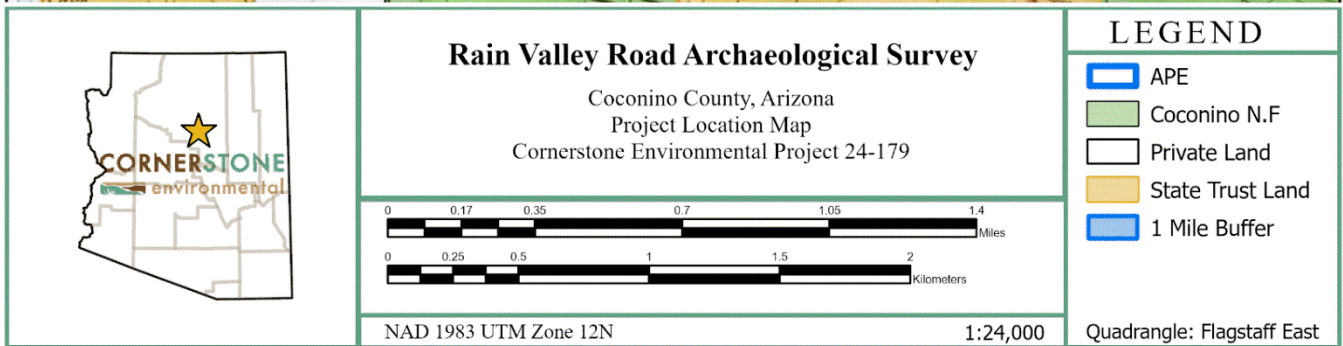
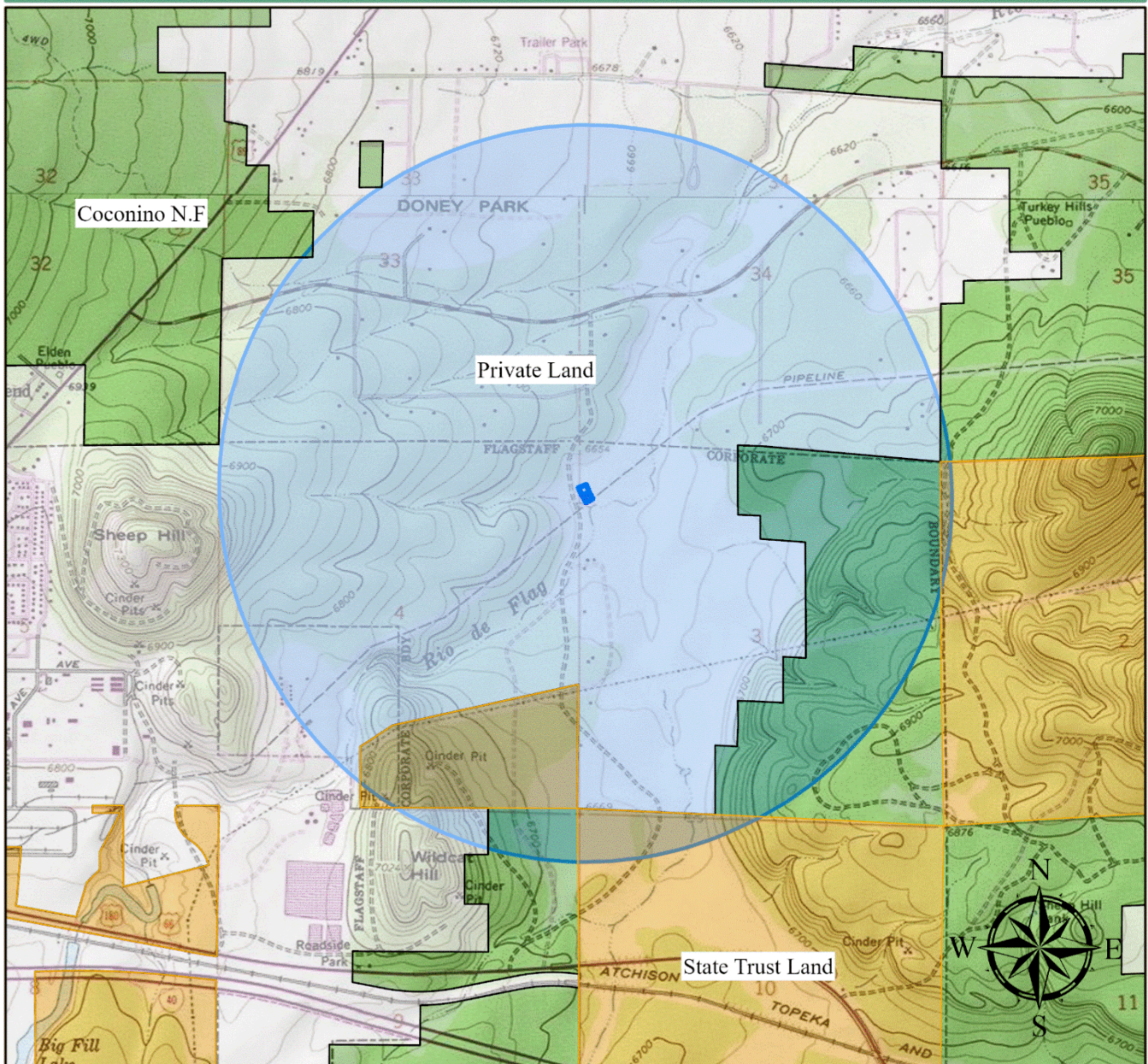
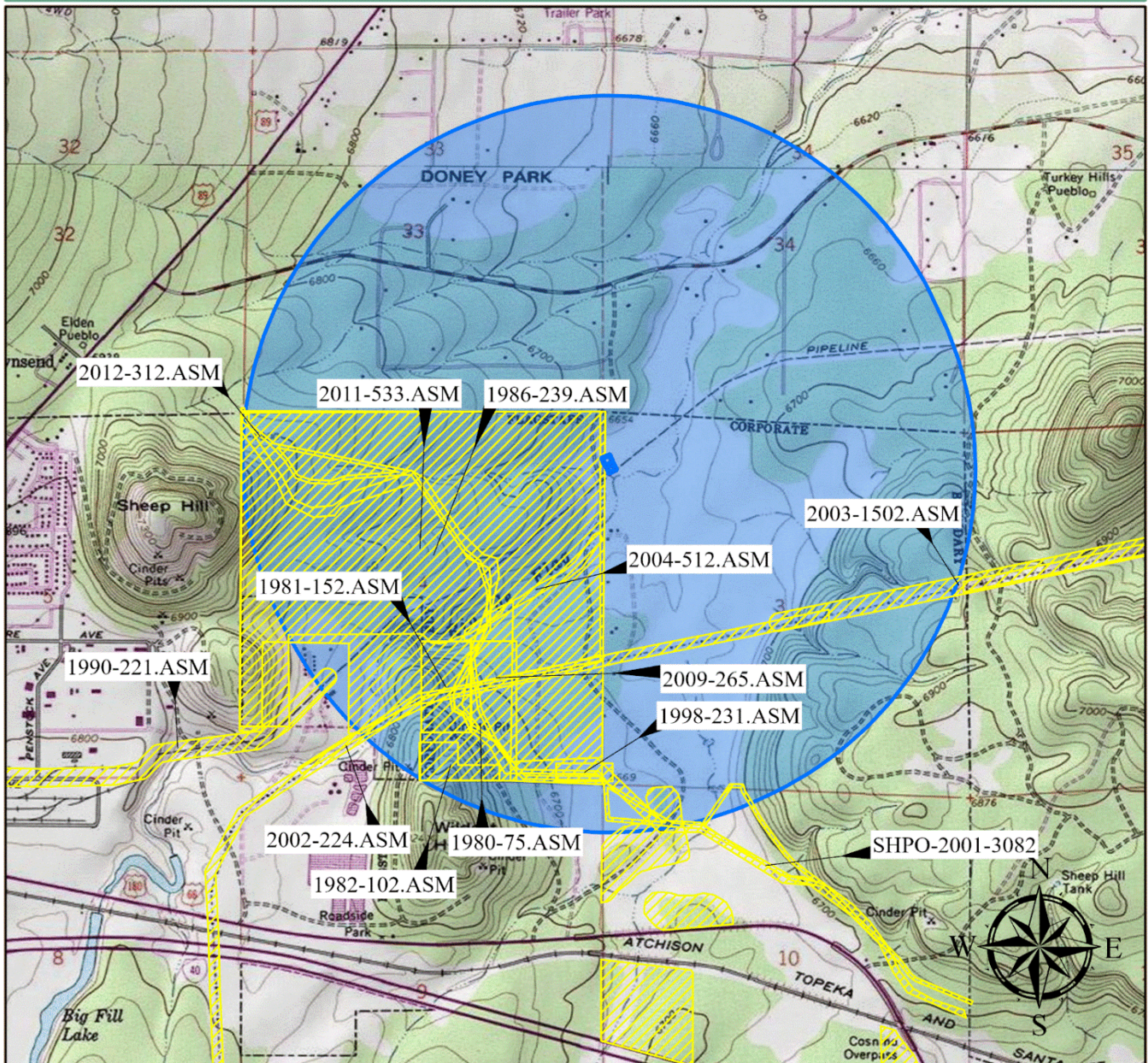
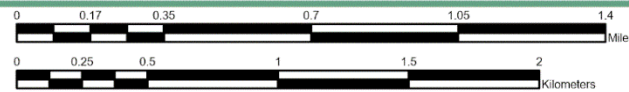

Figure 1. Topographic map showing survey area and land jurisdiction.



Rain Valley Road Archaeological Survey

Coconino County, Arizona
Previous Projects Map
Cornerstone Environmental Project 24-179



NAD 1983 UTM Zone 12N

1:24,000

LEGEND

- APE
- 1 Mile Buffer
- Projects

Quadrangle: Flagstaff East

Figure 2. Previous projects within one mile of the survey area.



Photograph 1. Project area overview, facing south.



Photograph 2. Project area overview, facing northwest.