

**LEGEND**

- EXISTING SLOPES 17-24.99%
- EXISTING SLOPES 25-34.99%
- EXISTING SLOPES >35%+
- REMOVED SLOPES 17-24.99%
- REMOVED SLOPES 25-34.99%
- LIMITS OF PROPOSED AMENITY GRADING
- AMENITY BOUNDARY
- PROJECT BOUNDARY
- JWP 126 BOUNDARY

**WOOD PATEL**

Wood, Patel & Associates, Inc.  
 Civil Engineering  
 Water Resources  
 Land Survey  
 Construction Management  
 602.335.8500  
 www.woodpatel.com



**JWP 126 PHASE 1 - AMENITY**  
**AMENITY SITE PLAN**  
 FLAGSTAFF, ARIZONA  
 NATURAL RESOURCE PROTECTION PLAN - SLOPES

REV	DESCRIPTION	DATE



PARCEL INFORMATION	FLOODPLAIN RESOURCES		<35% SLOPE RESOURCES							25-34.99% SLOPE RESOURCES					17-24.99% SLOPE RESOURCES							
	PARCEL	ACERAGE ±	ZONING	RURAL FLOODPLAIN (ACRES)	REQUIRED RURAL FLOODPLAIN PRESERVATION	TOTAL EXISTING >35% SLOPE (ACRES)	REQUIRED >35% PRESERVATION RATE	REQUIRED >35% SLOPE (ACRES)	DISTURBED >35% SLOPE (ACRES)	PRESERVED >35% SLOPE (ACRES)	PRESERVATION RATE %	TOTAL EXISTING 25-34.99% SLOPE (ACRES)	REQUIRED 25-34.99% PRESERVATION RATE	REQUIRED 25-34.99% SLOPE (ACRES)	DISTURBED 25-34.99% SLOPE (ACRES)	PRESERVED 25-34.99% SLOPE (ACRES)	PRESERVATION RATE %	TOTAL EXISTING 17-24.99% SLOPE (ACRES)	REQUIRED 17-24.99% PRESERVATION RATE	REQUIRED 17-24.99% SLOPE (ACRES)	DISTURBED 17-24.99% SLOPE (ACRES)	PRESERVED 17-24.99% SLOPE (ACRES)
AMENITY	0	RR-RPO	0	100%	0	100%	0	0	0	100%	0.293	80%	0.2344	0.038	0.255	87%	4.188	70%	2.9316	1.201	2.987	71%

Z:\2022\225329\DWG\Pre\_Plan\Plan\Golf Concept Block\_Plan\225329-005-Slopes-PP.dwg

EXPIRES 09-30-25  
 SCALE (HORIZ.) 1" = 200'  
 SCALE (VERT.) N/A  
 DATE 8/07/2025  
 JOB NUMBER 225329  
 SHEET 5 OF 6

CHECKED BY: DC DESIGNED BY: DC DRAFTED BY: LT

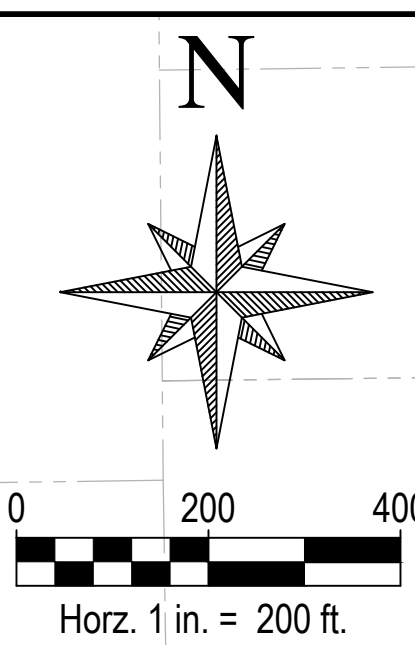

**WOOD PATEL**  
 Wood, Patel & Associates, Inc.  
 Civil Engineering  
 Water Resources  
 Land Survey  
 Construction Management  
 602.335.8500  
 www.woodpatel.com



**JWP 126 PHASE 1 - AMENITY**  
**AMENITY SITE PLAN**  
 FLAGSTAFF, ARIZONA  
 NATURAL RESOURCE PROTECTION PLAN - FOREST

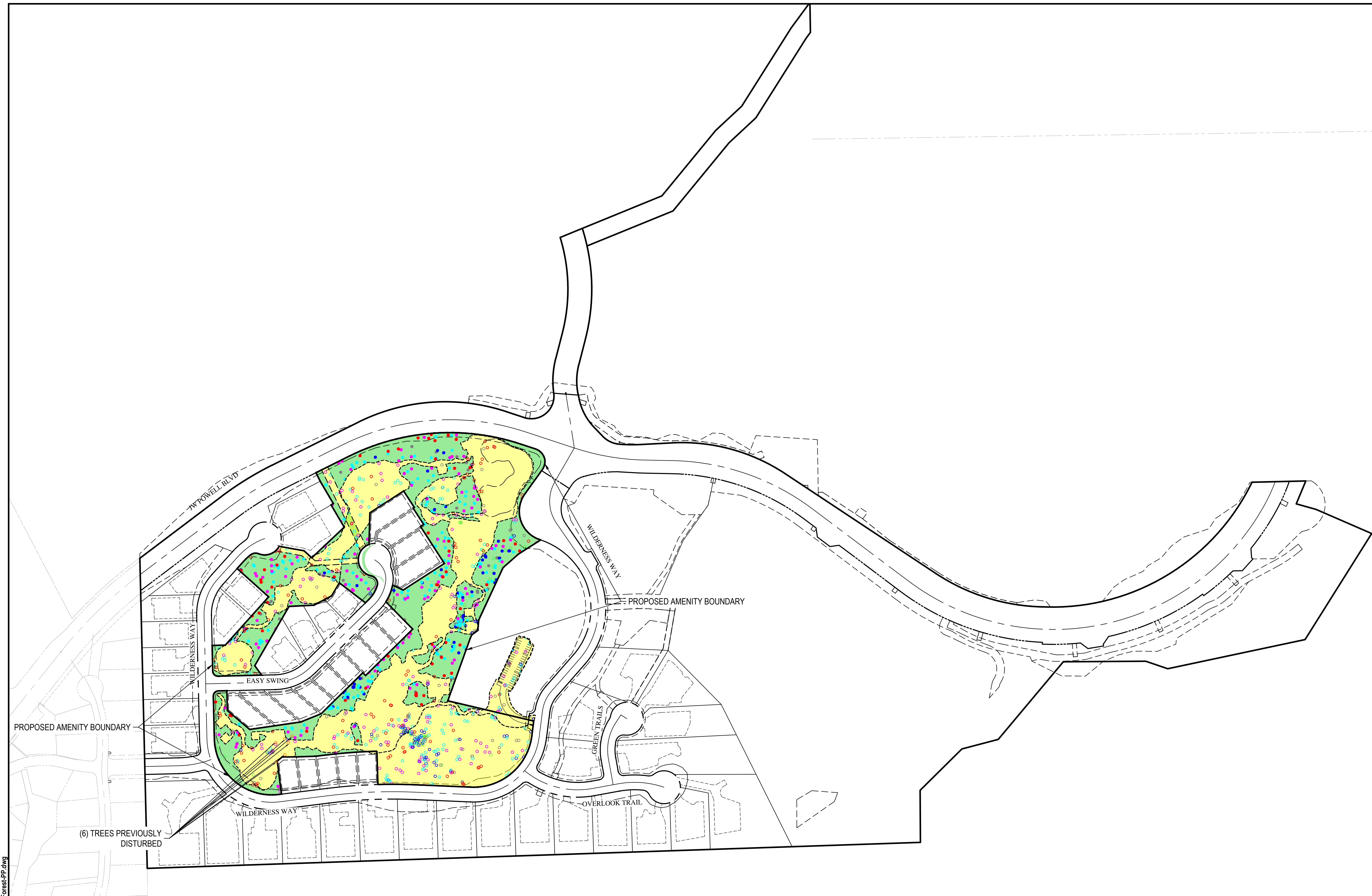

**FOREST RESOURCE POINTS**

TOTAL EXISTING TREE POINTS WITHIN GOLF TRACT AND PARKING AREA: 8,062  
 PROPOSED DISTURBED TREE POINTS WITHIN GOLF TRACT AND PARKING AREA: 2,469  
 PLUS (6) PREVIOUSLY DISTURBED TREES (8" DBH @ 1 POINT EA) = 6 POINTS  
 TOTAL DISTURBED TREE POINTS: 2,547  
 TOTAL PRESERVED TREE POINT PERCENTAGE: **68%** (8,062 - 2,547 = **5,515**)  
 FOREST RESOURCE PROTECTION WILL COMPLY WITH FOREST MANAGEMENT PLAN  
 STANDARDS OF CITY OF FLAGSTAFF.

- APPROXIMATE LIMITS OF DISTURBANCE
- APPROXIMATE LIMIT OF PRESERVED AREAS
- AMENITY BOUNDARY
- LIMITS OF PROPOSED AMENITY GRADING
- LIMITS OF DISTURBANCE

**LEGEND**

- 0 POINT UNDISTURBED TREE (< 6 IN. DBH)
- 0 POINT DISTURBED TREE (< 6 IN. DBH)
- 1 POINT PREVIOUSLY DISTURBED TREE (6-8 IN. DBH)
- 1 POINT UNDISTURBED TREE (6-8 IN. DBH)
- 1 POINT DISTURBED TREE (6-8 IN. DBH)
- 2 POINT UNDISTURBED TREE (9-12 IN. DBH)
- 2 POINT DISTURBED TREE (9-12 IN. DBH)
- 4 POINT UNDISTURBED TREE (13-17 IN. DBH)
- 4 POINT DISTURBED TREE (13-17 IN. DBH)
- 8 POINT UNDISTURBED TREE (18-24 IN. DBH)
- 8 POINT DISTURBED TREE (18-24 IN. DBH)
- 20 POINT UNDISTURBED TREE (> 25 IN. DBH)
- 20 POINT DISTURBED TREE (> 25 IN. DBH)

REV	DESCRIPTION	DATE

EXPIRES 08-30-25  
 SCALE (HORIZ.) 1" = 200'  
 SCALE (VERT.) N/A  
 DATE 8/07/2025  
 JOB NUMBER 225329  
 SHEET 6 OF 6

Z:\2022\225329\DWG\Pre\_Plan\Plan\Golf Concept Block\_Plan\329-006-Forest-PP.dwg