

December 2, 2025

Tim Kinney
121 E. Birch Ave, Suite 500
Flagstaff, AZ 86001
(928) 779-2820 x805
via email: tk@kinneyconstruction.net

Re: Cultural resource study letter report of 5 acres of an approximate 37-acre parcel (Parcel No. 111-02-004V) at 2100 N Kramer Street, Flagstaff, Arizona.

Dear Mr. Kinney,

EnviroSystems Management, Inc. (EnviroSystems or ESM) conducted a Class III Cultural Resources Inventory of 5 acres of private land for Tim Kinney in Coconino County, Arizona. The remaining 32 acres will remain undisturbed and undeveloped. To ensure that there were no cultural resources that would be impacted, 10.8 acres was surveyed to create a buffer around the 5-acre area being developed. The project was conducted in advance of proposed residential construction at 2100 North Kramer Street in Flagstaff, Arizona. The cultural study is necessary per Flagstaff Zoning Code 10-30.30.050 because the undeveloped property has not been previously surveyed and known cultural resources are located within the vicinity. The 5-acre parcel is located within the SE $\frac{1}{4}$ of Section 5, Township 21 North, Range 7 East of the Gila & Salt River Baseline and Meridian, Flagstaff, Coconino County, Arizona (Assessor's Parcel Number 111-02-004V). EnviroSystems' conducted background research and ESM archaeologists Ryan Wyser and Mitchell Cleveland conducted a pedestrian survey of the parcel on November 26, 2025.

Environmental Setting

The project area is located on the northeastern end of Observatory Mesa, just south of the Cheshire residential community and southwest of the Museum of Northern Arizona, both located along U.S. Route 180 (aka, Fort Valley Road) (*Figure 1*). A large, unnamed drainage is located immediately west of the parcel. Observatory Mesa is located within the Rocky Mountain (Petran) Conifer Forest Biotic Community (Brown 1995). Overstory vegetation within the parcels primarily includes open Ponderosa Pine (*Pinus ponderosa sp.*) with an understory of mullein on the northern portion of the project area and moderately dense grasses and forbs throughout (*Photograph 1*). The ground surface is primarily composed of "Pachic Argiustolls, Typic Halustaffs, and Lithic Hasplustepts; cool mesic ustic mountains" (NRCS 2025). These are comprised of cobbly silt loam above gravelly clay, loam, and bedrock derived from eroded basalt, forming hills. A relatively modern roadbed runs through the eastern portion of the project area toward a water tank. The road is no longer in use and small boulders have been placed across its surface to block access to it. The northern portion of the project area has commanding views of Humphreys Peak (*Photograph 2*).



Photograph 1. Project overview from southwest corner of property, facing northeast.



Photograph 2. Project overview with Humphreys Peak in the background, facing north.

Background Research

EnviroSystems consulted the AZSITE database for information pertaining to previous cultural resource investigations and recorded sites. Several small previous projects have been completed within 1 mile of Parcel Number 1111-02-004V (*Figure 2, Table 1*), but no previous investigations have been conducted on or adjacent to the current project area. No known archaeological sites are located within or adjacent to the project area; however, several sites are located within 1 mile of the proposed project area (see *Figure 2, Table 2*). Previously documented sites would not be affected by the proposed development.

Table 1. Previous Cultural Resources Inventories within 1 Mile of Parcel Number 1111-02-004V

Project Reference Number	Project Name	Author(s)	Year
1988-99.ASM	Schultz Wash Survey	Maldonado	1988
1990-221.ASM	EPNG SAN JAN PIPELINE EXPANSION	Dosh & Dechambre	1991a, 1991b
1994-164.ASM	FLAGSTAFF RESERVOIR	Wenker	1994
1997-355.ASM	US 180 N. of Flagstaff, MP 216-219.6	Spalding	1997
2003-659.ASM	US 180 - Sechrist School - Fremont Drive	Breen	2003
2003-847.ASM	Fort Valley Road and Davies Way	Davis & Hohmann	2003
2004-716.ASM	US 180 Flagstaff Multi-use Path	Breen	2004
2006-690.ASM	Schultz Pass Meadows Proposed Utilities	Dosh	2006
2008-236.ASM	Flagstaff Loop Trail Two Segments Inventory	Newsome	2008
2012-390.ASM	FUTS Signage Grant Cultural Resources Evaluation	Thomas & Newsome	2012
2012-618.ASM	US 180; Columbus Avenue-Snow Bowl	Bowler	2012
2013-79.ASM	Observatory Mesa Archaeological Survey	Edwards et al.	2013
2021-407.ASM	Pioneer Museum Survey	Pitts & De Santiago	2022
2022-335.ASM	Pipeline Fire EWP 2022b	Whetstone	2022

Table 2. Previously Documented Sites within 1 Mile of Parcel Number 1111-02-004V

Site Number/Name	Affiliation	Site Type	Eligibility Status	Associated Reference(s)
AZ I:14:5(ASM)/ Beale Wagon Road	Euro-American	Beale Wagon Road	Eligible with Ineligible portions	see Wisniewski (2023)*
AZ I:14:327(ASM)/ Flagstaff City Reservoir	Euro-American	City Reservoir	Recommended Eligible	Wenker (1994)
AZ I:14:437(ASM)	Euro-American	Can Dump	Not eligible (SHPO concurrence 7/3/2012 & 10/23/2020)	Edwards et al. (2013)
AZ I:14:438(ASM)	Euro-American	Refuse scatter	Not eligible (SHPO concurrence 7/3/2012 & 10/23/2020)	Edwards et al. (2013)
AZ I:14:521(ASM)	Native Archaeological Culture	Artifact Scatter	Recommended Eligible	Pitts & De Santiago (2022)
AZ I:14:522(ASM)	Euro-American	Multi-Component	Not eligible (SHPO concurrence 8/8/2022)	Whetstone (2022)
AZ I:14:523(ASM)	Euro-American	Earthen reservoir	Not eligible (SHPO concurrence 8/8/2022)	Whetstone (2022)

Site Number/Name	Affiliation	Site Type	Eligibility Status	Associated Reference(s)
AZ Q:7:74(ASM)/ US 180	Euroamerican	Highway (in use with abandoned segments)	Recommended Eligible with ineligible segments	Bowler (2012)
NA279	No Data	Mound	No Data	No Data
NA287	Native Archaeological Culture	Ceramic Scatter	Not eligible (SHPO concurrence 3/28/2018)	No Data
NA1199	No Data	No Data	No Data	No Data
NA1985	Native Archaeological Culture	Ceramic Scatter	No Data	No Data
NA15312	Euro-American	Spring and house	No Data	Documented by Richards (1977)
NA16331	Euro-American	Residence with spring and spring house	Not Evaluated (SHPO concurrence 2/21/2014)	Documented by Gallager & Weaver in 1978
NA19882	No Data	Lithic Scatter	No Data	Farnsworth, et al. in 1978
NA19985	Northern Sinagua	Habitations	No Data	Documented by "STS" in 1987
NA20814	No Data	No Data	No Data	No Data

*Although the Beale Wagon Road is depicted in AZSITE passing within 1 mile of the current project area, no portion within the study area has been documented as an archaeological site; Wisniewski (2023) offers the most comprehensive overview of all previously documented portions of the site in the surrounding area within the Coconino National Forest.

EnviroSystems also consulted General Land Office land patent and plat map records for Township 21 North, Range 7 East and Township 22 North, Range 7 East. The original GLO survey plat map of Township 21, North, Range 7 East from 1878 depicts a "sheep pen" in Section 5 near a spring at a location currently called The Narrows, about a half mile north-northeast of the current project area. The original GLO survey for Township 22 North, Range 7 East from 1895 depicts the "Road from Grand Canon to Flagstaff (now State Route 189) about 1 mile to the north of the property. None of the remaining 22 GLO plats depict any historic resources within one mile of the property.

Fieldwork

The pedestrian survey was conducted on November 26, 2025, employing transects spaced no more than 15 meters apart. The entire 5-acre parcel was surveyed by ESM archaeologists. No archaeological sites, historic properties, or Isolated Occurrences of cultural material were found within or adjacent to the proposed development.

Summary and Management Recommendations

On behalf of Mr. Kinney, EnviroSystems conducted a cultural resource study in advance of proposed residential construction on 5 acres of an approximate 37-acre parcel (Parcel No. 111-02-004V) at 2100 N Kramer Street, Flagstaff, Arizona. This work was completed prior to development to meet compliance with Flagstaff Zoning Code 10-30.30.050. EnviroSystems conducted background research and a pedestrian survey of the entire project area. No cultural resources were identified. In the absence of significant cultural resources, EnviroSystems recommends the proposed development will have no effect on cultural resources in or surrounding the project area. If you need any additional information or clarification, please do not hesitate to contact Dave Hart at (928) 226-0236 or dhart@esmaz.com.

Respectfully,



David R. Hart
Vice President / Cultural Resources Division Director

References Cited

Bowler, Maggie R.

2012 *A Cultural Resources Survey of 59.15 Acres along US Highway 180, within and outside ADOT Right-of-way, between milepost 216.20 and milepost 224.06, in Flagstaff, Coconino County, Arizona.* Report no. AZG0907-099. AZTEC Engineering, Phoenix. (2012-618.ASM)

Breen, Judith

2004 *A Cultural Resources Survey of 1.5 Acres of a Proposed Temporary Construction Easement for a Pathway along US 180 between Mileposts 216.18 and 217.30, Flagstaff, Coconino County, Arizona.* Logan Simpson Design, Inc. Technical Report No. 035027. Tempe, Arizona. (2004-716.ASM)

2003 *A Cultural Resources Survey of 3.0 Acres of Proposed New Right-of-Way and Temporary Construction Easements for a Multi-Use Path along US 180 between Mileposts 217.20 and 218.40, Flagstaff, Coconino County, Arizona.* LSD Technical Report No. 025042. Logan Simpson Design, Inc., Tempe. (2003-659.ASM)

Brown, David E. (editor)

1995 *Biotic Communities Southwestern United States and Northwestern Mexico.* University of Utah Press, Salt Lake City.

Davis, Margaret "Peg", and John W. Hohmann

2002 *A Class III Archaeological Survey of 0.3 Acres for a Cellular Tower at Fort Road and Davies Way, Flagstaff, Coconino County, Arizona.* The Louis Berger Group, Inc. Cultural Resource Division Clearance Report No. 412. Phoenix, Arizona. (2003-847.ASM)

Dosh, Steven G.

2006 *Cultural Resources Survey for Proposed Utilities Within The US Highway 180 Right-of-Way for the Schultz Pass Meadows Subdivision North of Flagstaff, Coconino County, Arizona.* Northland Research, Inc., Flagstaff. (2006-690.ASM)

Dosh, Steven G. and David J. Dechambre

1991a *Archaeological Survey Report, El Paso Natural Gas Company, San Juan Mainline Expansion, West Half: Flagstaff to Topock.* Northland Research, Inc., Flagstaff. (1990-221.ASM)

1991b *Archaeological Survey Report, El Paso Natural Gas Company, San Juan Mainline Expansion, East Half: Navajo Indian Reservation.* Northland Research, Inc., Flagstaff. (1990-221.ASM)

Edwards, Joshua S., Michael O'Hara, Ted Tsouras, and Leszek Pawlowicz

2013 *A Cultural Resource Survey of 2,260 Acres on Observatory Mesa in Flagstaff, Coconino County, Arizona.* Report no. 13-101. Cornerstone Environmental Consulting, Flagstaff, Arizona. (2013-79.ASM)

Maldonado, Ronald P.

1988 *An Archaeological Survey of 4450 Feet for a Proposed Road Widening – Schultz Wash Project.* Cultural and Environmental Systems. LOCATION. (1988-99.ASM)

Natural Resources Conservation Service (NRCS)

2025. Web Soil Survey. Website, <https://websoilsurvey.sc.egov.usda.gov/App/HomePage.htm>, accessed November 26, 2025.

Newsome, Daniel

2008 *Cultural Resources Inventory of Two Segments of the Proposed Flagstaff Loop Trail Across Arizona State Trust Land, Coconino County, Arizona.* EnviroSystems Management Project and Report No. 1383-08. EnviroSystems Management, Inc., Flagstaff. (2008-236.ASM)

Pitts, Michael and Edlin De Santiago.

2022 *Archaeological Survey of 2.94 Acres for the Pioneer Museum in Flagstaff, Arizona.* Report No. 21-138. Cornerstone Environmental Consulting, LLC, Flagstaff, Arizona. (2021-407.ASM)

Spalding, Nathanael

1997 *An Archaeological Survey of a Portion of the US 180 Right-of- Way, Milepost 216.0 to 219.6, and a Temporary Construction Easement Parcel, North of Flagstaff, Coconino County, Arizona.* Plateau Mountain Desert Research Project PMDR-96-13-18, Flagstaff. (1997-355.ASM)

Thomas, Anne R. and Daniel K. Newsome

2012 *Cultural Resources Evaluation for the Flagstaff Urban Trail System Signage Project, Coconino County, Arizona.* Report No. 1603-11. EnviroSystems Management, Inc., Flagstaff. (2012-390.ASM)

Wenker, Chris T.

1994 *A Cultural Resources for the City of Flagstaff 50-Million-Gallon Reservoir Rehabilitation.* Flagstaff, AZ: SWCA, Inc.(1994-164.ASM)

Whetstone, Tanner.

2022 *Class III Cultural Resources Survey of 20 Acres of City of Flagstaff Land for the Natural Resources Conservation Service Pipeline Fire EWP 2022b.* Flagstaff Field Office, Flagstaff, Arizona. (2022-335.ASM)

Wisniewski, Pete

2023 *In Search of Where the Rocks Were Moved: An Archaeological Inventory and Cultural Resources Clearance Report for the Beale Wagon Road and Grand Canyon Stage Historic Routes, and Monitoring Prep for Wing Mtn. and Hochderffer Task Order Timber Offerings.* CNF, Flagstaff Ranger District (2022-58A).

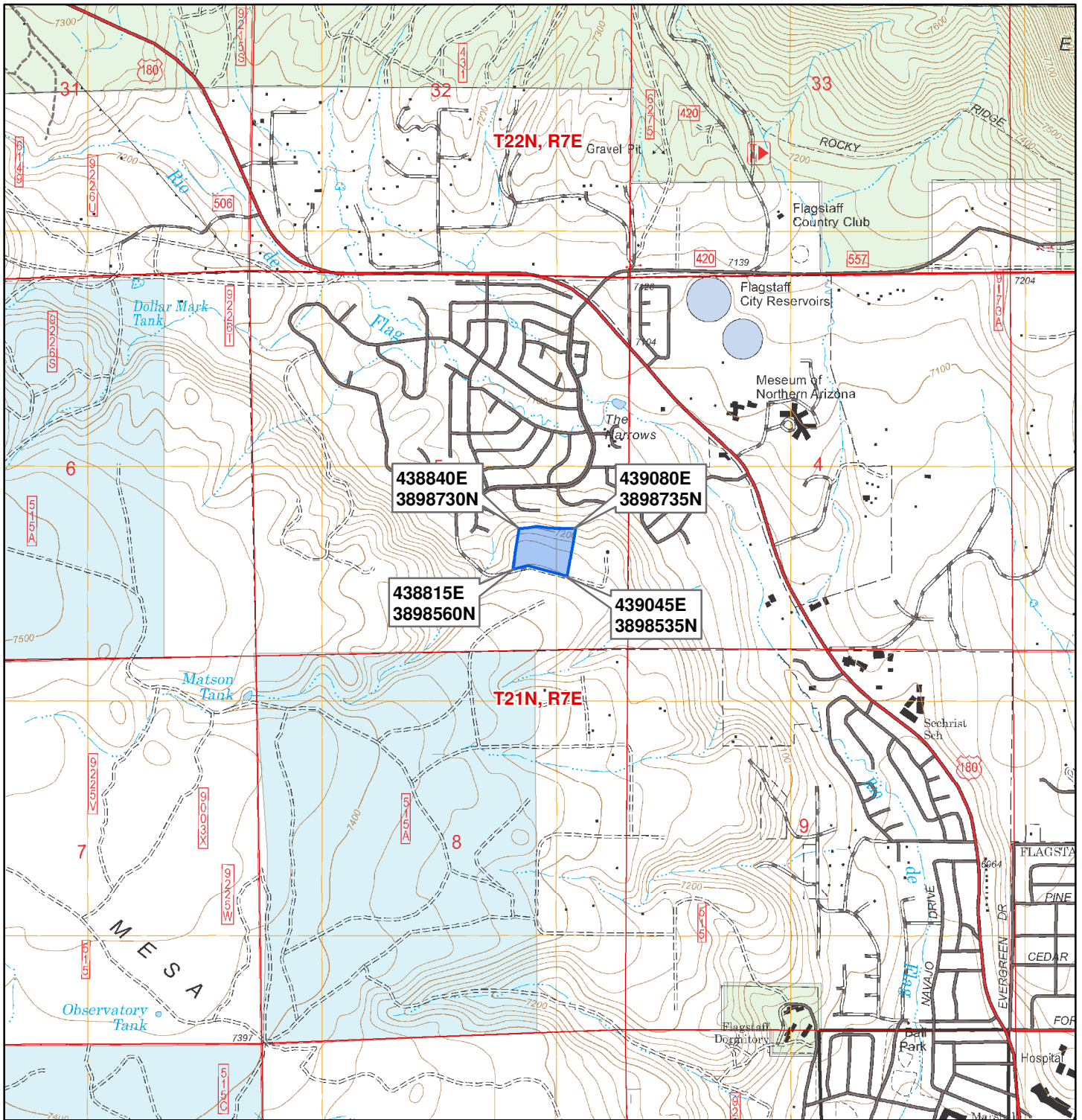

**2100 N Kramer St
Cultural Resources Inventory**
EnviroSystems Project No. 2315-25
Figure 1. Project area.



1:24,000

Legend

- Project area
- Private
- State
- US Forest Service

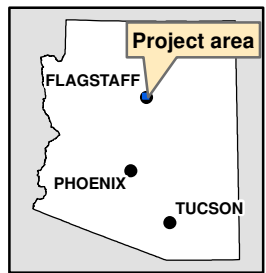

0 0.25 0.5 Miles



0 0.25 0.5 Kilometers



Base map is Flagstaff West, AZ (2017), USGS 7.5' quadrangle.

