

**PROPERTY RECORD CARD**

SP Pine Creek Village LP Record: 1 of 14  
 Property Identification

<<Prev Next >> Spec.Assmnt Taxes Exemptions Permits Home Print

Site Address: 1110 N 29th St  
 Sec/Town/Range: 05:35S :40E  
 Map ID: 24/05S  
 Zoning: R4

ParcelID: 2404-608-0120-000-9  
 Account #: 16788  
 Use Type: M-F >= 10U  
 City/Cnty: Fort Pierce



**Ownership and Mailing**

Owner: SP Pine Creek Village LP  
 Address: 2430 Estancia Blvd Ste 101  
 Clearwater FL 33761

**Legal Description**

GARDEN CITY FARMS 05 35 40 TRACT79-LESS N 25 FT- AND N 1/2 OF TRACT 82-LESS RD R/W- (OR 3443-2263)

**Sales Information**

Date	Price	Code	Deed	Book/Page
10/11/2012	5000000	0118	SP	3443 / 2263
9/18/2000	3100000	01	WD	1329 / 0116
9/14/2000	3100000	00	WD	1329 / 0106
9/24/1992	605000	00	DE	0808 / 2008

**Assessment 2013**

2013 Final:	3444600
Assessed:	3444600
Ag.Credit:	0
Exempt:	
Taxable:	
Taxes:	88041.59

**Total Land and Building**

Land Value:	810000	Acres:	6.66
Building Value:	2634600	Finished Area:	81452 SqFt

**BUILDING INFORMATION**

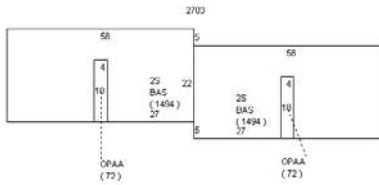

**Exterior Features**

View:	-	RoofCover:	FS - Fibrglss Shg	RoofStruct:	GA - Gable
ExtType:	LITC - Lithc Apart	YearBlt:	1971	Frame:	-
Grade:	C - C	EffYrBlt:	1971	PrimeWall:	BP - Conc Block
StoryHght:	0020 - 2 Story	No.Units:	107	SecWall:	-

**Interior Features**

BedRooms:	214	Electric:	MX - MAXIMUM	PrmIntWall:	DW - Drywall
FullBath:	0	HeatType:	FHA - FrcdHotAir	AvgHt/FI:	
1/2Bath:	0	HeatFuel:	ELEC - Electric	Prm.Flors:	CU - Carpet
%A/C:	100	%Heated:	100	%Sprinkled:	0

**Special Features and Yard Items**

Type	Y/S	Qty.	Units	Qual.	Cond.	YrBlt.	No.	Use Type	Type	Measure	Depth
ASP2 - ASP2 LOW	Y	1	67000	AV	AV	1971	1	0300-M-F >= 10U	107 -Unit	108	
CNC2 - CONCRETE LOW	Y	1	10500	AV	AV	1971					
FEN6 - CHAINLINK 6'	Y	1	1600	AV	AV	1971					

**Land Information**

THIS INFORMATION IS BELIEVED TO BE CORRECT AT THIS TIME BUT IT IS SUBJECT TO CHANGE AND IS NOT WARRANTED.

**PROPERTY RECORD CARD**

SP Pine Creek Village LP Record: 2 of 14  
Property Identification

<<Prev Next >> Spec.Assmnt Taxes Exemptions Permits Home Print

Site Address: 1110 N 29th St  
Sec/Town/Range: 05:35S :40E  
Map ID: 24/05S  
Zoning: R4

ParcelID: 2404-608-0120-000-9  
Account #: 16788  
Use Type: M-F >= 10U  
City/Cnty: Saint Lucie County



**Ownership and Mailing**

Owner: SP Pine Creek Village LP  
Address: 2430 Estancia Blvd Ste 101  
Clearwater FL 33761

**Legal Description**

GARDEN CITY FARMS 05 35 40 TRACT79-LESS N 25 FT- AND N 1/2 OF TRACT 82-LESS RD R/W- (OR 3443-2263)

**Sales Information**

Date	Price	Code	Deed	Book/Page
10/11/2012	5000000	0118	SP	3443 / 2263
9/18/2000	3100000	01	WD	1329 / 0116
9/14/2000	3100000	00	WD	1329 / 0106
9/24/1992	605000	00	DE	0808 / 2008

**Assessment 2013**

2013 Final:	3444600
Assessed:	3444600
Ag.Credit:	0
Exempt:	
Taxable:	
Taxes:	88041.59

**Total Land and Building**

Land Value:	810000	Acres:	
Building Value:	2634600	Finished Area:	81452 SqFt

**BUILDING INFORMATION**

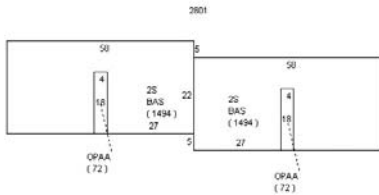

**Exterior Features**

View:	-	RoofCover:	FS - Fibrglss Shg	RoofStruct:	GA - Gable
ExtType:	LITC - Lithc Apart	YearBlt:	1971	Frame:	-
Grade:	C - C	EffYrBlt:	1971	PrimeWall:	BP - Conc Block
StoryHght:	0020 - 2 Story	No.Units:	8	SecWall:	-

**Interior Features**

BedRooms:	16	Electric:	MX - MAXIMUM	PrmIntWall:	DW - Drywall
FullBath:	0	HeatType:	FHA - FrcdHotAir	AvgHt/FI:	
1/2Bath:	0	HeatFuel:	ELEC - Electric	Prm.Flors:	CU - Carpet
%A/C:	100	%Heated:	100	%Sprinkled:	0

**Special Features and Yard Items**

Type	Y/S	Qty.	Units	Qual.	Cond.	YrBlt.	No.	Use Type	Type	Measure	Depth
							1	0300-M-F >= 10U	107 -Unit	108	

**Land Information**

THIS INFORMATION IS BELIEVED TO BE CORRECT AT THIS TIME BUT IT IS SUBJECT TO CHANGE AND IS NOT WARRANTED.

**PROPERTY RECORD CARD**

SP Pine Creek Village LP Record: 3 of 14  
 Property Identification

<<Prev Next >> Spec.Assmnt Taxes Exemptions Permits Home Print

Site Address: 1110 N 29th St  
 Sec/Town/Range: 05:35S :40E  
 Map ID: 24/05S  
 Zoning: R4

ParcelID: 2404-608-0120-000-9  
 Account #: 16788  
 Use Type: M-F >= 10U  
 City/Cnty: Saint Lucie County



**Ownership and Mailing**

Owner: SP Pine Creek Village LP  
 Address: 2430 Estancia Blvd Ste 101  
 Clearwater FL 33761

**Legal Description**

GARDEN CITY FARMS 05 35 40 TRACT79-LESS N 25 FT- AND N 1/2 OF TRACT 82-LESS RD R/W- (OR 3443-2263)

**Sales Information**

Date	Price	Code	Deed	Book/Page
10/11/2012	5000000	0118	SP	3443 / 2263
9/18/2000	3100000	01	WD	1329 / 0116
9/14/2000	3100000	00	WD	1329 / 0106
9/24/1992	605000	00	DE	0808 / 2008

**Assessment 2013**

2013 Final:	3444600
Assessed:	3444600
Ag.Credit:	0
Exempt:	
Taxable:	88041.59

**Total Land and Building**

Land Value:	810000	Acres:	
Building Value:	2634600	Finished Area:	81452 SqFt

**BUILDING INFORMATION**

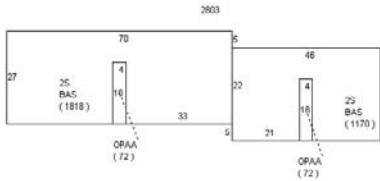

**Exterior Features**

View:	-	RoofCover:	FS - Fibrglss Shg	RoofStruct:	GA - Gable
ExtType:	LITC - Lithc Apart	YearBlt:	1971	Frame:	-
Grade:	C - C	EffYrBlt:	1971	PrimeWall:	BP - Conc Block
StoryHght:	0020 - 2 Story	No.Units:	8	SecWall:	-

**Interior Features**

BedRooms:	16	Electric:	MX - MAXIMUM	PrmIntWall:	DW - Drywall
FullBath:	0	HeatType:	FHA - FrcdHotAir	AvgHt/FI:	
1/2Bath:	0	HeatFuel:	ELEC - Electric	Prm.Flors:	CU - Carpet
%A/C:	100	%Heated:	100	%Sprinkled:	0

**Special Features and Yard Items**

Type	Y/S	Qty.	Units	Qual.	Cond.	YrBlt.
------	-----	------	-------	-------	-------	--------

**Land Information**

No.	Use Type	Type	Measure	Depth
1	0300-M-F >= 10U	107 -Unit	108	

THIS INFORMATION IS BELIEVED TO BE CORRECT AT THIS TIME BUT IT IS SUBJECT TO CHANGE AND IS NOT WARRANTED.

**PROPERTY RECORD CARD**

SP Pine Creek Village LP Record: 4 of 14  
 Property Identification

<<Prev Next >> Spec.Assmnt Taxes Exemptions Permits Home Print

Site Address: 1110 N 29th St  
 Sec/Town/Range: 05:35S :40E  
 Map ID: 24/05S  
 Zoning: R4

ParcelID: 2404-608-0120-000-9  
 Account #: 16788  
 Use Type: M-F >= 10U  
 City/Cnty: Saint Lucie County



**Ownership and Mailing**

Owner: SP Pine Creek Village LP  
 Address: 2430 Estancia Blvd Ste 101  
 Clearwater FL 33761

**Legal Description**

GARDEN CITY FARMS 05 35 40 TRACT79-LESS N 25 FT- AND N 1/2 OF TRACT 82-LESS RD R/W- (OR 3443-2263)

**Sales Information**

Date	Price	Code	Deed	Book/Page
10/11/2012	5000000	0118	SP	3443 / 2263
9/18/2000	3100000	01	WD	1329 / 0116
9/14/2000	3100000	00	WD	1329 / 0106
9/24/1992	605000	00	DE	0808 / 2008

**Assessment 2013**

2013 Final:	3444600
Assessed:	3444600
Ag.Credit:	0
Exempt:	
Taxable:	
Taxes:	88041.59

**Total Land and Building**

Land Value:	810000	Acres:	
Building Value:	2634600	Finished Area:	81452 SqFt

**BUILDING INFORMATION**

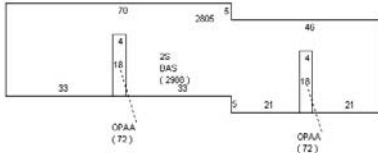

**Exterior Features**

View:	-	RoofCover:	FS - Fibrglss Shg	RoofStruct:	GA - Gable
ExtType:	LITC - Lithc Apart	YearBlt:	1971	Frame:	-
Grade:	C - C	EffYrBlt:	1971	PrimeWall:	BP - Conc Block
StoryHght:	0020 - 2 Story	No.Units:	8	SecWall:	-

**Interior Features**

BedRooms:	16	Electric:	MX - MAXIMUM	PrmIntWall:	DW - Drywall
FullBath:	0	HeatType:	FHA - FrcdHotAir	AvgHt/FI:	
1/2Bath:	0	HeatFuel:	ELEC - Electric	Prm.Flors:	CU - Carpet
%A/C:	100	%Heated:	100	%Sprinkled:	0

**Special Features and Yard Items**

Type	Y/S	Qty.	Units	Qual.	Cond.	YrBlt.
1						

**Land Information**

No.	Use Type	Type	Measure	Depth
1	0300-M-F >= 10U	107 -Unit	108	

THIS INFORMATION IS BELIEVED TO BE CORRECT AT THIS TIME BUT IT IS SUBJECT TO CHANGE AND IS NOT WARRANTED.

**PROPERTY RECORD CARD**

SP Pine Creek Village LP Record: 5 of 14  
Property Identification

<<Prev Next >> Spec.Assmnt Taxes Exemptions Permits Home Print

Site Address: 1110 N 29th St  
Sec/Town/Range: 05:35S :40E  
Map ID: 24/05S  
Zoning: R4

ParcelID: 2404-608-0120-000-9  
Account #: 16788  
Use Type: M-F >= 10U  
City/Cnty: Saint Lucie County



**Ownership and Mailing**

Owner: SP Pine Creek Village LP  
Address: 2430 Estancia Blvd Ste 101  
Clearwater FL 33761

**Legal Description**

GARDEN CITY FARMS 05 35 40 TRACT79-LESS N 25 FT- AND N 1/2 OF TRACT 82-LESS RD R/W- (OR 3443-2263)

**Sales Information**

Date	Price	Code	Deed	Book/Page
10/11/2012	5000000	0118	SP	3443 / 2263
9/18/2000	3100000	01	WD	1329 / 0116
9/14/2000	3100000	00	WD	1329 / 0106
9/24/1992	605000	00	DE	0808 / 2008

**Assessment 2013**

2013 Final:	3444600
Assessed:	3444600
Ag.Credit:	0
Exempt:	
Taxable:	
Taxes:	88041.59

**Total Land and Building**

Land Value:	810000	Acres:	
Building Value:	2634600	Finished Area:	81452 SqFt

**BUILDING INFORMATION**

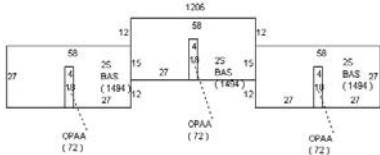

**Exterior Features**

View:	-	RoofCover:	FS - Fibrglss Shg	RoofStruct:	GA - Gable
ExtType:	LITC - Lithc Apart	YearBlt:	1971	Frame:	-
Grade:	C - C	EffYrBlt:	1971	PrimeWall:	BP - Conc Block
StoryHght:	0020 - 2 Story	No.Units:	12	SecWall:	-

**Interior Features**

BedRooms:	16	Electric:	MX - MAXIMUM	PrmIntWall:	DW - Drywall
FullBath:	0	HeatType:	FHA - FrcdHotAir	AvgHt/FI:	
1/2Bath:	0	HeatFuel:	ELEC - Electric	Prm.Flors:	CU - Carpet
%A/C:	100	%Heated:	100	%Sprinkled:	0

**Special Features and Yard Items**

Type	Y/S	Qty.	Units	Qual.	Cond.	YrBlt.
------	-----	------	-------	-------	-------	--------

**Land Information**

No.	Use Type	Type	Measure	Depth
1	0300-M-F >= 10U	107 -Unit	108	

THIS INFORMATION IS BELIEVED TO BE CORRECT AT THIS TIME BUT IT IS SUBJECT TO CHANGE AND IS NOT WARRANTED.

**PROPERTY RECORD CARD**

SP Pine Creek Village LP Record: 6 of 14  
 Property Identification

<<Prev Next >> Spec.Assmnt Taxes Exemptions Permits Home Print

Site Address: 1110 N 29th St  
 Sec/Town/Range: 05:35S :40E  
 Map ID: 24/05S  
 Zoning: R4

ParcelID: 2404-608-0120-000-9  
 Account #: 16788  
 Use Type: M-F >= 10U  
 City/Cnty: Saint Lucie County



**Ownership and Mailing**

Owner: SP Pine Creek Village LP  
 Address: 2430 Estancia Blvd Ste 101  
 Clearwater FL 33761

**Legal Description**

GARDEN CITY FARMS 05 35 40 TRACT79-LESS N 25 FT- AND N 1/2 OF TRACT 82-LESS RD R/W- (OR 3443-2263)

**Sales Information**

Date	Price	Code	Deed	Book/Page
10/11/2012	5000000	0118	SP	3443 / 2263
9/18/2000	3100000	01	WD	1329 / 0116
9/14/2000	3100000	00	WD	1329 / 0106
9/24/1992	605000	00	DE	0808 / 2008

**Assessment 2013**

2013 Final:	3444600
Assessed:	3444600
Ag.Credit:	0
Exempt:	
Taxable:	
Taxes:	88041.59

**Total Land and Building**

Land Value:	810000	Acres:	
Building Value:	2634600	Finished Area:	81452 SqFt

**BUILDING INFORMATION**

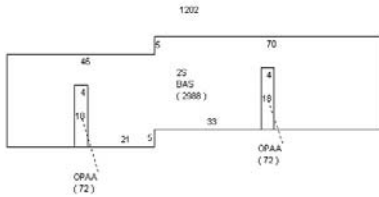

**Exterior Features**

View:	-	RoofCover:	FS - Fibrglss Shg	RoofStruct:	GA - Gable
ExtType:	LITC - Lithc Apart	YearBlt:	1971	Frame:	-
Grade:	C - C	EffYrBlt:	1971	PrimeWall:	BP - Conc Block
StoryHght:	0020 - 2 Story	No.Units:	8	SecWall:	-

**Interior Features**

BedRooms:	16	Electric:	MX - MAXIMUM	PrmlntWall:	DW - Drywall
FullBath:	0	HeatType:	FHA - FrcdHotAir	AvgHt/FI:	
1/2Bath:	0	HeatFuel:	ELEC - Electric	Prm.Flors:	CU - Carpet
%A/C:	100	%Heated:	100	%Sprinkled:	0

**Special Features and Yard Items**

Type	Y/S	Qty.	Units	Qual.	Cond.	YrBlt.
1						

**Land Information**

No.	Use Type	Type	Measure	Depth
1	0300-M-F >= 10U	107 -Unit	108	

THIS INFORMATION IS BELIEVED TO BE CORRECT AT THIS TIME BUT IT IS SUBJECT TO CHANGE AND IS NOT WARRANTED.

**PROPERTY RECORD CARD**

SP Pine Creek Village LP Record: 7 of 14  
Property Identification

<<Prev Next >> Spec.Assmnt Taxes Exemptions Permits Home Print

Site Address: 1110 N 29th St  
Sec/Town/Range: 05:35S :40E  
Map ID: 24/05S  
Zoning: R4

ParcelID: 2404-608-0120-000-9  
Account #: 16788  
Use Type: M-F >= 10U  
City/Cnty: Saint Lucie County



**Ownership and Mailing**

Owner: SP Pine Creek Village LP  
Address: 2430 Estancia Blvd Ste 101  
Clearwater FL 33761

**Legal Description**

GARDEN CITY FARMS 05 35 40 TRACT79-LESS N 25 FT- AND N 1/2 OF TRACT 82-LESS RD R/W- (OR 3443-2263)

**Sales Information**

Date	Price	Code	Deed	Book/Page
10/11/2012	5000000	0118	SP	3443 / 2263
9/18/2000	3100000	01	WD	1329 / 0116
9/14/2000	3100000	00	WD	1329 / 0106
9/24/1992	605000	00	DE	0808 / 2008

**Assessment 2013**

2013 Final:	3444600
Assessed:	3444600
Ag.Credit:	0
Exempt:	
Taxable:	
Taxes:	88041.59

**Total Land and Building**

Land Value:	810000	Acres:	
Building Value:	2634600	Finished Area:	81452 SqFt

**BUILDING INFORMATION**

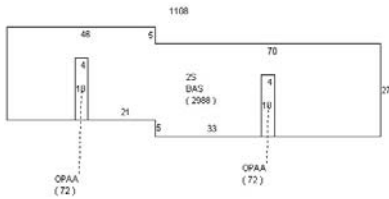

**Exterior Features**

View:	-	RoofCover:	FS - Fibrglss Shg	RoofStruct:	GA - Gable
ExtType:	LITC - Lithc Apart	YearBlt:	1971	Frame:	-
Grade:	C - C	EffYrBlt:	1971	PrimeWall:	BP - Conc Block
StoryHght:	0020 - 2 Story	No.Units:	8	SecWall:	-

**Interior Features**

BedRooms:	16	Electric:	MX - MAXIMUM	PrmIntWall:	DW - Drywall
FullBath:	0	HeatType:	FHA - FrcdHotAir	AvgHt/FI:	
1/2Bath:	0	HeatFuel:	ELEC - Electric	Prm.Flors:	CU - Carpet
%A/C:	100	%Heated:	100	%Sprinkled:	0

**Special Features and Yard Items**

Type	Y/S	Qty.	Units	Qual.	Cond.	YrBlt.
------	-----	------	-------	-------	-------	--------

**Land Information**

No.	Use Type	Type	Measure	Depth
1	0300-M-F >= 10U	107 -Unit	108	

THIS INFORMATION IS BELIEVED TO BE CORRECT AT THIS TIME BUT IT IS SUBJECT TO CHANGE AND IS NOT WARRANTED.

**PROPERTY RECORD CARD**

SP Pine Creek Village LP Record: 8 of 14  
Property Identification

<<Prev Next >> Spec.Assmnt Taxes Exemptions Permits Home Print

Site Address: 1110 N 29th St  
Sec/Town/Range: 05:35S :40E  
Map ID: 24/05S  
Zoning: R4

ParcelID: 2404-608-0120-000-9  
Account #: 16788  
Use Type: M-F >= 10U  
City/Cnty: Saint Lucie County



**Ownership and Mailing**

Owner: SP Pine Creek Village LP  
Address: 2430 Estancia Blvd Ste 101  
Clearwater FL 33761

**Legal Description**

GARDEN CITY FARMS 05 35 40 TRACT79-LESS N 25 FT- AND N 1/2 OF TRACT 82-LESS RD R/W- (OR 3443-2263)

**Sales Information**

Date	Price	Code	Deed	Book/Page
10/11/2012	5000000	0118	SP	3443 / 2263
9/18/2000	3100000	01	WD	1329 / 0116
9/14/2000	3100000	00	WD	1329 / 0106
9/24/1992	605000	00	DE	0808 / 2008

**Assessment 2013**

2013 Final:	3444600
Assessed:	3444600
Ag.Credit:	0
Exempt:	
Taxable:	
Taxes:	88041.59

**Total Land and Building**

Land Value:	810000	Acres:	
Building Value:	2634600	Finished Area:	81452 SqFt

**BUILDING INFORMATION**

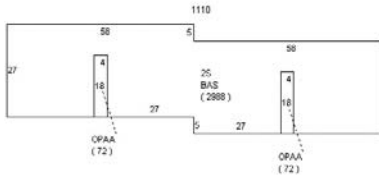

**Exterior Features**

View:	-	RoofCover:	FS - Fibrglss Shg	RoofStruct:	GA - Gable
ExtType:	LITC - Lithc Apart	YearBlt:	1971	Frame:	-
Grade:	C - C	EffYrBlt:	1971	PrimeWall:	BP - Conc Block
StoryHght:	0020 - 2 Story	No.Units:	8	SecWall:	-

**Interior Features**

BedRooms:	16	Electric:	MX - MAXIMUM	PrmIntWall:	DW - Drywall
FullBath:	0	HeatType:	FHA - FrcdHotAir	AvgHt/FI:	
1/2Bath:	0	HeatFuel:	ELEC - Electric	Prm.Flors:	CU - Carpet
%A/C:	100	%Heated:	100	%Sprinkled:	0

**Special Features and Yard Items**

Type	Y/S	Qty.	Units	Qual.	Cond.	YrBlt.	No.	Use Type	Type	Measure	Depth
							1	0300-M-F >= 10U	107 -Unit	108	

**Land Information**

THIS INFORMATION IS BELIEVED TO BE CORRECT AT THIS TIME BUT IT IS SUBJECT TO CHANGE AND IS NOT WARRANTED.



**PROPERTY RECORD CARD**

SP Pine Creek Village LP Record: 9 of 14  
 Property Identification

<<Prev Next >> Spec.Assmnt Taxes Exemptions Permits Home Print

Site Address: 1110 N 29th St  
 Sec/Town/Range: 05:35S :40E  
 Map ID: 24/05S  
 Zoning: R4

ParcelID: 2404-608-0120-000-9  
 Account #: 16788  
 Use Type: M-F >= 10U  
 City/Cnty: Saint Lucie County



**Ownership and Mailing**

Owner: SP Pine Creek Village LP  
 Address: 2430 Estancia Blvd Ste 101  
 Clearwater FL 33761

**Legal Description**

GARDEN CITY FARMS 05 35 40 TRACT79-LESS N 25 FT- AND N 1/2 OF TRACT 82-LESS RD R/W- (OR 3443-2263)

**Sales Information**

Date	Price	Code	Deed	Book/Page
10/11/2012	5000000	0118	SP	3443 / 2263
9/18/2000	3100000	01	WD	1329 / 0116
9/14/2000	3100000	00	WD	1329 / 0106
9/24/1992	605000	00	DE	0808 / 2008

**Assessment 2013**

2013 Final:	3444600
Assessed:	3444600
Ag.Credit:	0
Exempt:	
Taxable:	
Taxes:	88041.59

**Total Land and Building**

Land Value:	810000	Acres:	
Building Value:	2634600	Finished Area:	81452 SqFt

**BUILDING INFORMATION**

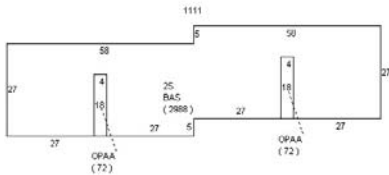

**Exterior Features**

View:	-	RoofCover:	FS - Fibrglss Shg	RoofStruct:	GA - Gable
ExtType:	LITC - Lithc Apart	YearBlt:	1971	Frame:	-
Grade:	C - C	EffYrBlt:	1971	PrimeWall:	BP - Conc Block
StoryHght:	0020 - 2 Story	No.Units:	8	SecWall:	-

**Interior Features**

BedRooms:	16	Electric:	MX - MAXIMUM	PrmIntWall:	DW - Drywall
FullBath:	0	HeatType:	FHA - FrcdHotAir	AvgHt/FI:	
1/2Bath:	0	HeatFuel:	ELEC - Electric	Prm.Flors:	CU - Carpet
%A/C:	100	%Heated:	100	%Sprinkled:	0

**Special Features and Yard Items**

Type	Y/S	Qty.	Units	Qual.	Cond.	YrBlt.	No.	Use Type	Type	Measure	Depth
							1	0300-M-F >= 10U	107 -Unit	108	

**Land Information**

THIS INFORMATION IS BELIEVED TO BE CORRECT AT THIS TIME BUT IT IS SUBJECT TO CHANGE AND IS NOT WARRANTED.

**PROPERTY RECORD CARD**

SP Pine Creek Village LP Record: 9 of 14  
 Property Identification

<<Prev Next >> Spec.Assmnt Taxes Exemptions Permits Home Print

Site Address: 1110 N 29th St  
 Sec/Town/Range: 05:35S :40E  
 Map ID: 24/05S  
 Zoning: R4

ParcelID: 2404-608-0120-000-9  
 Account #: 16788  
 Use Type: M-F >= 10U  
 City/Cnty: Saint Lucie County



**Ownership and Mailing**

Owner: SP Pine Creek Village LP  
 Address: 2430 Estancia Blvd Ste 101  
 Clearwater FL 33761

**Legal Description**

GARDEN CITY FARMS 05 35 40 TRACT79-LESS N 25 FT- AND N 1/2 OF TRACT 82-LESS RD R/W- (OR 3443-2263)

**Sales Information**

Date	Price	Code	Deed	Book/Page
10/11/2012	5000000	0118	SP	3443 / 2263
9/18/2000	3100000	01	WD	1329 / 0116
9/14/2000	3100000	00	WD	1329 / 0106
9/24/1992	605000	00	DE	0808 / 2008

**Assessment 2013**

2013 Final:	3444600
Assessed:	3444600
Ag.Credit:	0
Exempt:	
Taxable:	
Taxes:	88041.59

**Total Land and Building**

Land Value:	810000	Acres:	
Building Value:	2634600	Finished Area:	81452 SqFt

**BUILDING INFORMATION**

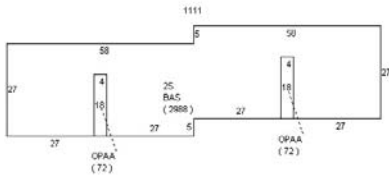

**Exterior Features**

View:	-	RoofCover:	FS - Fibrglss Shg	RoofStruct:	GA - Gable
ExtType:	LITC - Lithc Apart	YearBlt:	1971	Frame:	-
Grade:	C - C	EffYrBlt:	1971	PrimeWall:	BP - Conc Block
StoryHght:	0020 - 2 Story	No.Units:	8	SecWall:	-

**Interior Features**

BedRooms:	16	Electric:	MX - MAXIMUM	PrmlntWall:	DW - Drywall
FullBath:	0	HeatType:	FHA - FrcdHotAir	AvgHt/FI:	
1/2Bath:	0	HeatFuel:	ELEC - Electric	Prm.Flors:	CU - Carpet
%A/C:	100	%Heated:	100	%Sprinkled:	0

**Special Features and Yard Items**

Type	Y/S	Qty.	Units	Qual.	Cond.	YrBlt.	No.	Use Type	Type	Measure	Depth
							1	0300-M-F >= 10U	107 -Unit	108	

**Land Information**

THIS INFORMATION IS BELIEVED TO BE CORRECT AT THIS TIME BUT IT IS SUBJECT TO CHANGE AND IS NOT WARRANTED.

**PROPERTY RECORD CARD**

SP Pine Creek Village LP Record: 10 of 14  
Property Identification

<<Prev Next >> Spec.Assmnt Taxes Exemptions Permits Home Print

Site Address: 1110 N 29th St  
Sec/Town/Range: 05:35S :40E  
Map ID: 24/05S  
Zoning: R4

ParcelID: 2404-608-0120-000-9  
Account #: 16788  
Use Type: M-F >= 10U  
City/Cnty: Saint Lucie County



**Ownership and Mailing**

Owner: SP Pine Creek Village LP  
Address: 2430 Estancia Blvd Ste 101  
Clearwater FL 33761

**Legal Description**

GARDEN CITY FARMS 05 35 40 TRACT79-LESS N 25 FT- AND N 1/2 OF TRACT 82-LESS RD R/W- (OR 3443-2263)

**Sales Information**

Date	Price	Code	Deed	Book/Page
10/11/2012	5000000	0118	SP	3443 / 2263
9/18/2000	3100000	01	WD	1329 / 0116
9/14/2000	3100000	00	WD	1329 / 0106
9/24/1992	605000	00	DE	0808 / 2008

**Assessment 2013**

2013 Final:	3444600
Assessed:	3444600
Ag.Credit:	0
Exempt:	
Taxable:	88041.59

**Total Land and Building**

Land Value:	810000	Acres:	
Building Value:	2634600	Finished Area:	81452 SqFt

**BUILDING INFORMATION**

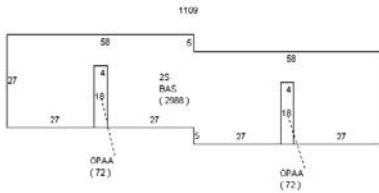

**Exterior Features**

View:	-	RoofCover:	FS - Fibrglss Shg	RoofStruct:	GA - Gable
ExtType:	LITC - Lithc Apart	YearBlt:	1971	Frame:	-
Grade:	C - C	EffYrBlt:	1971	PrimeWall:	BP - Conc Block
StoryHght:	0020 - 2 Story	No.Units:	8	SecWall:	-

**Interior Features**

BedRooms:	16	Electric:	MX - MAXIMUM	PrmIntWall:	DW - Drywall
FullBath:	0	HeatType:	FHA - FrcdHotAir	AvgHt/FI:	
1/2Bath:	0	HeatFuel:	ELEC - Electric	Prm.Flors:	CU - Carpet
%A/C:	100	%Heated:	100	%Sprinkled:	0

**Special Features and Yard Items**

Type	Y/S	Qty.	Units	Qual.	Cond.	YrBlt.
------	-----	------	-------	-------	-------	--------

**Land Information**

No.	Use Type	Type	Measure	Depth
1	0300-M-F >= 10U	107 -Unit	108	

THIS INFORMATION IS BELIEVED TO BE CORRECT AT THIS TIME BUT IT IS SUBJECT TO CHANGE AND IS NOT WARRANTED.

**PROPERTY RECORD CARD**

SP Pine Creek Village LP Record: 12 of 14  
 Property Identification

<<Prev Next >> Spec.Assmnt Taxes Exemptions Permits Home Print

Site Address: 1110 N 29th St  
 Sec/Town/Range: 05:35S :40E  
 Map ID: 24/05S  
 Zoning: R4

ParcelID: 2404-608-0120-000-9  
 Account #: 16788  
 Use Type: M-F >= 10U  
 City/Cnty: Saint Lucie County



**Ownership and Mailing**

Owner: SP Pine Creek Village LP  
 Address: 2430 Estancia Blvd Ste 101  
 Clearwater FL 33761

**Legal Description**

GARDEN CITY FARMS 05 35 40 TRACT79-LESS N 25 FT- AND N 1/2 OF TRACT 82-LESS RD R/W- (OR 3443-2263)

**Sales Information**

Date	Price	Code	Deed	Book/Page
10/11/2012	5000000	0118	SP	3443 / 2263
9/18/2000	3100000	01	WD	1329 / 0116
9/14/2000	3100000	00	WD	1329 / 0106
9/24/1992	605000	00	DE	0808 / 2008

**Assessment 2013**

2013 Final:	3444600
Assessed:	3444600
Ag.Credit:	0
Exempt:	
Taxable:	
Taxes:	88041.59

**Total Land and Building**

Land Value:	810000	Acres:	
Building Value:	2634600	Finished Area:	81452 SqFt

**BUILDING INFORMATION**

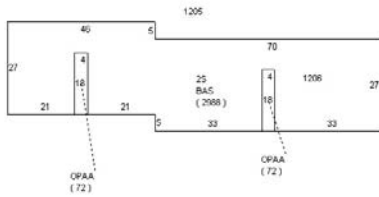

**Exterior Features**

View:	-	RoofCover:	FS - Fibrglss Shg	RoofStruct:	GA - Gable
ExtType:	LITC - Lithc Apart	YearBlt:	1971	Frame:	-
Grade:	C - C	EffYrBlt:	1971	PrimeWall:	BP - Conc Block
StoryHght:	0020 - 2 Story	No.Units:	8	SecWall:	-

**Interior Features**

BedRooms:	24	Electric:	MX - MAXIMUM	PrmIntWall:	DW - Drywall
FullBath:	0	HeatType:	FHA - FrcdHotAir	AvgHt/FI:	
1/2Bath:	0	HeatFuel:	ELEC - Electric	Prm.Flors:	CU - Carpet
%A/C:	100	%Heated:	100	%Sprinkled:	0

**Special Features and Yard Items**

Type	Y/S	Qty.	Units	Qual.	Cond.	YrBlt.	No.	Use Type	Type	Measure	Depth
							1	0300-M-F >= 10U	107 -Unit	108	

**Land Information**

THIS INFORMATION IS BELIEVED TO BE CORRECT AT THIS TIME BUT IT IS SUBJECT TO CHANGE AND IS NOT WARRANTED.

**PROPERTY RECORD CARD**

SP Pine Creek Village LP Record: 13 of 14  
 Property Identification

<<Prev Next >> Spec.Assmnt Taxes Exemptions Permits Home Print

Site Address: 1110 N 29th St  
 Sec/Town/Range: 05:35S :40E  
 Map ID: 24/05S  
 Zoning: R4

ParcelID: 2404-608-0120-000-9  
 Account #: 16788  
 Use Type: M-F >= 10U  
 City/Cnty: Saint Lucie County



**Ownership and Mailing**

Owner: SP Pine Creek Village LP  
 Address: 2430 Estancia Blvd Ste 101  
 Clearwater FL 33761

**Legal Description**

GARDEN CITY FARMS 05 35 40 TRACT79-LESS N 25 FT- AND N 1/2 OF TRACT 82-LESS RD R/W- (OR 3443-2263)

**Sales Information**

Date	Price	Code	Deed	Book/Page
10/11/2012	5000000	0118	SP	3443 / 2263
9/18/2000	3100000	01	WD	1329 / 0116
9/14/2000	3100000	00	WD	1329 / 0106
9/24/1992	605000	00	DE	0808 / 2008

**Assessment 2013**

2013 Final:	3444600
Assessed:	3444600
Ag.Credit:	0
Exempt:	
Taxable:	88041.59

**Total Land and Building**

Land Value:	810000	Acres:	
Building Value:	2634600	Finished Area:	81452 SqFt

**BUILDING INFORMATION**



**Exterior Features**

View:	-	RoofCover:	FS - Fibrglss Shg	RoofStruct:	GA - Gable
ExtType:	LITC - Lithc Apart	YearBlt:	1971	Frame:	-
Grade:	C - C	EffYrBlt:	1971	PrimeWall:	BP - Conc Block
StoryHght:	0020 - 2 Story	No.Units:	8	SecWall:	-

**Interior Features**

BedRooms:	16	Electric:	MX - MAXIMUM	PrmIntWall:	DW - Drywall
FullBath:	0	HeatType:	FHA - FrcdHotAir	AvgHt/FI:	
1/2Bath:	0	HeatFuel:	ELEC - Electric	Prm.Flors:	CU - Carpet
%A/C:	100	%Heated:	100	%Sprinkled:	0

**Special Features and Yard Items**

Type	Y/S	Qty.	Units	Qual.	Cond.	YrBlt.	No.	Use Type	Type	Measure	Depth
							1	0300-M-F >= 10U	107 -Unit	108	

**Land Information**

THIS INFORMATION IS BELIEVED TO BE CORRECT AT THIS TIME BUT IT IS SUBJECT TO CHANGE AND IS NOT WARRANTED.

**PROPERTY RECORD CARD**

SP Pine Creek Village LP Record: 14 of 14  
 Property Identification

<<Prev Next >> Spec.Assmnt Taxes Exemptions Permits Home Print

Site Address: 1110 N 29th St  
 Sec/Town/Range: 05:35S :40E  
 Map ID: 24/05S  
 Zoning: R4

ParcelID: 2404-608-0120-000-9  
 Account #: 16788  
 Use Type: M-F >= 10U  
 City/Cnty: Saint Lucie County



**Ownership and Mailing**

Owner: SP Pine Creek Village LP  
 Address: 2430 Estancia Blvd Ste 101  
 Clearwater FL 33761

**Legal Description**

GARDEN CITY FARMS 05 35 40 TRACT79-LESS N 25 FT- AND N 1/2 OF TRACT 82-LESS RD R/W- (OR 3443-2263)

**Sales Information**

Date	Price	Code	Deed	Book/Page
10/11/2012	5000000	0118	SP	3443 / 2263
9/18/2000	3100000	01	WD	1329 / 0116
9/14/2000	3100000	00	WD	1329 / 0106
9/24/1992	605000	00	DE	0808 / 2008

**Assessment 2013**

2013 Final:	3444600
Assessed:	3444600
Ag.Credit:	0
Exempt:	
Taxable:	
Taxes:	88041.59

**Total Land and Building**

Land Value:	810000	Acres:	
Building Value:	2634600	Finished Area:	81452 SqFt

**BUILDING INFORMATION**

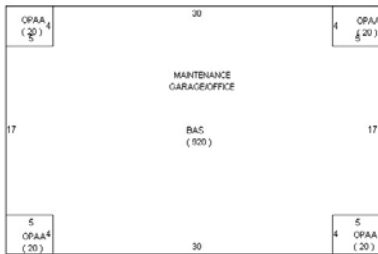

**Exterior Features**

View:	-	RoofCover:	FS - Fibrglss Shg	RoofStruct:	GA - Gable
ExtType:	DGAR - Detached Gar	YearBlt:	1971	Frame:	-
Grade:	C - C	EffYrBlt:	1971	PrimeWall:	BP - Conc Block
StoryHght:	0010 - 1 Story	No.Units:		SecWall:	-

**Interior Features**

BedRooms:	0	Electric:	MX - MAXIMUM	PrmIntWall:	PT - PT
FullBath:	0	HeatType:	-	AvgHt/Ft:	
1/2Bath:	0	HeatFuel:	-	Prm.Flors:	CG - CONC GRD
%A/C:	0	%Heated:	0	%Sprinkled:	0

**Special Features and Yard Items**

Type	Y/S	Qty.	Units	Qual.	Cond.	YrBlt.
1						

**Land Information**

No.	Use Type	Type	Measure	Depth
1	0300-M-F >= 10U	107 -Unit	108	

THIS INFORMATION IS BELIEVED TO BE CORRECT AT THIS TIME BUT IT IS SUBJECT TO CHANGE AND IS NOT WARRANTED.