

**PROPERTY RECORD CARD**

St Lucie County Record: 1 of 1

<<Prev

Next >>

Spec.Assmnt

Taxes

Exemptions Permits Home Print

**Property Identification**

Site Address: 1104 Jasmine Av  
 Sec/Town/Range: 21 :35S :40E  
 Map ID: 24/21N  
 Zoning: R2

ParcelID: 2421-514-0009-000-0  
 Account #: 28912  
 Use Type: SF Res  
 City/Cnty: Fort Pierce



**Ownership and Mailing**

Owner: St Lucie County  
 Address: 2300 Virginia Ave  
 Fort Pierce FL 34982-5632

**Legal Description**

MISIK'S RE-S/D OF MARAVILLA PARKBLK 3 LOT 3 (OR 3573-1841)

**Sales Information**

Date	Price	Code	Deed
10/25/2013	0	0118	TD
9/29/1988	100	02	QC

**Assessment 2014**

2014 TRIM:	42100
Assessed:	42100
Ag.Credit:	0
Exempt:	42100
Taxable:	0
Taxes:	470.28

**Total Land and Building**

Land Value:	5600	Acres:	0.22
Building Value:	36500		
Finished Area:	1390	SqFt	

**BUILDING INFORMATION**

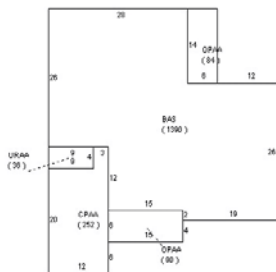

**Exterior Features**

View:	-	RoofCover:	SD - Dim Shingle	RoofStruct:	GA - Gable
ExtType:	HD - HD	YearBlt:	1954	Frame:	-
Grade:	D - D	EffYrBlt:	1975	PrimeWall:	BS - CB Stucco
StoryHght:	0010 - 1 Story	No.Units:	1	SecWall:	-

**Interior Features**

BedRooms:	2	Electric:	MX - MAXIMUM	PrmIntWall:	PF - PF
FullBath:	1	HeatType:	FHA - FrcdHotAir	AvgHt/FI:	
1/2Bath:	0	HeatFuel:	ELEC - Electric	Prm.Flors:	HW - Hardwood
%A/C:	100	%Heated:	100	%Sprinkled:	0

**Special Features and Yard Items**

Type	Y/S	Qty.	Units	Qual.	Cond.	YrBlt.	No.	Use Type	Type	Measure	Depth
DWC - Driv-Concret	Y	1	400	AV	AV	1954	1	0100-SF Res	BI -Front Ft	62.5	150

**Land Information**

THIS INFORMATION IS BELIEVED TO BE CORRECT AT THIS TIME BUT IT IS SUBJECT TO CHANGE AND IS NOT WARRANTED.