



CITY OF FORT PIERCE

PLANNING DEPARTMENT

Rebecca Grohall, AICP, Planning Manager
COMPREHENSIVE PLANNING ◊ DEVELOPMENT REVIEW
HISTORIC PRESERVATION ◊ URBAN DESIGN ◊ URBAN FORESTRY ◊ ZONING

Conditional Use – No New Construction

Property address or Location 1905 Okeechobee Rd.
Parcel ID #(s) _____
Project description _____

Property Owner(s) Herbert Rochester Holding LLC
Street Address 5514 Palmetto Dr.
City Fort Pierce State Fla. Zip 34982
Phone Number (772) 577-1234
Email Address _____

Dora E Duran
Applicant/Representative, Title, Company DOI
Street Address 1905 Okeechobee Rd.
City Fort Pierce State Fl Zip 34950
Phone Number (772) 818-5956
Email Address _____

Property Owner(s) Acknowledgements: - This application will not be considered complete without the signature of all property owners of record, which shall serve as an acknowledgement of the submission of this application. The property owner's signature below shall also authorize the Applicant (if other than the property owner) and/or Representative to act in his/her behalf for the purposes of seeking approval for the application described herein.

Samuel D. Walkowsky
Property Owner(s) Signature(s)

STATE OF FLORIDA -- COUNTY ST LUCIE
The foregoing instrument was acknowledged before me this 10 day of SEPTEMBER, 2014, by SAMUEL WALKOWSKY who is personally known to me or has produced FLDL W432784540250 as identification.

[Signature]
Signature of Notary

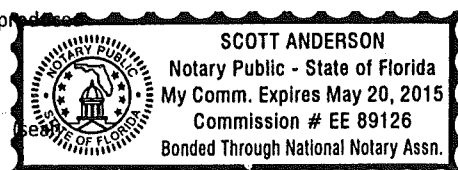

INTAKE MEETINGS ARE REQUIRED FOR ALL SUBMITTALS. CALL (772) 467-3729

TO BE COMPLETED BY STAFF

Zoning	Future Land Use	Total Acres	Historic District	Historic Designation	
				Contributing	Individual
				Non-Contributing	None

Pre-Application Meeting Date _____
Intake Planner _____
Planner Assigned _____
Approved By _____ Date _____
Comments _____

Fees _____ Control # _____ B. Permit # _____

Intake Date Stamp

**Dora's Learning Center
1907 Okeechobee Rd.
Fort Pierce Fla. 34950**

To whom it may concern,

Through this letter I would like to inform you that this daycare has provided its services to the city of Fort Pierce since March 21st, 2005. Our opening hours is from 6:00 a.m. to 5:30 p.m. from Monday to Friday. Throughout these 9 years we have taken care of kids between the ages of 1 to 10 years old. Not only have we educated them but also provided special care that has earned us the trust of their parents of bringing their kids here. We have provided them with a learning plan that is based on the "Creative Curriculum" which teaches the children while playing. We also provide all of our kids with breakfast, lunch, and snack that has been approved by the Heath Department of Food Program of the state of Florida. If you have any questions, please feel free to call us at (772)462-0353.

**Thank You,
Dora Duran**

PROPERTY RECORD CARD

Herbert Rochester Holdings LLC Record: 1 of 2

<<Prev

Next >>

Spec.Assmnt

Taxes

Exemptions

Permits Home Print

Property Identification

Site Address: 1905 OKEECHOBEE RD
 Sec/Town/Range: 09 :35S :40E
 Map ID: 24/09S
 Zoning: C3

ParcelID: 2409-712-0065-000-0
 Account #: 22531
 Use Type: OFCE BLDG
 City/Cnty: Fort Pierce



Ownership and Mailing

Owner: Herbert Rochester Holdings LLC
 Address: 5514 Palmetto Dr
 Fort Pierce FL 34982-7465

Legal Description

TUCKER TERRACE BLK 5 LOTS 8 AND 9 (OR 3040-2380; 3238-2174; 3269-2514)

Sales Information

Date	Price	Code	Deed	Book/Page
2/8/2011	100	0311	TR	3269 / 2514
10/8/2010	100	0330	SP	3238 / 2174
12/3/2008	100000	00	WD	3040 / 2380
11/21/2003	983000	00	WD	1850 / 1537
9/2/2000	100	04	QC	1327 / 0801
6/23/1995	75000	00	WD	0963 / 0223
4/20/1993	75000	01	WD	0837 / 0757
10/20/1992	60000	01	AA	0812 / 0672
4/1/1983	75000	00	CV	0398 / 2617
3/1/1982	85000	00	CV	0373 / 1351

Assessment 2014

2014 TRIM: 64600
 Assessed: 64600
 Ag.Credit: 0
 Exempt:
 Taxable:
 Taxes: 1651.13

Total Land and Building

Land Value: 43800 Acres: 0.29
 Building Value: 20800
 Finished Area: 1528 SqFt

BUILDING INFORMATION

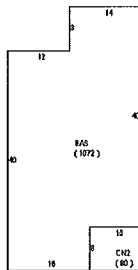

Exterior Features

View:	-	RoofCover:	SD - Dim Shingle	RoofStruct:	GA - Gable
ExtType:	LROF - OFFICE	YearBlt:	1948	Frame:	-
Grade:	Y_D+ - Commer D+	EffYrBlt:	1948	PrimeWall:	FS - Frm Stucco
StoryHght:	0010 - 1 Story	No.Units:	1	SecWall:	-

Interior Features

BedRooms:	2	Electric:	MX - MAXIMUM	PrmIntWall:	DW - Drywall
FullBath:	0	HeatType:	FHA - FrcdHotAir	AvgHt/Ft:	
1/2Bath:	0	HeatFuel:	ELEC - Electric	Prm.Flors:	VT - Vinyl Tiles
%A/C:	100	%Heated:	100	%Sprinkled:	0

Special Features and Yard Items

Type	Y/S	Qty.	Units	Qual.	Cond.	YrBlt.	No.	Use Type	Type	Measure	Depth
CNC2 - CONCRETE LOW	Y	1	5000	AV	AV	1950	1	1700-OFCE BLDG	325 -Sq Feet	12500	

Land Information

THIS INFORMATION IS BELIEVED TO BE CORRECT AT THIS TIME BUT IT IS SUBJECT TO CHANGE AND IS NOT WARRANTED.