

REVISIONS

REV #	DATE	BY:
1	10/23/14	J.P.
2	10/27/14	J.P.

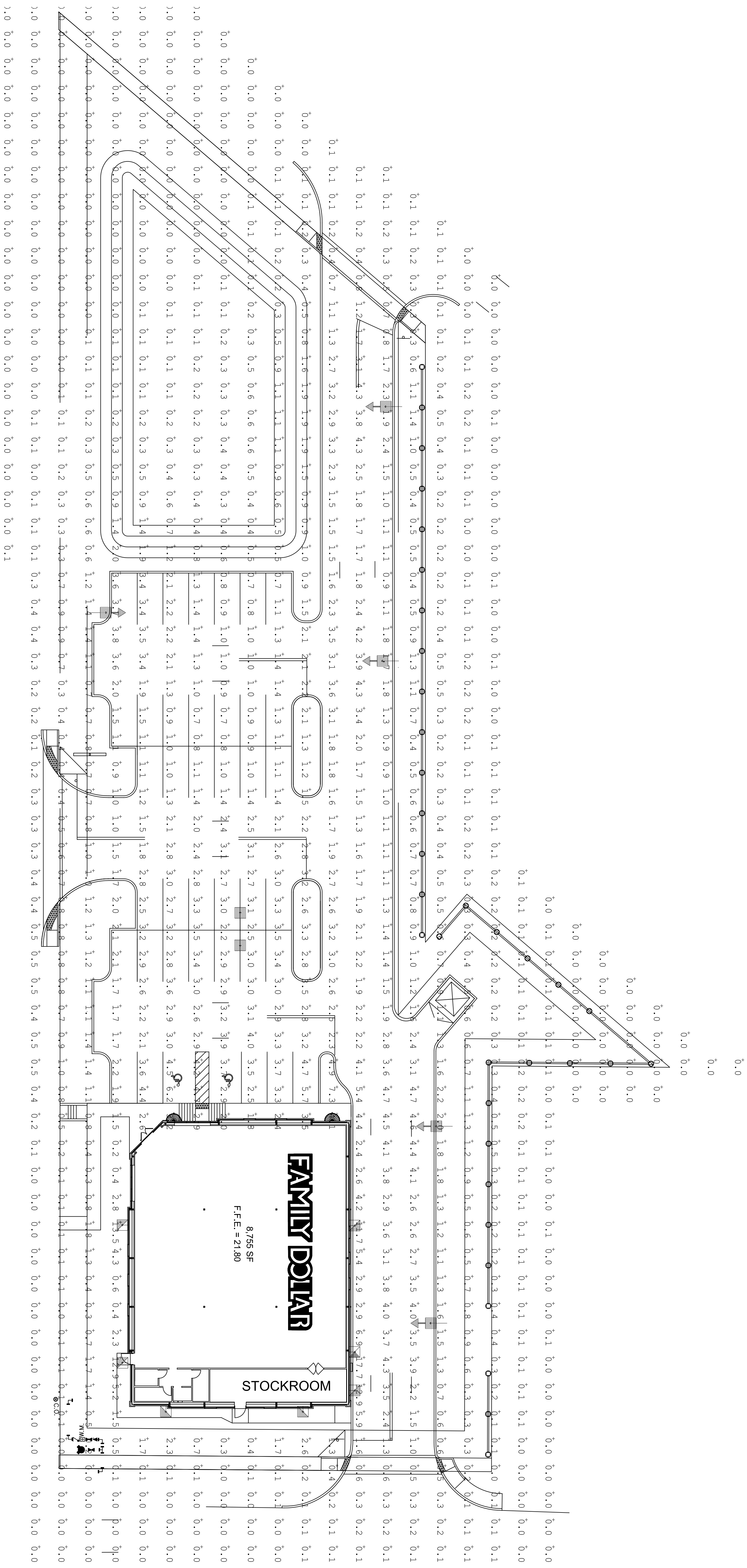

Calculation Summary

Label	Units	Avg	Max	Min	Avg/Min	Max/Min	PtSpecfc	PtSpecB
PAVED AREA	Fc	2.55	17.7	0.7	3.64	25.29	10	10
STILL SIMNARY	Fc	0.10	0.0	N.A.	N.A.	N.A.		
UNPAVED AREA	Fc	0.84	13.5	0.0	N.A.	N.A.		

Luminaire Schedule

Symbol	Qty	Label	Lumens	Lf*	Description
■	1	A	3400	0.800	WLS-FW-5-320-PSMH-FG 22'-6" POLE 2'-6" BASE
■	5	C	3400	0.800	WLS-FW-3-320-PSMH-FG-GS 22'-6" POLE 2'-6" BASE
■	6	G	N.A.	0.850	LGS-WF-CN-IP-SH-E2E 11'-6" MOUNTING HEIGHT
■	1	G1	N.A.	0.850	LGS-WF-CN-IP-SH-E2E 7'-8" MOUNTING HEIGHT
■	2	H	N.A.	0.850	ALXW LED 1 300350/31X S83 WMOJL DBRD 16" MOUNTING HEIGHT

BASED ON THE INFORMATION PROVIDED, ALL DIMENSIONS AND LUMINAIRE LOCATIONS SHOWN REPRESENT RECOMMENDED POSITIONS. THE ENGINEER AND/OR ARCHITECT MUST DETERMINE APPLICABILITY OF THE LAYOUT TO EXISTING OR FUTURE FIELD CONDITIONS.
THIS LIGHTING PATTERN REPRESENTS ILLUMINATION LEVELS CALCULATED FROM LABORATORY DATA TAKEN UNDER CONTROLLED CONDITIONS UTILIZING CURRENT INDUSTRY STANDARD LAMP RATINGS IN ACCORDANCE WITH ILLUMINATING ENGINEERING SOCIETY APPROVED METHODS. ACTUAL PERFORMANCE OF ANY MANUFACTURER'S LUMINAIRE MAY VARY DUE TO VARIATION IN ELECTRICAL VOLTAGE, TOLERANCE IN LAMPS AND OTHER VARIABLE FIELD CONDITIONS.

FAMILY DOLLAR
FORT PIERCE, FL

WLS LIGHTING SYSTEMS

Consider the Impact!

1919 WINDSOR PLACE
FORT WORTH, TX 76110
WWW.WLSLIGHTING.COM

WLS-10250

DATE - 11/25/13

SCALE: 1" = 20'

800-633-8711

PM: HOLLY

BY: J.P.

SHEET 1 OF 1