

Property Identification

Site Address: 712 EMIL DR Parcel ID: 2422-706-0008- Account #: 30457 Sec/Town/Range:
 000-5 Zoning: R2 Use Type: 0100 22/35S/40E
 Map ID: 24/22S Jurisdiction: Fort Pierce

Ownership

Branch Banking And Trust Co
 PO Box 167 ST
 Winston Salem, NC 27102-0167

Legal Description

HAMILTON ACRES E 60.5 FT OF LOT 8 AND W 50 FT OF LOT 9 (OR 3732-2738)

Current Values

Just/Market: \$74,700 Assessed: \$74,700
 Exemptions: \$0 Taxable: \$74,700

Historical Values 3-year

Year	Just/Market	Assessed	Exemptions	Taxable
2014	\$74,700	\$74,700	\$0	\$74,700
2013	\$73,900	\$73,900	\$0	\$73,900
2012	\$74,500	\$74,500	\$0	\$74,500

Sale History

Date	Book/Page	Sale Code	Deed	Grantor	Price
03-04-2015	3732 / 2738	0112	QC	Federal Home Loan Mort Corp	\$100
08-14-2009	3132 / 2238	0112	CT	Clance, Sarah T	\$0
04-01-1986	0498 / 2305	00	CV		\$72,000

Primary Building Information

Finished Area of this building: 2,140 SF
 Gross Area of this building: 3,000 SF

Exterior Data

View: Roof Cover: Fibrglss Shg Roof Structure: Hip Building Type: HC-
 Year Built: 1970 Frame: Grade: C- Effective Year: 1977
 Primary Wall: CB Stucco Story Height: 1 Story No. Units: 1 Secondary Wall:

Interior Data

Bedrooms: 3 A/C %: 100% Electric: MAXIMUM Primary Int Wall:
 Full Baths: 2 Heated %: 100% Heat Type: FrcdHotAir Avg Hgt/Floor: 0
 Half Baths: 0 Sprinkled %: 0% Heat Fuel: ELEC Primary Floors: Carpet

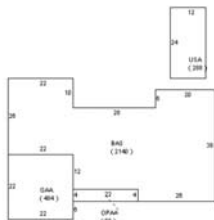

Total Areas

Finished/Under Air (SF):	2,140
Gross Area (SF):	3,000
Land Size (acres):	0.33
Land Size (SF):	14,321
Total Building Count:	1

Special Features and Yard Items

Type	Qty	Units	Year Blt
Driv-Concret	1	760	1970
CHAINLINK 4'	1	143	1977

This information is believed to be correct at this time but it is subject to change and is not warranted.
 © Copyright 2015 Saint Lucie County Property Appraiser. All rights reserved.