

Property Identification

Site Address: 401 S INDIAN RIVER DR
Sec/Town/Range: 10/35S/40E
Map ID: 24/10G
Zoning: C1

Parcel ID: 2410-808-0017-000-7
Account #: 23895
Use Type: 1000
Jurisdiction: Fort Pierce

Ownership

TA1 (IRD) LLC
 266 Park Dr
 Palatine, IL 60067-0000

Legal Description

ANDREWS AND RICHARDS S/D BLK D LOTS 1 AND 2 WITH
 RIP RTS-LESS RD R/W- AND 4 FT STRIP W OF AND ADJ TO W
 LI OF LOT AS DESC IN OR 92-520(MAP 24/10G) (OR 3546-
 2306)

Current Values

Just/Market Value: \$631,700
Assessed Value: \$631,700
Exemptions: \$0
Taxable Value: \$631,700
Taxes for this parcel: SLC Tax Collector's Office



Total Areas

Land Size (acres): 0.93
Land Size (SF): 40,686

Land Information

Total Area: 40,686 SF / 0.93 acres

Sequence Number	Number/Type of Units	Depth for Front Feet
1	27673 Sq Feet	0
Sequence Number	Number/Type of Units	Depth for Front Feet
2	15887 Sq Feet	0

Special Features and Yard Items

Type	Qty	Units	Year Blt
Permits			
Number	Date	Description	Amount
F01-0000415		Additions to existing construction	\$1,344
F98-001205	Sep 22, 1998	Roof	\$7,500
MC2003-19	Feb 20, 2003	Air Conditioning Only	\$2,350
0800001239	Mar 30, 2009	Alterations/Remodeling	\$2,000
BP09-1483	Oct 15, 2010	Demolition	\$0
BP09-1483	Nov 15, 2010	Demolition	\$0
			Fee
			\$0
			\$7,500
			\$75
			\$50
			\$130
			\$200

Notice: This does not necessarily represent all the permits for this property.
 Click the following link to check for additional permit data in Fort Pierce

Sale History

Date	Book/Page	Sale Code	Deed	Grantor	Price
Jul 3, 2013	3546 / 2306	0130	WD	DCGG LLC,	\$635,000
Jun 25, 2004	2008 / 0416	00	WD	Bryan Jr,Ben L	\$1,500,000
Dec 1, 1986	0526 / 1175	00	CV		\$300,000

Current Year Values

Current Values Breakdown

Building:	\$0
Land:	\$631,700
Just/Market:	\$631,700
Ag Credit:	\$0
Mkt/Asmnt Differential:	\$0
Assessed:	\$631,700
Exemption(s):	\$0
Taxable:	\$631,700

Current Year Exemption Value Breakdown

Current Year Special Assessment Breakdown

Start Year	AssessCode	Units	Description	Amount
2010	0041	4	Fort Pierce Stormwater Charge	\$216.00

This does not necessarily represent the total Special Assessments that could be charged against this property. The total amount charged for special assessments is reflected on the most current tax statement and information is available with the SLC Tax Collector's Office 

Historical Values

Year	Just/Market	Assessed	Exemptions	Taxable
2014	\$631,700	\$631,700	\$0	\$631,700
2013	\$631,700	\$631,700	\$0	\$631,700
2012	\$631,700	\$631,700	\$0	\$631,700

This information is believed to be correct at this time but it is subject to change and is not warranted.

© Copyright 2014 Saint Lucie County Property Appraiser.

Property Identification

Site Address: 411 S INDIAN RIVER DR
Sec/Town/Range: 10/35S/40E
Map ID: 24/10G
Zoning: C1

Parcel ID: 2410-808-0019-000-1
Account #: 23896
Use Type: 0000
Jurisdiction: Fort Pierce

Ownership

TMH LLC
2277 No Circle Dr
Palatine, IL 60067-0000

Legal Description

ANDREWS AND RICHARDS S/D BLK D LOT 3 (MAP 24/10G)
(OR 1814-1626)

Current Values

Just/Market Value: \$332,000
Assessed Value: \$332,000
Exemptions: \$0
Taxable Value: \$332,000
Taxes for this parcel: SLC Tax Collector's Office



Total Areas

Land Size (acres): 0.53
Land Size (SF): 22,898

Land Information

Total Area: 22,898 SF / 0.53 acres

Sequence Number	Number/Type of Units	Depth for Front Feet
1	13685 Sq Feet	0
Sequence Number	Number/Type of Units	Depth for Front Feet
2	9213 Sq Feet	0

Special Features and Yard Items

Type	Qty	Units	Year Blt
------	-----	-------	----------

Permits

Number	Date	Description	Amount	Fee
F93-001012	Jul 16, 1993	Roof	\$175	\$175
F94-001036	Aug 25, 1994	Roof	\$500	\$500
F98-001468	Dec 21, 1998	Fence	\$2,200	\$2,200
BP09-1419	Dec 8, 2009	Demolition	\$0	\$0
BP09-1419	Oct 6, 2010	Demolition	\$0	\$130

Notice: This does not necessarily represent all the permits for this property.
Click the following link to check for additional permit data in Fort Pierce

Sale History

Date	Book/Page	Sale Code	Deed	Grantor	Price
------	-----------	-----------	------	---------	-------

Sep 25, 2003	1814 / 1626	00	WD	MMG Holdings Llc,	\$400,000
Sep 20, 2001	1444 / 1613	00	WD	Rech,Mitchell E	\$282,000
Aug 1, 1972	0205 / 1844	00	CV		\$30,000

Current Year Values

Current Values Breakdown

Building:	\$0
Land:	\$332,000
Just/Market:	\$332,000
Ag Credit:	\$0
Mkt/Asmnt Differential:	\$0
Assessed:	\$332,000
Exemption(s):	\$0
Taxable:	\$332,000

Current Year Exemption Value Breakdown

Current Year Special Assessment Breakdown

Start Year	AssessCode	Units	Description	Amount
2010	0041	1.4	Fort Pierce Stormwater Charge	\$75.60

This does not necessarily represent the total Special Assessments that could be charged against this property. The total amount charged for special assessments is reflected on the most current tax statement and information is available with the SLC Tax Collector's Office 

Historical Values

Year	Just/Market	Assessed	Exemptions	Taxable
2014	\$332,000	\$332,000	\$0	\$332,000
2013	\$332,000	\$332,000	\$0	\$332,000
2012	\$332,000	\$332,000	\$0	\$332,000

This information is believed to be correct at this time but it is subject to change and is not warranted.

© Copyright 2014 Saint Lucie County Property Appraiser.

Property Identification

Site Address: 426 S INDIAN RIVER DR
Sec/Town/Range: 10/35S/40E
Map ID: 24/10G
Zoning: C1

Parcel ID: 2410-808-0020-010-4
Account #: 23898
Use Type: 0800
Jurisdiction: Fort Pierce

Ownership

Susnar Realty LLC
 2340 S Ocean Blvd
 Palm Beach, FL 33480-5304

Legal Description

ANDREWS AND RICHARDS S/D BLK D THAT PART OF LOT 4
 LYG E OF IND RIV DR (MAP 24/10G) (OR 3438-32, 34)

Current Values

Just/Market Value: \$194,400
Assessed Value: \$194,400
Exemptions: \$0
Taxable Value: \$194,400
Taxes for this parcel: SLC Tax Collector's Office



Total Areas

Finished/Under Air (SF): 3,200
Gross Area (SF): 3,300
Land Size (acres): 0.22
Land Size (SF): 9,666

Building Information (1 of 2)

Finished Area: 1,600 SF

Gross Total Area: 1,700 SF

Exterior Data

View:
Building Type: MFH
Grade: MFFQ
Story Height: 2 Story

Roof Cover: Asph Shingle
Year Built: 1977
Effective Year: 1977
No. Units: 2

Roof Structure: Hip
Frame:
Primary Wall: Frm Stucco
Secondary Wall:

Interior Data

Bedrooms: 1
Full Baths: 2
Half Baths: 0
A/C %: 100%

Electric: MAXIMUM
Heat Type: FrcdHotAir
Heat Fuel: ELEC
Heated %: 100%

Primary Int Wall:
Avg Hgt/Floor: 0
Primary Floors: Carpet
Sprinkled %: 0%

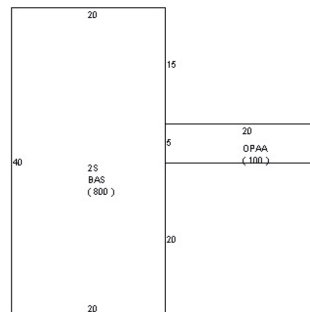

Building Information (2 of 2)

Finished Area: 1,600 SF

Gross Total Area: 1,600 SF

Exterior Data

View:

Building Type: MFH

Grade: MFFQ

Story Height: 2 Story

Roof Cover: Asph Shingle

Year Built: 1977

Effective Year: 1977

No. Units: 2

Roof Structure: Hip

Frame:

Primary Wall: Frm Stucco

Secondary Wall:

Interior Data

Bedrooms: 1

Full Baths: 2

Half Baths: 0

A/C %: 100%

Electric: MAXIMUM

Heat Type: FrdHotAir

Heat Fuel: ELEC

Heated %: 100%

Primary Int Wall:

Avg Hgt/Floor: 0

Primary Floors: Carpet

Sprinkled %: 0%

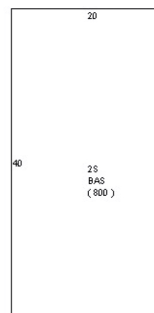

Land Information

Total Area: 9,666 SF / 0.22 acres

Sequence Number	Number/Type of Units	Depth for Front Feet
1	0 Sq Feet	0
Sequence Number	Number/Type of Units	Depth for Front Feet
1	9666 Sq Feet	0

Special Features and Yard Items

Type	Qty	Units	Year Blt
CONCRETE LOW	1	1800	1977

Permits

Number	Date	Description	Amount	Fee
F95-000778	Jul 19, 1995	Alterations/Remodeling	\$5,250	\$5,250
MC2003-56	May 27, 2003	Air Conditioning Only	\$1,243	\$75
MC2003386	Jan 20, 2004	Air Conditioning Only	\$1,230	\$75
RR2005908	Nov 2, 2005	Alterations/Remodeling	\$7,500	\$150
RR2005909	Nov 2, 2005	Alterations/Remodeling	\$7,500	\$150
RF2005609	May 6, 2008	Roof	\$7,000	\$195
0800000125	Oct 27, 2008	Fence	\$1,689	\$100

Notice: This does not necessarily represent all the permits for this property.

Sale History

Date	Book/Page	Sale Code	Deed	Grantor	Price
Sep 18, 2012	3438 / 0034	0111	QC	Susnar,Lisa	\$425,000
Sep 17, 2012	3438 / 0032	0111	WD	Lyman,John B	\$100
Aug 17, 2012	3438 / 0030	0111	QC	Lyman,John B	\$100
Aug 14, 2012	3438 / 0031	0111	QC	Lyman,John B	\$100
Aug 14, 2012	3438 / 0029	0111	QC	Lyman,John B	\$100
Feb 13, 2003	1659 / 0787	01	PR	Lyman Jr (EST),John B	\$100
Jul 1, 1984	0437 / 2798	01	CV		\$0

Current Year Values

Current Values Breakdown

Building:	\$54,200
Land:	\$140,200
Just/Market:	\$194,400
Ag Credit:	\$0
Mkt/Asmnt Differential:	\$0
Assessed:	\$194,400
Exemption(s):	\$0
Taxable:	\$194,400

Current Year Exemption Value Breakdown

Current Year Special Assessment Breakdown

Start Year	AssessCode	Units	Description	Amount
1999	0041	1.2	Fort Pierce Stormwater Charge	\$64.80

This does not necessarily represent the total Special Assessments that could be charged against this property. The total amount charged for special assessments is reflected on the most current tax statement and information is available with the SLC Tax Collector's Office 

Historical Values

Year	Just/Market	Assessed	Exemptions	Taxable
2014	\$194,400	\$194,400	\$0	\$194,400
2013	\$195,200	\$195,200	\$0	\$195,200
2012	\$195,500	\$195,500	\$0	\$195,500

This information is believed to be correct at this time but it is subject to change and is not warranted.

© Copyright 2014 Saint Lucie County Property Appraiser.

Property Identification

Site Address: 500 S INDIAN RIVER DR
Sec/Town/Range: 10/35S/40E
Map ID: 24/10S
Zoning: C1

Parcel ID: 2410-809-0001-000-5
Account #: 23899
Use Type: 1000
Jurisdiction: Fort Pierce

Ownership

Kraaz and Kraaz Finance LLC
 124 N 2nd ST Ste A
 Fort Pierce, FL 34950-4401

Legal Description

LOWRY`S S/D BLK E LOT 1 (MAP 24/10H)(OR 3714-2415)

Current Values

Just/Market Value: \$175,500
Assessed Value: \$175,500
Exemptions: \$0
Taxable Value: \$175,500
Taxes for this parcel: SLC Tax Collector's Office



Total Areas

Land Size (acres): 0.27
Land Size (SF): 11,974

Land Information

Total Area: 11,974 SF / 0.27 acres

Sequence Number	Number/Type of Units	Depth for Front Feet
1	7081 Sq Feet	0
Sequence Number	Number/Type of Units	Depth for Front Feet
2	5023 Sq Feet	0

Special Features and Yard Items

Type	Qty	Units	Year Blt

Permits

Number	Date	Description	Amount	Fee
F93-000557	Apr 27, 1993	Roof	\$1,250	\$1,250
F98-000045	Jan 30, 1998	Alterations/Remodeling	\$2,195	\$2,195
0700001210	Oct 26, 2007	Demolition	\$0	\$130

Notice: This does not necessarily represent all the permits for this property.
 Click the following link to check for additional permit data in Fort Pierce

Sale History

Date	Book/Page	Sale Code	Deed	Grantor	Price
Nov 24, 2003	1853 / 2721	01	WD	MMG Holdings LLC ,	\$360,000
Sep 6, 2002	1579 / 0950	02	WD	Adams,Jacklyn	\$375,000

Current Year Values

Current Values Breakdown

Building:	\$0
Land:	\$175,500
Just/Market:	\$175,500
Ag Credit:	\$0
Mkt/Asmnt Differential:	\$0
Assessed:	\$175,500
Exemption(s):	\$0
Taxable:	\$175,500

Current Year Exemption Value Breakdown

Current Year Special Assessment Breakdown

Start Year	AssessCode	Units	Description	Amount
1999	0041	2.4	Fort Pierce Stormwater Charge	\$129.60

This does not necessarily represent the total Special Assessments that could be charged against this property. The total amount charged for special assessments is reflected on the most current tax statement and information is available with the SLC Tax Collector's Office 

Historical Values

Year	Just/Market	Assessed	Exemptions	Taxable
2014	\$175,500	\$175,500	\$0	\$175,500
2013	\$175,500	\$175,500	\$0	\$175,500
2012	\$175,500	\$175,500	\$0	\$175,500

This information is believed to be correct at this time but it is subject to change and is not warranted.

© Copyright 2014 Saint Lucie County Property Appraiser.

Property Identification

Site Address: 507 S INDIAN RIVER DR
Sec/Town/Range: 10/35S/40E
Map ID: 24/10S
Zoning: C1

Parcel ID: 2410-809-0002-000-2
Account #: 23900
Use Type: 1000
Jurisdiction: Fort Pierce

Ownership

Kraaz and Kraaz Finance LLC
 124 N 2nd ST Ste A
 Fort Pierce, FL 34950-4401

Legal Description

LOWRY`S S/D BLK E LOTS 2 AND 3 (MAP 24/10H)(OR 3714-2415)

Current Values

Just/Market Value: \$311,600
Assessed Value: \$311,600
Exemptions: \$0
Taxable Value: \$311,600
Taxes for this parcel: SLC Tax Collector's Office



Total Areas

Land Size (acres): 0.52
Land Size (SF): 22,500

Land Information

Total Area: 22,500 SF / 0.52 acres

Sequence Number	Number/Type of Units	Depth for Front Feet
1	13087 Sq Feet	0
Sequence Number	Number/Type of Units	Depth for Front Feet
2	8400 Sq Feet	0

Special Features and Yard Items

Type	Qty	Units	Year Blt

Permits

Number	Date	Description	Amount	Fee
F99-000008		Roof	\$3,560	\$0
F93-001346	Oct 1, 1993	Roof	\$1,100	\$1,100
0700000798	Sep 26, 2007	Demolition	\$0	\$130

Notice: This does not necessarily represent all the permits for this property.
 Click the following link to check for additional permit data in Fort Pierce

Sale History

Date	Book/Page	Sale Code	Deed	Grantor	Price
Nov 24, 2003	1853 / 2721	02	WD	MMG Holdings LLC ,	\$360,000
Sep 6, 2002	1579 / 0950	02	WD	Adams,Jacklyn	\$375,000

Current Year Values

Current Values Breakdown

Building:	\$0
Land:	\$311,600
Just/Market:	\$311,600
Ag Credit:	\$0
Mkt/Asmnt Differential:	\$0
Assessed:	\$311,600
Exemption(s):	\$0
Taxable:	\$311,600

Current Year Exemption Value Breakdown

Current Year Special Assessment Breakdown

Start Year	AssessCode	Units	Description	Amount
1999	0041	1	Fort Pierce Stormwater Charge	\$54.00

This does not necessarily represent the total Special Assessments that could be charged against this property. The total amount charged for special assessments is reflected on the most current tax statement and information is available with the SLC Tax Collector's Office 

Historical Values

Year	Just/Market	Assessed	Exemptions	Taxable
2014	\$311,600	\$311,600	\$0	\$311,600
2013	\$311,600	\$311,600	\$0	\$311,600
2012	\$311,600	\$311,600	\$0	\$311,600

This information is believed to be correct at this time but it is subject to change and is not warranted.

© Copyright 2014 Saint Lucie County Property Appraiser.

Property Identification

Site Address: 509 S INDIAN RIVER DR
Sec/Town/Range: 10/35S/40E
Map ID: 24/10S
Zoning: C1

Parcel ID: 2410-809-0004-000-6
Account #: 23901
Use Type: 1000
Jurisdiction: Fort Pierce

Ownership

Kraaz and Kraaz
 124 N 2nd ST Ste A
 Fort Pierce, FL 34950-4401

Legal Description

LOWRY`S S/D BLK E LOT 4-LESS THAT PART DESC IN DBK
 164-329- (MAP 24/10H) (OR 3714-2415)

Current Values

Just/Market Value: \$164,700
Assessed Value: \$164,700
Exemptions: \$0
Taxable Value: \$164,700
Taxes for this parcel: SLC Tax Collector's Office



Total Areas

Land Size (acres): 0.26
Land Size (SF): 11,540

Land Information

Total Area: 11,540 SF / 0.26 acres

Sequence Number	Number/Type of Units	Depth for Front Feet
1	7593 Sq Feet	0
Sequence Number	Number/Type of Units	Depth for Front Feet
2	3765 Sq Feet	0

Special Features and Yard Items

Type	Qty	Units	Year Blt
------	-----	-------	----------

Permits

Number	Date	Description	Amount	Fee
F93-000825	Jun 17, 1993	Alterations/Remodeling	\$700	\$700
F94-001642	Jan 4, 1994	Dock	\$4,500	\$4,500
F97-000053	Jan 22, 1997	Additions to existing construction	\$3,500	\$3,500
MC2004308	Dec 2, 2004	Air Conditioning Only	\$2,475	\$150
RF2004587	Dec 6, 2004	Roof	\$6,000	\$0
DK200412	Jan 26, 2005	Dock	\$8,000	\$0
0700000799	Sep 26, 2007	Demolition	\$0	\$130
0800001001	Jan 7, 2009	Demolition	\$0	\$260

Notice: This does not necessarily represent all the permits for this property.
 Click the following link to check for additional permit data in Fort Pierce

Sale History

Date	Book/Page	Sale Code	Deed	Grantor	Price
Jul 3, 2013	3546 / 2309	0130	WD	MMG Holdings LLC,	\$165,000
Apr 22, 2005	2227 / 1737	00	WD	McCurdy, Carson	\$800,000
Oct 28, 1992	0959 / 1398	01	QC	FT PIERCE PRTNRSHP	\$30,300
Jan 1, 1988	0574 / 0366	01	CV		\$19,673
Jan 1, 1988	0574 / 0364	01	CV		\$19,664
Jan 1, 1988	0574 / 0362	01	CV		\$19,664

Current Year Values

Current Values Breakdown

Building:	\$0
Land:	\$164,700
Just/Market:	\$164,700
Ag Credit:	\$0
Mkt/Asmnt Differential:	\$0
Assessed:	\$164,700
Exemption(s):	\$0
Taxable:	\$164,700

Current Year Exemption Value Breakdown

Current Year Special Assessment Breakdown

Start Year	AssessCode	Units	Description	Amount
1999	0041	1	Fort Pierce Stormwater Charge	\$54.00

This does not necessarily represent the total Special Assessments that could be charged against this property. The total amount charged for special assessments is reflected on the most current tax statement and information is available with the SLC Tax Collector's Office 

Historical Values

Year	Just/Market	Assessed	Exemptions	Taxable
2014	\$164,700	\$164,700	\$0	\$164,700
2013	\$164,700	\$164,700	\$0	\$164,700
2012	\$164,700	\$164,700	\$0	\$164,700

This information is believed to be correct at this time but it is subject to change and is not warranted.

© Copyright 2014 Saint Lucie County Property Appraiser.

Property Identification

Site Address: 515 S INDIAN RIVER DR
Sec/Town/Range: 10/35S/40E
Map ID: 24/10H
Zoning: C1

Parcel ID: 2410-810-0001-000-9
Account #: 23903
Use Type: 0100
Jurisdiction: Fort Pierce

Ownership

Kraaz and Kraaz Finance LLC
 124-A N 2nd St
 Fort Pierce, FL 34950-0000

Legal Description

ANDREWS AND RICHARDS S/D THAT PART OF LOT 1 LYGE OF S2 ST AND BEG ON E LI OF S2 ST 8 FT S OF N LIOF LOT 2, RUN NELY 95.7 FT TO SD N LI, TH W ALG SD N LI TO E LI OF S2 ST, TH S TO POB (MAP 24/10H) (1) (OR 3669-906)

Current Values

Just/Market Value: \$244,700
Assessed Value: \$244,700
Exemptions: \$0
Taxable Value: \$244,700
Taxes for this parcel: SLC Tax Collector's Office



Total Areas

Finished/Under Air (SF): 4,219
Gross Area (SF): 4,295
Land Size (acres): 0.54
Land Size (SF): 23,490

Building Information (1 of 2)

Finished Area: 2,731 SF
 Gross Total Area: 2,789 SF

Exterior Data

View:
Building Type: HC-
Grade: C-
Story Height: 2 Story

Roof Cover: Fibrglss Shg
Year Built: 1900
Effective Year: 1960
No. Units: 1

Roof Structure: Hip
Frame:
Primary Wall: CB Stucco
Secondary Wall:

Interior Data

Bedrooms: 3
Full Baths: 2
Half Baths: 0
A/C %: 100%

Electric: MAXIMUM
Heat Type: FrcdHotAir
Heat Fuel: ELEC
Heated %: 100%

Primary Int Wall:
Avg Hgt/Floor: 0
Primary Floors: Carpet
Sprinkled %: 0%

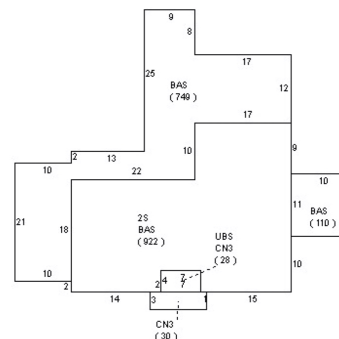

Building Information (2 of 2)

Finished Area: 1,488 SF

Gross Total Area: 1,506 SF

Exterior Data

View:

Building Type: HD

Grade: D

Story Height: 2 Story

Roof Cover: Fibrglss Shg

Year Built: 1920

Effective Year: 1960

No. Units: 1

Roof Structure: Hip

Frame:

Primary Wall: CB Stucco

Secondary Wall:

Interior Data

Bedrooms: 2

Full Baths: 1

Half Baths: 0

A/C %: 50%

Electric: MAXIMUM

Heat Type: FrcdHotAir

Heat Fuel: ELEC

Heated %: 50%

Primary Int Wall:

Avg Hgt/Floor: 0

Primary Floors: Carpet

Sprinkled %: 0%

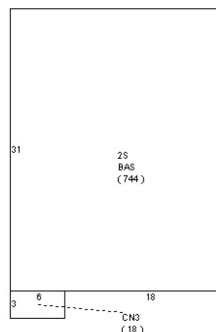

Land Information

Total Area: 23,490 SF / 0.54 acres

Sequence Number	Number/Type of Units	Depth for Front Feet
1	23490 Sq Feet	0
Sequence Number	Number/Type of Units	Depth for Front Feet
1	0 Sq Feet	0

Special Features and Yard Items

Type	Qty	Units	Year Blt
------	-----	-------	----------

Permits

Number	Date	Description	Amount	Fee
F00-000394		Roof	\$8,700	\$0
F94-000209	Mar 1, 1994	Alterations/Remodeling	\$60,000	\$60,000
F94-00209A	Mar 22, 1994	Heat and Air Conditioning	\$4,800	\$4,800
MC2004198	Oct 21, 2004	Air Conditioning Only	\$1,461	\$75
DK20057	Mar 21, 2005	Dock	\$20,000	\$325
BP13-1899	Jun 26, 2013	Alterations/Remodeling	\$1,500	\$329
BP13-2100	Aug 5, 2013	Roof	\$1,400	\$79
BP13-3052	Nov 13, 2013	Patio	\$200	\$79
BP13-1899	Feb 7, 2014	Alterations/Remodeling	\$1,800	\$129
BP13-2100	Feb 7, 2014	Re Roof Permit	\$1,400	\$129
BP14-0608	Apr 22, 2014	Alterations/Remodeling	\$1,900	\$80

Notice: This does not necessarily represent all the permits for this property.
 Click the following link to check for additional permit data in Fort Pierce

Sale History

Date	Book/Page	Sale Code	Deed	Grantor	Price
Sep 4, 2014	3669 / 0906	0205	WD	Weaver,Steven M	\$320,000
Jul 19, 2013	3546 / 2272	0205	WD	MMG Holdings LLC,	\$200,000
Nov 17, 2003	1848 / 0865	00	WD	Brennan (TR),John T	\$370,000
Dec 31, 2001	1474 / 0684	03	WD	Brennan,John T	\$370,000
Dec 5, 1975	0246 / 1265				\$1

Current Year Values

Current Values Breakdown

Building:	\$40,300
Land:	\$204,400
Just/Market:	\$244,700
Ag Credit:	\$0
Mkt/Asmnt Differential:	\$0
Assessed:	\$244,700
Exemption(s):	\$0
Taxable:	\$244,700

Current Year Exemption Value Breakdown

Current Year Special Assessment Breakdown

Start Year	AssessCode	Units	Description	Amount
2006	0041	4.6	Fort Pierce Stormwater Charge	\$248.40

This does not necessarily represent the total Special Assessments that could be charged against this property. The total amount charged for special assessments is reflected on the most current tax statement and information is available with the SLC Tax Collector's Office 

Historical Values

Year	Just/Market	Assessed	Exemptions	Taxable
2014	\$244,700	\$244,700	\$0	\$244,700
2013	\$371,300	\$371,300	\$0	\$371,300
2012	\$485,500	\$485,500	\$0	\$485,500

This information is believed to be correct at this time but it is subject to change and is not warranted.

© Copyright 2014 Saint Lucie County Property Appraiser.