

**Property Identification**

Site Address: 2014  
 DELAWARE AVE  
 Map ID: 24/09S

Parcel ID: 2409-313-0014-  
 000-3  
 Zoning: R4

Account #: 20944  
 Use Type: 0100

Sec/Town/Range:  
 09/35S/40E  
 Jurisdiction: Fort Pierce

**Ownership**

Simon P Castor  
 207 Dixieland DR  
 Fort Pierce, FL 34982-6705

**Legal Description**

9 35 40 W 1/2 OF W 1 AC OF S 1/2OF SW 1/4 OF NE 1/4 OF SW 1/4-LESS S 30 FT- AND FROM MONU 30FT N AND 25 FT E OF SW COR OF SE 1/4 OF SE 1/4 OF NW 1/4 OF SW 1/4 RUN E 307.28 FT TO POB, TH CONT E 16 FT M/L TO SLY EXT OF ELI MIDTOWN S/D, TH N ALG SD SLY EXT 93.4 FT TO S LI MIDTOWN S/D, TH WLY ALG SD S LI 13.5 FT M/L, TH S 93.4 M/L FT TO POB (OR 3774-1501)

**Current Values**

Just/Market: \$31,400 Assessed: \$31,400  
 Exemptions: \$0 Taxable: \$31,400

**Historical Values 3-year**

Year	Just/Market	Assessed	Exemptions	Taxable
2015	\$31,400	\$31,400	\$0	\$31,400
2014	\$31,000	\$31,000	\$0	\$31,000
2013	\$30,800	\$30,800	\$0	\$30,800

**Sale History**

Date	Book/Page	Sale Code	Deed	Grantor	Price
08-03-2015	3774 / 1501	0111	TD	Montano Pierina	\$7,100
01-06-2006	2471 / 1332	00	WD	Marante,Felix	\$177,000
03-08-2004	1917 / 0708	00	WD	Gallant,Edith H	\$44,900

**Primary Building Information**

Finished Area of this building: 1,072 SF  
 Gross Area of this building: 1,396 SF

**Exterior Data**

View: Roof Cover: Sheet Metal Roof Structure: Gable Building Type: HD  
 Year Built: 1941 Frame: Grade: D Effective Year: 1977  
 Primary Wall: CB Stucco Story Height: 1 Story No. Units: 1 Secondary Wall:

**Interior Data**

Bedrooms: 2 A/C %: 100% Electric: MAXIMUM Primary Int Wall:  
 Full Baths: 1 Heated %: 100% Heat Type: FredHotAir Avg Hgt/Floor: 0  
 Half Baths: 0 Sprinkled %: 0% Heat Fuel: ELEC Primary Floors: Double Pine

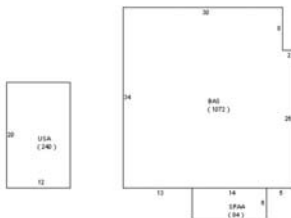

**Total Areas**

Finished/Under Air (SF):	1,072
Gross Area (SF):	1,396
Land Size (acres):	0.52
Land Size (SF):	22,545
Total Building Count:	1

**Special Features and Yard Items**

Type	Qty	Units	Year Blt
------	-----	-------	----------

This information is believed to be correct at this time but it is subject to change and is not warranted.  
 © Copyright 2015 Saint Lucie County Property Appraiser. All rights reserved.