

**FT. PIERCE PRECAST CONCRETE PLANT
TRAFFIC IMPACT ANALYSIS**

Prepared for

CIVIL DESIGN, INC.

**PINDER TROUTMAN CONSULTING, INC.
Certificate of Authorization Number: 7989
2005 Vista Parkway, Suite 111
West Palm Beach, FL 33411
(561) 296-9698**

Linda Riccardi, P.E.
Florida Registration #45359

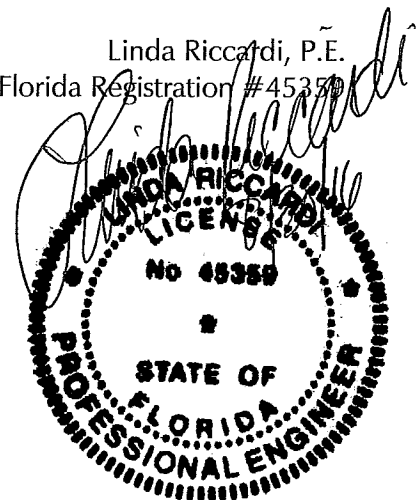

**#PTC16-071
August 30, 2016**

FT. PIERCE PRECAST CONCRETE PLANT

TRAFFIC IMPACT ANALYSIS

Introduction

Pinder Troutman Consulting, Inc. (PTC) has been retained to conduct a traffic impact analysis for a proposed heavy industrial project located in the City of Ft. Pierce. It is proposed to develop a 75 acre precast concrete plant facility. The purpose of this study is to examine the traffic impacts of the proposed development on the surrounding roadway network and to determine compliance with Chapter V – Adequate Public Facilities, of the St. Lucie County Land Development Code. A Traffic Methodology Statement was presented on August 23, 2016 and is included in Appendix A.

Site Data

The site is located on the east side of Selvitz Road, south of Glades Cut-Off Road, as shown on Exhibit 1. Proposed access to the site is via one driveway connection to Selvitz Road. Issues related to driveway location, turn lanes and geometrics would be addressed during final design. Any reference to intersection geometrics is conceptual in nature and subject to final design and approval by others. A five-year (2021) buildout is proposed.

Existing Traffic Conditions

The latest available daily and peak hour traffic volumes and adopted level of service volumes for the surrounding roadway network were used. The source of the traffic count data is the St. Lucie TPO "Traffic Counts and Level of Service Report, Fall 2015", which is provided in Appendix B. Historic traffic data utilized in growth rate analyses are also provided in Appendix B.

Roadway Improvements

The Transportation Improvement Program from the St. Lucie TPO was reviewed to determine if any roadways within the study area are scheduled to be improved. Midway Road from Selvitz Road to 25th Street is currently being widened to a four-lane facility. Midway Road from 25th Street to US 1 will also be widened to four lanes and is scheduled for construction this year.

Trip Generation

The Institute of Transportation Engineers (ITE), Trip Generation, 9th Edition was reviewed to determine acceptable daily and peak hour trip generation rates for the proposed project. Exhibit 2 provides the daily, AM and PM peak hour trip generation data for the proposed development. Based on the net external daily trip generation of 506 and the St. Lucie County TPO standards, a one mile Radius of Area of Influence was utilized.

Trip Distribution and Assignment

A directional distribution was developed based on a review of land use patterns, approved traffic studies in the area and existing travel patterns. The project traffic distribution is shown on Exhibit 3A. Exhibits 3B and 3C show the assignment of AM and PM peak hour project traffic on the surrounding roadway network, as well as the project's impact percentage (% of peak hour directional service volume) to determine project significance. Project traffic is considered to be significant on the directly accessed Major Road where Project traffic consumes one percent or more of the directional capacity, and on any other Major Road within one mile where Project traffic consumes five percent or more of the directional capacity.

Committed Trips

Committed development traffic from projects located within the one mile radius must be included in the projection of future traffic volumes. Information on committed projects was obtained from St. Lucie County. The City of Fort Pierce also provided information on approved projects within the one mile radius. Committed development data from the following projects are included in Appendix C:

Midway Road Professional Plaza	Mariner Cove
Becker/Carriage House	Lone Pine Subdivision

Historic Growth

Historic growth trends must be analyzed in the projection of future background traffic volumes. Historic growth data for a three-year period is shown on Exhibit 4A for the surrounding roadway links. Exhibit 4B provides a seven-year growth comparison for use in the intersection analyses to coincide with the intersection count year for Midway Road and Selvitz Road. Areawide growth rates

were used in the intersection analyses.

Intersection Analysis

Intersection capacity analyses are required for the major intersections within a significantly impacted roadway segment. The intersections of Midway Road with Selvitz Road and Edwards Road with Selvitz Road were analyzed using Highway Capacity Manual procedures. Recent turning movement counts for the intersection of Midway Road with Selvitz Road were unavailable, and the intersection is currently under construction. Therefore, the latest available counts were used and are included in Appendix D. Projected background traffic was calculated based on a combination of seven-year and three-year areawide growth rates for the intersection of Midway Road and Selvitz Road. A peak hour turning movement count was performed on August 24, 2016 for the intersection of Edwards Road and Selvitz Road. The three-year areawide growth rate was utilized for projected background traffic for the intersection of Edwards Road and Selvitz Road. The worksheets, capacity analyses, signal plans for the improved intersection and existing signal timing are provided in Appendix D. The analyses for Midway Road and Selvitz Road were based on projected signal timing, given that the existing signal timing is not reflective of the new and programmed lanes. The signal timing for the intersection of Edwards Road and Selvitz Road was optimized based on projected turning movements. The results are summarized on Exhibit 5. Both intersections are projected to operate at the adopted level of service standards.

Roadway Link Capacity Analysis

Exhibit 6 provides future peak hour traffic projections for the significantly impacted roadway links. The total traffic consists of existing traffic plus the highest of historic growth or Committed Development and 1% growth, whichever is greatest, plus Project traffic. The roadway links are projected to operate at the adopted peak hour level of service standards.

Driveway Volumes

Driveway volumes are shown on Exhibit 7. Based on St. Lucie County and FDOT standards, a left turn lane is recommended.

Conclusions

This analysis shows that roadway links and intersections surrounding the site are projected to operate at the adopted level of service standards with the proposed development. Therefore, the project is in conformance with the requirement of Chapter V – Adequate Public Facilities, of the St. Lucie County Land Development Code.

EXHIBITS

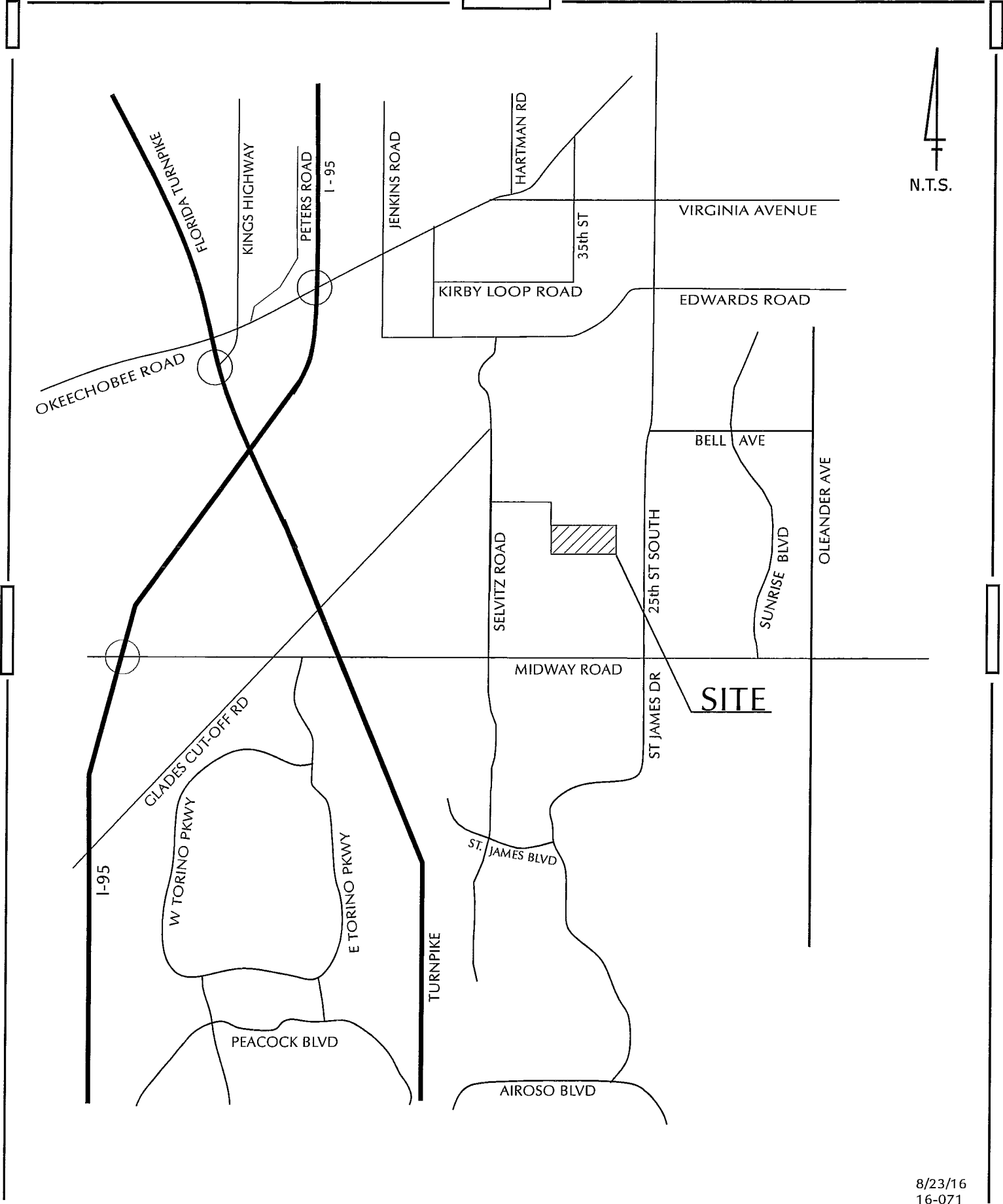

**FT PIERCE PRECAST
CONCRETE PLANT**

**EXHIBIT 1
PROJECT LOCATION**

PTC

8/23/16
16-071

Exhibit 2
Ft Pierce Precast Concrete Plant
Trip Generation

DAILY

Land Use	ITE Code	Intensity	Trip Generation Rate (1)	Total Trips
General Heavy Industrial	120	75 Acre	6.75 /Acre	506
TOTALS				506

AM PEAK HOUR

Land Use	ITE Code	Intensity	Trip Generation Rate (1)	Total Trips	
				In	Out
General Heavy Industrial	120	75 Acre	1.98 /Acre (83/17)	124	25
TOTALS				124	25

PM PEAK HOUR

Land Use	ITE Code	Intensity	Trip Generation Rate (1)	Total Trips	
				In	Out
General Heavy Industrial	120	75 Acre	2.16 /Acre (22/78)	36	126
TOTALS				36	126

(1) Source: Palm Beach County and Institute of Transportation Engineers (ITE), Trip Generation, 9th Edition. Used peak hour in/out percentages from General Light Industrial, ITE Code 110.

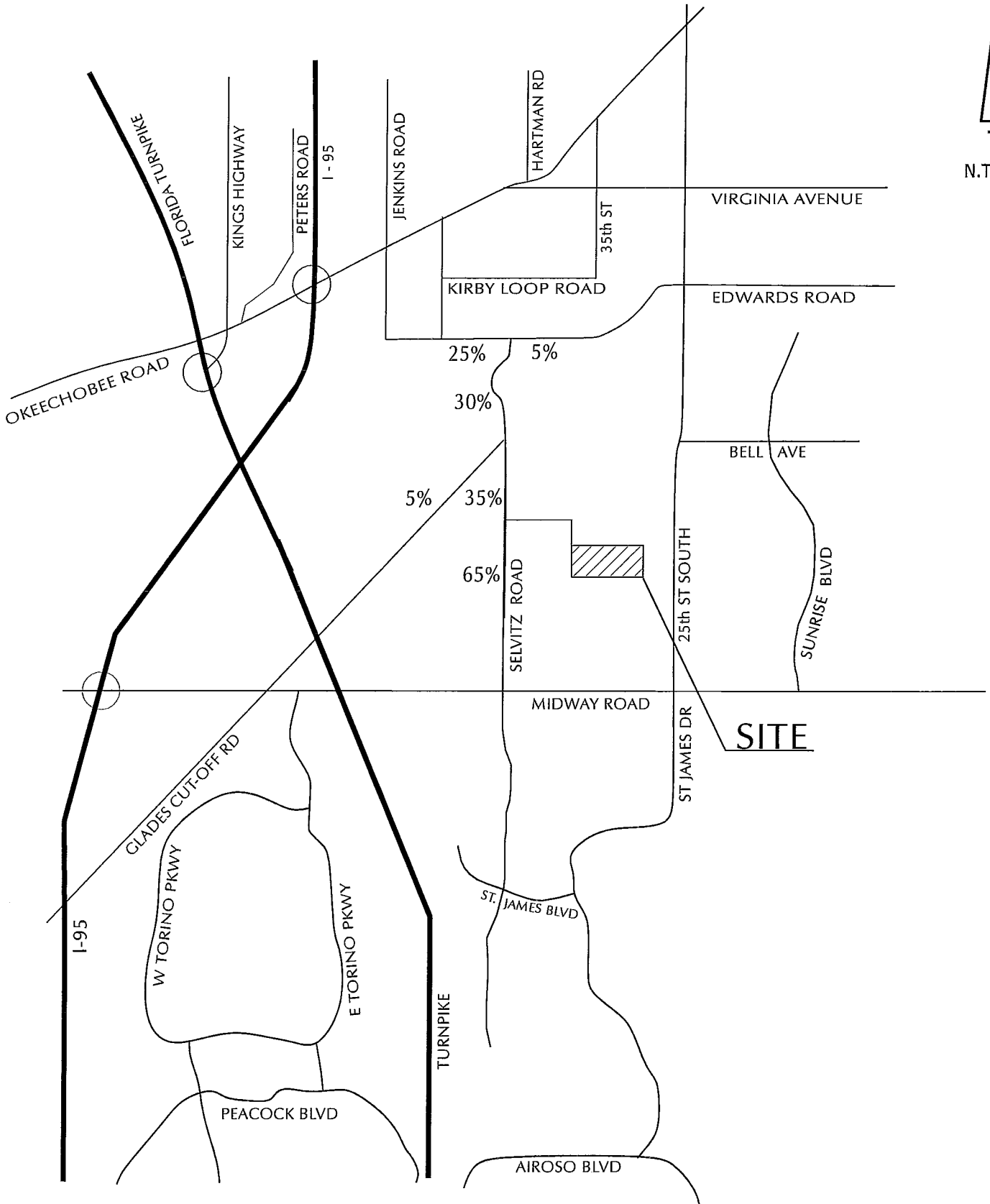

FT PIERCE PRECAST
CONCRETE PLANT

EXHIBIT 3A
PROJECT TRAFFIC DISTRIBUTION

8/22/16
16-071



Exhibit 3B
Ft Pierce Precast Concrete Plant
Project Traffic Assignment

AM Peak

Roadway	Link	Existing Lanes	Dir	Project Traffic		Total Project Impact	Service Volume (1)	Significant Impact? (Yes/No)
				124	In			
				25	Out			
				% Dist	Trips			
Selvitz Rd	Glades Cut Off Rd to Edwards Rd	2L	NB	30%	8	1.01%	790	No
			SB	30%	37	4.68%	790	No
	Site to Glades Cut-Off Rd (2)	2L	NB	35%	9	1.29%	700	YES
			SB	35%	43	6.14%	700	YES
	Midway Rd to Site (2)	2L	NB	65%	81	11.57%	700	YES
			SB	65%	16	2.29%	700	YES
Glades Cut-Off Rd	Jenkins Rd to Selvitz Rd	2L	EB	5%	6	0.72%	830	No
			WB	5%	1	0.12%	830	No
Edwards Rd	McNeil Rd to Selvitz Rd	2L	EB	25%	31	4.43%	700	No
			WB	25%	6	0.86%	700	No
	Selvitz Rd to 25th Street	2L	EB	5%	1	0.11%	880	No
			WB	5%	6	0.68%	880	No

(1) Source: St. Lucie TPO, Traffic Counts and Level of Service Report, Fall 2015.
(2) First accessed roadway link.

Exhibit 3C
Ft Pierce Precast Concrete Plant
Project Traffic Assignment

PM Peak

Roadway	Link	Existing Lanes	Dir	Project Traffic		Total Project Impact	Service Volume (1)	Significant Impact? (Yes/No)
				36	In			
				126	Out			
				% Dist	Trips			
Selvitz Rd	Glades Cut Off Rd to Edwards Rd	2L	NB	30%	38	4.81%	790	No
			SB	30%	11	1.39%	790	No
	Site to Glades Cut-Off Rd (2)	2L	NB	35%	44	6.29%	700	YES
			SB	35%	13	1.86%	700	YES
	Midway Rd to Site (2)	2L	NB	65%	23	3.29%	700	YES
			SB	65%	82	11.71%	700	YES
Glades Cut-Off Rd	Jenkins Rd to Selvitz Rd	2L	EB	10%	4	0.48%	830	No
			WB	10%	13	1.57%	830	No
Edwards Rd	McNeil Rd to Selvitz Rd	2L	EB	25%	9	1.29%	700	No
			WB	25%	32	4.57%	700	No
	Selvitz Rd to 25th Street	2L	EB	5%	6	0.68%	880	No
			WB	5%	2	0.23%	880	No

(1) Source: St. Lucie TPO, Traffic Counts and Level of Service Report, Fall 2015.

(2) First accessed roadway link.

**Exhibit 4A
Ft Pierce Precast Concrete Plant
Historic Growth - Three Year**

Roadway	Link	AADT		Growth Rate
		Traffic Volumes ⁽¹⁾ 2012	2015	
Edwards Rd	McNeil Rd to Selvitz Rd	10,270	9,300	-3.25% /Year
	Selvitz Rd to 25th St	11,807	15,500	9.50% /Year (2)
Selvitz Rd	Glades Cut-Off Rd to Edwards Rd	10,000	11,500	4.77% /Year
	Midway Rd to Glades Cut-Off Rd	6,900	8,100	5.49% /Year
Glades Cut-Off Road	Jenkins Rd to Selvitz Rd	4,815	4,955	0.96% /Year
Areawide		31,985	33,855	1.91% /Year

(1) Count data from St. Lucie County. See Appendix B.

(2) Removed due to abnormally high growth rate.

**Exhibit 4B
Ft Pierce Precast Concrete Plant
Historic Growth (2008 to 2015)**

Roadway	Link	AADT		Growth Rate
		Traffic Volumes (1) 2008	2015	
Edwards Rd	McNeil Rd to Selvitz Rd	9,725	9,300	-0.64% /Year
	Selvitz Rd to 25th St	13,195	15,500	2.33% /Year
Selvitz Rd	Glades Cut-Off Rd to Edwards Rd	N/A	11,500	N/A /Year
	Midway Rd to Glades Cut-Off Rd	N/A	8,100	N/A /Year
Glades Cut-Off Road	Jenkins Rd to Selvitz Rd	5,920	4,955	-2.51% /Year
Areawide		28,840	29,755	1.05% /Year

(1) Count data from St. Lucie County. See Appendix B.

N/A: Not Available.

**Exhibit 5
Ft Pierce Precast Concrete Plant
Intersection Analysis (1)**

Intersection	2021 AM Peak Hour		2021 PM Peak Hour	
	Inters. Delay (sec)	LOS	Inters. Delay (sec)	LOS
Midway Rd / Selvitz Road	43.4	D	43.2	D
Selvitz Rd / Edwards Road	33.3	C	36.9	D

(1) See Appendix D for intersection capacity analyses.

**Exhibit 6
Ft Pierce Precast Concrete Plant
Link Analysis**

Roadway	Link	Lanes	Dir	AM PEAK HOUR										
				Existing (2015) ⁽¹⁾	Committed Dev. Analysis ⁽²⁾		Growth (2021)		Total Bkgd. ⁽³⁾	Project	Total (2021)	Service Volume	Meets Std?	
					Projects	Growth	Total	Volume						%/Year
Selvitz Road	Site to Glades Cut-Off Road	2L	NB	489	19	30	49	59	1.91%	548	9	557	700	Yes
			SB	489	47	30	77	59	1.91%	566	43	609	700	Yes
	Midway Rd to Site	2L	NB	489	46	30	76	59	1.91%	565	81	646	700	Yes
			SB	489	20	30	50	59	1.91%	548	16	564	700	Yes

Roadway	Link	Lanes	Dir	PM PEAK HOUR										
				Existing (2015) ⁽¹⁾	Committed Dev. Analysis ⁽²⁾		Growth (2021)		Total Bkgd. ⁽³⁾	Project	Total (2021)	Service Volume	Meets Std?	
					Projects	Growth	Total	Volume						%/Year
Selvitz Road	Site to Glades Cut-Off Road		NB	528	55	32	87	63	1.91%	615	44	660	700	Yes
			SB	528	34	32	66	63	1.91%	594	13	607	700	Yes
	Midway Rd to Site		NB	528	34	32	66	63	1.91%	594	23	618	700	Yes
			SB	528	55	32	87	63	1.91%	615	82	697	700	Yes

⁽¹⁾ Count data from St. Lucie County. See Appendix B.

⁽²⁾ Committed development data provided in Appendix C.

⁽³⁾ Background traffic includes Existing plus the highest of Committed Development and 1% growth or historic growth.

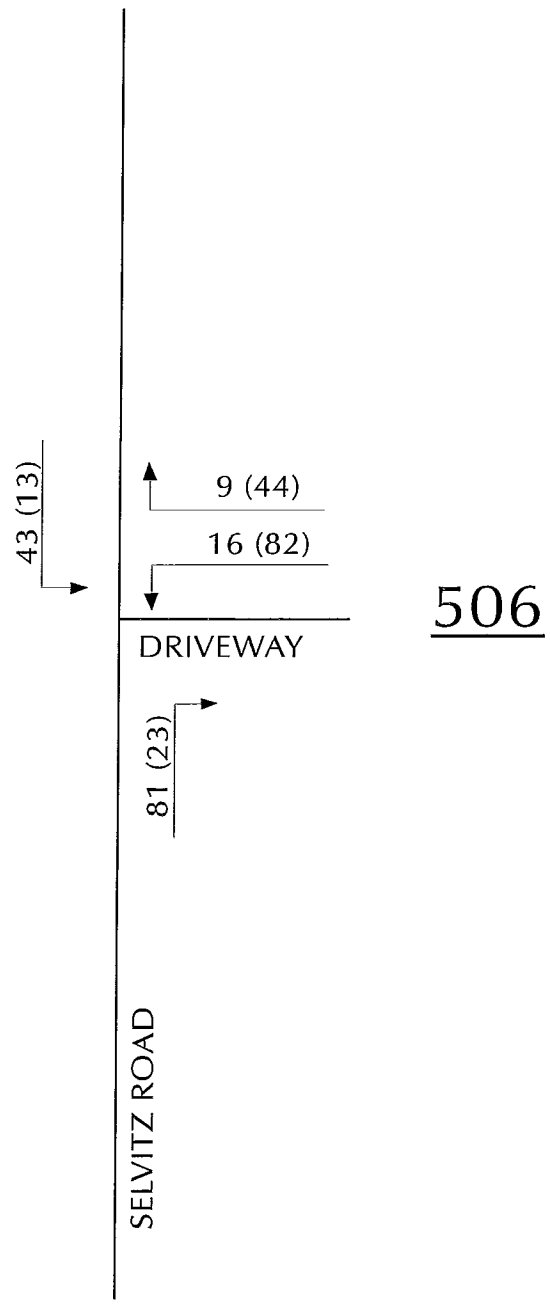

LEGEND

5 - AM Peak Hour
(26) - PM Peak Hour
506 - ADT

8/25/16
16-071

FT PIERCE PRECAST
CONCRETE PLANT

EXHIBIT 7
PROJECT DRIVEWAY VOLUMES



APPENDIX A



Transportation Consultants



2005 Vista Parkway, Suite 111
West Palm Beach, FL 33411-6700
(561) 296-9698 Fax (561) 684-6336
Certificate of Authorization Number: 7989

August 23, 2016

Mr. Kori Benton, MPA
Senior Planner
City of Ft. Pierce Planning Department
100 North US Hwy 1
Fort Pierce, Florida 34950

Re: Ft. Pierce Pre-Cast Concrete Plant - #PTC16-071
Methodology Statement

Dear Mr. Benton:

The purpose of this letter is to provide a traffic methodology statement for a Traffic Impact Statement for a proposed commercial project. The 75-acre site is located on the east of Selvitz Road, south of Glades Cut-Off Road in the City of Ft Pierce. It is proposed to develop a Pre-Cast Concrete Plant facility with access to Selvitz Road as shown on the attached preliminary site plan. A 5-year buildout is proposed.

Traffic Impact Statement

The trip generation is shown on Attachment 1. The rates are based on ITE, Trip Generation Manual, 9th Edition. No internalization or pass-by rates are proposed for this heavy industrial use. Based on the trip generation, the radius of development influence (RDI) is one mile. Midway Road from Selvitz Road to 25th Street is currently under construction from a two-lane to a four-lane facility. Midway Road from 25th Street to US 1 is funded for construction as a four-lane facility this year. No other roadway improvements within the RDI are programmed for construction. The proposed project traffic distribution, which is based on a review of land use patterns and previously approved traffic studies is provided on Attachment 2.

The roadway link analyses will be based on AM and PM peak-hour directional traffic. The service volumes and existing traffic counts will be obtained from the St. Lucie TPO "Traffic Counts and Level of Service Report, Fall 2015." The roadway segments will be analyzed for: the directly accessed Major Road, where the Project traffic consumes one percent or more of the directional capacity, and the Major Road within the RDI where Project traffic consumes five percent or more of the directional capacity. The major signalized intersections within the RDI and within a significantly impacted roadway segment will also be analyzed.

Analyses will be conducted for Existing Conditions, Background Conditions and Background + Project Conditions. Background growth will be based on a three-year areawide historic growth for the links within the one mile RDI. If committed project traffic data is available from St. Lucie County, then the greater of historic growth or "committed plus 1% growth" will be used.

Mr. Benton
Re: Ft. Pierce Concrete Plant - #PTC16-071
August 23, 2016
Page 2 of 2

We are requesting your review and approval of the above methodology. We are also requesting that you provide the following information:

- Committed development traffic data for the radius of development influence.

If you have any questions, please do not hesitate to contact this office.

Sincerely,

A handwritten signature in black ink, appearing to read "Linda Riccardi". The signature is fluid and cursive, with a large initial "L" and "R".

Linda Riccardi, P.E.
Project Manager

Attachments

**Attachment 1
Fort Pierce Pre-Cast Concrete Plant
Trip Generation**

DAILY

Land Use	ITE Code	Intensity	Trip Generation Rate (1)	Total Trips
General Heavy Industrial	120	75 Acre	6.75 /Acre	506
TOTALS				506

AM PEAK HOUR

Land Use	ITE Code	Intensity	Trip Generation Rate (1)	Total Trips	
				In	Out
General Heavy Industrial	120	75 Acre	1.98 /Acre (83/17)	124	25
TOTALS				124	25

PM PEAK HOUR

Land Use	ITE Code	Intensity	Trip Generation Rate (1)	Total Trips	
				In	Out
General Heavy Industrial	120	75 Acre	2.16 /Acre (22/78)	36	126
TOTALS				36	126

(1) Source: Palm Beach County and Institute of Transportation Engineers (ITE), Trip Generation, 9th Edition. Used peak hour in/out percentages from General Light Industrial, ITE Code 110.

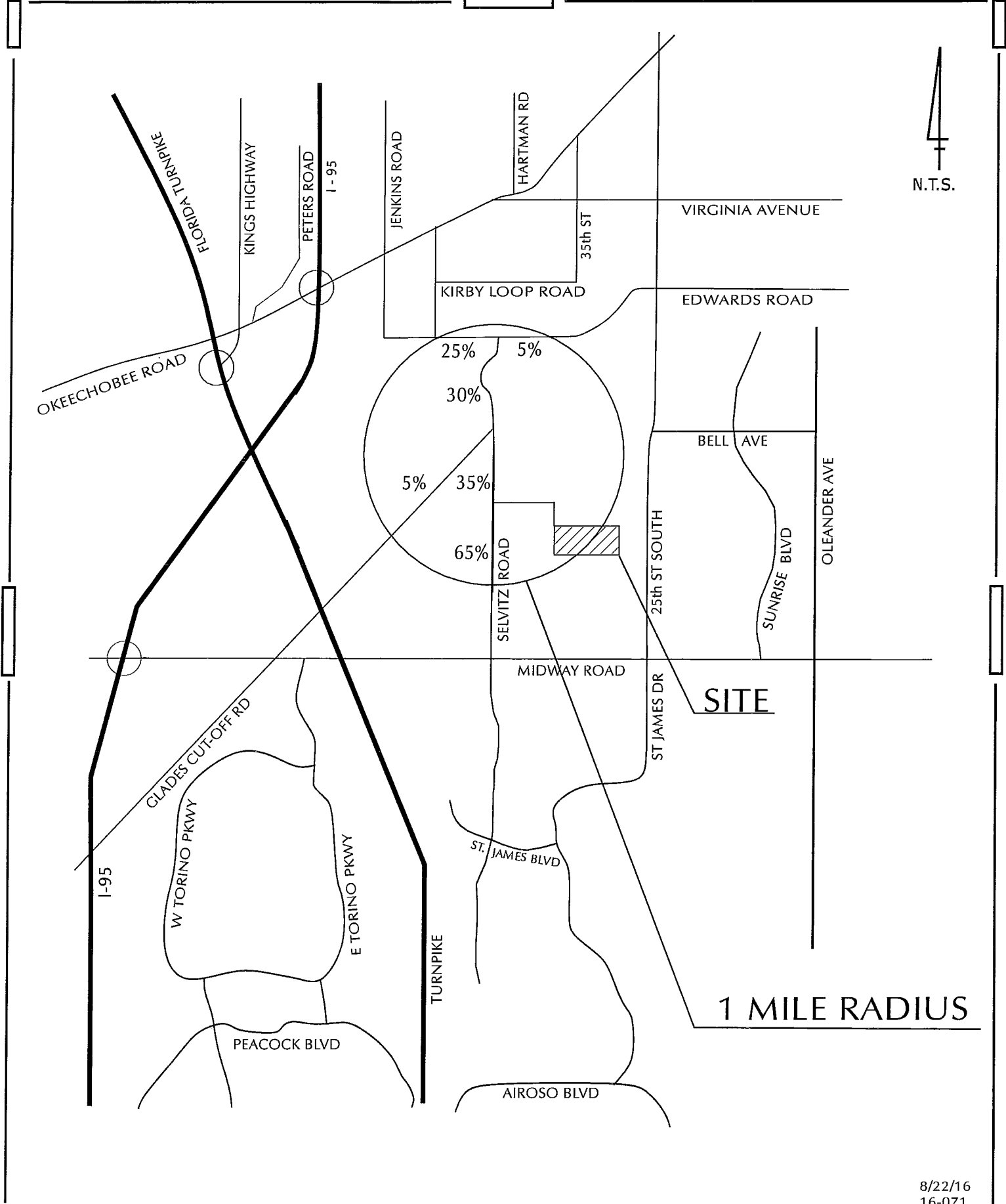

1 MILE RADIUS

FT PIERCE PRE-CAST
CONCRETE PLANT

ATTACHMENT 2
PROJECT TRAFFIC DISTRIBUTION

8/22/16
16-071
PTC

APPENDIX B

2015

Transportation
Planning
Organization

St. Lucie



Coco Vista Centre
466 SW Port St. Lucie Blvd, Suite 111
Port St. Lucie, FL 34953
772-462-1593 www.stluciepo.org

Traffic Counts and Level of Service Report
Fall 2015

Roadway Name	Location	AADT	Pk Hr Service Capacity	AM Pk Hr Pk Dir			PM Pk Hr Pk Dir		
				Volume	LOS	V/C	Volume	LOS	V/C
DELAWARE AVE	HARTMAN RD to 33RD ST	1,133	600	244	C	0.813	171	C	0.570
DELAWARE AVE	33RD ST to 25TH ST	3,725	1,710	274	C	0.356	279	C	0.362
DELAWARE AVE	25TH ST to OKEECHOBEE RD	4,500	1,220	0	B	0.000	0	B	0.000
DELAWARE AVE	OKEECHOBEE RD to 13TH ST	8,833	790	454	D	0.575	484	D	0.613
DELAWARE AVE	13TH ST to 10TH ST	7,325	750	409	D	0.545	389	D	0.519
DELAWARE AVE	10TH ST to 7TH ST	7,325	600	409	D	0.682	389	D	0.648
DELAWARE AVE	7TH ST to US 1	7,800	750	436	D	0.581	419	D	0.559
EAST TORINO PKWY	CASHMERE BLVD to TORINO PKWY	6,471	830	446	C	0.572	372	C	0.477
EAST TORINO PKWY	TORINO PKWY to MIDWAY RD	12,500	880	856	D	0.973	755	C	0.910
EASY ST	US 1 to BUCHANAN DR	10,703	750	895	F	1.119	703	D	0.937
EASY ST	BUCHANAN DR to YUCCA DR	10,703	540	895	F	1.543	703	F	1.212
EDWARDS RD	JENKINS RD to MCNEIL RD	9,300	630	467	C	0.778	465	C	0.775
EDWARDS RD	MCNEIL RD to SELVITZ RD	9,300	700	467	C	0.708	465	C	0.705
EDWARDS RD	SELVITZ RD to 25TH ST	15,500	880	928	F	1.055	946	F	1.075
EDWARDS RD	25TH ST to SUNRISE BLVD	13,500	1,630	741	D	0.455	1,021	D	0.626
EDWARDS RD	SUNRISE BLVD to OLEANDER AVE	14,000	1,630	701	C	0.960	684	C	0.937
EDWARDS RD	OLEANDER AVE to US 1	9,200	1,630	444	C	0.608	444	C	0.608
FARMER'S MARKET RD	OLEANDER AVE to US 1	1,800	750	117	C	0.316	103	C	0.278
FLORESTA DR	OAKLYN ST to PORT ST LUCIE BLVD	11,000	920	835	C	0.960	648	C	0.745
FLORESTA DR	THORNHILL DR to CROSSTOWN PKWY	17,000	880	1,221	F	1.387	1,062	F	1.207
FLORESTA DR	PORT ST LUCIE BLVD to THORNHILL DR	17,000	880	1,221	F	1.387	1,062	F	1.207
FLORESTA DR	CROSSTOWN PKWY to PRIMA VISTA BLVD	12,000	920	801	C	0.921	705	C	0.810
FLORESTA DR	PRIMA VISTA BLVD to AIROSO BLVD	9,400	920	526	C	0.605	586	C	0.674
FLORESTA DR	SELVITZ RD to BAYSHORE BLVD	3,400	630	273	C	0.455	264	C	0.440
FLORESTA DR	AIROSO BLVD to SELVITZ RD	3,400	880	273	C	0.329	264	C	0.318
FT PIERCE BLVD	INDRIO RD to EMERSON AVE	3,500	540	268	C	0.993	211	C	0.781
GARDENIA AVE	OLEANDER AVE to US 1	2,667	750	201	C	0.543	189	C	0.511
GATLIN BLVD	W OF I-95 to E OF I-95	40,950	3,170	3,082	C	0.997	2,512	C	0.813
GATLIN BLVD	E OF I-95 to SAVAGE BLVD	40,950	3,170	3,082	C	0.997	2,512	C	0.813

* Volumes shown were adjusted using FDOT Seasonal Factors

* AADT = Annual Average Daily Traffic

2015



Coco Vista Centre
466 SW Port St. Lucie Blvd, Suite 111
Port St. Lucie, FL 34953
772-462-1593 www.stlucietpo.org

Traffic Counts and Level of Service Report
Fall 2015

Roadway Name	Location	AADT	Pk Hr Service Capacity	AM Pk Hr Pk Dir			PM Pk Hr Pk Dir		
				Volume	LOS	V/C	Volume	LOS	V/C
GATLIN BLVD	SAVAGE BLVD to ROSSER BLVD	40,950	3,170	3,082	C	0.997	2,512	C	0.813
GATLIN BLVD	ROSSER BLVD to SAVONA BLVD	40,950	3,170	3,082	C	0.997	2,512	C	0.813
GATLIN BLVD	SAVONA BLVD to PORT ST LUCIE BLVD	40,950	3,170	3,082	C	0.997	2,512	C	0.813
GEORGIA AVE	25TH ST to OKEECHOBEE RD	4,233	600	234	C	0.780	232	C	0.773
GEORGIA AVE	OKEECHOBEE RD to 17TH ST	4,233	750	234	C	0.632	232	C	0.627
GEORGIA AVE	17TH ST to 13TH ST	5,200	600	274	C	0.913	272	C	0.907
GEORGIA AVE	13TH ST to 7TH ST	2,300	600	151	C	0.503	160	C	0.533
GEORGIA AVE	7TH ST to US 1	1,800	600	130	C	0.433	121	C	0.403
GILSON RD	MARTIN C.L. to BECKER RD	9,100	710	798	F	1.050	778	F	1.024
GILSON RD	BECKER RD to LAKERIDGE DR	9,100	540	798	F	1.376	778	F	1.341
GLADES CUT-OFF RD	RANGE LINE RD to RESERVE BLVD	2,200	1,070	185	B	0.487	205	B	0.539
GLADES CUT-OFF RD	RESERVE BLVD to COMMERCE CENTER DR	2,762	1,070	375	B	0.987	325	B	0.855
GLADES CUT-OFF RD	CARLTON RD to RANGE LINE RD	2,200	390	185	B	0.841	205	B	0.932
GLADES CUT-OFF RD	COMMERCE CENTER DR to MIDWAY RD	2,220	920	169	C	0.194	154	C	0.177
GLADES CUT-OFF RD	MIDWAY RD to JENKINS RD	6,795	790	455	D	0.576	405	D	0.513
GLADES CUT-OFF RD	JENKINS RD to SELVITZ RD	4,955	830	304	C	0.390	274	C	0.351
GRAHAM RD	KINGS HWY to JENKINS RD	3,733	630	257	C	0.428	224	C	0.373
GREEN RIVER PKWY	MARTIN C.L. to CHARLESTON DR	4,100	1,070	309	B	0.813	309	B	0.813
GREEN RIVER PKWY	CHARLESTON DR to MELALEUCA BLVD	4,100	1,070	309	B	0.813	309	B	0.813
GREEN RIVER PKWY	MELALEUCA BLVD to WALTON RD	4,100	1,070	309	B	0.813	309	B	0.813
HARTMAN RD	OKEECHOBEE RD to PETERSON RD	6,267	750	459	D	0.612	397	D	0.529
HARTMAN RD	PETERSON RD to DELAWARE AVE	6,267	540	459	D	0.850	397	D	0.735
HARTMAN RD	DELAWARE AVE to ORANGE AVE	6,267	790	459	D	0.581	397	D	0.503
HEADER CANAL RD	OKEECHOBEE RD to ORANGE AVE	500	670	29	B	0.132	29	B	0.132
HILLMOOR DR	US 1 to LENNARD RD	3,200	790	204	C	0.523	239	C	0.613
I-95	GATLIN BLVD to ST LUCIE WEST BLVD	74,660	4,580	3,823	C	0.835	3,453	C	0.754
I-95	ST LUCIE WEST BLVD to MIDWAY RD	55,171	4,580	3,103	B	0.924	2,676	B	0.796
I-95	MIDWAY RD to OKEECHOBEE RD	66,916	4,580	4,039	C	0.882	3,280	B	0.976
I-95	OKEECHOBEE RD to ORANGE AVE	45,500	7,320	1,822	B	0.405	1,894	B	0.421

* Volumes shown were adjusted using FDOT Seasonal Factors
* AADT = Annual Average Daily Traffic

2015



Coco Vista Centre
466 SW Port St. Lucie Blvd, Suite 111
Port St. Lucie, FL 34953
772-462-1593 www.stlucietpo.org

Traffic Counts and Level of Service Report
Fall 2015

Roadway Name	Location	AADT	Pk Hr Service Capacity	AM Pk Hr Pk Dir		PM Pk Hr Pk Dir			
				Volume	LOS	V/C	Volume	LOS	V/C
PORT ST LUCIE BLVD	FLORIDA'S TURNPIKE to BAYSHORE BLVD	48,787	3,170	3,262	F	1.029	2,961	C	0.958
PORT ST LUCIE BLVD	BAYSHORE BLVD to AIROSO BLVD	47,763	3,020	3,019	D	1.000	2,991	D	0.990
PORT ST LUCIE BLVD	AIROSO BLVD to FLORESTA DR	48,832	3,020	3,006	D	0.995	2,634	C	0.896
PORT ST LUCIE BLVD	FLORESTA DR to VETERANS MEMORIAL PKWY	63,490	3,020	4,550	F	1.507	3,393	F	1.124
PORT ST LUCIE BLVD	VETERANS MEMORIAL PKWY to MORNINGSIDE BLVD	42,408	3,020	2,552	C	0.868	2,264	C	0.770
PORT ST LUCIE BLVD	MORNINGSIDE BLVD to US 1	41,158	3,170	3,126	D	0.986	1,949	C	0.631
PRIMA VISTA BLVD	BAYSHORE BLVD to AIROSO BLVD	21,500	2,100	971	C	0.483	976	C	0.486
PRIMA VISTA BLVD	AIROSO BLVD to FLORESTA DR	21,500	2,100	1,149	C	0.572	998	C	0.497
PRIMA VISTA BLVD	FLORESTA DR to NARANJA AVE	34,000	2,100	2,246	F	1.070	1,747	C	0.869
PRIMA VISTA BLVD	NARANJA AVE to RIO MAR DR	34,000	2,000	2,246	F	1.123	1,747	C	0.915
PRIMA VISTA BLVD	RIO MAR DR to US 1	29,556	2,100	1,588	C	0.790	1,329	C	0.661
PRIMA VISTA BLVD	US 1 to LENNARD RD	2,467	1,710	167	C	0.217	151	C	0.196
RANGE LINE RD	MARTIN C.L. to BECKER RD	1,700	1,080	135	B	0.329	164	B	0.400
RANGE LINE RD	BECKER RD to 2 MI S OF GLADES CUT-OFF RD	1,700	1,080	135	B	0.329	164	B	0.400
RANGE LINE RD	2 MI S OF GLADES CUT-OFF RD to GLADES CUT-OFF...	1,700	1,080	135	B	0.329	164	B	0.400
RIO MAR DR	PRIMA VISTA BLVD to BEACH AVE	5,358	750	327	C	0.884	371	D	0.495
RIO MAR DR	BEACH AVE to US 1	5,358	790	327	C	0.838	371	C	0.951
ROSSER BLVD	APRICOT RD to GATLIN BLVD	9,800	920	0	B	0.000	0	B	0.000
ROSSER BLVD	PAAR DR to APRICOT RD	9,800	1,070	0	B	0.000	0	B	0.000
SAVONA BLVD	BECKER RD to PAAR DR	7,800	790	726	D	0.919	656	D	0.830
SAVONA BLVD	PAAR DR to GATLIN BLVD	7,800	750	726	D	0.968	656	D	0.875
SAVONA BLVD	GATLIN BLVD to CALIFORNIA BLVD	13,500	790	712	D	0.901	790	D	1.000
SAVAGE BLVD	GATLIN BLVD to GALIANO RD	2,100	920	144	C	0.166	130	C	0.149
SAVANNAH RD	US 1 to INDIAN RIVER DR	2,100	540	130	C	0.481	142	C	0.526
SELVITZ RD	BAYSHORE BLVD to ST JAMES BLVD	7,200	750	0	B	0.000	0	B	0.000
SELVITZ RD	ST JAMES BLVD to MIDWAY RD	7,200	750	0	B	0.000	0	B	0.000
SELVITZ RD	MIDWAY RD to GLADES CUT-OFF RD	8,100	700	489	C	0.741	528	C	0.800
SELVITZ RD	GLADES CUT-OFF RD to EDWARDS RD	11,500	790	729	D	0.923	661	D	0.837
SHINN RD	MIDWAY RD to OKEECHOBEE RD	600	580	47	C	0.092	44	C	0.086

* Volumes shown were adjusted using FDOT Seasonal Factors
* AADT = Annual Average Daily Traffic

2012



Coco Vista Centre
466 SW Port St. Lucie Blvd, Suite 111
Port St. Lucie, FL 34953
772-462-1593 www.stluciepo.org

**Traffic Counts and Level of Service Report
Fall 2012**

Roadway Name	Location	AADT	PKWT Service Capacity	AM PKWHPK/DI		PM PKWHPK/DI	
				Volume	V/C	Volume	V/C
CORTEZ BLVD	25TH STREET to SUNRISE BLVD	2,400	570	159	B	0.279	B
COUNTRY CLUB DR	ST LUCIE WEST BLVD to CALIFORNIA BLVD	6,000	1,340	336	B	0.251	B
CROSTOWN PKWY	VILLAGE PKWY to I-95	5,100	1,850	297	B	0.161	B
CROSTOWN PKWY	I-95 to CALIFORNIA BLVD	13,000	2,780	956	B	0.344	B
CROSTOWN PKWY	CALIFORNIA BLVD to CASHMERE BLVD	14,000	2,780	855	B	0.308	B
CROSTOWN PKWY	CASHMERE BLVD to CAMEO BLVD	16,500	2,780	860	B	0.309	B
CROSTOWN PKWY	CAMEO BLVD to BAYSHORE BLVD	20,000	2,670	1,036	C	0.388	C
CROSTOWN PKWY	BAYSHORE BLVD to AIROSO BLVD	12,500	2,780	686	B	0.247	B
CROSTOWN PKWY	AIROSO BLVD to SANDIA DR	7,100	2,670	426	C	0.160	C
CROSTOWN PKWY	SANDIA DR to OCEAN LN	4,800	600	255	B	0.425	B
CROSTOWN PKWY	OCEAN LN to FLORESTA DR	3,900	460	243	B	0.528	B
CROSSROADS PKWY	OKEECHOBEE RD to KINGS HWY	550	600	43	B	0.072	B
DARWIN BLVD	BECKER RD to PAAR DR	5,040	630	459	C	0.729	C
DARWIN BLVD	PAAR DR to TULIP BLVD	5,040	830	459	B	0.553	B
DARWIN BLVD	TULIP BLVD to PORT ST LUCIE BLVD	11,916	830	731	C	0.881	D
DEL RIO BLVD	PORT ST LUCIE BLVD to CALIFORNIA BLVD	11,940	830	730	C	0.880	C
DEL RIO BLVD	CALIFORNIA BLVD to CASHMERE BLVD	8,200	790	477	C	0.604	B
DEL RIO BLVD	CASHMERE BLVD to CALIFORNIA BLVD	4,000	790	253	B	0.320	B
DELAWARE AVE	HARTMAN RD to 33RD ST	2,300	580	375	C	0.647	C
DELAWARE AVE	33RD ST to 25TH ST	4,640	1,670	272	C	0.163	C
DELAWARE AVE	17TH ST to 13TH ST	11,000	770	564	D	0.732	D
DELAWARE AVE	13TH ST to 10TH ST	7,900	730	508	D	0.696	C
DELAWARE AVE	10TH ST to 7TH ST	7,900	580	508	D	0.876	D
DELAWARE AVE	7TH ST to US 1	6,800	570	414	D	0.726	D
EASY ST	US 1 to LENNARD EXTENSION RD	12,403	570	1,011	F	1.774	F
EASY ST	LENNARD EXTENSION RD to YUCCA DR	12,403	460	1,011	F	2.198	F
EDWARDS RD	JENKINS RD to MC NEIL RD	10,270	630	549	C	0.871	C
EDWARDS RD	MC NEIL RD to SELVITZ RD	10,270	630	549	C	0.871	C
EDWARDS RD	SELVITZ RD to 25TH ST	11,807	790	637	C	0.806	C

* Volumes shown were adjusted using FDOT Seasonal Factors
* AADT = Annual Average Daily Traffic

2012



Coco Vista Centre
466 SW Port St. Lucie Blvd, Suite 111
Port St. Lucie, FL 34953
772-462-1593 www.stlucietpo.org

Traffic Counts and Level of Service Report
Fall 2012

Roadway Name	Location	AADT	P-Hr Service Capacity	AMPHR-PC-DIT		BMP-PTI-PK-DII	
				Volume	LOS	Volume	LOS
GLADES CUT-OFF RD	RESERVE BLVD to COMMERCE CENTER DR	2,817	1,120	400	B	348	B
GLADES CUT-OFF RD	MARTIN COUNTY LINE to RANGE LINE RD	1,800	430	135	B	153	B
GLADES CUT-OFF RD	COMMERCE CENTER DR to MIDWAY RD	2,033	830	154	B	141	B
GLADES CUT-OFF RD	MIDWAY RD to JENKINS RD	6,583	830	456	B	430	B
GLADES CUT-OFF RD	JENKINS RD to SELVITZ RD	4,815	830	313	B	282	B
GRAHAM RD	KINGS HWY to JENKINS RD	2,800	460	219	B	175	B
GREEN RIVER PKWY	BERKSHIRE BLVD to MARIPOSA AVE	3,267	1,140	228	B	208	B
GREEN RIVER PKWY	MARIPOSA AVE to MELALEUCA	3,267	1,140	228	B	208	B
GREEN RIVER PKWY	MELALEUCA to WALTON RD	3,267	1,140	228	B	208	B
HARTMAN RD	OKEECHOBEE RD to PETERSON RD	4,800	790	302	B	297	B
HARTMAN RD	PETERSON RD to DELAWARE AVE	4,800	630	302	B	297	B
HARTMAN RD	DELAWARE AVE to ORANGE AVE	4,800	770	302	C	297	C
HEADER CANAL RD	OKEECHOBEE RD to ORANGE AVE	444	740	32	B	29	B
HILLMOOR DR	TIFFANY AVE to LENNARD RD	3,800	600	229	B	268	B
INDIAN RIVER DR	MARTIN COUNTY LINE to WALTON RD	5,257	1,140	358	B	383	B
INDIAN RIVER DR	WALTON RD to MIDWAY RD	4,349	1,140	336	B	306	B
INDIAN RIVER DR	MIDWAY RD to SAVANNAH RD	5,265	1,140	456	C	475	C
INDIAN RIVER DR	SAVANNAH RD to CITRUS AVE	3,057	1,140	286	B	289	B
INDIAN RIVER DR	CITRUS AVE to ORANGE AVE	4,740	770	282	C	323	C
INDIAN RIVER DR	ORANGE AVE to AVENUE A	4,866	790	284	B	277	B
INDIAN RIVER DR	AVENUE D to SEAWAY DR	6,005	750	351	D	413	D
INDIAN RIVER DR	AVENUE A to AVENUE D	6,005	630	351	B	413	C
INDRIO RD	3 MILES WEST OF I-95 to INTERSTATE 95 - WEST...	1,385	1,120	101	B	109	B
INDRIO RD	INTERSTATE 95 - WEST RAMPS to INTERSTATE 95 ...	1,385	3,130	101	B	109	B
INDRIO RD	INTERSTATE 95 - EAST RAMPS to KOBLEGARD RD	9,955	3,130	569	B	598	B
INDRIO RD	KOBLEGARD RD to JOHNSTON RD	9,955	640	569	C	598	C
INDRIO RD	JOHNSTON RD to EMERSON RD	9,955	800	569	C	598	C
INDRIO RD	EMERSON RD to KINGS HWY	9,892	840	596	C	502	C
INDRIO RD	KINGS HWY to US 1	5,752	920	457	B	411	B

* Volumes shown were adjusted using FDOT Seasonal Factors

* AADT = Annual Average Daily Traffic

2012



Traffic Counts and Level of Service Report
Fall 2012

Coco Vista Centre
466 SW Port St. Lucie Blvd, Suite 111
Port St. Lucie, FL 34953
772-462-1593 www.stluciepo.org

Roadway Name	Location	AADT	Priority Service Capacity	AM PR HT PE DIT		PM PR HT PE DIT			
				Volume	LOS	Volume	LOS	V/C	V/C
RANGE LINE RD	MARTIN COUNTY LINE to BECKER RD.	1,503	740	123	B	126	B	0.166	0.170
RANGE LINE RD	BECKER RD to GATLIN BLVD	1,503	740	123	B	126	B	0.166	0.170
RANGE LINE RD	GATLIN BLVD to GLADES CUT-OFF RD	1,503	740	123	B	126	B	0.166	0.170
RIO MAR DR	PRIMA VISTA BLVD to BEACH AVE	5,627	790	340	B	377	B	0.430	0.477
RIO MAR DR	BEACH AVE to US 1	5,627	600	340	D	377	D	0.567	0.628
SAVONA BLVD	BECKER RD to PAAR DR	5,157	830	519	C	452	B	0.625	0.545
SAVONA BLVD	PAAR DR to GATLIN BLVD	5,157	790	519	C	452	B	0.657	0.572
SAVONA BLVD	GATLIN BLVD to CALIFORNIA	11,500	830	602	C	622	C	0.725	0.749
SAVAGE BLVD	GATLIN BLVD to SW IMPORT DR	3,592	830	215	B	235	B	0.259	0.283
SAVANNAH RD	US 1 to INDIAN RIVER DR	2,323	630	169	B	160	B	0.268	0.254
SELVITZ RD	MIDWAY RD to GLADES CUT-OFF RD	6,900	630	501	C	445	C	0.795	0.706
SELVITZ RD	GLADES CUT-OFF RD to EDWARDS RD	10,000	830	620	C	516	C	0.747	0.622
SHINN RD	MIDWAY RD to OKEECHOBEE RD	600	580	50	B	48	B	0.086	0.083
SHINN RD	OKEECHOBEE RD to ORANGE AVE	870	740	60	B	69	B	0.081	0.093
SNEED RD	OKEECHOBEE RD to ORANGE AVE	1,493	740	108	B	104	B	0.146	0.141
SR A1A NORTH	US 1 to OLD DIXIE HWY	4,710	660	318	D	318	D	0.482	0.482
SR A1A NORTH	OLD DIXIE HWY to SHOREWINDS DR	7,200	540	399	B	374	B	0.739	0.693
SR A1A NORTH	SHOREWINDS DR to INDIAN RIVER COUNTY LINE	6,803	920	366	B	401	B	0.398	0.436
SR A1A SOUTH	NETTLES ISLAND to FPL PLANT	5,977	920	366	B	328	B	0.398	0.357
SR A1A SOUTH	FPL PLANT to BLUE HERON BLVD	3,530	700	422	C	338	B	0.603	0.483
SR A1A SOUTH	SEAWAY DR to BLUE HERON BLVD	7,363	700	398	B	476	C	0.569	0.680
SR A1A SOUTH	BINNEY DR to SEAWAY DR	11,698	700	582	C	609	C	0.831	0.870
SR A1A SOUTH	SOUTH CAUSEWAY PARK to BINNEY DR	11,698	920	582	C	609	C	0.633	0.662
SR A1A SOUTH	INDIAN RIVER DR to SOUTH CAUSEWAY PARK	11,994	1,860	660	B	597	B	0.355	0.321
SR A1A SOUTH	INDIAN RIVER DR to US 1	11,994	660	660	D	597	D	1.000	0.905
ST JAMES DR	AIROSO BLVD to ST JAMES BLVD	18,563	2,060	1,387	B	1,288	B	0.673	0.625
ST JAMES DR	ST JAMES BLVD to PEACHTREE BLVD	17,810	1,860	1,276	C	1,227	C	0.686	0.660
ST JAMES DR	PEACHTREE BLVD to TELFORD AVE	18,563	1,960	1,387	B	1,288	B	0.708	0.657
ST JAMES DR	TELFORD AVE to MIDWAY RD	22,482	2,060	1,451	B	1,414	B	0.704	0.686

* Volumes shown were adjusted using FDOT Seasonal Factors

* AADT = Annual Average Daily Traffic

2008

St. Lucie County
Spring 2008 Traffic Count Analysis



Sta#	Roadway Name	Location	Roadway Classification	No. Ln	Count Date	ADT	LOS ¹	2008			2008		
								AM Peak Time	AM Pkhr Vol	AM LOS ²	PM Peak Time	PM Pkhr Vol	PM LOS ²
104	Bell Ave	W. of Sunrise Blvd	Other County Road	2	3/24/2008	2,646	C	745-845	277	C	1645-1745	249	C
234	California Blvd	S of St Lucie West Blvd	Major City/County Road	2	4/30/2008	16,898	F	730-830	1317	D	1645-1745	1427	E
233	California Blvd	N of St Lucie West Blvd	Major City/County Road	2	4/30/2008	7,576	C	715-815	580	C	1730-1830	678	C
231	Cashmere Blvd	N of St Lucie West Blvd	Major City/County Road	2	4/30/2008	10,410	D	700-800	975	D	1700-1800	860	C
232	Cashmere Blvd	S of St Lucie West Blvd	Major City/County Road	2	4/30/2008	15,271	E	800-900	1053	D	1715-1815	1335	D
0160	Citrus Ave	E. of US 1 South	State Two-Way Arterial - Interrupted Flow Class I	2	8/8/2007								
235	Darwin Rd	N. of Becker Rd	State Two-Way Arterial - Interrupted Flow Class I	2	5/12/2008	4,772	C	745-845	384	B	1700-1800	549	C
311	Del Rio Blvd	N. of Port St Lucie Blvd	Major City/County Road	2	5/7/2008	12,419	D	715-815	927	D	1700-1800	991	D
500	Delaware Ave	W. of 25th St South	Major City/County Road	4	3/5/2008	6,504	C	700-800	591	C	1645-1745	611	C
237	East Torino Pkwy	S of Midway Rd	Major City/County Road	2	5/14/2008	9,716	D	700-800	983	D	1645-1745	969	D
110	Edwards Rd	W. of 25th St South	State Two-Way Arterial - Interrupted Flow Class I	2	4/9/2008	13,195	C	715-815	1030	C	1630-1730	1176	C
174	Edwards Rd	W. of Selvitz Rd	State Two-Way Arterial - Interrupted Flow Class I	2	4/9/2008	9,725	B	760	760	C	1630-1730	871	C
108	Edwards Rd	W. of Sunrise Blvd	State Two-Way Arterial - Interrupted Flow Class I	4	4/9/2008	17,719	B	730-830	1544	B	1630-1730	1527	B
173	Edwards Rd	W. of US 1	State Two-Way Arterial - Interrupted Flow Class I	4	4/9/2008	9,003	B	730-830	723	B	1645-1745	802	B
502	Edwards Rd	W. of Oleander Ave	State Two-Way Arterial - Interrupted Flow Class I	4	4/9/2008	14,242	B	730-830	1119	B	1630-1730	1261	B
105	Emerson Ave	N. of Indrio Rd	State Two-Way Arterial - Uninterrupted Flow	2	2/20/2008	5,586	B	700-800	476	B	1645-1745	569	B
112	Farmer's Market Rd	W. of US 1 South	Other County Road	2	3/26/2008	2,314	C	1130-1230	208	C	1645-1745	204	C
109	Floresta Dr	S. of Prima Vista Blvd	State Two-Way Arterial - Interrupted Flow Class I	2	4/23/2008	13,458	C	730-830	1079	C	1700-1800	1199	C
313	Floresta Dr	W. of Airoso Blvd	Major City/County Road	2	4/23/2008	3,575	C	830-930	454	C	1515-1615	353	C
315	Floresta Dr	N. of Port St Lucie Blvd	State Two-Way Arterial - Interrupted Flow Class I	2	4/23/2008	17,493	F	730-830	1382	D	1700-1800	1554	D
317	Floresta Dr	S. of Port St Lucie Blvd	Major City/County Road	2	4/23/2008	11,930	D	730-830	991	D	1700-1800	1119	D
107	Floresta Dr	E. of Airoso Blvd	State Two-Way Arterial - Interrupted Flow Class I	2	5/7/2008	10,004	C	815-915	816	C	1700-1800	960	C
226	Fort Pierce Blvd	W. of West Seminole Rd	State Two-Way Arterial - Interrupted Flow Class I	2	2/20/2008	2,642	B	700-800	306	B	1630-1730	305	B
5075	Gatlin Blvd	E. of I-95	State Two-Way Arterial - Interrupted Flow Class I	4	8/27/2007								
0718	Gatlin Blvd	W. of Port St Lucie Blvd	State Two-Way Arterial - Interrupted Flow Class I	6	8/27/2007								
504	Georgia Ave	W. of US 1 South	Major City/County Road	2	3/6/2008	2,336	C	1145-1245	195	C	1645-1745	233	C
506	Georgia Ave	W. of 7th St South	Major City/County Road	2	3/5/2008	2,449	C	1115-1215	168	C	1700-1800	217	C
508	Georgia Ave	W. of 13th St South	Major City/County Road	2	3/5/2008	5,219	C	1115-1215	342	C	1630-1730	469	C
111	Gilson Rd	N. of Martin County Line	Major City/County Road	2	5/14/2008	11,451	D	715-815	973	D	1645-1745	1197	D
113	Glades Cut-Off Rd	W. of Selvitz Rd	Major City/County Road	2	2/25/2008	5,920	C	630-730	491	C	1615-1715	571	C
115	Glades Cut-Off Rd	N. of Midway Rd West	Major City/County Road	2	2/27/2008	4,703	C	615-715	425	C	1615-1715	434	C
117	Glades Cut-Off Rd	N. of Reserve Blvd	State Two-Way Arterial - Interrupted Flow Class I	2	3/19/2008	3,376	B	630-730	474	C	1515-1615	420	C
119	Glades Cut-Off Rd	S. of Reserve Blvd	State Two-Way Arterial - Interrupted Flow Class I	2	3/19/2008	2,528	B	630-730	423	C	1515-1615	348	B
229	Glades Cut-Off Rd	S. of Midway Rd West	State Two-Way Arterial - Interrupted Flow Class I	2	3/19/2008	2,605	B	630-730	292	B	1630-1630	279	B
319	Green River Pkwy	S. of Walton Rd	Major City/County Road	2	4/9/2008	2,839	C	715-815	210	C	1645-1745	305	C

St. Lucie TPO

Spring 2008 Traffic Counts

APPENDIX C

**Ft Pierce Precast Concrete Plant
Committed Development Traffic (1)**

Roadway	Link	Dir	AM PEAK HOUR											
			Lone Pine Subdiv. (2)		Becker/Carrriage House		Mariner Cove (2)		Midway Prof Plaza (3)		Total			
			In/Out:	Distr.	In/Out:	Distr.	In/Out:	Distr.	In/Out:	Distr.	In/Out:	Distr.		
Selvitz Road	Site to Glades Cut-Off Road	NB	5	-	40	14	16	24	19	5%	35%	5%	7%	2
		SB	16	1	121	42	80	6	47	5%	35%	5%	7%	-
	Midway Rd to Site	NB	-	-	42	42	4	-	46	5%	35%	5%	7%	-
		SB	1	1	14	14	1	2	20	5%	35%	5%	7%	2

Roadway	Link	Dir	PM PEAK HOUR											
			Lone Pine Subdiv. (2)		Becker/Carrriage House		Mariner Cove (2)		Midway Prof Plaza (3)		Total			
			In/Out:	Distr.	In/Out:	Distr.	In/Out:	Distr.	In/Out:	Distr.	In/Out:	Distr.		
Selvitz Road	Site to Glades Cut-Off Road	NB	18	1	138	48	75	12	55	5%	35%	5%	7%	1
		SB	10	1	78	27	38	2	34	5%	35%	5%	7%	2
	Midway Rd to Site	NB	1	1	27	27	2	2	34	5%	35%	5%	7%	2
		SB	1	1	48	48	4	1	55	5%	35%	5%	7%	1

- (1) Based on information provided from St. Lucie County Planning Department and City of Ft Pierce on approved and unbuilt projects.
- (2) Assumed the project traffic assignment based on roadway network.
- (3) The project traffic assignment was based on the approved Traffic Study by Susan E. O'Rourke, dated 9/5/08.

FROM St. Lucie County

RAVINIA PUD - Committed Trips

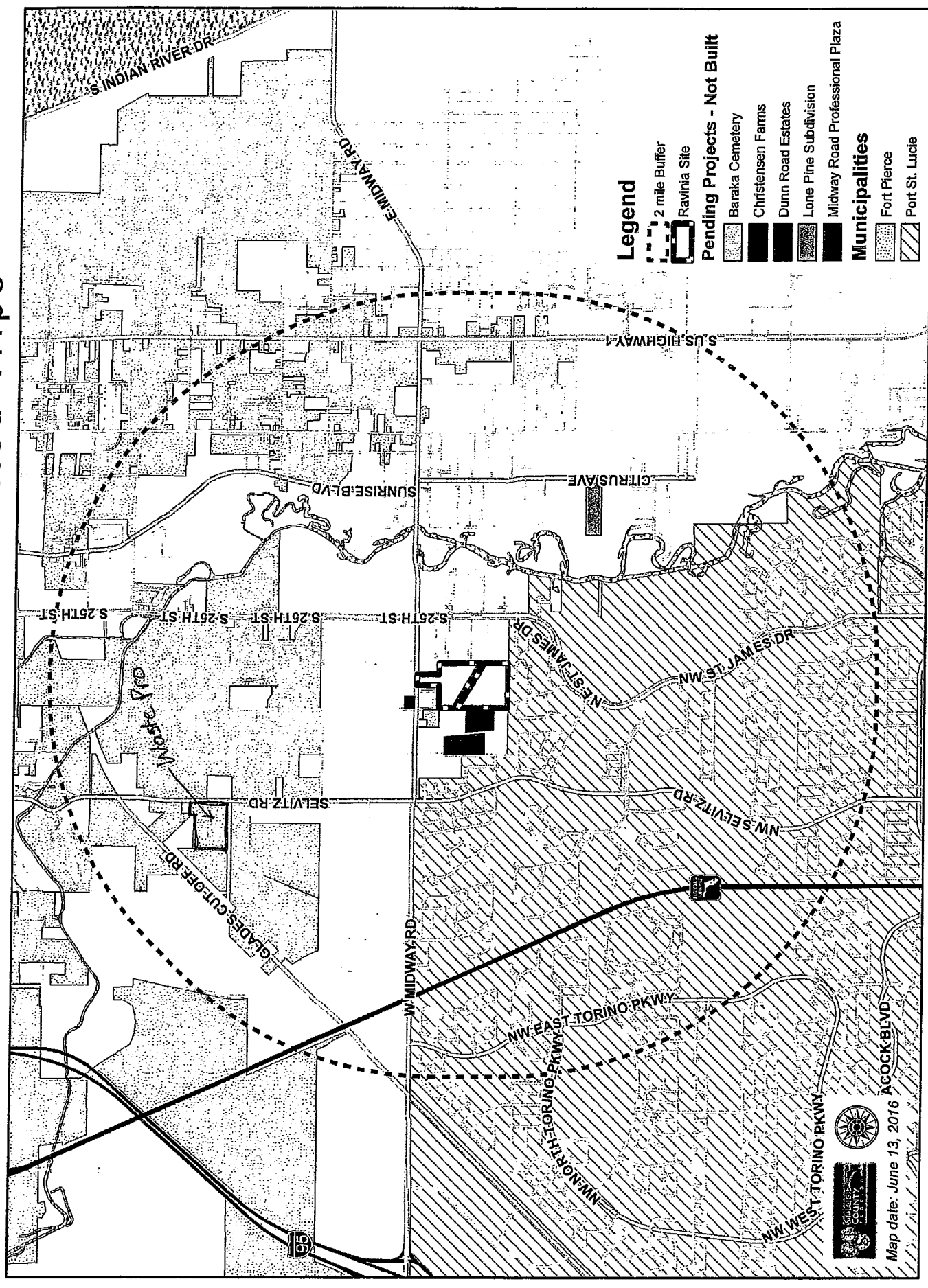

Legend

- 2 mile Buffer
- Ravinia Site
- Pending Projects - Not Built**
 - Baraka Cemetery
 - Christensen Farms
 - Dunn Road Estates
 - Lone Pine Subdivision
 - Midway Road Professional Plaza
- Municipalities**
 - Fort Pierce
 - Port St. Lucie



Map date: June 13, 2016

FileNumber	MapID	Type	ProjectName	Category	Description	Status	SFUnits	MFUUnits	TotalUnits	CommSqFt	IndSqFt	OfficalInst	Resolution	Built
MINSF-04021	53	Minor site plan	Christensen Farms	Residential	A 5-Lot Residential Subdivision	approve		5	0	5	0	0	5/16/2005	1 built
MINSF-03022	68	Minor site plan	Dunn Road Estates	Residential	An 8 lot residential subdivision (avg size 2.25 ac)	approve		8	0	8	0	0		No
PUD-03030	20	Major site plan	Lone Pine Subdivision	Residential	Construct 30 lot residential subdivision	approve		30	0	30	0	0	8/17/2004	2 homes bit
PUD-05020	209	PNRD	Midway Road Professional Plaza	Commerical	4 one story office buildings	approve		0	0	0	0	12679	9/19/2006	No
			Major adjustment											
SPMU-1220144832	0	to major site plan	Baraka Cemetery	Institutional	Increase plots and revise roadway layout	approve		0	0	0	0	0	6/18/2015	No

Committed Projects Trip Generation

DAILY

Land Use	ITE Code	Intensity	Trip Generation Rate (1)	Total Trips
Lone Pine Subdivision	210	28 DUs	9.52 /DU	267

AM Peak Hour

Land Use	ITE Code	Intensity	Trip Generation Rate (1)	Total Trips		
				In	Out	Total
Lone Pine Subdivision	210	28 DUs	0.75 /DU (25/75)	5	16	21

PM Peak Hour

Land Use	ITE Code	Intensity	Trip Generation Rate (1)	Total Trips		
				In	Out	Total
Lone Pine Subdivision	210	28 DUs	1.00 /DU (63/37)	18	10	28

(1) Source: Institute of Transportation Engineers (ITE), Trip Generation, 9th Edition.

SUSAN E. O'ROURKE, P.E., Inc.

Traffic Engineering, Transportation Planning

RECEIVED

2008 SEP 10 A 10:43

ST. LUCIE COUNTY
GROWTH MANAGEMENT

**TRAFFIC ANALYSIS
FOR THE
MIDWAY ROAD PROFESSIONAL PLAZA**

Prepared for:

GIK Development, LLC
804 SE Portage Avenue
Port Saint Lucie, Florida 34984

Prepared by

Susan E. O'Rourke, P.E., Inc.
428 SW Akron Avenue, Ste. 1A
Stuart, Florida 34994
(772)781-7918

August 29, 2005
Revised October 18, 2005
Revised February 9, 2006
Revised July 19, 2006
Updated September 5, 2008

SR05082.4

License # 42684

Certificate of Authorization #26869

428 SW Akron Avenue
Suite 1A
Stuart, Florida 34994

772.781.7918
772.781.9261 fax

SEORourke@comcast.net

Susan E. O'Rourke 9/8/08

PROJECT TRAFFIC

To estimate traffic generated by the Midway Road Professional Plaza, the ITE Trip Generation, 7th Edition trip rates were applied. These calculations provide an estimate of the typical generation. Trip generation for the project is shown in Table 1.

TABLE 1: Trip Generation

DAILY

Description	Land Use Code	SF/ Quantity	Daily Equation	Daily Trips	% In	% Out	Daily In	Daily Out
Medical Office	720	12,699	$T=40.89(x)-214.97$	301	50	50	151	150

PM

Description	Land Use Code	SF/ Quantity	PM Equation	PM Trips	% In	% Out	PM In	PM Out
Medical Office	720	12,699	$\ln(T)=0.93 \ln(x)+1.47$	46	27	73	12	34

Source: Trip Generation, 7th Edition

The PM-peak hour total trips would be 46 with 12 entering and 34 trips exiting the project.

PROJECT DISTRIBUTION/ ASSIGNMENT/ IMPACT

The project traffic was distributed by general geographic direction and then assigned to the roadway network.

Distribution/Assignment – The projects general geographic traffic distribution was estimated as 25% north, 35% south, 20% east, and 20% west. This general distribution led to an assignment of 60% to the west and 40% to the east on Midway Road. Figure 2 summarizes the project turning movements at the driveway and the project percent impact on the roadway links. Given the low volumes a right-turn lane would not be needed. The need for a left turn would be based on the overall design of Midway Road and the access management plan for the roadway. No egress will be allowed from the Christensen Road driveway based on the approved resolution.

The trip assignment and resultant trips on the links are included in Table 2 discussed in the next section of this statement.

OTHER TRAFFIC – BACKGROUND TRAFFIC

Growth rates were calculated for Midway Road using FDOT Historical AADT Data. The growth rate was calculated as 1.012. Other approved and pending projects have been included: Frontera, Oak Alley PUD, Ravinia, Mayo Dev. Corp., LTC Ranch and Liberty Baptist Church. These projects along with the growth rate were added to the existing and project traffic to develop total traffic. Appendix A provides the data on the other projects.

AM Trips: $2.39 \times 1000 \text{ SF} (79\% \text{ In} / 21\% \text{ Out})$ ←

→ $30^{\text{trips}} (24 \text{ In} / 6 \text{ Out})$

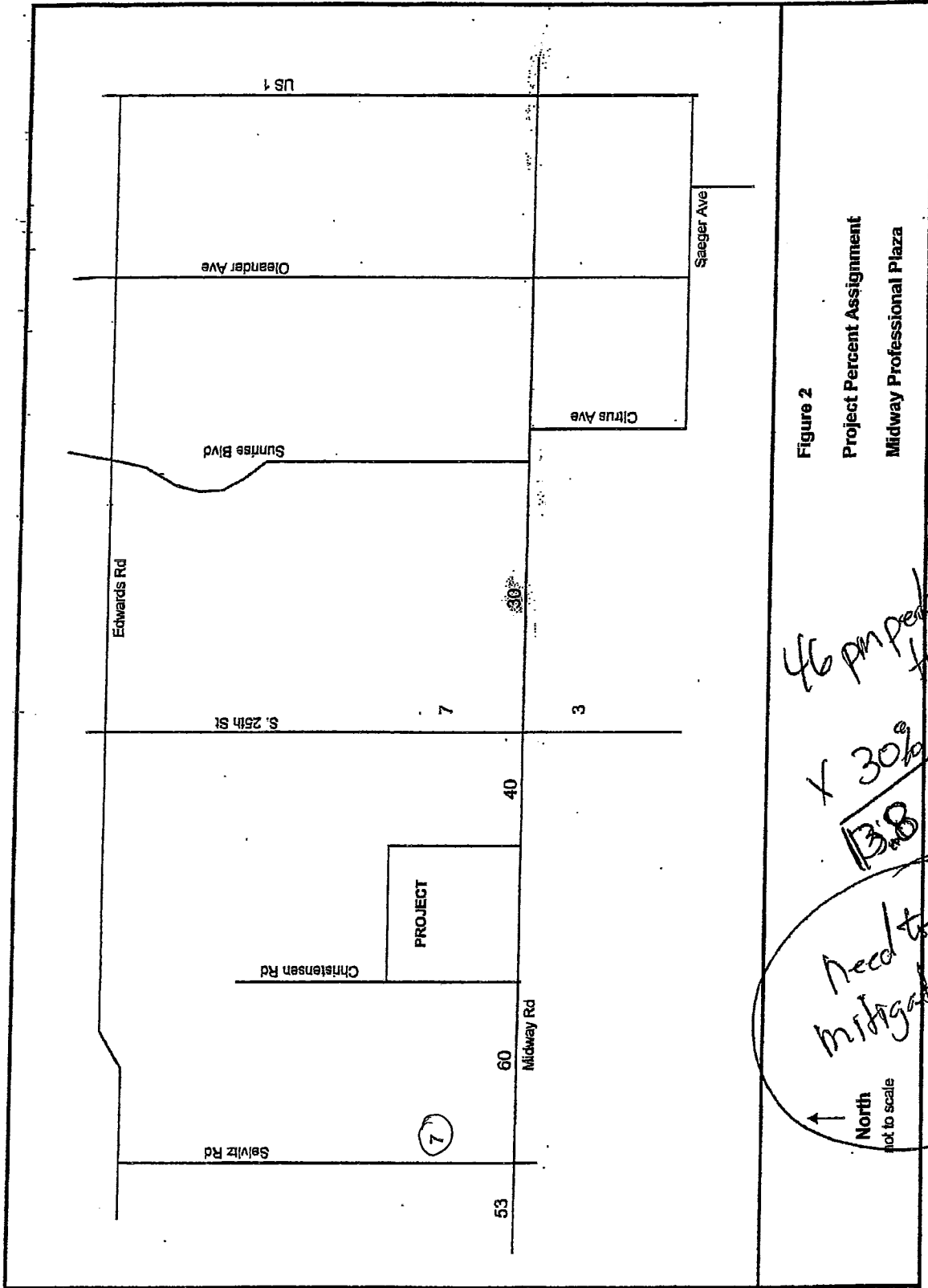

Figure 2
Project Percent Assignment
Midway Professional Plaza

46 pm peak hour
trips

X 30%

13.8 pm peak
trips

Need to be
mitigated for

**BECKER PARCEL
TRAFFIC IMPACT ANALYSIS**

Prepared for

LBFH, INC.

Prepared by

**PINDER TROUTMAN CONSULTING, INC.
2324 South Congress Avenue, Suite 1H
West Palm Beach, FL 33406
(561) 434-1644**

Andrea M. Troutman
2/24/04

Andrea M. Troutman, P.E.
Florida Registration #45409

**#PTC04-035
February 24, 2004**



Exhibit 3
 Becker Parcel
 Trip Generation

DAILY

Land Use	ITE Code	Intensity	Trip Generation Rate (1)	Total Trips
Residential-Single	210	214 Dus	9.57 /DU	2,048
TOTALS		214 Dus		2,048

AM Peak Hour

Land Use	ITE Code	Intensity	Trip Generation Rate (2)	Total Trips	
				In	Out
Residential-Single	210	214 Dus	0.75 /DU (25/75)	40	121
TOTALS		214 Dus		40	121

PM Peak Hour

Land Use	ITE Code	Intensity	Trip Generation Rate (2)	Total Trips	
				In	Out
Residential-Single	210	214 Dus	1.01 /DU (64/36)	138	78
TOTALS		214 Dus		138	78

(1) Source: Section 10.8, Fair Share Road Impact Fees, of the Palm Beach County Unified Land Development Code (ULDC).

(2) Source: Institute of Transportation Engineers (ITE), Trip Generation, 6th Edition.

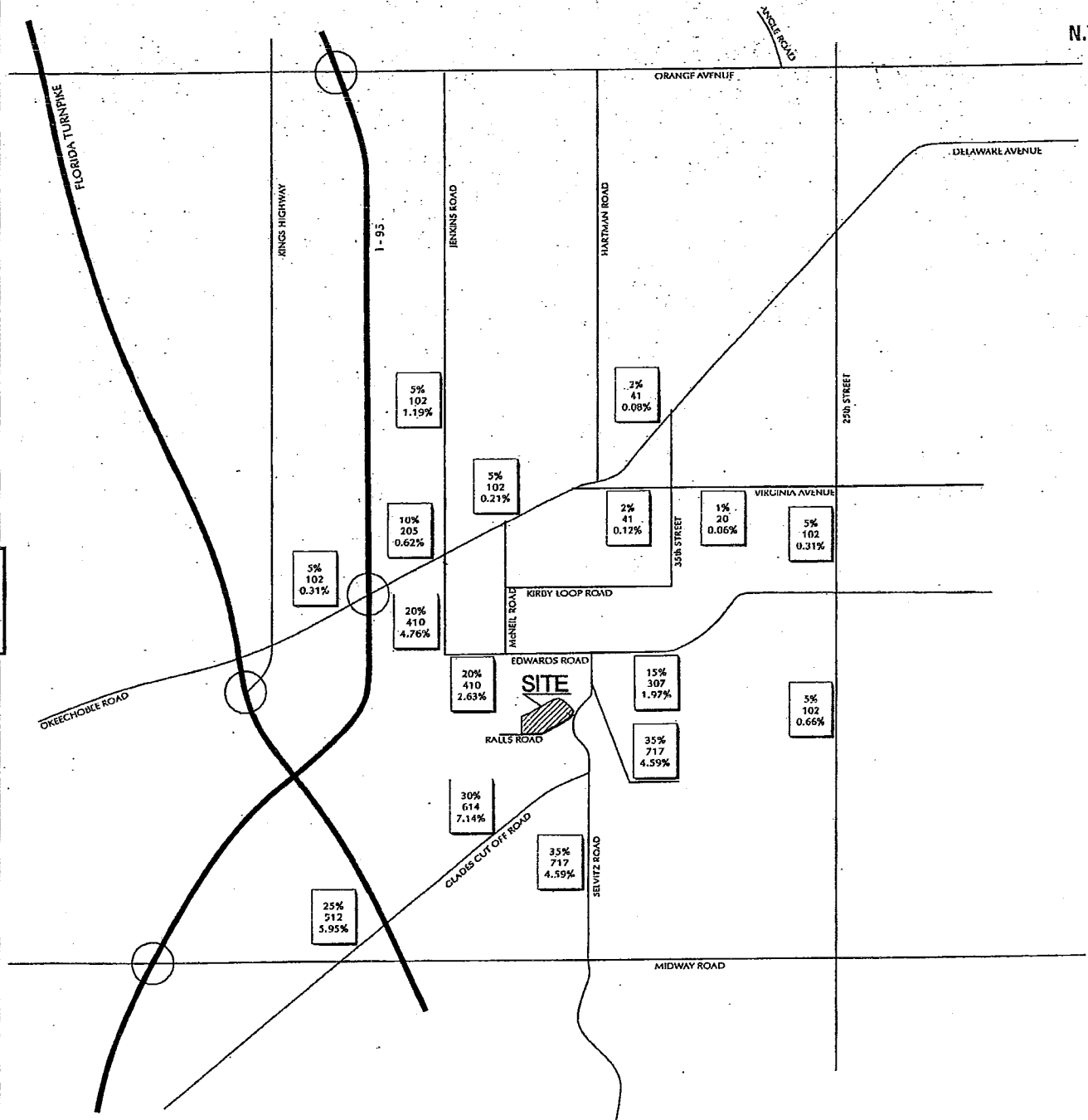
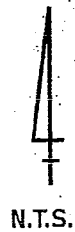

LEGEND
 15% - PROJECT DISTRIBUTION
 307 - DAILY PROJECT TRAFFIC
 1.97% - % OF DAILY SERVICE VOLUME

02/19/04
 04-035

BECKER PARCEL

EXHIBIT 4
 PROJECT TRAFFIC ASSIGNMENT



SUSAN E. O'ROURKE, P.E., Inc.

Traffic Engineering, Transportation Planning

TRAFFIC ANALYSIS

FOR

Mariner Cove

Prepared for:

Mr. Stanley Markofsky
Mariner Cove Builders, LLC
1400 East Oakland Park Boulevard, Ste. 103
Ft. Lauderdale, FL 33334

Prepared by:

Susan E. O'Rourke, P.E., Inc.
969 SE Federal Highway, Suite 402
Stuart, FL 34994
(772) 781-7918

June 2, 2015

SR15014.0

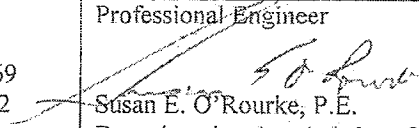
Prepared by: Susan E. O'Rourke, P.E., Inc. Certificate of Authorization: #26869 969 SE Federal Highway, Suite 402 Stuart, Florida 34994 772-781-7918	Professional Engineer  Susan E. O'Rourke, P.E. Date signed and sealed: June 2, 2015 License #: 42684
---------------------------------------------------------------------------------------------------------------------------------------------------------------------	------------------------------------------------------------------------------------------------------------------------------------------------------------------------------------------------------

969 SE Federal Highway
Suite 402
Stuart, FL 34994

772.781.7918

SEORourke@comcast.net

PROJECT TRAFFIC

To estimate traffic generated by the Mariner Cove Development, the ITE Trip Generation, 9th Edition trip rates were applied. These calculations provide an estimate of the typical generation. Trip generation for the project is shown in **Table 1**.

TABLE 1: Project Trip Generation

Land Use	Units	ITE Land Use Code	Daily Trip Equation	AM Peak Hour Trip Equation	%In/ %Out (trips in/trip out)	PM Peak Hour Trip Equation	%In/ %Out
Town Home	216	230	$\ln(T) = 0.87\ln(x) + 2.96$	$\ln(T) = 0.8\ln(x) + 0.26$	17% 83%	$\ln(T) = 0.82\ln(x) + 0.32$	67% 33%
Total			2072	96	<u>16/ 80</u>	113	<u>75/ 38</u>

The AM peak hour total trips would be 96 with 16 entering and 80 exiting the project. The PM peak hour total trips would be 113 with 75 entering and 38 exiting the project.

PROJECT DISTRIBUTION / ASSIGNMENT IMPACT

The project traffic was distributed by general geographic direction and then assigned to the roadway network.

Distribution -- The project general geographic traffic led to the detached assignments as shown in **Figure 2**.

Impact — This general distribution led to an assignment of external, new trips to the roadway network. **Tables 2a and 2b** summarize the project impact as it related to the percent of the service volume capacity or maximum allowable service volume for the project. The project is deemed significant based on 1% of LOS D capacity of the adjacent link and 3% on all the links.

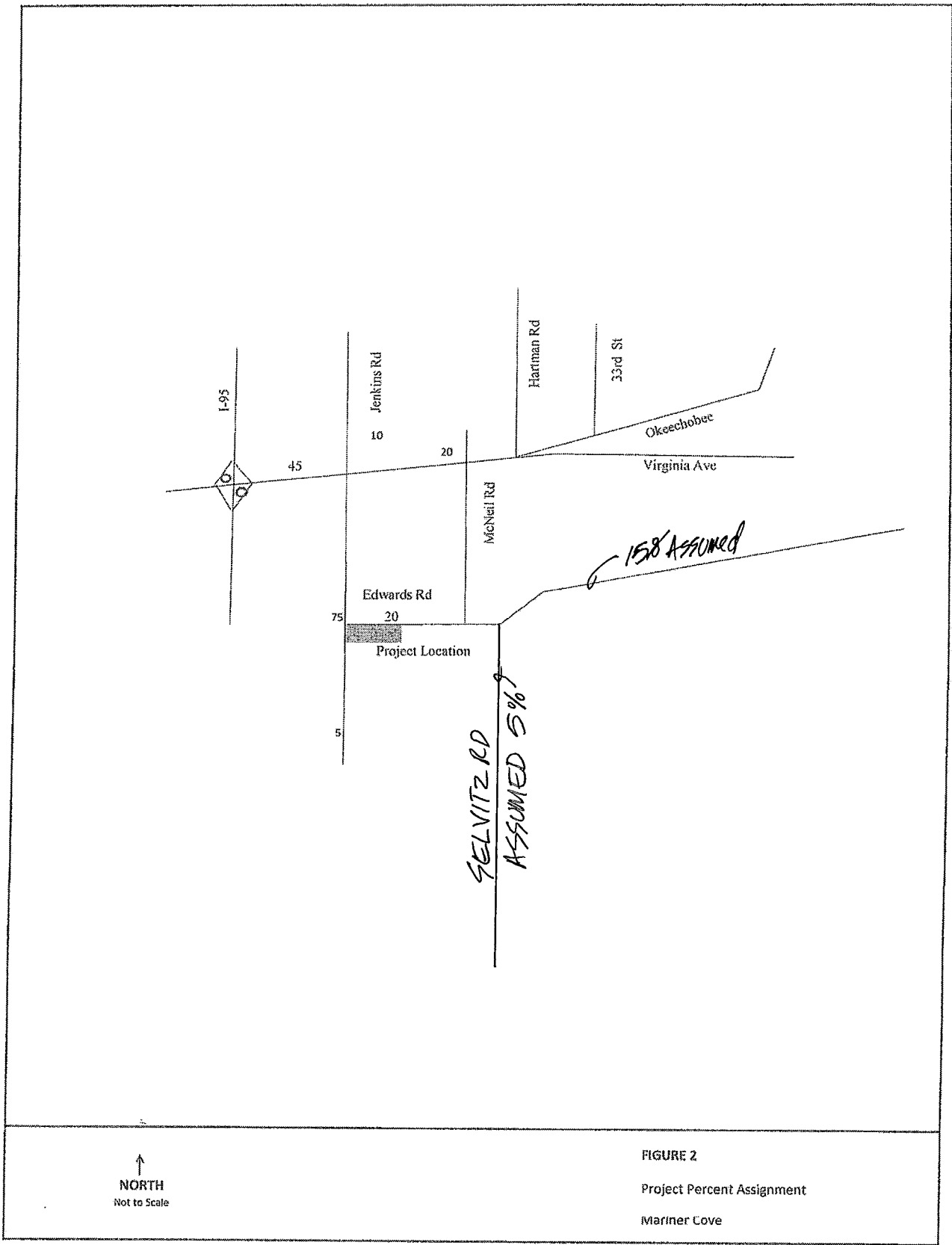

APPENDIX D

INTERSECTION ANALYSIS SHEET

Ft Pierce Precast Concrete Plant

Midway Rd & Selvitz Rd

Growth 2015 - 2021: 1.91%
 Growth 2008 - 2015: 1.05%
 Peak Season = 1.10
 Buildout Year = 2021

AM Peak Hour												
Intersection Volume Development												
	Northbound			Southbound			Eastbound			Westbound		
	LT	Thru	RT	LT	Thru	RT	LT	Thru	RT	LT	Thru	RT
Existing Volume (9/18/08)	129	244	53	53	82	100	78	506	73	46	421	64
Peak Season Volume	142	268	58	58	90	110	86	557	80	51	463	70
Growth 2008 - 2015	11	20	4	4	7	8	7	42	6	4	35	5
Growth 2015 - 2021	18	35	7	7	12	14	11	72	10	7	60	9
Total Growth	29	55	11	11	19	22	18	114	16	11	95	14
% Project Traffic	0%	2%	0%	18%	2%	45%	45%	0%	0%	0%	0%	18%
Direction	in	in	in	out	in	out	in	in	in	out	out	in
Project Traffic	0	2	0	5	2	11	56	0	0	0	0	22
Total	171	326	69	74	112	143	160	671	96	62	558	107

PM Peak Hour												
Intersection Volume Development												
	Northbound			Southbound			Eastbound			Westbound		
	LT	Thru	RT	LT	Thru	RT	LT	Thru	RT	LT	Thru	RT
Existing Volume (9/18/08)	74	95	35	57	243	92	96	477	168	66	448	31
Peak Season Volume	81	105	39	63	267	101	106	525	185	73	493	34
Growth 2008 - 2015	6	8	3	5	20	8	8	40	14	6	37	3
Growth 2015 - 2021	11	14	5	8	35	13	14	68	24	9	64	4
Total Growth	17	22	8	13	55	21	22	108	38	15	101	7
% Project Traffic	0%	2%	0%	18%	2%	45%	45%	0%	0%	0%	0%	18%
Direction	in	in	in	out	in	out	in	in	in	out	out	in
Project Traffic	0	1	0	23	1	57	16	0	0	0	0	6
Total	98	127	47	98	323	179	144	633	223	88	594	48

SHORT REPORT													
General Information						Site Information							
Analyst PTC Agency or Co. #16-071 Date Performed 8/23/2016 Time Period AM Peak Hour						Intersection Midway Rd & Selvitz Rd Area Type All other areas Jurisdiction SLC Analysis Year 2021 - Programmed Impvts.							
Volume and Timing Input													
	EB			WB			NB			SB			
	LT	TH	RT	LT	TH	RT	LT	TH	RT	LT	TH	RT	
Number of Lanes	2	2	1	1	2	0	2	2	0	1	2	0	
Lane Group	L	T	R	L	TR		L	TR		L	TR		
Volume (vph)	160	671	96	62	558	107	171	326	69	74	112	143	
% Heavy Vehicles	5	5	5	5	5	5	5	5	5	5	5	5	
PHF	0.92	0.92	0.92	0.92	0.92	0.92	0.92	0.92	0.92	0.92	0.92	0.92	
Pretimed/Actuated (P/A)	A	A	A	A	A	A	A	A	A	A	A	A	
Startup Lost Time	2.0	2.0	2.0	2.0	2.0		2.0	2.0		2.0	2.0		
Extension of Effective Green	2.0	2.0	2.0	2.0	2.0		2.0	2.0		2.0	2.0		
Arrival Type	3	3	3	3	3		3	3		3	3		
Unit Extension	3.0	3.0	3.0	3.0	3.0		3.0	3.0		3.0	3.0		
Ped/Bike/RTOR Volume	0	0	0	0	0	0	0	0	0	0	0	0	
Lane Width	12.0	12.0	12.0	12.0	12.0		12.0	12.0		12.0	12.0		
Parking/Grade/Parking	N	0	N	N	0	N	N	0	N	N	0	N	
Parking/Hour													
Bus Stops/Hour	0	0	0	0	0		0	0		0	0		
Minimum Pedestrian Time		3.2			3.2			3.2			3.2		
Phasing	Excl. Left	Thru & RT	03			04		Excl. Left	Thru & RT	07		08	
Timing	G = 18.0	G = 50.0	G =			G =		G = 18.0	G = 30.0	G =		G =	
	Y = 6	Y = 6	Y =			Y =		Y = 6	Y = 6	Y =		Y =	
Duration of Analysis (hrs) = 0.25						Cycle Length C = 140.0							
Lane Group Capacity, Control Delay, and LOS Determination													
	EB			WB			NB			SB			
	LT	TH	RT	LT	TH	RT	LT	TH	RT	LT	TH	RT	
Adjusted Flow Rate	174	729	104	67	723		186	429		80	277		
Lane Group Capacity	429	1230	813	221	1201		429	719		221	676		
v/c Ratio	0.41	0.59	0.13	0.30	0.60		0.43	0.60		0.36	0.41		
Green Ratio	0.13	0.36	0.53	0.13	0.36		0.13	0.21		0.13	0.21		
Uniform Delay d ₁	56.1	36.7	16.7	55.3	36.9		56.3	49.5		55.8	47.4		
Delay Factor k	0.11	0.18	0.11	0.11	0.19		0.11	0.19		0.11	0.11		
Incremental Delay d ₂	0.6	0.8	0.1	0.8	0.9		0.7	1.4		1.0	0.4		
PF Factor	1.000	1.000	1.000	1.000	1.000		1.000	1.000		1.000	1.000		
Control Delay	56.7	37.5	16.8	56.1	37.7		57.0	50.9		56.8	47.8		
Lane Group LOS	E	D	B	E	D		E	D		E	D		
Approach Delay	38.7			39.3			52.8			49.8			
Approach LOS	D			D			D			D			
Intersection Delay	43.4			Intersection LOS						D			

SHORT REPORT												
General Information						Site Information						
Analyst	PTC					Intersection	Midway Rd & Selvitz Rd					
Agency or Co.	#16-071					Area Type	All other areas					
Date Performed	8/23/16					Jurisdiction	SLC					
Time Period	PM Peak Hour					Analysis Year	2021 - Programmed Impvts					
Volume and Timing Input												
	EB			WB			NB			SB		
	LT	TH	RT	LT	TH	RT	LT	TH	RT	LT	TH	RT
Number of Lanes	2	2	1	1	2	0	2	2	0	1	2	0
Lane Group	L	T	R	L	TR		L	TR		L	TR	
Volume (vph)	144	633	223	88	594	48	98	127	47	98	323	179
% Heavy Vehicles	5	5	5	5	5	5	5	5	5	5	5	5
PHF	0.92	0.92	0.92	0.92	0.92	0.92	0.92	0.92	0.92	0.92	0.92	0.92
Pretimed/Actuated (P/A)	A	A	A	A	A	A	A	A	A	A	A	A
Startup Lost Time	2.0	2.0	2.0	2.0	2.0		2.0	2.0		2.0	2.0	
Extension of Effective Green	2.0	2.0	2.0	2.0	2.0		2.0	2.0		2.0	2.0	
Arrival Type	3	3	3	3	3		3	3		3	3	
Unit Extension	3.0	3.0	3.0	3.0	3.0		3.0	3.0		3.0	3.0	
Ped/Bike/RTOR Volume	0	0	0	0	0	0	0	0	0	0	0	0
Lane Width	12.0	12.0	12.0	12.0	12.0		12.0	12.0		12.0	12.0	
Parking/Grade/Parking	N	0	N	N	0	N	N	0	N	N	0	N
Parking/Hour												
Bus Stops/Hour	0	0	0	0	0		0	0		0	0	
Minimum Pedestrian Time		3.2			3.2			3.2			3.2	
Phasing	Excl. Left	Thru & RT	03		04		Excl. Left	Thru & RT	07		08	
Timing	G = 18.0	G = 50.0	G =	G =	G = 18.0	G = 30.0	G =	G =				
	Y = 6	Y = 6	Y =	Y =	Y = 6	Y = 6	Y =	Y =				
Duration of Analysis (hrs) = 0.25							Cycle Length C = 140.0					
Lane Group Capacity, Control Delay, and LOS Determination												
	EB			WB			NB			SB		
	LT	TH	RT	LT	TH	RT	LT	TH	RT	LT	TH	RT
Adjusted Flow Rate	157	688	242	96	698		107	189		107	546	
Lane Group Capacity	429	1230	813	221	1217		429	708		221	699	
v/c Ratio	0.37	0.56	0.30	0.43	0.57		0.25	0.27		0.48	0.78	
Green Ratio	0.13	0.36	0.53	0.13	0.36		0.13	0.21		0.13	0.21	
Uniform Delay d ₁	55.8	36.2	18.5	56.3	36.4		54.9	45.8		56.7	51.9	
Delay Factor k	0.11	0.16	0.11	0.11	0.17		0.11	0.11		0.11	0.33	
Incremental Delay d ₂	0.5	0.6	0.2	1.4	0.7		0.3	0.2		1.7	5.7	
PF Factor	1.000	1.000	1.000	1.000	1.000		1.000	1.000		1.000	1.000	
Control Delay	56.3	36.7	18.7	57.7	37.0		55.2	46.0		58.4	57.6	
Lane Group LOS	E	D	B	E	D		E	D		E	E	
Approach Delay	35.5			39.5			49.4			57.7		
Approach LOS	D			D			D			E		
Intersection Delay	43.2			Intersection LOS						D		

TRAFFIC SURVEY SPECIALISTS, INC.

MIDWAY ROAD & SELVITZ ROAD
 PORT ST LUCIE, FLORIDA
 COUNTED BY: MAXIE ESPINOSA
 SIGNALIZED

624 GARDENIA TERRACE
 DELRAY BEACH, FLORIDA 33444
 (561) 272-3255 FAX (561) 272-4381

Site Code : 00080161
 Start Date: 09/18/08
 File I.D. : MIDWSELV
 Page : 1

ALL VEHICLES

Date 09/18/08	SELVITZ ROAD From North				MIDWAY ROAD From East				SELVITZ ROAD From South				MIDWAY ROAD From West				Total
	UTurn	Left	Thru	Right	UTurn	Left	Thru	Right	UTurn	Left	Thru	Right	UTurn	Left	Thru	Right	
07:00	0	6	17	20	0	8	65	11	0	26	39	10	0	17	85	11	315
07:15	0	10	18	16	0	7	91	14	0	34	63	11	0	26	97	17	404
07:30	0	13	18	24	0	12	98	12	0	23	68	18	0	28	145	19	478
07:45	0	21	12	28	0	14	132	29	0	37	70	11	0	26	156	15	551
Hr Total	0	50	65	88	0	41	386	66	0	120	240	50	0	97	483	62	1748
08:00	0	9	30	30	0	10	77	10	0	38	52	16	0	18	105	21	416
08:15	0	10	22	18	0	10	114	13	0	31	54	8	0	6	100	18	404
08:30	0	8	19	18	0	2	103	8	0	25	36	14	0	24	102	16	375
08:45	0	16	24	10	0	5	93	10	0	23	43	6	0	21	78	24	353
Hr Total	0	43	95	76	0	27	387	41	0	117	185	44	0	69	385	79	1548
* BREAK *																	
16:00	0	8	44	25	0	16	108	9	0	24	22	11	0	18	129	45	459
16:15	0	15	47	14	0	12	115	12	0	25	34	8	0	21	117	36	456
16:30	1	16	67	28	0	13	102	7	0	18	19	8	0	22	120	37	458
16:45	0	13	54	20	0	16	92	8	0	16	25	11	0	24	109	39	427
Hr Total	1	52	212	87	0	57	417	36	0	83	100	38	0	85	475	157	1800
17:00	0	18	48	18	0	15	132	8	0	21	22	5	0	28	139	57	511
17:15	0	9	74	26	0	22	122	8	0	19	29	11	0	22	109	35	486
17:30	0	10	42	29	0	24	120	9	0	11	30	16	0	8	97	43	439
17:45	0	10	40	20	0	26	116	6	0	16	27	9	0	17	99	20	406
Hr Total	0	47	204	93	0	87	490	31	0	67	108	41	0	75	444	155	1842
TOTAL	1	192	576	344	0	212	1680	174	0	387	633	173	0	326	1787	453	6938

TRAFFIC SURVEY SPECIALISTS, INC.

MIDWAY ROAD & SELVITZ ROAD
 PORT ST LUCIE, FLORIDA
 COUNTED BY: MAXIE ESPINOSA
 SIGNALIZED

624 GARDENIA TERRACE
 DELRAY BEACH, FLORIDA 33444
 (561) 272-3255 FAX (561) 272-4381

Site Code : 00080161
 Start Date: 09/18/08
 File I.D. : MIDWSELV
 Page : 2

ALL VEHICLES

SELVITZ ROAD				MIDWAY ROAD				SELVITZ ROAD				MIDWAY ROAD				Total
From North				From East				From South				From West				
UTurn	Left	Thru	Right	UTurn	Left	Thru	Right	UTurn	Left	Thru	Right	UTurn	Left	Thru	Right	
Date 09/18/08																
Peak Hour Analysis By Entire Intersection for the Period: 07:00 to 09:00 on 09/18/08																
Peak start 07:30				07:30				07:30				07:30				
Volume	0	53	82	100	0	46	421	64	0	129	244	53	0	78	506	73
Percent	0%	23%	35%	43%	0%	9%	79%	12%	0%	30%	57%	12%	0%	12%	77%	11%
Pk total	235			531				426				657				
Highest	08:00			07:45				07:45				07:45				
Volume	0	9	30	30	0	14	132	29	0	37	70	11	0	26	156	15
Hi total	69			175				118				197				
PHF	.85			.76				.90				.83				

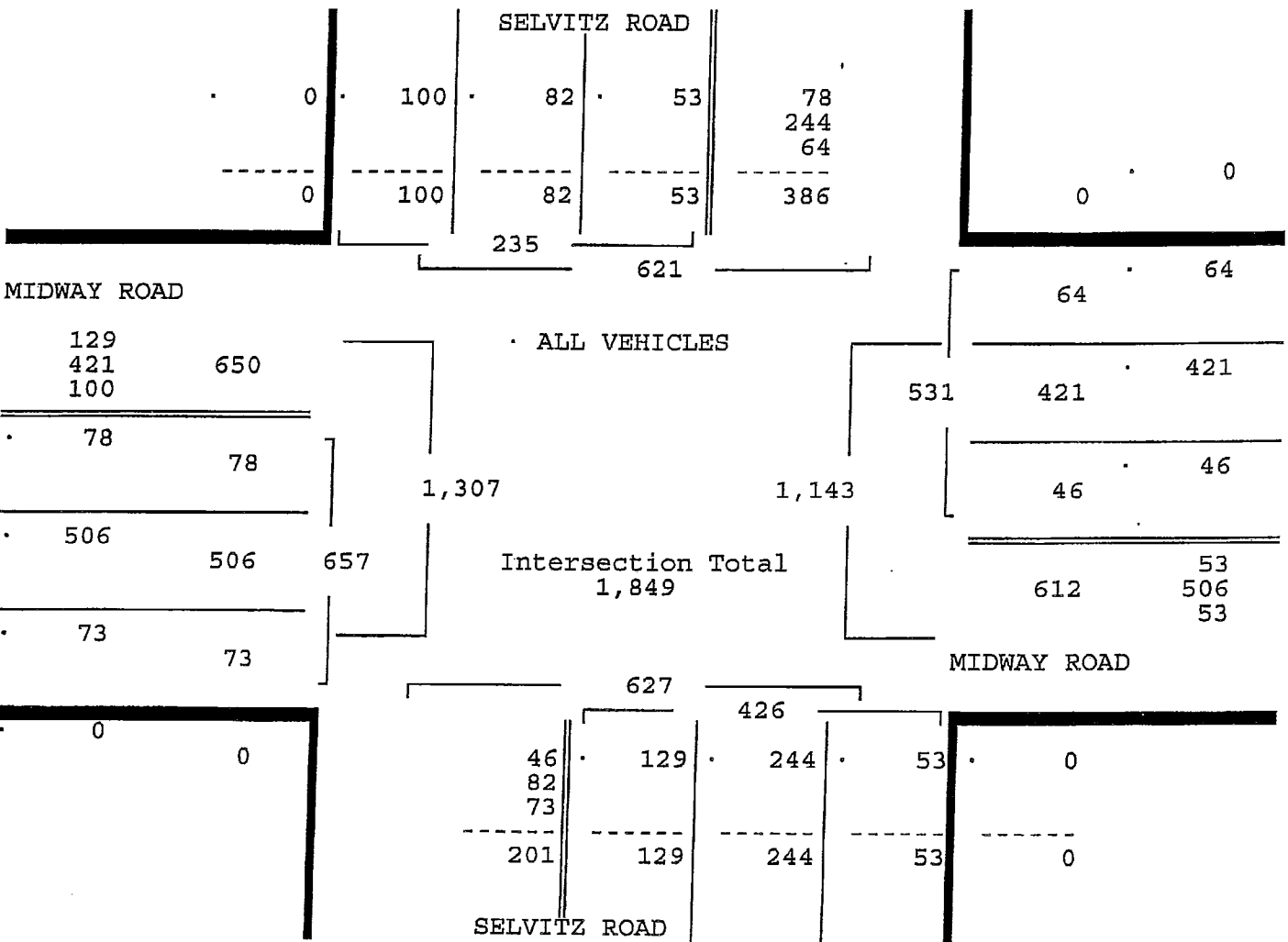

MIDWAY ROAD & SELVITZ ROAD
 PORT ST LUCIE, FLORIDA
 COUNTED BY: MAXIE ESPINOSA
 SIGNALIZED

TRAFFIC SURVEY SPECIALISTS, INC.
 624 GARDENIA TERRACE
 DELRAY BEACH, FLORIDA 33444
 (561) 272-3255 FAX (561) 272-4381

Site Code : 00080161
 Start Date: 09/18/08
 File I.D. : MIDWSELV
 Page : 3

ALL VEHICLES

SELVITZ ROAD				MIDWAY ROAD				SELVITZ ROAD				MIDWAY ROAD				Total	
From North				From East				From South				From West					
UTurn	Left	Thru	Right	UTurn	Left	Thru	Right	UTurn	Left	Thru	Right	UTurn	Left	Thru	Right		
Date 09/18/08																	
Peak Hour Analysis by Entire Intersection for the Period: 16:00 to 18:00 on 09/18/08																	
Peak start 16:30				16:30				16:30				16:30					
Volume	1	56	243	92	0	66	448	31	0	74	95	35	0	96	477	168	
Percent	0%	14%	62%	23%	0%	12%	82%	6%	0%	36%	47%	17%	0%	13%	64%	23%	
Pk total	392				545				204				741				
Highest 16:30				17:00				17:15				17:00					
Volume	1	16	67	28	0	15	132	8	0	19	29	11	0	28	139	57	
Hi total	112				155				59				224				
PHF	.88				.88				.86				.83				

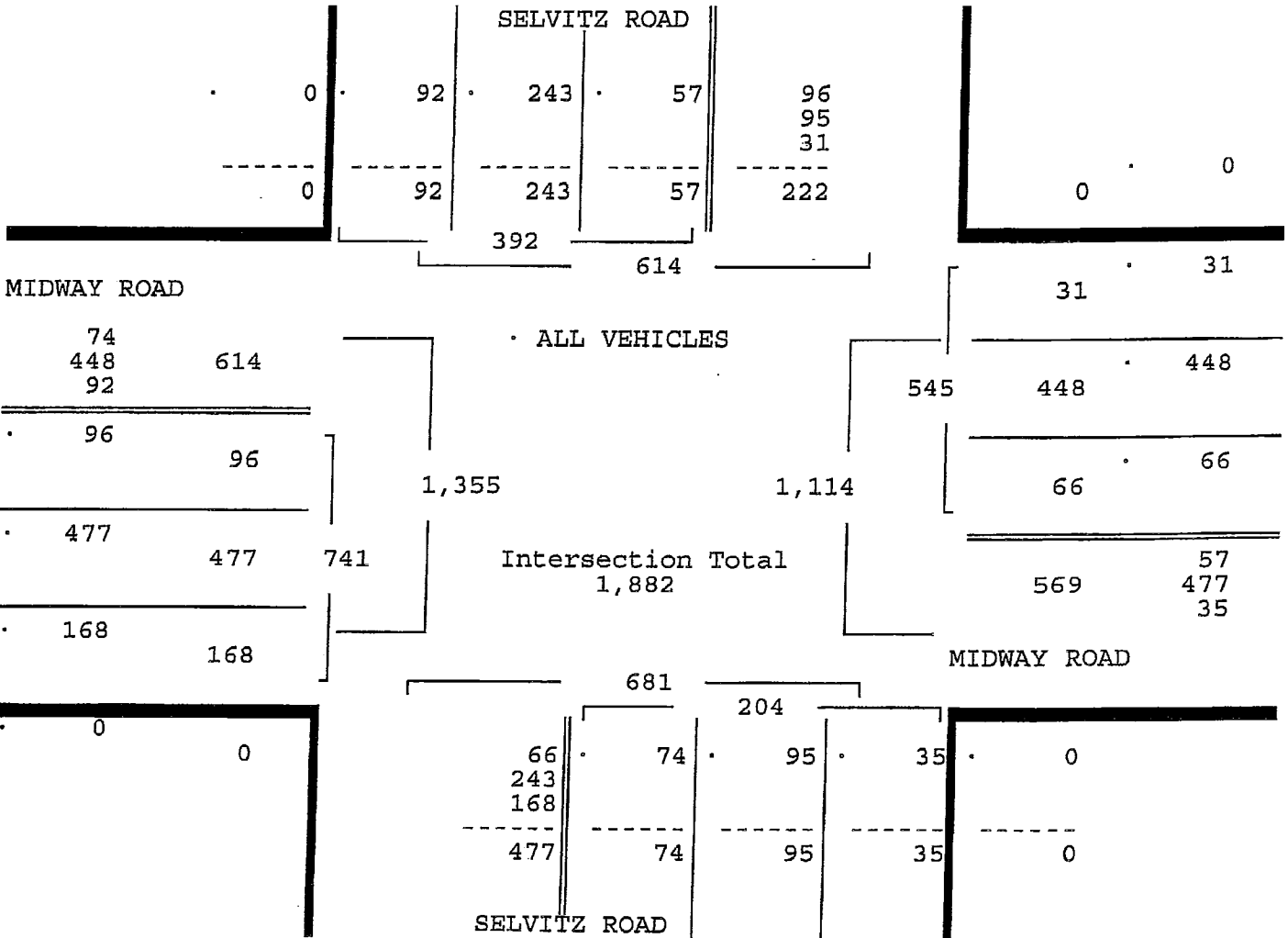

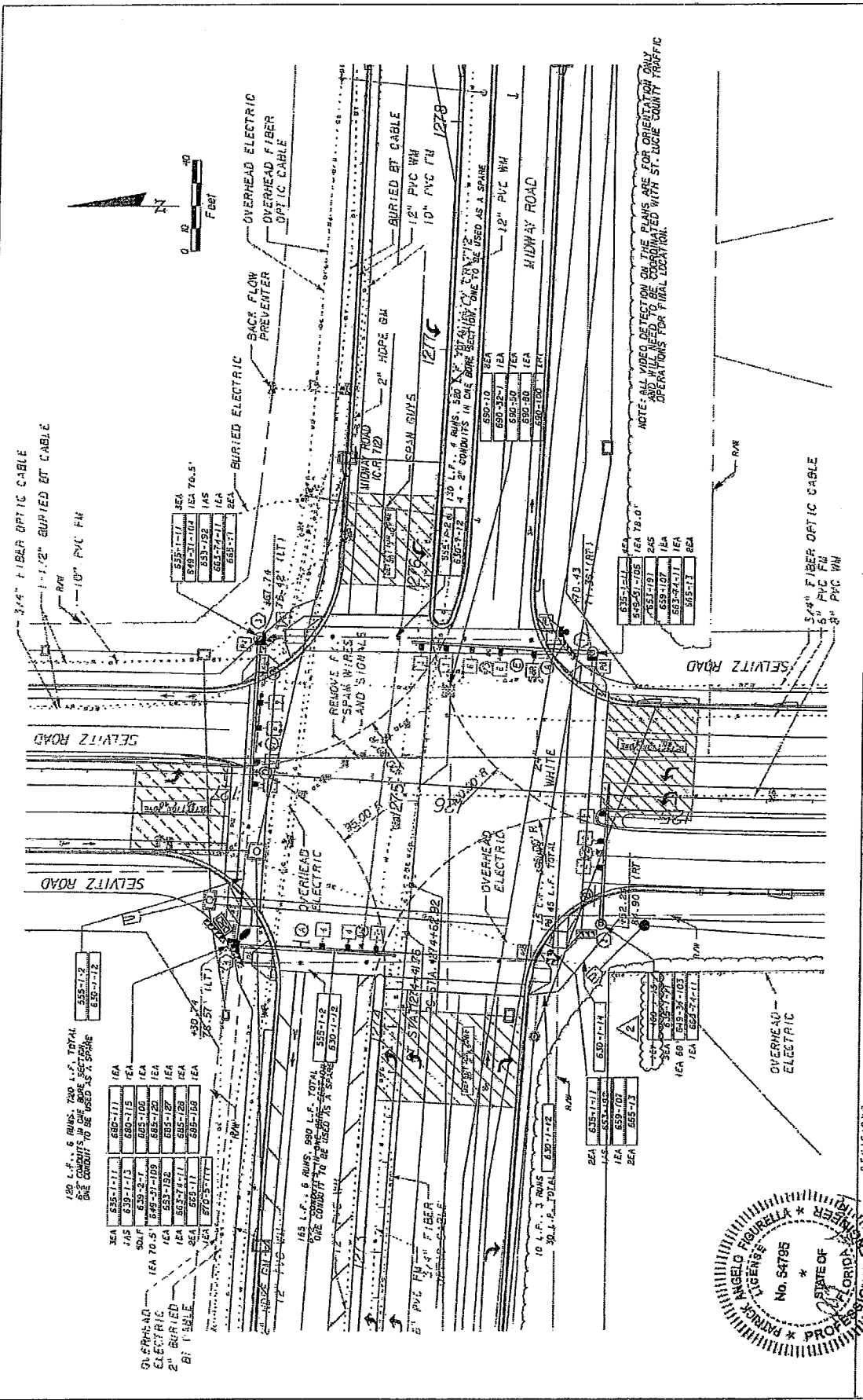

120 L.F. 6 RUNS. 230 L.F. TOTAL
ONE CONDUIT TO BE USED AS A SPARE

SEA	635-1-17	1EA
1AS	639-1-13	1EA
SOIL	639-2-7	1EA
1EA	649-31-109	1EA
1EA	653-192	1EA
1EA	653-74-11	1EA
1EA	655-11	1EA
1EA	670-25-117	1EA

163 L.F. 6 RUNS. 990 L.F. TOTAL
ONE CONDUIT TO BE USED AS A SPARE

SEA	635-1-17	1EA
1AS	639-1-13	1EA
SOIL	639-2-7	1EA
1EA	649-31-109	1EA
1EA	653-192	1EA
1EA	653-74-11	1EA
1EA	655-11	1EA
1EA	670-25-117	1EA

SEA	635-1-17	1EA
1AS	639-1-13	1EA
SOIL	639-2-7	1EA
1EA	649-31-109	1EA
1EA	653-192	1EA
1EA	653-74-11	1EA
1EA	655-11	1EA
1EA	670-25-117	1EA

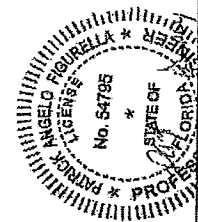

DATE	09-14-2014	REVISIONS		PROJECT NO.	06-18	SHEET NO.	7-4
BY		REVISIONS		CITY	ST. LUCIE	COUNTY	ST. LUCIE COUNTY
APP'D		REVISIONS		PROJECT NO.	06-18	CITY	ST. LUCIE
DATE		REVISIONS		CITY	ST. LUCIE	COUNTY	ST. LUCIE COUNTY
DATE		REVISIONS		CITY	ST. LUCIE	COUNTY	ST. LUCIE COUNTY
DATE		REVISIONS		CITY	ST. LUCIE	COUNTY	ST. LUCIE COUNTY
DATE		REVISIONS		CITY	ST. LUCIE	COUNTY	ST. LUCIE COUNTY
DATE		REVISIONS		CITY	ST. LUCIE	COUNTY	ST. LUCIE COUNTY
DATE		REVISIONS		CITY	ST. LUCIE	COUNTY	ST. LUCIE COUNTY
DATE		REVISIONS		CITY	ST. LUCIE	COUNTY	ST. LUCIE COUNTY
DATE		REVISIONS		CITY	ST. LUCIE	COUNTY	ST. LUCIE COUNTY

G.A. ENGINEERS & PLANNERS, INC.
 1000 W. BAYVIEW BLVD., SUITE 100
 ST. LUCIE, FLORIDA 34957
 TEL: 888-345-7272
 FAX: 888-345-7273
 WWW.GAENGINEERS.COM

ST. LUCIE COUNTY
 ENGINEERING DIVISION
 COUNTY
 ST. LUCIE
 PROJECT NO.
 06-18

SIGNALIZATION PLAN
 MIDWAY ROAD AND SELVITZ ROAD

LOCAL CONTROLLER TIMING

INTERSECTION: Midway & Selwitz

ID# 40 ZONE# N/A ADDR# _____

APPROVED BY: [Signature] DATE: 8/1/06

PH	MOVEMENT	INT	EXT	YEL	RED CLR	MAX 1	MAX 2	WLK	PED CLR	MIN REC	MAX REC	PED REC	MEM	CNA 1
1	WBL	7	3.0	4.0	1.0	15		N/A	N/A					
2	EB	10	4.0	4.0	2.0	50								
3	—													
4	S-B	10	3.5	4.0	2.0	40								
5	EBL	7	3.0	4.0	1.0	15								
6	WLB	10	4.0	4.0	2.0	50								
7	—													
8	EB	10	3.5	4.0	2.0	40								

DESIGNED TRAFFIC INSTALLATION

INTERSECTION ANALYSIS SHEET Ft Pierce Precast Concrete Plant

Edwards Rd & Selvitz Rd

Growth 1.91%

Peak Season = 1.16
Buildout Year = 2021
Years = 5

AM Peak Hour												
Intersection Volume Development												
	Northbound			Southbound			Eastbound			Westbound		
	LT	Thru	RT	LT	Thru	RT	LT	Thru	RT	LT	Thru	RT
Existing Volume (8/24/16)	325	0	317	0	0	0	0	220	180	202	286	0
Peak Season Volume	377	0	368	0	0	0	0	255	209	234	332	0
Growth 2016 - 2021	37	0	36	0	0	0	0	25	21	23	33	0
Total Growth	37	0	36	0	0	0	0	25	21	23	33	0
% Project Traffic	25%	0%	5%	0%	0%	0%	0%	0%	25%	5%	0%	0%
Direction	out	in	out	out	in	out	in	in	in	in	out	in
Project Traffic	6	0	1	0	0	0	0	0	31	6	0	0
Total	420	0	405	0	0	0	0	280	261	264	365	0

PM Peak Hour												
Intersection Volume Development												
	Northbound			Southbound			Eastbound			Westbound		
	LT	Thru	RT	LT	Thru	RT	LT	Thru	RT	LT	Thru	RT
Existing Volume (8/24/16)	222	0	272	0	0	0	0	303	252	232	299	0
Peak Season Volume	258	0	316	0	0	0	0	351	292	269	347	0
Growth 2016 - 2021	26	0	31	0	0	0	0	35	29	27	34	0
Total Growth	26	0	31	0	0	0	0	35	29	27	34	0
% Project Traffic	25%	0%	5%	0%	0%	0%	0%	0%	25%	5%	0%	0%
Direction	out	in	out	out	in	out	in	in	in	in	out	in
Project Traffic	32	0	6	0	0	0	0	0	9	2	0	0
Total	315	0	353	0	0	0	0	386	330	298	381	0

SHORT REPORT												
General Information						Site Information						
Analyst <i>PTC</i> Agency or Co. <i>#16-071</i> Date Performed <i>8/29/2016</i> Time Period <i>AM Peak Hour</i>						Intersection <i>Edwards Rd & Selvitz Rd</i> Area Type <i>All other areas</i> Jurisdiction <i>SLC</i> Analysis Year <i>2021 - Proposed Timing</i>						
Volume and Timing Input												
	EB			WB			NB			SB		
	LT	TH	RT	LT	TH	RT	LT	TH	RT	LT	TH	RT
Number of Lanes		1	0	1	1		1		1			
Lane Group		TR		L	T		L		R			
Volume (vph)		280	261	264	365		420		405			
% Heavy Vehicles		5	5	5	5		5		5			
PHF		0.92	0.92	0.92	0.92		0.92		0.92			
Pretimed/Actuated (P/A)		A	A	A	A		A		A			
Startup Lost Time		2.0		2.0	2.0		2.0		2.0			
Extension of Effective Green		2.0		2.0	2.0		2.0		2.0			
Arrival Type		3		3	3		3		3			
Unit Extension		3.0		3.0	3.0		3.0		3.0			
Ped/Bike/RTOR Volume	0	0	0	0	0		0	0	60	0	0	
Lane Width		12.0		12.0	12.0		12.0		12.0			
Parking/Grade/Parking	N	0	N	N	0	N	N	0	N	N	0	N
Parking/Hour												
Bus Stops/Hour		0		0	0		0		0			
Minimum Pedestrian Time		3.2			3.2			3.2			3.2	
Phasing	WB Only	EW Perm	03	04	NB Only	06	07	08				
Timing	G = 13.0	G = 42.0	G =	G =	G = 35.0	G =	G =	G =				
	Y = 5	Y = 5	Y =	Y =	Y = 6	Y =	Y =	Y =				
Duration of Analysis (hrs) = 0.25						Cycle Length C = 106.0						
Lane Group Capacity, Control Delay, and LOS Determination												
	EB			WB			NB			SB		
	LT	TH	RT	LT	TH	RT	LT	TH	RT	LT	TH	RT
Adjusted Flow Rate		588		287	397		457		375			
Lane Group Capacity		670		374	1025		568		508			
v/c Ratio		0.88		0.77	0.39		0.80		0.74			
Green Ratio		0.40		0.57	0.57		0.33		0.33			
Uniform Delay d ₁		29.6		16.7	12.8		32.4		31.4			
Delay Factor k		0.40		0.32	0.11		0.35		0.30			
Incremental Delay d ₂		12.7		9.3	0.2		8.3		5.6			
PF Factor		1.000		1.000	1.000		1.000		1.000			
Control Delay		42.3		26.0	13.0		40.7		37.1			
Lane Group LOS		D		C	B		D		D			
Approach Delay		42.3		18.5			39.1					
Approach LOS		D		B			D					
Intersection Delay		33.3		Intersection LOS							C	

SHORT REPORT												
General Information						Site Information						
Analyst PTC Agency or Co. #16-071 Date Performed 8/29/2016 Time Period AM Peak Hour						Intersection Edwards Rd & Selvitz Rd Area Type All other areas Jurisdiction SLC Analysis Year 2021 Existing Timing						
Volume and Timing Input												
	EB			WB			NB			SB		
	LT	TH	RT	LT	TH	RT	LT	TH	RT	LT	TH	RT
Number of Lanes		1	0	1	1		1		1			
Lane Group		TR		L	T		L		R			
Volume (vph)		280	261	264	365		420		405			
% Heavy Vehicles		5	5	5	5		5		5			
PHF		0.92	0.92	0.92	0.92		0.92		0.92			
Pretimed/Actuated (P/A)		A	A	A	A		A		A			
Startup Lost Time		2.0		2.0	2.0		2.0		2.0			
Extension of Effective Green		2.0		2.0	2.0		2.0		2.0			
Arrival Type		3		3	3		3		3			
Unit Extension		3.0		3.0	3.0		3.0		3.0			
Ped/Bike/RTOR Volume	0	0	0	0	0		0	0	60	0	0	
Lane Width		12.0		12.0	12.0		12.0		12.0			
Parking/Grade/Parking	N	0	N	N	0	N	N	0	N	N	0	N
Parking/Hour												
Bus Stops/Hour		0		0	0		0		0			
Minimum Pedestrian Time		3.2			3.2				3.2			3.2
Phasing	WB Only	EW Perm	03	04	NB Only	06	07	08				
Timing	G = 15.0	G = 35.0	G =	G =	G = 40.0	G =	G =	G =				
	Y = 5	Y = 5	Y =	Y =	Y = 6	Y =	Y =	Y =				
Duration of Analysis (hrs) = 0.25						Cycle Length C = 106.0						
Lane Group Capacity, Control Delay, and LOS Determination												
	EB			WB			NB			SB		
	LT	TH	RT	LT	TH	RT	LT	TH	RT	LT	TH	RT
Adjusted Flow Rate		588		287	397		457		375			
Lane Group Capacity		559		331	939		649		580			
v/c Ratio		1.05		0.87	0.42		0.70		0.65			
Green Ratio		0.33		0.52	0.52		0.38		0.38			
Uniform Delay d ₁		35.5		24.9	15.7		28.0		27.2			
Delay Factor k		0.50		0.40	0.11		0.27		0.22			
Incremental Delay d ₂		52.4		20.8	0.3		3.5		2.5			
PF Factor		1.000		1.000	1.000		1.000		1.000			
Control Delay		87.9		45.7	16.0		31.4		29.7			
Lane Group LOS		F		D	B		C		C			
Approach Delay		87.9		28.5			30.7					
Approach LOS		F		C			C					
Intersection Delay		46.0		Intersection LOS							D	

SHORT REPORT												
General Information						Site Information						
Analyst <i>PTC</i> Agency or Co. <i>#16-071</i> Date Performed <i>8/30/2016</i> Time Period <i>PM Peak Hour</i>						Intersection <i>Edward Rd & Selvitz Rd</i> Area Type <i>All other areas</i> Jurisdiction <i>SLC</i> Analysis Year <i>2021 Proposed Timing</i>						
Volume and Timing Input												
	EB			WB			NB			SB		
	LT	TH	RT	LT	TH	RT	LT	TH	RT	LT	TH	RT
Number of Lanes		1	0	1	1		1		1			
Lane Group		TR		L	T		L		R			
Volume (vph)		386	330	298	381		315		353			
% Heavy Vehicles		5	5	5	5		5		5			
PHF		0.92	0.92	0.92	0.92		0.92		0.92			
Pretimed/Actuated (P/A)		A	A	A	A		A		A			
Startup Lost Time		2.0		2.0	2.0		2.0		2.0			
Extension of Effective Green		2.0		2.0	2.0		2.0		2.0			
Arrival Type		3		3	3		3		3			
Unit Extension		3.0		3.0	3.0		3.0		3.0			
Ped/Bike/RTOR Volume	0	0	0	0	0		0	0	60	0	0	
Lane Width		12.0		12.0	12.0		12.0		12.0			
Parking/Grade/Parking	N	0	N	N	0	N	N	0	N	N	0	N
Parking/Hour												
Bus Stops/Hour		0		0	0		0		0			
Minimum Pedestrian Time		3.2			3.2			3.2			3.2	
Phasing	WB Only	EW Perm	03	04	NB Only	06	07	08				
Timing	G = 12.0	G = 52.0	G =	G =	G = 26.0	G =	G =	G =				
	Y = 5	Y = 5	Y =	Y =	Y = 6	Y =	Y =	Y =				
Duration of Analysis (hrs) = 0.25						Cycle Length C = 106.0						
Lane Group Capacity, Control Delay, and LOS Determination												
	EB			WB			NB			SB		
	LT	TH	RT	LT	TH	RT	LT	TH	RT	LT	TH	RT
Adjusted Flow Rate		779		324	414		342		318			
Lane Group Capacity		832		389	1178		422		377			
v/c Ratio		0.94		0.83	0.35		0.81		0.84			
Green Ratio		0.49		0.65	0.65		0.25		0.25			
Uniform Delay d ₁		25.4		14.3	8.4		37.7		38.1			
Delay Factor k		0.45		0.37	0.11		0.35		0.38			
Incremental Delay d ₂		17.7		14.3	0.2		11.3		15.9			
PF Factor		1.000		1.000	1.000		1.000		1.000			
Control Delay		43.1		28.6	8.6		49.0		53.9			
Lane Group LOS		D		C	A		D		D			
Approach Delay		43.1		17.4			51.4					
Approach LOS		D		B			D					
Intersection Delay		36.9		Intersection LOS							D	

SHORT REPORT												
General Information						Site Information						
Analyst <i>PTC</i> Agency or Co. <i>#16-071</i> Date Performed <i>8/30/2016</i> Time Period <i>PM Peak Hour</i>						Intersection <i>Edward Rd & Selvitz Rd</i> Area Type <i>All other areas</i> Jurisdiction <i>SLC</i> Analysis Year <i>2021 Existing Timing</i>						
Volume and Timing Input												
	EB			WB			NB			SB		
	LT	TH	RT	LT	TH	RT	LT	TH	RT	LT	TH	RT
Number of Lanes		1	0	1	1		1		1			
Lane Group		TR		L	T		L		R			
Volume (vph)		386	330	298	381		315		353			
% Heavy Vehicles		5	5	5	5		5		5			
PHF		0.92	0.92	0.92	0.92		0.92		0.92			
Pretimed/Actuated (P/A)		A	A	A	A		A		A			
Startup Lost Time		2.0		2.0	2.0		2.0		2.0			
Extension of Effective Green		2.0		2.0	2.0		2.0		2.0			
Arrival Type		3		3	3		3		3			
Unit Extension		3.0		3.0	3.0		3.0		3.0			
Ped/Bike/RTOR Volume	0	0	0	0	0		0	0	60	0	0	
Lane Width		12.0		12.0	12.0		12.0		12.0			
Parking/Grade/Parking	N	0	N	N	0	N	N	0	N	N	0	N
Parking/Hour												
Bus Stops/Hour		0		0	0		0		0			
Minimum Pedestrian Time		3.2			3.2			3.2			3.2	
Phasing	WB Only	EW Perm	03	04	NB Only	06	07	08				
Timing	G = 15.0	G = 35.0	G =	G =	G = 40.0	G =	G =	G =				
	Y = 5	Y = 5	Y =	Y =	Y = 6	Y =	Y =	Y =				
Duration of Analysis (hrs) = 0.25						Cycle Length C = 106.0						
Lane Group Capacity, Control Delay, and LOS Determination												
	EB			WB			NB			SB		
	LT	TH	RT	LT	TH	RT	LT	TH	RT	LT	TH	RT
Adjusted Flow Rate		779		324	414		342		318			
Lane Group Capacity		560		311	939		649		580			
v/c Ratio		1.39		1.04	0.44		0.53		0.55			
Green Ratio		0.33		0.52	0.52		0.38		0.38			
Uniform Delay d ₁		35.5		32.1	15.9		25.6		25.9			
Delay Factor k		0.50		0.50	0.11		0.13		0.15			
Incremental Delay d ₂		186.8		62.3	0.3		0.8		1.1			
PF Factor		1.000		1.000	1.000		1.000		1.000			
Control Delay		222.3		94.4	16.2		26.5		27.0			
Lane Group LOS		F		F	B		C		C			
Approach Delay	222.3			50.6			26.7					
Approach LOS	F			D			C					
Intersection Delay	104.8			Intersection LOS						F		

EDWARDS ROAD & SELVITZ ROAD
 FORT PIERCE, FLORIDA
 COUNTED BY: JOHN FLOOD
 SIGNALIZED

TRAFFIC SURVEY SPECIALISTS, INC.
 85 SE 4TH AVENUE, UNIT 109
 DELRAY BEACH, FLORIDA
 PHONE (561)272-3255

Site Code : 00160174
 Start Date: 08/24/16
 File I.D. : EDWASELV
 Page : 1

ALL VEHICLES

Date	From North				EDWARDS ROAD From East				SELVITZ ROAD From South				EDWARDS ROAD From West				Total
	UTurn	Left	Thru	Right	UTurn	Left	Thru	Right	UTurn	Left	Thru	Right	UTurn	Left	Thru	Right	
08/24/16																	
07:00	0	0	0	0	0	63	60	0	0	36	0	50	0	0	63	43	315
07:15	0	0	0	0	0	55	67	0	0	77	0	73	0	0	52	33	357
07:30	0	0	0	0	0	62	80	0	0	58	0	66	0	0	64	54	384
07:45	0	0	0	0	0	57	72	0	0	99	0	92	0	0	47	47	414
Hr Total	0	0	0	0	0	237	279	0	0	270	0	281	0	0	226	177	1470
08:00	0	0	0	0	0	28	67	0	0	91	0	86	0	0	57	46	275
08:15	0	0	0	0	0	52	67	0	0	67	0	65	0	0	51	38	340
08:30	0	0	0	0	0	38	64	0	0	54	0	48	0	0	46	30	280
08:45	0	0	0	0	0	32	49	0	0	53	0	39	0	0	71	36	280
Hr Total	0	0	0	0	0	150	247	0	0	265	0	238	0	0	225	150	1275
* BREAK *																	
16:00	0	0	0	0	0	51	65	0	0	66	0	71	0	0	80	55	388
16:15	0	0	0	0	0	61	79	0	0	50	0	70	0	0	83	56	399
16:30	0	0	0	0	0	60	69	0	0	53	0	67	0	0	71	73	393
16:45	0	0	0	0	0	51	84	0	0	53	0	67	0	0	70	67	392
Hr Total	0	0	0	0	0	223	297	0	0	222	0	275	0	0	304	251	1572
17:00	0	0	0	0	0	60	67	0	0	66	0	68	0	0	79	56	396
17:15	0	0	0	0	0	60	72	0	0	47	0	64	0	0	80	76	399
17:30	0	0	0	0	0	50	84	0	0	50	0	73	0	0	63	53	373
17:45	0	0	0	0	0	39	67	0	0	52	0	57	0	0	57	49	321
Hr Total	0	0	0	0	0	209	290	0	0	215	0	262	0	0	279	234	1489
TOTAL	0	0	0	0	0	819	1113	0	0	972	0	1056	0	0	1034	812	5806

TRAFFIC SURVEY SPECIALISTS, INC.

EDWARDS ROAD & SELVITZ ROAD
 FORT PIERCE, FLORIDA
 COUNTED BY: JOHN FLOOD
 SIGNALIZED

85 SE 4TH AVENUE, UNIT 109
 DELRAY BEACH, FLORIDA
 PHONE (561)272-3255

Site Code : 00160174
 Start Date: 08/24/16
 File I.D. : EDWASELV
 Page : 2

ALL VEHICLES

From North				EDWARDS ROAD From East				SELVITZ ROAD From South				EDWARDS ROAD From West				Total
UTurn	Left	Thru	Right	UTurn	Left	Thru	Right	UTurn	Left	Thru	Right	UTurn	Left	Thru	Right	

Date 08/24/16
 Peak Hour Analysis By Entire Intersection for the Period: 07:00 to 09:00 on 08/24/16

	07:15				07:15				07:15				07:15				
Volume	0	0	0	0	0	202	286	0	0	325	0	317	0	0	220	180	
Percent	0%	0%	0%	0%	0%	41%	59%	0%	0%	51%	0%	49%	0%	0%	55%	45%	
Pk total	0				488				642				400				
Highest	07:00				07:30				07:45				07:30				
Volume	0	0	0	0	0	62	80	0	0	99	0	92	0	0	64	54	
Hi total	0				142				191				118				
PHF	.0				.86				.84				.85				

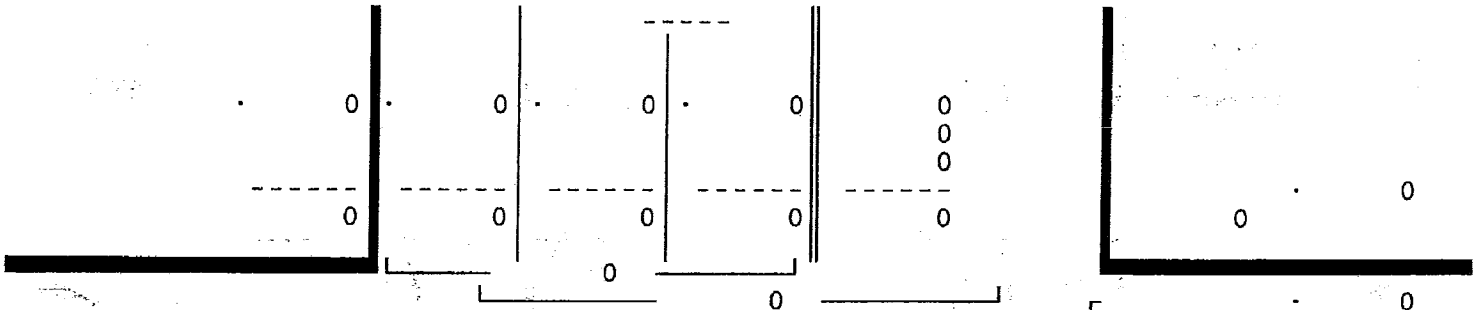

EDWARDS ROAD

325	
286	611
0	
<hr/>	
0	0
<hr/>	
220	220
<hr/>	
180	180
<hr/>	
0	0

ALL VEHICLES

1,011 1,025

Intersection Total
 1,530

488	286	286
<hr/>		
202	202	202
<hr/>		
537	220	317

EDWARDS ROAD

1,024		642
202	325	0
0		
180		
<hr/>		
382	325	0

SELVITZ ROAD

317	0
<hr/>	
317	0

TRAFFIC SURVEY SPECIALISTS, INC.

85 SE 4TH AVENUE, UNIT 109

DELRAY BEACH, FLORIDA

PHONE (561)272-3255

Site Code : 00160174

Start Date: 08/24/16

File I.D. : EDWASELV

Page : 3

EDWARDS ROAD & SELVITZ ROAD

FORT PIERCE, FLORIDA

COUNTED BY: JOHN FLOOD

SIGNALIZED

ALL VEHICLES

Date	From North				EDWARDS ROAD From East				SELVITZ ROAD From South				EDWARDS ROAD From West				Total
	UTurn	Left	Thru	Right	UTurn	Left	Thru	Right	UTurn	Left	Thru	Right	UTurn	Left	Thru	Right	
08/24/16																	
Peak Hour Analysis By Entire Intersection for the Period: 16:00 to 18:00 on 08/24/16																	
Peak start 16:15					16:15				16:15				16:15				
Volume	0	0	0	0	0	232	299	0	0	222	0	272	0	0	303	252	
Percent	0%	0%	0%	0%	0%	44%	56%	0%	0%	45%	0%	55%	0%	0%	55%	45%	
Pk total	0				531				494				555				
Highest	07:00				16:15				17:00				16:30				
Volume	0	0	0	0	0	61	79	0	0	66	0	68	0	0	71	73	
Hi total	0				140				134				144				
PHF	.0				.95				.92				.96				

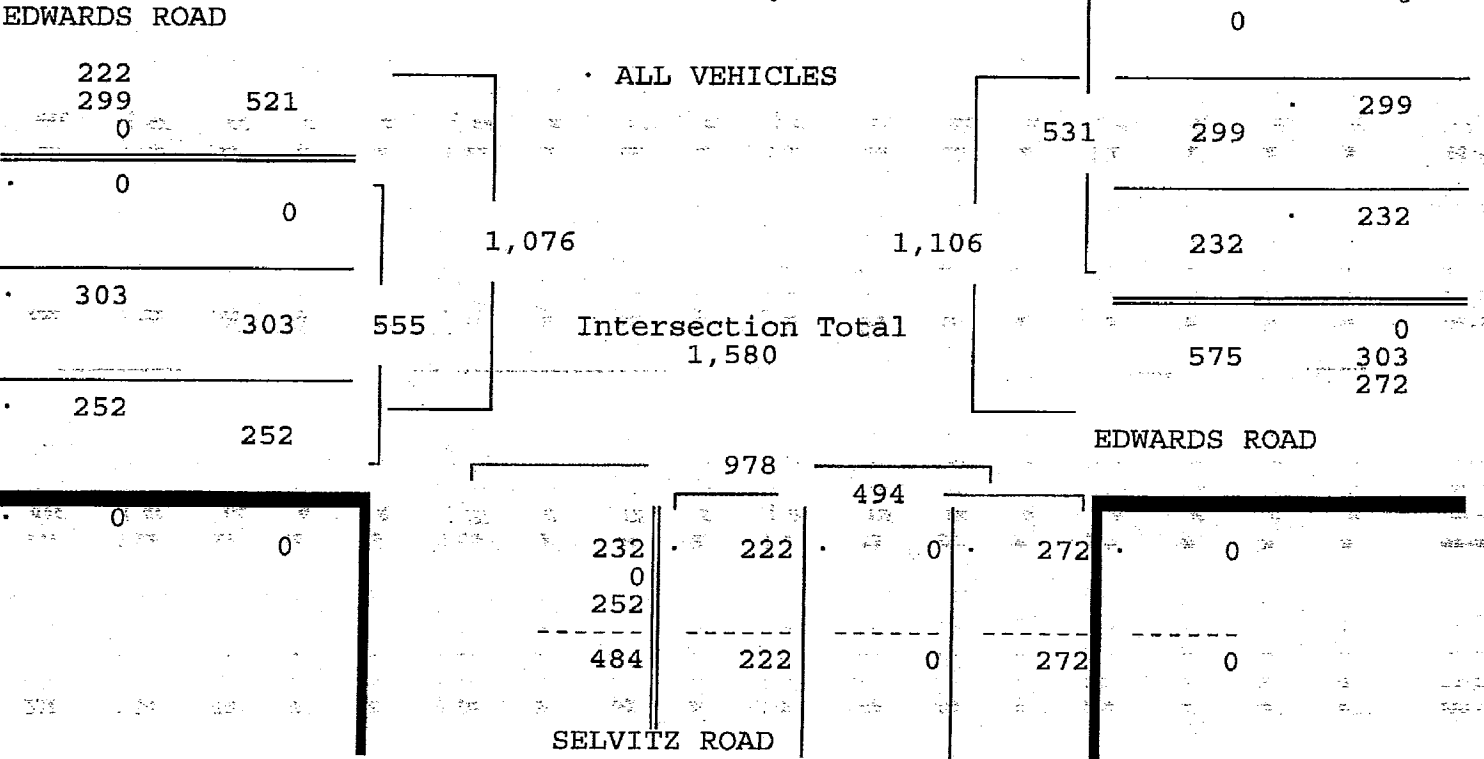
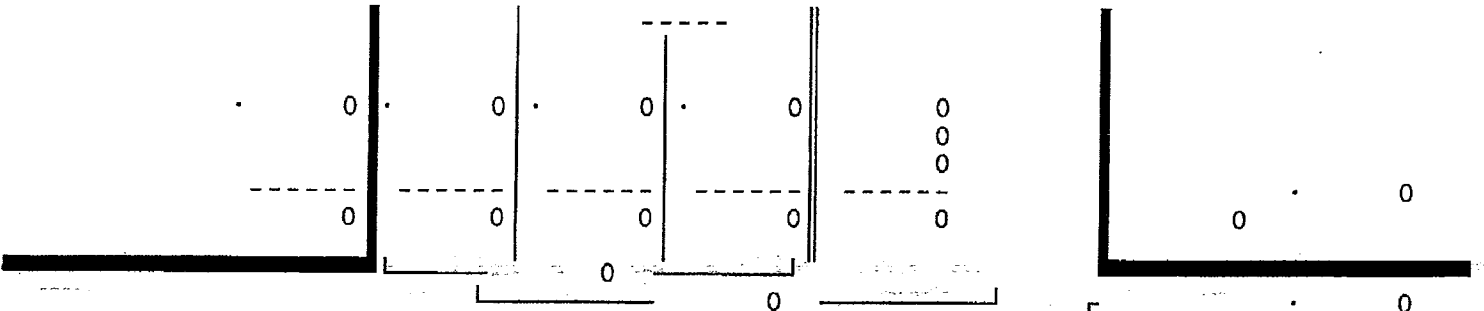

EDWARDS ROAD

ALL VEHICLES

Intersection Total
1,580

EDWARDS ROAD

SELVITZ ROAD

North ↑

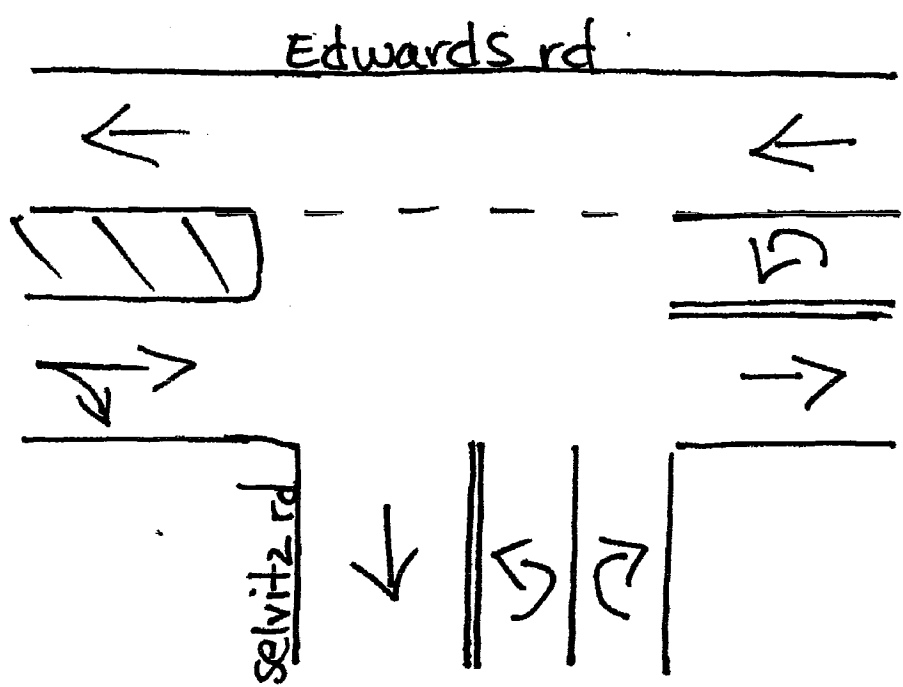

Fort Pierce, Florida
August 25, 2016
drawn by: Luis Palomino
signalized

