

Location Map

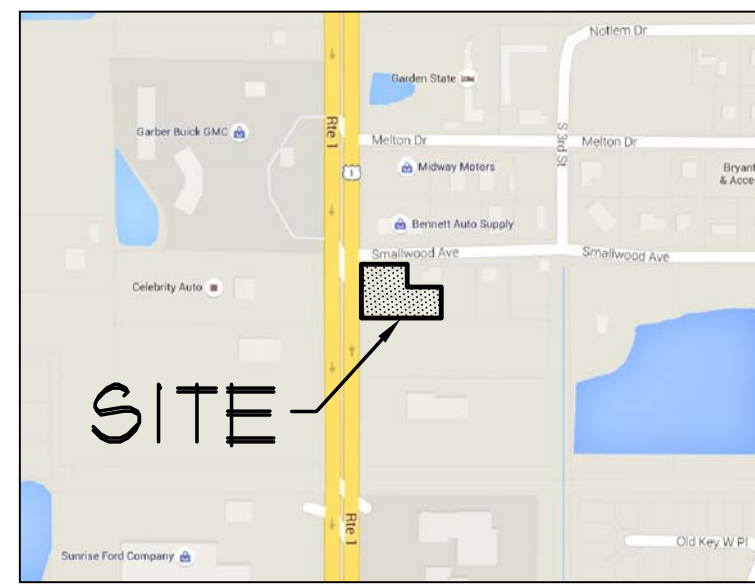

Parcel Data

PCN	3403-433-0007-000-5
TOTAL SITE AREA	30,928 SF / 0.71 AC
SEC/TOWN/RANGE	03 / 36S / 40E
EXISTING ZONING	C-3
ADDRESS	5300 US HWY 1

Parking Data

PARKING SPACES REQUIRED	4
Wholesale Trade (1 / 600 sf)	4
PARKING SPACES PROVIDED	5

Notes

1. THE PLAN HAS BEEN PREPARED WITHOUT THE BENEFIT OF A SURVEY AND SHOULD BE CONSIDERED AN EXHIBIT TO PRESENT SITE IMPROVEMENTS ONLY.
2. ALL CONSTRUCTION SHALL COMPLY WITH THE CONDITIONS SPECIFIED IN THE CITY OF FORT PIERCE CODE OF ORDINANCES SECTIONS 17 AND 22.
3. A BIKE RACK SHALL BE INSTALLED PER CITY OF FORT PIERCE ORDINANCES.

Legal Description

BEGINNING AT A POINT IN THE SW CORNER OF SMALLWOOD AVENUE AND THE INTERSECTION OF U.S. HIGHWAY NO. 1, WHICH INTERSECTION IS LOCATED IN THE NORTHWEST CORNER OF THE SW 1/4 OF THE SW 1/4 OF THE SE 1/4 OF SECTION 3, TOWNSHIP 36 SOUTH, RANGE 40 EAST, ST. LUCIE COUNTY, FLORIDA, FOR POINT OF BEGINNING; THENCE RUN SOUTH ALONG THE EAST RIGHT-OF-WAY OF U.S. HIGHWAY NO. 1 A DISTANCE OF 146 FEET, MORE OR LESS, TO THE INTERSECTION OF THE NORTH BOUNDARY OF A CERTAIN 10 FOOT EASEMENT FOR INGRESS AND EGRESS AND THE EAST RIGHT-OF-WAY BOUNDARY OF U.S. HIGHWAY NO. 1; THENCE RUN EAST 160 FEET ALONG THE NORTHERN BOUNDARY OF THE AFORESAID EASEMENT TO A POINT; THENCE SOUTH 10 FEET; THENCE EAST 175 FEET; THENCE NORTH 81 FEET; THENCE WEST 200 FEET; THENCE NORTH 75 FEET TO THE SOUTH RIGHT-OF-WAY BOUNDARY OF SMALLWOOD AVENUE; THENCE WEST ALONG THE SOUTH BOUNDARY OF SMALLWOOD AVENUE 135, MORE OR LESS, TO THE POINT OF BEGINNING.

Copyright  
All ideas, designs, arrangements, and plans indicated or represented by this drawing are owned by and the property of the designer, and were created, evolved, and developed for use on and in connection with the specified project. None of such ideas, designs, arrangements, or plans shall be used by or disclosed to any person, firm, or corporation for any purpose whatsoever without the written permission of the designer.

SMALLWOOD AVENUE

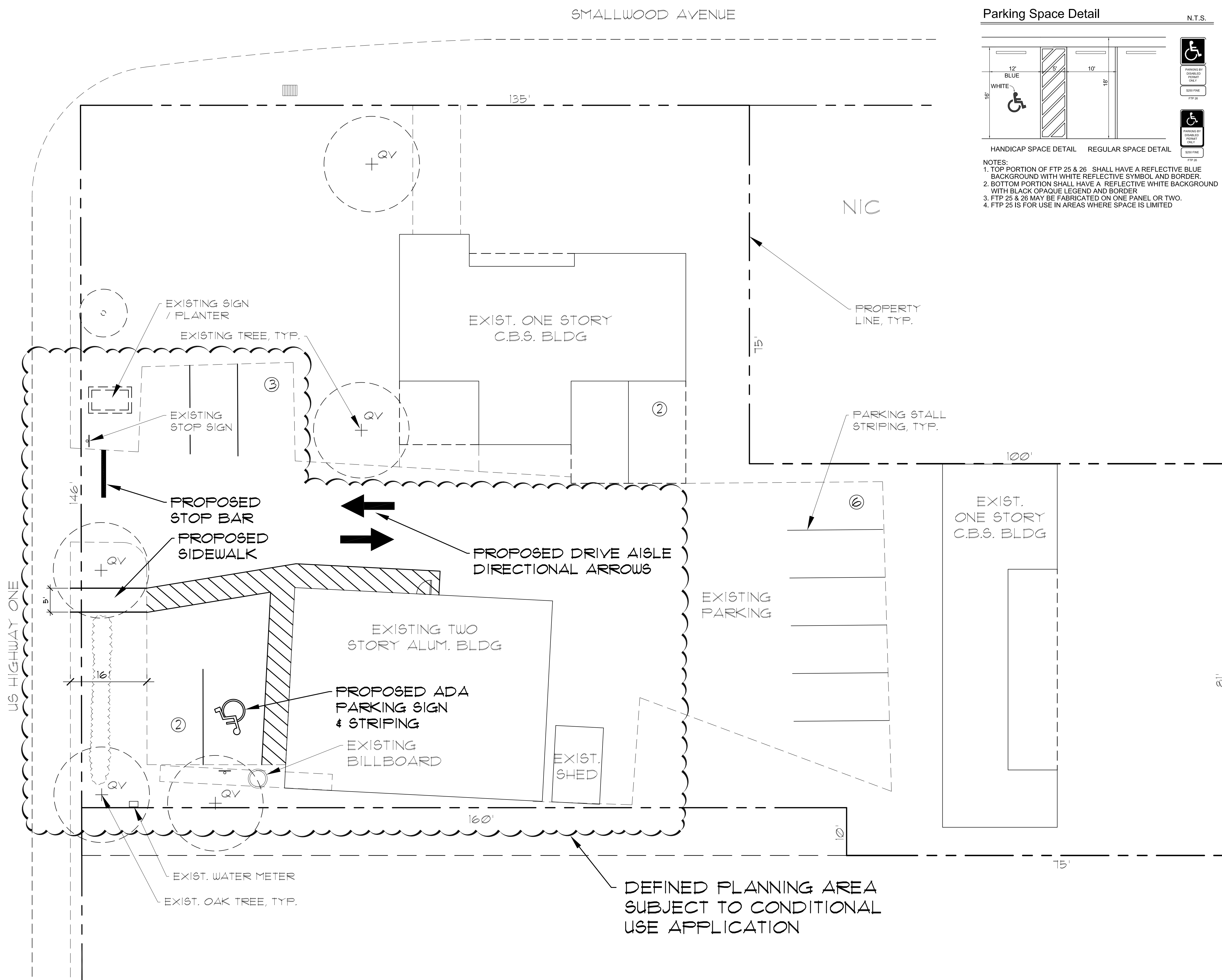

Parking Space Detail

N.T.S.

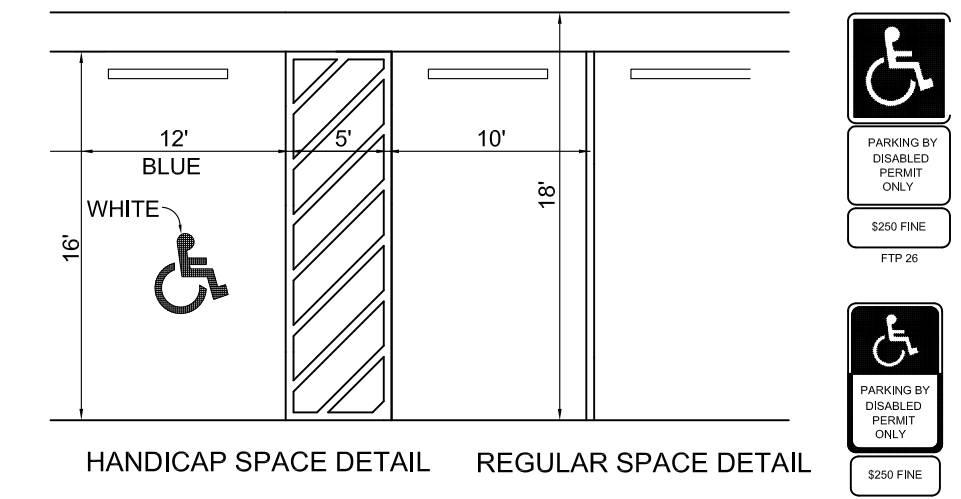

- NOTES:
1. TOP PORTION OF FTP 25 & 26 SHALL HAVE A REFLECTIVE BLUE BACKGROUND WITH WHITE REFLECTIVE SYMBOL AND BORDER.
  2. BOTTOM PORTION SHALL HAVE A REFLECTIVE WHITE BACKGROUND WITH BLACK OPAQUE LEGEND AND BORDER.
  3. FTP 25 & 26 MAY BE FABRICATED ON ONE PANEL OR TWO.
  4. FTP 25 IS FOR USE IN AREAS WHERE SPACE IS LIMITED



McCarty & Associates

LAND PLANNING AND DESIGN

STUART • FT. PIERCE

772.341.9322  
www.McCartyLandPlanning.com  
Mike@McCartyLandPlanning.com

**Rico Farms**  
5300 S US HWY 1  
City of Fort Pierce, Florida  
**Site Improvement Exhibit**

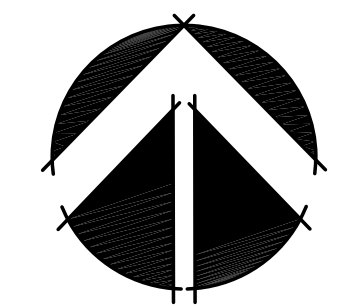

Scale: 1" = 10'

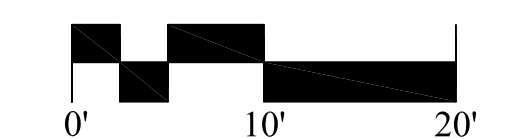

Drawn By \_\_\_\_\_ SL  
Checked By \_\_\_\_\_ MM  
Scale \_\_\_\_\_ 1" = 10'  
Drawing Date \_\_\_\_\_ 2/26/2016  
staff comments 2/29/2016